

Keychron Q1 Max Wireless Mechanical Keyboard



Keychron Q1 Max Wireless Mechanical Keyboard User Manual

[Home](#) » [Keychron](#) » Keychron Q1 Max Wireless Mechanical Keyboard User Manual 

Contents

- [1 Keychron Q1 Max Wireless Mechanical Keyboard](#)
- [2 Fully Assembled Version](#)
- [3 Barebone Version](#)
- [4 Connect 2.4 GHz Receiver](#)
- [5 Connect Bluetooth](#)
- [6 Connect Cable](#)
- [7 Adjust The Backlight Brightness](#)
- [8 Documents / Resources](#)
 - [8.1 References](#)



Keychron

Keychron Q1 Max Wireless Mechanical Keyboard



Fully Assembled Version

Keyboard

- 1x Fully Assembled Keyboard

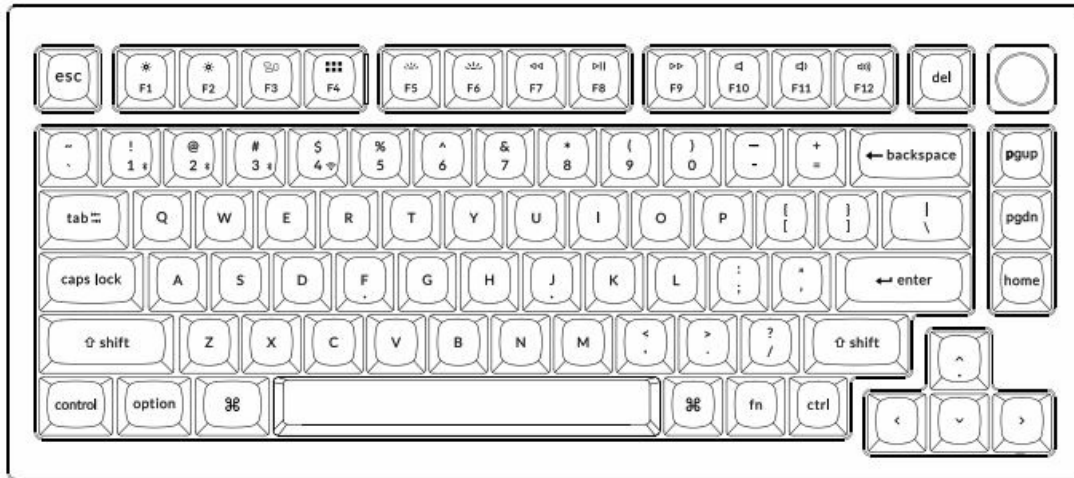

Including

- 1x Aluminum Case
- 1x PCB
- 1x PC Plate
- 1x Sound Absorbing Foam
- 1x IXPE Foam
- 1x PET Foam
- 1x Latex Bottom Pad
- 1x Bottom Case Acoustic Foam
- 1x Bottom Case PET Foam
- 14x Gaskets (10 Installed and 4 in the Box)
- 4 sets x Stabilizers
- 1 set x Keycaps (PBT Double-shot)
- 1 set x Switches

Cable

- 1x Type-C to Type-C Cable
- 1x Type-A to Type-C Adapter

Receiver

- 1x Type-A 2.4 GHz Receiver

Tools

- 1x Keycap & Switch Puller

- 1x Screwdriver
- 1x Hex Key

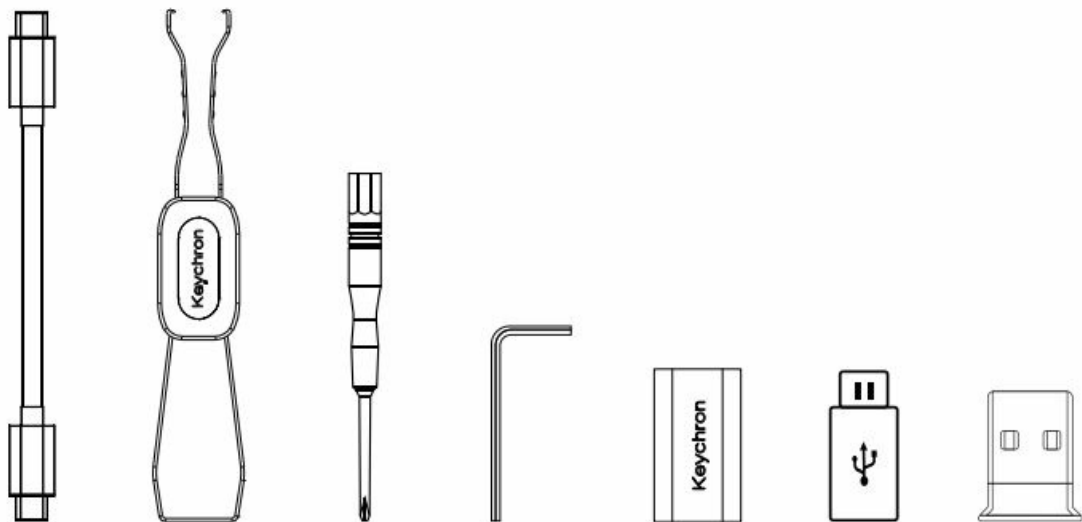

Barebone Version

- Keyboard Kit
- 1x Keyboard Kit (Without Keycaps & Switches)

Including

- 1x Aluminum Case
- 1x PCB
- 1x PC Plate
- 1x Sound Absorbing Foam
- 1x IXPE Foam
- 1x PET Foam
- 1x Latex Bottom Pad
- 1x Bottom Case Acoustic Foam
- 1x Bottom Case PET Foam
- 14x Gaskets (10 Installed and 4 in the Box)
- 4 sets x Stabilizers

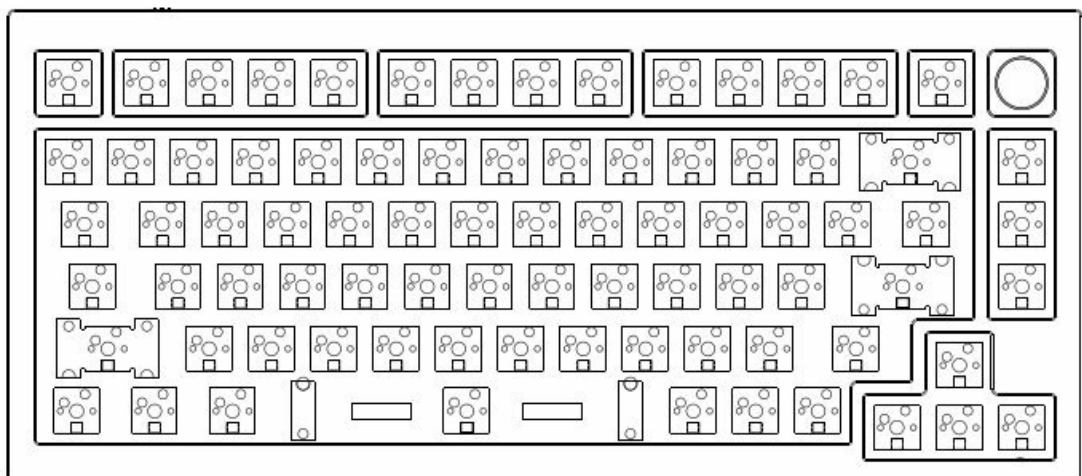

Cable

- 1x Type-C to Type-C Cable
- 1x Type-A to Type-C Adapter

Receiver

- 1x Type-A 2.4 GHz Receiver

Tools

- 1x Keycap & Switch Puller
- 1x Screwdriver
- 1x Hex Key

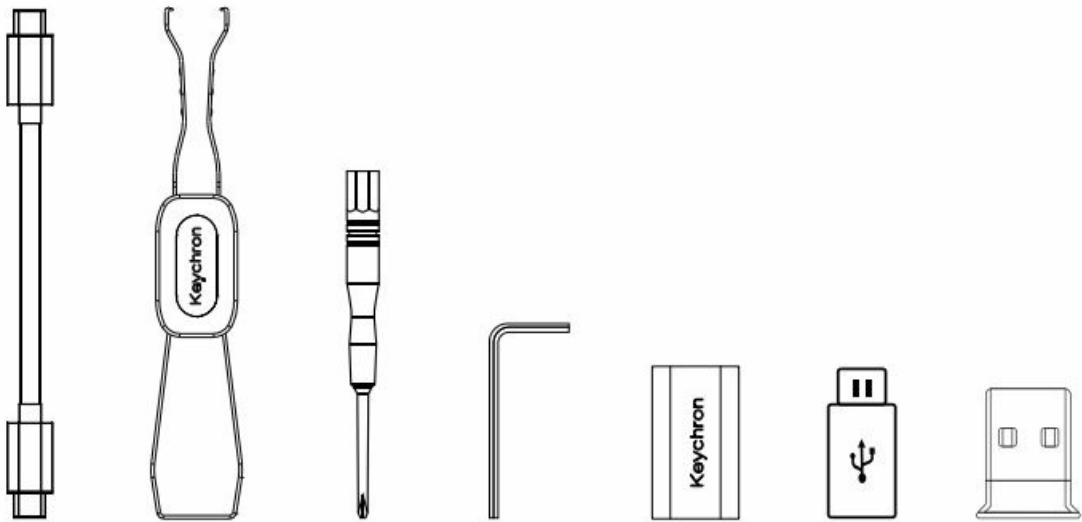

Quick Start Guide

- If you are a Windows user, please find the appropriate keycaps in the box, then follow the instructions below to find and replace the following keycaps.

Mac / Windows

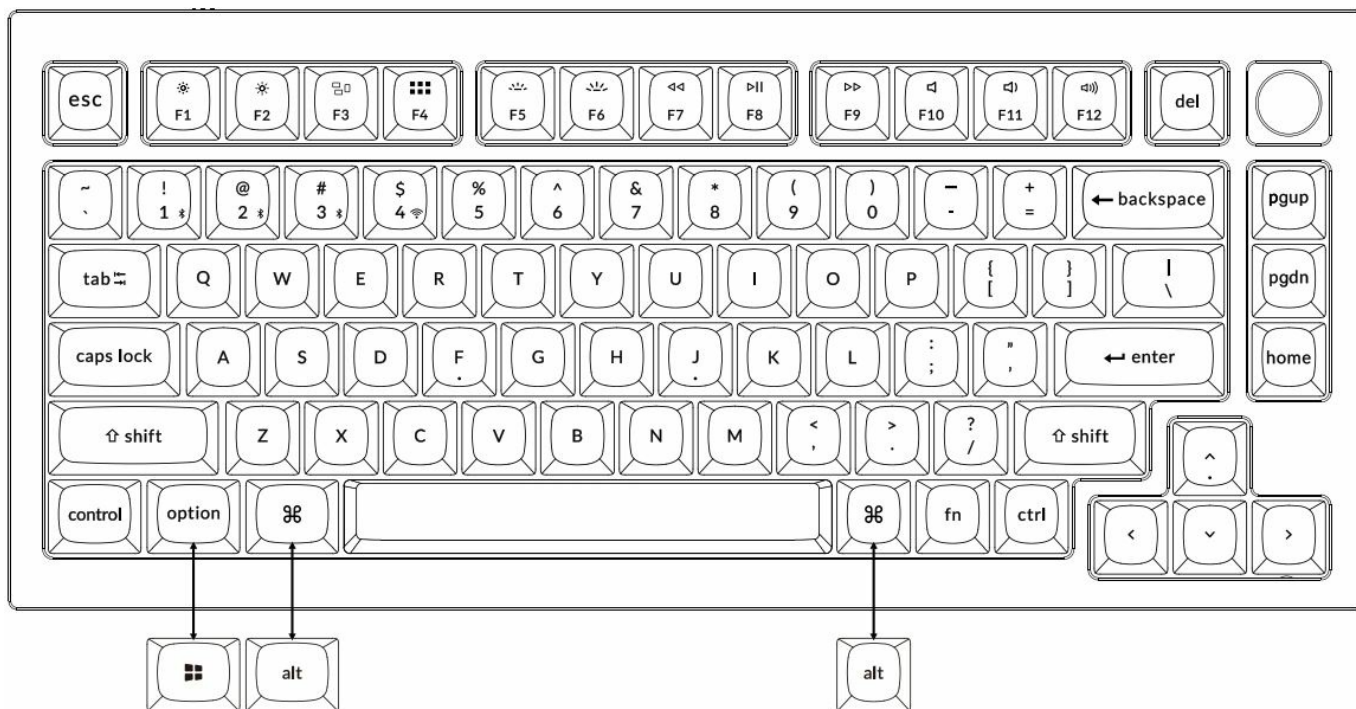

Connect 2.4 GHz Receiver

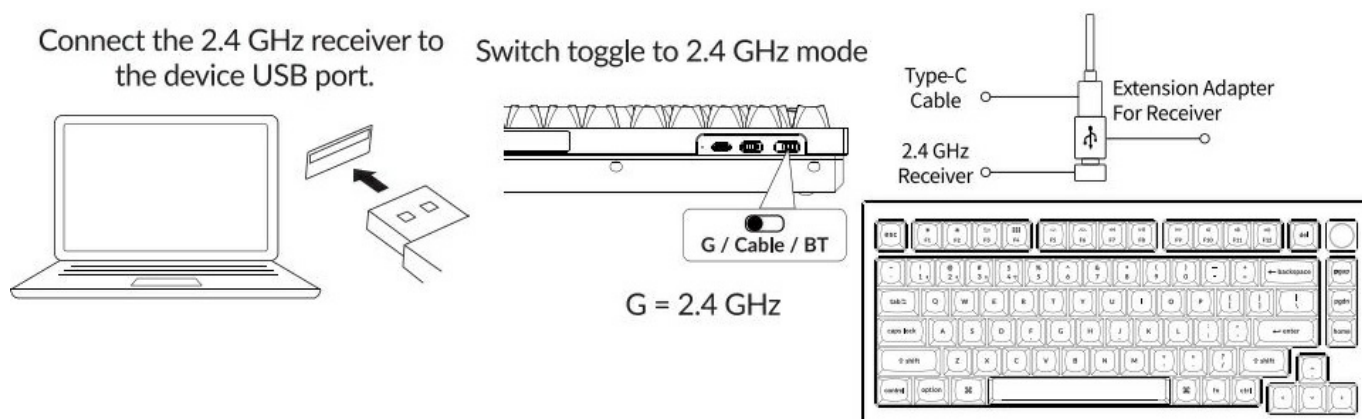

- **Note:** For the best wireless experience, we recommend using the extension adapter for the receiver and putting the 2.4 GHz receiver somewhere on your desk close to your keyboard for a low rate of latency and fewer signal interferences.

Connect Bluetooth

- Press fn + 1 (for 4 seconds) and pair with a device named Keychron Q1 Max

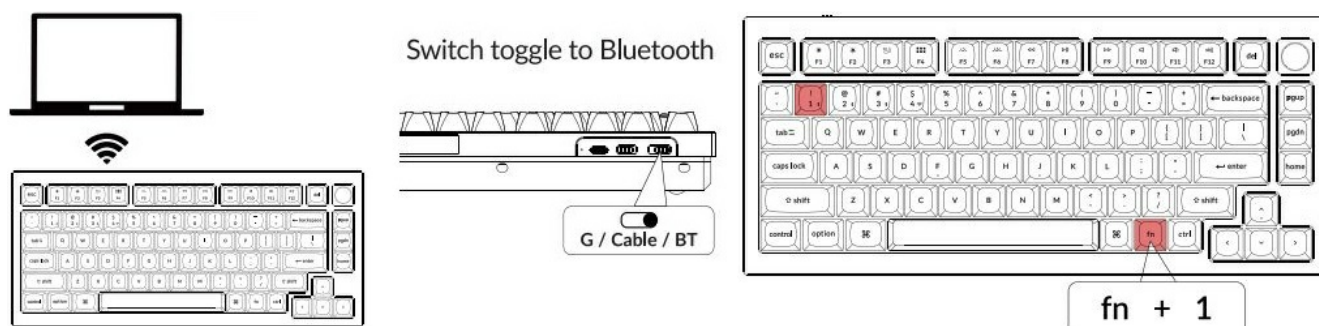

Connect Cable

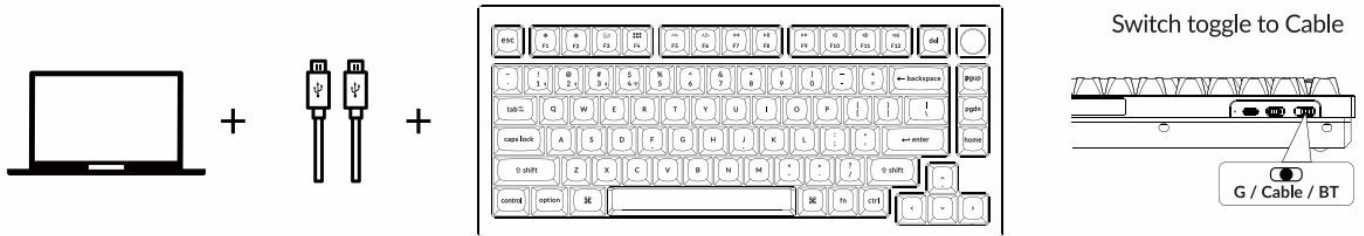

The VIA Key Remapping Software

- Please visit use.via.app to use the online VIA software to remap the keys.
- If the VIA cannot recognize your keyboard, please reach our support to get the instruction.



- The online VIA software can only run on the latest version of Chrome, Edge, and Opera browsers.
- VIA only works when the keyboard is connected by wire to the computer.

The Layers

- There are four layers of key settings on the keyboard. Layer 0 and layer 1 are for the Mac system. Layer 2 and layer 3 are for the Windows system.
- If your system toggle is switched to Mac, then layer 0 will be activated.
- If your system toggle is switched to Windows, then layer 2 will be activated. Remember that if you are using it in Windows mode, please make changes to layer 2 instead of the top layer (layer 0).
- This is a common mistake people are making.



The Backlight

- Press fn + Q to change the lighting effect
- Press the fn + tab to turn the backlight on/off

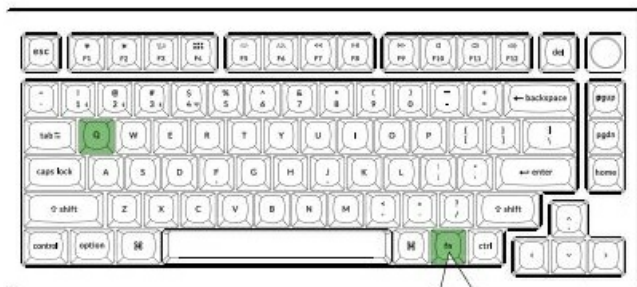

fn + Q

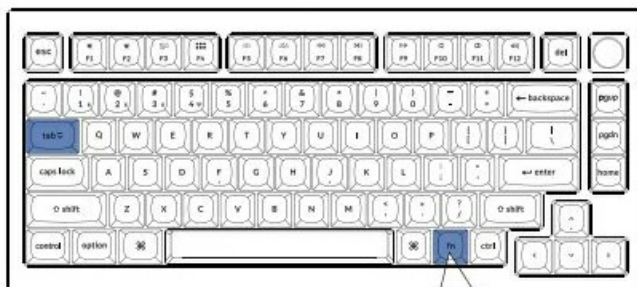

fn + tab

Adjust The Backlight Brightness

- Press fn + W to increase the backlight brightness
- Press fn + S to decrease the backlight brightness



fn + W

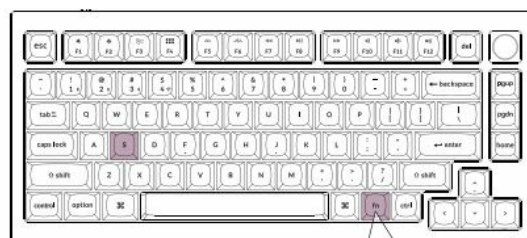

fn + S

Adjust The Backlight Speed

- Press fn + T to increase the light effect speed
- Press fn + G to decrease the light effect speed

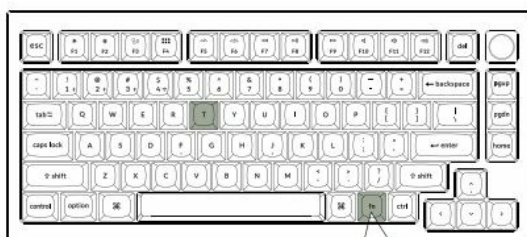

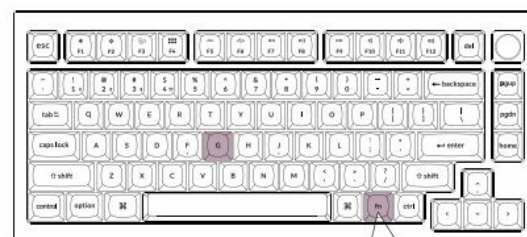

fn + T



fn + G

Documents / Resources

	Keychron Q1 Max Wireless Mechanical Keyboard [pdf] User Manual 2ASF4-Q1MAX, 2ASF4Q1MAX, Q1 Max Wireless Mechanical Keyboard, Q1 Max, Wireless Mechanical Keyboard, Mechanical Keyboard, Keyboard
	Keychron Q1 Max Wireless Mechanical Keyboard [pdf] User Manual 2ASF4-Q1MAX, 2ASF4Q1MAX, q1max, Q1 Max Wireless Mechanical Keyboard, Q1 Max, Wireless Mechanical Keyboard, Mechanical Keyboard, Keyboard

References

- [User Manual](#)

[Manuals+](#), [Privacy Policy](#)

This website is an independent publication and is neither affiliated with nor endorsed by any of the trademark owners. The "Bluetooth®" word mark and logos are registered trademarks owned by Bluetooth SIG, Inc. The "Wi-Fi®" word mark and logos are registered trademarks owned by the Wi-Fi Alliance. Any use of these marks on this website does not imply any affiliation with or endorsement.