

Keychron K5 Max Mechanical Keyboard



Keychron K5 Max Mechanical Keyboard User Guide

[Home](#) » [Keychron](#) » Keychron K5 Max Mechanical Keyboard User Guide 

Contents

- [1 Keychron K5 Max Mechanical Keyboard](#)
- [2 USING INSTRUCTION](#)
- [3 Warranty](#)
- [4 Factory Reset](#)
- [5 Documents / Resources](#)
 - [5.1 References](#)
- [6 Related Posts](#)



Keychron K5 Max Mechanical Keyboard



USING INSTRUCTION

If you are a Windows user, please find the appropriate keycaps in the box, then follow the instructions below to find and replace the following keycaps.

1. Connect 2.4GHz Receiver

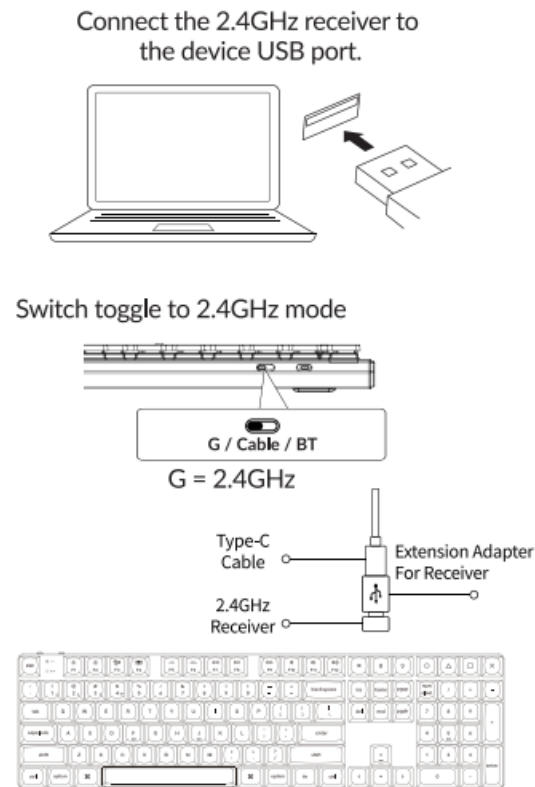

Note:For the best wireless experience, we recommend using the extension adapter for the receiver and putting the 2.4GHz receiver somewhere on your desk close to your keyboard for a low rate of latency and fewer signal interferences.

2. Connect Bluetooth



Switch toggle to Bluetooth

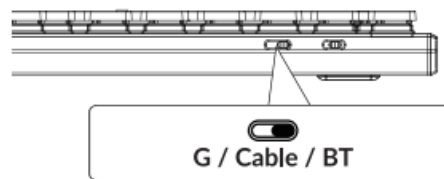

Press fn + 1 (for 4 seconds) and pair with device named Keychron K5 Max.

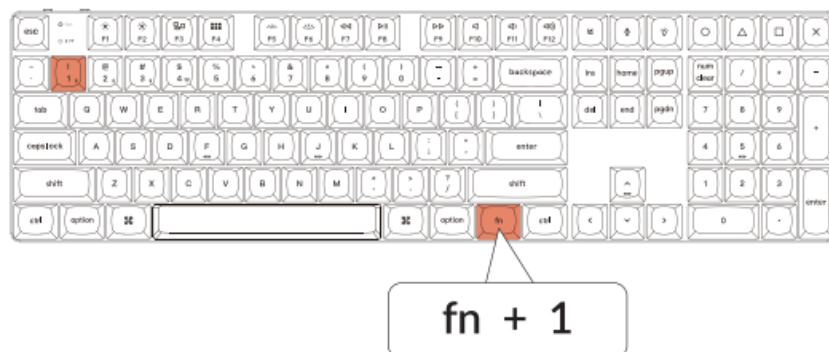

3. Connect Cable



4. Switch To The Right System

Please make sure the system toggle on the top left corner has been switched to the same system as your computer's operating system.

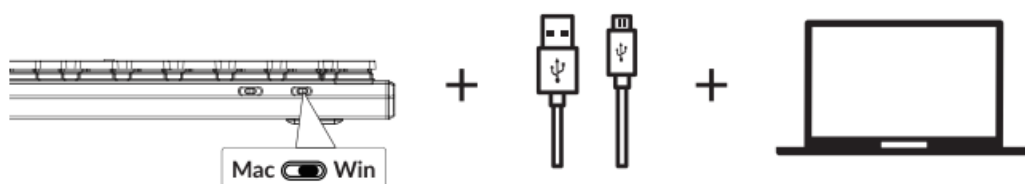

5. The Layers

1. There are four layers of key settings on the keyboard. Layer 0 and layer 1 are for the Mac system. Layer 2 and layer 3 are for the Windows system.

2. If your system toggle is switched to Mac, then layer 0 will be activated.

3. If your system toggle is switched to Windows, then layer 2 will be activated. Remember that if you are using it in Windows mode, please make a change to layer 2 instead of the top layer (layer 0) This is a common mistake that are making

6. The VIA Key Remapping Software

Please visit us via. app to use the online VIA software to remap the keys.

If the VIA cannot recognize your keyboard, please reach our support to get the instruction.



The online VIA software can only run on the latest version of Chrome, Edge, and Opera browsers yet.

A colonel on the labored to connect bacon to the commenter

7. The Backlight

- Press fn + Q to change the lighting effect
- Press fn + tab to turn the backlight on/off

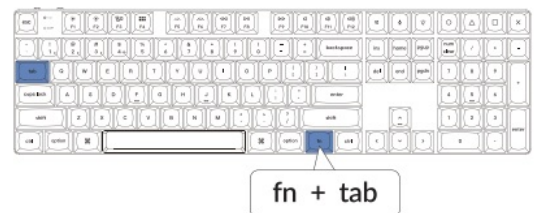

8. Adjust The Backlight Brightness

- Press fn + W to increase the backlight brightness
- Press fn + S to decrease the backlight brightness

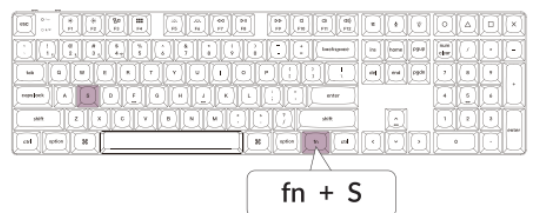

Warranty

The keyboard is highly customizable and easy to rebuild.

If anything goes wrong with any of the keyboard components of the keyboard during the warranty period, we will only replace the defective parts of the keyboard, not the whole keyboard.

Factory Reset

Troubleshooting? Don't know what's going on with the keyboard?



1. Download the right firmware and QMK Toolbox from our website.
2. Unplug the power cable and switch the keyboard to Cable mode.
3. Remove the space bar keycap to find the reset button on the PCB.
4. Hold the reset key first, then plug the power cable into the keyboard. Release the reset key after 2 seconds, and the keyboard will now enter DFU mode.
5. Flash the firmware with the QMK Toolbox.
6. Factory reset the keyboard by pressing fn + J + Z (for 4 seconds).
Step by step guide can be found on our website.

Not Happy

support@keychron.com

Documents / Resources



[Keychron K5 Max Mechanical Keyboard](#) [pdf] User Guide
K5 Max Mechanical Keyboard, K5 Max, Mechanical Keyboard, Keyboard

References

- [User Manual](#)

[Manuals+](#), [Privacy Policy](#)

This website is an independent publication and is neither affiliated with nor endorsed by any of the trademark owners. The "Bluetooth®" word mark and logos are registered trademarks owned by Bluetooth SIG, Inc. The "Wi-Fi®" word mark and logos are registered trademarks owned by the Wi-Fi Alliance. Any use of these marks on this website does not imply any affiliation with or endorsement.