



Keychron K3 Max Wireless Mechanical Keyboard User Guide

[Home](#) » [Keychron](#) » Keychron K3 Max Wireless Mechanical Keyboard User Guide 



K3 Max Wireless Mechanical Keyboard

Contents

- [1 IN THE BOX:](#)
- [2 K3 Max BLUETOOTH MECHANICAL KEYBOARD SPECIFICATIONS](#)
- [3 K3 Max BLUETOOTH MECHANICAL KEYBOARD OVERVIEW](#)
- [4 DEFAULT KEY LAYOUT:](#)
- [5 KEY DESCRIPTION](#)
- [6 FUNCTION DESCRIPTION: CHARGING](#)
- [7 TROUBLESHOOTING](#)
- [8 Documents / Resources](#)
 - [8.1 References](#)

IN THE BOX:

Keychron K3 Max Wireless Mechanical Keyboard x 1
Type-C Cable x 1
Manual x 1
Quick Start Guide x 1
Extra Keycaps Set x 1
Type-A to Type-C Adapter x 1
Type-A 2.4GHz Receiver x 1

QUICK START GUIDE

If you are a Windows user, please find the appropriate keycaps in the box, then follow the instructions below to find and replace the following keycaps.

Mac / Windows

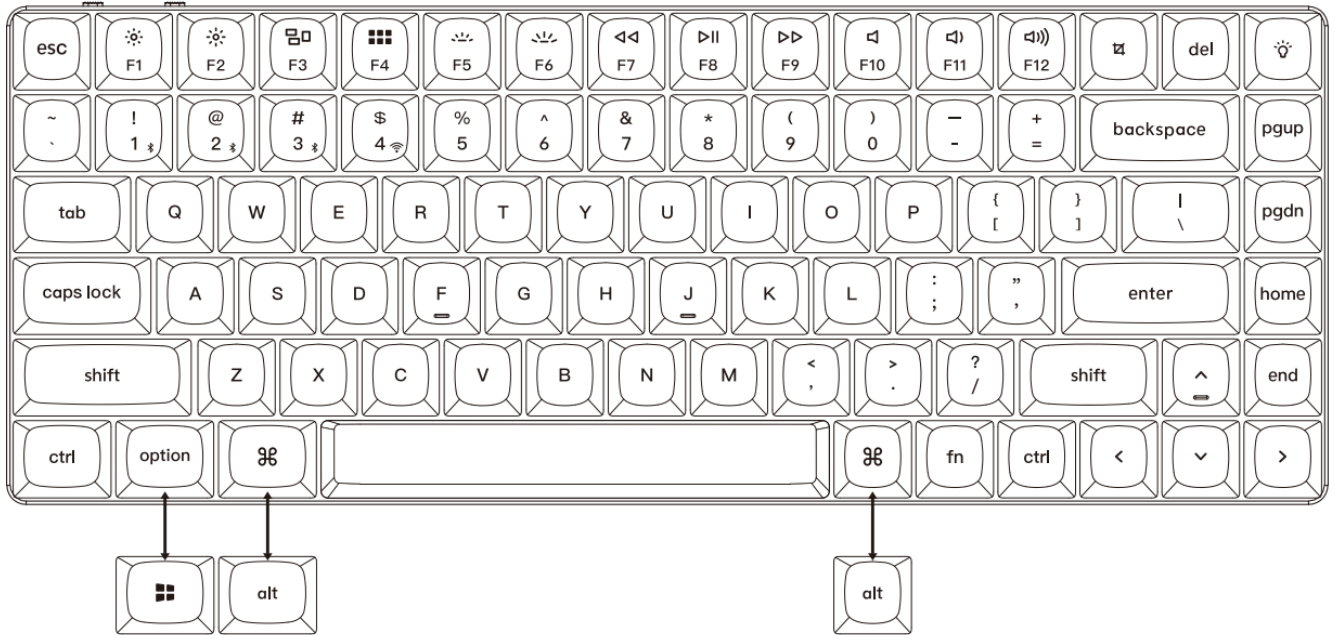

1. connect 2.4GHz Receiver

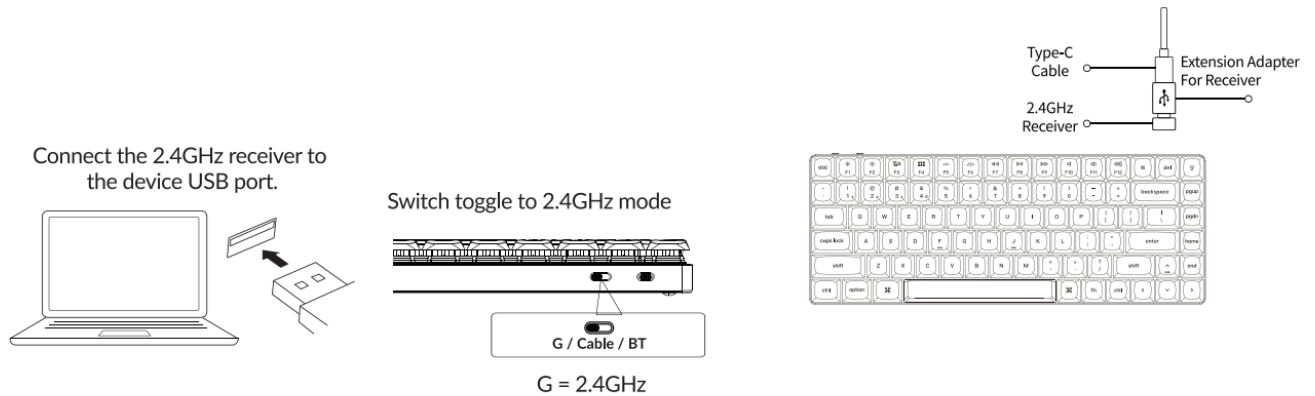

Note: For the best wireless experience, we recommend using the extension adapter for receiver and putting the 2.4GHz receiver somewhere on your desk close to your keyboard for a low rate of latency and fewer signal interferences.

2. Connect Bluetooth

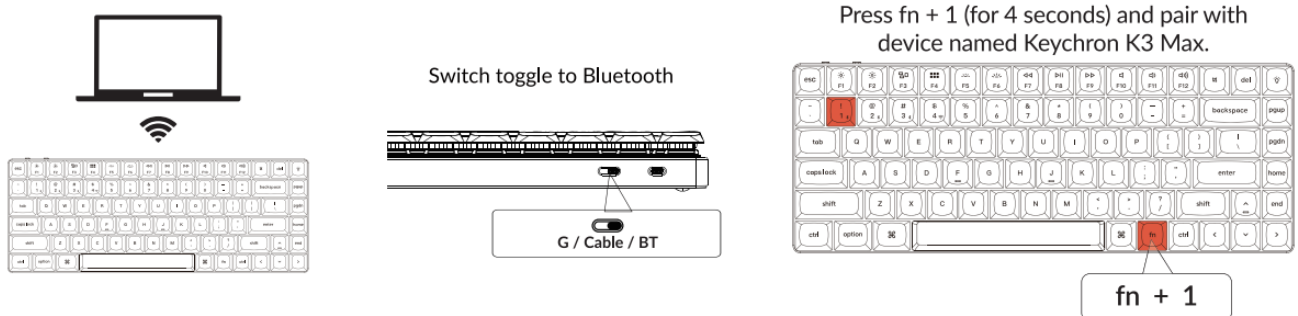

3. Connect Cable



4. The VIA Key Remapping Software

Please visit usevia.app to use the online VIA software to remap the keys.

If the VIA cannot recognize your keyboard, please reach our support to get the instruction.



- * The online VIA software can only run on the latest version of Chrome, Edge, and Opera browsers yet.
- * VIA only works when the keyboard is connected by wire to the computer.

5. The Layers

<p>There are four layers of key settings on the keyboard. The layer 0 and layer 1 are for the Mac system. The layer 2 and layer 3 are for the Windows system.</p>	<p>If your system toggle is switched to Mac, then the layer 0 will be activated.</p>	<p>If your system toggle is switched to Windows, then the layer 2 will be activated. Remember that if you are using it in Windows mode, please make changes to the layer 2 instead of the top layer (the layer 0).</p> <p>This is a common mistake people are making.</p>

6. The Backlight

Press **fn + Q** to change the lighting effect

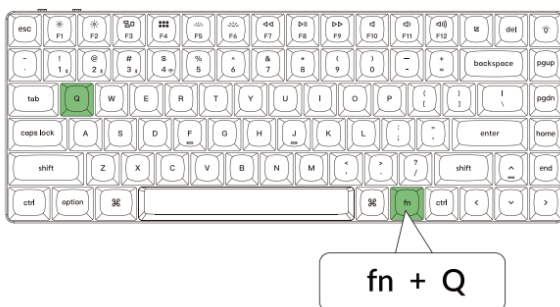

Press **fn + tab** to turn the backlight on/off

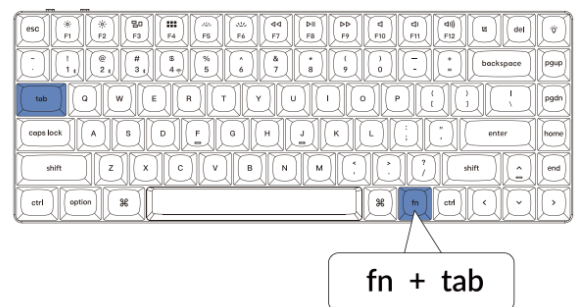

7. Adjust The Backlight Brightness

Press **fn + W** to increase the backlight brightness

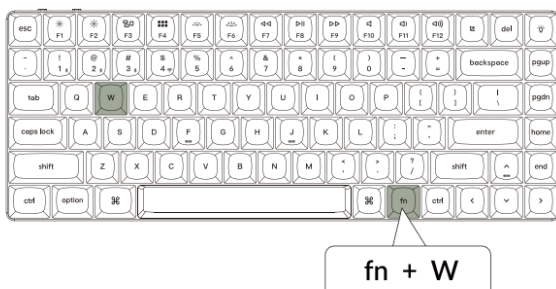

Press **fn + S** to decrease the backlight brightness

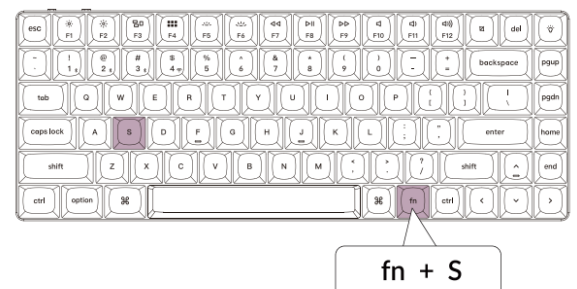

8. Adjust The Backlight Speed

Press fn + T to increase the light effect speed

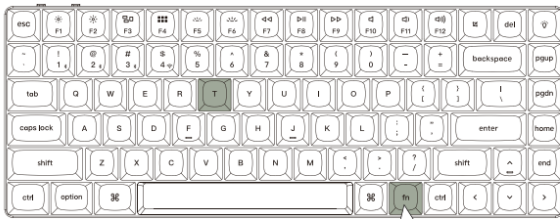

fn + T

Press fn + G to decrease the light effect speed

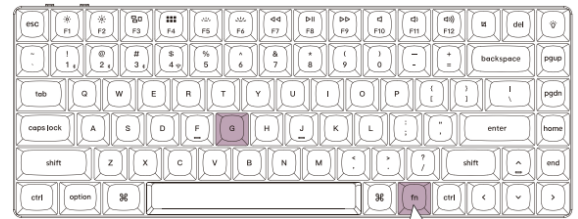

fn + G

9. Warranty

The keyboard is highly customizable and easy to be rebuilt.

If anything goes wrong with any of the keyboard components of keyboard during the warranty period, we will only replace the defective parts of the keyboard, not the whole keyboard.



10. Watch The Building Tutorial On Our Website

If you are building the keyboard for the first time, we highly recommend you watch the building tutorial video on our website first, then start building the keyboard yourself."



11. Factory Reset

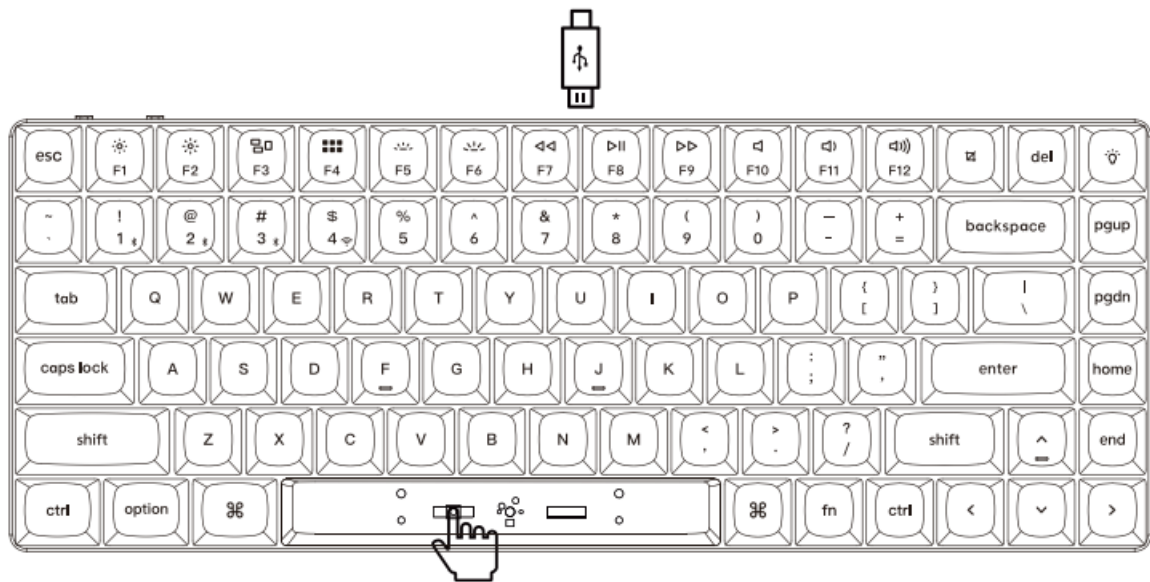

Troubleshooting? Don't know what's going on with the keyboard?

1. Download the right firmware and QMK Toolbox from our website.
 2. Unplug the power cable and switch the keyboard to Cable mode.
 3. Remove the space bar keycap to find the reset button on the PCB.
 4. Hold the reset key first, then plug the power cable into the keyboard.
Release the reset key after 2 seconds, and the keyboard will now enter DFU mode.
 5. Flash the firmware with the QMK Toolbox.
 6. Factory reset the keyboard by pressing fn + J + Z (for 4 seconds).
- * Step by step guide can be found on our website.

K3 Max BLUETOOTH MECHANICAL KEYBOARD SPECIFICATIONS

Number of keys: 84
 Switch type: Mechanical
 Battery: 1550mAh
 Charging time: Around 3 hours
 Charging port: USB Type-C
 Mode: Bluetooth / Wired / 2.4GHz
 Bluetooth operating distance: Within 10 meters (open space)
 Name of Bluetooth device: Keychron K3 Max

LED STATUS OVERVIEW

Function	LED Location	Status
Charging	Battery Indicator	Low Power – Red Light Blinking Charging – Static Red Full charged – Static Green
Bluetooth	Bluetooth Indicator	Switching – Fast Blinking Paired – Light Off Pairing – Slow Blinking
2.4G	2.4G Indicator	Reconnecting-Fast Blinking Paired – Light Off Pairing – Slow Blinking

K3 Max BLUETOOTH MECHANICAL KEYBOARD OVERVIEW

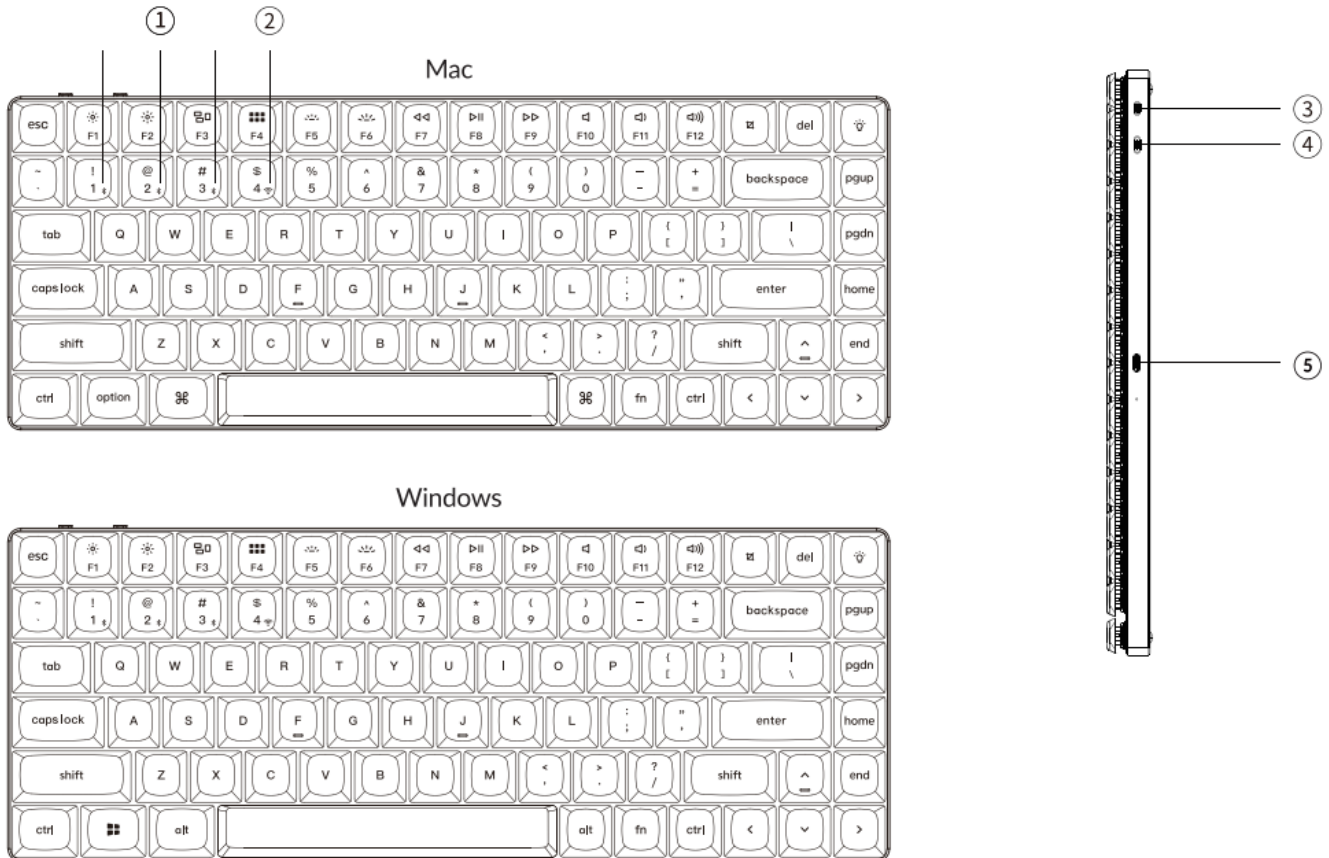

1. Bluetooth indicator
2. 2.4G Indicator
3. Win/Android Mac/iOS (OS Toggle)
4. 92.4G /Cable/ BT(Connection Mode Toggle)
5. Charging port

DEFAULT KEY LAYOUT:

LAYER 0: This layer will be activated when your keyboard's system toggle is switched to Mac.

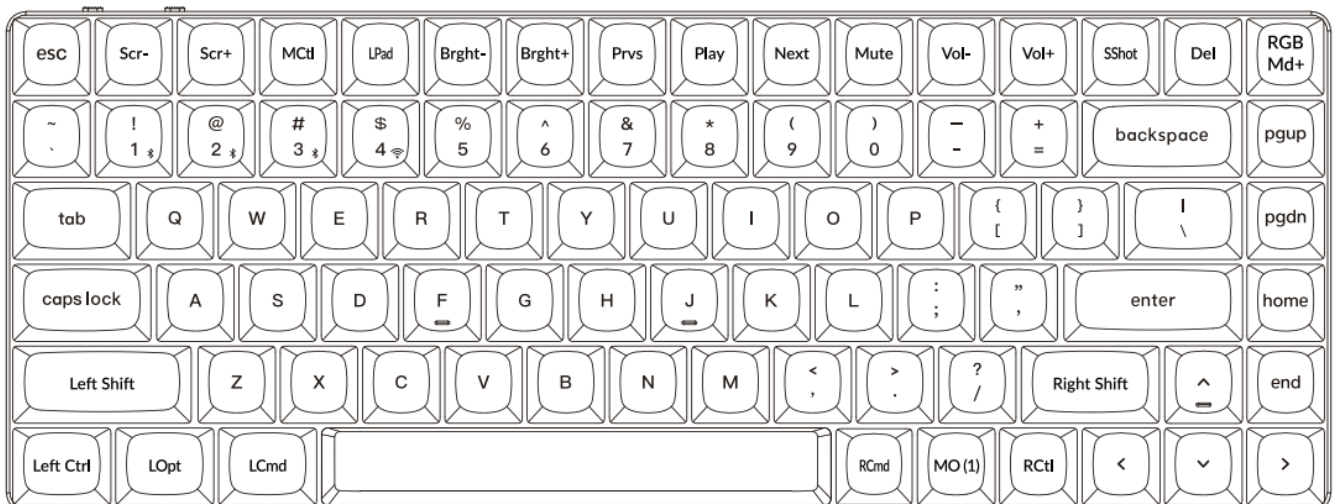

LAYER 1: This layer will be activated when your keyboard's system toggle is switched to Mac and press the

fn/MO(1) key.

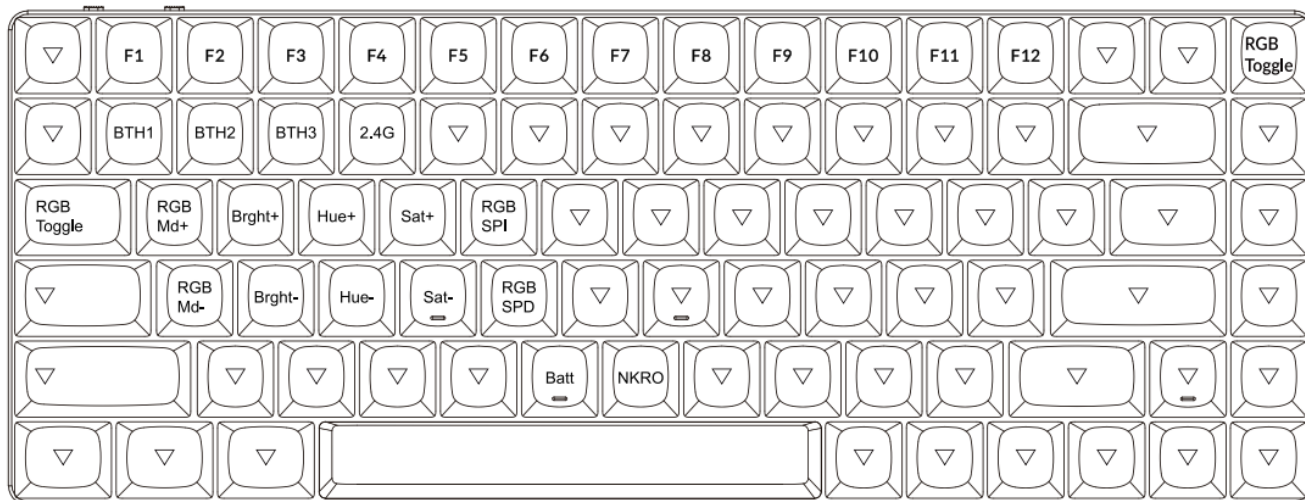

LAYER 2: This layer will be activated when your keyboard's system toggle is switched to Windows.

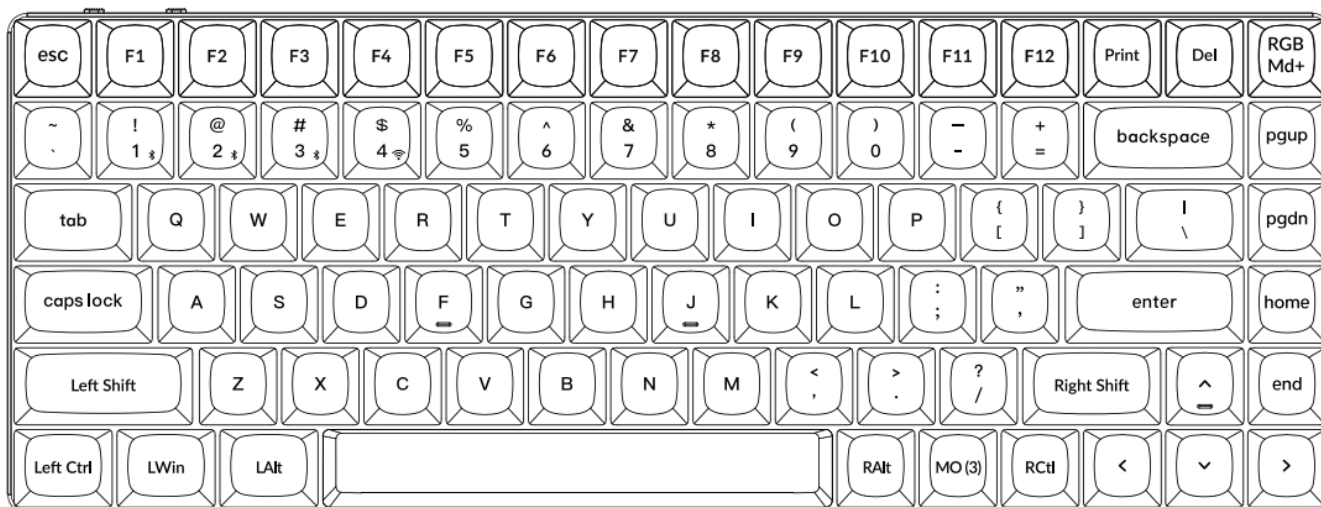

LWin = Left Windows LAlt = Left Alt RAlt = Right Alt Rctl = Right Ctrl

LAYER 3: This layer will be activated when your keyboard's system toggle is switched to Windows and press the fn/MO(3) key.

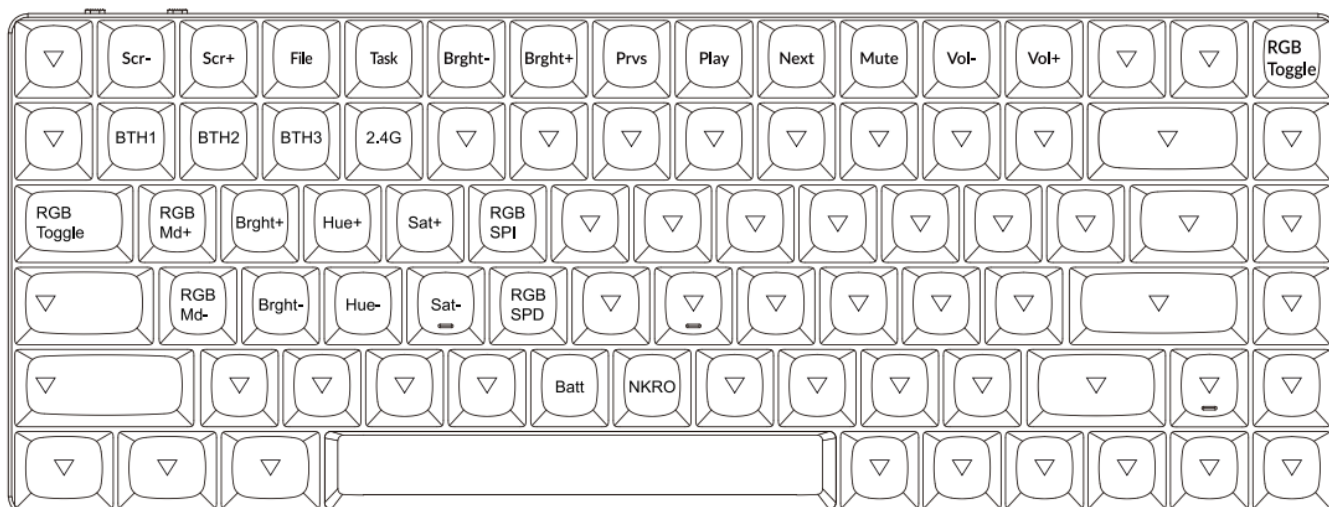

KEY DESCRIPTION

Key Description	
Ser-	Screen Brightness Decrease
Ser+	Screen Brightness Increase
Bright-	Backlight Decrease
Bright+	Backlight Increase
Prvs	Previous
Play	Play/Pause
Next	Next
Mute	Mute
Vol-	Volume Decrease
Vol+	Volume Increase
RGBToggle	Turn Backlight on/off
RGBMd+	RGB Mode Next
RGBMd	RGB Mode Previous
Hue+	Hue Increase
Hue	Hue Decrease
RGBSPI	RGB Speed Increase
RGB SPD	RGB Speed Decrease
MO(1)	Layer 1 will be activated when holding this key
MO(2)	Layer 2 will be activated when holding this key
MO(3)	Layer 3 will be activated when holding this key
BTH1	Bluetooth Host 1
BTH2	Bluetooth Host 2
BTH3	Bluetooth Host 3
2.4G	2.4GHz Host

FUNCTION DESCRIPTION: CHARGING

Plug the cable into a USB port and plug the other end into the keyboard port. Charging Indicator: A red light will stay on while charging; Fully charged in around 5 hours, a green battery indicator will appear.

The K3 Max keyboard is compatible with all USB ports. Please use a 5V 1A adapter or USB 3.0 for the best performance. The K3 Max can be charged in Bluetooth/on/off mode.

****This product supports up to 5V charging voltage and 1A charging current. We are not responsible for any problems caused by improper charging.**

2.4GHZ / CABLE/ BLUETOOTH MODE (MODE TOGGLE SWITCH)

2.4GHZ MODE

1. Connect the 2.4GHz receiver to your device's USB Port.

2. Switch the toggle switch to the 2.4GHz option. The keyboard will automatically connect to your device.

Press the key combination “Fn” + “4” to enter the forced pairing mode. During this period, it is recommended that the keyboard be within 20cm of the receiver.

BLUETOOTH MODE

1. Switch the toggle switch to the Bluetooth option.
2. Backlighting will be turned on.
3. Hold “fn+1” key for 4 seconds to activate Bluetooth pairing (the Bluetooth indicator fast flashes for 3 minutes to detect pairing).
4. Search for the Bluetooth device “Keychron K3 Max” on your device and connect it (the Bluetooth indicator goes off after successful pairing).

Note: This keyboard supports pairing up to 3 devices simultaneously via key combination “fn” + “1” | “fn” + “2” / “fn” + “3”. The Bluetooth indicator will continue to flash for 3 minutes.

Slow or failed connections may exist due to different Bluetooth versions, please make sure all the settings are correct.

SWITCH BLUETOOTH DEVICES

Short press key combination “fn” + “1” | “fn” + “2” / “fn” + “3” to switch to other device.

RECONNECT:

1. Switch the keyboard to the Bluetooth option to activate the keyboard.
 2. The Bluetooth indicator flashes for 3 seconds and automatically pairs with the last paired device.
 3. If the Bluetooth indicator is off, press any button to enter the connection again.
- * The keyboard must have been paired with the device to perform this function.

WIRED MODE



1. Switch the toggle switch to the Cable option (it only works when a USB cable is plugged in).
2. Connect our cable with your PC and keyboard.
3. Backlighting will be turned on.

Under Wired Mode, keyboard will not enter into Battery Saver Mode.

TURN OFF THE KEYBOARD

Switch the keyboard to the OFF option.

BACKLIGHT SETTING

- Short press  to switch between different types of lighting effects.
- When backlighting is on, press  button to switch among them.

OS TOGGLE SWITCH

1. MAC/iOS

Switch the toggle to Mac/iOS when the keyboard is connected to a Mac or iOS operating system.

2. WINDOWS/ANDROID

Switch the toggle to Windows/Android when the keyboard is connected to a Windows or Android operating system.

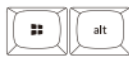

When using the Windows/Android mode,   keys are used for “Windows” and “Alt” functions.

3. INPUT METHOD SWITCH

For iOS:

Input method switch: Ctrl + Space

Caps Lock: Caps (Enable General>Keyboards> Hardware Keyboard>Caps Lock Language Switch)

For Android:

Input method switch: Shift+ Space

NOTE: Functions of certain multimedia key may be disabled due to compatibility, versions, brands and drivers of Windows/ Android OS. We also recommend not to switch OS frequently as it may impact keyboard operations.

TROUBLESHOOTING

If unable to pair keyboard to device, confirm that the device you’re trying to pair with is Bluetooth-capable. If so, restart the device and try pairing it with the keyboard again.

Note: On a Windows computer, a new Bluetooth connection will sometimes require additional software updates-a process that may still be ongoing after a message appears indicating a successful completion. Wait at least 20 minutes after pairing to make sure all updates are completed before restarting the computer.

Confirm that the device is configured to accept Bluetooth connections (Windows) and supports an external keyboard (HID profile).

Go to Bluetooth Devices > Open Settings and select the following:

Allow Bluetooth devices to find this computer

Allow Bluetooth devices to connect to this computer

Alert me when a Bluetooth device wants to connect

My keyboard isn’t working in Bluetooth mode.

For the computer/smartphone:

Go to your device Bluetooth settings>Select the keyboard and remove/delete/unpair it.

Then restart your device.

For the keyboard:

Turn the keyboard off and back on. Then reconnect it to your device.

Bluetooth connection is interrupted even within 10 meters.

Check if the keyboard is resting on a metal surface that can interfere with the Bluetooth signal.

Third-party input tools are not compatible with the keyboard.

Due to compatibility, versions, brands and drivers of Windows/Android OS, functions of third-party input tools may be affected while using the keyboard. Please make sure your operating system and drivers are up to date.

Certain multimedia keys or function keys do not work.

Functions of certain multimedia keys may be disabled due to compatibility, versions, brands, and drivers of devices.

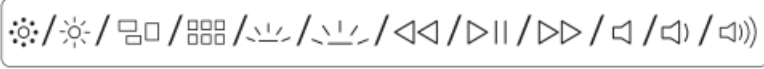
Multimedia keys:	
Function keys:	F1 / F2 / F3 / F4 / F5 / F6 / F7 / F8 / F9 / F10 / F11 / F12

Safety Precaution:

Keep the product, accessories and packaging parts out of the reach of children to prevent any accidents and choking hazards.

Always keep the product dry to avoid corrosion.

Do not expose the product to extreme temperatures below -10°C (5°F) or above 50°C (131 °F) to preserve the lifespan of the keyboard and battery.

Keychron, Inc.

Dover, DE 19901, United States

Find us at:

<https://www.keychron.com>

Support@keychron.com



@keychron



@@keychron



@keychronMK

Designed by Keychron

Made in China

Documents / Resources

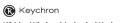
	<p>Keychron K3 Max Wireless Mechanical Keyboard [pdf] User Guide</p> <p>K3, K3 Max Wireless Mechanical Keyboard, Max Wireless Mechanical Keyboard, Wireless Mechanical Keyboard, Mechanical Keyboard, Keyboard</p>
---	--

References

- [User Manual](#)