

Keychron
K2 Wireless
Mechanical Keyboard



Keychron K2 Wireless Mechanical Keyboard User Manual

[Home](#) » [Keychron](#) » Keychron K2 Wireless Mechanical Keyboard User Manual 

Contents

- 1 [Keychron K2 Wireless Mechanical Keyboard](#)
- 2 [Product Usage Instructions](#)
- 3 [Barebone Version Contents](#)
- 4 [Quick Start Guide](#)
- 5 [The Keychron Launcher App](#)
- 6 [Specifications](#)
- 7 [K10 Max Wireless Mechanical Keyboard Overview](#)
- 8 [Key Descriptions](#)
- 9 [Troubleshooting](#)
- 10 [FAQS](#)
- 11 [Documents / Resources](#)
 - 11.1 [References](#)



Keychron K2 Wireless Mechanical Keyboard



Specifications

- Product: Wireless Mechanical Keyboard

- Wireless Connectivity: 2.4 GHz Receiver, Bluetooth
- Backlighting: Adjustable brightness and speed
- Compatibility: Supports Mac/iOS and Windows/Android systems

Product Usage Instructions

Connect 2.4 GHz Receiver

The 2.4 GHz mode offers a stable wireless connection:

1. Connect the 2.4 GHz receiver to the device USB port.
2. Switch toggle to 2.4 GHz mode.

Connect via Bluetooth

The Bluetooth mode allows pairing with multiple devices:

1. Switch toggle to Bluetooth.
2. Press Fn + 1 keys for 4 seconds to enter pairing mode.

Connect Cable

To use the keyboard in Cable mode:

1. Switch toggle to Cable mode.

Switch to the Right System

Select the appropriate system mode for Mac/iOS or Windows/Android:

The Backlight

Adjust the backlight settings:

- Press Fn + Q to change lighting effect.
- Press Fn + Tab to turn backlight on/off.

Adjust Backlight Brightness

Fine-tune the backlight brightness:

- Press Fn + W to make it brighter.
- Press Fn + S to dim the backlight.

Adjust Backlight Speed

Customize the backlight speed:

- Press Fn + T to increase speed.
- Press Fn + G to slow down the effect.

Keychron Launcher App

Utilize the Keychron Launcher App for customization and firmware management.

Layers

Your keyboard includes four layers of key settings for seamless transitions and customization.

Note: Apply changes or customizations to Layer 2 when using Windows mode.

Dear customer,

Thank you for purchasing our product. Please read the following instructions carefully before first use and keep this user manual for future reference. Pay particular attention to the safety instructions. If you have any questions or comments about the device, please visit our customer support page: www.alza.cz/EN/kontakt.

Fully Assembled Version Contents

Keyboard Components:

- 1x Fully Assembled Keyboard, which consists of:
 - 1x Case
 - 1x PCB
 - 1x Steel Plate
 - 1x Sound Absorbing Foam
 - 1x IXPE Foam
 - 1x PET Film
 - 1x EPDM Foam
 - 1x Bottom Case PET Film
 - 1x Silicone Bottom Pad
 - 8 Sets of Stabilizers
 - 1 Set of Keycaps (PBT Double-shot)
 - 1 Set of Switches

Cable:

- 1x Type-A to Type-C Cable

Receiver:

- 1x Type-A 2.4GHz Receiver
- 1x Extension Adapter for Receiver

Tools:

- 1x Keycap & Switch Puller
- 1x Screwdriver
- 1x Hex Key

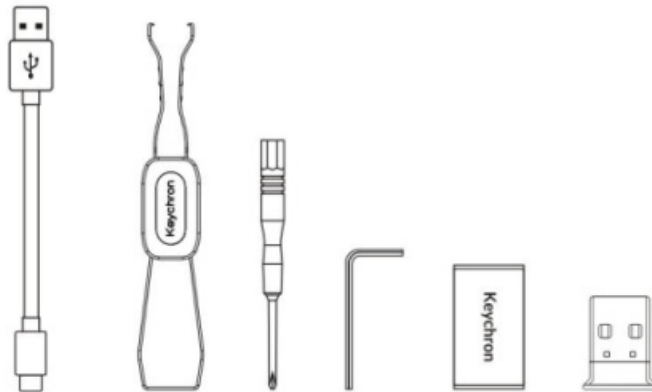

Barebone Version Contents

Keyboard Kit:

- 1x Keyboard Kit (Without Keycaps & Switches), which contains:
 - 1x Case
 - 1x PCB
 - 1x Steel Plate
 - 1x Sound Absorbing Foam
 - 1x IXPE Foam
 - 1x PET Film
 - 1x EPDM Foam
 - 1x Bottom Case PET Film
 - 1x Silicone Bottom Pad
 - 8 Sets of Stabilizers

Cable:

- 1x Type-A to Type-C Cable

Receiver:

- 1x Type-A 2.4GHz Receiver
- 1x Extension Adapter for Receiver

Tools:

- 1x Keycap & Switch Puller
- 1x Screwdriver
- 1x Hex Key

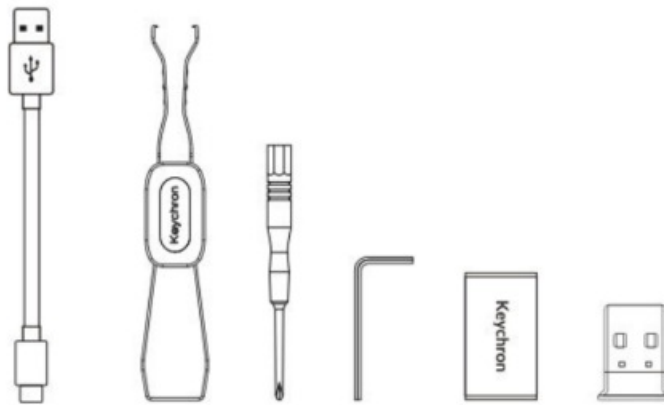
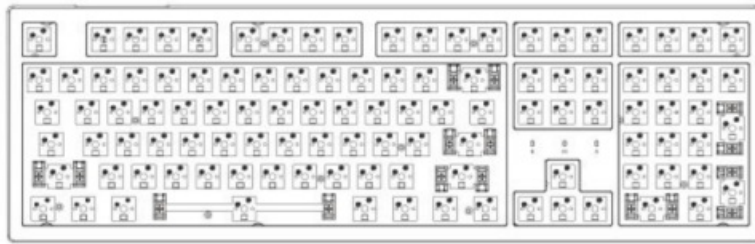

Quick Start Guide

If you are using a Windows system, locate and replace the keycaps.

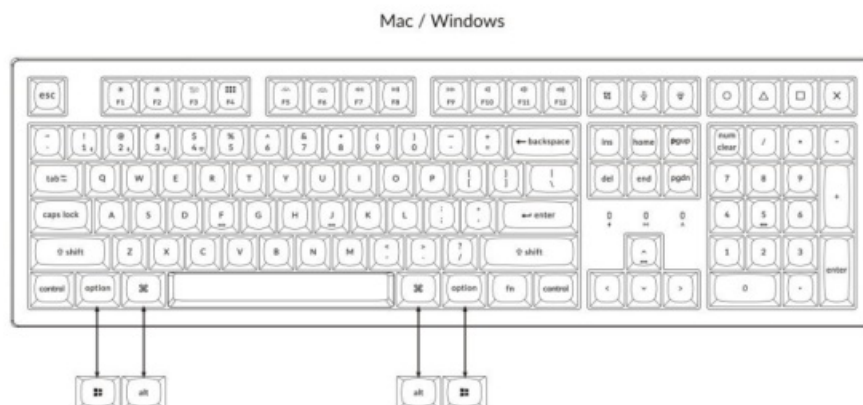

Connect 2.4 GHz Receiver

The 2.4 GHz mode offers a stable and reliable wireless connection. Follow these steps to set it up:

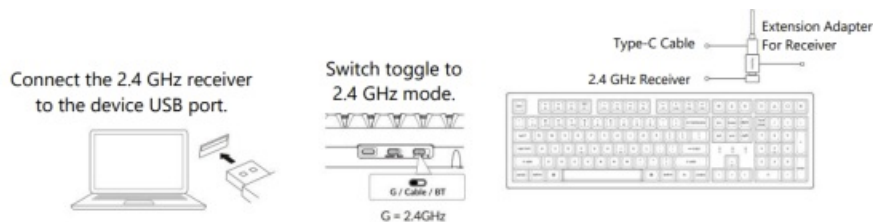

Note: For optimal wireless performance, we recommend utilizing the extension adapter for the 2.4GHz receiver. Position the receiver on your desk, close to your keyboard, to minimize latency and reduce the likelihood of signal interference. This setup ensures a stable and seamless typing experience.

Connect via Bluetooth

The Bluetooth mode provides versatility by allowing you to pair your keyboard with multiple devices such as smartphones, tablets, or laptops. Here's how to connect via Bluetooth:

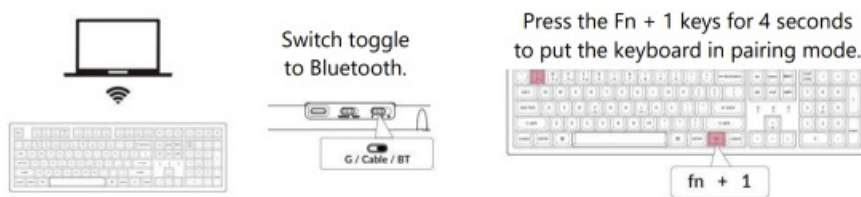

Connect Cable

For a wired connection, follow these steps to use the keyboard in Cable mode:



Switch to the Right System

The Keychron keyboard is designed to support both Mac/iOS and Windows/Android systems. To ensure optimal functionality, select the appropriate system mode:

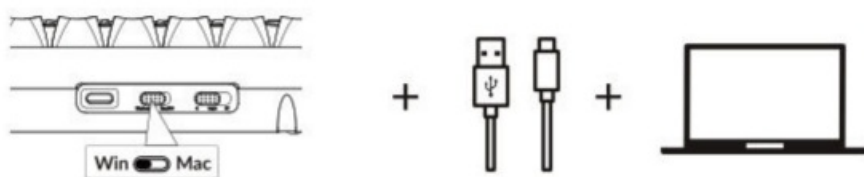

The Backlight

The backlight feature on your keyboard adds both aesthetic appeal and functional convenience, especially in low-light environments.

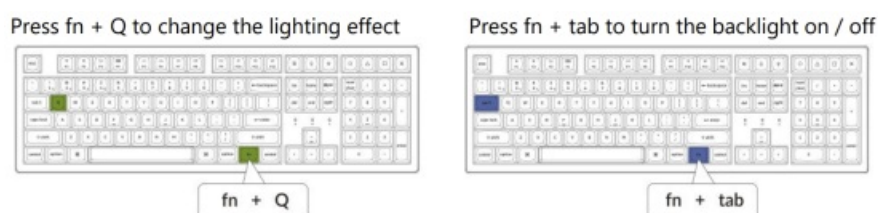

Adjust the Backlight Brightness

Brightness control allows you to fine-tune the intensity of the backlight, ensuring it's comfortable for your eyes and

suited to your environment

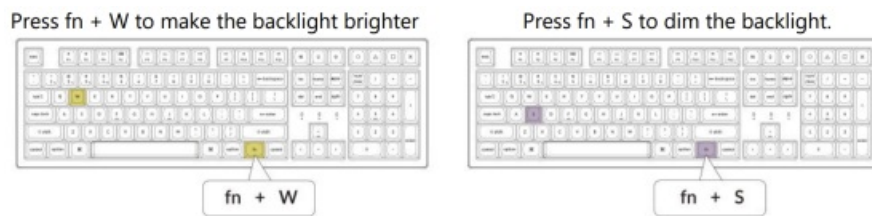

Adjust the Backlight Speed

The backlight effects on your keyboard can add a dynamic and customizable look. If the default animation speed feels too fast or too slow, you can adjust it with the following steps:

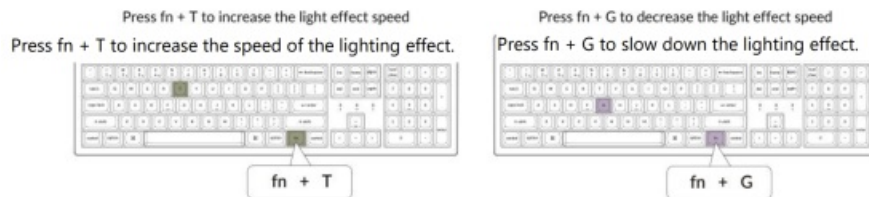

The Keychron Launcher App

The Keychron Launcher App offers advanced customization and firmware management for your keyboard. Here's how to utilize it:

- Access the Launcher:

Visit launcher.keychron.com using the latest version of a compatible web browser, such as Chrome, Edge, or Opera. This web-based app provides a user-friendly interface to enhance your keyboard's functionality.

- Customization Options:

- Remap Keys: Reassign keys to suit your workflow or preferences.
- Create Macros: Set up complex actions with a single keypress, improving productivity.
- Flash Firmware: Keep your keyboard updated with the latest features and fixes by installing firmware updates directly through the Launcher.

- Connection Requirements:

To use the Launcher, your keyboard must be connected to your computer via the Type-C cable in wired mode. Ensure your keyboard is powered on and recognized by the Launcher for seamless operation.

- Troubleshooting:

If the Launcher cannot detect your keyboard, reach out to Keychron support for guidance. They can provide step-by-step instructions to resolve the issue.

The Launcher app empowers you to unlock the full potential of your keyboard, ensuring it remains up-to-date and tailored to your specific needs.

The Layers

Your keyboard includes four layers of key settings, providing versatile options for both Mac and Windows operating systems. These layers allow seamless transitions and customization tailored to your workflow:

- **Mac Layers (Layer 0 and Layer 1):**

When the system toggle is switched to Mac, Layer 0 will be activated by default. This layer is optimized for

macOS, including specific key mappings and shortcuts designed to enhance your Mac experience. Layer 1 can be accessed by pressing certain function keys (e.g., Fn + MO(1)) for additional customizations.

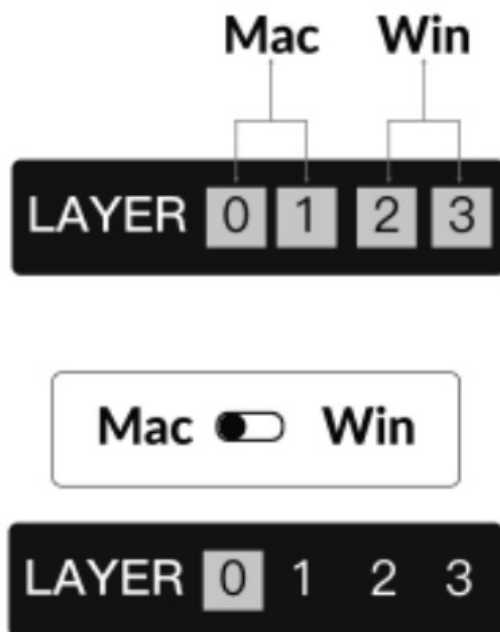

- **Windows Layers (Layer 2 and Layer 3):**

When the toggle is set to Windows, the system will activate Layer 2, which is pre-configured for Windows-based layouts and shortcuts. For extended functionality, you can switch to Layer 3 with a combination keypress (e.g., Fn + MO(3)). This makes it easy to switch between layers while ensuring compatibility with Windows devices.

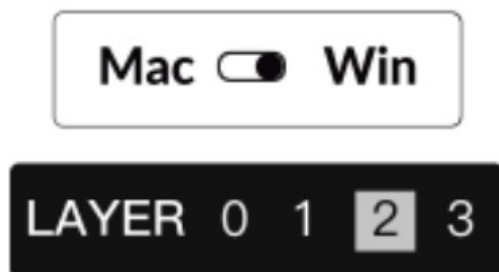

- **Important Note:**

When using Windows mode, ensure that changes or customizations are applied to Layer 2, not Layer 0. This is a common oversight that can cause key mapping issues. Familiarizing yourself with these layers ensures optimal functionality across operating systems.

Factory Reset & Firmware Update

If you experience persistent issues or need to update your keyboard, you can perform a factory reset or flash the firmware to resolve problems and enhance performance.

Factory Reset Your Keyboard:

- **Power On the Keyboard:** Ensure your keyboard is turned on and ready.
- **Initiate Reset:** Press and hold Fn + J + Z for 4 seconds.
- **Confirmation:** The keyboard backlight will flash red for 3 seconds, indicating the reset process has been successful. Your keyboard will now return to its default factory settings.

Firmware Update:

- Access the Launcher: Visit launcher.keychron.com using a modern browser (e.g., Chrome, Edge).
- Connection: Connect your keyboard to your computer via a Type-C cable in wired mode. Ensure the keyboard is powered on.
- Update Process:
 - Navigate to the Firmware Update tab within the Launcher.
 - Follow the on-screen instructions to download and install the latest firmware for your keyboard.
- Completion: Once the update process finishes, your keyboard will restart with the new firmware applied.

Troubleshooting Tips:

- If the Launcher does not recognize your keyboard, verify the wired connection or consult Keychron support for additional assistance.
- Always use the latest browser version and ensure your keyboard is in wired mode during firmware updates.

Performing a factory reset or firmware update ensures your keyboard operates smoothly and stays up to date with the latest features and fixes.

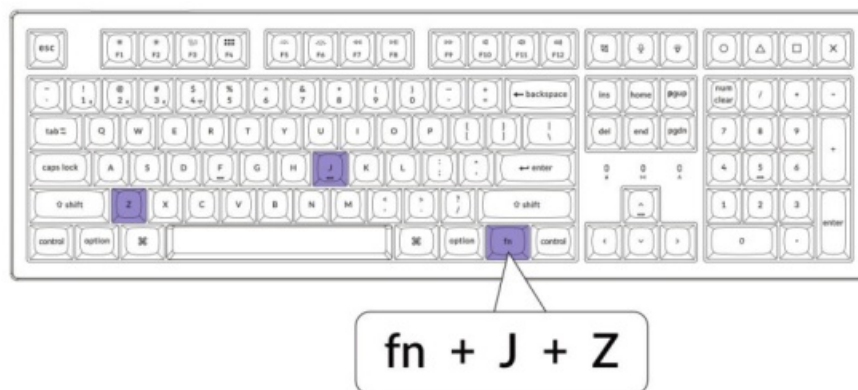

Specifications

- Specification Details
- **Number of Keys** 108
- **Switch Type** Mechanical
- **Battery Capacity** 4000 mAh
- **Charging Time** Around 5 hours
- **Charging Port** Type-C
- **Mode** Bluetooth / Wired / 2.4 GHz
- **Bluetooth Operating Distance** Within 10 meters (open space)
- **Bluetooth Device Name** Keychron K10 Max

LED Status Overview

LED Location	Function	Status
		– Low Power: Red Light Blinking
Power Indicator	Charging	– Charging: Static Red
		– Full Charged: Static Green
		– Reconnecting: Fast Blinking
Bluetooth / 2.4 GHz Indicator	Bluetooth / 2.4 GHz	– Paired: Light Off
		– Pairing: Slow Blinking
Caps Lock Indicator	Caps Lock	– Enabled: Static Red – Disabled: Light Off

K10 Max Wireless Mechanical Keyboard Overview

1. Power Indicator
2. Bluetooth / 2.4GHz Indicator
3. Caps Lock Indicator
4. Type-C Port
5. OS Toggle
6. Connection Mode Toggle

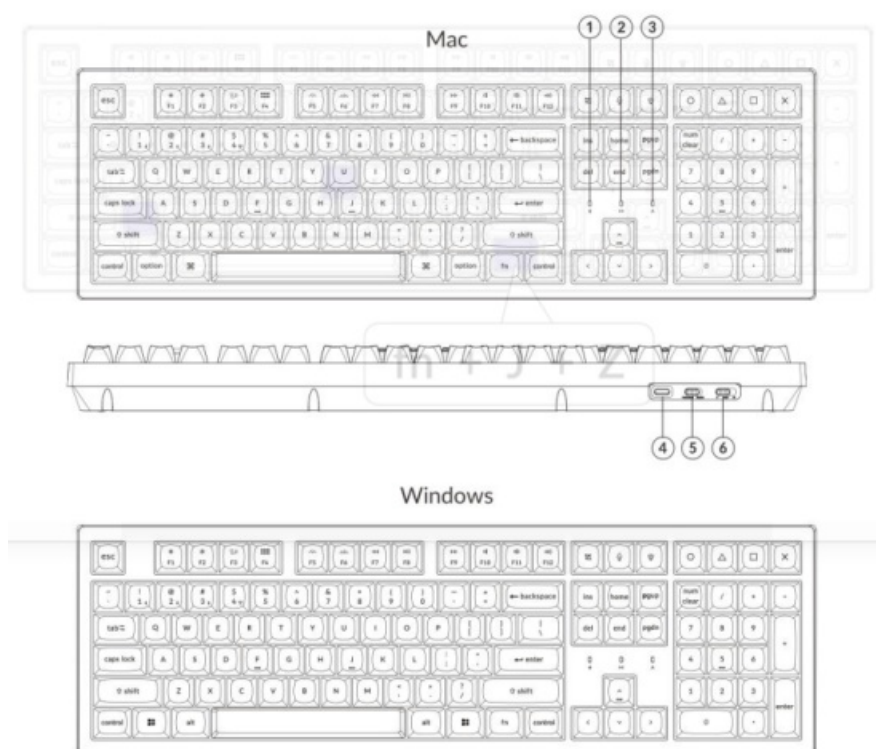

Default Key Layout

Layer 0

This is the default layer that becomes active automatically when the keyboard's system toggle is set to Mac mode.



Layer 1: Alternate Functional Layout

This layer is activated by switching your keyboard's system toggle to Mac mode and pressing the fn/MO(1) key.



Layer 2: Windows Mode Key Layout

This specific layer becomes active when the keyboard's system toggle is switched to the Windows operating mode.



Layer 3: Alternate Windows Mode with fn/MO(3)

This advanced layer is specifically triggered when the keyboard is set to Windows mode and the fn/MO(3) key is pressed.



Key Descriptions

Screen Brightness Control

- **Scr-:** Decreases the screen brightness, allowing you to dim the display to a comfortable level.

- Scr+: Increases the screen brightness, making it easier to view in brighter environments.

Backlight Adjustment

- Bright-: Reduces the keyboard backlight intensity for a more subtle appearance.
- Bright+: Boosts the keyboard backlight for enhanced visibility, especially in dim settings.

Media Controls

- Prvs: Skips to the previous track when playing audio or video.
- Play: Toggles play/pause for media playback, offering instant control over audio or video.
- Next: Advances to the next track in your playlist or media library.
- Mute: Instantly silences the system audio for uninterrupted focus.
- Vol-: Lowers the system volume gradually for quieter sound output.
- Vol+: Increases the system volume for louder and more dynamic audio.

RGB Lighting Modes

- RGB Toggle: Turns the keyboard backlight on or off with a single press.
- RGBMd+: Cycles forward through available RGB lighting modes to customize the appearance.
- RGBMd-: Cycles backward through RGB modes for finer adjustments.
- Hue+: Enhances the color hue of the RGB lighting, adding vibrancy to the display.
- Hue-: Decreases the RGB hue intensity for a softer tone.
- Sat+: Boosts the color saturation, making the RGB lighting more vivid.
- Sat-: Lowers saturation for a more muted color palette.
- RGB SPI: Increases the RGB effect speed, making transitions faster and more dynamic.
- RGB SPD: Decreases the RGB effect speed, allowing for smoother and more gradual lighting changes.

Layer Activation

- MO(1): Activates Layer 1 temporarily while the key is held, providing additional functionality.
- MO(3): Activates Layer 3 temporarily, offering a set of advanced features and shortcuts.

Bluetooth and 2.4GHz Host Switching

- BTH1: Switches to the first paired Bluetooth host for seamless device connectivity.
- BTH2: Connects to the second paired Bluetooth host, ensuring fast switching.
- BTH3: Selects the third paired Bluetooth host, offering flexibility for multiple devices.
- 2.4 G: Activates the 2.4GHz wireless mode for a stable and responsive connection.

Battery and N-Key Rollover

- Batt: Displays the keyboard's current battery status for timely charging reminders.
- NKRO: Enables N-Key Rollover mode, ensuring accurate key registration during fast typing or gaming.

System and Application Controls

- Task: Opens the Task View (Windows) or Mission Control (Mac) for managing open apps.
- File: Launches the File Explorer (Windows) or Finder (Mac) for quick access to files.
- MCTL: Activates Mission Control, showcasing all open windows and desktops (Mac).
- LPad: Launches the Launchpad on macOS for easy access to apps.

Function Description: Charging

To charge your Keychron K10 Max keyboard, connect one end of the USB cable to a power source such as a USB port on your computer or a USB power adapter, and the other end to the keyboard's charging port. While the keyboard is charging, the power indicator will display a red light, signifying that the charging process is active. It typically takes approximately 3 hours to fully charge the keyboard. Once fully charged, the red indicator light will turn off and a green power indicator will illuminate.

- The K10 Max keyboard is compatible with all USB ports. For optimal charging performance, it is recommended to use a 5V 1A adapter or a USB 3.0 port.
- The product supports charging with a voltage of 5V and a current of 1A. Please note that improper charging practices may result in damage to the device, and the manufacturer will not be held liable for such issues.

2.4GHz / Cable / Bluetooth Mode (Mode Toggle Switch)

The Keychron K10 Max keyboard offers multiple connectivity options, including 2.4GHz, Bluetooth, and a cable mode, giving users the flexibility to choose the method that best suits their needs. To switch between modes, toggle the designated switch on the keyboard to the desired option.

2.4GHz Mode

- Plug the 2.4GHz receiver into an available USB port on your device.
- Slide the mode toggle switch to the 2.4GHz position. The keyboard will automatically detect and connect to the receiver.
- If the keyboard does not connect automatically, press the key combination "fn" + "4" to enter the forced pairing mode. During this process, keep the keyboard within a 20cm range of the receiver for optimal pairing success.

It is recommended to maintain close proximity between the keyboard and the receiver while pairing to ensure a stable connection.

Bluetooth Mode

- Switch the mode toggle switch to the Bluetooth position.
- When Bluetooth mode is activated, the keyboard's backlighting will automatically turn on, indicating that the mode is active.
- To pair the keyboard with your device, press and hold "fn" + "1" for approximately 4 seconds. The Bluetooth indicator will begin flashing rapidly, signaling that the keyboard is in pairing mode. This flashing will continue for 3 minutes to allow the keyboard to detect nearby devices.
- On your device, search for the Bluetooth device labeled "Keychron K10 Max" in your Bluetooth settings. Select it to establish the connection. Once the pairing process is complete, the Bluetooth indicator will turn off.
- This keyboard supports pairing with up to three Bluetooth devices simultaneously. To switch between paired devices, use the key combinations "fn" + "1", "fn" + "2", and "fn" + "3" respectively.

- The Bluetooth indicator will flash continuously during the pairing window, which lasts for 3 minutes. After this time, the keyboard will exit pairing mode if no device is connected.
- **Note:** Connection issues may arise due to differences in Bluetooth versions or device settings. Ensure all relevant settings on your device are correctly configured to enable seamless pairing.

Switching Between Bluetooth Devices

To easily switch between Bluetooth devices, you can use the keyboard's multi-device pairing feature. After pairing your Keychron K10 Max with multiple devices (up to three), you can seamlessly toggle between them:

- Use the key combinations "fn" + "1", "fn" + "2", or "fn" + "3" to switch to a specific paired device.
- Press the respective combination briefly, and the keyboard will automatically reconnect to the selected device if it is within range and Bluetooth is active.

This feature allows you to manage multiple devices efficiently, such as a computer, tablet, and smartphone, without the need for repeated pairing.

Reconnecting To A Previously Paired Device

If you need to reconnect to a device the keyboard was previously paired with:

- Ensure that the keyboard is set to Bluetooth mode by toggling the switch.
- The keyboard's Bluetooth indicator will flash for 3 seconds after being activated. During this time, it will automatically search for and connect to the most recently paired device.
- If the Bluetooth indicator stops flashing and no connection is established, press any key to force the keyboard to reattempt the connection.

Please note: For this reconnection process to work, the keyboard must have been successfully paired with the device beforehand. Ensure that the device's Bluetooth is turned on and ready to connect.

Using The Keyboard In Wired Mode

For those who prefer a wired connection or need to conserve battery, the Keychron K10 Max can easily function in wired mode. To enable this mode:

- Slide the toggle switch to the Cable option to activate wired mode.
- Connect the supplied cable securely to both your keyboard and your PC or compatible device.
- Upon establishing the connection, the keyboard's backlighting will turn on to indicate that it is now operating in wired mode.
- In wired mode, the keyboard bypasses its internal battery and does not enter Battery Saver Mode, ensuring uninterrupted operation for extended periods.

This mode is particularly useful for gaming or intensive typing sessions where a stable and lag-free connection is crucial.

Turning Off The Keyboard

If you wish to power down the Keychron K10 Max:

- Switch the mode toggle to the Cable option.
- Disconnect the power cable from the keyboard.

By doing this, the keyboard will turn off completely and stop consuming power. This simple method ensures the keyboard is off when not in use, especially for those who prefer to conserve battery or are transitioning to wired-only usage.

Backlight Settings

The Keychron K10 Max keyboard includes customizable backlight options to enhance your typing experience, especially in low-light environments. You can cycle through various lighting effects and patterns with ease:

- To change the backlighting effect, short press the lightbulb key () located on the keyboard. Each press will switch to a different effect or pattern.
- These effects include static lighting, breathing effects, and dynamic animations that add a stylish touch to your workspace.

Experiment with the different lighting modes to find the one that best suits your preferences. This feature not only enhances the keyboard's aesthetics but also improves visibility during use.

Os Toggle Switch

The Keychron K10 Max keyboard is designed to work seamlessly with multiple operating systems. You can toggle between Mac/iOS mode and Windows/Android mode, ensuring that the keyboard functions optimally with your chosen device.

1. MAC/ios MODE

- Slide the toggle switch to the Mac/iOS position when using the keyboard with a Mac computer or an iOS device such as an iPad or iPhone.
- In this mode, the keyboard layout and key functions are optimized for Mac and iOS operating systems, providing full compatibility and access to all essential shortcuts.

2. Windows/Android Mode

- Move the toggle switch to the Windows/Android position when connecting the keyboard to a Windows PC or Android device.
- In this mode, the Command (⌘) key and Option key on the keyboard will function as the Windows and Alt keys, respectively, to align with standard Windows keyboard layouts.

Tip: Switching to the correct mode ensures a smoother experience with operating system-specific functions and shortcuts. Always verify the toggle switch position before use.

Input Method Switch

The Keychron K10 Max also supports input method switching, making it easy to toggle between different language layouts and input options depending on the operating system.

For iOS Devices:

- To switch the input method, press Ctrl + Space on the keyboard. This allows you to cycle through the available keyboard input methods configured on your iOS device.
- To enable the Caps Lock Language Switch feature, navigate to Settings > General > Keyboards > Hardware Keyboard on your iOS device. Once activated, the Caps Lock key can also be used for language switching.

For Android Devices:

- To change the input method on Android, press Shift + Space. This will cycle through the available input methods configured on your device.

Note: Ensure that your device's input settings are configured correctly to make full use of these switching functions.

Important Notes:

- Certain multimedia keys may not function correctly due to compatibility issues, variations in operating system versions, or specific device drivers. Always update your device's OS and keyboard firmware to minimize these issues.
- Avoid frequent OS mode switching, as it can disrupt the keyboard's operation or require additional configuration steps. It is best to set the appropriate mode based on your primary device and stick with it for uninterrupted performance.

Troubleshooting

If you encounter issues pairing the Keychron K10 Max keyboard with a device, follow these steps to resolve the problem:

- **Verify Bluetooth Compatibility:**
 - Ensure that the device you are attempting to pair with supports Bluetooth functionality. If it does, restart the device to refresh its Bluetooth connection and try pairing it with the keyboard again.
- **Windows-Specific Note:**
 - On Windows computers, establishing a new Bluetooth connection may sometimes trigger additional system updates or driver installations. Even if the pairing appears successful, these updates might still be in progress in the background.
 - To avoid disruptions, wait at least 20 minutes after pairing to ensure that all related updates and processes are fully completed before restarting your computer.
- **Device Configuration:**
 - Confirm that the device is configured to accept Bluetooth connections, especially external keyboards that rely on the HID (Human Interface Device) profile. Some devices may have this functionality disabled by default.
- **Bluetooth Settings on Windows:**
 - Navigate to Bluetooth Devices in your device settings, then open the advanced settings menu. Ensure that the following options are enabled:
- Allow Bluetooth devices to find this computer.
- Allow Bluetooth devices to connect to this computer.
- Alert me when a Bluetooth device wants to connect.

What To Do If The Keyboard Doesn't Work In Bluetooth Mode

If your Keychron K10 Max is not functioning correctly in Bluetooth mode, try these troubleshooting steps:

For the Computer or Smartphone:

- Open your device's Bluetooth settings and locate the list of paired devices.
- Find the entry for the Keychron K10 Max keyboard.
- Remove or delete the keyboard from the list (this process is often referred to as "unpairing").
- Restart your device to reset the Bluetooth system.
- After restarting, attempt to pair the keyboard again.

For the Keyboard:

- Turn the keyboard off using the toggle switch, and then turn it back on.
- Re-enter Bluetooth pairing mode by pressing fn + 1 (or the respective pairing key) and hold it for 4 seconds until the indicator light flashes rapidly.
- Attempt to reconnect the keyboard to your device.

My Keyboard Isn't Working in 2.4GHz Mode

If you encounter issues with the keyboard in 2.4GHz mode, follow these steps for troubleshooting:

- Check the Toggle Switch:
 - Ensure that the mode toggle is set to 2.4GHz. This is essential for the keyboard to operate in this mode.
- Reconnect the Receiver:
 - Remove the 2.4GHz receiver from your device and press the key combination "fn" + "4" on the keyboard for 4 seconds. This will activate the forced pairing mode.
 - Reinsert the receiver into the device, ensuring the keyboard is placed within 20 cm of the receiver during this process to ensure a stable connection.

Bluetooth Connection Is Interrupted Even Within 10 Meters

If the Bluetooth connection frequently disconnects, even when you are within the standard range of 10 meters:

- Check for Signal Interference:
 - Ensure that the keyboard is not resting on a metal surface or in an environment with heavy electronic interference, as this can disrupt the Bluetooth signal.
- Optimize the Environment:
 - Avoid placing the keyboard near other wireless devices that may use the same frequency band, such as Wi-Fi routers or other Bluetooth devices, as this may create interference.

Third-Party Input Tools Are Not Compatible

Certain third-party input tools may not function properly with the Keychron K10 Max keyboard. This is often due to compatibility issues arising from:

- Differences in software versions, device brands, or operating system drivers.
- Limitations in input tools designed specifically for Windows/Android or other platforms.

To resolve this, ensure that:

- Your operating system and drivers are up to date.
- You use the keyboard's default configuration for best compatibility.

Certain Multimedia Keys or Function Keys Do Not Work

If specific multimedia keys or function keys fail to operate, it is likely due to compatibility issues with the connected device or the software version. This issue is more common with older operating systems or devices using outdated drivers.

- Affected Multimedia Keys:
 - Keys such as play/pause, volume up/down, next/previous track may not function as intended on all devices.
- Function Keys:
 - Standard function keys such as F1 through F12 may have limited functionality depending on the system configuration.

Safety Precaution

To ensure the longevity and safety of the keyboard and its accessories, follow these guidelines:

- Keep Out of Reach of Children:
 - Small parts, including accessories and packaging materials, may pose a choking hazard. Store them safely away from children.
- Prevent Corrosion:
 - Keep the keyboard and its components dry at all times. Exposure to moisture may cause corrosion or other damage.
- Temperature Tolerance:
 - Do not expose the keyboard to extreme temperatures. Specifically:
- Avoid temperatures below -10°C (14°F).
- Avoid temperatures above 50°C (122°F).
 - Extreme conditions can degrade the keyboard's battery and internal components.

Warranty Conditions

A new product purchased in the Alza.cz sales network is guaranteed for 2 years. If you need repair or other services during the warranty period, contact the product seller directly, you must provide the original proof of purchase with the date of purchase.

The following are considered to be a conflict with the warranty conditions, for which the claimed claim may not be recognized:

- Using the product for any purpose other than that for which the product is intended or failing to follow the instructions for maintenance, operation, and service of the product.
- Damage to the product by a natural disaster, the intervention of an unauthorized person or mechanically through the fault of the buyer (e.g., during transport, cleaning by inappropriate means, etc.).
- Natural wear and aging of consumables or components during use (such as batteries, etc.).
- Exposure to adverse external influences, such as sunlight and other radiation or electromagnetic fields, fluid intrusion, object intrusion, mains overvoltage, electrostatic discharge voltage (including lightning), faulty supply or input voltage and inappropriate polarity of this voltage, chemical processes such as used power supplies, etc.
- If anyone has made modifications, modifications, alterations to the design or adaptation to change or extend the functions of the product compared to the purchased design or use of non-original components.

EU Declaration of Conformity

This equipment is in compliance with the essential requirements and other relevant provisions of Directive 2014/53/EU and Directive 2011/65/EU amended (EU) 2015/863.



WEEE

This product must not be disposed of as normal household waste in accordance with the EU Directive on Waste Electrical and Electronic Equipment (WEEE – 2012/19/EU). Instead, it shall be returned to the place of purchase or handed over to a public collection point for the recyclable waste. By ensuring this product is disposed of correctly, you will help prevent potential negative consequences for the environment and human health, which could otherwise be caused by inappropriate waste handling of this product. Contact your local authority or the nearest collection point for further details. Improper disposal of this type of waste may result in fines in accordance with national regulations.



FAQS

Q: Can I use the keyboard with multiple devices simultaneously?

A: Yes, you can pair the keyboard with multiple devices via Bluetooth and switch between them easily.



Q: How do I update the firmware of the keyboard?

A: You can update the firmware using the Keychron Launcher App by following the instructions provided within the app.

Documents / Resources

	<p>Keychron K2 Wireless Mechanical Keyboard [pdf] User Manual 147180, Benutzerhandbuch, K2 Wireless Mechanical Keyboard, Wireless Mechanical Keyboard , Mechanical Keyboard, Keyboard</p>
---	---

References

-  [Alza.cz – rychlý a pohodlný nákup odkudkoliv | Alza.cz](#)
-  [Launcher](#)
-  [Alza.cz](#)
- [User Manual](#)

[Manuals+](#), [Privacy Policy](#)

This website is an independent publication and is neither affiliated with nor endorsed by any of the trademark owners. The "Bluetooth®" word mark and logos are registered trademarks owned by Bluetooth SIG, Inc. The "Wi-Fi®" word mark and logos are registered trademarks owned by the Wi-Fi Alliance. Any use of these marks on this website does not imply any affiliation with or endorsement.