

Keychron K1 Max QMK and VIA Wireless Custom Mechanical Keyboard



Keychron K1 Max QMK and VIA Wireless Custom Mechanical Keyboard User Guide

[Home](#) » [Keychron](#) » Keychron K1 Max QMK and VIA Wireless Custom Mechanical Keyboard User Guide 

Contents

- [1 Keychron K1 Max QMK and VIA Wireless Custom Mechanical Keyboard](#)
- [2 Product Information](#)
- [3 Product Usage Instructions](#)
- [4 OVERVIEW](#)
- [5 Connect 2.4GHz Receiver](#)
- [6 Connect Cable](#)
- [7 Adjust The Backlight Brightness](#)
- [8 Warranty](#)
- [9 Factory Reset](#)
- [10 Documents / Resources](#)
 - [10.1 References](#)



Keychron K1 Max QMK and VIA Wireless Custom Mechanical Keyboard



Product Information

The Keychron K1 Max is a highly customizable keyboard that offers both wired and wireless connectivity options. It features 2.4GHz wireless connectivity, Bluetooth compatibility, and a USB Type-C cable for wired connections. The keyboard has four layers of key settings, with layer 0 and layer 1 designed for Mac systems, and layer 2 and layer 3 for Windows systems. The K1 Max also includes customizable backlighting options for enhanced visual aesthetics.

Specifications

- **Connectivity:** 2.4GHz wireless, Bluetooth, USB Type-C cable
- **Compatibility:** Windows and Mac systems
- **Layers:** Four layers of key settings
- **Backlight:** Customizable lighting effects

Product Usage Instructions

Connect 2.4GHz Receiver

- To use the wireless functionality of the keyboard, connect the provided 2.4GHz receiver to your device's USB port.

Switch to 2.4GHz Mode

- Toggle the switch on the keyboard to the "G" position to activate the 2.4GHz wireless mode.

Connect via Bluetooth

- If you prefer to use Bluetooth for connectivity, toggle the switch to either the "Cable" or "BT" position. For Bluetooth pairing:

1. Press "fn + 1" and hold for 4 seconds.
2. Pair your device with the keyboard named "Keychron K1 Max".

- **Note:** For optimal wireless performance, it is recommended to use the extension adapter for the 2.4GHz

receiver and place it near your keyboard on the desk to minimize latency and signal interference.

Switch to Cable Mode

- If you prefer a wired connection, toggle the switch to the “Cable” position.

The Layers

- The keyboard has four layers of key settings. The default active layer depends on the system toggle.
- If the toggle is switched to “Mac”, layer 0 will be activated.
- If the toggle is switched to “Windows”, layer 2 will be activated.

When using the keyboard in Windows mode, make changes to layer 2 instead of the top layer (layer 0) to avoid common mistakes.

The Backlight

The keyboard offers customizable backlighting options:

- To change the lighting effect, press “fn + Q”.
- To toggle the backlight on/off, press “fn + tab”.

The VIA Key Remapping Software

- Visit us via. app to access the online VIA software for key remapping. If VIA does not recognize your keyboard, please contact our support for further instructions.
- VIA software is compatible with the latest versions of Chrome, Edge, and Opera browsers. Note that VIA only works when the keyboard is connected via cable.

Adjust the Backlight Brightness

To increase the backlight brightness, press “fn + W”. To decrease the brightness, press “fn + S”.

Warranty

The Keychron K1 Max comes with a warranty. If any keyboard component becomes defective during the warranty period, we will replace the defective parts rather than the entire keyboard.

Factory Reset

If you encounter any issues or need to reset the keyboard to its factory settings, follow these steps:

1. Download the appropriate firmware and QMK Toolbox from our website.
2. Switch the keyboard to Cable mode and unplug the power cable.
3. Remove the space bar keycap to access the reset button on the PCB.
4. Hold the reset key and plug the power cable into the keyboard.

5. Release the reset key after 2 seconds to enter DFU mode.
6. Use the QMK Toolbox to flash the firmware.
7. To factory reset the keyboard, press “fn + J + Z” and hold for 4 seconds.

FAQ

Q: Can I use the Keychron K1 Max with both Windows and Mac systems?

- **A:** Yes, the Keychron K1 Max is compatible with both Windows and Mac systems. Simply toggle the system switch to the desired mode.

Q: How can I customize the keyboard’s backlighting?

- **A:** Press “fn + Q” to change the lighting effect and “fn + tab” to toggle the backlight on or off. You can also adjust the brightness using “fn + W” to increase and “fn + S” to decrease.

Q: How do I perform a factory reset on the keyboard?

- **A:** To perform a factory reset, switch the keyboard to Cable mode, unplug the power cable, hold the reset key, plug the power cable back in, release the reset key after 2 seconds, and then press “fn + J + Z” for 4 seconds.
- If you are a Windows user, please find the appropriate keycaps in the box, then follow the instructions below to find and replace the following keycaps.

OVERVIEW

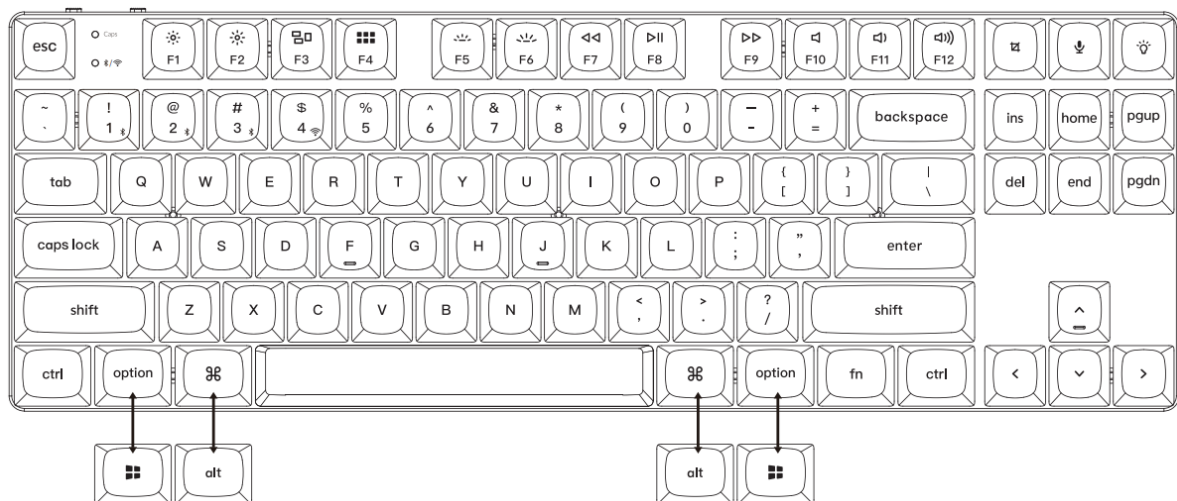

Connect 2.4GHz Receiver

Connect the 2.4GHz receiver to the device’s USB port.

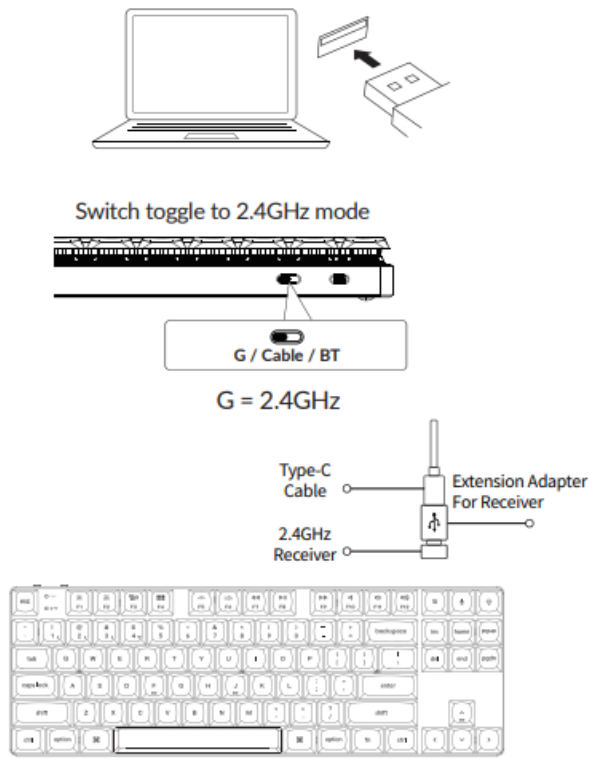

Note: For the best wireless experience, we recommend using the extension adapter for the receiver and putting the 2.4GHz receiver somewhere on your desk close to your keyboard for a low rate of latency and fewer signal interferences.

Connect Bluetooth



Switch the toggle to Bluetooth

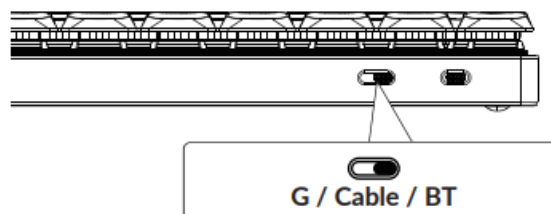

Press fn + 1 (for 4 seconds) and pair with a device named Keychron K1 Max.

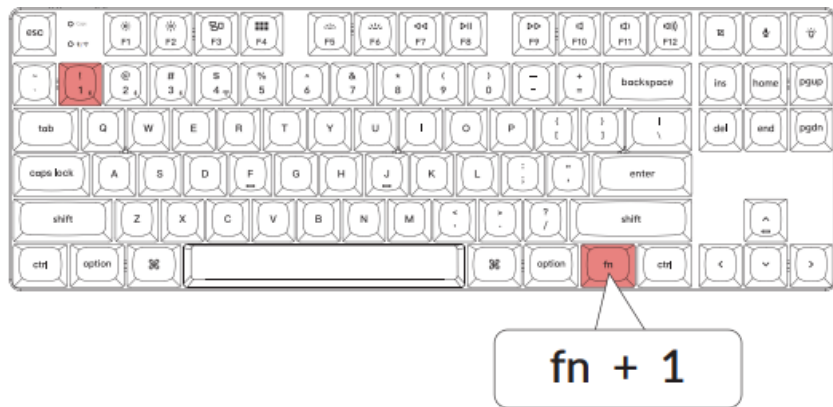

Connect Cable

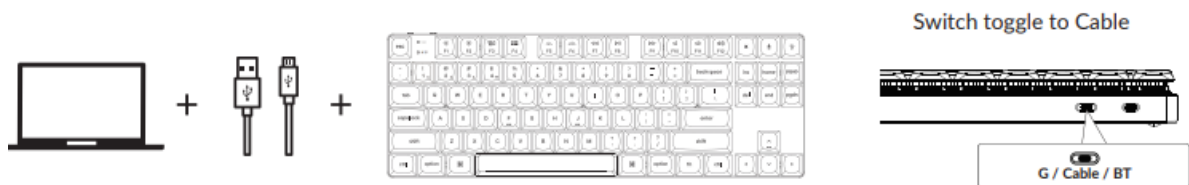

Switch To The Right System

Please make sure the system toggle on the top left corner has been switched to the same system as your computer's operating system.



The Layers

- There are four layers of key settings on the keyboard. Layer 0 and layer 1 are for the Mac system. Layer 2 and layer 3 are for the Windows system.
- If your system toggle is switched to Mac, then layer 0 will be activated.
- If your system toggle is switched to Windows, then layer 2 will be activated.
- Remember that if you are using it in Windows mode, please make changes to layer 2 instead of the top layer (layer 0).
- This is a common mistake people are making.



The VIA Key Remapping Software

- Please visit the usevia.com app to use the online VIA software to remap the keys.
- If the VIA cannot recognize your keyboard, please reach our support to get the instruction.



- The online VIA software can only run on the latest version of Chrome, Edge, and Opera browsers.
- VIA only works when the keyboard is connected by wire to the computer.

The Backlight

Press fn + Q to change the lighting effect



Press fn + tab to turn the backlight on/off



Adjust The Backlight Brightness

Press fn + W to increase the backlight brightness



Press fn + S to decrease the backlight brightness



Warranty

- The keyboard is highly customizable and easy to rebuild.
- If anything goes wrong with any of the keyboard components of the keyboard during the warranty period, we will only replace the defective parts of the keyboard, not the whole keyboard.

Factory Reset

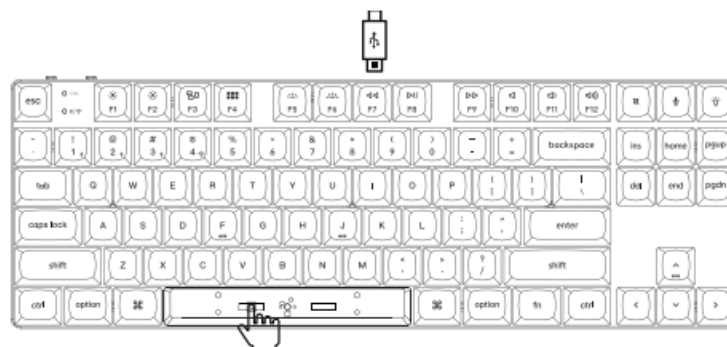

Troubleshooting? Don't know what's going on with the keyboard?

1. Download the right firmware and QMK Toolbox from our website.
 2. Unplug the power cable and switch the keyboard to Cable mode.
 3. Remove the space bar keycap to find the reset button on the PCB.
 4. Hold the reset key first, then plug the power cable into the keyboard.
 - Release the reset key after 2 seconds, and the keyboard will now enter DFU mode.
 5. Flash the firmware with the QMK Toolbox.
 6. Factory reset the keyboard by pressing fn + J + Z (for 4 seconds).
 - Step by step guide can be found on our website
-
- Not Happy support@keychron.com
-

Documents / Resources

	Keychron K1 Max QMK and VIA Wireless Custom Mechanical Keyboard [pdf] User Guide K1 Max, K1 Max QMK and VIA Wireless Custom Mechanical Keyboard, QMK and VIA Wireless Custom Mechanical Keyboard, VIA Wireless Custom Mechanical Keyboard, Wireless Custom Mechanical Keyboard, Custom Mechanical Keyboard, Mechanical Keyboard, Keyboard
--	---

References

- [User Manual](#)

[Manuals+](#), [Privacy Policy](#)

This website is an independent publication and is neither affiliated with nor endorsed by any of the trademark owners. The "Bluetooth®" word mark and logos are registered trademarks owned by Bluetooth SIG, Inc. The "Wi-Fi®" word mark and logos are registered trademarks owned by the Wi-Fi Alliance. Any use of these marks on this website does not imply any affiliation with or endorsement.