



**KKIMBF-26SSB
Front Load Counter
Top Ice Maker**



Kenmore KKIMBF-26SSB Front Load Counter Top Ice Maker Instruction Manual

[Home](#) » [Kenmore](#) » Kenmore KKIMBF-26SSB Front Load Counter Top Ice Maker Instruction Manual 

Contents

- [1 Kenmore KKIMBF-26SSB Front Load Counter Top Ice Maker](#)
- [2 Product Usage Instructions](#)
- [3 IMPORTANT SAFEGUARDS](#)
- [4 PARTS AND FEATURES](#)
- [5 SPECIFICATIONS](#)
- [6 OPERATING YOUR ICE MAKER](#)
- [7 CARE AND CLEANING](#)
- [8 WARRANTY](#)
- [9 CONTACT](#)
- [10 TROUBLESHOOTING FAQ](#)
- [11 Documents / Resources](#)
 - [11.1 References](#)



Kenmore KKIMBF-26SSB Front Load Counter Top Ice Maker



Product Usage Instructions

- Open the package and take out all the accessories.
- Place the ice maker vertically on an even surface.
- Use a clean towel to wipe the water tank, ice basket, and ice scoop.
- Keep the ice maker upright for 6 hours before the first use.
- Place the ice maker upright for more than 6 hours before the first use.
- Ensure the drain plug is in place.
- Pull out the ice basket and ensure it securely rests on the edge of its slot.
- Slowly pour 950 ml of drinkable water into the ice basket. (Note: do not exceed the MAX water level.)
- Push the ice basket securely back into place.

IMPORTANT SAFEGUARDS

This product is designed to make bullet-shaped ice suitable for cooling, preserving, and refreshing food and drinks. It's great for use in kitchens, living rooms, and more.

To get the best performance from your new bullet ice maker, please carefully read and follow all the instructions in this manual before use and keep this manual for future reference.

- It is recommended to use chilled water for faster ice production.
- Before using, ensure the power outlet's voltage corresponds to the value shown on the appliance nameplate.
The wrong voltage will damage the product.
- The product should always be grounded correctly. Only use a grounded power strip with a power rating greater than 1000 W.
- Leave at least 4 inches (10.2 cm) of clearance on all sides of the ice maker for proper ventilation.

- Do not attempt to disassemble, repair, modify, or replace any part of this product.
- Before using the ice maker for the first time or after moving it, please place the ice maker on a level surface and wait for 6 hours.
- Before operation, we recommend cleaning the ice maker as outlined in the “Cleaning” section of this manual. Do not turn the ice maker upside down, this may cause the compressor and/or refrigeration system to malfunction.
- Only use this product with potable/drinkable water; failure to do so is hazardous to users’ health.
- Do not use hot water with this product.
- Always use water that is colder than 86°F (30°C).
- Do not immerse any part of the product in water or touch the plug with wet hands.
- To avoid frostbite, do not touch the ice-making parts while in use.· This product should not be used outside, in hot or poorly ventilated rooms, or in flammable and corrosive environments.
- Always use this product on a dry, even, and stable surface.
- The incline angle of the ice maker cabinet should not exceed 45 during transportation or use.
- Do not allow children or persons who lack experience and knowledge to use the product.
- When not in use, please drain the water tank and dry the product with a clean towel. Then, store it in a dry and well-ventilated place.
- Only use the mechanical devices and alternative methods provided by the manufacturer to accelerate the defrosting process.
- This product can only be used in homes and other similar settings.
- Before placing the ice maker down, ensure the power cord is not damaged or stuck inside the machine.
- Do not place multiple portable socket-outlets or power supplies at the rear of the product.

RECYCLING

This product contains a refrigerant, which under Federal Law must be removed prior to product disposal. Legally dispose of the product according to the local regulations.

WARNING: Risk of fire/flammable materials.

HOUSEHOLD USE ONLY; SAVE THESE INSTRUCTIONS!

PARTS AND FEATURES

1. Control Panel
2. Ice Basket
3. Heat Dissipation Vent
4. Power Cord
5. Drain Hole
6. Drain Plug
7. Ice Scoop

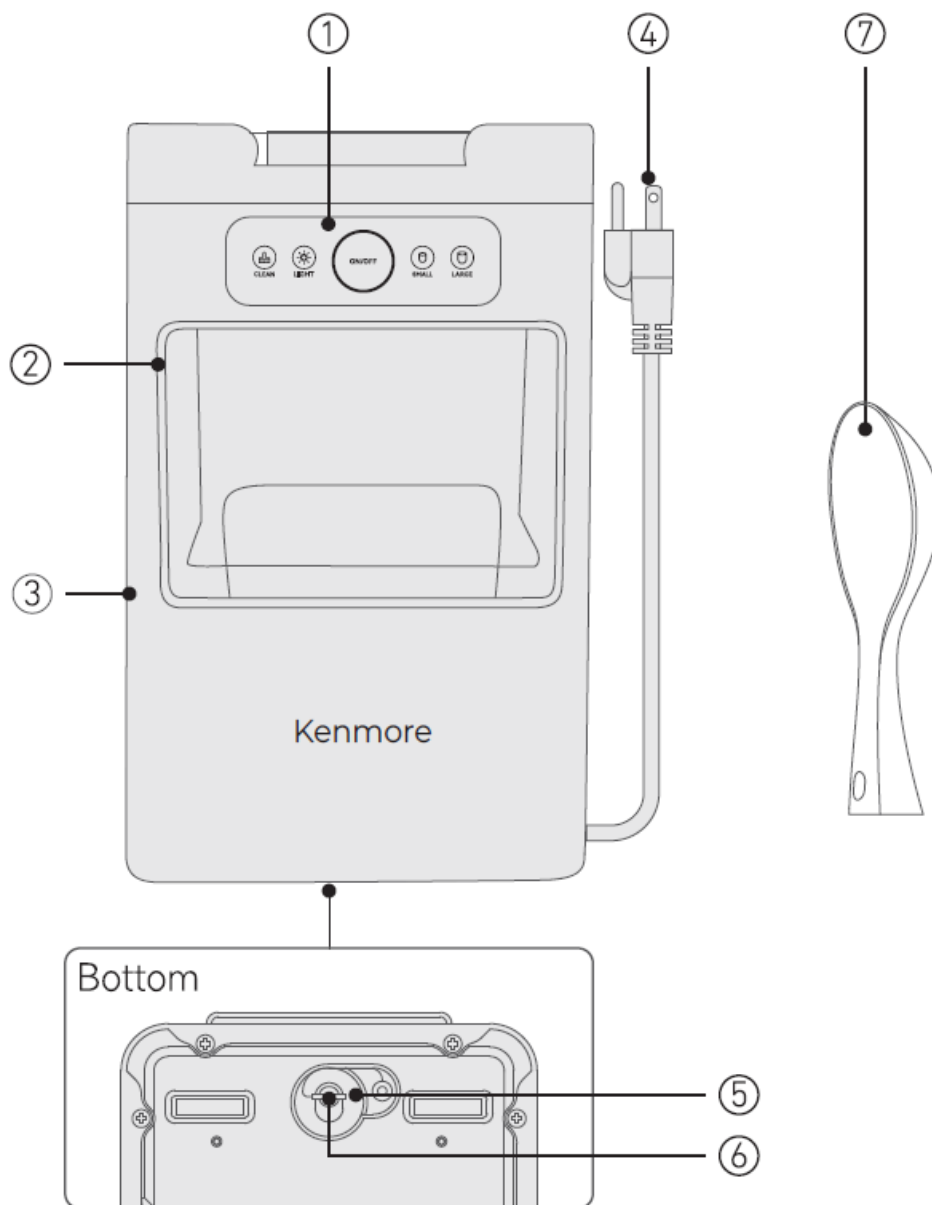

1. LED Light
2. Ice-Producing Port
3. Ice-Making Part
4. Ice-Making Box
5. Infrared Sensor
6. Maximum Water Level
7. Water Tank
8. Filter
9. Fan

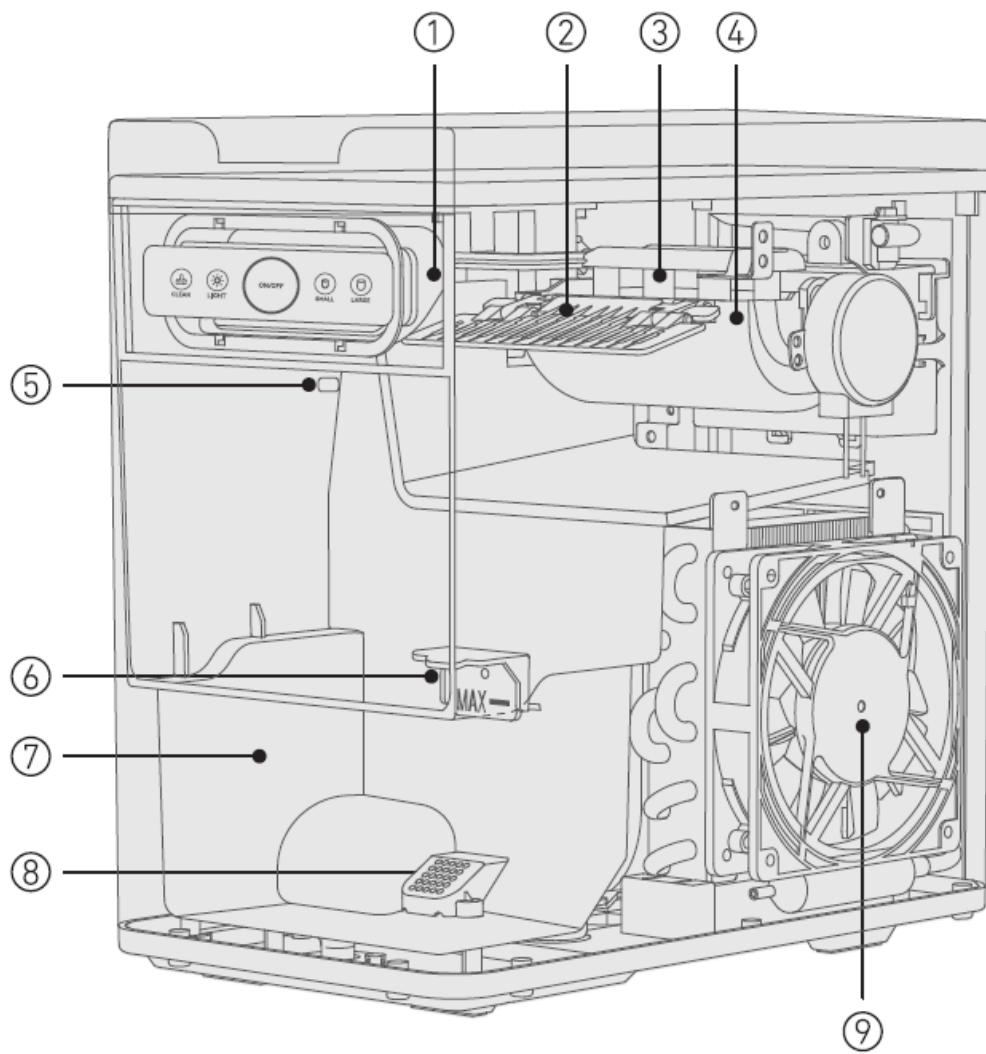

SPECIFICATIONS

- Ice-Making Time: 6-10 Mins
- Ice Basket Capacity: 1.6 lbs (750 g)
- Water Tank Capacity: 950 ml
- Electrical Rating: AC 120 V/60 Hz/1.5 A
- Power: 110 W
- Dimensions: L 7.3 x W 12.8 x H 11.6 in (18.5 x 32.5 x 29.5 cm)
- Weight: 15 lbs (7 kg)
- Refrigerant Amount: R600a / 30g (+/-0.2)

OPERATING YOUR ICE MAKER

INSTALLATION

1. Open the package and take out all the accessories.
2. Place the ice maker vertically on an even surface.
3. Use a clean towel to wipe the water tank, ice basket, and ice scoop.
4. Keep the ice maker upright for 6 hours before the first use.

CONTROL PANEL

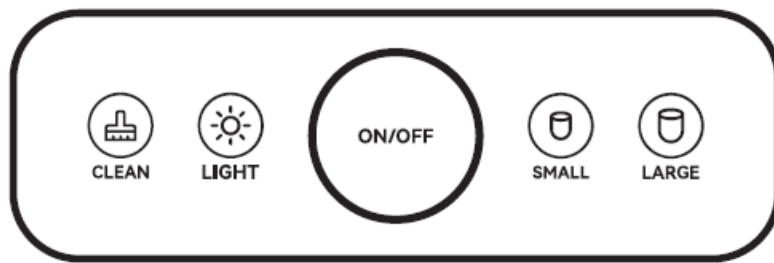

BUTTON FUNCTIONS

ON/OFF Power Button



- Press the button to turn the ice maker on/off.
- Press to start/stop ice making after selecting the desired ice-making mode

Water Shortage

- The Power Button illuminates in orange when the water level is low..

Full Ice Basket

- The Power Button illuminates green when the ice basket is full

LIGHT Button



- **LIGHT** Press and hold the button for 3 seconds to turn the light off.
- Press and hold the button for 3 seconds to turn it on.

Press to make small ice cubes.



- **SMALL** This indicator flashes when choosing the small ice mode.
- After the machine starts making ice, the indicator will stay illuminated.

Press to make large ice cubes



- **LARGE** This indicator flashes when choosing the large ice mode.
- After the machine starts making ice, the indicator will stay illuminated.

CLEAN Button



- **CLEAN** Press and hold for 3 seconds to start cleaning mode, press it again to stop cleaning.
- After starting the cleaning mode, the indicator will stay illuminated.

ADD WATER

1. Place the ice maker upright for more than 6 hours before the first use.
2. Ensure the drain plug is in place.

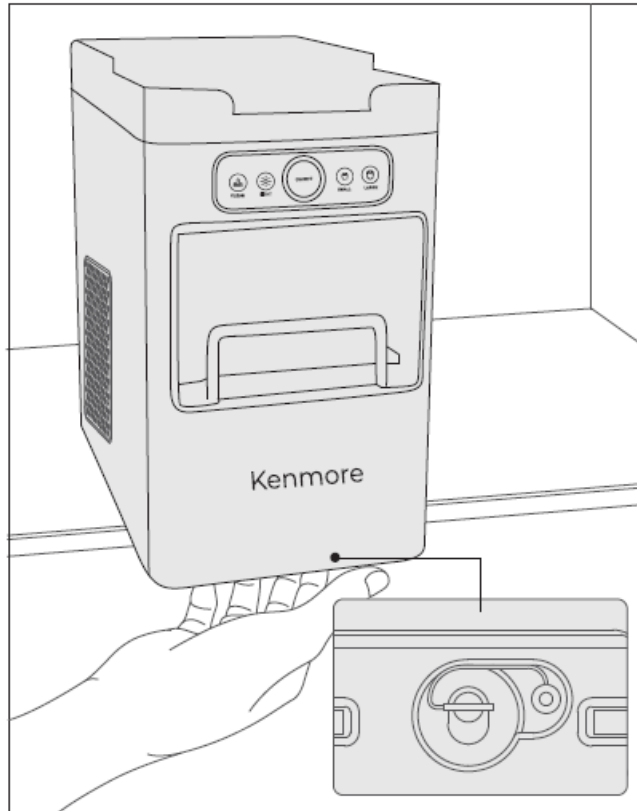

3. Pull out the ice basket and ensure it securely rests on the edge of its slot.
4. Slowly pour 950 ml of drinkable water into the ice basket. (Note: do not exceed the MAX water level.)
5. Push the ice basket securely back into place.

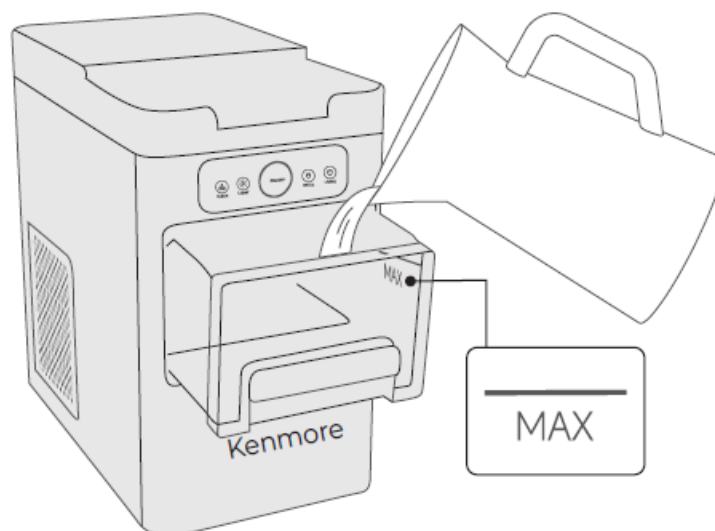

PLUG IN

1. Check that the power outlet's voltage corresponds to the value shown on the appliance nameplate.
2. After plugging in, all the indicators will flash for 1 second and then turn off.

NOTE – Do not use wet hands to plug in the machine. Keep the plug dry.

MAKE ICE

1. Press the ON/OFF Button to turn on the unit.
2. Select the desired ice size.
3. Press the ON/OFF Button to start making ice.

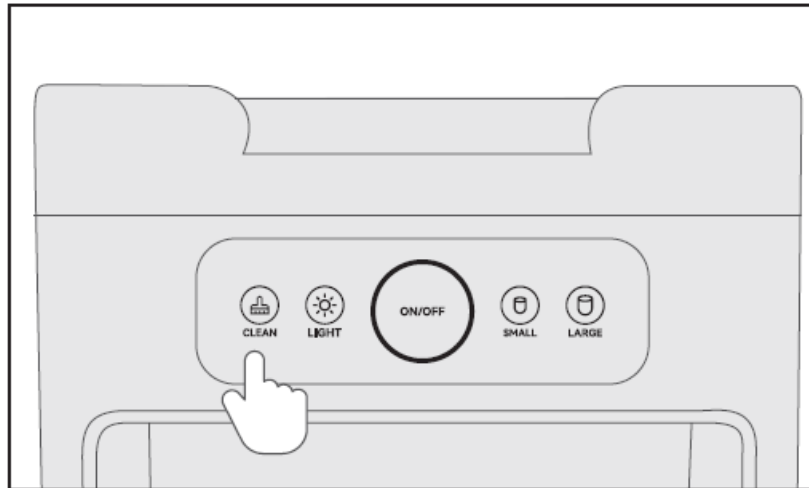

NOTE

1. If the product has been idle for a long time or if it is for the first use, please refer to the "Cleaning" section.
2. It takes approximately 6-10 minutes to make ice. The duration may fluctuate based on the ice size, ambient temperature, and water temperature.
3. The ice may come out small in the beginning. This is usually because the interior cooling pipes have not completely cooled yet. This is normal and will resolve after a few minutes.
4. The ice maker stops making ice after the ice basket is full. The product will resume making ice once the basket is no longer full.

DRAIN WATER

1. Disconnect the power plug before draining.
2. Carefully move the ice maker to an area appropriate to drain water into, such as a sink.
3. Disconnect the drain plug and ensure the residual water flows into the appropriate area.
4. After the water tank is empty, securely plug in the drain plug. Use a clean towel to wipe the residual water.
5. Place the ice maker back on a dry, solid surface.

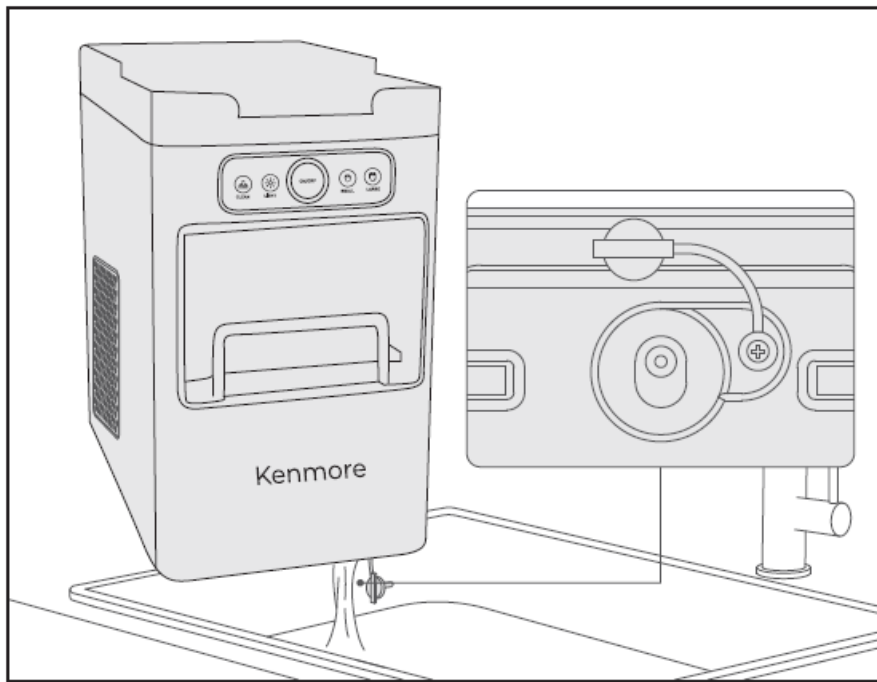

Drain out water in the following situations

1. Always use fresh drinking water to make ice; excess water should be drained after every use.
2. When the product will be idle for a long time.

CARE AND CLEANING

WARNING

- DO NOT immerse the unit in water or any other liquid.
- ALWAYS UNPLUG the unit from the electric outlet before cleaning.

To keep your ice tasting fresh and your ice maker clean, we commend cleaning your ice maker at least once per week.

1. Pull out the ice basket and add water to it. Then, slide the basket back in.
2. Press and hold the Start/Pause Button for 3 seconds; the cleaning indicator will illuminate, and the cleaning mode will start. After 15 minutes, it will stop cleaning. The Start/Pause Button can be pressed to manually stop the cleaning.
3. Disconnect the drain plug after the cleaning has stopped. After it drains, tightly plug the drain plug back in.
4. Add fresh drinking water to the ice basket, activate the cleaning mode, and repeat these steps 2-4 times to ensure the machine is thoroughly washed.

NOTE

1. If the tank is dirty, add some citric acid to clean it (please use the recommended ratio of your citric acid manual for cleaning).
2. Do not use organic solvents, boiled water, strong acids, or bases for cleaning.
3. If not in use for a long time, please wipe down the machine and keep its interior dry.

WARRANTY

2-Year Limited Warranty

- FOR TWO YEARS from the date of sale, this product is warranted against defects in material or workmanship.
- WITH PROOF OF SALE, a defective product will be repaired or replaced free of charge.
- The Kenmore brand is used under license. Direct all claims for warranty service to Koolatron Customer Assistance, call 1-[800-265-8456](tel:800-265-8456) or email service@koolatron.com
- This warranty covers manufacturer's defects, including electrical and mechanical defects, provided the appliance is correctly assembled, operated, and maintained according to the supplied instructions. It does not cover damage caused by accident, misuse, or abuse, including overheating, unauthorized repairs or alterations, or use with a voltage converter or aftermarket accessories, and it does not apply to scratches, stains, discoloration, or other surface damage that does not impair the product's function. This warranty is void if the appliance is ever used for purposes other than private household use.

CONTACT

Koolatron Corporation

- 4320 Federal Drive, Batavia, NY 14020 U.S.A.
- 139 Copernicus Blvd., Brantford, ON N3P1N4 Canada

Kenmore and the Kenmore logo are registered trademarks of Transform SR Brands Management LLC and are used under license by Koolatron Corporation

Customer Assistance

- 1-[800-265-8456](tel:800-265-8456)
- www.koolatron.com

TROUBLESHOOTING FAQ

- THE ICE MAKER DOES NOT WORK
 - Check if the product is powered correctly.
 - Check if the water tank has sufficient water.
 - Check if the compressor is working.
- THE ICE MAKER LEAKS
 - Do not exceed the MAX water level when adding water.
 - Check if the drain plug is tightly plugged.
- WITH SUFFICIENT WATER, THE PRODUCT DOES NOT PRODUCE ICE
 - Check if the water tank's filter is blocked.
 - Check if the compressor is working.

THE FULL ICE INDICATOR ILLUMINATES WHILE THE ICE BASKET IS NOT FULL The infrared sensor is blocked by ice; remove excess ice.

Documents / Resources

	Kenmore KKIMBF-26SSB Front Load Counter Top Ice Maker [pdf] Instruction Manual KKIMBF-26SS, KKIMBF-26SSB, KKIMBF-26SSB Front Load Counter Top Ice Maker, KKIMBF-26SSB, Front Load Counter Top Ice Maker, Counter Top Ice Maker, Top Ice Maker, Ice Maker
---	---

References

- [User Manual](#)

[Manuals+](#), [Privacy Policy](#)

This website is an independent publication and is neither affiliated with nor endorsed by any of the trademark owners. The "Bluetooth®" word mark and logos are registered trademarks owned by Bluetooth SIG, Inc. The "Wi-Fi®" word mark and logos are registered trademarks owned by the Wi-Fi Alliance. Any use of these marks on this website does not imply any affiliation with or endorsement.