



Kenmore KKIBC5SS Immersion Blender Set User Manual

[Home](#) » [Kenmore](#) » Kenmore KKIBC5SS Immersion Blender Set User Manual 

Contents

- [1 Kenmore KKIBC5SS Immersion Blender Set User Manual](#)
- [2 IMPORTANT SAFEGUARDS](#)
- [3 PARTS AND FEATURES SET UP AND ASSEMBLY](#)
- [4 PARTS AND FEATURES SET UP AND ASSEMBLY](#)
- [5 Documents / Resources](#)
 - [5.1 References](#)
- [6 Related Posts](#)

Kenmore KKIBC5SS Immersion Blender Set User Manual

IMPORTANT SAFEGUARDS

When using your Kenmore Immersion Blender Set, basic safety precautions should always be followed, including the following:

1. READ ALL INSTRUCTIONS BEFORE USE
2. Before using the appliance for the rest time, remove any packaging material, promotional labels, and stickers. Safely dispose of plastic bags or small pieces that could present a suocation or choking hazard to young children.
3. PLACEMENT: To protect against re, injury, electrical shock, or property damage, observe the following safeguards:
 - a. Do not use near the edge of a counter or table or on a wet or uneven surface;
 - b. Do not set up the blending cup or food chopper on or near a hot surface such as a stovetop or cooking pot;

- c. Do not use on a metal surface such as a sink drain board.
- 4. Before using, check that the voltage of the wall outlet corresponds to the one shown on the rating plate. If an extension cord is used, the marked electrical rating of the extension cord must be at least as great as the electrical rating of the appliance. Do not attempt to use the appliance with a voltage converter.
- 5. Fully unwind cord before use. Do not let the cord become knotted, hang over the edge of a counter or table, or contact hot surfaces, such as a stovetop or cooking pot.
- 6. Do not attempt to operate the appliance if there is damage to the cord or plug, after it has malfunctioned or been dropped or damaged in any way, if it is not operating properly, or if the blending or chopping blades are bent or damaged in any way. Do not attempt to sharpen the blades. Take the appliance to the nearest authorized service facility for examination and repair.
- 7. Always unplug the appliance from the power source when not in use and before cleaning. To unplug, grasp plug and pull it from the electrical outlet; never unplug it by pulling on the power cord.
- 8. This appliance is recommended for indoor household use only. Do not operate in moving vehicles or boats and do not operate outdoors. Using this appliance for anything other than its intended use (non-commercial household food preparation) will void your warranty.
- 9. This appliance is not intended for use by persons, including children, with reduced physical, sensory or mental capabilities, or lack of experience and knowledge, without supervision and instruction by a person responsible for their safety. Children should be supervised to ensure they do not play with the appliance.
- 10. Ensure the appliance is properly assembled before connecting to a power outlet and operating. Do not attempt to defeat the safety interlocks at any time.
- 11. Do not leave the appliance unattended while in use.
- 12. To protect against electrical shock, do not immerse the motor body, power cord, or electrical plug in any liquid. Only the blending rod, whisk, and chopper attachments are designed for immersion in liquids for blending or cleaning. Always remove the attachments from the motor body before cleaning them.
- 13. If the motor body falls into any liquid, immediately unplug the power cord and then remove from liquid. Do not reach into the liquid without first unplugging the unit.
- 14. To reduce the risk of personal injury and/or damage to the appliance, keep hands, hair, clothing, and utensils away from attachments and out of the mixing container during operation. Avoid any contact with moving parts.
- 15. To reduce the risk of injury, never place cutting blade on base without first putting bowl properly in place.
- 16. Be certain cover is securely locked in place before operating appliance.
- 17. The blending and chopping blades are extremely sharp. Use extreme caution and avoid contact with cutting edges when handling and cleaning the blades.
- 18. To reduce the risk of injury when assembling chopper attachment, set the work bowl on the work surface and check the work bowl for the presence of foreign objects before placing the chopping blade on its base.
- 19. Ensure that the chopping blade, lid, and motor body are all properly positioned before attempting to operate the chopper attachment. Release the power button and wait until the blade has completely stopped rotating before removing the chopper lid.
- 20. When blending liquids, especially hot liquids, use a tall container or process small quantities at a time to reduce the risk of spilling, splattering, and/or burning injury.
- 21. Do not use the appliance to chop ice or to blend hard and dry substances as this could damage the blade.
- 22. Do not attempt to operate the appliance by any method other than as described in this manual. Aftermarket attachments or accessories not recommended by Kenmore will void your warranty and may cause re, electrical shock, or injury.
- 23. For any maintenance other than cleaning, call or email Kolton Customer Assistance.

PARTS AND FEATURES SET UP AND ASSEMBLY

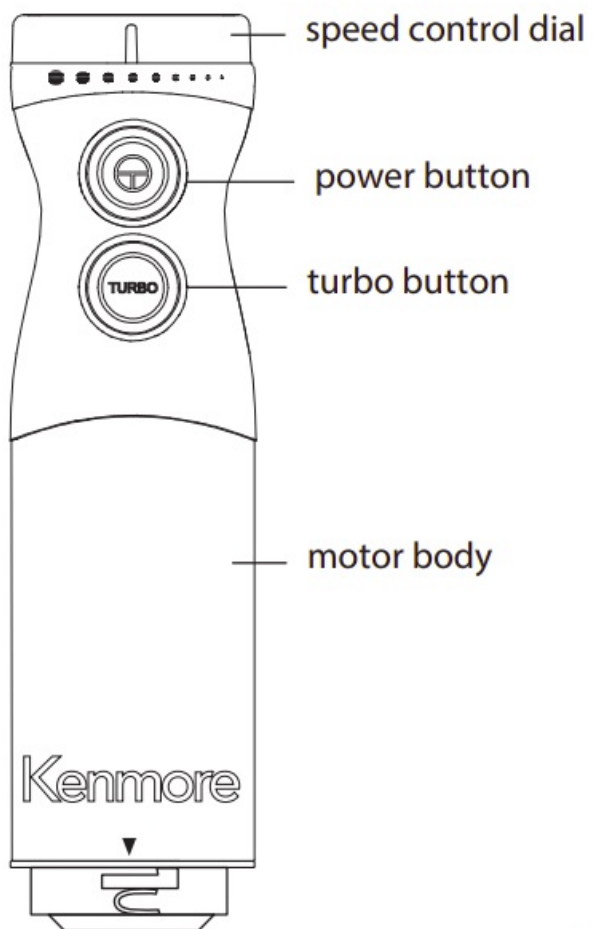

CHOPPER ATTACHMENT

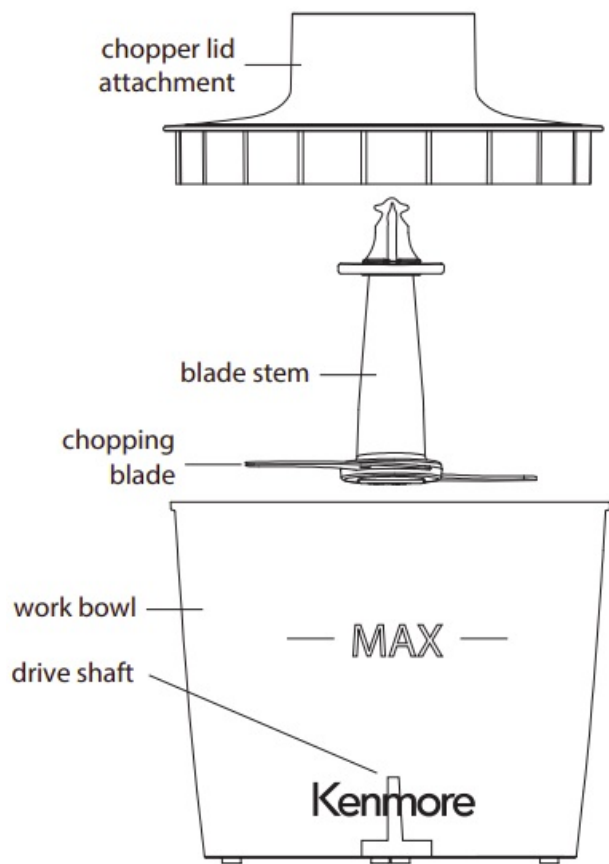

BLENDER ATTACHMENT

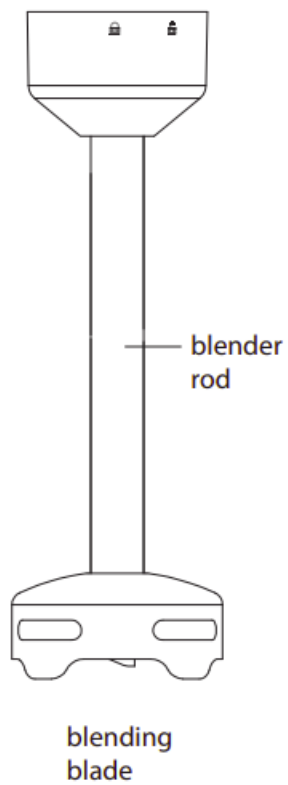

WISK ATTACHMENT

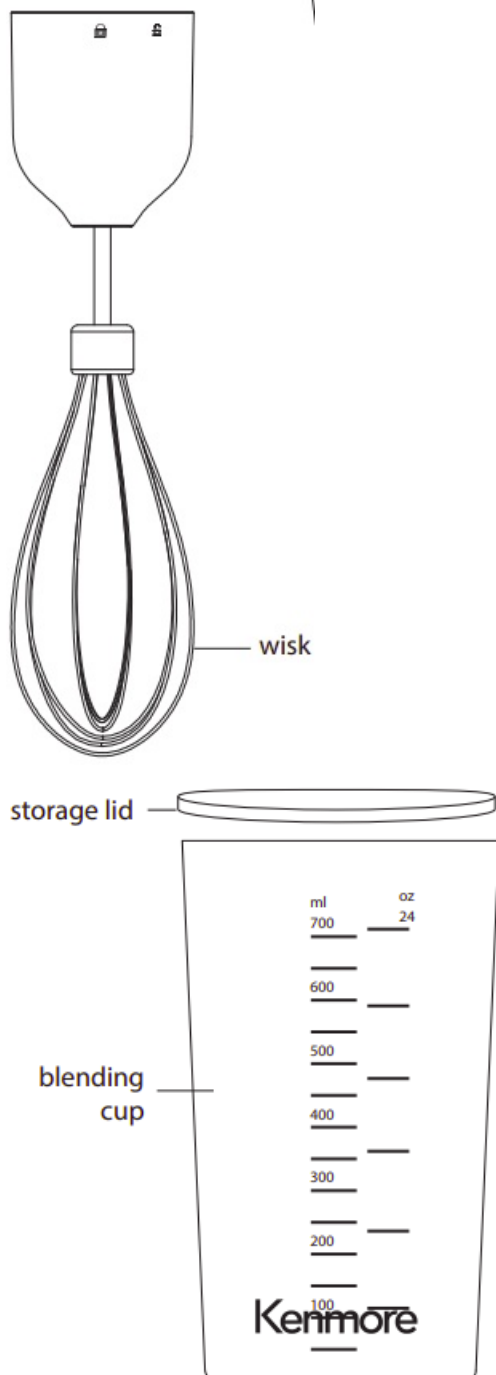

PARTS AND FEATURES SET UP AND ASSEMBLY



WARNING – To protect against electric shock, ALWAYS UNPLUG the unit from the electric outlet before disassembling or cleaning.

Before using the Kenmore Variable Speed Immersion Blender for the first time, wipe the motor body and all attachments with a clean, damp cloth to remove any dirt or dust. Dry thoroughly with a soft cloth.



WARNING – The blending and chopping blades are extremely sharp. Use caution when handling and avoid contact with the cutting edges.

IMMERSION BLENDER

1. Align arrow on motor body with “unlock” icon on blending rod (Fig. 1).

2. Push the two pieces together and rotate blending rod until arrow aligns with “lock” icon (Fig. 2)
3. To disassemble, rotate blending rod until arrow aligns with “unlock” icon and pull motor body and blending rod apart.

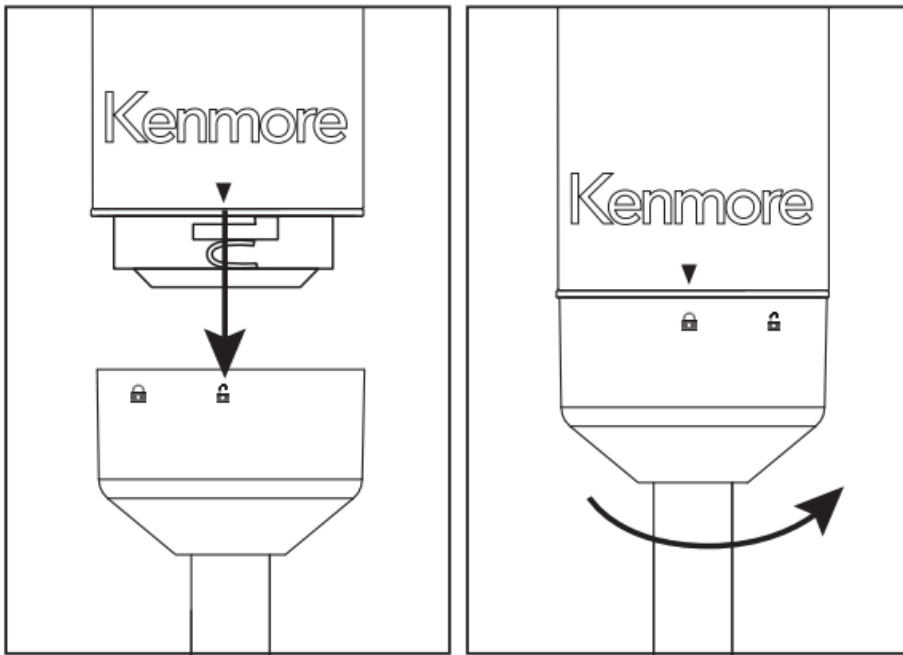

WHISK

1. Insert whisk into whisk adapter and push firmly into place (Fig. 3).
2. Align arrow on motor body with “unlock” icon on whisk adapter.
3. Push the two pieces together and rotate whisk adapter until arrow aligns with “lock” icon.
4. To disassemble, rotate whisk adapter until arrow aligns with “unlock” icon and pull whisk adapter and motor body apart.
5. Firmly grasp whisk and whisk adapter in your hands and pull apart

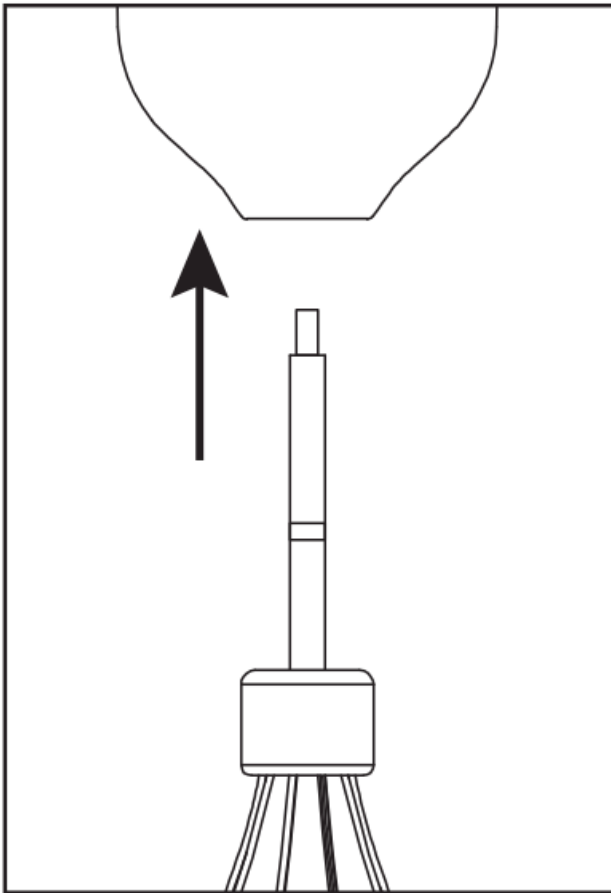

Documents / Resources

	Kenmore KKIBC5SS Immersion Blender Set [pdf] User Manual KKIBC5SS Immersion Blender Set, KKIBC5SS, Immersion Blender, Blender SetSet
-------------------------------------------------------------------------------------	---------------------------------------------------------------------------------------------------------------------------------------------------------

References

- [Koolatron | Global Leader in Thermoelectric Products](#)
- [User Manual](#)

[Manuals+](#), [Privacy Policy](#)

This website is an independent publication and is neither affiliated with nor endorsed by any of the trademark owners. The "Bluetooth®" word mark and logos are registered trademarks owned by Bluetooth SIG, Inc. The "Wi-Fi®" word mark and logos are registered trademarks owned by the Wi-Fi Alliance. Any use of these marks on this website does not imply any affiliation with or endorsement.