



# KeeYees ESP32 Development Board Instruction Manual

[Home](#) » [KeeYees](#) » KeeYees ESP32 Development Board Instruction Manual 

## Contents

- [1 KeeYees ESP32 Development Board](#)
- [2 Download and install the CP2102 driver](#)
- [3 Add ESP32 development board in Arduino IDE](#)
- [4 Documents / Resources](#)
  - [4.1 References](#)
- [5 Related Posts](#)

KeeYees

## KeeYees ESP32 Development Board



ESP32 is a module that developers can easily get started with. Professional manufacturers can use this module to develop more diversified products. This article mainly discusses how to correctly use ESP32 in Arduino IDE.

## Download and install the CP2102 driver

1. Click the website below to enter the download interface <https://www.silabs.com/products/development-tools/software/usb-to-uart-bridge-vcp-drivers>
2. Select the driver suitable for your system and download it as shown below.

Platform	Software	Release Notes
 Windows 10 Universal	<a href="#">Download VCP (2.3 MB)</a>	<a href="#">Download VCP Revision History</a>

Platform	Software	Release Notes
 Windows 7/8/8.1	<a href="#">Download VCP (5.3 MB) (Default)</a>	<a href="#">Download VCP Revision History</a>
 Windows 7/8/8.1	<a href="#">Download VCP with Serial Enumeration (5.3 MB)</a> <a href="#">Learn More &gt;</a>	<a href="#">Download VCP Revision History</a>

Platform	Software	Release Notes
 Windows XP/Server 2003/Vista/7/8/8.1	<a href="#">Download VCP (3.66 MB)</a>	<a href="#">Download VCP Revision History</a>

3. After downloading, unzip the file, and then choose to install the driver suitable for your operating system.

arm	2019/8/29 16:16	文件夹	
arm64	2019/8/29 16:16	文件夹	
x64	2019/8/29 16:16	文件夹	
x86	2019/8/29 16:16	文件夹	
CP210x_Universal_Windows_Driver.zip	2019/8/29 16:14	360压缩 ZIP 文件	879 KB
CP210x_Universal_Windows_Driver_R...	2019/6/24 13:01	文本文档	24 KB
CP210xVCPInstaller_x64.exe	2018/5/7 17:05	应用程序	1,026 KB
CP210xVCPInstaller_x86.exe	2018/5/7 17:05	应用程序	903 KB
dpinst.xml	2018/5/7 16:46	XML 文档	12 KB
silabser.cat	2019/6/24 9:21	安全目录	13 KB
silabser.inf	2019/6/24 9:21	安装信息	11 KB
SLAB_License_Agreement_VCP_Windo...	2019/6/24 13:37	文本文档	9 KB

## Add ESP32 development board in Arduino IDE

1. Open arduino ide and click file-> Preferences, as shown below.

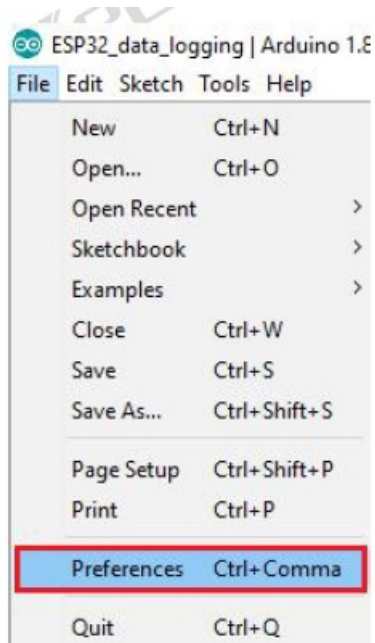

2. Then enter [https://dl.espressif.com/dl/package\\_esp32\\_index.json](https://dl.espressif.com/dl/package_esp32_index.json) in the additilnal boards manaper URLs field, and click "ok" as shown below.

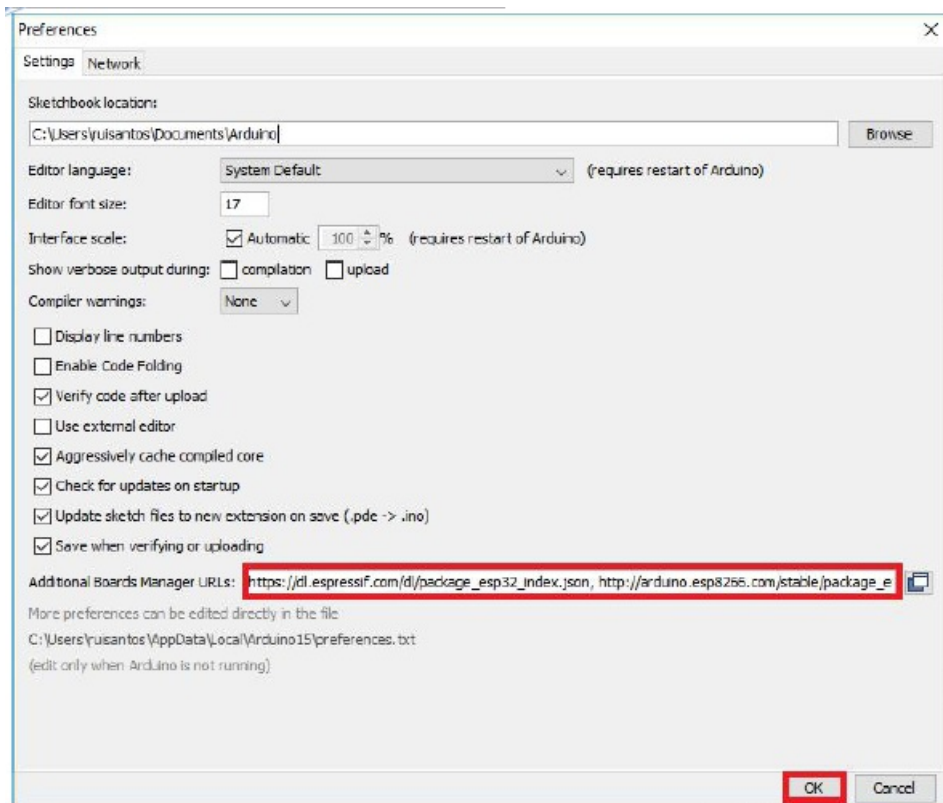

- Click tools-> board-> Boards Manager in turn, then enter ESP32 in the pop-up interface, and click Install. As shown below.

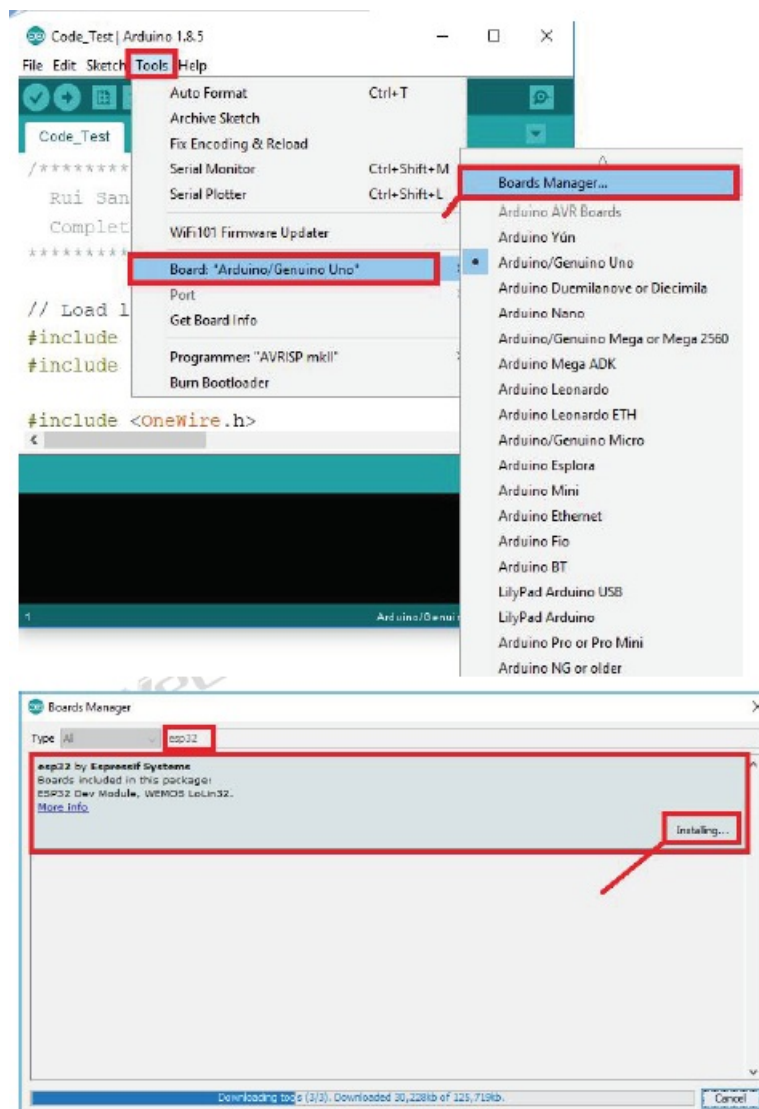

- Close the window after downloading, and then select the development board ESP32-Dev Module as shown

below

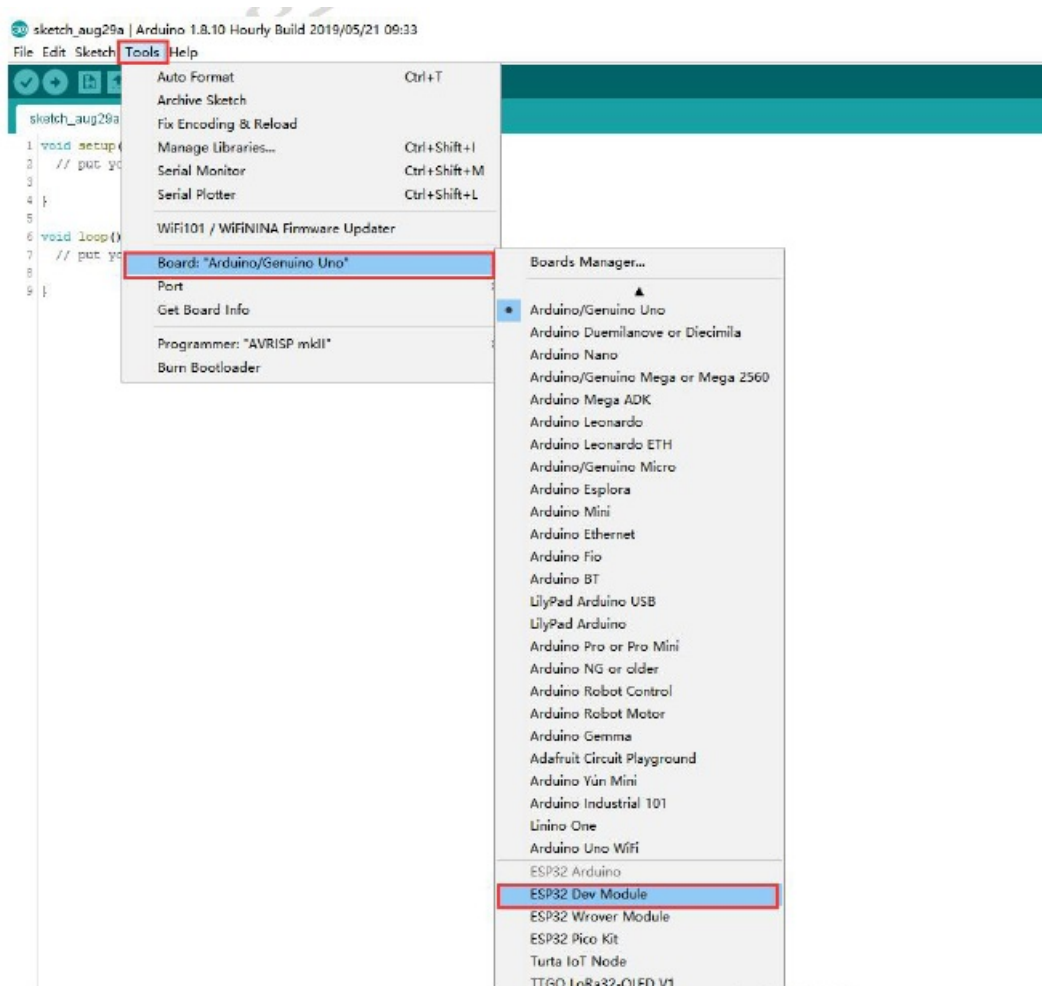

5. Now you can develop your project in arduinoIDE.
6. In the process of uploading the program, when Arduino ide prompts a symbol like as shown below, please long press the IO0 button onthe ESP32 module for about 2 to 3 seconds, and then the program can be uploaded successfully.

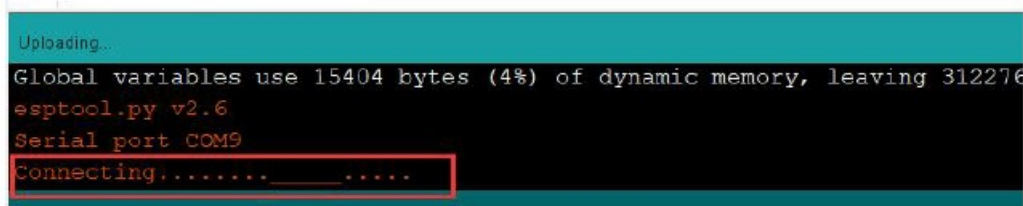

## Documents / Resources

	<a href="#">KeeYees ESP32 Development Board</a> [pdf] Instruction Manual ESP32, Development Board, ESP32 Development Board
---	---

## References

- [dl.espressif.com/dl/package\\_esp32\\_index.json](https://dl.espressif.com/dl/package_esp32_index.json)

