



KARCHER SC 3 EasyFix User Manual

[Home](#) » [Karcher](#) » KARCHER SC 3 EasyFix User Manual

KARCHER SC 3 EasyFix User Manual

KÄRCHER

makes a difference

SC 3 EasyFix



59687540 2019.08

Contents [[hide](#)

[1 STEAM CLEANER OPERATOR'S MANUAL](#)

[2 IMPORTANT SAFETY INSTRUCTIONS](#)

[3 GROUNDING INSTRUCTIONS](#)

[4 Description of the unit](#)

[5 Initial commissioning](#)

[6 Installation](#)

[7 Operation](#)

[8 Important application instructions](#)

[9 Use of accessories](#)

[10 Care and service](#)

[11 Troubleshooting guide](#)

[12 Documents / Resources](#)

[12.1 References](#)

[13 Related Posts](#)

STEAM CLEANER OPERATOR'S MANUAL

IMPORTANT SAFETY INSTRUCTIONS

Observe all basic precautions when using the device, including the following:

READ ALL INSTRUCTIONS BEFORE USING THIS MACHINE

This device is exclusively intended for private household use.

WARNING

Risk of electric shock, burns and injuries

- Never leave the device unsupervised while it is plugged in. Pull the plug out of the power socket when not using the device and before all maintenance work.
- Turn off all controls before unplugging
- Unplug before connecting accessory.
- Check that the mains voltage matches the information on the type plate.
- Use only accessories recommended by the manufacturer.
- Use and store the device only in dry indoor spaces at ambient temperatures above 32 °F (0 °C). Protect the device from moisture.
- Store the device in closed rooms.
- Store the device in a suitable location after use to avoid tripping accidents.
- Do not expose to rain.
- Repairs are only to be carried out by qualified personnel. Ensure that only identical original spare parts are installed.
- Immediately replace a damaged power cable with an original part.
- If the mains cable is damaged, or the device has fallen down, has been left outside or has been immersed in water, have the device checked by our Customer Service department before using it.
- Never touch the device, mains plug or mains socket with wet hands.
- Do not pull or carry by the power cable, do not use power cable as a handle, do not close a door on the power cable, or pull cord around sharp edges or corners. Do not run device over power cable. Keep power cable

away from heated surfaces.

- Always pull the plug and never the cable in order to disconnect the device from the mains supply.
- Never use the device with an extension cord.
- Only use the device for the intended use.
- The device is not a toy. Exercise special care when using the device in the presence of children.
- Unintentional starting of the device. Ensure that the device is switched off before lifting or transporting it.
- Exercise caution when using the device on stairs.
- Never insert objects into the device openings. Do not use the device if the device openings are blocked.
- Never fill solvents, solvent-containing liquids or undiluted acids (e.g. detergents, petrol, paint thinner, and acetone) into the water reservoir as these substances corrode the materials used in the device.
- Never immerse the device in water or other liquids.
- Only use the device in containers / pools that are not filled with water or other liquids.
- Do not use the device with water that has been combined with detergent, descaling, aromatic, alcohol, rinse and/or any other sort of chemicals.
- The device may not be operated in explosive atmospheres.
- Do not spray steam in the direction of another person, animal or electrical outlet.
- Do not clean over floor electrical outlets.
- Accessories become hot during use-allow to cool down before handling.
- Allow the device to cool down and empty the tank before storing.
- Store the device indoors in a cool, dry place.
- Do not use the steam cleaner to treat any items of clothing that are still being worn on the body.
- Do not touch any hot areas on the steam cleaner. It is normal for the steam cleaner to heat up during operation.
- Do not overfill the tank. Do not exceed the maximum filling level.
- Do not operate the device without water in the tank. Always top off with water when needed.
- The steam switch must not be locked during the operation.
- The device must be placed horizontally on the floor during use.
- To prevent electric shock use only with a grounded outlet. See Grounding Instructions.

SAVE THESE INSTRUCTIONS

Polarization instructions

- To reduce the risk of an electric shock, the device is fitted with a polarized plug (one pin is wider than the other). This plug only fits into a polarized socket in one direction. Rotate the plug if it does not fit fully into the power socket. If the plug still does not fit then you must have a suitable socket installed by a qualified electrician. Never modify or replace the plug.

GROUNDING INSTRUCTIONS

- This device must be grounded. If it should malfunction or break down, grounding provides a path of least resistance for electric current to reduce the risk of electric shock.
- This device is equipped with a cord having an equipment grounding conductor and ground plug.
- The plug must be inserted into an appropriate outlet that is properly installed and grounded in accordance with all local codes and ordinances.

WARNING:

- Improper connection of the equipment grounding conductor can result in a risk of electric shock.
- Check with a qualified electrician or service person if you are in doubt as to whether the outlet is properly grounded.
- Do not modify the plug provided with the appliance.
If it will not fit the outlet, have a proper outlet installed by a qualified electrician.
- This appliance is for use on a nominal 120-volt circuit, and has a grounded plug that looks like the plug illustrated in Fig. A.
- Make sure that the appliance is connected to an outlet having the same configuration as the plug. No adaptor should be used with this appliance.
- **DO NOT ATTEMPT TO REPAIR POWER CORD.**
IN ALL CASES, MAKE SURE THE RECEPTACLE IN QUESTION IS PROPERLY GROUNDED. NEVER REMOVE GROUNDING PRONG FROM POWER PLUG.

EXTENSION CORDS

If an extension cord is absolutely necessary, an extension cord rated a minimum of 15 ampere 14 gauge cord should be used. Cords rated for less amperage may overheat. Care should be taken to arrange the cord so it cannot be pulled or tripped over.

Figure A

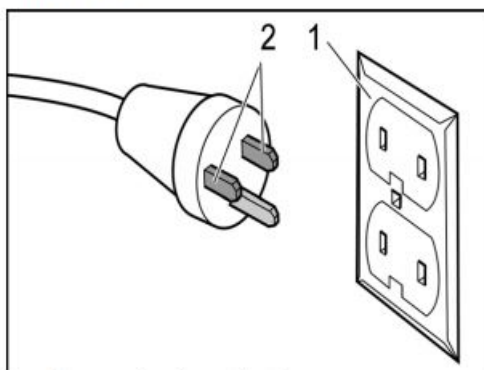

- 1 Grounded outlet box
2 Current carrying prongs Grounding prong is longest of the 3 prongs.

Safety devices



Missing or modified safety devices Safety devices are provided for your own protection. Never modify or bypass safety devices.

Pressure regulator

In the case of excessively high pressure in the event of a fault, a safety valve relieves the pressure into the atmosphere.

Fuse

The fuse prevents the device from overheating. If the device overheats, the fuse disconnects the device from the power supply. Before restarting the device, contact the KÄRCHER Customer Service at 1-800-537-4129.

Hazard levels



Indication of an imminent threat of danger that will lead to severe injuries or even death.

WARNING

Indication of a potentially dangerous situation that may lead to severe injuries or even death.

CAUTION



Indication of a potentially dangerous situation that may lead to minor injuries.

ATTENTION

- Indication of a potentially dangerous situation that may lead to damage to property.

Symbols on the device

(according to type of the device)

	Risk of burns, surface of device becomes hot during operation
	Risk of scalding from steam
	Read the operating instructions

Intended use

- The device is intended for household use only and not for commercial purposes.
- The device is intended to be used with steam and can be used with the appropriate accessories as described in these operating instructions. You will not need any detergent. Please adhere to the safety instructions.
- Please use this device only with accessories and spare parts approved by KÄRCHER.

Note

The manufacturer accepts no liability for possible damage caused by improper use or incorrect operation.

Owner/User Responsibility

The owner and/or user must have an understanding of the manufacturer's operating instructions and warnings before using this appliance. Warning information should be emphasized and understood. If the operator is not fluent in English, the manufacturer's instructions and warnings shall be read to and discussed with the operator in the operator's native language by the purchaser/ owner, making sure that the operator comprehends its contents. Owner and/ or user must study and maintain for future reference the manufacturer's instructions.

Scope of delivery

The scope of delivery for the appliance is shown on the packaging. During unpacking, check the contents for completeness. If any accessories are missing or in the event of any shipping damage, please contact our Customer Care Group by calling 1-800-537-4129. Select the prompts for warranty services.

Customer Service for USA and Canada

Our local KÄRCHER branch will be happy to help you if you have any questions or problems with the device. You can register your device at www.karcher-register.com. Technical support is available at www.karcher-help.com. In the case of a warranty claim, you can contact our Customer Service department under the phone number 1-800-537-4129. You must fax or mail your purchase receipt to the Customer Service department in order to make a warranty claim. Further information is available at www.kaercher.com/us www.kaercher.com/ca

Technical data

Electrical connection		
Voltage	V	120
Phase	~	1
Frequency	Hz	60
Degree of protection		IPX4
Protection class		I
Device performance data		
Heating capacity	W	1450
Maximum operating pressure	psi (MPa)	44,0 (0,3)
Heating-up time	Sec-onds	40
Continuous steaming	oz/min (g/min)	1,76 (50)
Maximum steam blast	oz/min (g/min)	4,23 (120)
Filling quantity		
Water reservoir	gal (l)	0,26 (1,0)
Dimensions and weights		
Weight (without accessories)	lbs (kg)	7,05 (3,2)
Length	in (mm)	14,17 (360)
Width	in (mm)	9,3 (236)
Height	in (mm)	9,9 (253)
Part No.	1.513-	120.0
Subject to technical changes without notice.		

Description of the unit

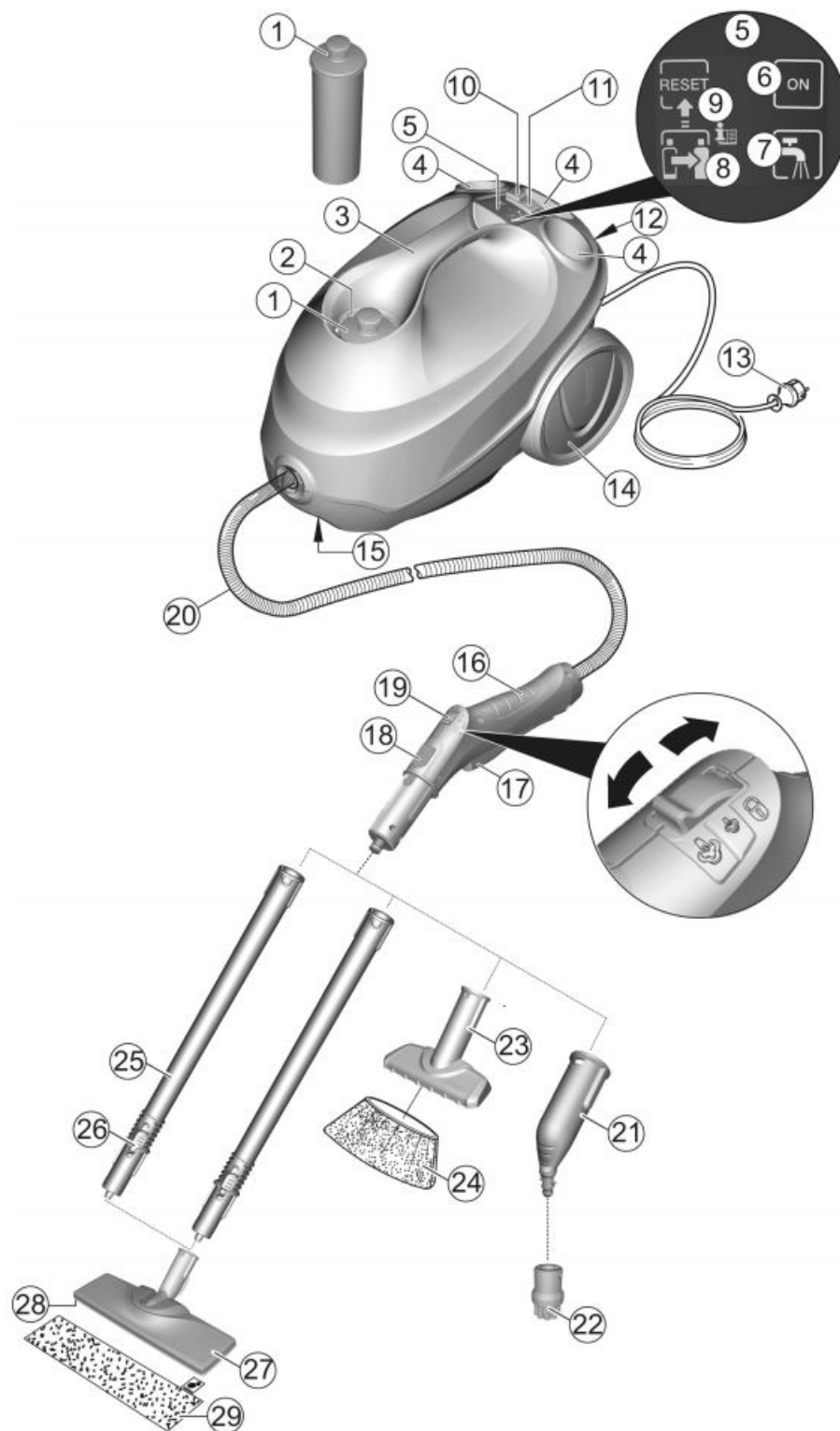

- (1) Decalcification cartridge
- (2) Filling hole for water
- (3) Carrying handle
- (4) Holder for accessories
- (5) Display
- (6) Indicator light (green) – mains volt-age present
- (7) Indicator light (red) – water shortage
- (8) Indicator light (red) – replace decal- ciation cartridge
- (9) RESET button – set water hardness
- (10) Switch – On

- (11) Switch – Off
- (12) Park bracket for floor nozzle
- (13) Mains connection cable with mains plug
- (14) Non-driven wheels (2 x)
- (15) Steering roller
- (16) Steam gun
- (17) Steam lever
- (18) Unlocking button
- (19) Selector switch for steam volume (child lock)
- (20) Steam hose
- (21) Spotlight nozzle
- (22) Round brush (small, black)
- (23) Manual nozzle
- (24) Microfiber cover for manual nozzle
- (25) Extension tubes (2 x)
- (26) Unlocking button
- (27) Floor nozzle
- (28) Hook and loop fastener
- (29) Microfiber floor cloth (1 x)

Initial commissioning

ATTENTION

Device damage due to calcification

The decalcification cartridge only works properly if you adjust the device to the local water hardness before operating it for the first time. Set the device to the local water hardness. Set the device to the current water hardness before using it in an area with a different water hardness (e.g. after a move)

1. Insert the decalcification cartridge into the opening and push it so that it is firmly in place.

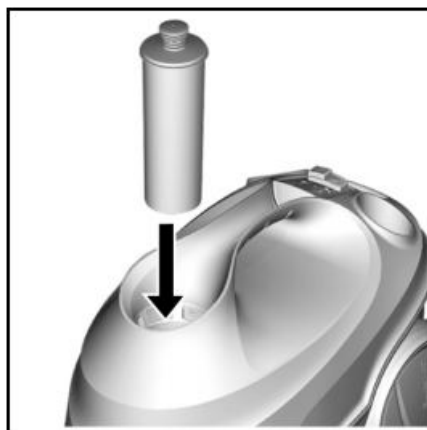

2. Set the water hardness, see chapter Setting the water hardness.

Installation

Installing accessories

1. Insert and engage the steering roller and non-driven wheels.

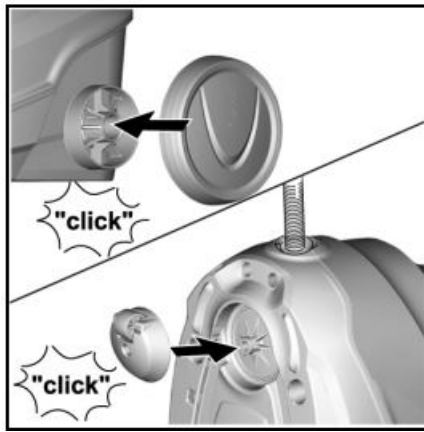

2. Push the open end of the accessory onto the steam gun so that the unlocking button on the steam gun engages.

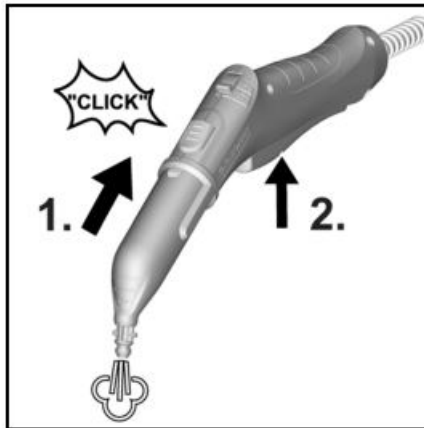

3. Push the open end of the accessory onto the spotlight nozzle.

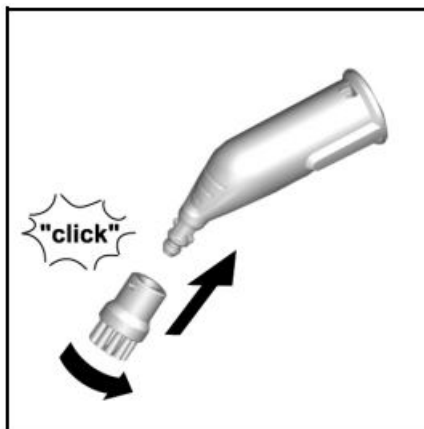

4. Connect extension tubes with the steam gun.
 - a Push the 1st extension tube onto the steam gun until the unlocking button on the steam gun engages. The connection pipe is connected.
 - b Push the 2nd extension tube onto the 1st extension tube. The connection pipes are connected.
- 5.

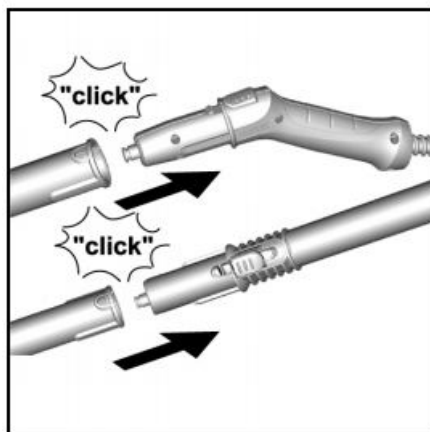

Push the accessory and / or the floor nozzle onto the free end of the extension tube.

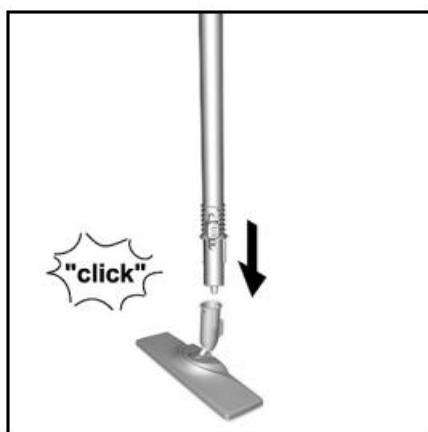

The accessory is connected.

Disconnecting accessories

1. Set the selector switch for the steam volume to the rear. The steam lever is locked.
2. Push the unlocking button and pull the parts apart.

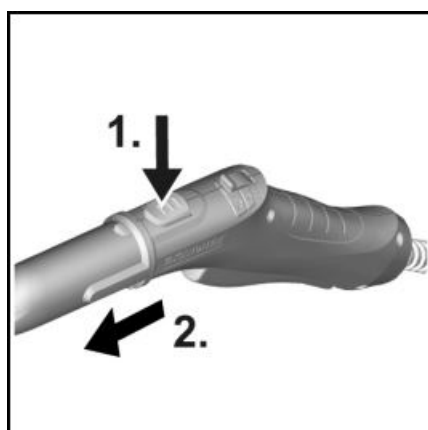

Operation

Filling with water

The water reservoir can be filled at any time.

ATTENTION

Damage to the device

Unsuitable water can block the nozzles or damage the water level indicator. Do not use condensation from the clothes dryer for filling. Do not use collected rain water for filling. Do not use detergents or other additives (e.g. scents) for filling.

1. Fill the water reservoir with a maximum of 1 l of tap water.

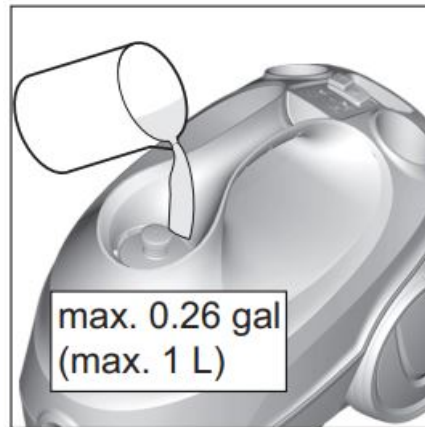

Switching the device on

ATTENTION

Device damage due to incorrectly set water hardness The decalcification cartridge only works properly if the device is adjusted to the local water hardness. The device may calcify if the water hardness is set incorrectly. Adjust the device to the local water hardness before operating it for the first time, see chapter Setting the water hardness.

Note

When steaming for the first time after removing and reinserting the decalcification cartridge, the steam jet may be weak or irregular, and individual drops of water may be expelled. The device requires a short running-in period during which the decalcification cartridge fills with water. The steam volume that is expelled increases constantly until the maximum steam volume has been reached after approx. 60 seconds.

1. Place the device on a solid surface.
2. Plug the mains plug into a socket.
 - a Press the ON switch.

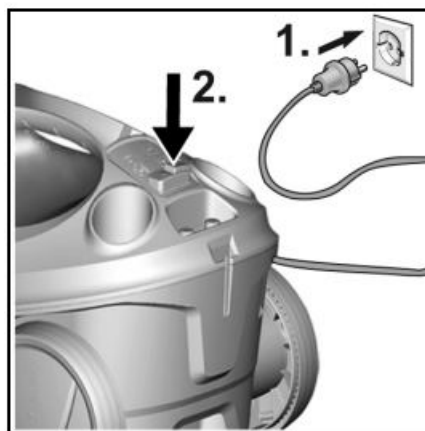

3. The green heating indicator light lights up. The device is ready for use after approximately 60 seconds.

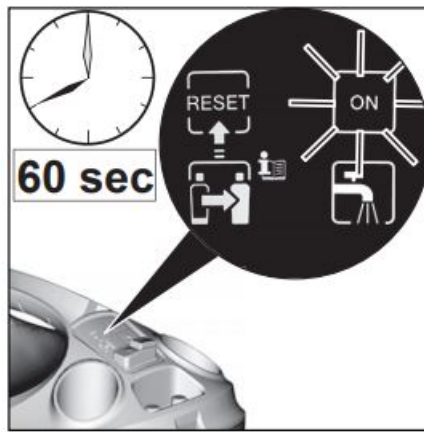

4. Note

After the cartridge is inserted for the first time or has been replaced, it takes about 60 seconds for a good steam image result. **Regulating the steam volume**

The expelled steam volume is regulated using the selector switch for steam volume. The selector switch has three positions:

	Maximum steam volume
	Reduced steam volume
	No steam - child lock Note <i>In this position, the steam lever cannot be operated.</i>

1. Set the selector switch for the steam volume to required steam volume.
2. Press the steam lever.
3. Before starting cleaning, point the steam gun at a cloth until steam is expelled evenly.

Refilling water

If there is a water shortage, the red water shortage indicator light lights up constantly. For constant steam output, the water has to be topped up through the cover of the decalcification cartridge. When refilling the water, the decalcification cartridge remains secured in the device.

Note

The device is equipped with dry running protection for the pump. If the pump runs dry for a longer period, e.g. because the decalcification cartridge is not correctly inserted, the pump switches off and the red water shortage indicator light flashes. To be able to operate the device again, the device has to be switched off and back on again. In the process, you must make sure that the cartridge has been inserted correctly and there is enough water in the water reservoir.

1. Fill the water reservoir with a maximum of 1 l of tap water through the cover of the decalcification cartridge. The red water shortage indicator light goes out.

Interrupting operation

In order to save energy, we recommend that you switch off the device for operating breaks longer than 20 minutes. 1. Press the OFF switch.

Switching off the device

1. Press the OFF switch.

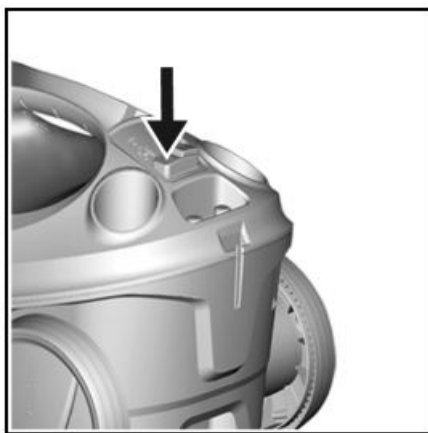

The device is switched off.

2. Press the steam lever until no more steam flows out.

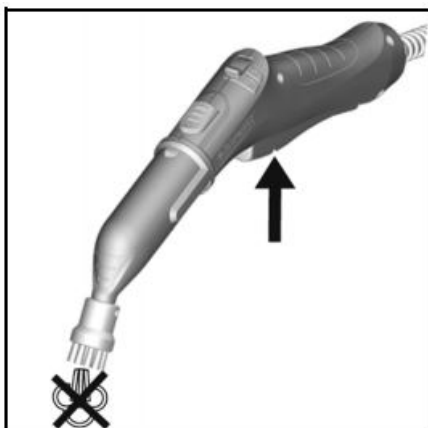

The steam boiler is depressurized.

3. Set the child lock (selector switch for steam volume) to the rear. The steam lever is locked.
4. Pull the mains plug out of the socket.

ATTENTION

Device damage due to water putrefaction If the device is not put into operation for more than 2 months, the water in the tank may putrefy. Drain the water reservoir before breaks in operation.

5. Drain the water reservoir.

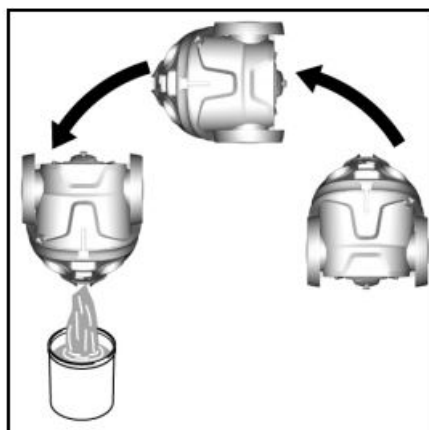

Keep the device safe

1. Plug the extension tubes into the large holders for accessories.
2. Plug a manual nozzle and spotlight nozzle into each extension tube.
3. Fasten the large round brush to the spotlight nozzle.

4. Plug the small round brush and nozzles into the medium-sized holder for accessories.
5. Hang the floor nozzle in the park bracket.

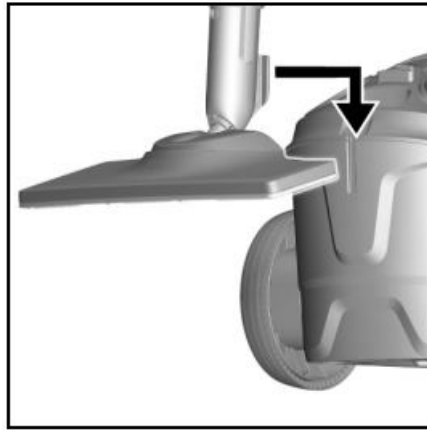

6. Wind the steam hose around the extension tube and plug the steam gun into the floor nozzle.

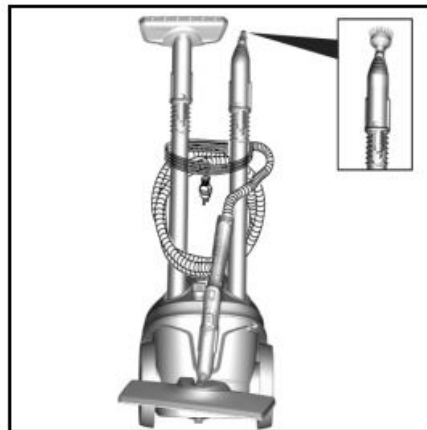

7. Wind the mains cable around the extension tube.
8. Store the device in a dry location that is protected from frost.

Important application instructions

Cleaning the floor areas

We recommend sweeping the floor or vacuum cleaning it before using the device. In this way the floor will be cleared of dirt and loose particles before the wet cleaning commences.

Freshening up textiles

Prior to using the device, always check the compatibility of the textiles at a concealed point: Steam down the textile, allow it to dry and then check it for any change in color or shape.

Cleaning coated or painted surfaces

ATTENTION

Damaged surfaces Steam can loosen wax, furniture polish, plastic coatings or paint and edge band from edges. Do not direct the steam at glued laminated edges as the edge band may loosen. Do not use the device for cleaning unsealed wood or parquet floors. Do not use the device for cleaning painted or plastic coated surfaces such as kitchen or living room furniture, doors or parquet.

1. To clean these surfaces, steam a cloth briefly and use it to wipe over the surfaces.

Glass cleaner

ATTENTION

Glass breakages and damaged surfaces Steam can damage sealed points of the window frame and, at low exterior temperatures, lead to tension on the surface of window panes and hence to glass breakages. Do not direct the steam at sealed points on the window frame. At low exterior temperatures, heat up the window panes by gently steaming the whole glass surface.

- Clean the window area with a manual nozzle and cover. To remove the water, use a squeegee or wipe the surfaces dry.

Use of accessories

Steam gun

The steam gun can be used for the following applications without accessories:

- For removing slight creases from the hanging clothing items: Steam the clothing item from a distance of 1020 cm.
- For wiping damp dust: Steam a cloth briefly and use it to wipe over the furniture.

Spotlight nozzle

The spotlight nozzle is suitable for cleaning areas, joints, fittings, drains, sinks, toilets, blinds or heaters that are difficult to access. The closer the spotlight nozzle is to the soiled area, the greater the cleaning efficiency will be, since the temperature and steam volume are at their highest at the nozzle opening. Larger lime deposits can be treated before steam cleaning with a suitable detergent. Allow the detergent to soak in for approx. 5 minutes and then steam it off.

1. Slide the spotlight nozzle onto the steam gun.

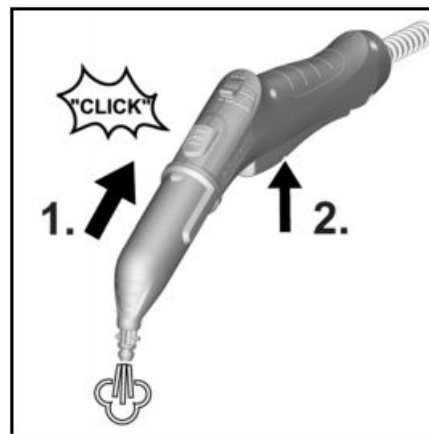

Round brush (small)

The small round brush is used for cleaning stubborn soiling. Stubborn soiling can be removed more easily by brushing.

ATTENTION

Damaged surfaces The brush may scratch sensitive surfaces. It is not suitable for cleaning sensitive surfaces.

1. Fit the round brush to the spotlight nozzle.

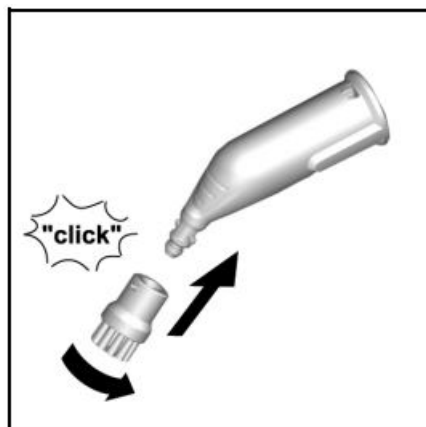

Manual nozzle

The manual nozzle is used for cleaning small areas that can be washed down, shower cubicles and mirrors.

1. Push the manual nozzle onto the steam gun according to the spotlight nozzle.

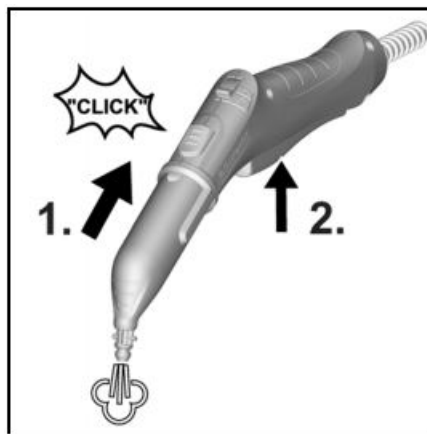

2. Pull the cover over the manual nozzle.

Floor nozzle

The floor nozzle is used for cleaning washable wall and floor coverings e.g. stone floors, tiles and PVC floors.

ATTENTION

Damage due to steam effects

Heat and moisture can lead to damage. Check the heat resistance and steam effect on an inconspicuous area using a minimal steam volume prior to use.

Note

Detergent residue or care emulsions on the surface to be cleaned can lead to streaks during steam cleaning, which will disappear however once these have been used several times. We recommend sweeping the floor or vacuum cleaning it before using the device. In this way the floor will be cleared of dirt and loose particles before the wet cleaning commences.

Work slowly on surfaces that are heavily soiled so that the steam has longer to take effect.

1. Connect extension tubes with the steam gun.

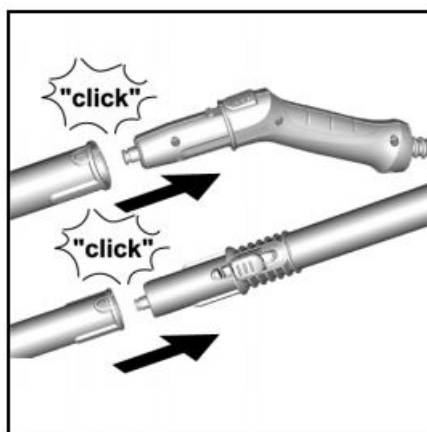

2. Push floor nozzle onto extension tube.

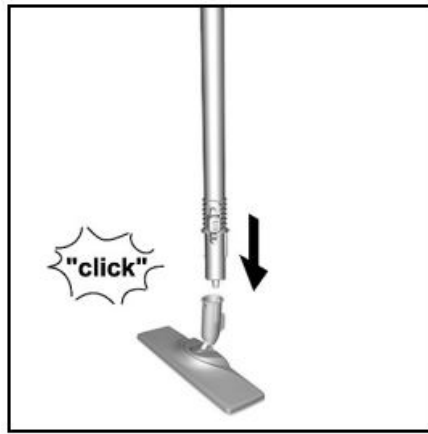

3. Attach floor cleaning cloth to floor nozzle.

- a Place the floor cleaning cloth with the hook and loop fastener pointing upwards on the floor.
- b Place the floor nozzle onto the floor cleaning cloth, applying slight pressure.

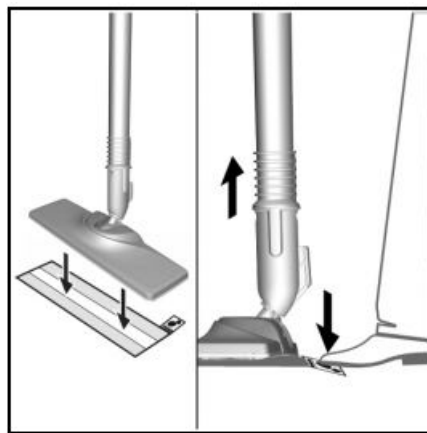

The floor cleaning cloth will stick to the floor nozzle of its own accord due to the hook and loop fastener.

Removing the floor cleaning cloth

- 1. Place one foot on the bottom corner of the floor cleaning cloth and lift the floor nozzle up.

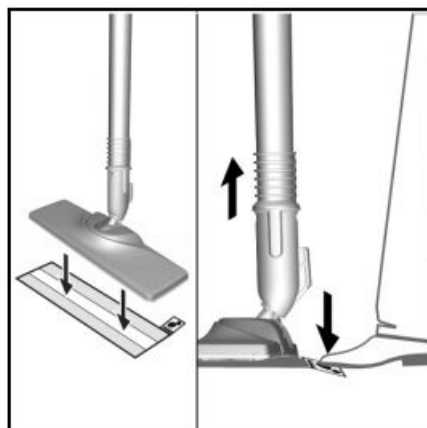

Note

Initially, the floor cleaning cloth's hook and loop fastener strip is very strong and cannot be removed from the floor nozzle easily. After the floor cleaning cloth has been used several times and washed, it is easier to remove from the floor nozzle and it has reached the optimum adhesion.

Parking the floor nozzle

- 1. Hang the floor nozzle in the park bracket during breaks in work.

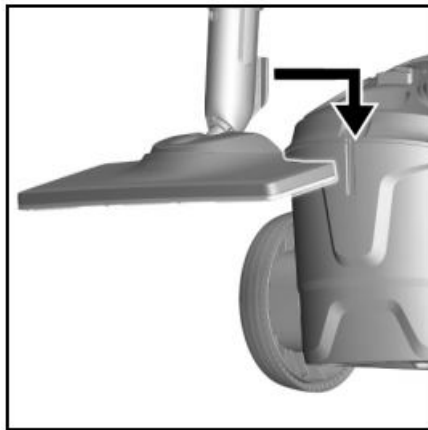

Care and service

Draining the water reservoir

ATTENTION

Device damage due to water putrefaction If the device is not put into operation for more than 2 months, the water in the tank may putrefy. Drain the water reservoir before breaks in operation.

1. Press the OFF switch. The device is switched off.
2. Pull the mains plug out of the outlet.
3. Remove the accessory/accessories from the accessory holders.
4. Remove the decalcification cartridge from the device.
5. Drain the water reservoir.

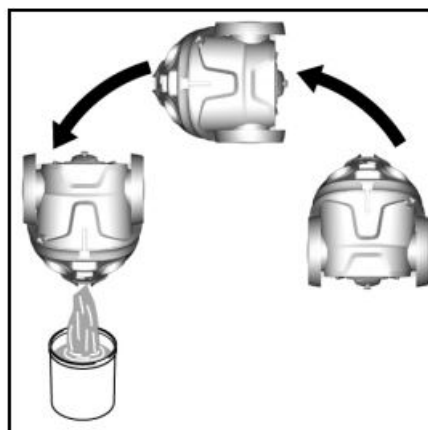

Replacing the decalcification cartridge

ATTENTION

Device damage and shortened service life If the replacement intervals (indicator light) for the decalcification cartridge are not observed, there is a risk of device damage and the service life of the device may be shortened. Observe the replacement intervals (indicator light).

Note

The replacement intervals depends on the local water hardness. Areas with hard water (e.g. III/IV) have a higher replacement interval than areas with soft water (e.g. I/II).

Indicator lamp at end of the run time

The “decalcification cartridge indicator light” indicates when the decalcification cartridge has to be replaced:

- The indicator light flashes 2 hours before the run time expires.

- The indicator light flashes more quickly 1 hour before the run time expires.
- Once the run time for the decalcification cartridge has expired, the indicator light lights up constantly and the device switches off automatically in order to prevent device damage.

Inserting the decalcification cartridge

ATTENTION

Device damage

There is a risk of damage to the device if the used decalcification cartridge is re-used. Work carefully in order to prevent mixing up the cartridges.

Note

When steaming for the first time after removing and reinserting the decalcification cartridge, the steam jet may be weak or irregular, and individual drops of water may be expelled. The device requires a short running-in period during which the decalcification cartridge fills with water. The steam volume that is expelled increases constantly until the maximum steam volume has been reached after approx. 60 seconds.

1. Press the OFF switch. The device is switched off.
2. Remove the decalcification cartridge.
3. Insert the new decalcification cartridge.
4. Press the On switch. The device is switched on.
5. Press and hold the RESET button for 4 seconds. The “replace decalcification cartridge” indicator light goes out and the run time for the decalcification cartridge starts again.
6. Allow the device to heat up. 7. Press and hold the steam lever for approximately 60 seconds to vent the decalcification cartridge.

Note

After the cartridge is inserted for the first time or has been replaced, it takes about 60 seconds for a good steam image result.

Setting the water hardness

ATTENTION

Device damage due to calcification Without a decalcification cartridge, the device may calcify if the water hardness is set incorrectly. Always work with a decalcification cartridge. Set the device to the local water hardness. Set the device to the current water hardness before using it in an area with a different water hardness (e.g. after a move).

Note

Your water board or municipal utilities authority can provide information on hardness of tap water. The water hardness is set using the RESET button. The water hardness setting is stored until a new setting (e.g. after a move) is made. The device is set to the highest water hardness (level IV) in the factory. The device indicates the set water hardness with flash pulses.

Water hardness levels and flash pulses

Hardness range		°dH	mmol/l	Number of flash pulses	Interval between flash pulses
I	Soft	0-7	0-1.3	1x	4 seconds
II	Medium	7-14	1.3-2.5	2x	
III	Hard	14-21	2.5-3.8	3x	
IV	Very hard	>21	>3.8	4x	

Note

The anti-calcification effect of the decalcification cartridge is activated as soon as the device is filled with water and put into operation. Lime in the water is absorbed by the granulate in the decalcification cartridge. Additional decalcification is not required.

Note

The granulate in the cartridge can discolor on contact with water due to the mineral content in the water, which is no cause for concern and has no negative effects on the device, cleaning work or the functionality of the cartridge.

Note

Do not pause for longer than 15 seconds when setting as the device will otherwise be set automatically to the last selected water hardness or the highest water hardness set during initial start-up.

1. Connect the mains plug.
2. Make sure that the device is switched off.
3. Press the RESET button and hold it while switching on the device. After approximately 2 seconds, the indicator light flashes and signals the current water hardness setting with the number of pulses.

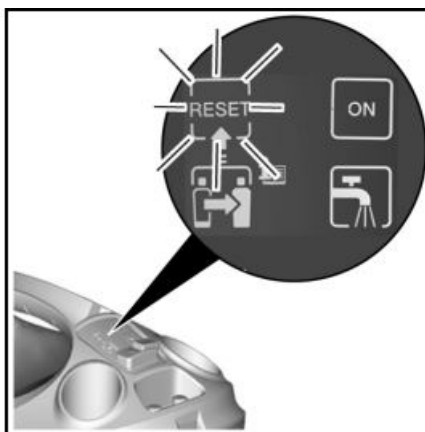

4. Press the RESET button repeatedly to change the water hardness level.

Note

When the RESET button is pressed, the flash pulse for the water hardness level is not indicated.

5. Release the RESET button. The flash pulse for the set water hardness is indicated.
6. Repeat the procedure as necessary until the desired water hardness level has been achieved.
7. Press and hold the RESET button for 3 seconds to save the setting for the water hardness level. The indicator light for the water hardness lights up.

Care of accessories

(Accessories – depending on scope of delivery)

Note

The microfiber cloths are not suitable for dryer.

Note

When washing the cloths, observe the notes on the washing tag. Do not use any liquid softeners as this will affect the ability of the cloths to pick up dirt.

1. Wash the floor cleaning cloths and covers at a max. temperature of 140° F (60° C) in the washing machine.

Troubleshooting guide

Malfunctions often have simple causes that you can remedy yourself using the following overview. When in doubt, or in the case of malfunctions not mentioned here, please contact your authorized Customer Service.

WARNING

Risk of electric shock and burns Trying to eliminate faults while the device is connected to the mains or has not yet cooled down is always dangerous. Remove the mains plug. Allow the device to cool down. The water shortage indicator light flashes red The dry running protection for the pump is deactivated.

1. Switch the device off and back on again.
2. Make sure that the decalcification cartridge has been inserted correctly and there is sufficient water in the tank.

The water shortage indicator light lights up constantly in red No water in the water reservoir.

1. Refill the water reservoir, see chapter Refilling water.

The steam lever cannot be pressed The steam lever is locked with the child lock.

- Set the child lock (selector switch for steam volume) to the front. The steam lever is released.

No steam / little steam despite sufficient water in the tank

The decalcification cartridge has not been inserted or has been inserted incorrectly.

- Insert the decalcification cartridge or insert it correctly. The decalcification cartridge has been removed while topping up the water.
- Leave the decalcification cartridge in the device when topping off. New decalcification cartridge has been inserted. Press and hold the steam lever constantly. The full steam output is reached after approximately 60 seconds.

Red indicator light “replace decalcification cartridge” lights up / flashes Run time of the decalcification cartridge ends soon.

- Insert the new decalcification cartridge and reset the maintenance indicator, see chapter Replacing the decalcification cartridge. The RESET button was not pressed after replacement of the decalcification cartridge.
- Press and hold the RESET button for 4 seconds after inserting the decalcification cartridge, see chapter Replacing the decalcification cartridge.

Device switches off automatically

Run time for the decalcification cartridge has expired

- Insert the new decalcification cartridge and reset the maintenance indicator, see chapter Replacing the decalcification cartridge. The RESET button was not pressed after replacement of the decalcification cartridge.
- Press and hold the RESET button for 4 seconds after inserting the decalcification cartridge, see chapter Replacing the decalcification cartridge.

Documents / Resources

 <p>KÄRCHER Handy-Druckersprayer</p> <p>SC 3 EasyFix</p> <p>Handy-Druckersprayer 2000 PSI 1.8 l/min</p> <p>2000 PSI 1.8 l/min</p>	<p><u>KÄRCHER SC 3 EasyFix</u> [pdf] User Manual KÄRCHER, SC 3 EasyFix</p>
--	---

References

- [Home | Kärcher Canada](#)
- [Cleaning Equipment for Home & Industrial Applications | Kärcher](#)
- [Support : Karcher US Online Support](#)
- [Home Garden Warranty Registration Karcher North America USA | Kärcher](#)