



Kanlux HLDR-GX5.3 Light Source Fitting Instruction Manual

[Home](#) » [Kanlux](#) » Kanlux HLDR-GX5.3 Light Source Fitting Instruction Manual 

Kanlux

ELICEO/ ELICEO-ST

2022/03-1

A3-297x420mm/ISO216

Instruction Manual

Contents

- [1 HLDR-GX5.3 Light Source Fitting](#)
- [2 INTENDED USE / APPLICATION](#)
- [3 FUNCTIONAL CHARACTERISTICS](#)
- [4 USAGE GUIDELINES / MAINTENANCE](#)
- [5 EXPLANATIONS OF SYMBOLS USED](#)
- [6 ENVIRONMENTAL PROTECTION](#)
- [7 COMMENTS / GUIDELINES](#)
- [8 Documents / Resources](#)
 - [8.1 References](#)
- [9 Related Posts](#)

HLDR-GX5.3 Light Source Fitting

light source becomes heated to a high temperature. Product may heat up to a higher temperature. Do not cover the product. Place all the leads and elements mating with the fixture ensuring no contact with the parts of the lighting system that become heated. Adjustment of lighting direction and/or replacement of the light source must be done when the product has cooled down. Replacement of light source to be performed after the product cools down: see pictures. Product must not be used in unfavourable environment, e.g. dust, moisture, water, vibrations, etc. The inspection of all connections and elements of the lighting system is recommended.

EXPLANATIONS OF SYMBOLS USED

P1: Rated voltage.

P2: Maximum power of the light source.

P3: LED lamp.

P4: Base/holder.

P5: Product meets the requirements of EU directives.

P6: The product not suitable for covering with heat-insulating material.

P7: Class III A product in which protection against electric shock is provided by feeding it with very low safe voltage (SELV) with no risk of creating higher than safe voltage.

P8: Use only indoors.

P9: Protection against solid foreign objects bigger than 12mm provided.

P10: The symbol describes the minimal distance of a light fixture (its light source) from the spots and objects that it's illuminating.

P11: Class II. A product in which protection against electric shock is provided not only through basic insulation, but also double or reinforced insulation.

P12: The product is compliant with all relevant United Kingdom regulations.

P13: The product meets the requirements of technical regulations applicable in Ukraine.

ENVIRONMENTAL PROTECTION

Keep your environment clean. Segregation of post-packaging waste is recommended.

COMMENTS / GUIDELINES

Failure to follow these instructions may result in e.g. fire, burns, electrical shock, physical injury and other material and non-material damage. For more information about Kanlux products visit www.kanlux.com. Kanlux S.A. shall not be responsible for any damage resulting from the failure to follow these instructions. Kanlux SA reserves the right to make changes in the manual- the current version can be downloaded at www.kanlux.com.

ELICEO

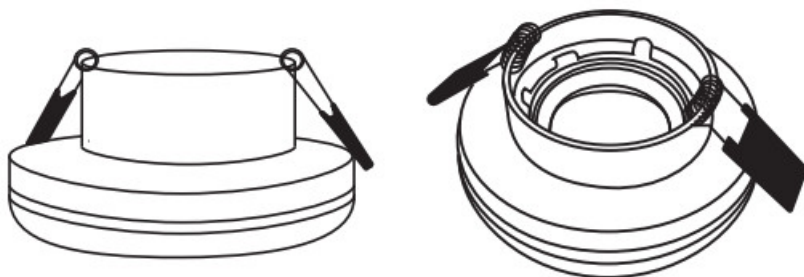

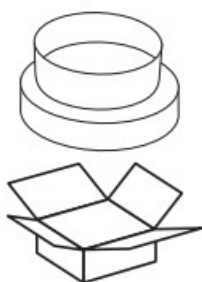
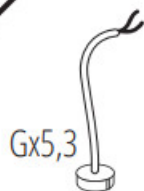
**12V****220-240V~****1/2****ELICEO****2/2**

GX5,3

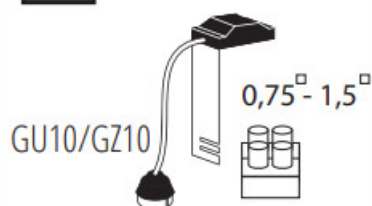
**HLDR-GX5.3****Index:**
72109**2/2**

GU10/GZ10

0,75[□] - 1,5[□]**BR-GZ10****Index:**
72369**ELICEO**

[mm] Ø68

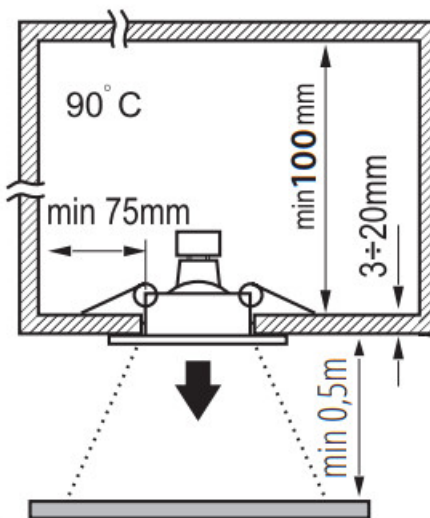
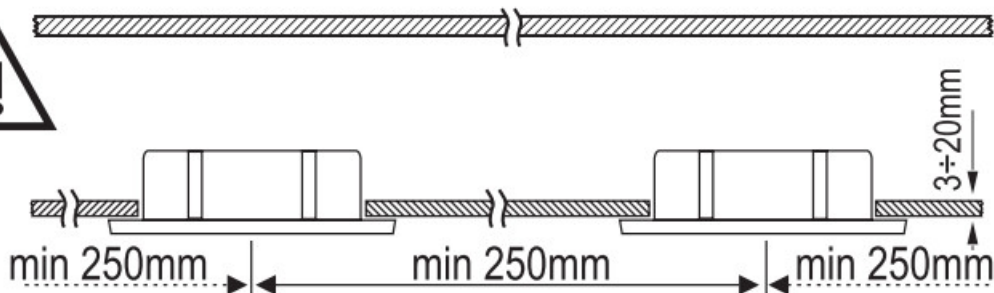
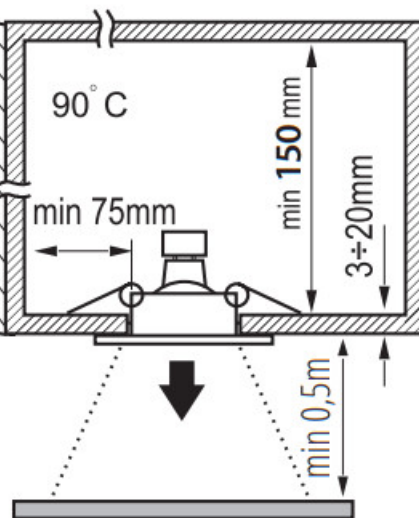
**12V****220-240V~****12V****Gx5,3****MR16 LED**



IP20



=



+



2/2

HLDR-GX5.3

Index:

72109

220-240V~

GU10/GZ10

PAR16 LED

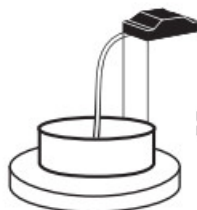

=



+



2/2

BR-GZ10

Index:

72369



GX5.3
220-240V~

EN Note: Do not use

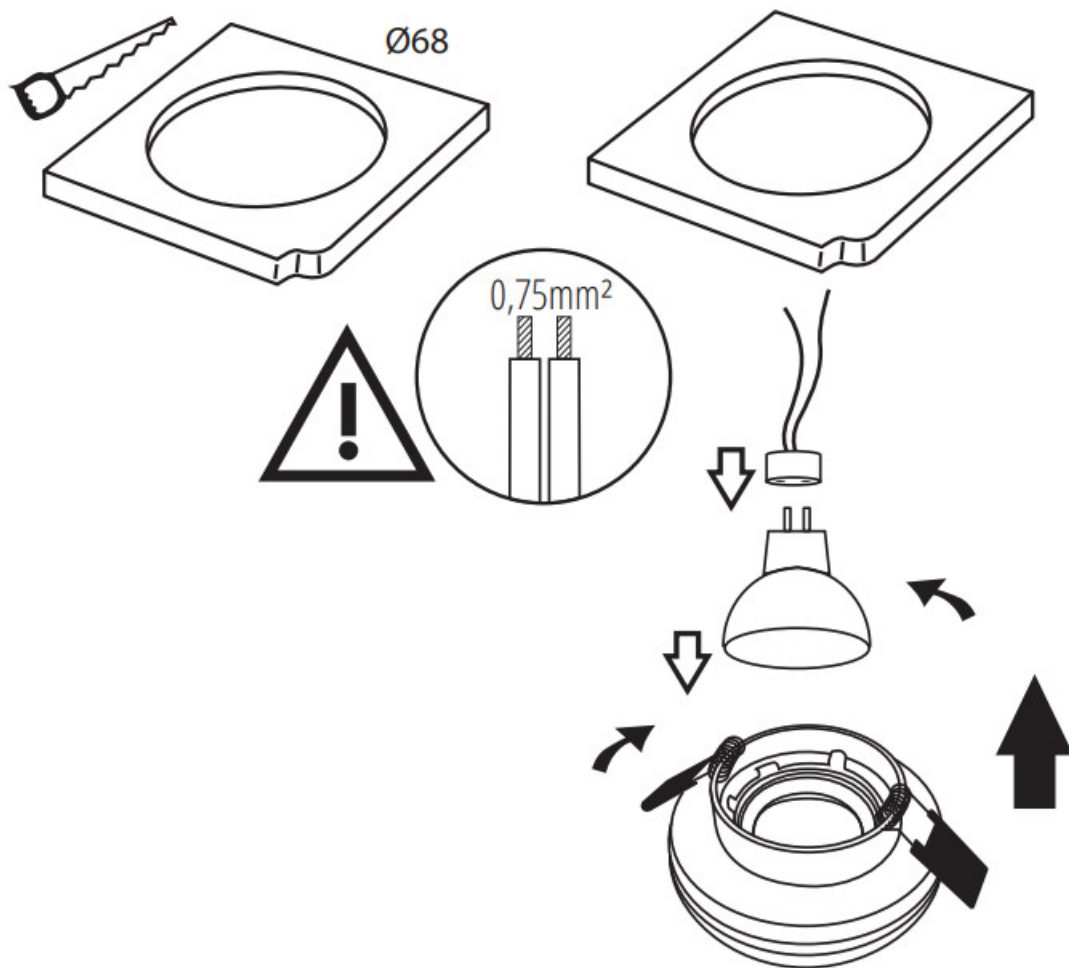

12V, HLDR-GX5.3

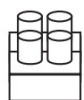
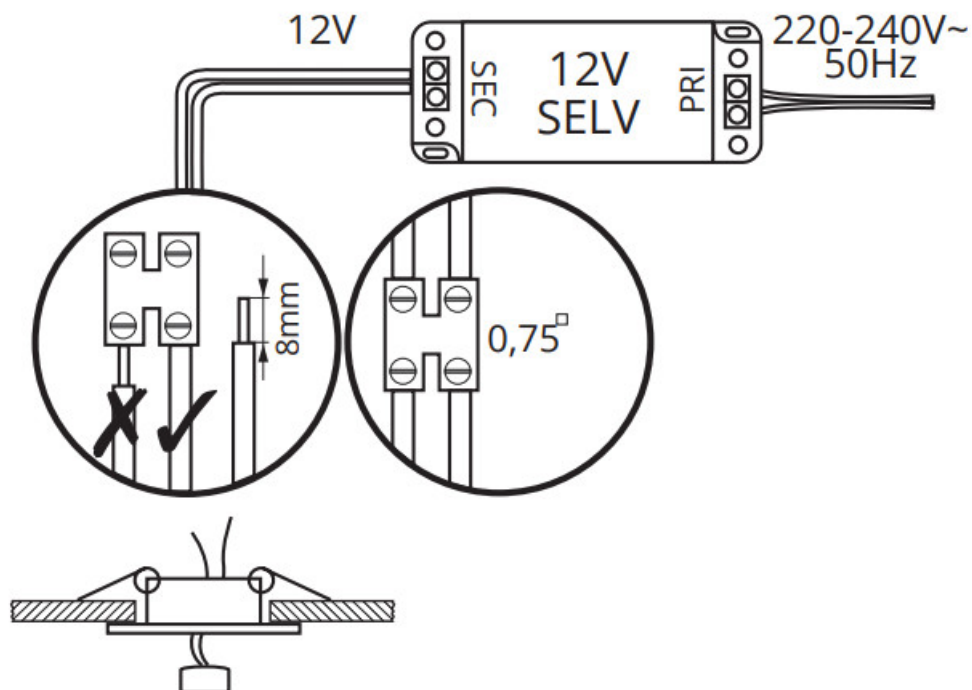

Not included

12V, HLDR-GX5.3 SC-1 [25590]

Using a light source with a power of less than 10W, we recommend using SC shields (available from Kanlux)-index: 25590.

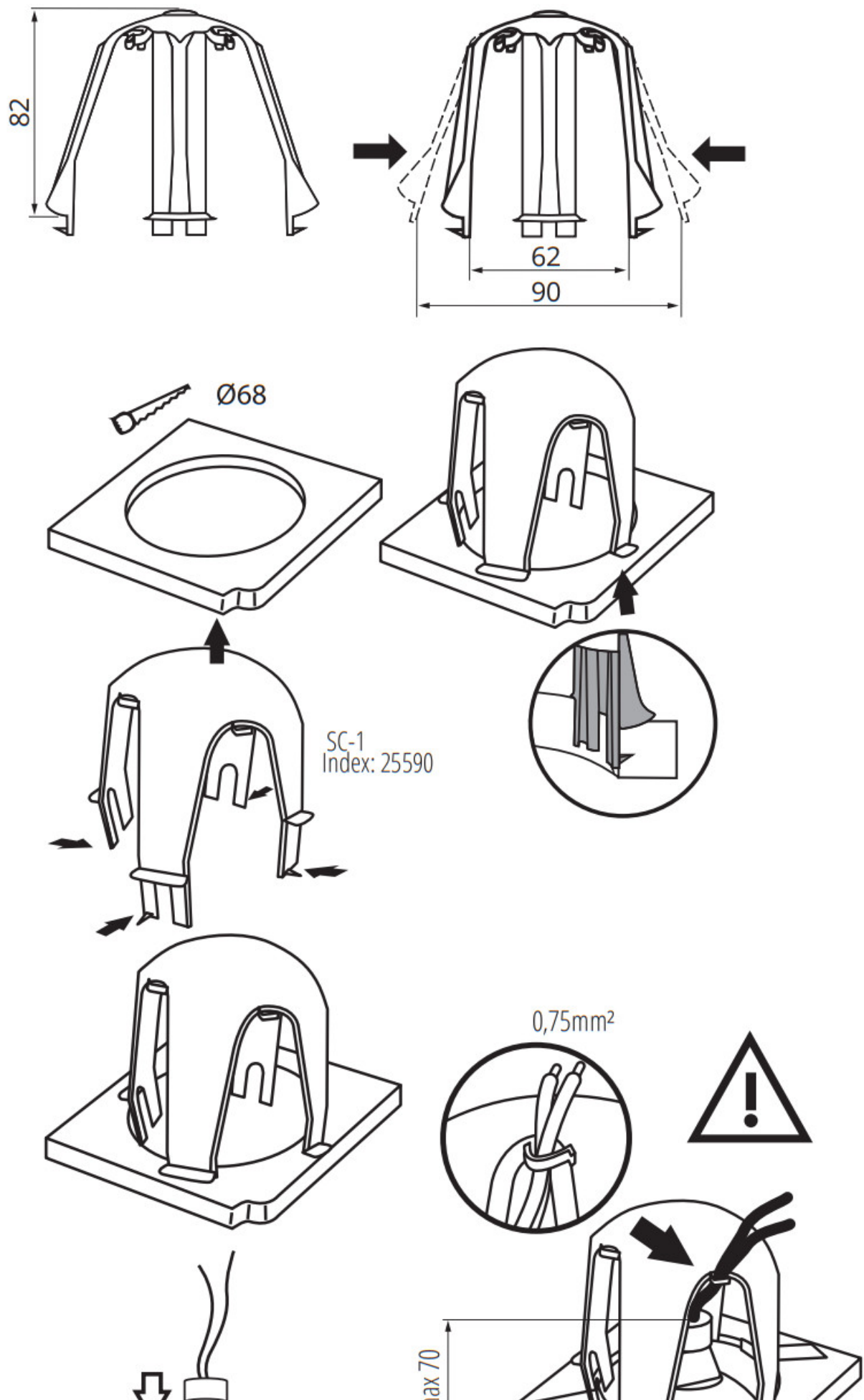

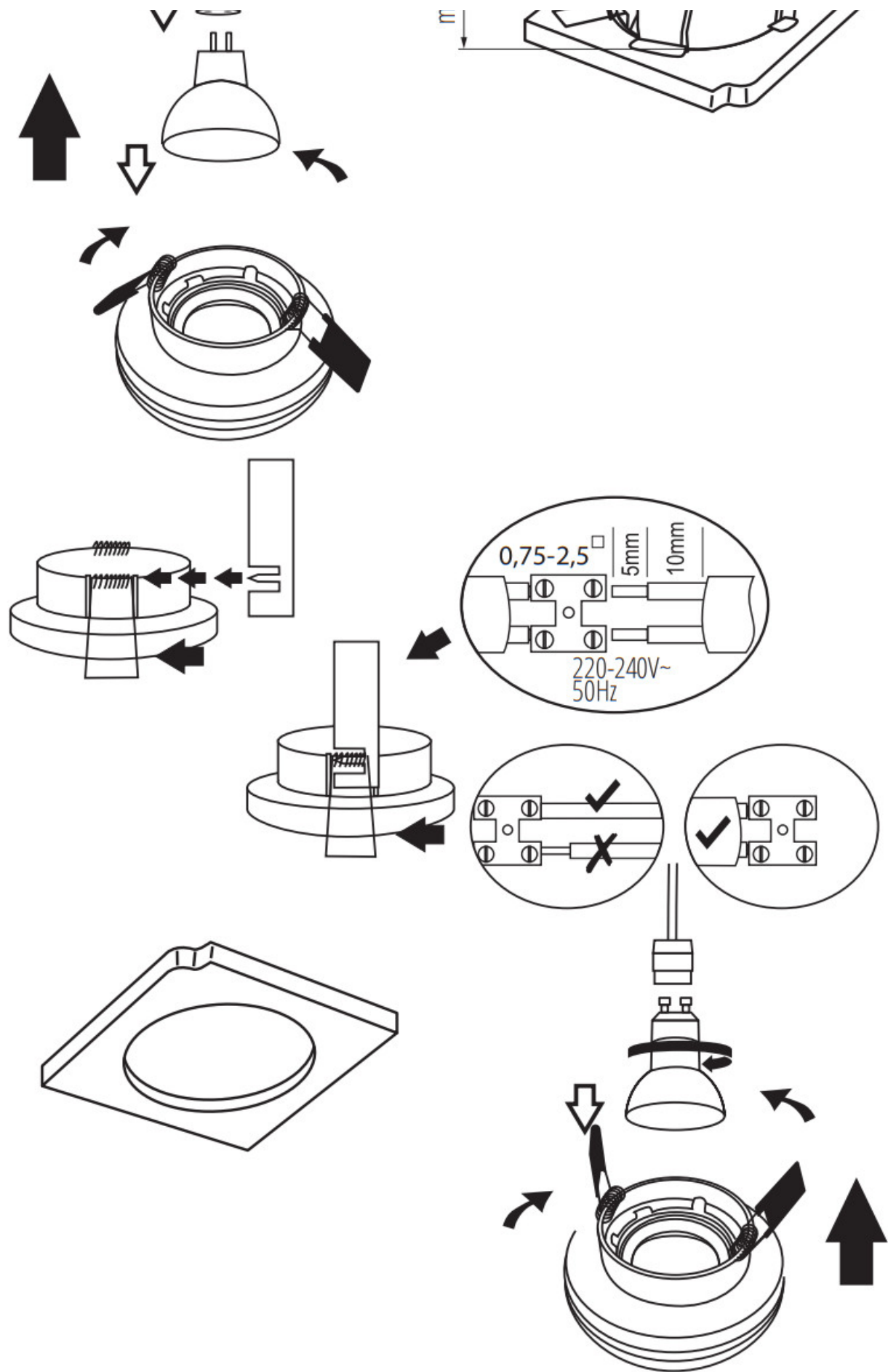

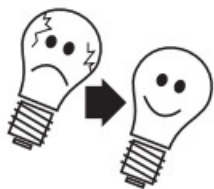

12V, HLDR-GX5.3

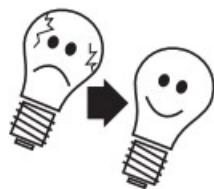
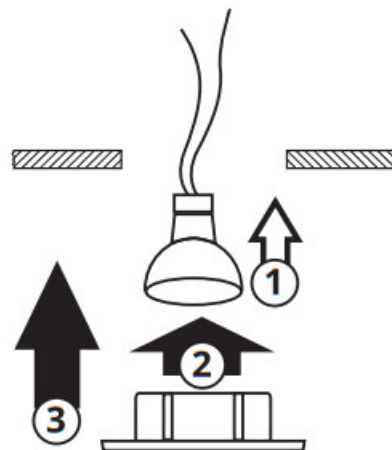
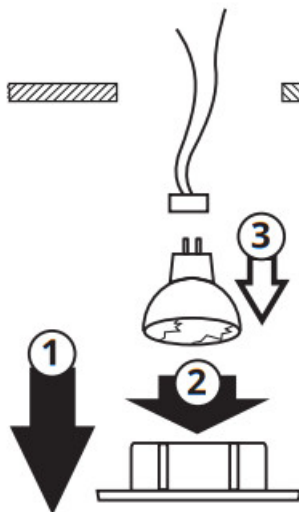

220-240V~, BR-GZ10

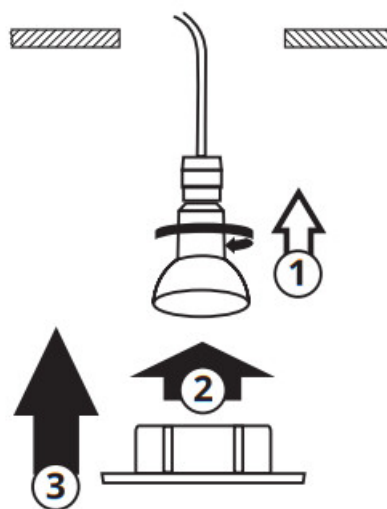
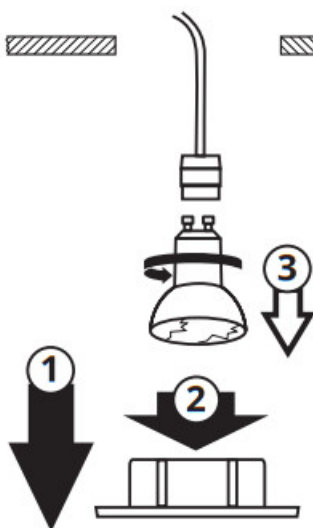

www.kanlux.com



[Kanlux HLDR-GX5.3 Light Source Fitting](#) [pdf] Instruction Manual
HLDR-GX5.3 Light Source Fitting, HLDR-GX5.3, Light Source Fitting, Source Fitting, Fitting

References

- [✕ Kanlux - więcej niż światło. - Kanlux](#)