

KandM 18880 Keyboard Base Table Instructions

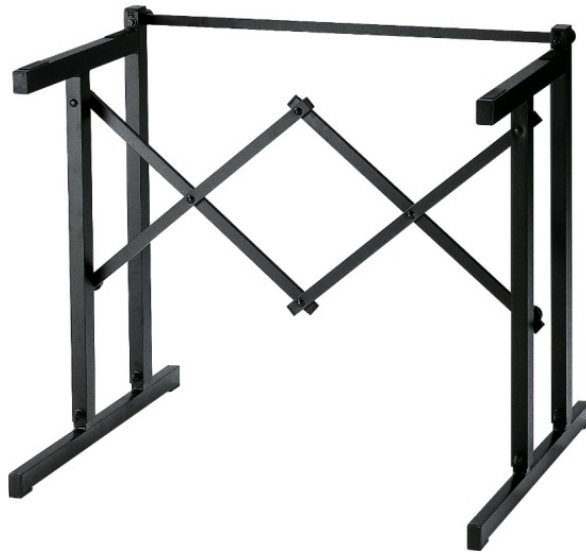

Contents [[hide](#)]

[1 Instruction For Use](#)

[2 Important Information:](#)

[3 Documents / Resources](#)

[3.1 References](#)

Instruction For Use

Warning:

Mount the side parts **7** at the same height -keyboard needs to be fully horizontal.
Tighten all screws securely.

How to Set Up:

Pull the side parts **7** apart as far as they go and secure them with the locking screw **8**.
Use the bolts **9** (M6 x 50 mm), washers **10** and locking nuts **11** to fasten the connecting brace **12** to the top of the side parts (**Fig. A**) and tighten it (**Fig. B**).

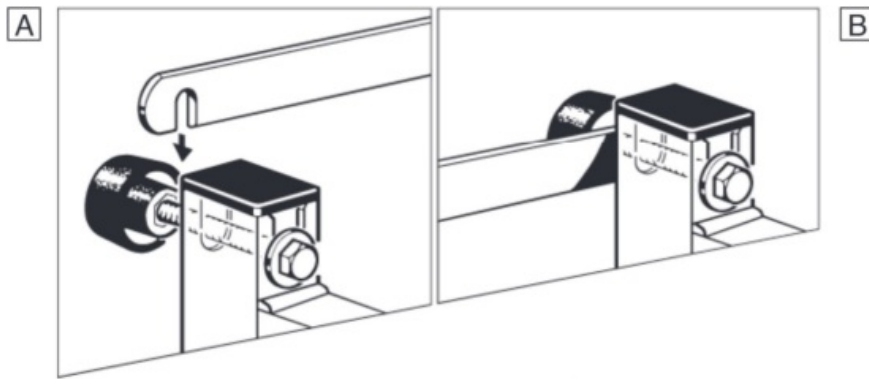

Press in the plastic end caps **13** and stick the rubber pads **14** onto the support arms.

Height-adjustment (12-way):

Remove end caps **2** and loosen locking parts (nuts **3**, washers **4**, bolts **5**, **6**). For the desired height insert the **4** bolts **5**, **6** in the same hole on each base part **1**.

Attention: Insert the hexagon bolts in the round holes, the square neck carriage bolts in the square holes.

Stick the side parts **7** onto the base parts **1** until they hit the bolts (**Fig. C**) and tighten with washers **4** and nuts **3**. Press in the end caps **2**.



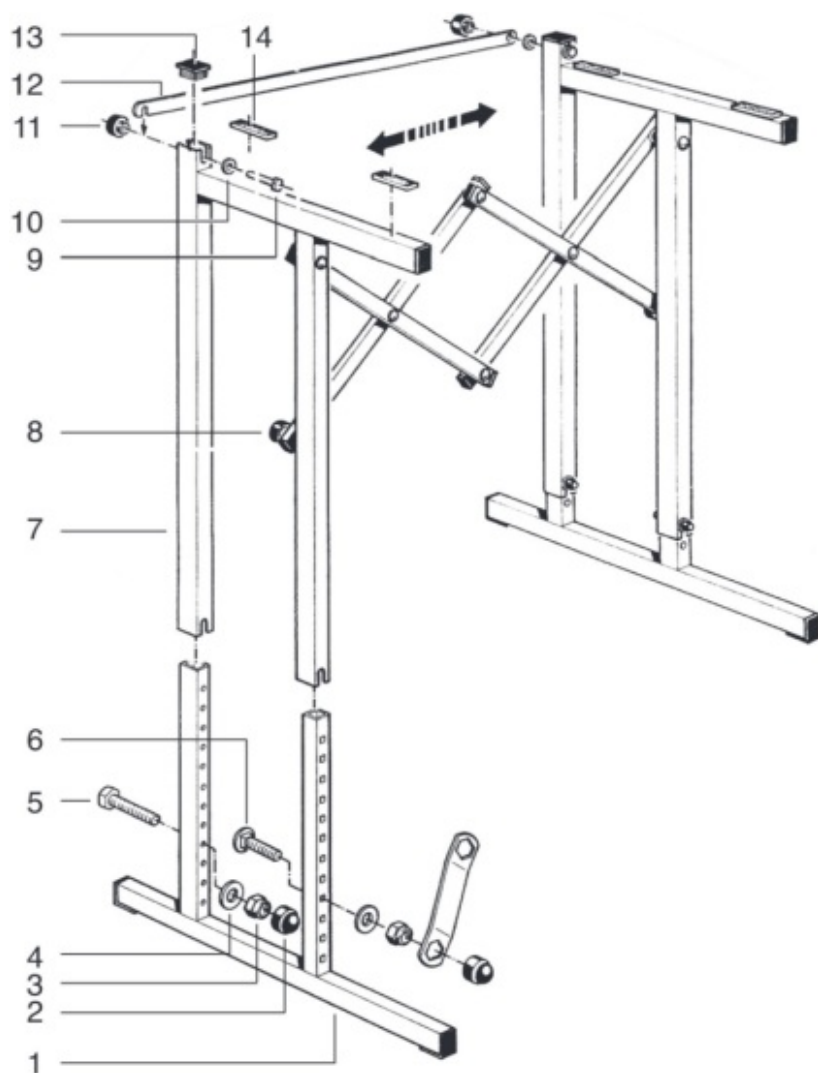

To fold up the stand:

Loosen the locking nuts **11**, fold out the connecting brace **12** and re tighten the locking nuts **11**. Loosen the locking screw **8** and push the side parts **7** together. Secure with the locking screw **8**.

Important Information:

If you place the stand inside your house, it may be advisable to put a non-sliding pad under the stand's rubber end caps as they could leave marks on sensitive floors, for example parquet flooring.

KÖNIG & MEYER GmbH & Co. KG

Kiesweg 2, 97877 Wertheim, www.k-m.de

18880-000-55 Rev.01 9/19



Documents / Resources

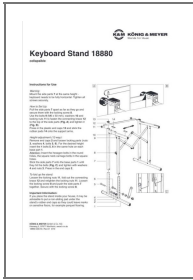

[KandM 18880 Keyboard Base Table \[pdf\]](#) Instructions

18880 Keyboard Base Table, 18880, Keyboard Base Table, Base Table

References

- [User Manual](#)

18880, 18880 Keyboard Base Table, Base Table, KandM, Keyboard Base

KandM Table

Leave a comment

Your email address will not be published. Required fields are marked *

Comment *

Name

Email

Website

☐ Save my name, email, and website in this browser for the next time I comment.

Post Comment

Search:

e.g. whirlpool wrf535swhz

Search

[Manuals+](#) | [Upload](#) | [Deep Search](#) | [Privacy Policy](#) | [@manuals.plus](#) | [YouTube](#)

This website is an independent publication and is neither affiliated with nor endorsed by any of the trademark owners. The "Bluetooth®" word mark and logos are registered trademarks owned by Bluetooth SIG, Inc. The "Wi-Fi®" word mark and logos are registered trademarks owned by the Wi-Fi Alliance. Any use of these marks on this website does not imply any affiliation with or endorsement.