



KANDAO QooCam 3 360 Degree Action Camera User Manual

[Home](#) » [KANDAO](#) » KANDAO QooCam 3 360 Degree Action Camera User Manual 

QooCam 3 KANDAO

Quaca 3 360 Degree Action Camera
User Manual

Contents

- 1 QooCam 3 360 Degree Action Camera
- 2 Product Profile
- 3 Preparations before Use
- 4 Charging
- 5 Update Camera's Firmware
- 6 Operations
- 7 Basic Operations
- 8 Start Photography
- 9 Image Parameters
- 10 Connect to the QooCam 3 App
- 11 File Transfer
- 12 Maintenance
- 13 Battery Information
- 14 Tech Specifications
- 15 Documents / Resources
 - 15.1 References

QooCam 3 360 Degree Action Camera

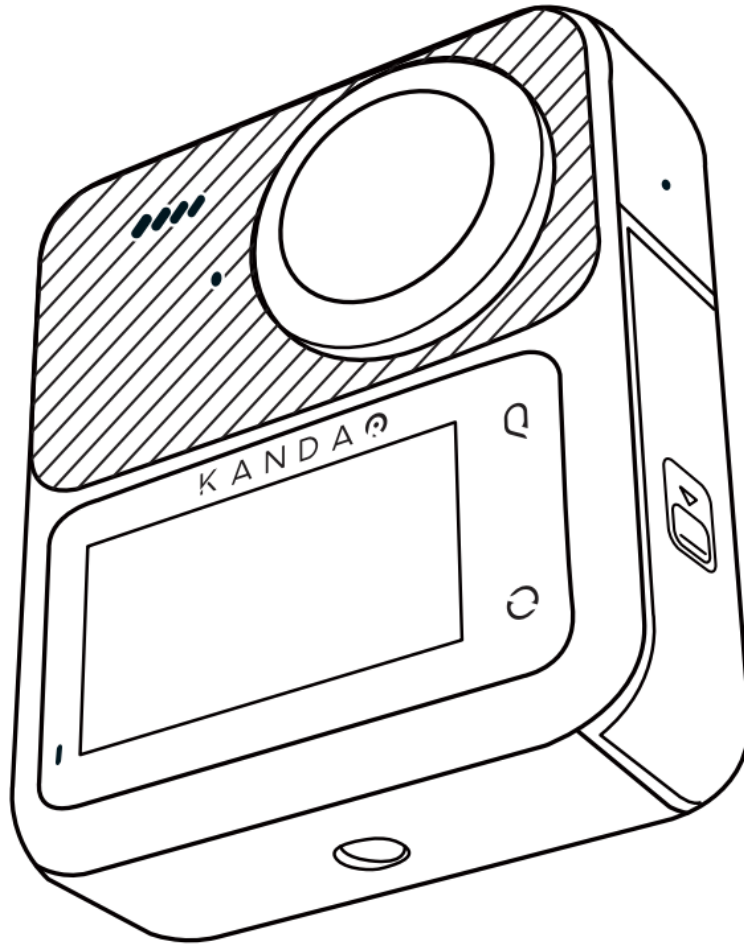

Reading Tips

Read before First Use

Please read the following document carefully for full understanding and reasonable and safe usage of the QooCam 3:

1. QooCam 3 User Manual
2. Safety Guidelines
3. Quick Start Guide of QooCam 3

Please read the Quick Start Guide of QooCam 3 and QooCam 3 User Manual carefully, and watch the tutorial videos on the QooCam 3 Product Page on KanDao's official website. Please read the Safety Guidelines carefully to learn about your legal rights and responsibilities.

Download QooCam 3 App

To use this product, you will need to download and install the QooCam 3 App.

Please search "QooCam 3" in the App store on your mobile device or scan the following QR code to install the App.



<https://www.kandaovr.com/download/?from=code#download-qoocam-2022>

Note: The QooCam 3 App supports iOS 13.0 or above, or Android 8.0 or above versions.

Product Profile

About the Camera

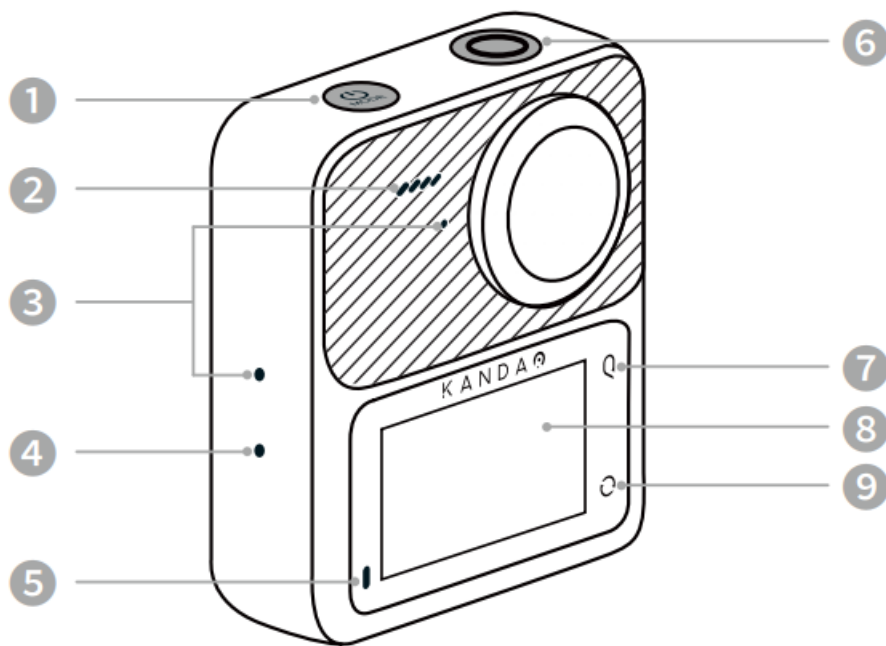

1. Power Button
2. Speaker
3. Pickup Hole*
4. Air Pressure Balancing Hole
5. Status Indicator
6. Shutter Button
7. Q Function Button
8. Touch Screen
9. Lens Switch Button

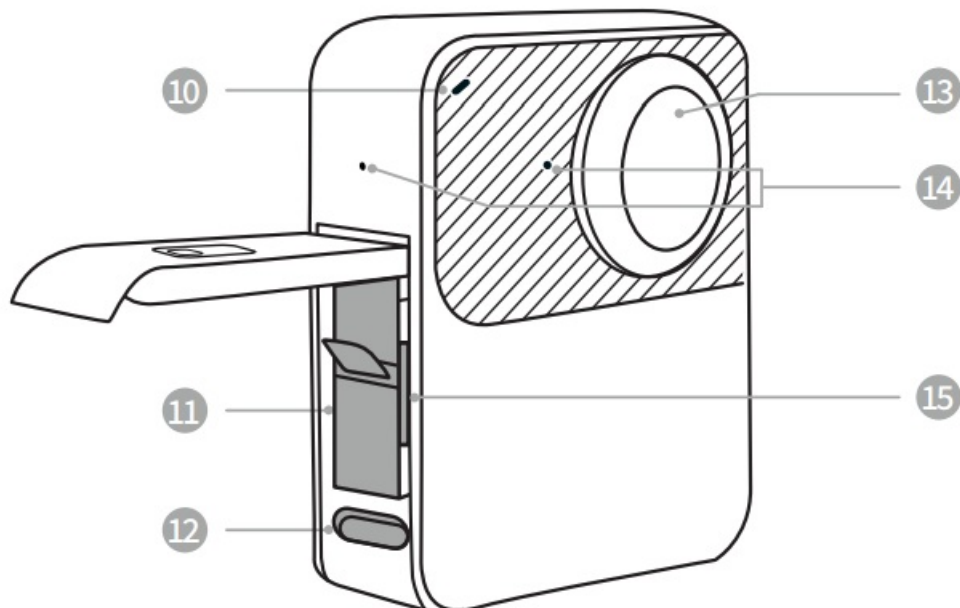

10. Status Indicator
11. Battery
12. USB-C port

- 13. Lens
- 14. Pickup Hole*
- 15. MicroSD Card Slot

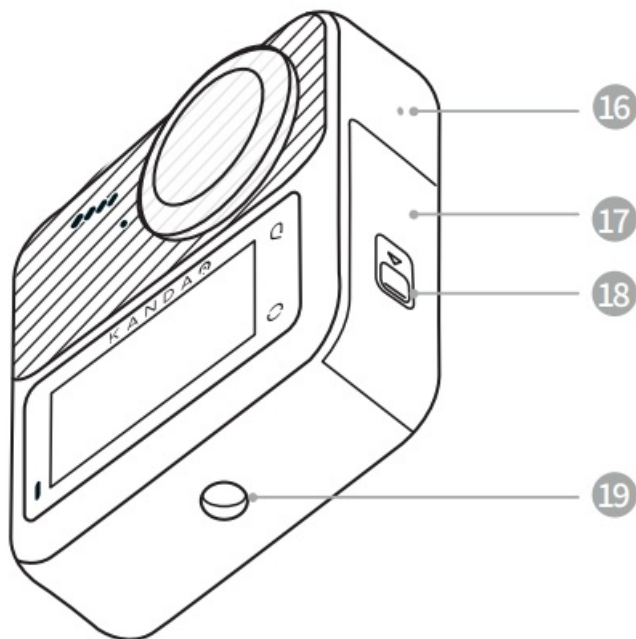

- 16. Pickup Hole*
- 17. Battery Cover
- 18. Latch of Battery Cover
- 19. 1/4 Screw hole

*Please avoid obstructing the sound pickup hole of the camera during video recording as it may impact the pickup quality.

Preparations before Use

MicroSD Card

You'll need to prepare a microSD card for saving videos and photos. The microSD card must meet the following requirements:

- 1. Has a speed level of UHS-I V30 or higher
- 2. Support a maximum capacity of 256 GB
- 3. File system: exFAT

For the list of recommended microSD cards, please visit https://www.kandaovr.com/support/detail/?form=goocam-3#support_detail_faq

Note:

- 1. Please keep your hands clean and dry when handling the microSD card and do not touch its metal part. If there is any dust or dirt on the microSD card or camera, you can use a soft cloth or eraser to wipe it. Avoid using chemical or liquid cleaners to prevent potential damage to the camera and microSD card.
- 2. Do not remove the microSD card when recording videos, taking photos or playing back, otherwise the file may be lost or the camera may be damaged.
- 3. Do not format the microSD card or modify the files when it is inserted into other devices. Before transferring

files to other devices, it is recommended to backup the files first to avoid file loss or damage.

4. The performance of the microSD card will gradually deteriorate over time and affect the camera's function of saving media files. If any problem occurs, please replace the card with a new one.
5. Regularly formatting the microSD card helps to keep the favorable status. However, formatting the microSD card will erase all files on the card, so please be sure to back up the files in advance.
6. If necessary, please refer to the manufacturer's guide of the microSD card for information on the acceptable temperature range and other details.

Install MicroSD Card and Battery

1. Hold the battery cover latch and push it outwards.

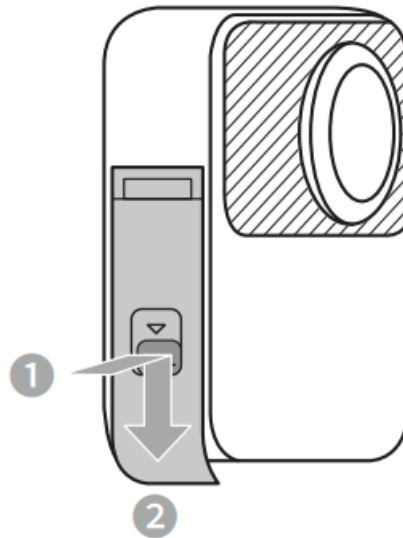

2. Install the microSD card.

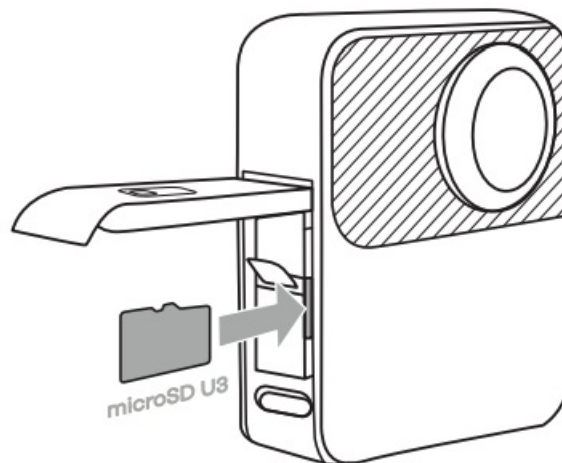

3. Insert the battery.

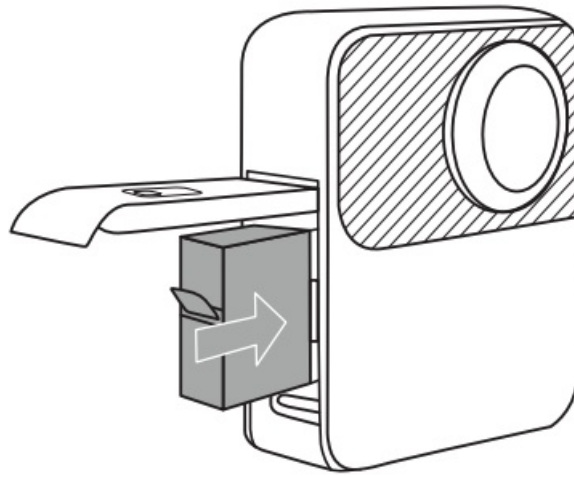

Charging

1. Charging the camera by connecting it to the USB charger (self-provided) with the included USB-C cable. When charging with the camera turned off, the status indicator light is solid red, and it will turn off once the camera is fully charged. It takes about 90 minutes to fully charge the camera*.

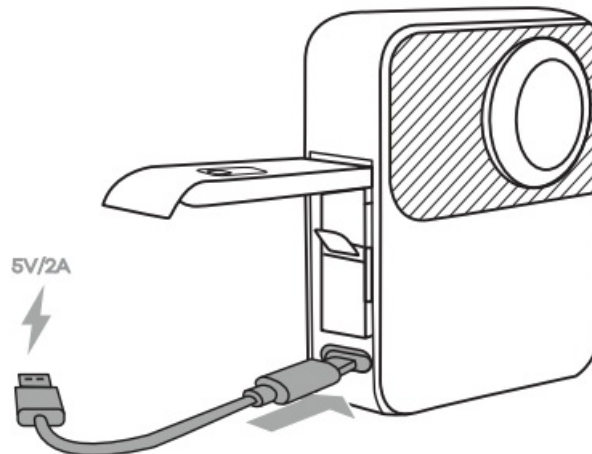

2. You may remove the battery cover for convenience when charging*.

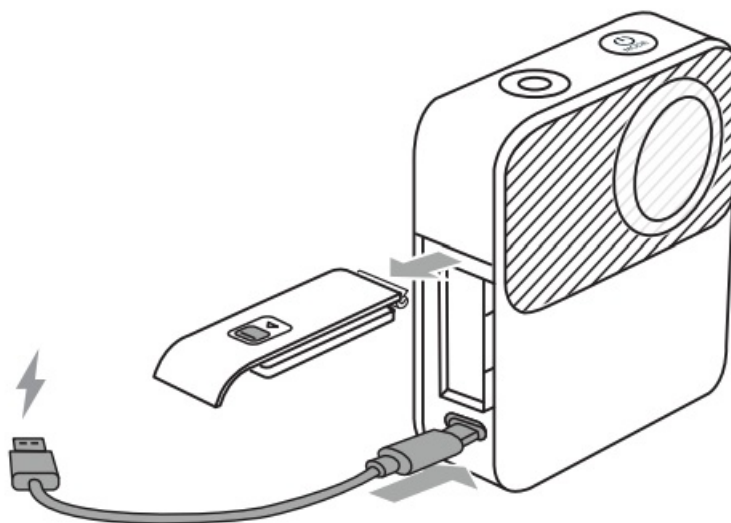

3. Once the charging is complete, please disconnect the charging cable and securely close the battery cover. Before using the camera, please make sure the latch of battery cover has been closed and locked.

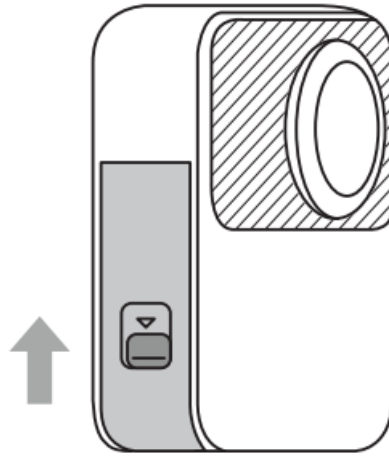

*It takes about 90 minutes to fully charge a power-off camera with a 5V/2A USB adapter under laboratory environment. The test result is for reference.

*Please do not use QooCam 3 when the battery cover is removed as the battery may slide out. Without the battery cover, the camera will lose its waterproof capability.

Update Camera's Firmware

To get the latest features and best performance from your QooCam 3, please make sure the camera is using the latest version of firmware.

Update with the QooCam 3 App

1. Download the QooCam 3 App from the App store on the mobile device.
2. Follow QooCam 3 App's instructions to connect the camera to your mobile device. If a new camera firmware is available, the QooCam 3 App will provide the installation guide for you.

Update with the MicroSD Card

1. Please visit https://www.kandaovr.com/support/detail/?form=qoocam-3#support_detail_download_software
2. Select the latest firmware of the QooCam 3, download the firmware to a microSD card.
3. Insert the microSD card into the camera and make sure the camera is turned off.
4. Power on the camera, the blue and green status indicator lights will flash alternately, indicating that the camera is being upgraded.
5. After the upgrade is complete, the camera will automatically restart .

Note:

1. Before upgrading, please make sure the battery level of the QooCam 3 is greater than 50%. You are recommended to use a fully charged battery for upgrading.
2. Please prepare a microSD card for upgrading.
3. If the upgrade fails, please contact the after-sales service team of KanDao's Technology via service@kandaovr.com.

Operations

Buttons

Power Button

Power on

Long press the power button for 2 s to turn on the camera.

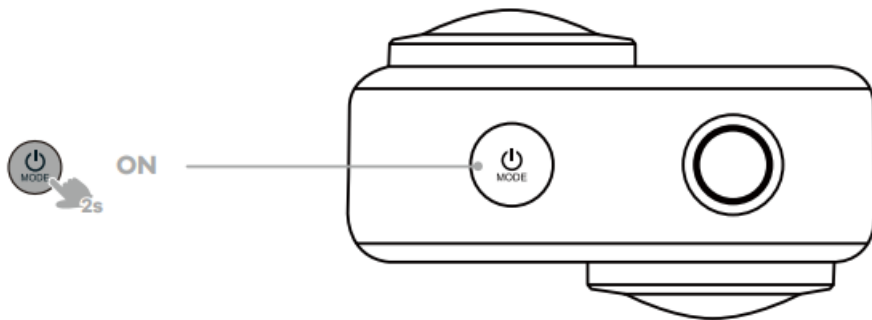

Power off

Long press the power button for 2 s to turn off the camera.

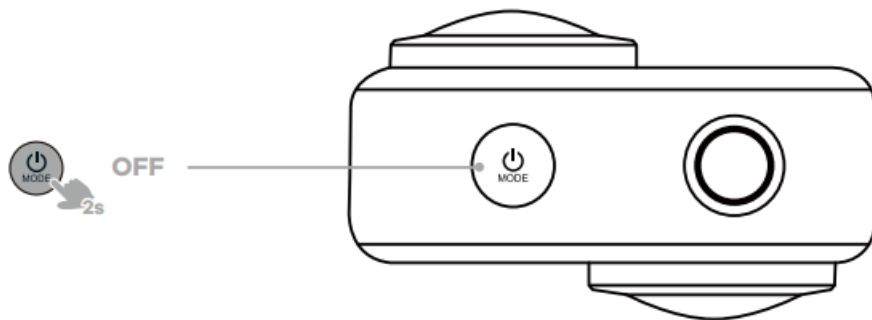

Switch Modes

In preview, you may shortly press the power button to switch shooting modes.

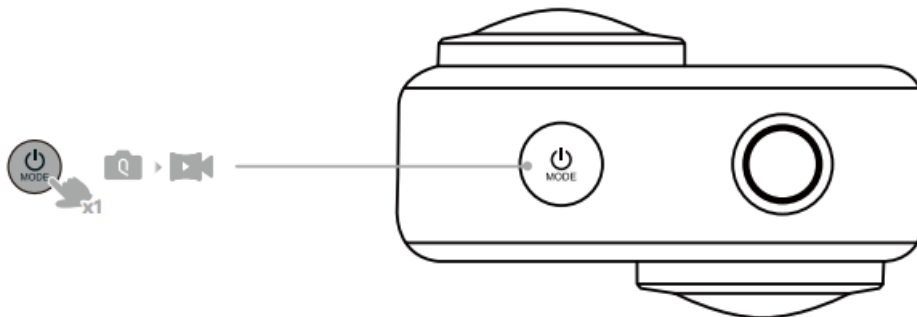

Q Function Button

When you press the [Q function button], the camera will execute the function that you have set in the system settings.

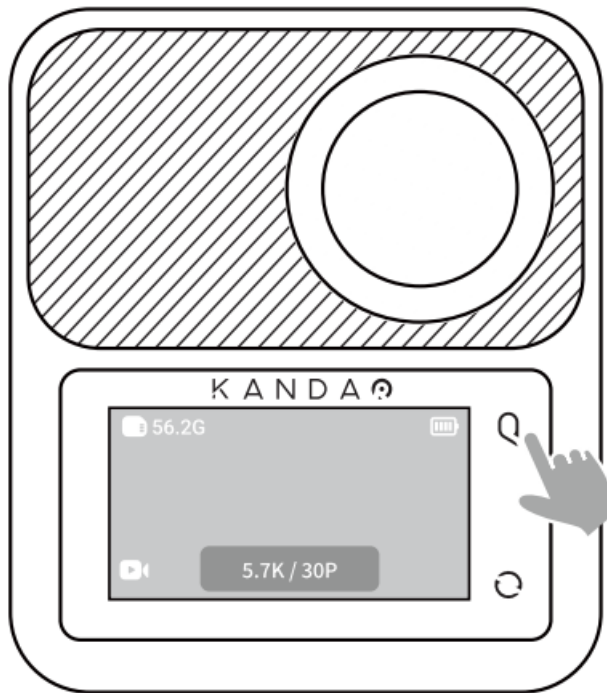

Note:

Open the [Dashboard] – [Settings] – [Q Function] to set a commonly used function to the Q button.

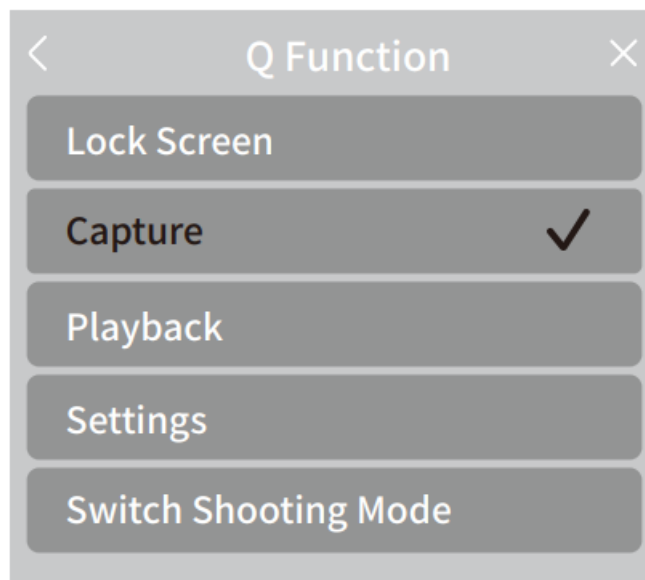

Shutter Button

In preview, you may shortly press the shutter button to take photos or start/stop the video recording.

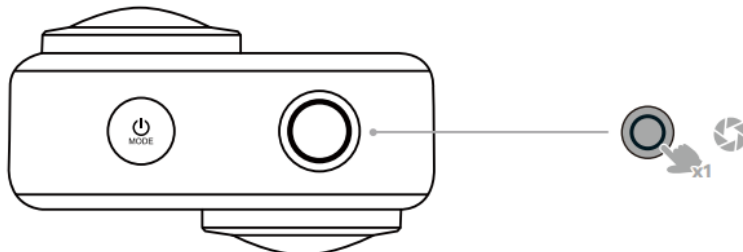

Lens Switch Button

Press the [Lens switch button] to switch the lens and display the preview.

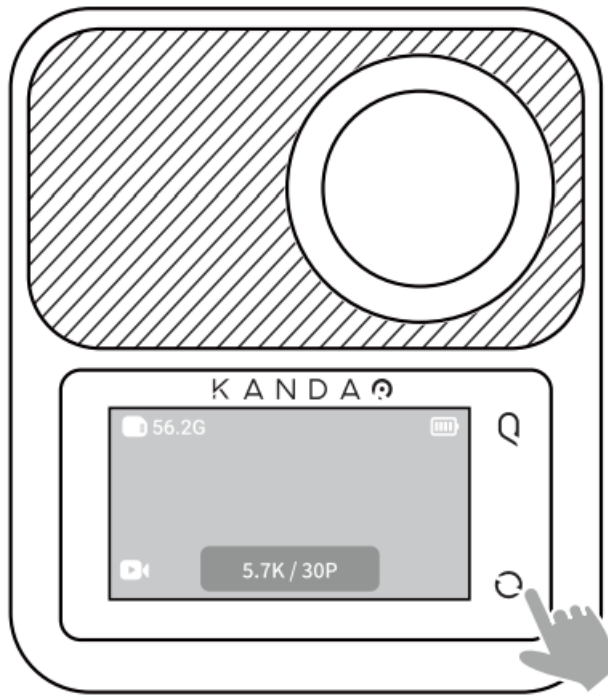

Basic Operations

Touch Screen Operations

Power on the camera, then you can try various functions by tapping or swiping the touch screen.

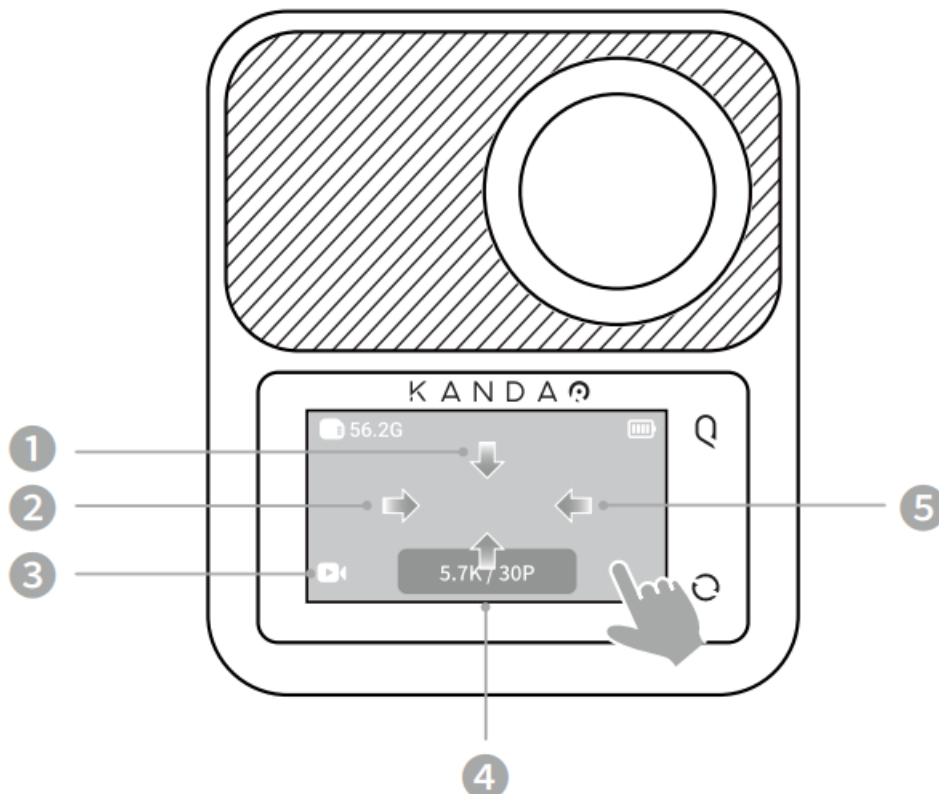

1. Swipe Down from the Top Edge

Open the Dashboard.

2. Swipe Right

See the photos and videos you captured.

3. Tap the Shooting Mode Icon in the Left Lower Corner Select a shooting mode.

4. **Swipe Up from the Bottom Edge/**

Tap the Parameter Area at the Bottom Adjust the parameters for shooting.

5. **Swipe Left**

Open the image settings.

Basic Icons on Camera Homepage

After the camera is turned on, the touch screen will show the camera status and provide real-time preview for capturing images.

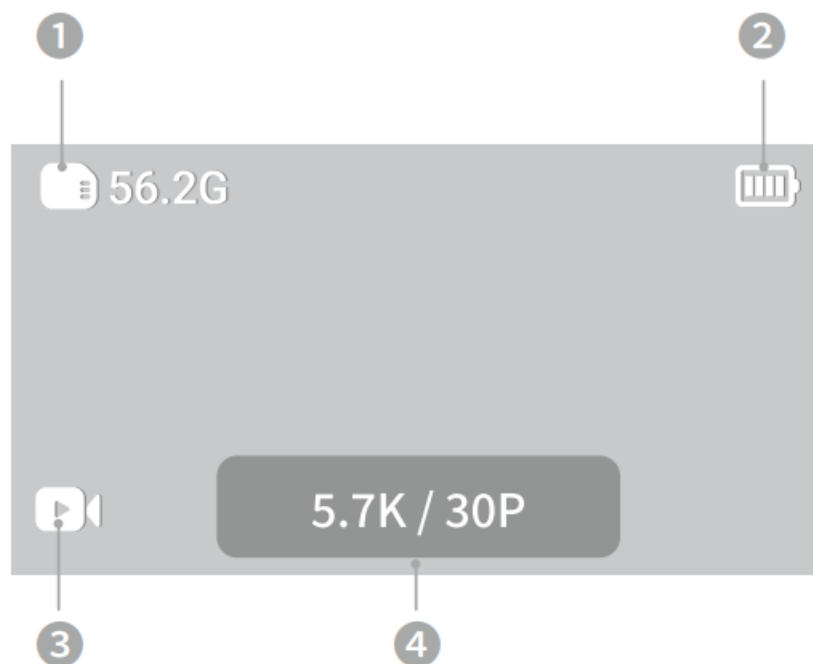

1. Remaining capacity of the microSD card

2. Battery status

3. Current shooting mode

4. Shooting parameters

Start Photography

Shooting Modes

Tap the  icon, then swipe the screen to select a shooting mode.

Shooting Modes	Description
Photo	Take one panoramic photo and support countdown.
Video	Record a panoramic video.
Time-lapse	According to the pre-set interval time, convert the long time recording into panoramic time-lapse video.
Interval Photo	Take a series of photos with the pre-set interval and support countdown.
DNG 8	Continuously take 8 DNG panoramic photos of the same scene and support countdown.
AEB	Continuously take multiple panoramic photos of the same scene with different exposures and support countdown.

Image Parameters

Exposure

On the [Camera homepage], swipe left from the right edge of the screen, select [Exposure] to set camera's exposure mode.

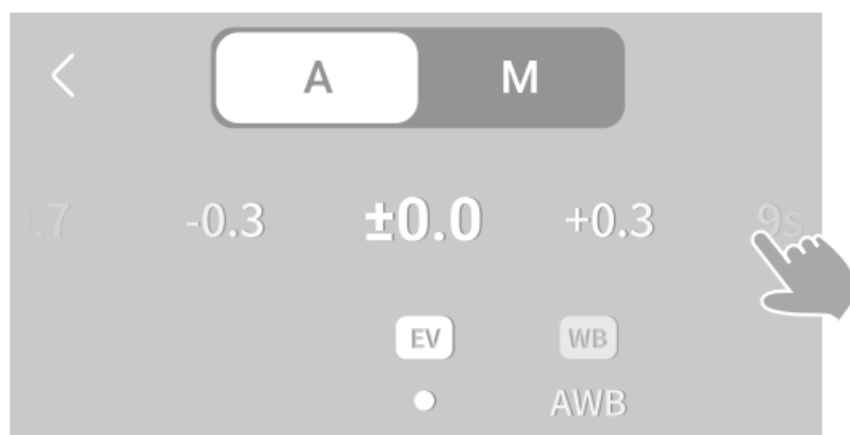

Exposure Mode	Description
Auto Mode	The camera automatically adjusts the shutter speed and ISO sensitivity by measuring the brightness of the ambient light and the reflectivity in the scene. In this mode, you may manually adjust the [Exposure value].
Manual Mode	Support users to manually adjust the [Shutter speed] and [ISO] of the camera to achieve the desired exposure effect.

White Balance

On the [Camera homepage], swipe left from the right edge of the screen, select [White Balance] to set the white balance of the image.

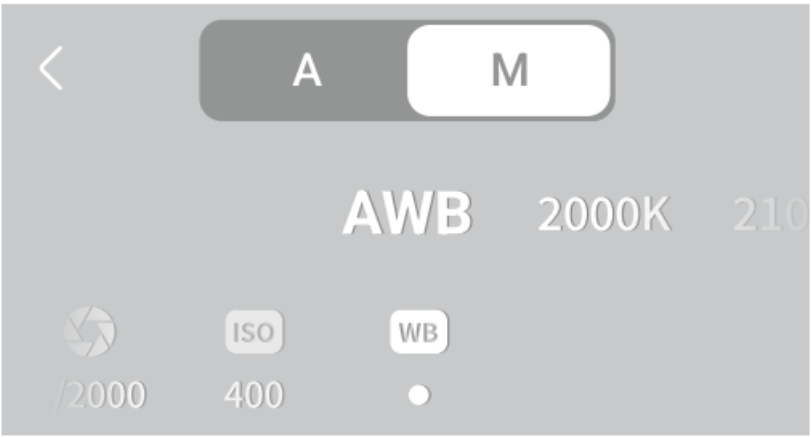

White Balance Mode	Description
AWB	Automatically optimize the white balance according to the different light conditions of the image.
Manual	Support users to manually adjust the [Color Temperature].

Format

On the [Camera homepage], swipe left from the right edge of the screen, select [Format] and set the format of the saved files.



Shooting Mode	Format
Photo/Interval Photo /DNG8/AE B	JPG: Digital image files processed and compressed by the camera. DNG: Store unprocessed raw data image files produced by the camera.
Video/Time-lapse	mp4

Shooting Parameters

Shooting Mode	Shooting Parameters
Photo	Support [Countdown].
Video	Support the setting of [Resolution] and [Frame rate].
Time-lapse	Support the setting of [Interval].
Interval Photo	Support the setting of [Interval] and [Countdown].
DNG 8	Support [Countdown].
AEB	Support the setting of [EV step], [Photo number] and [Countdown].

Dashboard

Swipe down from the top of the [Camera homepage] to enter the Dashboard.

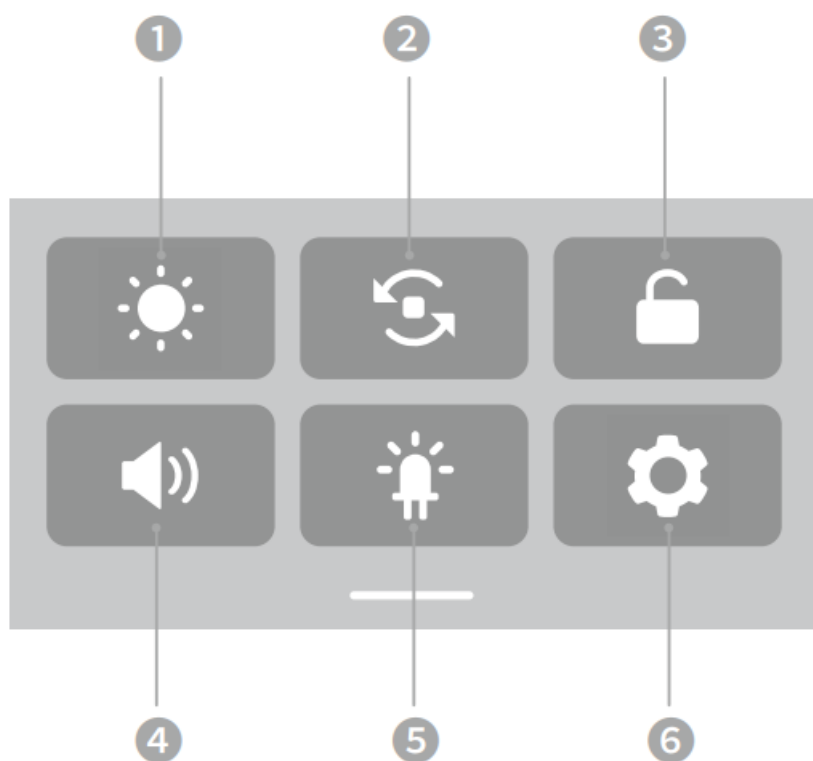

1. Brightness Adjustment

Tap to open the brightness module and swipe to adjust screen's brightness.

2. Screen Orientation Lock

Lock the screen orientation or allow screen auto-rotation.

3. Screen Lock

Lock the screen. After the screen is locked, you may slide up to unlock the screen.

4. Beep Volume

Tap to open the beep volume module and swipe to adjust the volume.

5. Indicator Lights

Enable or disable the LED indicators of the camera.

6. System Settings

Items	Description
Wireless Connection	Tap to view camera' s hotspot information, set the Wi-Fi frequency band and reset the hotspot password. You can also connect the QooCam 3 App to camera' s hotspot for camera control, firmware upgrade, file transfer, etc.
Auto Stop Rec Temp	Default setting is Standard. It also can be switched to the high threshold.
Q Function Button	You may set a commonly used function (support functions including screen lock, capture, playback and so on) to the Q function button.
Anti-Flicker	You may select a anti-flicker frequency according to the grid frequency of your location. Support setting to 50 Hz or 60 Hz.
Auto Lock Screen	Set the time for the camera to automatically lock and turn off the screen when there is no operation.
Rec Lock Screen	Set the time for the camera to automatically lock and turn off the screen when there is no operation during recording. It will not affect the recording process.
Auto Shutdown	Set the time for the camera to automatically shut down when there is no operation.
Gyro Calibration	Calibrate the gyroscope of the QooCam 3.
Language	Set the language of the camera.
Format	Format the microSD card will erase all files in it, so please be sure to back up the relevant files in advance.
Reset	Restore factory settings of the camera and clear all connections.
About camera	Display camera' s information, SN No. and firmware version.

Playback

You may swipe right from the left edge of the screen to view the photos and videos.

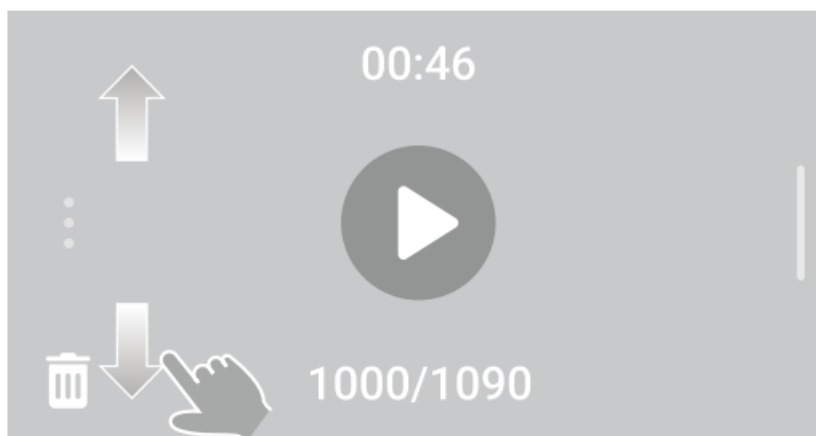

Status Indicator

QooCam3 is equipped with two LED status indicators that indicate the same information. You may turn on/off the indicators in the Dashboard of the camera.

Flashing status of the indicator	Indicated information
Green light always on	Ready
Green light flashes twice quickly	Starting
Blue light flashes 1 time slowly	Taking photo
Blue light flashes slowly	Recording
Blue and green lights flash alternately and slowly	Upgrading
Red light flashes quickly	Camera error or low battery

Connect to the QooCam 3 App

Connect to the Camera

You can use the QooCam3 App to control the camera for photo-taking, video recording, file transferring and material processing.

Steps for connection:

1. Power on the QooCam 3 and turn on the Camera Hotspot;
2. Turn on the Wi-Fi and Bluetooth of your mobile device;
3. Open the QooCam 3 App, click the “Device connection” icon  and follow the instructions to connect the camera.

Note:

When the QooCam 3 fails to connect to the QooCam 3 App, please follow these steps:

1. Make sure the Wi-Fi and Bluetooth of the mobile device are turned on;
2. Make sure the QooCam 3 App is the latest version;
3. Make sure the firmware of your QooCam 3 is the latest version;
4. For Android devices, please ensure the QooCam 3 App has the following permissions:
 - ① Bluetooth: Used for obtaining the device information of QooCam 3 to establish the wireless connection;
 - ② Wi-Fi: Used to connect Android device and QooCam 3 via WiFi.
5. For iPhone, please ensure the QooCam 3 App has the following permissions:
 - ① Bluetooth: Used for obtaining the device information of QooCam 3 to establish the wireless connection;
 - ② Wi-Fi: Used to connect the iPhone and QooCam 3 via WiFi.
 - ③ Local network: Used to ensure the communication between the iPhone and QooCam 3 under the same network.
6. Ensure the Camera Hotspot of QooCam 3 is turned on.

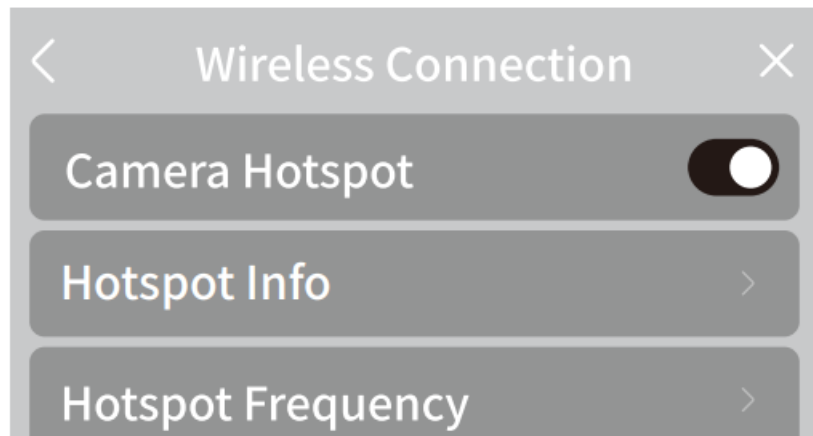

Remote Control Interface



1. Homepage

< Back to the homepage of the App.

2. Resolution and Frame Rate



Set the resolution and frame rate for the video. Different parameters can be set for different shooting modes.

3. White Balance



Set the white balance.

4. Camera Settings



Set parameters such as anti-flicker, prompt tone of camera and SD card formatting.

5. Projection Mode



Switch projection modes for real-time preview.

6. Exposure Mode



Display the current exposure mode. You may tap it to adjust exposure modes and parameters.

7. Shooting Mode

video Swipe to select different shooting modes.

Shooting Mode	Description
Photo	Take one panoramic photo and support countdown.
Video	Record a panoramic video.
Time-lapse	According to the pre-set interval time, convert the long time recording into a panoramic time-lapse video.
Interval Photo	Take a series of photos with the pre-set interval and support countdown.
DNG8	Continuously take 8 DNG panoramic photos of the same scene and support countdown.
AEB	Continuously take multiple panoramic photos of the same scene with different exposures and support countdown.

8. Shutter Button



Press the shutter button to take a photo or start/stop the video recording.

9. Playback



Tap to playback the photos and videos.

10. Battery Level



Display the current battery level of QooCam 3.

11. MicroSD Card Information



Display the remaining capacity of the microSD card.

File Transfer

Transfer Files to Your Mobile Device

Wireless file transfer

After connecting the QooCam 3 and the QooCam 3 App wirelessly, you may click the playback icon or album icon in the QooCam 3 App to view photos and videos. Click the download button  to download the materials to your

mobile device. These downloaded materials can be edited in the QooCam 3 App and shared on social media platforms.



Transfer files to the computer

Turn on the QooCam 3, then you can use a USB-C cable to transfer your files from camera to the computer. The camera cannot be used for shooting while transferring files.

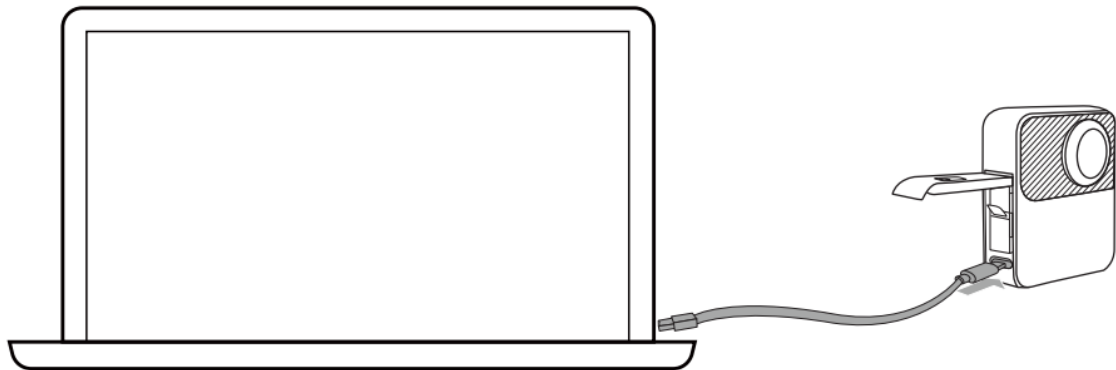

Note:

1. Please do not shut down the camera when transferring files.
2. If the transmission is abnormal or interrupted, please unplug the data cable and re-connect it to the computer.

Maintenance

Camera Maintenance

1. Crashes or heavy impacts may damage the QooCam 3 and cause it to work abnormally.
2. The lens of QooCam 3 is made of tempered glass, but there is still the possibility of scratches or cracks. The protective glass of the lens may be scratched by a foreign object.
3. If the protective glass of the lens is damaged accidentally, please be careful to avoid being injured.
4. Please away from dust and sand prevention when using QooCam 3. If the sound pick-up hole is clogged with sand, dust, or other substances, please rinse the QooCam 3 with clean water while it is tightly locked.
5. Please do not use sharp or hard objects to poke the USB-C port or microSD card slot.

6. Please do not expose the QooCam 3 to extreme cold or hot conditions. Low or high temperatures may shorten the service life of battery or cause temporary malfunction.
7. Please do not use the QooCam 3 during thunderstorms.
8. Please do not disassemble and repair the QooCam 3 by yourself.
9. When attaching QooCam 3 to the roof or window of a car, the QooCam 3 may fall off if the car travels too fast, the surface is not clean, or there is bad weather such as high winds or a thunderstorm.
10. Please do not place the camera close to a magnet, motor or other devices that may generate strong electromagnetic fields. Exposure to strong magnetic fields may cause the camera to malfunction or damage image data.

Notes for Underwater Usage

1. The QooCam 3 is waterproof at a depth of 10 m and does not require additional protective cover. Please ensure all protective covers are closed before using the product under or near water, and in dusty or sandy environment.
2. Please keep the waterproof rubber rings of the QooCam 3's battery and lens clean and free of foreign object, such as sand and dust, to ensure the waterproof effect. The built-in membranes of the pick-up hole, speaker hole and air pressure balance hole on the camera are specially designed for waterproofing, please do not remove it or damage it with sharp objects to ensure the waterproof effect.
3. Please install the battery correctly according to User Manual, and make sure the protective covers for ports and lens are tightly closed to prevent water. Be sure to wipe off the water on the camera before removing the battery.
4. Rinse the QooCam 3 with freshwater after each use in seawater, and wipe it with the supplied lens wipe or a soft dry cloth.
5. Please do not use the QooCam 3 in the hot spring or corrosive liquid. It is not recommended to use the QooCam 3 in an extreme water environment or unknown liquid environment.

Battery Information

Measures to Maximize Battery Life

1. Record videos at lower frame rates and resolutions.
2. Enable the automatic power-off.
3. Use a external USB power supply to power the camera during photographing .
4. Charge the camera in time when the battery level is low. Leaving the camera at a low battery level for a long time (more than 4 months) will affect the battery life.

Battery Storage

1. If the QooCam 3 will not be used in more than 10 days, please charge or discharge the battery to a level of 40%-60% for storage to maximize its service life.
2. Extreme temperature may temporarily shorten the battery life or cause the camera the camera to malfunction. Please avoid the abrupt change of temperature or humidity, otherwise the condensation may appear on the surface or inside of the camera.

3. Please do not dry the camera with an external heat source such as a microwave oven or hair dryer. Any damage to the camera or battery caused by liquids inside the camera is beyond the warranty scope.
4. Please do not store the battery with metal objects such as coins, keys, or necklaces. It may cause a fire if the battery terminals come in contact with metal objects.

Tech Specifications

II Model	QCM0301
General	
Dimensions	71.5 mm x 82.7 mm x 26.6 mm
II Weight	201 g
Water and Dust Resistant	IP68 Waterproof
Touch screen	1.9"
Gyroscope	6-axis gyroscope
Microphone	4
I Speaker	1 I
Wi-Fi	2.4 GHz/5 GHz 802.11a/b/g/n/ac
Bluetooth	BLE 4.2
Storage	Have no built-in memory and support microSD card storage
MicroSD Cards	Support microSD cards with a speed class of UHS-I V30 or higher, up to 256 GB File system: exFAT

Camera	
CMOS	1/1.55"
Aperture	F0,2.
35 mm Equivalent Focal Length	9.36 mm
Exposure Compensation	±2 EV
ISO Range	100-6400
Shutter Speed	Photo: 1/6400s – 60s Video: 1/6400s – to the limit of frames per second
White Balance	Auto, 2500K-8000K
Maximum Resolution of II Photos	62 MP (11136 x 5568) is
Video Resolution @ Frame Rate	5.7K @ 30fps 4K @ 30 / 60fps
Photo Modes	Standard panoramic photo, Interval Photo, DNG8 and AEB
Video Modes	Standard panoramic video and Time-lapse
Image Format	JPG / DNG
Video Format	MP4
Audio Output	MC (16 bit/Quadraphonic/48 KHz/192 kbps)
Operation Temperature	0°C-40°C

Battery	
Battery Capacity	1600mAh
Ambient Temperature for Charging	5°C-40°C
Ambient Temperature for Working	0°C-40°C
Charging Voltage and current	5V/2 A

KANDAO

This content is subject to change without prior notice.

Download the latest version from official website of Kandan Technology.

If you have any question or suggestion about the user manual, please contact us via the following email: service@kandaovr.com

Copyright 2016-2023 Kandan All Rights Reserved.

Documents / Resources

<div><div><div>QooCam 3</div><div>User Manual- 用户手册</div><div>用户手册: 2019-12-27 15</div></div><div></div><div>KANDAO</div></div> <div>KANDAO QooCam 3 360 Degree Action Camera [pdf] User Manual B1JCT2, D6GL, QooCam 3, QooCam 3 360 Degree Action Camera, 360 Degree Action Camera, Action Camera, Camera</div>

References

- [K_____](#)
- [K_____](#)
- [K Product Support](#)
- [K Product Support](#)
- [K_____](#)
- [K_____](#)
- [User Manual](#)