



K F CONCEPT TM2515T1 Camera Tripod Best Tripod for DSLR User Manual

[Home](#) » [K F CONCEPT](#) » K F CONCEPT TM2515T1 Camera Tripod Best Tripod for DSLR User Manual 

Contents

- [1 K F CONCEPT TM2515T1 Camera Tripod Best Tripod for DSLR](#)
- [2 Installation Instructions](#)
- [3 Documents / Resources](#)
- [4 Related Posts](#)

K&F CONCEPT®

K F CONCEPT TM2515T1 Camera Tripod Best Tripod for DSLR



Installation Instructions

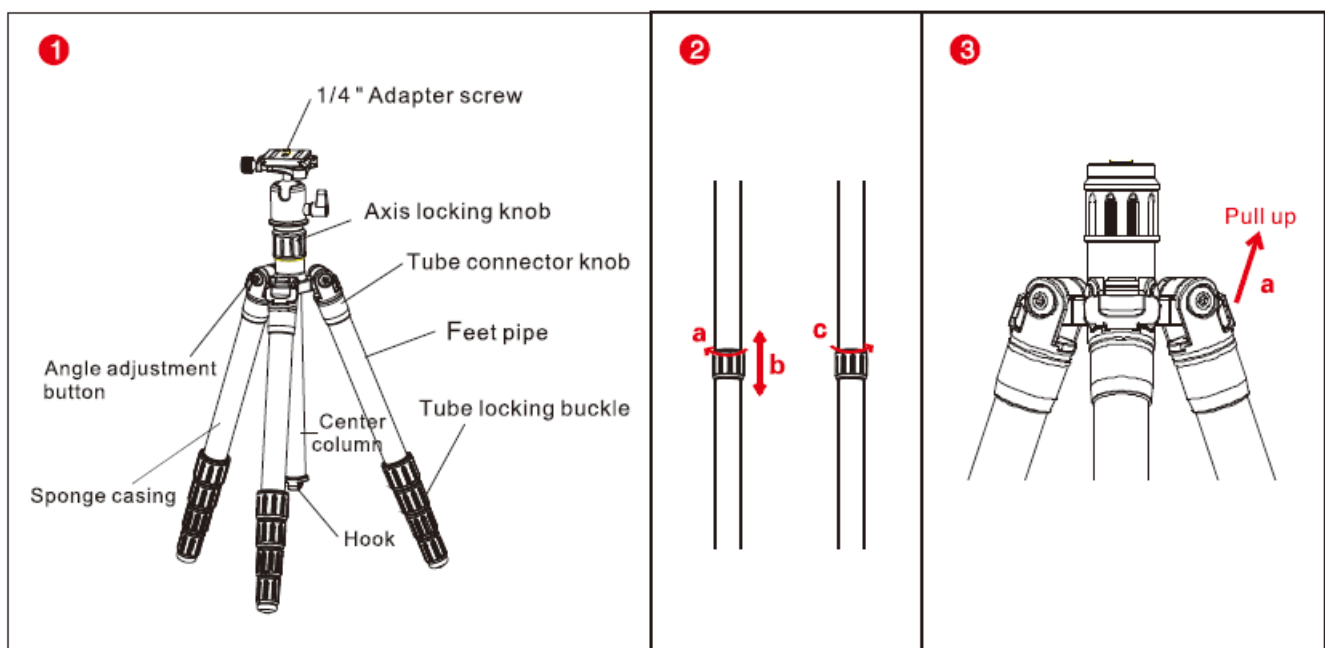

1. Know tripod

2. Feet pipe extension

- As shown in figure a: simultaneously or separately rotate the locking buckle and then pull the tube out to the length you want; Then you can rotate the buckle back to lock the tube like figure c shows.

3. Angle adjustment

- Three support angles can be adjusted for each tube to suit different shooting requirements, as shown in figure a: pull up the angle control button and turn the tube to the appropriate angle, then press the button down.

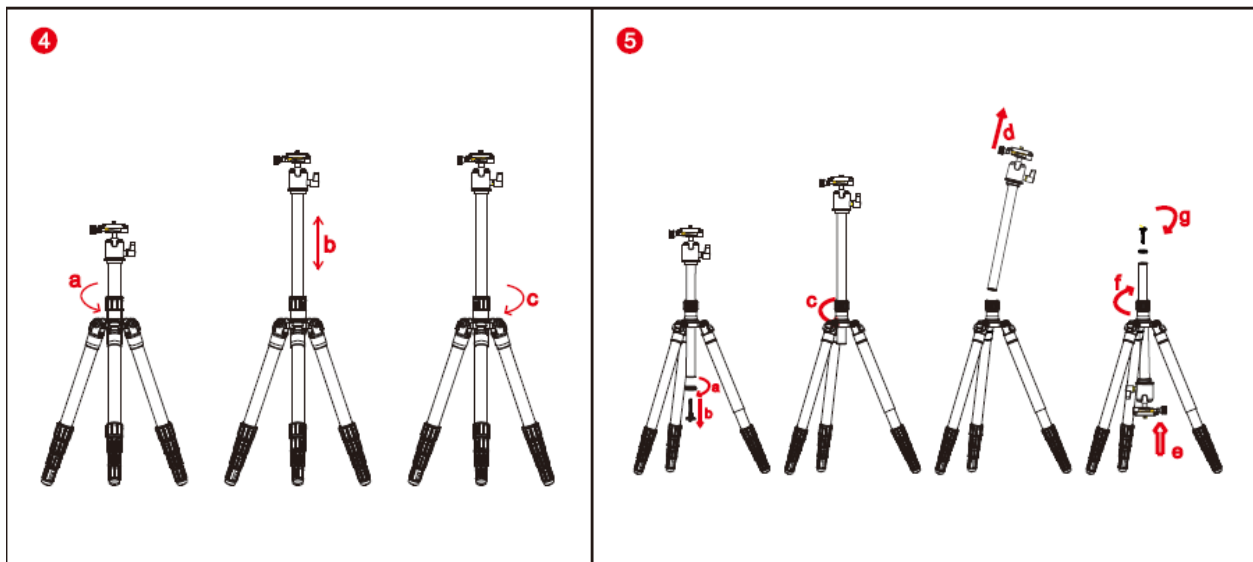

4. Center column adjustment.

- According to A direction rotate. While the tensile center column as shown. C is the locking direction.

5. Center column inverted installation

6. Tripod anti- folded

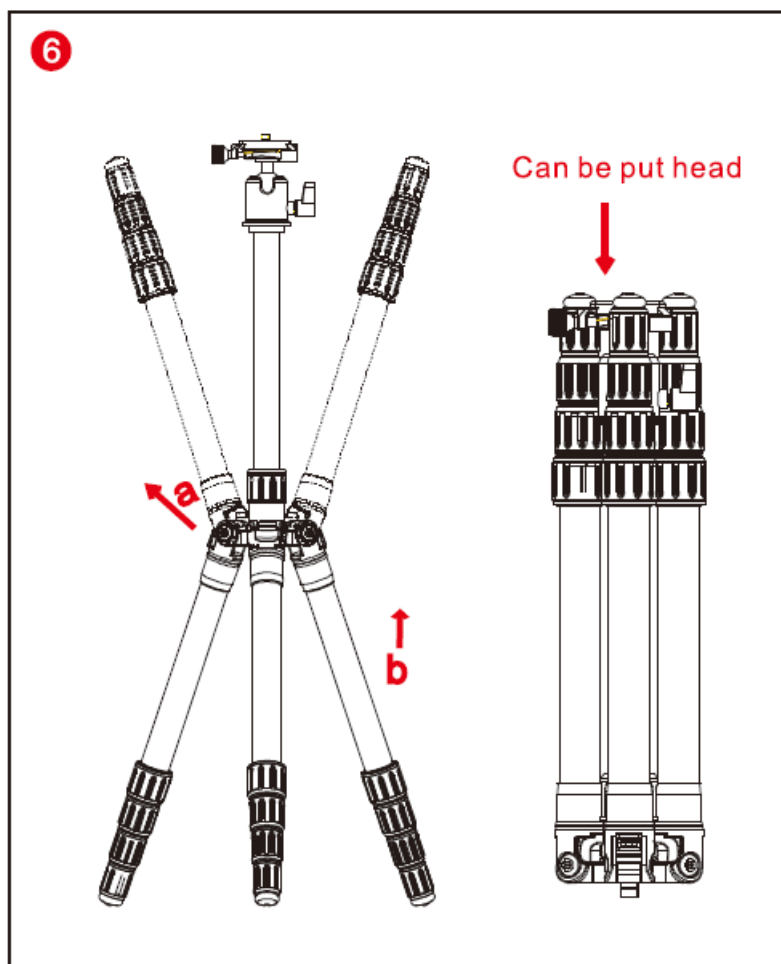

- After all the tubes are retracted and locked, pull up the angle control button as shown in the figure a, and then pull the three leg tubes to the opposite side to realize the refolding as shown in the figure b. Making the tripod a min size for easy carrying.

Note

1. Do not exceed the maximum specified load (refer to individual product descriptions).
2. When using the product, please try to lock the central column and operating in a safe condition.
3. Do not use at temperatures below minus 40 degrees Celsius or higher than 100 degrees Celsius.
4. When used in wet/ sandy/ dusty environment, keep in mind the product dry and clean is not recommended for use in seawater.
5. Never long on the sun exposure and avoid high-temperature environments , such as long on the inside or glass.



- The Company reserves the product upgrades and power due to product upgrades and changes to various parameters without notice .If the printing errors or omissions or errors in translation, hope the majority of user understanding
6. Do not away from the people when use in the public areas .. Please operate carefully in the dangerous places .
 7. Use a mild detergent and a soft towel to clean the dust and sand cleared from all the lock system and the sliding part .
 8. Unless there is a need , this device does not need lubrication on a regular basis , if they really need to , please use the standard oil or wax.
 9. For the sake of their own safety, do not contact with any power.
 10. Prohibit tripod equipped with a device (camera) together with mobile.

Documents / Resources

	<p>K F CONCEPT TM2515T1 Camera Tripod Best Tripod for DSLR [pdf] User Manual TM2515T1 Camera Tripod Best Tripod for DSLR, TM2515T1, Camera Tripod Best Tripod for DSLR, Tripod Best Tripod for DSLR, Best Tripod for DSLR, Tripod for DSLR, DSLR</p>
---	---