



JVC KD-X561DBT Optimill Reverse Camera Installation Guide

[Home](#) » [JVC](#) » JVC KD-X561DBT Optimill Reverse Camera Installation Guide 

Contents

- 1 JVC KD-X561DBT Optimill Reverse Camera
- 2 Optimill Reverse Camera installation for JVC KD-X561DBT (Single-DIN)
- 3 Universal Optimill Reverse Camera installation
- 4 Documents / Resources
 - 4.1 References
- 5 Related Posts

JVC

JVC KD-X561DBT Optimill Reverse Camera



Optimill Reverse Camera installation for JVC KD-X561DBT (Single-DIN)

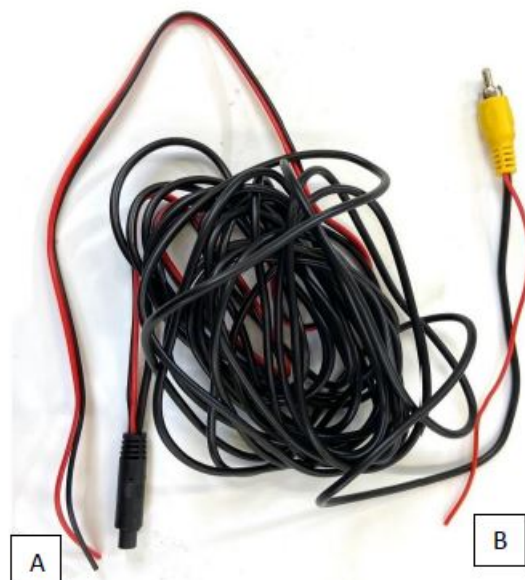

RED Wire (A) on Camera Loom:

Connect to an ignition LIVE.

BLACK Wire on Camera Loom:

Connect to black/earth wire on the MUD Piggy-Back loom.

Yellow RCA Wire on Camera Loom:

Connect to RCA extension cable and run forwards to the yellow RCA socket on the back of the head unit. You can ignore the separate red wire (B) on the RCA cable.

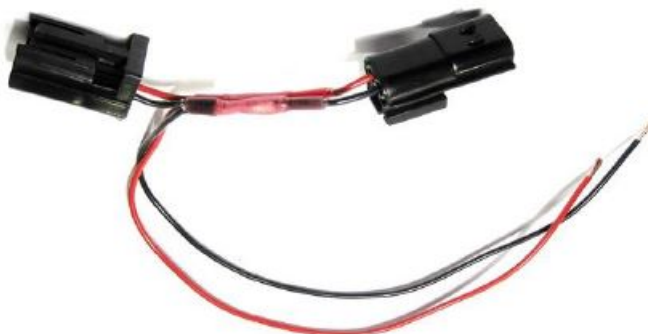

Red Wire on Reverse Lamp Piggy-Back Loom:

Connect to the purple/white camera-input wire on the back of the head unit labelled 'Reverse'

Black Wire on Piggy-Back Loom.

Connect to the black/earth wire on the camera loom

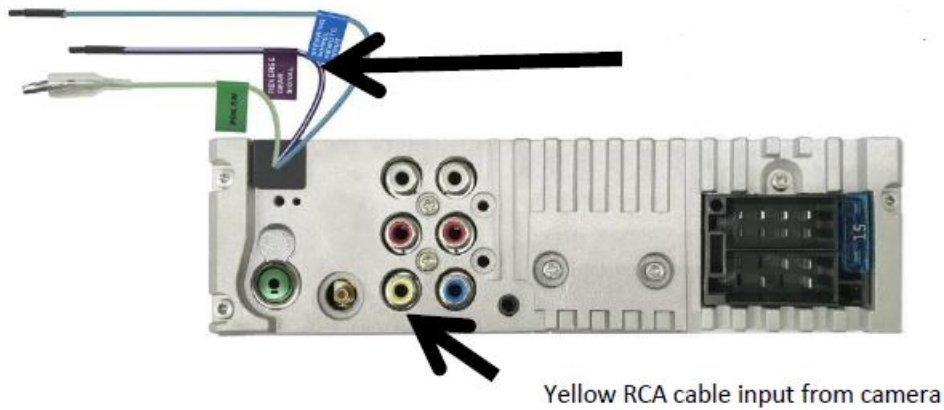

Reverse input from Piggy-Back loom/ Reverse lamp connects into Purple/White wire marked 'Reverse'. Yellow RCA cable input from camera If the image on your head unit screen is reversed, flip the image in your head unit menu settings. If your head unit doesn't have an image flip function, cut the small green/blue wire loop on the camera harness to reverse the image.

Universal Optimill Reverse Camera installation

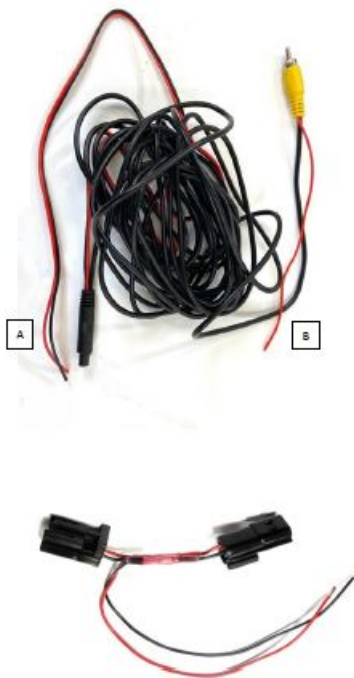

Black Plug

Connect to the corresponding plug on Camera Harness

Red Wire (A)

Connect to Red Wire on Reverse Lamp Piggy Back Loom.

Black Wire

Connect to Black wire on Reverse Lamp Piggy Back Loom

Yellow RCA plug

Connect to yellow RCA socket on the back of head unit/reverse monitor normally labelled 'Camera' Extra Red Wire (B) on Yellow RCA plug Connect to the wire on back of head unit labelled 'reverse', normally purple in colour.

Note:

To create a separate switched camera supply you can install a switch into this red wire to provide a manual off/on override function for the camera.

MUD Piggy Back Loom

Connect the loom directly into the back of the reverse lamp to provide the reverse feed to camera.

Red Wire

Connect to red wire on camera harness.

Black Wire

Connect to Black wire on camera harness.

If the image on your head unit screen is reversed, flip the image in your head unit menu settings. If your head unit doesn't have an image flip function, cut the small green/blue wire loop on the camera harness to reverse the image.

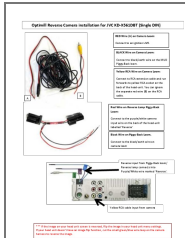
Documents / Resources

[JVC KD-X561DBT Optimill Reverse Camera](#) [pdf] Installation Guide
KD-X561DBT Optimill Reverse Camera, KD-X561DBT, Optimill Reverse Camera

References

-  [MUD-UK](#)