



JUPE LED JPL-ZGREC5-250VA Smart Dimmer Module 250W Instruction Manual

[Home](#) » [JUPE LED](#) » JUPE LED JPL-ZGREC5-250VA Smart Dimmer Module 250W Instruction Manual 



JPL-ZGREC5-250VA
Smart Dimmer Module 250W



Contents

- [1 JPL-ZGREC5-250VA Smart Dimmer Module 250W](#)
- [2 Specifications](#)
- [3 Installation](#)
- [4 Operation](#)
- [5 Zigbee Cluster](#)
- [6 Zigbee Setting](#)
- [7 Documents / Resources](#)
 - [7.1 References](#)
- [8 Related Posts](#)

JPL-ZGREC5-250VA Smart Dimmer Module 250W

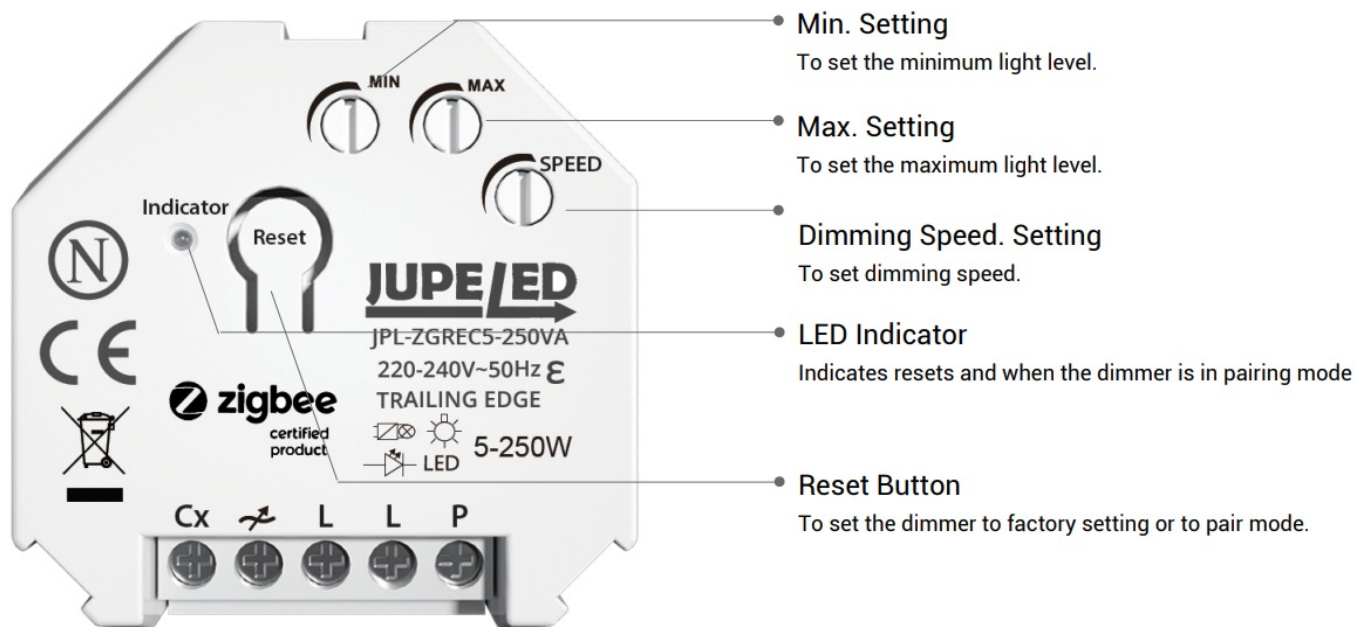

- ✓ Zigbee support
- ✓ Suitable for several home automation apps
- ✓ Voice support (Amazon Alexa & Google Assistant / Homey)
- ✓ Works with push-button (momentary switch)
- ✓ Optimal dimmable & light stability
- ✓ Suitable for 0-250W LED
- ✓ Saves and restores the last status after a power failure
- ✓ MIN and MAX light adjustment and dimming speed
- ✓ Suitable for 90% of all LEDs
- ✓ Does not require a neutral line, 3 wire connection available
- ✓ Soft start system
- ✓ Noiseless dimming

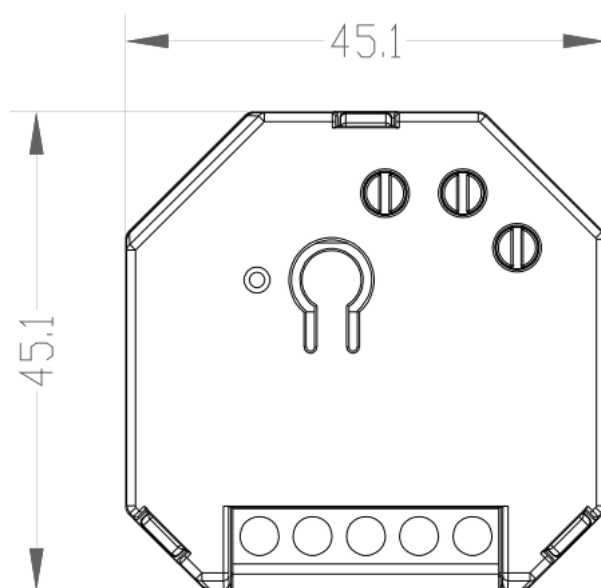

Specifications

Input voltage	230V ~ 50Hz
Power (load)	0-250W LED
	10-250W Halogen light bulbs
Suitable for	Led-, halogen-, incandescent bulbs R,C
Dimming method	Phase cut
Working temperature	40°C
Operation	Push Dimming by Momentary Switch
Dimensions	45.1*45.1*19.8mm
Weight	35.4g

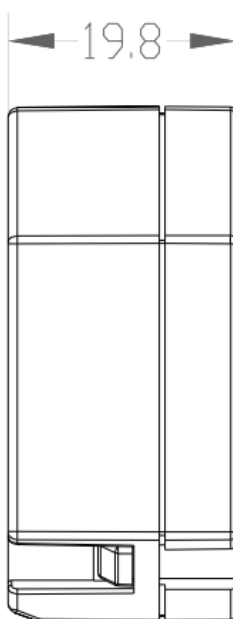

Installation

1. Turn off the power

To prevent electrical shock and/or equipment damage, disconnect electrical power at the main fuse or circuit breaker before installation and maintenance. Be aware that even if the circuit breaker is off, some voltage may remain in the wires — before proceeding with the installation, be sure no voltage is present in the wiring. Take extra precautions to avoid accidentally turning the device on during installation.

2. Connect the device exactly according to the diagrams shown below

This dimmer is available for 2wire and 3-wire system. please note if it is 2wire, N and Load port must be connected to make stable dimming.

3. Turn the power back

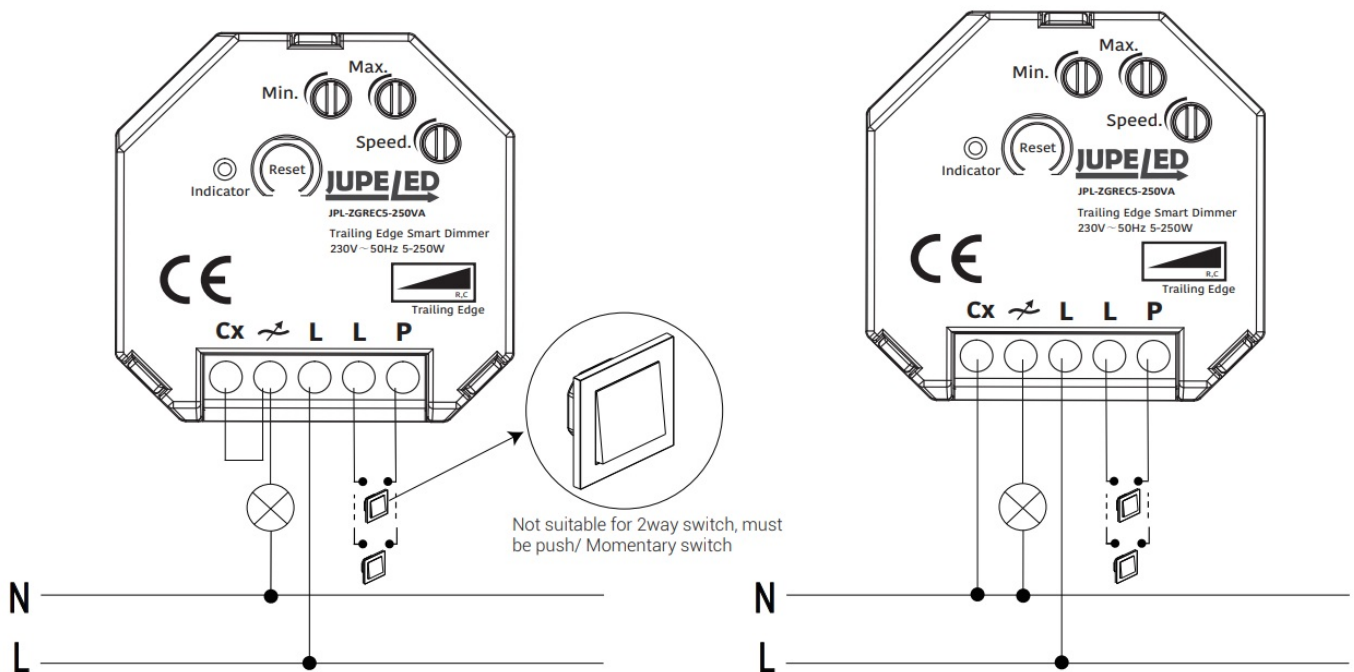

Operation

1. Min./Max./Dimming Speed adjustment

For the SMART dimmer to work optimally or suitable for your preference, you can adjust the brightness at the Min. and Max. level and also the dimming speed with the MIN./MAX./Dimming Speed adjustment.

MIN adjustment : Switch on the lights. When the lights are on, insert a screwdriver in MIN and turn to the left. When the light becomes unsteady, turn slightly back to the right so that the light remains steady.

MAX adjustment : Switch on the lights. When the lights are on, insert a screwdriver in MAX and turn to the right. When the light becomes unsteady, turn slightly back to the left so that the light remains steady.

Dimming Speed adjustment: Insert a screwdriver in Speed, clockwise to increase the dimming speed when you push the momentary switch, vice versa.

Zigbee Cluster

1. Input Cluster

- 0x0000: Basic
- 0x0003: Identify
- 0x0004: Groups
- 0x0005: Scenes
- 0x0006: On/off
- 0x0008: Level Control
- 0x0b05: Diagnostics

2. Output Cluster

- 0x0019: OTA

Zigbee Setting

1. Factory Reset

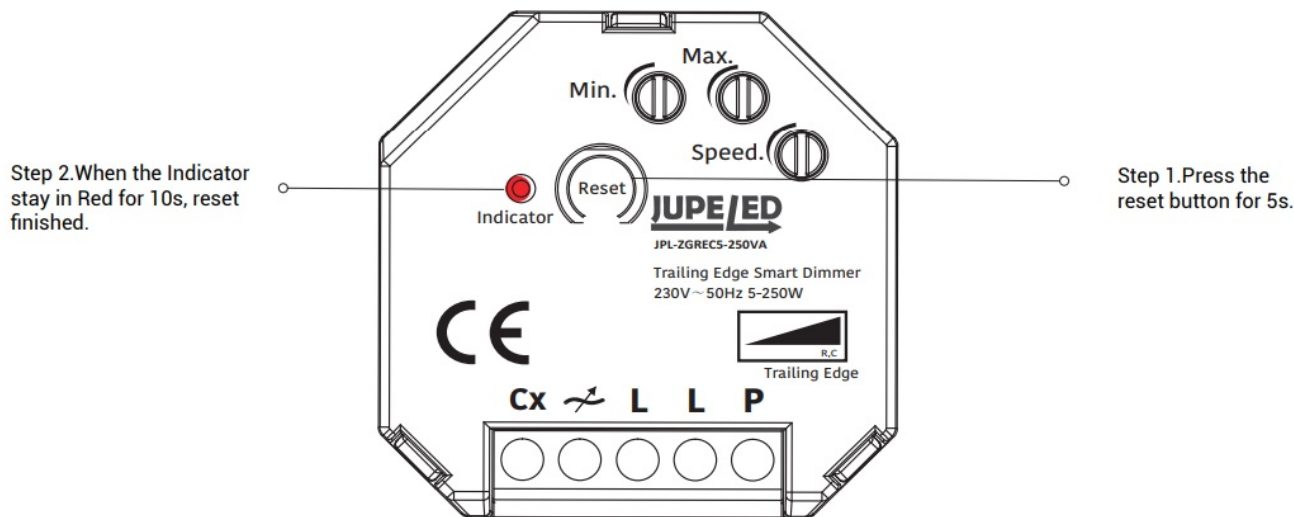

Please Note:

This procedure should only be used when the primary controller is inoperable or otherwise missing.

Reset Dimmer controller to factory default settings will sets the Dimmer to not in Z-Wave network state, delete the Association setting and restore the Configuration setting to the default.

The Dimmer controller will start SmartStart Inclusion when it is reset.

2. Inclusion to a Zigbee Network

Step 1. Remove the device from previous Zigbee network if it has already been added to, otherwise pairing mode will be fail.

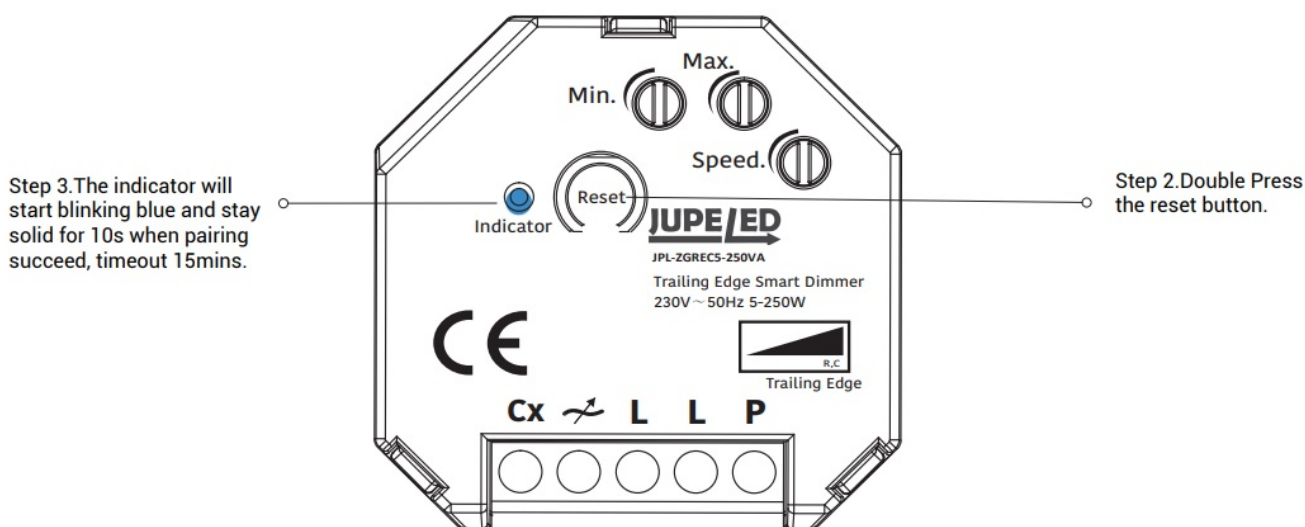

3. Remove from a Zigbee Network

Method 1. From your Zigbee hub interface, choose to delete or reset the device as instructed.

Method 2. Remove from the Device, see below instructions.

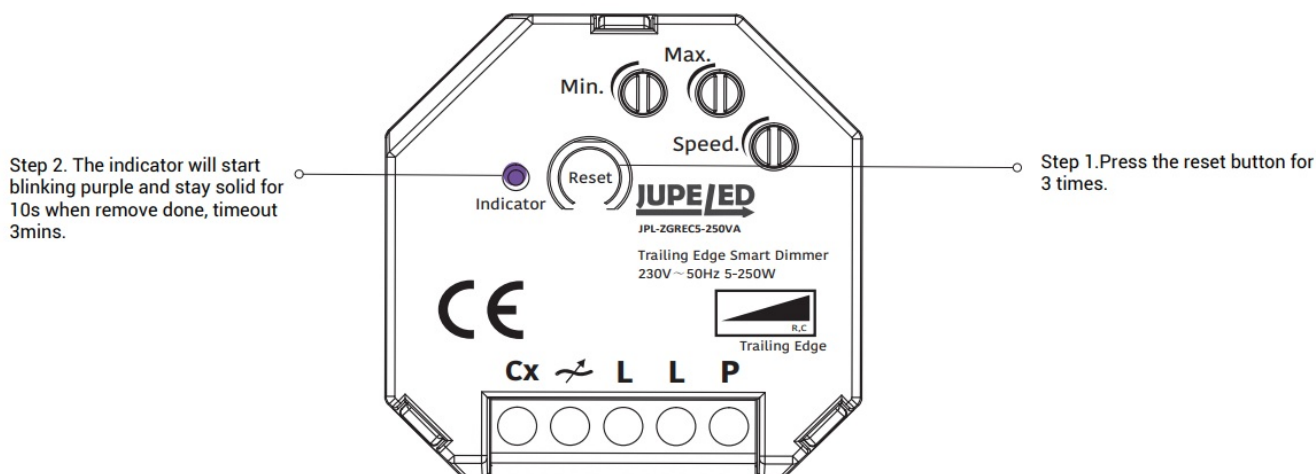

4. TouchLink

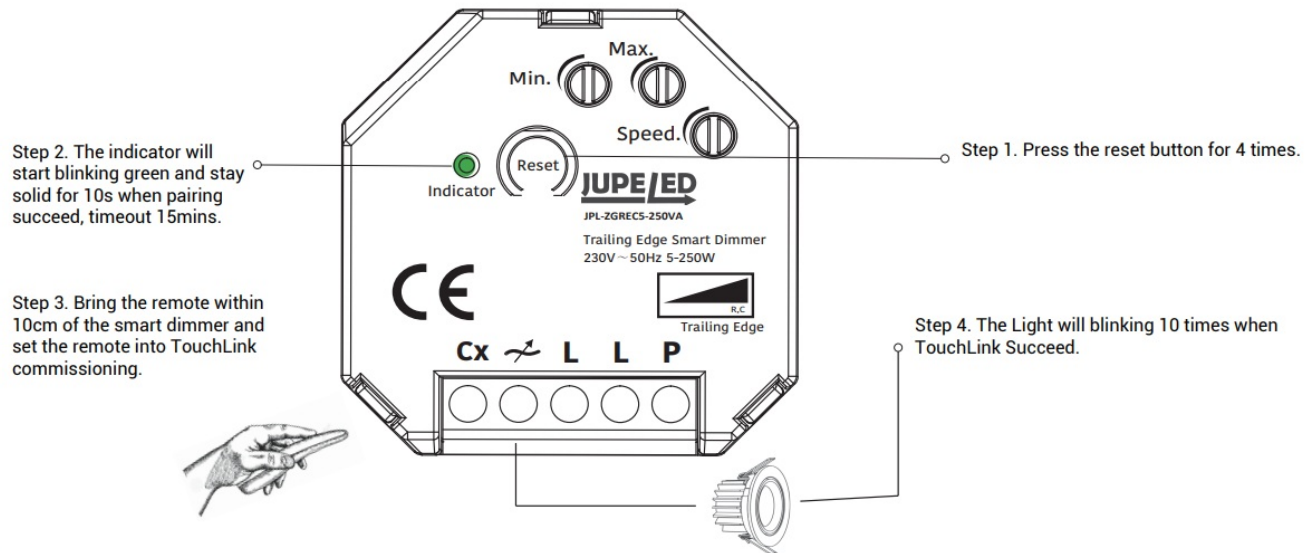

Note:

- When both devices (Dimmer and remote) not included in the Zigbee Network, each dimmer can link with one remote max.
 - When both devices are included in the same Zigbee network, each dimmer can link with max 30 remotes.
 - For Philips Hue Hubs and Amazon Echo Plus, add remote and device to network first then touchlink.
5. Find and Bind

Note: Make sure the device and remote already added to the same Zigbee network

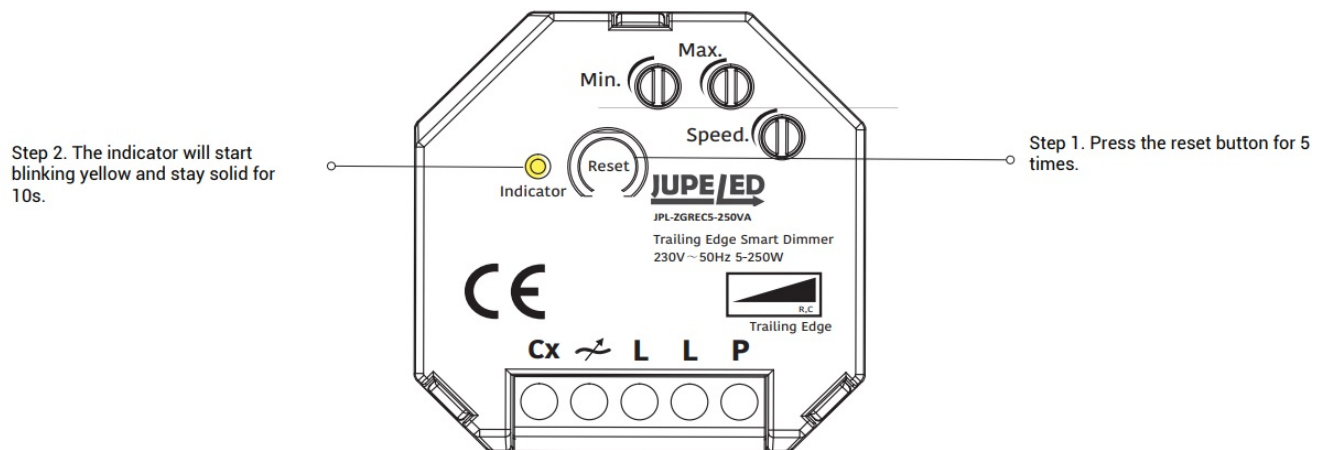

Step 3. Set the remote into find and bind mode and enable it to find and bind commissioning. Please refer to the manufacturers instructions of how.

Step 4. There shall be an indication on the remote that it binds the device successfully and can control it.

Jupeled Oy
info@jupeled.fi
www.jupeled.fi

Documents / Resources

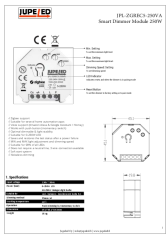

[JUPE LED JPL-ZGREC5-250VA Smart Dimmer Module 250W](#) [pdf] Instruction Manual
JPL-ZGREC5-250VA, Smart Dimmer Module 250W, Dimmer Module 250W, Smart Module 250
W, Module 250W

References

- [JUPE LED - Laadukkaat LED-valaisimet yritysasiakkaille - Jupeled Oy](#)