

[Skip to content](#)

**Manuals+**

User Manuals Simplified.



# JUNO T286L HTEK Trac Head Trac Master Flat Back Cylinder LED Installation Guide

[Home](#) » [Juno](#) » JUNO T286L HTEK Trac Head Trac Master Flat Back Cylinder LED Installation Guide



## INSTALLATION INSTRUCTIONS

Contents [hide](#)

[1 T286L HTEK Trac Head Trac Master Flat Back Cylinder LED](#)

[2 Installation Instructions for T283L/T285L/T286L Accessories](#)

[3 WARRANTY](#)

[4 Documents / Resources](#)

[4.1 References](#)

[5 Related Posts](#)

### T286L HTEK Trac Head Trac Master Flat Back Cylinder LED

**WARNING:** For your safety, read and understand instructions completely before starting installation.

**Note:** Use with non-Juno fixtures voids Juno warranty.

#### SAVE THESE INSTRUCTIONS

### Installation Instructions for T283L/T285L/T286L Accessories

**Step 1.** Remove all items from accessory packaging.

**Step 2.** 3 set screws are required for installation. Place up to 2 accessory media in between the fixture and accessory holder, snoot, or barn door. (See T283L/T285L/T286L spec sheet for compatible accessory media).

**Step 3.** Line up the accessory holder, snoot, or barn door so that the set screws will fasten to the fixture bezel.

**Step 4.** Use the provided Allen wrench to tighten all 3 set screws until you cannot pull off the accessory.

**Caution:** Do not over-tighten, however pull lightly on the accessory to make sure it is snug, and will not come off the fixture.

**Note:** Lining up the accessory holders to the fixture bezel is important due to when the set screws are installed and tightened, they will leave a mark.

**Figure 1.**  
Extrenal Accessory Holder:  
T770BL, T770SL, T770WH

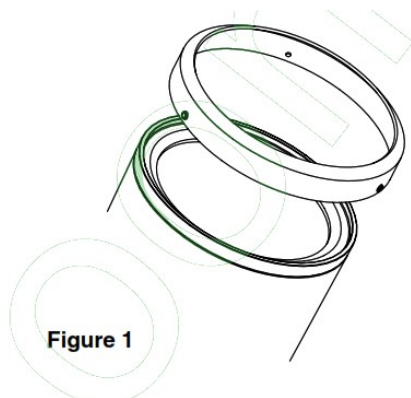

**Figure 2.**  
External Snoot/Accessory  
Holder: T5788BL

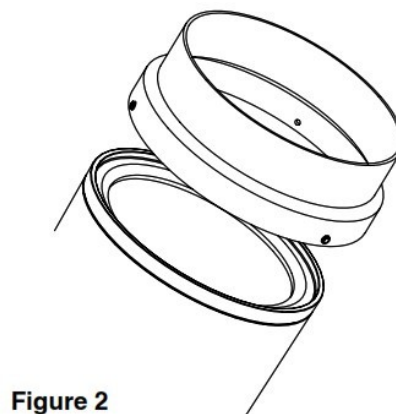
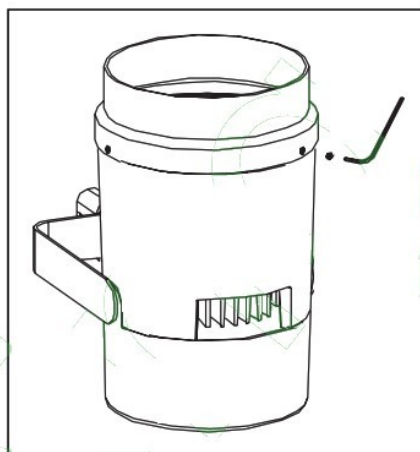

**Figure 3.**  
External Barn Door/Accessory  
Holder: T5774BL\*

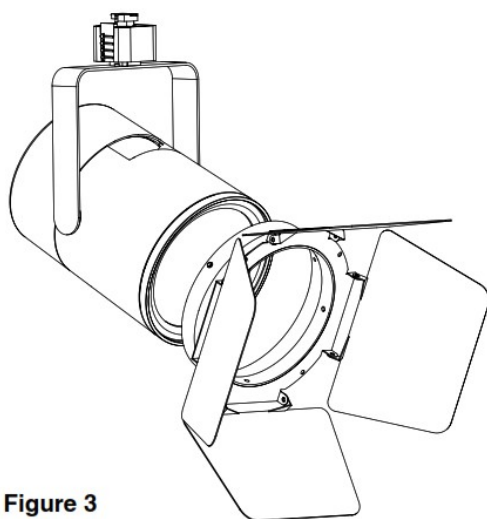

\* Cannot be used with T579BL, Cube Cell louver

## WARRANTY

5-year limited warranty. Complete warranty terms located at  
[www.acuitybrands.com/CustomerResources/Terms\\_and\\_conditions.aspx](http://www.acuitybrands.com/CustomerResources/Terms_and_conditions.aspx)  
Technical Services Phone (888) 387-2212

**AcuityBrands.**

1300 S. Wolf Road · Des Plaines, IL 60018 · Phone 800-323-5068  
· Visit us at [www.acuitybrands.com/juno-recessed](http://www.acuitybrands.com/juno-recessed)  
©2017 Acuity Brands Lighting, Inc Rev 3/22 P4218



**[JUNO T286L HTEK Trac Head Trac Master Flat Back Cylinder LED](#)** [pdf] Installation Guide  
T286L HTEK Trac Head Trac Master Flat Back Cylinder LED, T286L, HTEK Trac Head Trac Master Flat Back Cylinder LED, Master Flat Back Cylinder LED

References

- [Terms and Conditions and Warranties | Acuity Brands](#)
- [Home | Juno Lighting | Acuity Brands](#)

[Manuals+](#),

- [home](#)
- [privacy](#)