



Juniper Personal Storage Drawer Installation Guide

[Home](#) » [JUNIPer](#) » Juniper Personal Storage Drawer Installation Guide 

Juniper Personal Storage Drawer Installation Guide



Contents

- [1 Personal Storage Drawer](#)
- [2 Align Storage Drawer](#)
- [3 Secure to Workstation](#)
- [4 Documents / Resources](#)
 - [4.1 References](#)
- [5 Related Posts](#)

Personal Storage Drawer

Under-Surface Mounting

Align Storage Drawer

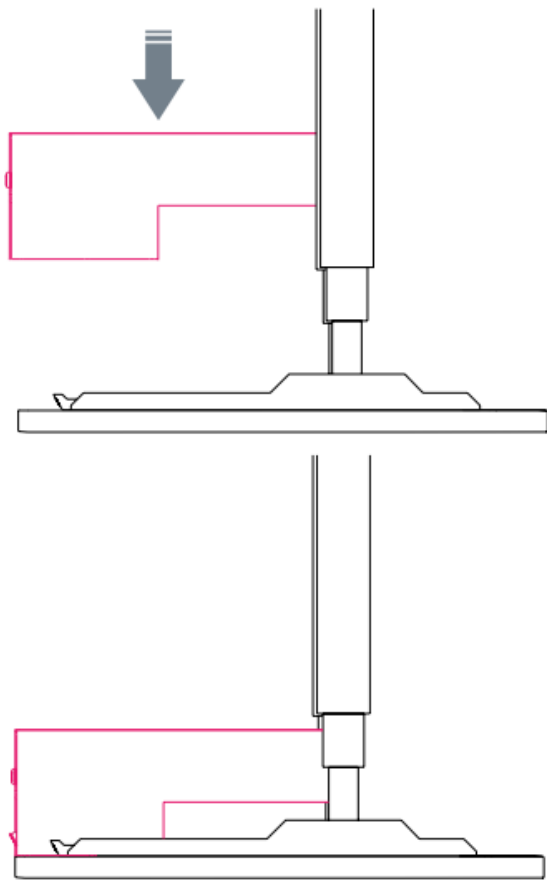

Choose left or right side of workstation to install storage drawer. Align front of drawer to edge of workstation surface.

NOTE: For Height-Adjustable Workstations: Drawer will be placed on inside of leg of workstation where back of drawer is free of obstruction.

Secure to Workstation

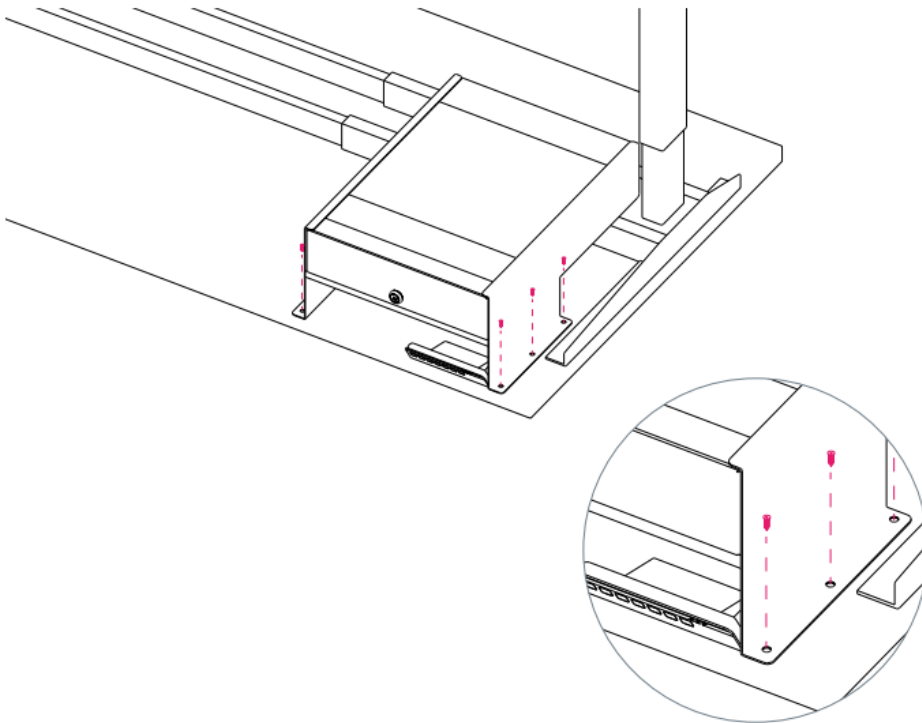

Using 6 wood screws, secure drawer to underside of surface.

NOTE: Placement may vary due to size and type of workstation.

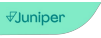
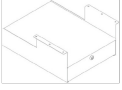

Documents / Resources

  <small>Personal Storage Drawer Under-Desk Mounting</small>	<p>Juniper Personal Storage Drawer [pdf] Installation Guide Personal Storage Drawer, Storage Drawer, Drawer</p>
------------------------------------------------------------------------------------------------------------------------------------------------------------------------------------------------------------------------------------------	-------------------------------------------------------------------------------------------------------------------------------------

References

- [Juniper | Office Furniture for the Entire Workspace](#)
- [User Manual](#)

Manuals+, [Privacy Policy](#)

This website is an independent publication and is neither affiliated with nor endorsed by any of the trademark owners. The "Bluetooth®" word mark and logos are registered trademarks owned by Bluetooth SIG, Inc. The "Wi-Fi®" word mark and logos are registered trademarks owned by the Wi-Fi Alliance. Any use of these marks on this website does not imply any affiliation with or endorsement.