



Juniper Networks AP45 Access Point Installation Guide

[Home](#) » [JUNIPER NETWORKS](#) » Juniper Networks AP45 Access Point Installation Guide 

Contents

- [1 Juniper Networks AP45 Access Point](#)
- [2 AP45 Hardware Installation Guide](#)
 - [2.1 Overview](#)
- [3 I/O ports](#)
- [4 AP45](#)
- [5 Mounting](#)
- [6 Technical Specifications](#)
- [7 Warranty Information](#)
- [8 Regulatory Compliance Information](#)
- [9 FCC Requirement for Operation in the United States of America:](#)
- [10 Documents / Resources](#)
- [11 Related Posts](#)



Juniper Networks AP45 Access Point



AP45 Hardware Installation Guide

Overview

The Mist AP45 contains four IEEE 802.11ax radios that deliver 4×4 MIMO with four spatial streams when operating in multi-user (MU) or single-user (SU) mode. The AP45 is capable of operating simultaneously in the 6GHz band, 5GHz band, and 2.4GHz band along with a dedicated tri-band scan radio.

I/O ports

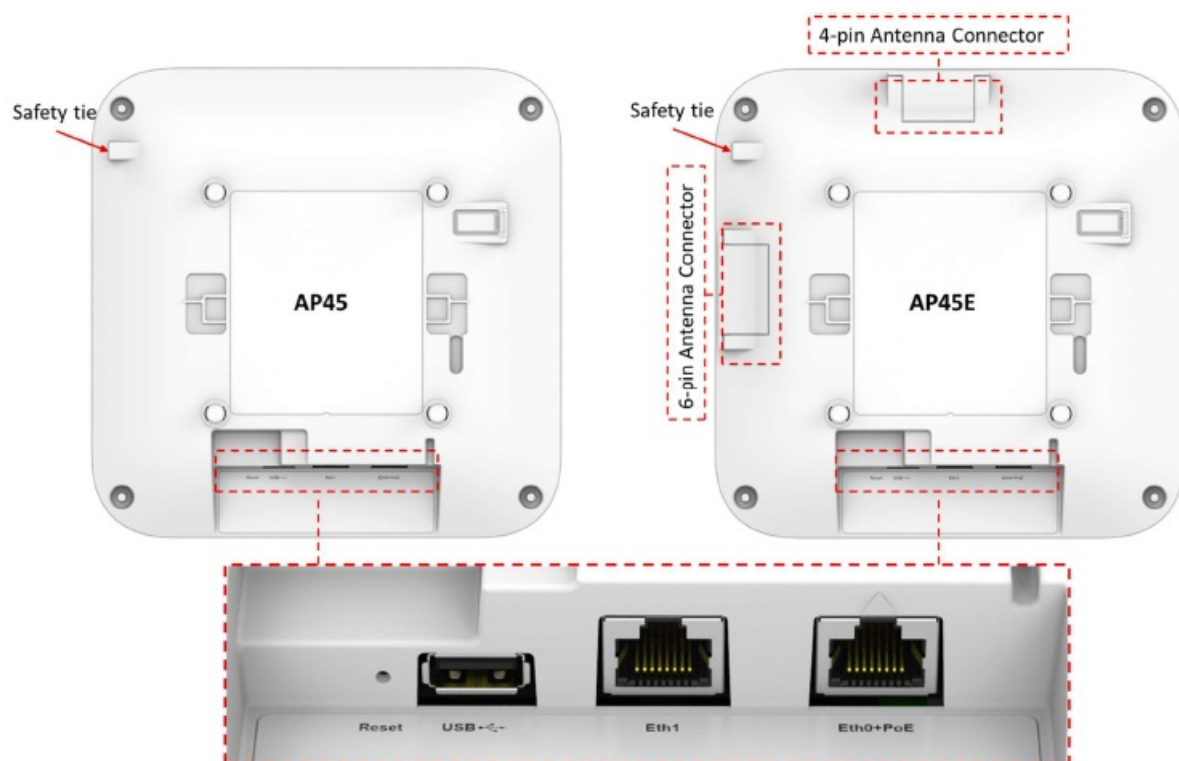

Reset	Reset to the factory default settings
Eth0+PoE-in	100/1000/2500/5000BASE-T RJ45 interface that supports 802.3at/802.3bt PoE PD
Eth1+PSE-out	10/100/1000BASE-T RJ45 interface + 802.3af PSE (if PoE- in is 802.3bt)
USB	USB2.0 support interface

AP45

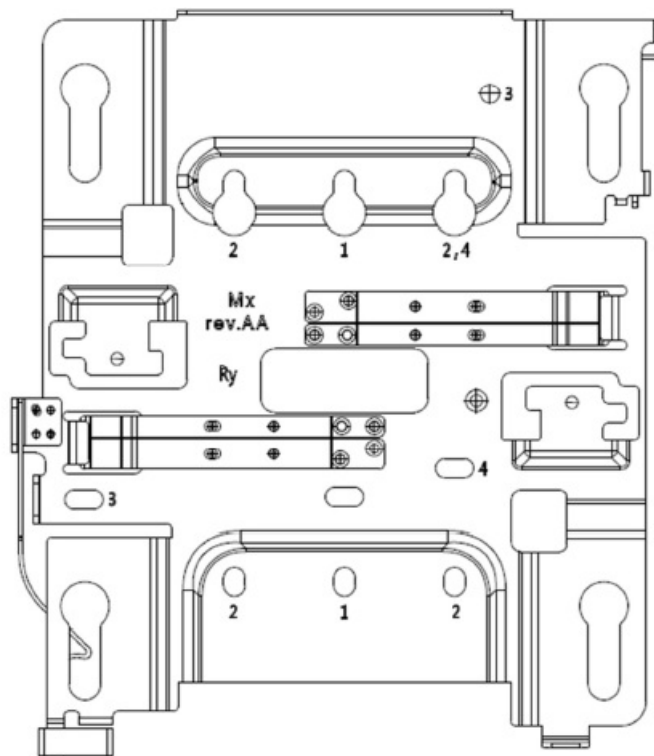

Mounting

In a wall mount installation, please use screws that have a 1/4in. (6.3mm) diameter head with a length at least 2 in. (50.8mm).

APBR-U that is in the AP45(E) box includes a set screw and an eyehook.

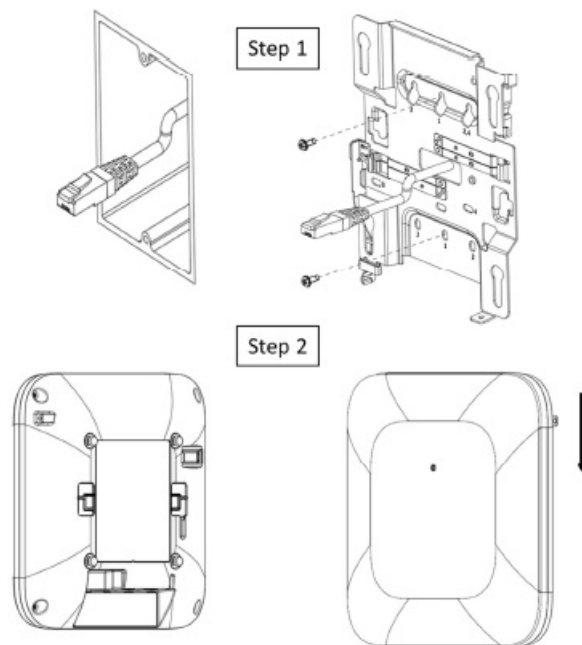
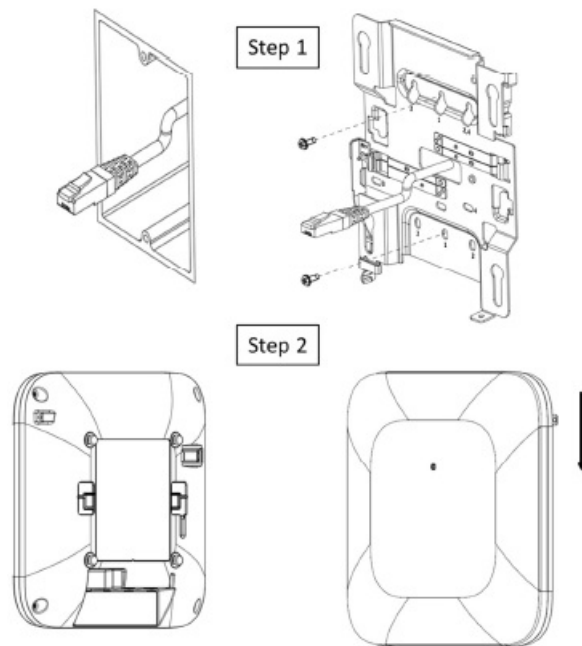
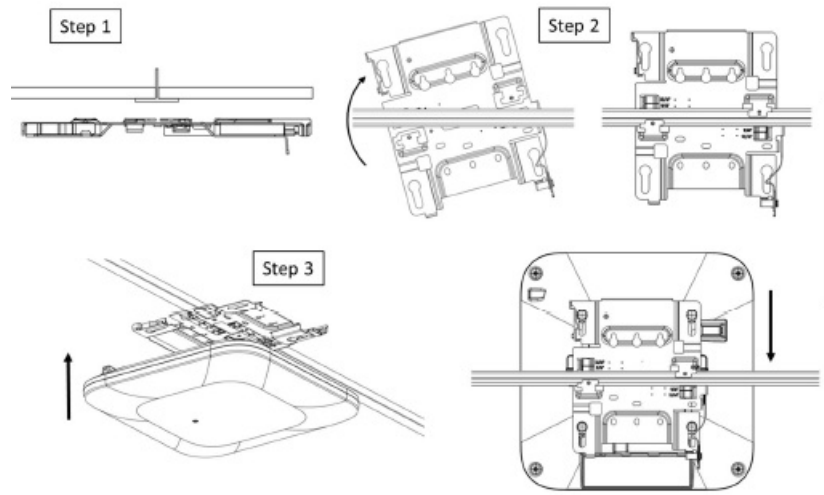

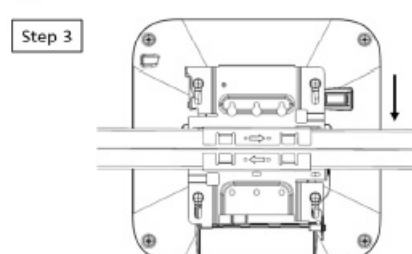
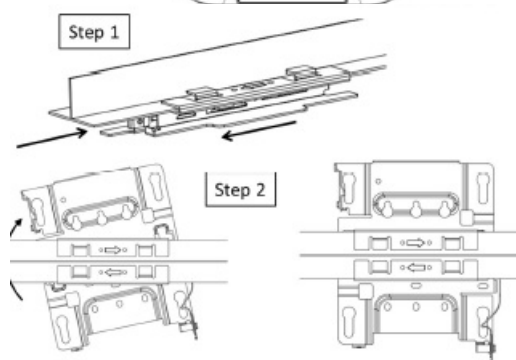
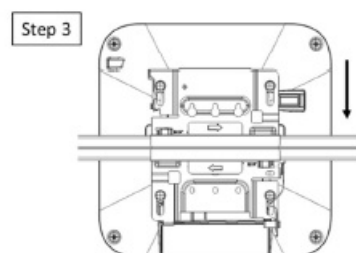
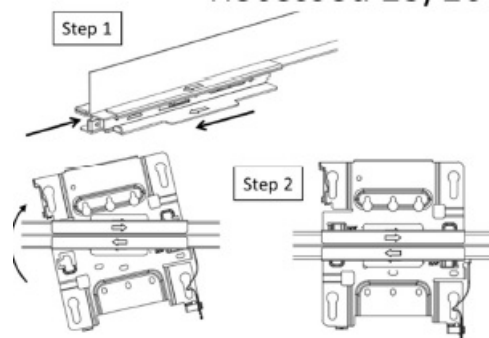
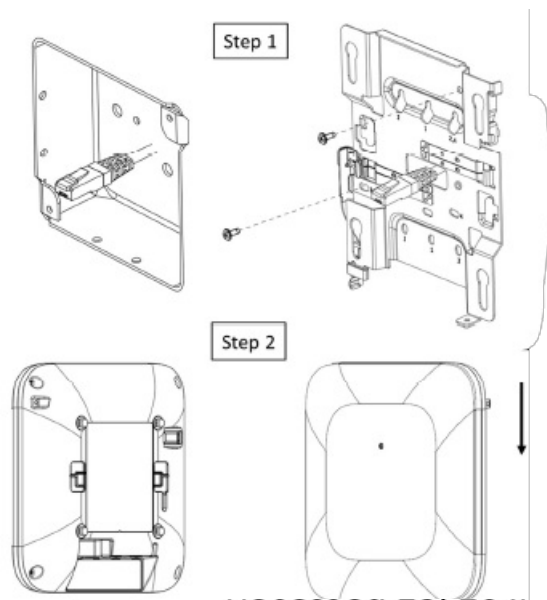

Technical Specifications

Feature	Description
Power options	802.3at/802.3bt PoE
Dimensions	230mm x 230mm x 50mm (9.06in x 9.06in x 1.97in)
Weight	AP45: 1.34 kg (2.95 lbs) AP45E: 1.30 kg (2.86 lbs)
Operating temperature	AP45: 0° to 40° C AP45E: -20° to 50° C
Operating humidity	10% to 90% maximum relative humidity, non-condensing
Operating altitude	3,048m (10,000 ft)
Electromagnetic emissions	FCC Part 15 Class B
I/O	1 – 100/1000/2500/5000BASE-T auto-sensing RJ-45 with PoE 1 – 10/100/1000BASE-T auto-sensing RJ-45 USB2.0
RF	2.4GHz or 5GHz – 4x4:4SS 802.11ax MU-MIMO & SU-MIMO 5GHz – 4x4:4SS 802.11ax MU-MIMO & SU-MIMO 6GHz – 4x4: 4SS 802.11ax MU-MIMO & SU-MIMO 2.4GHz / 5GHz / 6GHz scanning radio 2.4GHz BLE with Dynamic Antenna Array
Maximum PHY rate	Total maximum PHY rate – 9600 Mbps 6GHz – 4800 Mbps 5GHz – 2400 Mbps 2.4GHz or 5GHz – 1148 Mbps or 2400Mbps
Indicators	Multi-color status LED
Safety standards	UL 62368-1 CAN/CSA-C22.2 No. 62368-1-14 UL 2043 ICES-003:2020 Issue 7, Class B (Canada)

Warranty Information

The AP45 family of Access Points comes with a limited lifetime warranty.

Ordering Information:

Access Points

AP45-US	802.11ax 6E 4+4+4 – Internal Antenna for the US Regulatory domain
AP45E-US	802.11ax 6E 4+4+4 – External Antenna for the US Regulatory domain
AP45-WW	802.11ax 6E 4+4+4 – Internal Antenna for the WW Regulatory domain
AP45E-WW	802.11ax 6E 4+4+4 – External Antenna for the WW Regulatory domain

Mounting brackets

APBR-U	Universal AP Bracket for T-Rail and Drywall mounting for Indoor Access Points
APBR-ADP-T58	Adapter for 5/8-inch threaded rod bracket
APBR-ADP-M16	Adapter for 16mm threaded rod bracket
APBR-ADP-T12	Adapter for 1/2-inch threaded rod bracket
APBR-ADP-CR9	Adapter for channel rail and recessed 9/16" t-rail
APBR-ADP-RT15	Adapter for recessed 15/16" t-rail
APBR-ADP-WS15	Adapter for recessed 1.5" t-rail

Power Supply options

802.3at or 802.3bt PoE power

Regulatory Compliance Information

This product and all interconnected equipment must be installed indoors within the same building, including the associated LAN connections as defined by the 802.3at Standard.

Operations in the 5.15GHz – 5.35GHz band are restricted to indoor usage only.

If you need further assistance with purchasing the power source, please contact Juniper Networks, Inc.

FCC Requirement for Operation in the United States of America:

FCC Part 15.247, 15.407, 15.107, and 15.109

FCC Guideline for Human Exposure

This equipment complies with FCC radiation exposure limits set forth for an uncontrolled environment. This equipment should be installed and operated with minimum distance 26 cm between the radiator & your body.

This device complies with Part 15 of the FCC Rules. Operation is subject to the following two conditions:

1. This device may not cause harmful interference, and
2. This device must accept any interference received, including interference that may cause undesired operation.

This equipment has been tested and found to comply with the limits for a Class B digital device, pursuant to Part 15 of the FCC Rules. These limits are designed to provide reasonable protection against harmful interference in a residential installation. This equipment generates, uses and can radiate radio frequency energy and, if not installed and used in accordance with the instructions, may cause harmful interference to radio communications. However, there is no guarantee that interference will not occur in a particular installation. If this equipment does cause harmful interference to radio or television reception, which can be determined by turning the equipment off and on, the user is encouraged to try to correct the interference by one of the following measures:

- Reorient or relocate the receiving antenna.
- Increase the separation between the equipment and receiver.
- Connect the equipment into an outlet on a circuit different from that to which the receiver is connected.
- Consult the dealer or an experienced radio/TV technician for help.

FCC Caution

- Any changes or modifications not expressly approved by the party responsible for compliance could void the

user's authority to operate this equipment.

- This transmitter must not be co-located or operating in conjunction with any other antenna or transmitter.
- For operation within 5.15 ~ 5.25GHz / 5.47 ~5.725GHz / 5.925 ~ 7.125GHz frequency range, it is restricted to indoor environment.
- The 5.925 ~ 7.125GHz operation of this device is prohibited on oil platforms, cars, trains, boats, and aircraft, except that operation of this device is permitted in large aircraft while flying above 10,000 feet.
- Operation of transmitters in the 5.925-7.125 GHz band is prohibited for control of or Communications with unmanned aircraft systems.

Documents / Resources

 AP45 Hardware Installation Guide <small>Copyright © 2015 Juniper Networks, Inc. All rights reserved. This document is for internal use only. It is not to be distributed outside of Juniper Networks, Inc. or its subsidiaries. Juniper Networks, the Juniper logo, and other marks contained herein are trademarks of Juniper Networks, Inc. in the United States and other countries. All other marks contained herein are the property of their respective owners.</small>	Juniper Networks AP45 Access Point [pdf] Installation Guide AP45, 2AHBN-AP45, 2AHBNAP45, AP45 Access Point, Access Point
--	--

Manuals+