

JTECH LinkWear Core Manager Communications System



JTECH LinkWear Core Manager Communications System User Guide

[Home](#) » [JTECH](#) » JTECH LinkWear Core Manager Communications System User Guide 

Contents

- 1 JTECH LinkWear Core Manager Communications System
- 2 Product Information
- 3 Product Usage Instructions
- 4 Frequently Asked Questions (FAQ)
- 5 Identify Components
- 6 Usage Instructions
- 7 Addressing Range Issues
- 8 LinkWear Menus
- 9 Smart Band Assembly
 - 9.1 Inserting and Removing the Brain
- 10 Smart Band Operations
- 11 ABOUT COMPANY
- 12 Documents / Resources
 - 12.1 References



JTECH LinkWear Core Manager Communications System



Product Information

Specifications:

- **Power Supply:** 110-240v
- **Components:** Charger, Extender, Hub, Brains Smart Band, Bands, Tablet, Stand
- **Antenna:** 2 antennas required for proper functioning

Product Usage Instructions

• Step 1: Attach Antennas

Tightly connect the 2 antennas to the Hub by screwing them on by hand. Antennas should always point UP.

• Step 2: Hub Mount/Power

Mount the Hub on a flat surface in a central location in the middle of your building. Plug the power supply into a standard 110-240v outlet and then into the Hub. Ensure all antennas are pointed up.

• Step 3: Brain Charger Setup

Plug the power supply into a standard 110-240v outlet and then into the Charger. Ensure the switch is turned to ON. Store in a cool, dry place.

• Step 4: Charge LW Brain

Insert all Brains into the Charger and charge for 4 hours. Brains must be inserted properly for charging.

• Step 5: Tablet Mount/Power

Assemble the stand and mount the tablet. Plug the power supply into a standard outlet and then into the Tablet. Turn on the Tablet.

• Step 6: Connect Tablet to Hub

The Hub creates its own WIFI which the tablet connects to. Ensure the Tablet is connected to the Hub's WIFI network.

• Step 7: Range Test

Perform a Range Test to ensure coverage in all areas. Follow the steps provided in the manual for an accurate

test.

- **Step 8: Adding an Extender**

If needed, add an Extender to improve coverage in areas with weak signals.

- **Step 9: Assigning Smart Bands**

Assign Smart Bands at the beginning of each shift using the Tablet Settings.

- **Step 10: Send Messages to Smart Bands**

Utilize the LinkWear Dashboard on your Tablet to send messages to Smart Bands.

Frequently Asked Questions (FAQ)

- **What should I do if the Smart Bands show weak signal during the Range Test?**

If there are areas of weak signal, consider adding an Extender to improve coverage.

- **How long should I charge the LW Brains?**

Charge the LW Brains for 4 hours for optimal performance.

Identify Components



1. Charger
2. Extender
3. Hub
4. Brains
5. Bands
6. Tablet
7. Stand
8. Power Supplies (not shown)

Usage Instructions

- **STEP 1 Attach Antennas**

Tightly connect the 2 antennas to the Hub by screwing them on by hand. Antennas should always point UP.



- **STEP 2 Hub Mount/Power**

Mount the Hub on a flat surface, in a cool, dry, metal free, central location in the middle of your building. The ideal height for mounting the hub is above 8'. Plug the power supply into a standard 110-240v outlet and then into the Hub. When plugged in a red light will show, followed by a flashing blue light after 3 minutes to indicate ready status. Ensure all antennas are pointed up.

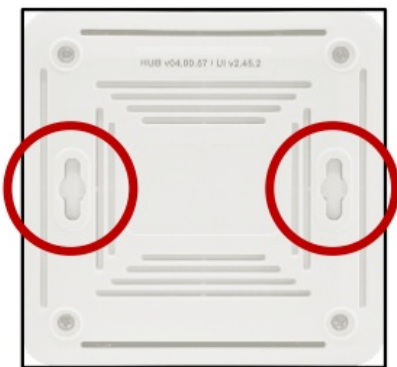

- **STEP 3 Brain Charger Setup**

Plug the power supply into a standard 110-240v outlet and then into the Charger. Ensure that the switch is turned to ON, a red light will show next to power. Store in a cool, dry & safe place (like the office).



- **STEP 4 Charge LW Brains**

Insert all Brains (removed from the band) into the Charger and charge for 4 hours. All Brains must be inserted as shown or they will not charge. Display will read "Charging" when inserted properly. Brains stay in charger when not in use.



• STEP 5 Tablet Mount/Power

Assemble the stand and place in the desired location. Mount the tablet. Plug the power supply into a standard 110-240v outlet and then into the Tablet. Turn the Tablet on by pressing and holding power button on the left side of tablet. ****Keep away from heat lamps****



• STEP 6 Connect Tablet to Hub

- Swipe down from the top of the screen.
- Press and hold the WiFi icon to open WiFi settings.
- Select your LinkWear Hub (ex. LinkWear 00xxx).
- Once connected press center home button.
- Tap the LW Dashboard icon. To start the application.

Note: This system uses WIFI but not the internet. The Hub creates its own WIFI which the tablet connects to.



**A surge protector is recommended for all LinkWear devices.*

• STEP 7 Range Test

Perform a Range Test to ensure all areas of your location have coverage. To accurately test the range of your system you will need your Hub, Tablet, and Smart Bands to be ON and charged.

1. Tap Settings and Range Test
2. Turn on the Range Test, then remove two Brains from the Charger and insert into bands.
3. Place one Smart Band on each wrist.
4. Every 15 seconds the Smart Bands will vibrate and show if the range is strong (4 green bars) or weak (1 green bar).
5. Walk the entire coverage area with the Smart Bands, noting areas that have poor coverage.

If both the Smart Bands received any level signal in your coverage area, move on to step 8. If there are areas where both bands received weak and/or no alerts in the same area, you should add an Extend.

• STEP 8 Adding an Extender

- Extends come pre-configured to system
- The Range Extender comes with an attached power brick
- Requires a standard 110-240v outlet
- Plug in the Range Extender right on the fringe of area where coverage is weak
- For Multiple Extenders, rename each Range Extender in the software with an identifying name so they are easily located

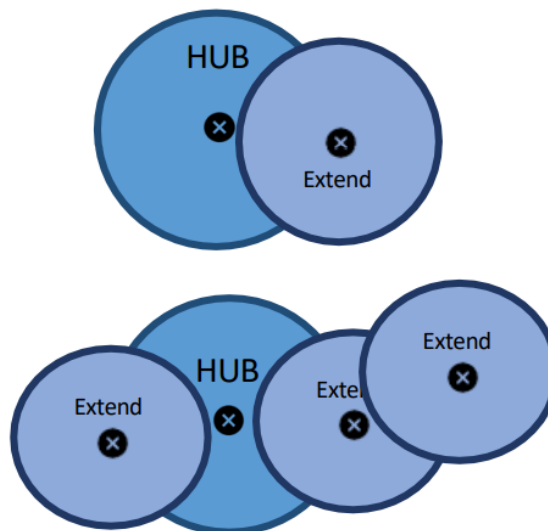

• STEP 9 Assigning Smart Bands

Assign Smart Bands at the beginning of each shift.

1. On the Tablet Settings, tap Assignment in the top right corner.
2. You will see a list of all paired Smart Bands (ex. SB-01). Tap your current Smart Band to open the assignment window.
3. Tap Create or Edit Person. Enter the employee's first and last name. Next, choose staff or management and what role should be assigned to them. If the employee has already been created, search their name by selecting Search Person.
4. After entering the information, tap Save. The Smart Band will be displayed under Manager or Staff – assigned to that employee.
5. Repeat steps 2-4 for all Smart Bands.

Note: Placing a Smart Band back into the charger will erase all messages and takes the Smart Band off the LinkWear Dashboard.

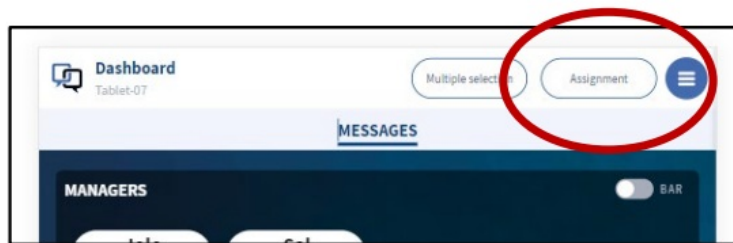

• STEP 10 SendMessage Smart Bands

1. Hand out the assigned Smart Bands to each employee.
2. Navigate to the LinkWear Dashboard on your Tablet.
3. You will see a list of Smart Bands under manager and staff.
4. To send the default message, tap on the employee's name.
5. To send a predefined message, hold on the employee's name for 3 seconds and then release. A popup screen will list all predefined messages. Tap on the message you want to send.
6. Tap "Multiple Selection" for custom messages and more message options.

Addressing Range Issues

- Fringe areas can receive messages, but you are getting close to the limit of the range. When the messages stop you have exceeded the fringe area. This can be caused by:
 - General range limits
 - Obstructions – Metal, elevators, freezers, etc.
 - Multiple levels
- If you exceeded any fringe areas (red bar), you can extend range by:
 - Moving the hub to a more central location
 - Mounting the Hub higher or different location
 - Adding range extender(s) to your system
- After moving the Hub or adding range extender(s), repeat these steps to verify the area has adequate coverage.

NOTE: Some reflective window coverings have been shown to significantly reduced coverage outside of the

window. Should you discover this issue is reducing your systems range, please call our support team for solutions.

LinkWear Menus

Click the Hamburger Stack Icon to access the various LinkWear Menus.

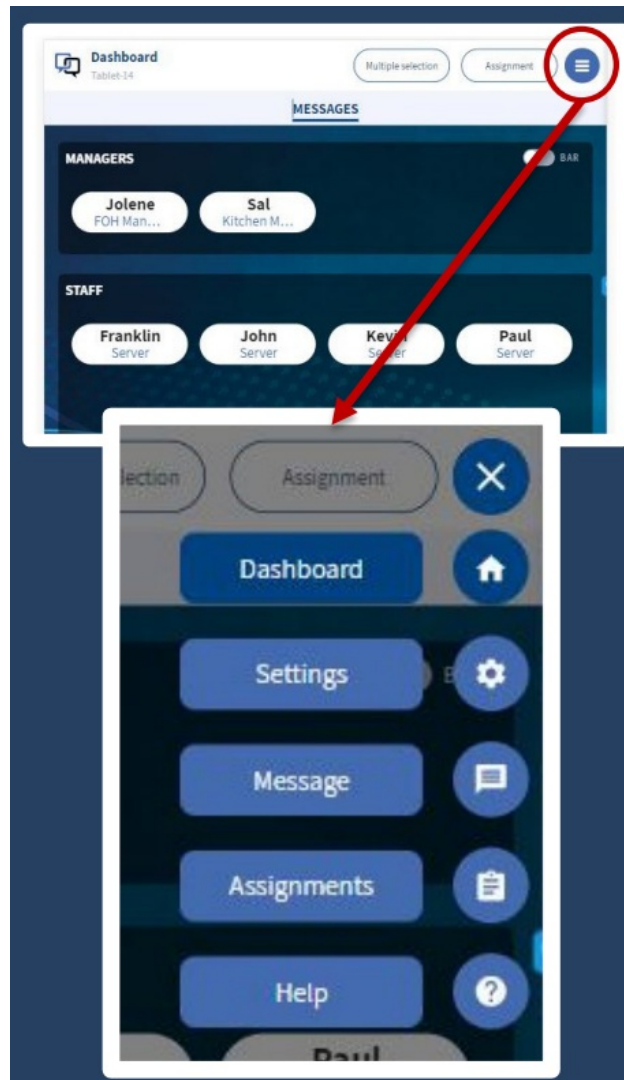

Smart Band Assembly

Smart Bands are key part of the LinkWear system. At the beginning of each shift employees should take a fully charged smart band and assign it to themselves with the appropriate role for that shift.

Inserting and Removing the Brain

- **Inserting**

- Insert the USB end into the slot on the band side with the holes as far as you can.
- Push down on the brain while pulling up on the clasp side of the band to seat the brain.

- **Removing**

- Pull down on the clasp side of the band while pushing up on the same side of the brain.
- Grab the brain and pull it away from the band while holding the side of the band with the holes.

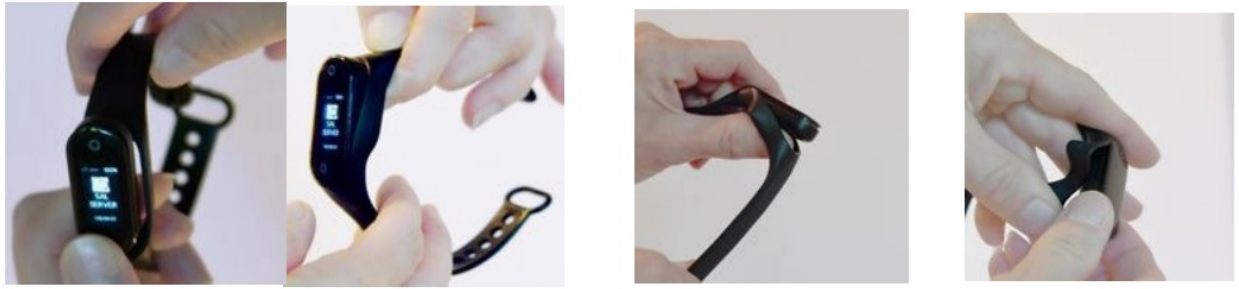

Smart Band Operations

- **Power On** – Hold bottom and top for 2 seconds.
- **Activate Sleep Mode** – Do not touch for 10 seconds.
- **Go to Message Screen from Standby Screen** – Touch and hold bottom for 2 seconds.
- **Look through Messages from Message Screen** – Tap top to scroll up and tap bottom to scroll down.
- **Look through Responses from Message Screen** – Touch and hold bottom for 2 seconds to see and scroll through all responses.
- **Select and Send Response** – When desired response is on the screen, tap and hold bottom for 2 seconds to send response.
- **Connection/Pairing Mode** – Touch and hold top and bottom buttons for 10 seconds and release. Mode will time out in 20 seconds.

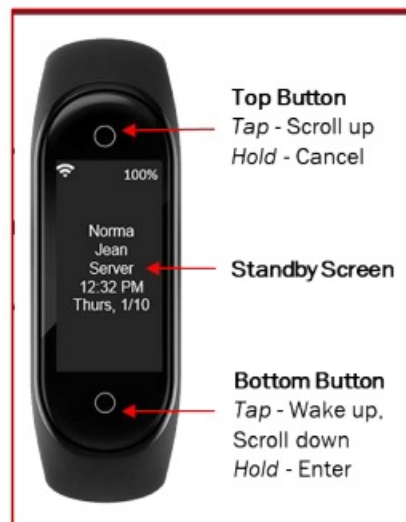

ABOUT COMPANY

- 800.321.6221
- www.JTECH.com
- wecare@jtech.com

Documents / Resources



[JTECH LinkWear Core Manager Communications System](#) [pdf] User Guide
LinkWear Core Manager Communications System, Manager Communications System, Communications System, System

References

- [User Manual](#)

[Manuals+](#), [Privacy Policy](#)

This website is an independent publication and is neither affiliated with nor endorsed by any of the trademark owners. The "Bluetooth®" word mark and logos are registered trademarks owned by Bluetooth SIG, Inc. The "Wi-Fi®" word mark and logos are registered trademarks owned by the Wi-Fi Alliance. Any use of these marks on this website does not imply any affiliation with or endorsement.