



JOYDECO SC0003-BL-27-V2 Cordless Zebra Roller Shade Instruction Manual

[Home](#) » [JOYDECO](#) » JOYDECO SC0003-BL-27-V2 Cordless Zebra Roller Shade Instruction Manual 

JOYDECO



**Cordless Zebra
Roller Shade
Installation Instructions**

Contents

- [1 COMPONENTS LIST](#)
- [2 TOW INSTALLATION METHODE](#)
- [3 Documents / Resources](#)
 - [3.1 References](#)
- [4 Related Posts](#)

COMPONENTS LIST

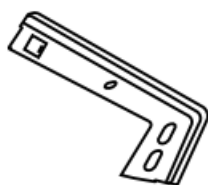

L-bracket × 2

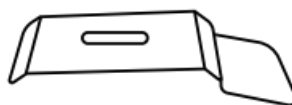

C-bracket × 2



Screw × 5



Expansion Bolt × 5

NOTE: If any of them are missing or damaged, please feel free to contact us.

TOOLS AND FASTENERS YOU MAY NEED (PACKAGE NOT INCLUDED)



Drill with Bits



Metal Tape Measure



Screwdrivers



Pencil

TOW INSTALLATION METHODE

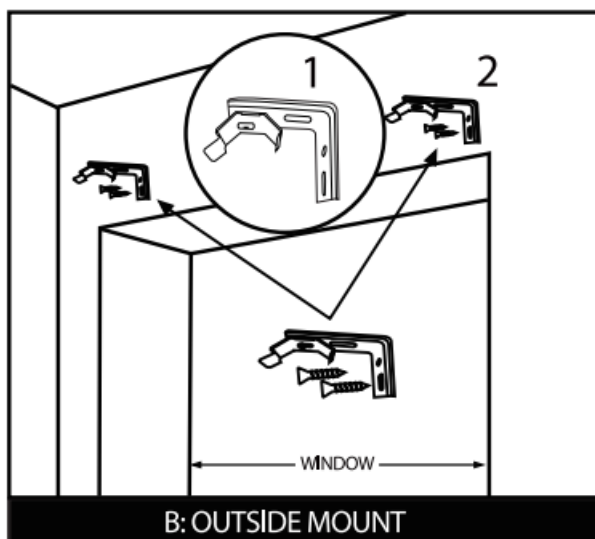
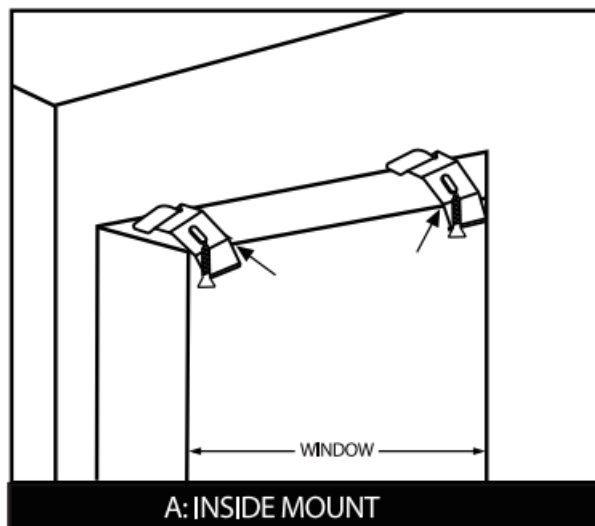

Note:

Ensure the two brackets are installed symmetrically at the same height, depth, and both vertical to the the window frame.

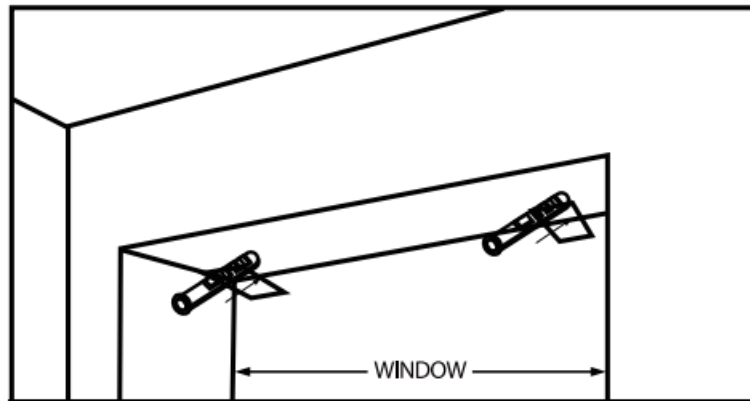
A. INSIDE MOUNT

1. Mark and drill two holes at the same depth within the window frame symmetrically, put the expansion bolts into the holes.

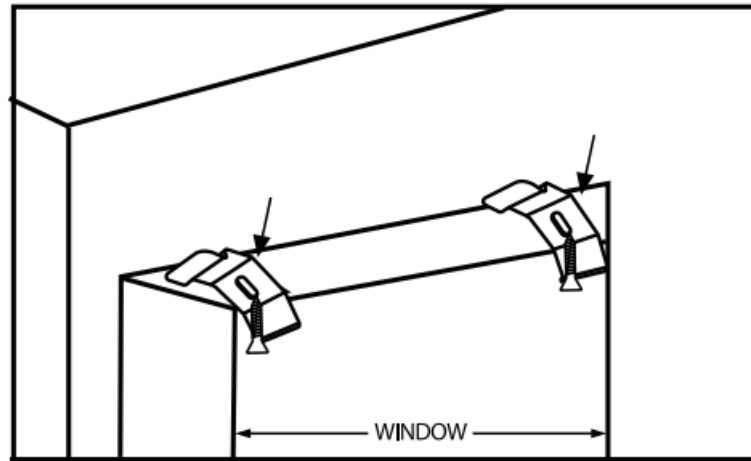

2. Fix two C-brackets with screws and ensure they are aligned.

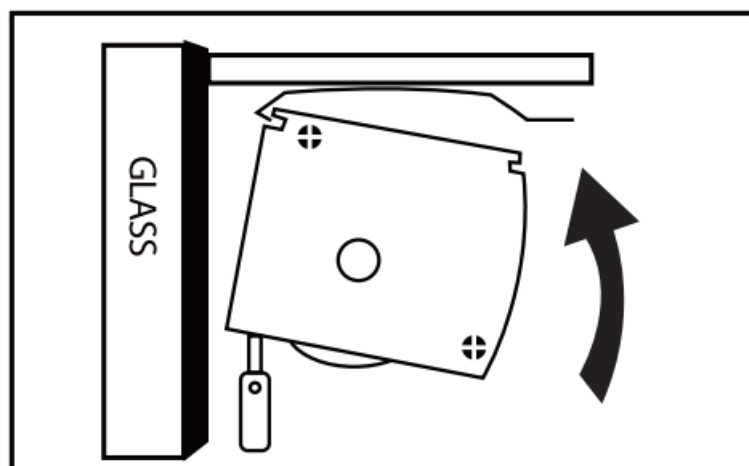

3. Place the rear groove of the headrail into the bracket, rotate the headrail upwards to place it into the bracket completely.

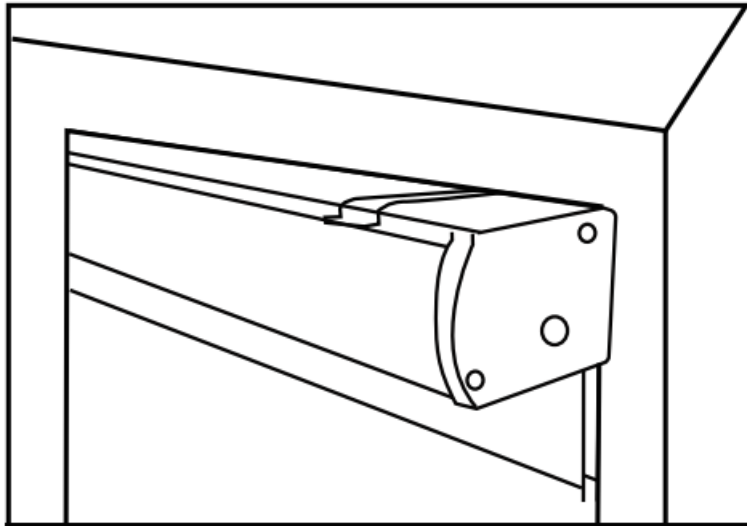

4. Finish installation when you hear “click”.

B-1. OUTSIDE MOUNT

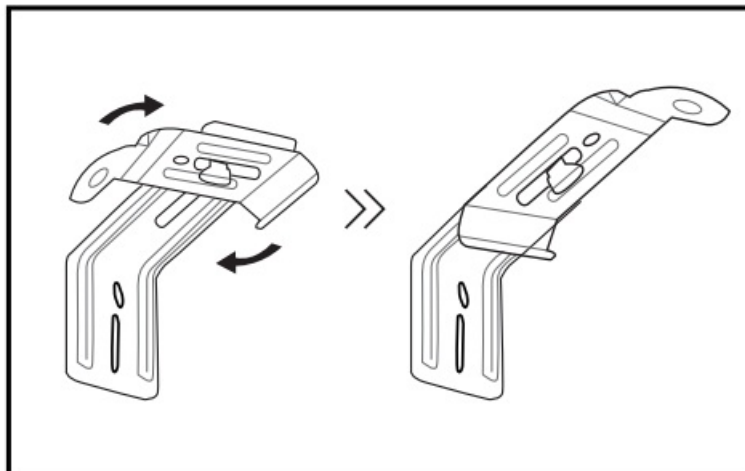

1. Connect the L-bracket and the C-bracket, turn the C-bracket 90 degree to tighten, ensure the C-bracket is vertical to wall.

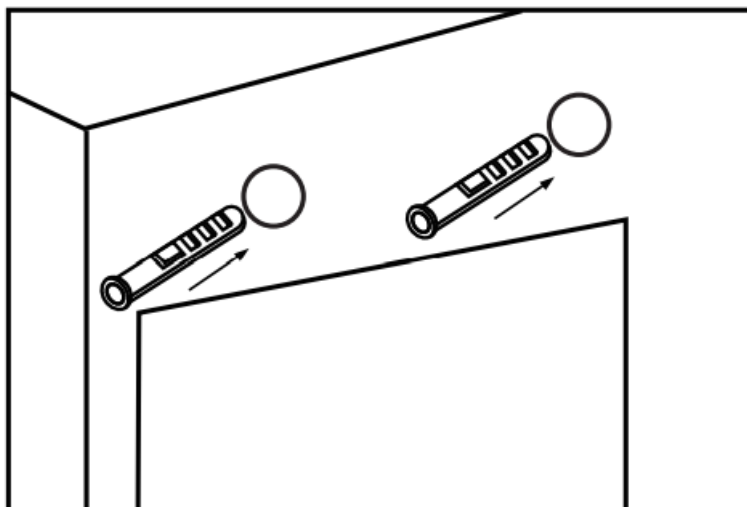

2. Mark and drill two holes at the same height above the window frame symmetrically, put the expansion bolts into the holes.

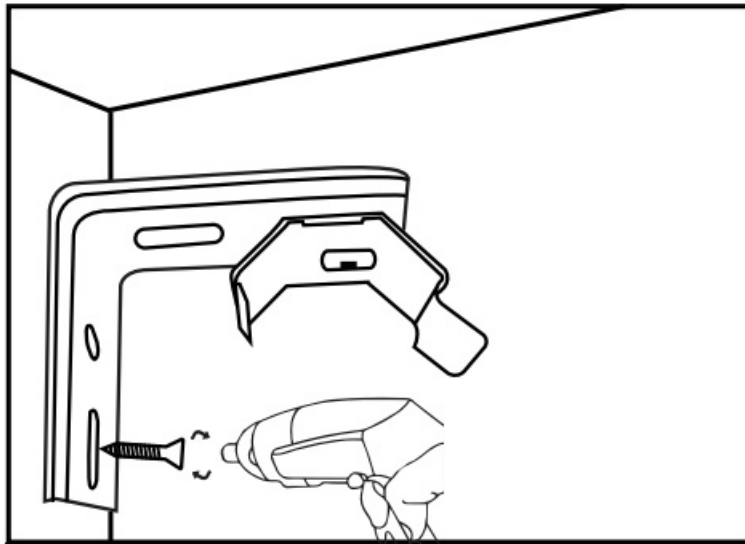

3. Fix the bracket (assembled in step 1) to the wall.

B-2. OUTSIDE MOUNT

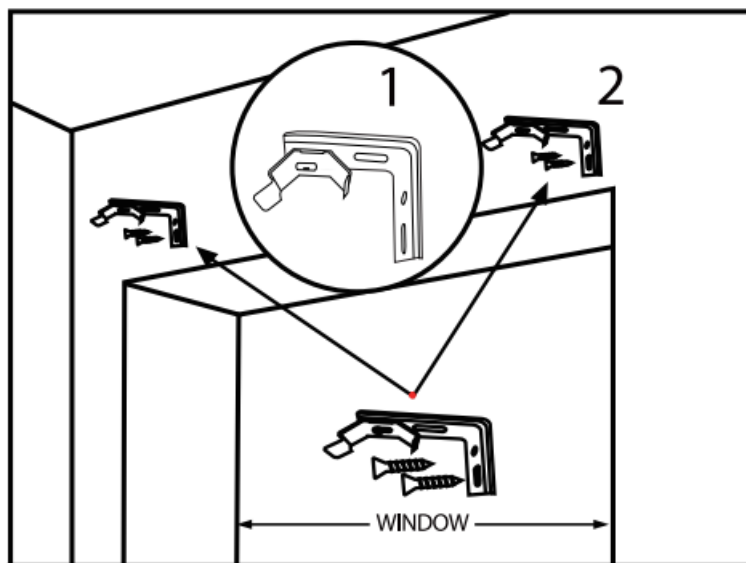

4. Fix another bracket on the wall. Ensure they are aligned.

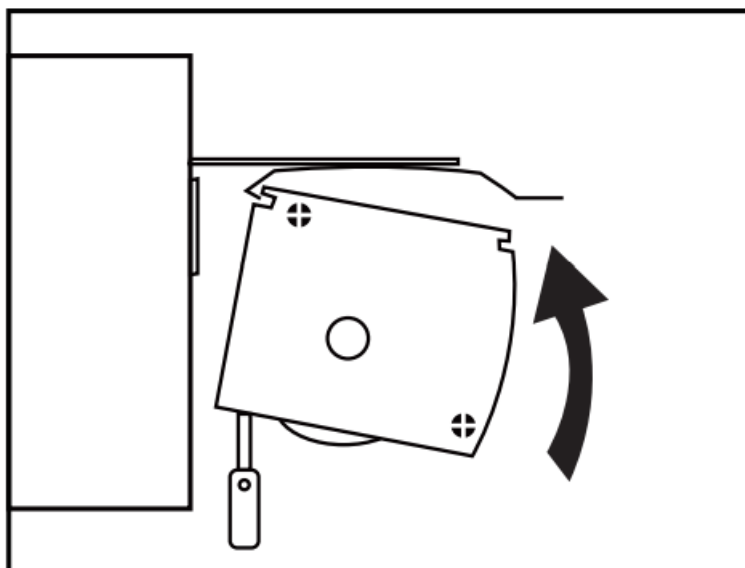

5. Place the rear groove of the headrail into the the bracket, rotate the headrail upwards to place it into the bracket completely.

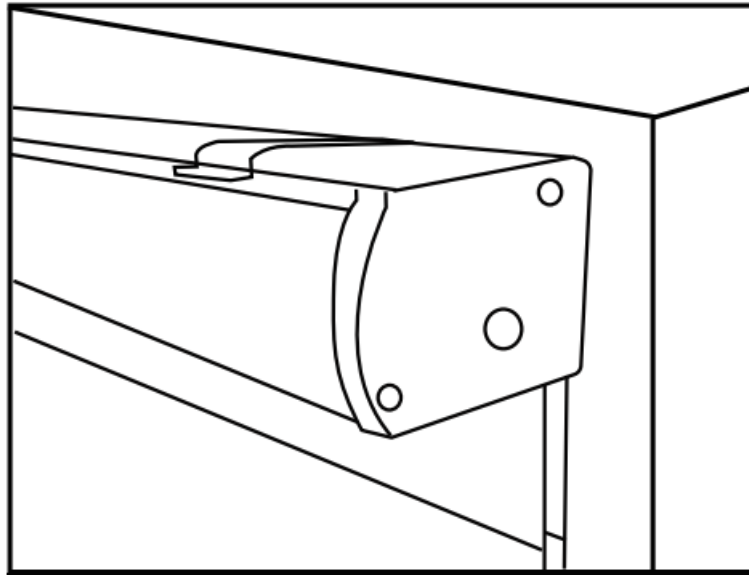

6. Finish installation when you hear “click”.

Documents / Resources



[JOYDECO SC0003-BL-27-V2 Cordless Zebra Roller Shade](#) [pdf] Instruction Manual
SC0003-BL-27-V2 Cordless Zebra Roller Shade, SC0003-BL-27-V2, Cordless Zebra Roller Shade, Zebra Roller Shade, Roller Shade, Shade

References

- [User Manual](#)