



JOWAVE G3 Bluetooth Headset User Manual

[Home](#) » [JOWAVE](#) » JOWAVE G3 Bluetooth Headset User Manual 

JOYWAVE

(G3)
BUSINESS HEADSET



User Manual

Contents

- 1 WELCOME
- 2 PACKAGE LIST
- 3 PRODUCT OVERVIEW
- 4 PAIRING AND CONNECTION
- 5 Wireless Headset Connection
- 6 BASIC OPERATION
- 7 HOW TO CHARGE
- 8 TROUBLE SHOOTING
- 9 SAFETY INSTRUCTION
- 10 PRODUCT PARAMETERS
- 11 Documents / Resources
 - 11.1 References

WELCOME

Thank you for choosing the “G3” Wireless Headset. Please read the below instructions carefully before using. It will help you set up and operate this product properly and enjoy the advanced features.

No matter any questions, such as item broken or missing accessories when you received the package, please contact our customer service team, we will do our best to give you a satisfactory answer.

✉ 24 Hours customer service team: support@playoung.cn

🌐 Website: www.playoung.cn



www.playoung.cn

PACKAGE LIST

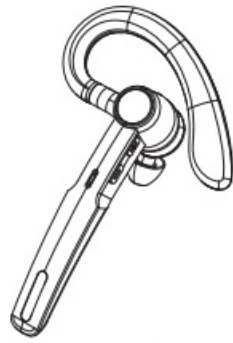

Headset *1

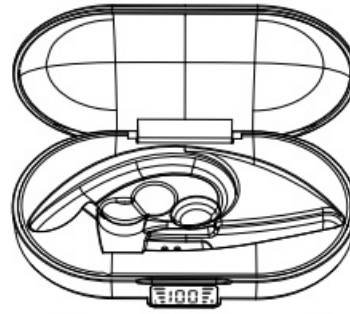

Charging Case*1



Charging Cable *1



Eartips*2

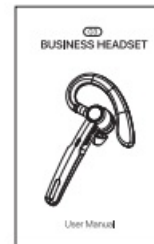

User Manual *1

PRODUCT OVERVIEW

HOW TO WEAR THE HEADSET

1. Adjust the angle of the earhook and the microphone boom, and then hang the earhook on your auricle.
2. After you adjust the ear hook, you can hold on to the earplug to adjust the ear tips angle to find a suitable position then you can wear the headset in your ear canal comfortably.

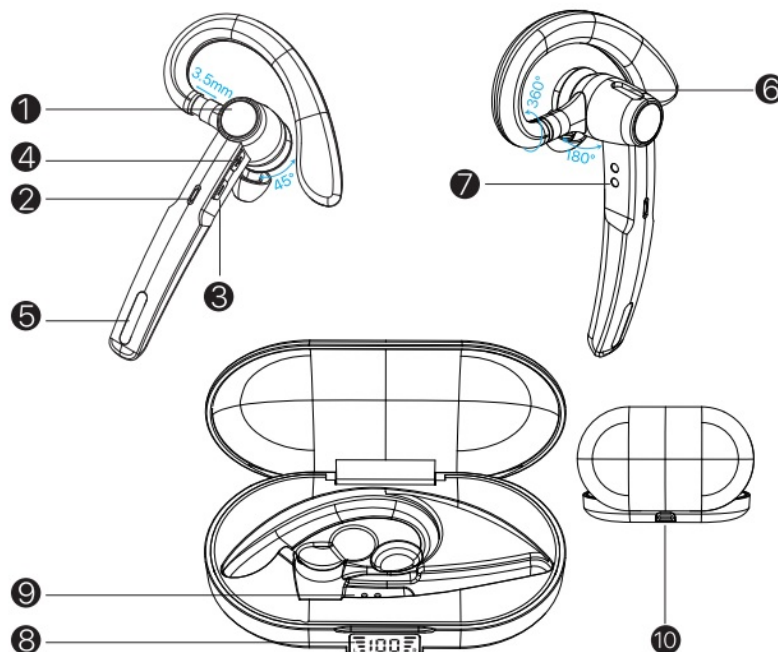

1. MFB (Multi Function Button)
2. LED Indicator
3. Volume+

4. Volume-
5. Microphone
6. TYPE-C Charging port
7. Charging Pin
8. Battery Power Display
9. Charging Pin
10. TYPE-C Charging port

PAIRING AND CONNECTION

Step1

1. Open the charging case and take out the earbud Earbud, it will power on auto and the light will flash (Blue and Red) with a voice prompt "Power on", will enter pairing mode, and with a voice prompt "Pairing"
2. In off status, press the "MFB" button 3s to power on and auto enters into pairing mode with the Indicator light flashing blue 10 times and then flashing red-blue alternately.

Step2

1. Turn on the Bluetooth function on your phone via 'Setting'>'Bluetooth On';
2. Tap on "G3" on the retrieved device to connect;
3. After connecting is completed, the earbud will respond with a voice prompt "Connected".
4. You can use the Bluetooth headset to listen to music or on a Call.

The next time you use this earbud, just need to take out the Bluetooth earbud from the charging case and turn on the Bluetooth function of the smart device to automatically connect.

Wireless Headset Connection

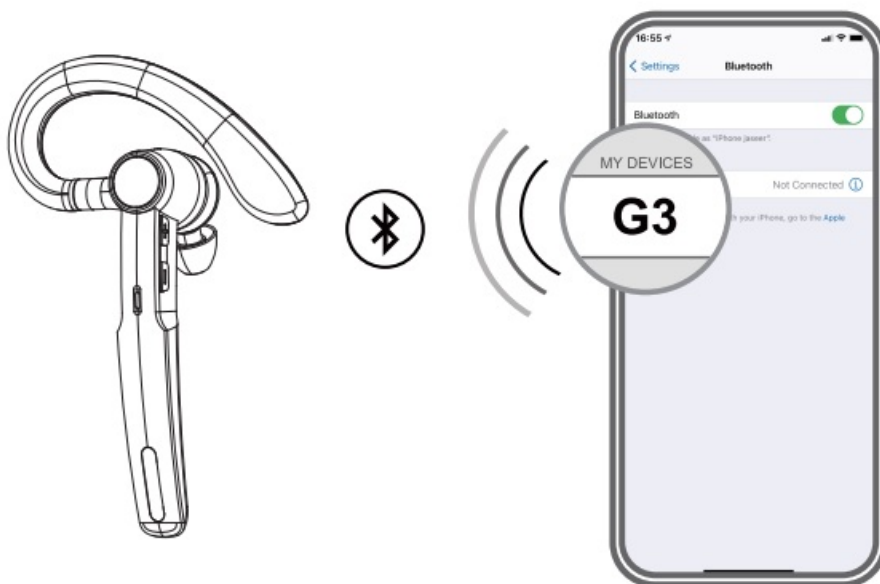

BASIC OPERATION

Function	Operation	LED	Beep
Power on	In off status, touch and hold “MFB” button for 2s to power on.	Indicator light flashes blue 3 times.	Power on
Power off	In off status, touch and hold “MFB” button for 5s to power on.	Indicator light flashes red 3 times.	Power off
Enter into pairing mode	When you take it out of the charging case, it automatically enters pairing mode.	Indicator light flashes blue 10 times and then flashes red-blue alternately.	Pairing
Pairing completed	/	Indicator light off	Connected
Answer a call	Short touch “MFB” button(when call coming)	/	/
Hang up a call	Short dual touch ,’MFB” button (during a call)	/	/
Reject a call	Tbouuttcohnafnodr 2holds (w”hMeF n call coming)	/	/
Mute/ Unmute	Double press “—” button(during a call)	/	Mute on/ Mute off
Redial a call	Double touch “MFB” button.	/	/
Play / Pause	Short touch “MFB” button when play music.	/	/
Siri	Touch and hold “MFB” button for 1 second to activate “Siri” in standby state.	Indicator light flashes blue.	/
Volume up	Short press “+” button.	/	/
Previous song	Press and hold “+” button.	/	/
Volume down	Short press “—” button.	/	/
Next song	Press and hold “—” button.	/	/
When charging the headset	/	Indicator light is red solid.	/
When the headset is full charged	/	Indicator light is blue solid.	/
Initialize	While charging, touch and hold “MFB” button.	Indicator lightflashes red-blue alternately.	/

HOW TO CHARGE

1. Charging with Type-C Cable

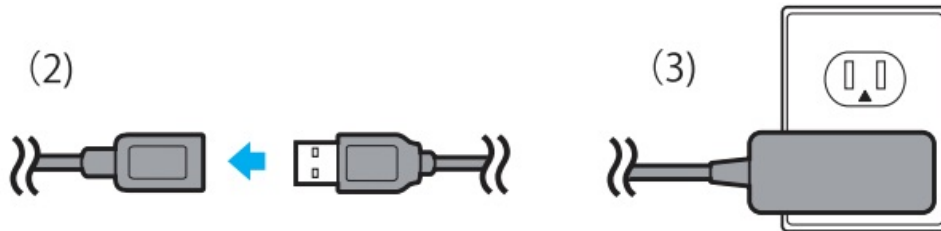
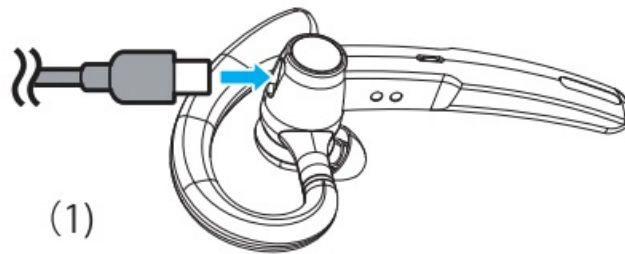

Headset

Charging: Red light

Fully Charged: Blue light

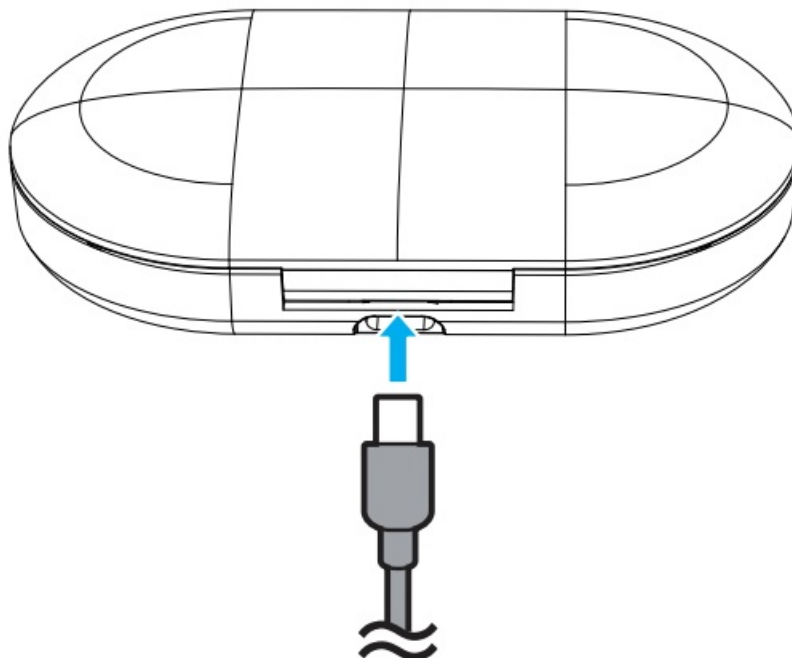

Charging Case

The number on the right side of the battery display will flash.

2. Charging with Charge Case

(1). Put the headset in the charging case. (Please attach the charging pin of the headset and charging case exactly.)

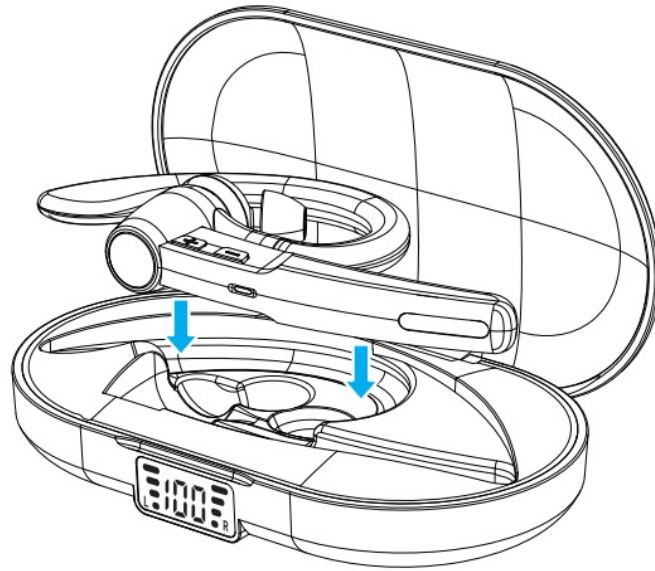

(2). Closing the lid, and the two utility poles beside the number will flash. The two poles will flash 3 times and then the lights will stay on when the headset is fully charged.

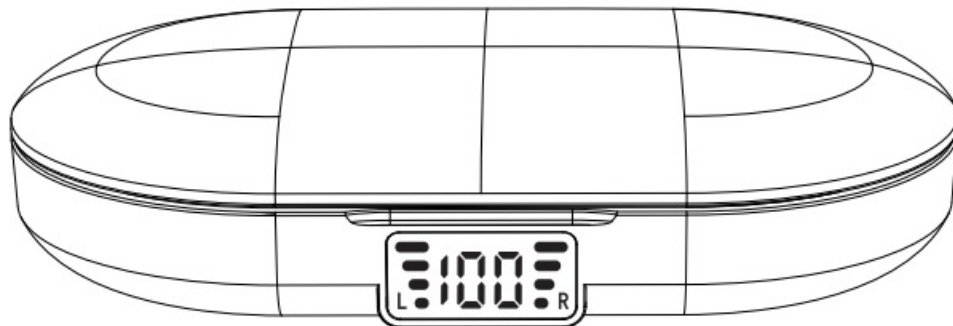

NOTE:

When using the headset for the first time, please fully charge the battery. (Be sure to charge it with the included TYPE-C cable.)

The number displayed on the LED is the battery level of the charging case, not the of the headset. The headset battery level can be displayed on the connected device.

TROUBLE SHOOTING

1. The headset cannot be connected to the smart device:

1. Confirm the status of the Bluetooth function;
2. Turn off the Bluetooth function of your device, delete the historical connection, and pair again;
3. Please try to connect other accessories devices.

2. The headset can not be charged:

1. Make sure that the headset is correctly placed/stored in the charging case.
2. Confirm the battery capacity of the charging case.
3. Check whether the charging contact point of the charging case or headset has a spot or not.

3. The headset does not respond:

Put the headset in the charging case back, close the lid, and wait another 1 minute or so, then take out the headset, and try to connect again.

4. The charging case cannot be charged:

1. Check whether the charging cable is tightly connected to the charging case.
2. Check the remaining battery capacity.
3. Replace another charge cable

5. The headset has no sound:

1. Check whether the audio track is played via the smartphone application.
2. Check whether the headset battery was run out of.
3. Increase the volume of headset and mobile devices (or music playback applications).
4. Make sure that the correct mobile device is connected.
Please try to connect to other mobile devices.
5. Please try to connect other accessories devices.

SAFETY INSTRUCTION

1. Do not charge the battery for too long, be sure to disconnect the connection cable after charging. (1.5H)
2. When the product is not used for a long period, please charge it once a month.
3. Do not charge the product near a wet source. It may cause fire or malfunction due to electric shock or short circuit.
4. To protect your ears, Please reduce the volume before use, and do not turn the volume up too loud.
5. If the product is dropped into a flammable liquid such as water, please stop using it and contact the store where you purchased it or us. If it continues to be used it may lead to fire, malfunction, or electric shock.
6. Do not touch the interior. and opening the interior may result in malfunction or electric shock. In addition, we do not guarantee performance if the interior has been modified.
7. Do not charge with wet hands or touch the charging port.
It may cause electric shock.
8. If you feel uncomfortable while using this product, please stop using it immediately.
9. If you are using a medical device such as a pacemaker, please consult your doctor before use.
10. Do not allow children to use it. (Less than 3 years old)

PRODUCT PARAMETERS

Model:	G3
Chips Version:	V5.2
Voltage:	DC4.7-5V/1A
Headset Capacity:	105mAh
Charge Case Capacity:	400mAh
Net of Headset:	16.5g
Net of Charge Case:	61g
Charge Time (Headset):	1.5H
Charge Time (Charge Case):	1.5H
Support System:	OS/Android/Windows
Transmission Range:	33feet(10m)



C&E Connection E-commerce (DE) GmbH
Zurn Linnegraben 20, 65933, Frankfurt am Main, Germany



Made in China

Documents / Resources

	<p>JOWAVE G3 Bluetooth Headset [pdf] User Manual G3 Bluetooth Headset, G3, Bluetooth Headset, Headset</p>
-------------------------------------------------------------------------------------	-------------------------------------------------------------------------------------------------------------------------------

References

- [User Manual](#)

[Manuals+](#), [Privacy Policy](#)

This website is an independent publication and is neither affiliated with nor endorsed by any of the trademark owners. The "Bluetooth®" word mark and logos are registered trademarks owned by Bluetooth SIG, Inc. The "Wi-Fi®" word mark and logos are registered trademarks owned by the Wi-Fi Alliance. Any use of these marks on this website does not imply any affiliation with or endorsement.