



JOTUL C 620 Fan That Increases Air Circulation Instruction Manual

[Home](#) » [Jotul](#) » JOTUL C 620 Fan That Increases Air Circulation Instruction Manual 

Contents

- [1 JOTUL C 620 Fan That Increases Air Circulation](#)
- [2 Installation](#)
- [3 Safety precautions](#)
- [4 Documents / Resources](#)
 - [4.1 References](#)
- [5 Related Posts](#)



JOTUL C 620 Fan That Increases Air Circulation



Jøtul C 620 has a fan solution that increases air circulation in the convection chamber, thereby effectively warming the room and providing enhanced comfort.

Installation

Check that all the parts are included in the package:

- Fan
- Installation manual
- Bag of screws and cable ties
- Control box
- Cable and plug

Fig 1

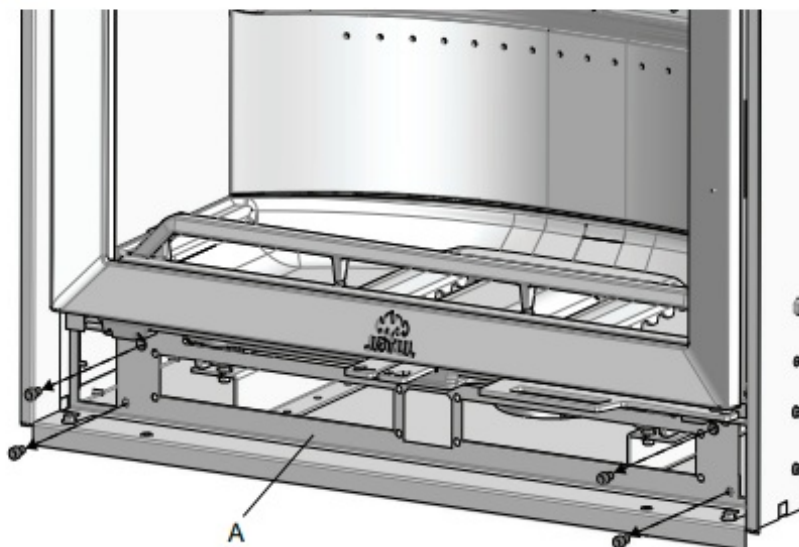

1. Unscrew the 4 screws securing the front bracket (A) with a 5 mm Allen key.

2. Tilt out the front bracket (A).

Fig 2

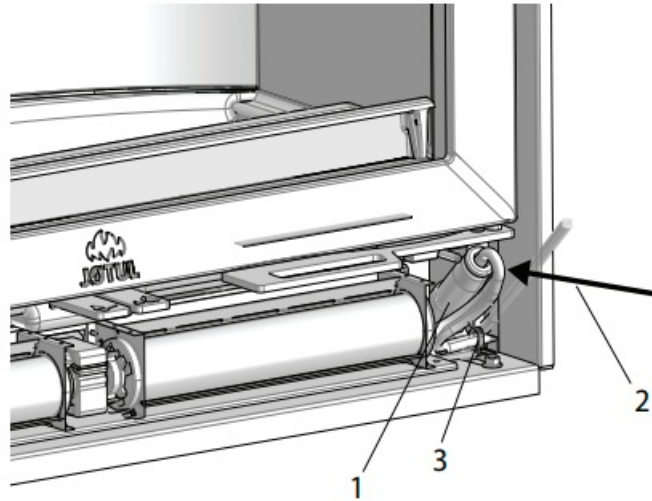

1. Use pliers to remove the cable lid.

Fig 3

Fig 3

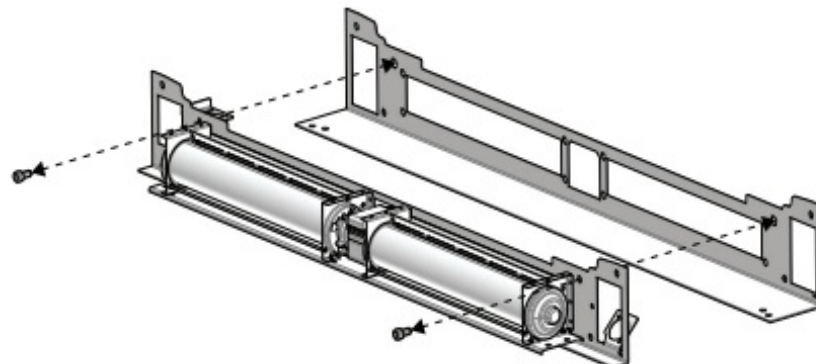

Unscrew the screws from the front bracket, and use them to secure the fan to the front bracket.

Fig 4

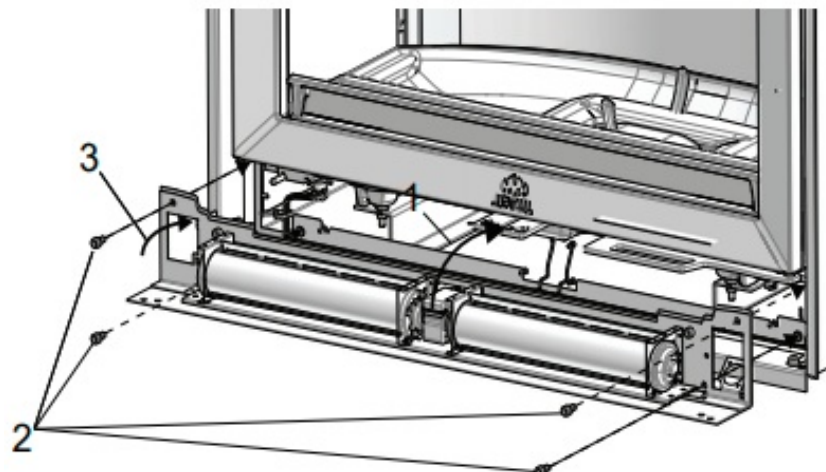

1. Tilt in the front bracket and fan.

2. Reattach the 4 screws (see fig.1) securing the front bracket with a 5 mm Allen key.
3. Flip the thermostat inwards.

Fig 5

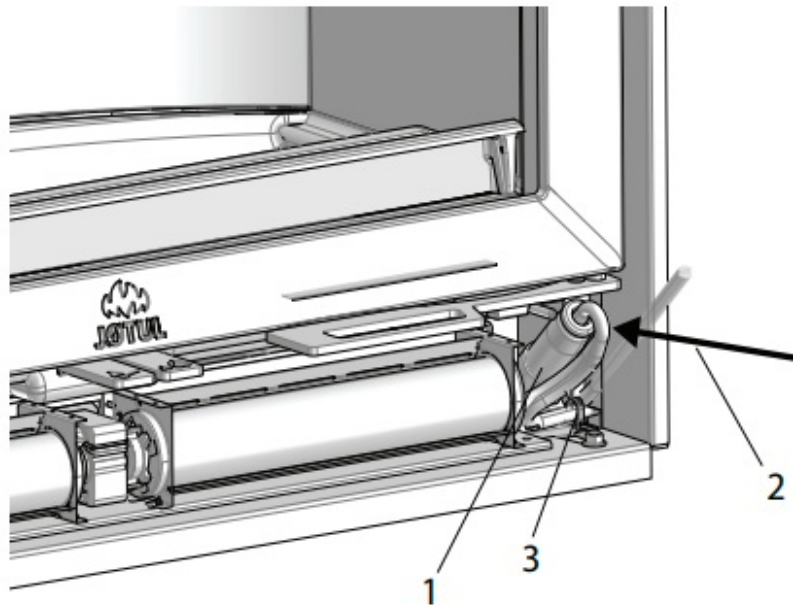

1. Thread the cable with the female connector through the slot made in fig.2, and connect it to the fan.
2. Bend the connection inwards, so that the connector will fit inside the frame (see the installation manual that comes with the cassette).
3. Use a cable tie to secure the cable to the bracket on the bottom of the fan cover (make sure there is enough cable for the connector to fit).

Fig 6

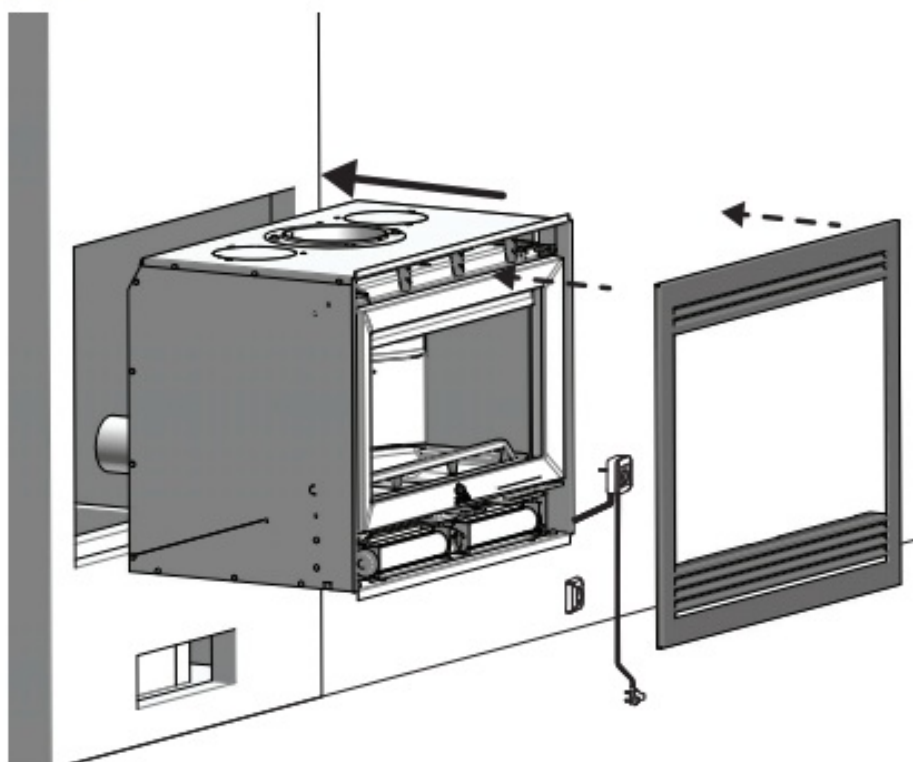

1. Install the cassette into the surround and mount the frame, as shown in in the installation manual that comes with the cassette. There must be room for the cable to fi t without being damaged on the outside of the cassette. NB: The frame must be installed, as it protects the electrical parts of the fan.
2. Install the control box (Fig. 8) in a suitable location, following the wiring diagram in fi g. 7.

Fig 7a

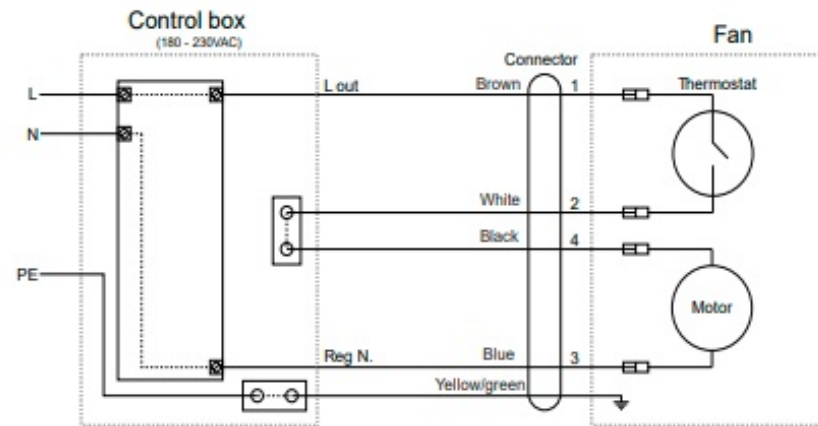
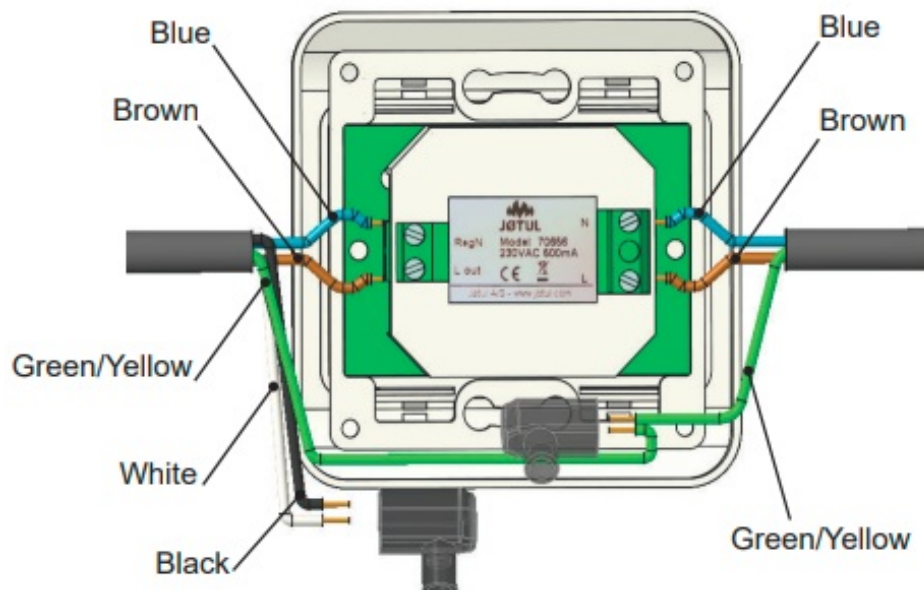

Fig 7b



1. Connect the wires in the control box according to fi g.7a+b.

NB: Installation must be carried out by a qualified electrician in conformance with local regulations.

The control box can now be connected to an electrical source.

Fig 8

Fig 8

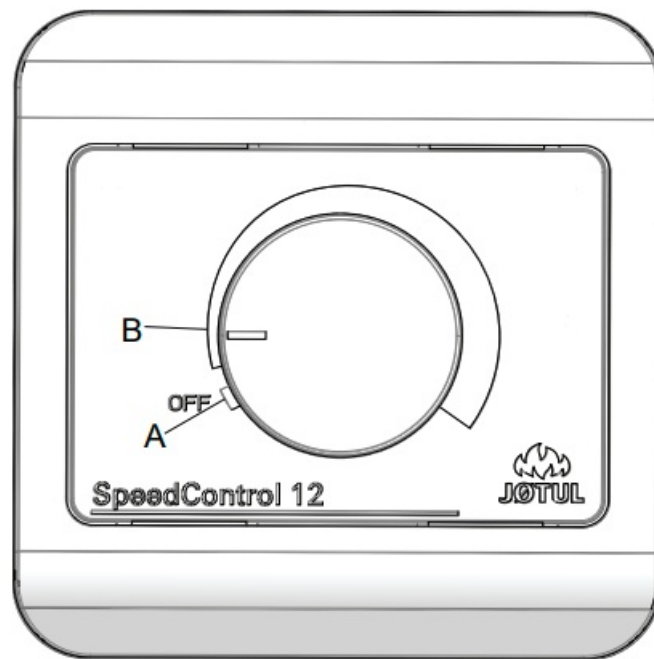

- A. The fan is off
- B. The fan starts at the selected speed when the burn chamber starts to generate heat. When the burn chamber has cooled down again, the fan stops automatically.

Lowest speed approx. 140 m³/h

Highest speed approx. 180 m³/h

Setpoint

- Start: 50°C
- Stop: 35°C

The fan will start once the burn chamber reaches 50°C (approx. 45 minutes after lighting the fire), and stop automatically when the temperature drops below 35°C.

- Fuse: 500 mA (not replaceable) 250 V
- Power consumption: 16 W

Safety precautions

The installation can only be taken into use after it has been checked by a qualified inspector.

This appliance can be used by children aged from 8 years and above and persons with reduced physical, sensory or mental capabilities or lack of experience and knowledge if they have been given supervision or instruction concerning use of the appliance in a safe way and understand the hazards involved

- Children shall not play with the appliance
- Cleaning and user maintenance shall not be made by children without supervision

Jøtul AS,

P.o. box 1411
N-1602 Fredrikstad, Norway
www.jotul.com

Jøtul pursues a policy of constant product development. Products supplied may therefore differ in specification, colour and type of accessories from those illustrated and described in the manual

Quality

Jøtul AS has a quality system that conforms to NS-EN ISO 9001 for product development, manufacturing, and distribution of stoves and fi replaces. This policy gives our customers quality and safety piece of mind as a result of Jøtul's vast experience dating back to when the company first started in 1853.

Documents / Resources

	<p>JOTUL C 620 Fan That Increases Air Circulation [pdf] Instruction Manual C 620 Fan, That Increases Air Circulation</p>
---	--

References

-  [Norwegian Cast Iron Stoves, Fireplaces & Inserts | Jøtul](#)