



JOSOBO JS-GZ001 Portable Blender User Manual

[Home](#) » [JOSOBO](#) » JOSOBO JS-GZ001 Portable Blender User Manual 

JOSOBO

Portable Blender
Model: JS-GZ000T

Contents

- [1 JS-GZ001 Portable Blender](#)
- [2 Precautions for product use](#)
- [3 Technical parameter](#)
- [4 What's Included](#)
- [5 Product Part Name](#)
- [6 Operation Guide](#)
- [7 Tips:](#)
- [8 Maintenance](#)
- [9 Fault Analysis and Elimination](#)
- [10 Precautions for product disposal](#)
- [11 WARRANTY](#)
- [12 Documents / Resources](#)
 - [12.1 References](#)

JS-GZ001 Portable Blender

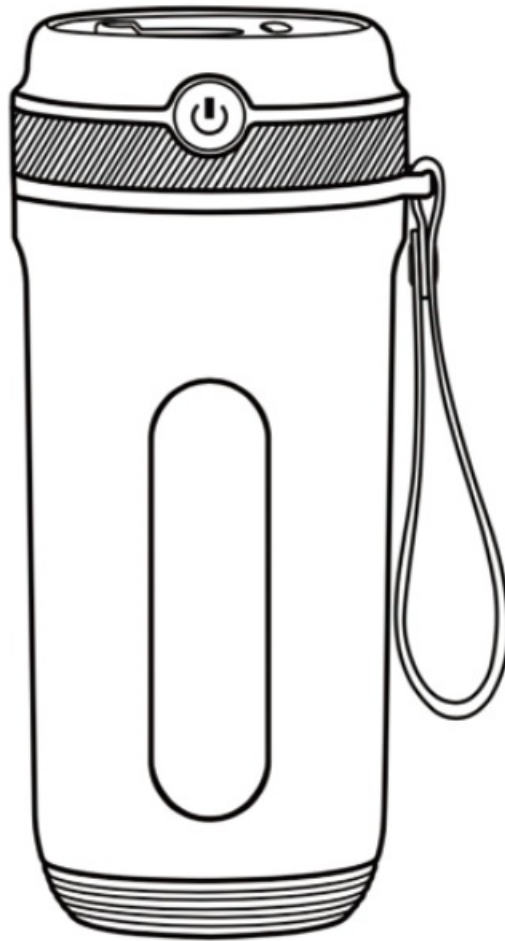

User Manual

Contact customersupport at

support@josobo.com

WWW.josobo.com

Thank you for using the products produced by our company. Before use, please read this manual carefully and correctly grasp the usage method of this product, in order to fully utilize its superior performance. | believe it will bring convenience and comfort to your and your family's lives.

Precautions for product use

⊘ Prohibition

*To ensure safe use and avoid personal injury and property damage to you or others, please be sure to follow the following safety precautions: Failure to follow safety warnings may lead to accidents when using

This product is prohibited from idle or overloaded operation: the maximum squeezing time for this product is 30 seconds each time, after which the product automatically stops working; If you need to continue squeezing juice, you need to restart the button switch.

When the product is working, it is strictly prohibited to unscrew the cup cover and put hands or other hard objects into the juice cup to prevent accidents.

This product is a fruit juicer and is prohibited from being used for mincing meat and grinding other products such as beans, as it may affect the product's service life.

Do not clean or disinfect the components of this product in dishwashers, disinfection cabinets, microwave ovens, and other cleaning equipment with temperatures exceeding 60 ° C to avoid deformation of the components due to heat.

The juice squeezed by this product should be drunk or stored in time, It is prohibited to store it in a mixing cup for more than 6 hours, otherwise the juice may produce spoilage and odor, which is harmful to human health. Do not use accessories and accessories other than this product. Please do not allow children, people with intellectual disabilities, and people with disabilities to come into contact or use this product.

⚠ Notice

This product drives the DC motor to work through a battery, and the battery can be charged by connecting it to an external power source through a charging cable

Please do not allow children, people with intellectual disabilities, and people with disabilities to come into contact or use this product.

Technical parameter

Model	JS-GZ001	Capacity	350m1
Charging Voltage	5V	Charging current	800mA
Rated power	80W	Rated voltage	7.4V
Battery capacity	1500mAh*2		

What’s Included

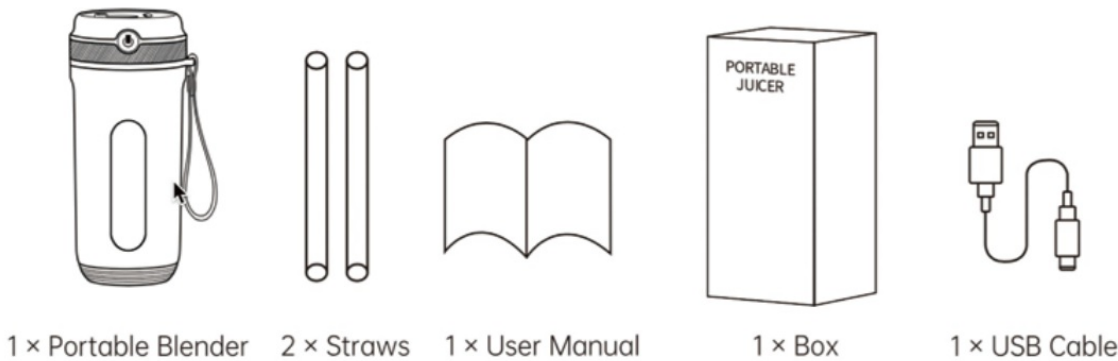

Product Part Name

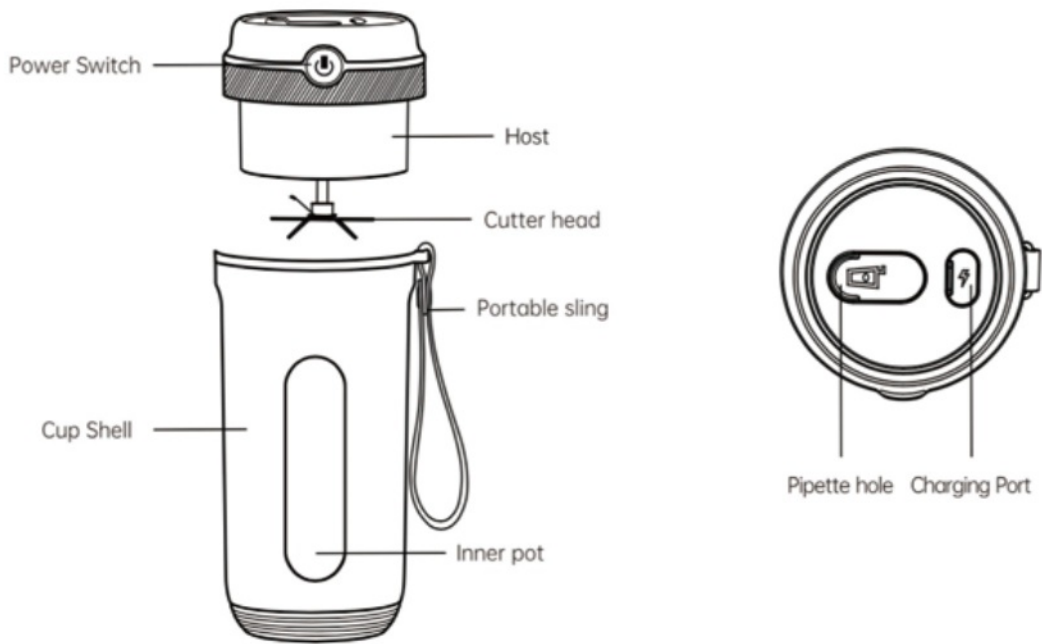

Operation Guide

Operating Instructions



1. Unscrew the mixing cup and cup cover counterclockwise and clean them thoroughly.

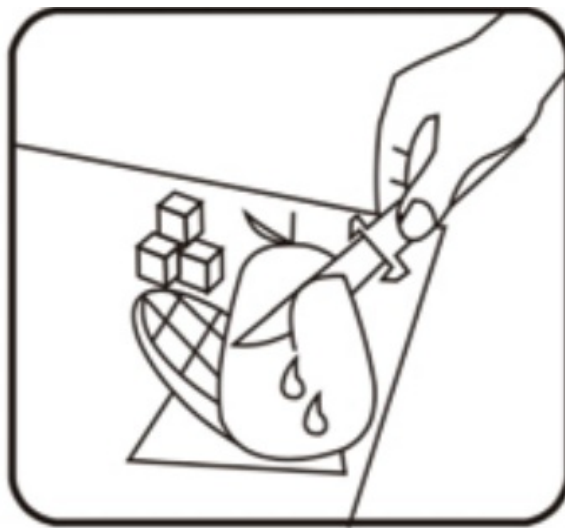

2. Wash, peel, and seed the fruit, and then cut it into small pieces about 10X10X10mm (about the size of a small thumb).



3. Put the cut fruit into a juicer, add appropriate pure water, and then tighten the lid clockwise
 1. The total amount of fruit/water added should not exceed the maximum water level of 300ml (three-quarters of the mixing cup) in the mixing cup, and the water temperature should not exceed 40 ° C.
 2. Hard fruits and vegetables (such as carrots) not exceeding 50g.

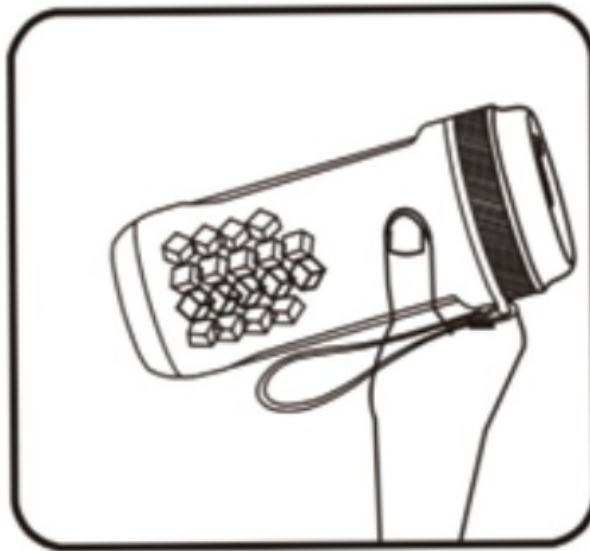

4. Double click the start button switch diagonally downwards by about 45 °, and the work indicator light will display in blue. The product will work for a cycle of 30 seconds.

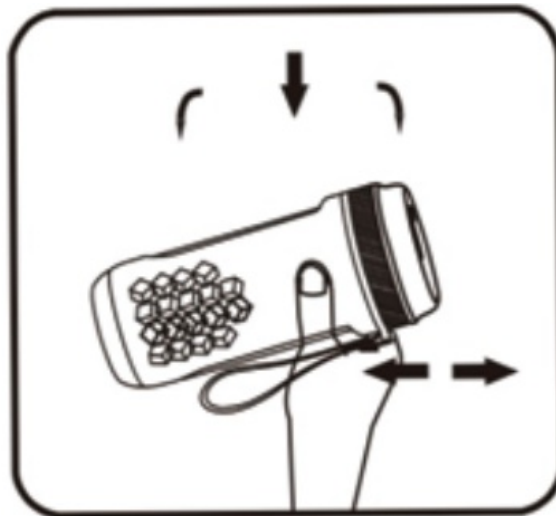

5. Place the juicer horizontally in your hand, and then tilt the main machine back and forth at 15 ° until the juice is made. Shake the entire process back and forth for better mixing effect.



6. After completing the juice extraction, you can pick up the host and drink directly, or you can unscrew the cup lid and pour the drink into a cup for drinking.

Tips:

1. Gently shaking the product during operation will improve the mixing effect.

2. The juicer is equipped with a safety protection device, and the machine cannot be started if the lid is not tightened.
3. If there is jamming with large pieces of food during the juice extraction process, the machine will stop working and can only resume normal operation after being cleaned again.

Charging instructions:

1. Double-click the power button twice, and the indicator light will cycle from blue to red to blue, indicating that the device is out of power.
2. After plugging in the USB power cord, the barrier turns red and stays on, indicating charging.
When the indicator light turns blue and stays on, it means it is fully charged.

Tips:

1. The battery charging time is 4-6 hours, and the charging time may vary slightly depending on the season,
2. Recharge at least once every three months, otherwise using up the original battery power will affect the battery's lifespan.
3. It is necessary to frequently charge and operate lithium-ion batteries.

Maintenance

After using the product, it is recommended to clean it immediately to avoid residual juice spoilage and odor. When cleaning, the following operations can be referred to:

1. Whole machine cleaning:

Add half a cup of clean water to the cup, and add a small amount of detergent if necessary. Then stir according to the method of beating juice for about 30 seconds.

2. Juice cup cleaning:

Turn the juice cup counterclockwise, open it and rinse it under the faucet, or put it in warm water with detergent for cleaning. When cleaning, pay attention to the water temperature not exceeding 40 degrees.

3. Host cleaning:

It is strictly prohibited to directly immerse the host in water for cleaning or rinse with water. When wiping the host, a damp cloth that has been wrung dry can be used to wipe it clean.



The blade is very sharp. It is recommended to use a cleaning brush to clean the blade and be careful of scratches! After cleaning, place the machine and components in a ventilated area to dry, and then assemble them for storage.



This product and components are strictly prohibited from being placed in a high-temperature disinfection cabinet for high-temperature disinfection! Do not soak in boiling water! Otherwise, it may cause serious deformation or damage to the product!

Fault Analysis and Elimination



Notice

- This product is equipped with an overheating protection device. In case of abnormal use or severe overload operation of the motor, the product will automatically stop for protection, and the red and blue indicator lights of the button will flash.
- If the knife component gets stuck during use of the product, please immediately release the button switch and take out the ingredients that have stuck the knife. Wait for the motor to cool before continuing to use.
- Due to the sharp blade of the product, please pay attention to safety during disassembly and cleaning,
- After using the product, please pay attention to turning off the main power switch.
- When the battery is low, please pay attention to timely charging.

Fault phenomenon	Cause analysis	Troubleshooting
leaking water	The juicer is not tightened properly	Tighten the juicer
	The sealing ring is missing or not installed properly	Reinstall the sealing ring
„hie click the button to start the , ... itch, and the red light will stay on for 30 seconds after starting a nd working	Buttery out of charge (under overload condition)	Please charge the base according to the charging operation instructions, or stop the machine to reduce the a mount of food in the cup and refill it
Double click the button to start th e switch, the red light flashes twi ce . It does not work	Juicer not installed or not installed pr operly	Install the juicer in place.
Double click the button to start th e switch, and the red light will fla sh for 10 seconds after starting a nd working	Motor stuck	Take out the ingredients that are stu ck in the knife set, cut them into sma ll pieces, [and put them back in agai n
Double click the button to start th e switch. Suddenly, the machine stops and the red and blue lights alternate for 60 seconds during o peration	The machine has been working unde r heavy load for along time and the te mperature is too high	Stop and wait for 10 minutes before restarting
During the operation of the mach ine, it suddenly stops and does n ot work without any prompt	Safety switch disconnected	Install the mixing cup in place or submit for inspection

Precautions for product disposal



Danger!

The battery used in this product is a specialized rechargeable battery and cannot be used in other products. Please do not remove the rechargeable battery for charging.

- Please do not throw it into the fire to overheat it
- Do not use nails to pierce, impact by gravity, or undergo decomposition or modification
- Do not directly connect the positive and negative electrodes of the battery with metal
- Do not store it with necklaces, hair clips, etc
- Do not charge, use, or place in high temperature places such as by the stove or in the scorching sun

The above situations can all cause heating, fire, rupture, and other phenomena.



Warning

Please keep the removed rechargeable battery out of reach of infants and young children to prevent accidental ingestion.

- If swallowed by mistake, please seek medical attention immediately
- When battery fluid leaks, do not touch the liquid with your bare hands and handle it according to the following methods.
- When battery liquid enters the eyes, there is a risk of blindness. Do not rub the eyes directly with your hands. Wash them immediately with water and seek medical attention.
- When battery fluid gets on the body or clothing, it may cause skin inflammation or injury. Please rinse with clean water. If you still feel unwell, seek medical attention immediately.

The product can only be disassembled when discarded. Failure to comply may result in accidents such as fire and electric shock. If repairs are needed (except for battery replacement), please consult the store where you originally purchased this product.

The lithium-ion battery used in this product is a valuable resource that can be recycled and recycled. Please remove the lithium-ion battery after use and dispose of it, and hand it over to a professional organization that can recycle and recycle rechargeable batteries for disposal.

WARRANTY

Thanks for choosing JOSOBO product.

The product is covered with JOSOBO product and warranty for 12 months from the date of its original purchase.

The warranty will not apply in cases of :

- Accident, misuse, or repairs performed by unauthorized personnel.
- Any unit that has been tampered with or used for commercial purpose.
- Normal wear and tear of wearable parts.
- Use of force, damage caused by external influences.
- Damage caused by non-observance of the User Manual, such as connecting to an unsuitable mains supply or Disobeying the user instructions.
- Partially or completely dismantled appliances.
- Defects caused by or resulting from damages from shipping or from repairs, service, or a termination to the product or any of its parts that have been performed by a repair person not authorized by JOSOBO.

We can only provide after sales service for products that are sold by JOSOBO or JOSOBO authorized retailers and distributors. If you have purchased your unit from a different place, please contact your seller for return and warranty issues.

Please have your invoice and order ID ready before contacting Customer Support.



Documents / Resources

<p>JOSOBO</p> <p>Contact customersupport at support@josobo.com www.josobo.com</p>	<p>JOSOBO JS-GZ001 Portable Blender [pdf] User Manual JS-GZ001 Portable Blender, JS-GZ001, Portable Blender, Blender</p>
--	--

References

- [User Manual](#)

Manuals+, Privacy Policy

This website is an independent publication and is neither affiliated with nor endorsed by any of the trademark owners. The "Bluetooth®" word mark and logos are registered trademarks owned by Bluetooth SIG, Inc. The "Wi-Fi®" word mark and logos are registered trademarks owned by the Wi-Fi Alliance. Any use of these marks on this website does not imply any affiliation with or endorsement.