

Joso D6 Mobile Game Controller



Joso D6 Mobile Game Controller User Guide

[Home](#) » [Joso](#) » Joso D6 Mobile Game Controller User Guide 

Contents

- 1 Joso D6 Mobile Game Controller
- 2 Product Information
- 3 Product Usage Instructions
- 4 TROUBLESHOOTING TIPS
- 5 PS Remote Play Upgrade Tutorial
- 6 Getting started with PS Remote Play
- 7 Documents / Resources
 - 7.1 References
- 8 Related Posts



Joso D6 Mobile Game Controller



Product Information

Specifications

- **Model:** D6
- **Compatibility:** iOS/Android devices
- **Connection Mode:** Bluetooth
- **App:** ShootingPlus V3

Product Usage Instructions

Troubleshooting Tips

Won't turn on

If the controller doesn't turn on, follow these steps:

1. Poke the reset key for 5 seconds with a small pin.
2. Plug the charger cable in – you should see the red LED light blinking slowly.
3. Once fully charged, connect the controller to your device with the correct pairing mode. Refer to the video tutorial for assistance.

Buttons Don't Work

If the buttons don't work, it's likely set up on the wrong connection mode. Follow these steps:

1. Try each pairing mode mentioned in the user manual.
2. Delete the controller from your device before trying a new mode.
3. If in doubt, test the controller with Asphalt 9: Legends (a free driving game) in the 'Bluetooth' connection mode for iOS/Android.

The controller doesn't work in PS Remote Play

If the controller doesn't work in PS Remote Play, please upgrade the controller using the following tutorial:

PS Remote Play Upgrade Tutorial

1. Please download the 'ShootingPlus V3' app on your Google Play Store or scan the QR code with your Android phone to download the 'ShootingPlus V3' App.
2. In the controller off state, press the 'V3' key to boot the controller, and the Blue indicator light will flash.
3. Turn on the Bluetooth function on your Android phone, search, and select 'D6'. Once the connection is done, the Blue indicator light will stay on.
4. Open the 'ShootingPlus V3' App, the controller will automatically connect to the D6 controller. Make sure 'D6 Connected' is displayed.
5. Tap 'Setting', then tap 'Upgrade Beta' and enter the password '123' to enter the upgrade process. The indicator on the controller will turn 'cyan' and stay on.
6. After the upgrade is completed, the indicator light will turn off.

Getting started with PS Remote Play

To get started with PS Remote Play, follow these steps:

1. Ensure that your controller is fully charged and paired with your device using the correct pairing mode.
2. Launch the PS Remote Play app on your device.
3. Follow the on-screen instructions to connect to your PlayStation console.
4. Once connected, you can use the controller to play games remotely on your device.

Frequently Asked Questions (FAQ)

Q: How do I charge the controller?

- **A:** Plug in the charger cable and wait for the red LED light to blink slowly. Once fully charged, you can use the controller.

Q: How do I switch between pairing modes?

- **A:** Refer to the user manual for instructions on how to switch between pairing modes. Make sure to delete the controller from your device before trying a new mode.

Q: Why is the controller not working in PS Remote Play?

- **A:** Please make sure to upgrade the controller using the provided tutorial. If the issue persists, contact customer support for further assistance.

TROUBLESHOOTING TIPS

1. Won't turn on. Charge or key lag?

- Poke the reset key for 5 seconds with a small pin.
- Then plug the charger cable in – you should see the red LED light blinking slowly.
- Once fully charged, connect the controller to your device with the correct pairing mode.
- (see video tutorial)

2. Buttons Don't Work?

- It's likely set up on the wrong connection mode.
- Try each pairing mode (see user manual).
- Remember to delete the controller from your device before trying a new mode.
- If in doubt, test our controller with Asphalt 9: Legends (free driving game) in the 'Bluetooth' connection mode for iOS/Android.

3. The controller doesn't work in PS Remote Play

- Please upgrade the controller.

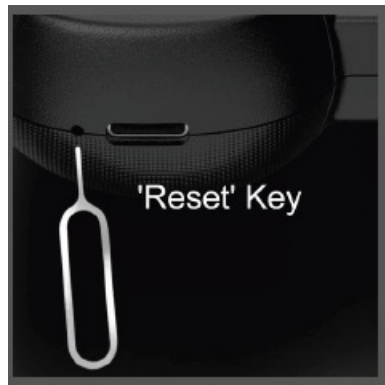



PS Remote Play Upgrade Tutorial

1. Please download the 'ShootingPlus V3' app on your Google Play Store or scan the QR code with your Android phone for downloading the 'ShootingPlus V3' App.

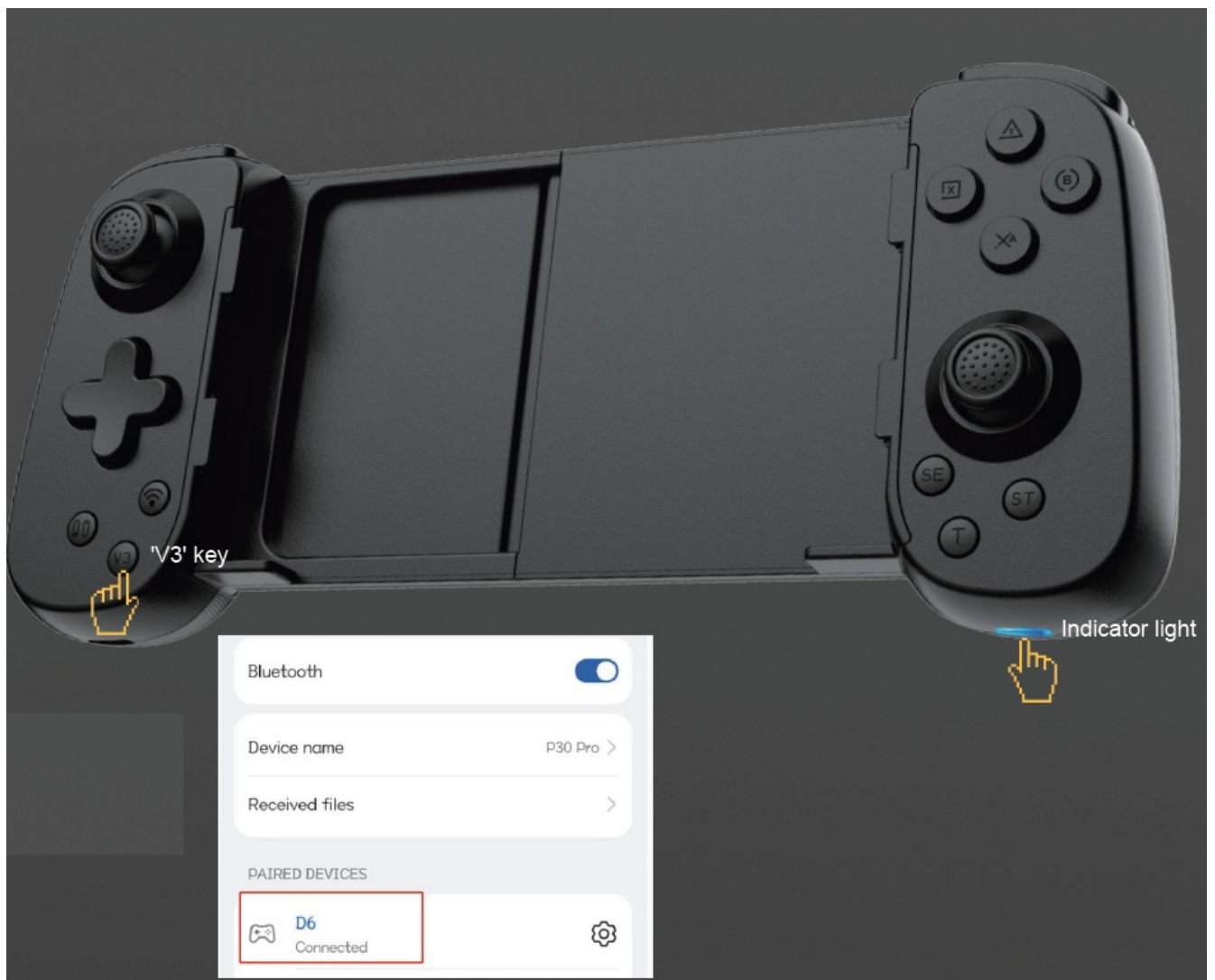

- (Need to allow ShootingPlus V3 to access the device's location while in use)
2. In the controller off state, press the 'V3' key to boot the controller, and the Blue indicator light will flash.



3. Turn on Bluetooth function on your Android phone, search and select 'D6', once the connection has done, the Blue indicator light will keep on.
 4. Open the 'ShootingPlus V3' App, the controller will automatically connect to the D6 controller, make sure 'D6 Connected'.
- Tap  on Setting then tap 'Upgrade Beta' into 'Firmware upgrade', tap 'Firmware upgrade' on the bottom, enter password '123' then tap 'OK' to enter the upgrade process, the indicator on the controller is 'cyan' and keeps on.
 - After the upgrade is completed, the indicator goes off.

Setting Firmware upgrade

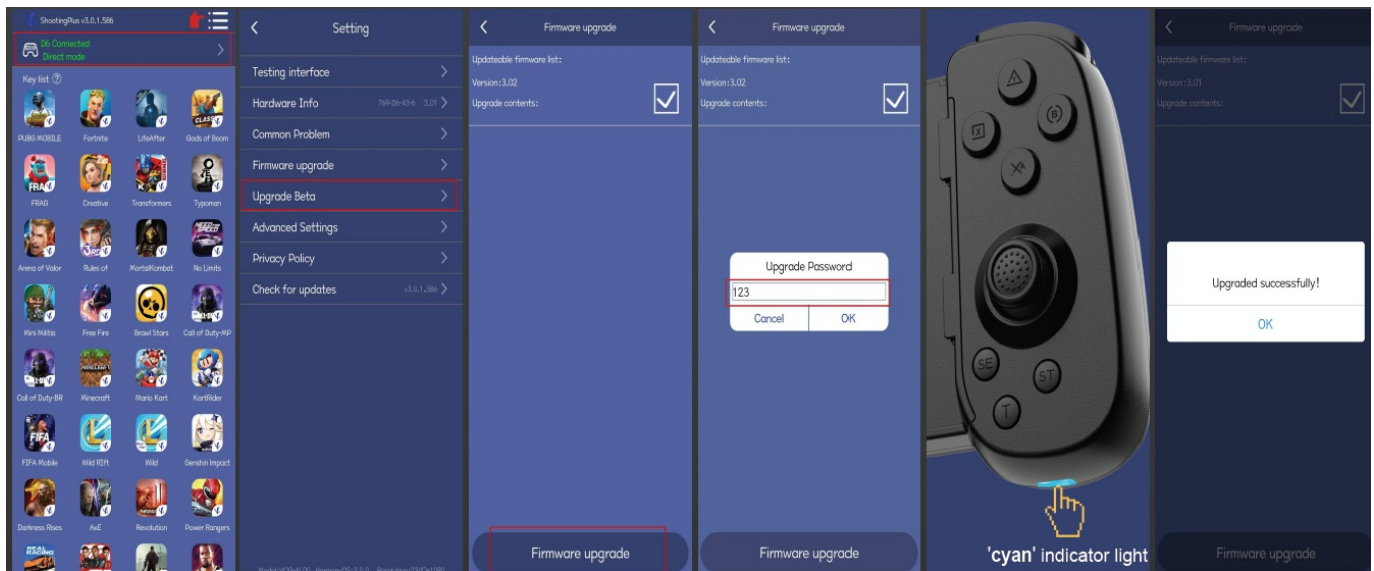

Getting started with PS Remote Play

PLEASE NOTE BEFORE PS STREAMING

1. Make sure your Sony login account on the PS remote play APP is the same as on your PS4/PS5 console.
2. Make sure the controller is off.
 1. **Connect a D6 game controller**
 - Press and hold the 'L3' Key, then press the 'Bluetooth' key for 5 seconds to boot the controller until the 'purple' indicator light flashes quickly, and then turn on the Bluetooth connection 'DUALSHOCK 4 Wireless Controller' on your iOS device or Wireless Controller' on your Android device, once the connection has done, the 'purple' indicator light will keep on.
 2. **Go to the PS4/PS5 console setting**
 - **FOR PS4**
 - **Step 1:** On PS4 go to 'Settings – Account Management – Activate as Your Primary PS4'.
 - **Step 2:** On PS4 go to 'Settings – Remote Play Connection Settings – Turn on: Enable Remote Play'.
 - **Step 3:** On PS4 go to 'Settings – Power Save Settings – Set Features Available in Rest Mode – Turn on Stay Connected to the
 - **Internet – Turn on:** Enable Turning On PS4 from Network'.
 - **FOR PS5**
 - **Step 1:** On PS5 go to 'Settings – Users and Accounts – Other – Enable: Console Sharing and Offline Play'.
 - **Step 2:** On PS5 go to 'Settings – System – Remote Play – Turn on: Enable Remote Play'.
 - **Step 3:** On PS5 go to 'Settings – System – Power Saving – Features Available in Rest Mode – Turn on: Stay Connected to the
 - **Internet – Turn on:** Enable Turning On PS5 from Network'
3. **Start a new game or jump back in**
 - You're now playing your PS console from your mobile device.
 - Be sure to enable mobile data usage within the PS Remote Play app if you want to play off of Wifi.



Documents / Resources



[Jojo D6 Mobile Game Controller](#) [pdf] User Guide

D6 Mobile Game Controller, D6, Mobile Game Controller, Game Controller, Controller

References

- [User Manual](#)

[Manuals+](#). [Privacy Policy](#)

This website is an independent publication and is neither affiliated with nor endorsed by any of the trademark owners. The "Bluetooth®" word mark and logos are registered trademarks owned by Bluetooth SIG, Inc. The "Wi-Fi®" word mark and logos are registered trademarks owned by the Wi-Fi Alliance. Any use of these marks on this website does not imply any affiliation with or endorsement.