

Joom M8 Rechargeable Lint Remover



# Joom M8 Rechargeable Lint Remover User Manual

[Home](#) » [JOOM](#) » Joom M8 Rechargeable Lint Remover User Manual 

## Contents

- [1 Joom M8 Rechargeable Lint Remover](#)
- [2 Diagram](#)
- [3 Specifications](#)
- [4 Charging Before Use](#)
- [5 Product Usage](#)
- [6 Easy Clean and Replace Blades](#)
- [7 Fault Analysis and Troubleshooting](#)
- [8 Warranty Service](#)
- [9 Documents / Resources](#)
  - [9.1 References](#)



**Joom M8 Rechargeable Lint Remover**

**Specifications:**

- Battery Capacity: 2000mAh
- Battery Runtime: 200 Mins
- Charging Input: DC 5V 1A Type-C
- Charging Time: 2 Hours
- Gear Speed: Gear I, Gear II, Gear III
- Executive Standard: GB4706.1-2007

**Product Usage:**

1. Turn off the lint remover.
2. Lay the dry clothes on a horizontal surface and flatten the wrinkles.
3. Short press the Power/Gear button to turn on and select gears I, II, or III based on clothing materials.
4. After use, short press the Power/Gear button to shut down, open the dust storage cover, remove fuzz and pills, and store the product in a cool place.

**Charging Before Use:**

1. Turn off the lint remover.
2. Connect the Type-C cable to a proper power adapter plug (above 5V 1A) for full charging.

**Cleaning and Blade Replacement:**

1. Power off the lint remover.
2. Open the dust container to clean inside fabrics with the included cleaning brush.
3. Install the dust container and mesh cover after cleaning. Store in a cool, dry place.

## Warnings:

- Avoid placing the product where children can reach it.
- Avoid inserting fingers or metal objects into the blade.
- Do not dismantle, repair, or replace the battery by yourself.
- Ensure clothes are flat before use to prevent damage.
- Avoid using the lint remover on clothes while wearing them.
- Turn off the product during charging and avoid hot/humid charging environments.

## FAQ:

**Q: Can this product be used on down clothing?**

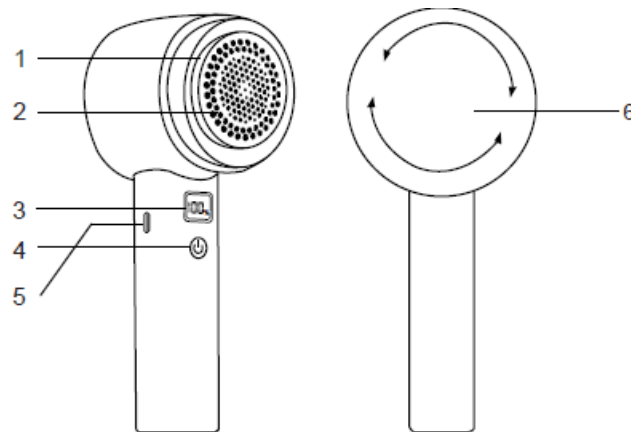

**A:** No, this product cannot be used on down clothing.

## Diagram



1. Open Mesh Cover
2. Mesh Cover
3. LED Display (show gear speed and battery capacity)
4. Power / Gear Button
5. Type-C Charging Input
6. Dust Container

## Specifications

Battery Capacity	2000mAh Battery
Runtime	200 Mins
Charging Input	DC 5V 1A Type-C
Charing Time	2 Hours
Charging Indicators	 Flashing—Charging  Stop Flash— Fully Charged
Gear Speed	Gear I,Gear II,Gear III
Executitive Standard	GB4706.1-2007

## Charging Before Use

1. Turn off the lint remover and then connect Type-C cable with a proper power adapter plug (above 5V 1A) for fully charging.
2. The LED screen will show the battery capacity and charging icon will flash while charging.  
When it is fully charged, LED display will show 100% and charging icon stops flashing.

Don't turn on lint remover for use while charging,it is recommended to use after full charged

## Product Usage

1. First lay the dry clothes on a horizontal surface and flatten the wrinkles on the clothes.
2. Short press the Power/Gear button and repeat press it to select gears I, II, III according to the clothing materials.
3. Fit the product perfectly to the clothing and move it back and forth (it is recommended that the angle of them should be 90° for a better trimming effect).
4. After use, short press the Power/Gear button to shut down, open the dust storage cover remove the fuzz and pills, install the cover and store the product in a cool and ventilated place.

You must turn off the lint remover before removing the mesh cover or dust storage cover in case of causing danger.

## Easy Clean and Replace Blades

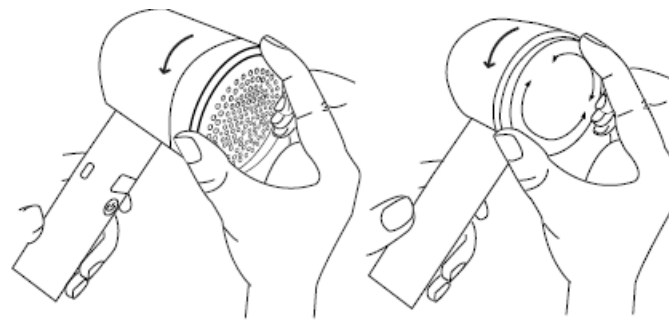

Open the Mesh  
Cover to Replace  
the Blade

Open the Dust  
Bin to Clean

1. Power off the lint remover.
2. Rotate the dust container to open it.
3. Clean the inside fabrics with the included cleaning brush.
4. After cleaning, install the dust container and mesh cover. Please keep it in the cool and dry place.

### Reminder

1. Put the clothes flat first, and pay special attention to the following positions when removing the lint and pills:

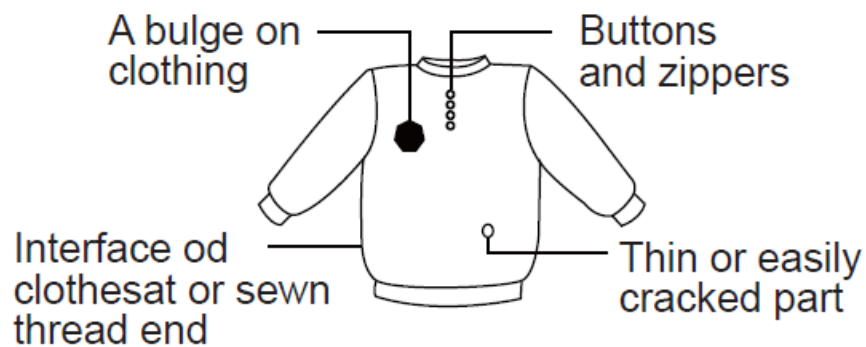

2. Please stop use this lint remover if any abnormalities and faults
3. please deal with it according to the type of fault, and contact customer service for aftersales maintenance if necessary. Hassle free lifetime customer service with quick response within 24 hours.

**Note:** This product cannot be used on down clothing!

### Warning

1. There are sharp blades inside the product, do not put the product in a place where children can reach it or use it as a toy, otherwise it will cause danger;
2. Do not insert fingers or metal objects into the blade, which may cause damage injury;
3. Non-professionals are not allowed to dismantle the machine, repair, refit or replace the battery by themselves to avoid danger.
4. Before use, the clothes must be tiled to prevent wrinkles, to avoid damage to the clothes during working;
5. Please do not use the lint remover to treat the clothes on your body, to avoid damage to the body and clothes;
6. Please make sure that the product is turned off when charging, and do not place it in a hot and humid place for charging;
7. Before use, please install the back cover on the machine body correctly

8. Do not use until the battery is completely discharged, it is recommended to charge at any time before use.

## Fault Analysis and Troubleshooting

Fault Phenomenon	Exclusion method
The product does not work	1. Cover the mesh cover again 2. Fully charge the product 3. Clean the fuzz on the blade 4. Contact seller customer service on amazon order dashboard
Fuzz and pills cannot be completely removed	1. Recharge the product 2. Clean the dust storage cover
Product cannot be charged	1. Plug in the charging socket again 2. Change the charger for charging

## Warranty Service

Please be sure to contact seller by writing message on your amazon account order dashboard before returning the product, which can effectively shorten the repair and return time.

### What we seller provide:

- We seller provide 1 year warranty with this item.
- We provide quick response within 24 Hours.
- We seller can provide satisfactory solution even amazon close the return or refund window.

---

## Documents / Resources

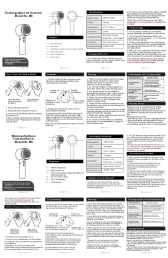
	<p><a href="#">Joom M8 Rechargeable Lint Remover</a> [pdf] User Manual</p> <p>M8 Rechargeable Lint Remover, M8, Rechargeable Lint Remover, Lint Remover, Remover</p>
---	--

## References

- [User Manual](#)

## **Manuals+. Privacy Policy**

This website is an independent publication and is neither affiliated with nor endorsed by any of the trademark owners. The "Bluetooth®" word mark and logos are registered trademarks owned by Bluetooth SIG, Inc. The "Wi-Fi®" word mark and logos are registered trademarks owned by the Wi-Fi Alliance. Any use of these marks on this website does not imply any affiliation with or endorsement.