

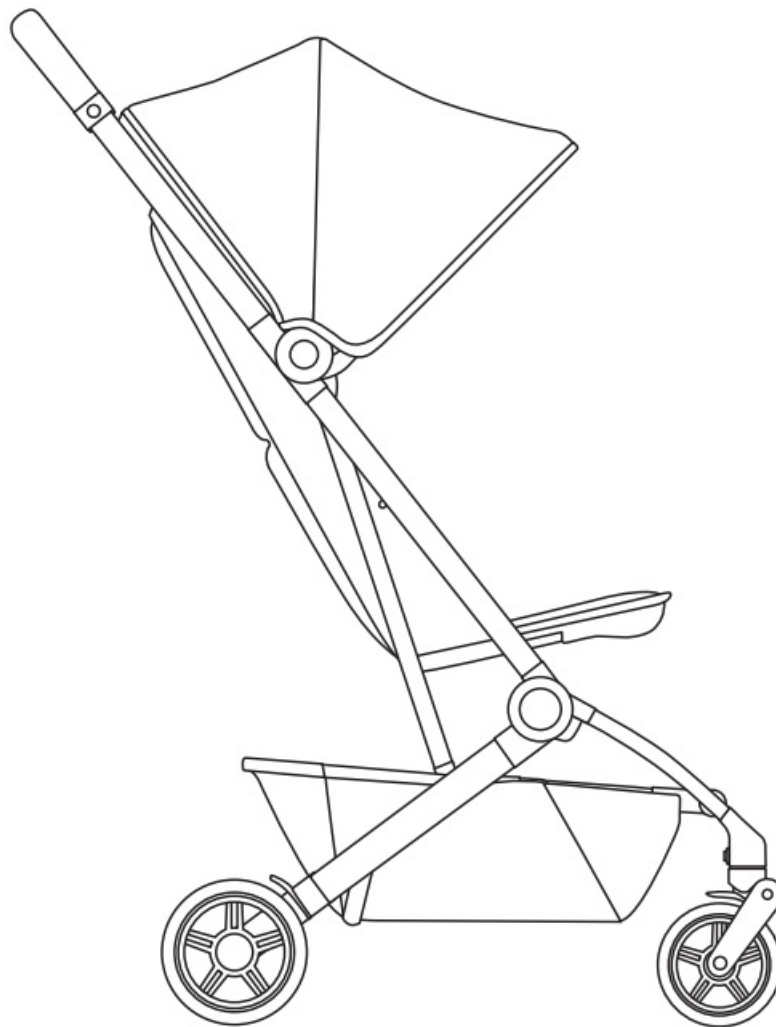

JOOLZ Aer Compact Folding Buggy Instruction Manual

[Home](#) » [Joolz](#) 

JOOLZ Aer Compact Folding Buggy



Contents

1 Warranty

2 Hello airplane, Goodbye box

3 Introduction

3.1 Get me ready

3.2 How to use the Joolz Aer+

3.3 How to use the seat harness

3.4 How to use the buckle

3.5 How to use the brake

3.6 How to use the swivel lock

3.6.1 comment utiliser les roues pivotantes

3.7 Compact storage

3.7.1 stockage compact

3.8 MAINTENANCE/WASHING INSTRUCTIONS Clean the fabric with lukewarm water and soap. Rinse with fresh water and leave to dry. Never use bleach or other chemical detergents. Periodically (approximately once a month) treat the wheels and metal parts with Teflon or silicon spray to ensure the buggy continues to run smoothly. The aluminium parts of your Aer+ buggy are coated to protect it from external influences such as corrosion. Coated aluminium parts are vulnerable to acidic cleaners or grease, which can cause stains and discoloration of the aluminium parts. We therefore advise you to clean the aluminum parts of your buggy with warm water and a soft cloth.

3.9 MAINTENANCE/WASHING INSTRUCTIONS

3.10 WARRANTY

4 Documents / Resources

4.1 References

Warranty

10-Year Transferable Warranty



Want to contribute to a better world for your child? With our 10-Year Transferable Warranty, other families can enjoy your stroller after you've grown out of it. All they need to do is register the warranty within 6 months of acquiring it. It's a great solution for people and the planet.

One stroller, One tree



Every Joolz on the street is a tree in one of our Birth Forests in Asia, Africa, Europe or South America. When you buy a stroller or buggy your tree joins hundreds of thousands of others in helping to make the world just a little bit greener.

Reusable Packaging



Reuse, recycle, and have fun with your Joolz cardboard box. Cut out the cute design printed on the box, and decorate your little one's room.

Hello airplane, Goodbye box

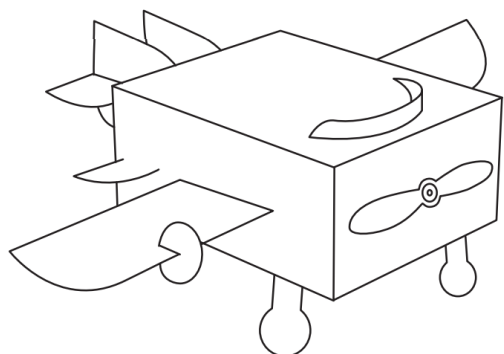

See all the possibilities on joolz.com



Introduction



1. One hand (un)folding button
2. Handlebar
3. Reclinable seat with ventilation
4. Carry strap
5. Shopping basket
6. Brake
7. Rear wheels
8. Extendable sun hood with ventilation
9. Harness incl. buckle
10. Footrest
11. Swivel lock
12. Front swivel wheels

Sizes – dimensions

Unfolded – 83x45x105,5 cm/32.7×17.7×41.5 in

Folded – 53,5x45x21,5 cm/21×17.7×8.5 in

Length backrest – 55 cm/21.7 in

Height handlebar – 105,5 cm/41.5 in

Weights Joolz Aer+ 6.4kg/14.1 lbs

Weight capacity – Joolz Aer+ 22 kg/50 lbs

Basket – 5 kg/11 lbs

Get me ready

1



2

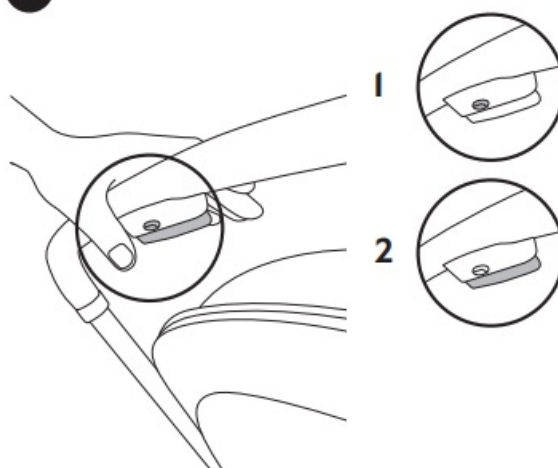

3

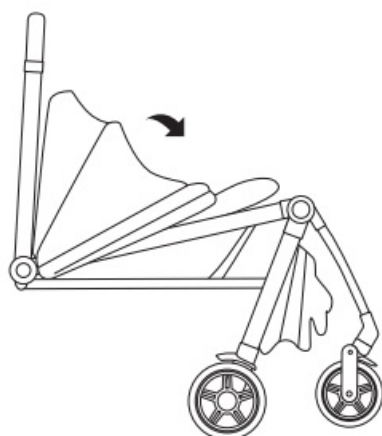

4

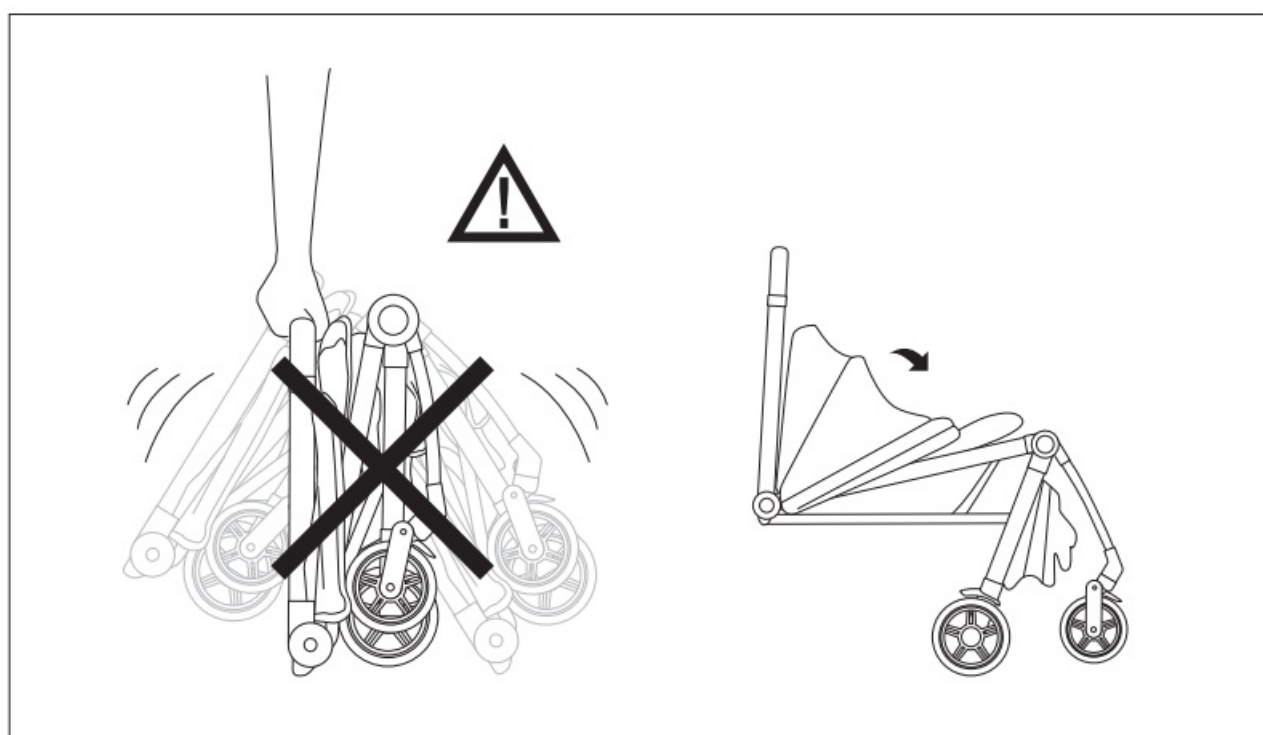
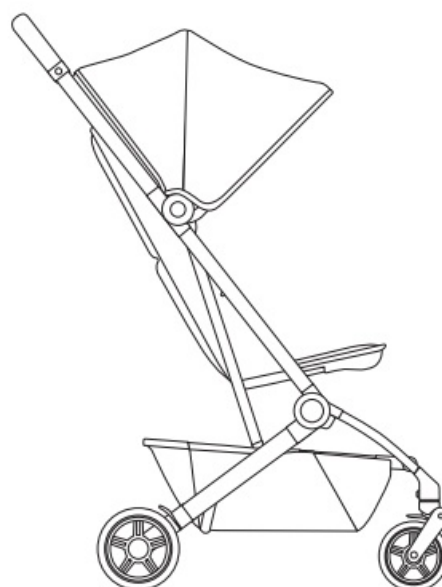

WARNING: To avoid injury ensure that you and your child/children are safe from moving parts when unfolding, folding and adjusting this product. Please note this product can unfold without using the activation button when shaken.

How to use the Joolz Aer+

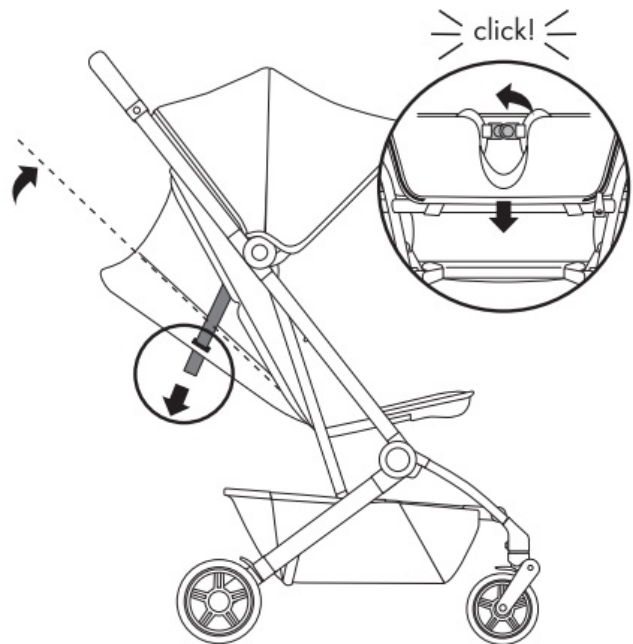
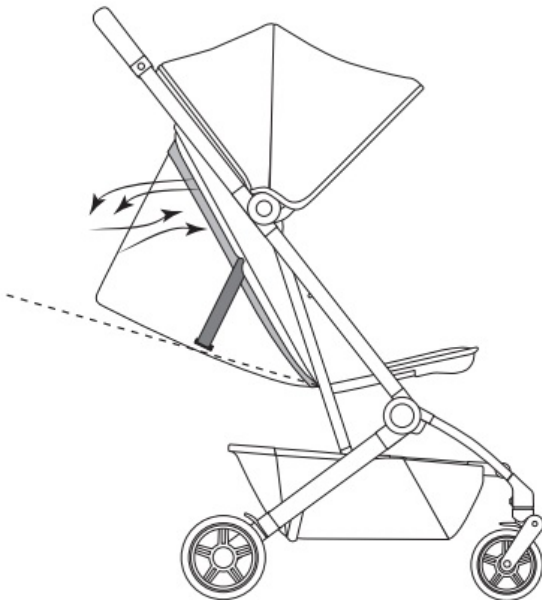
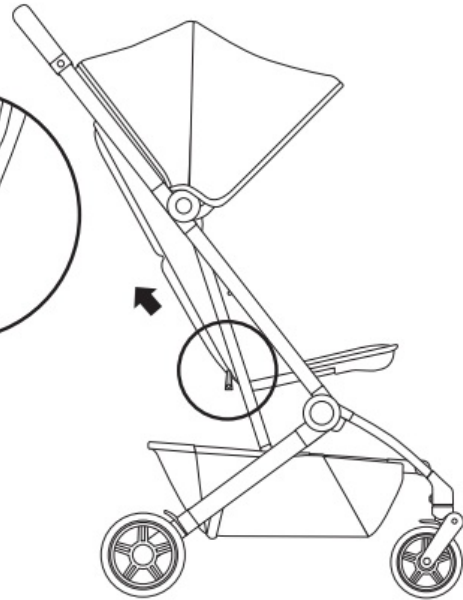
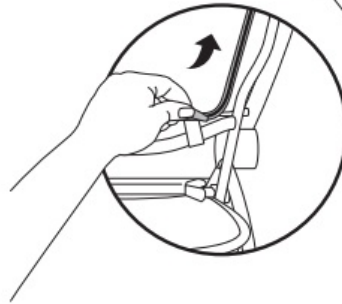
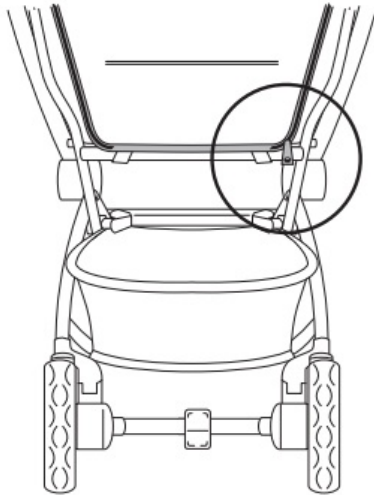

NOTE: breezes of fresh air

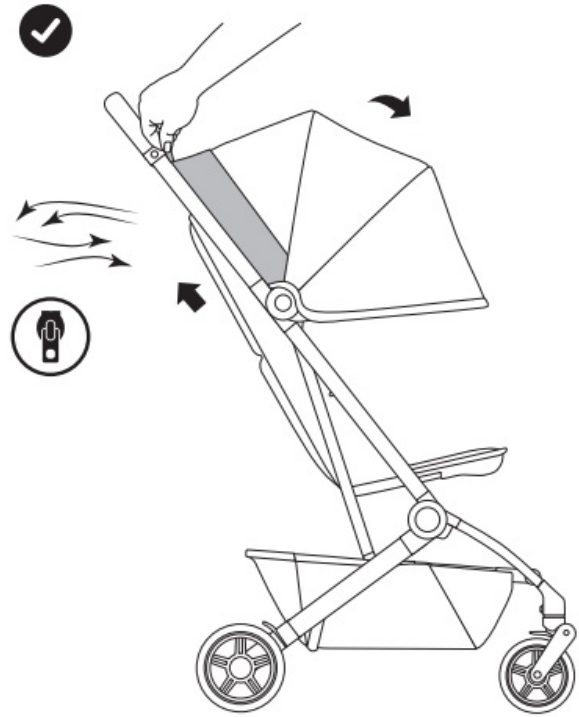
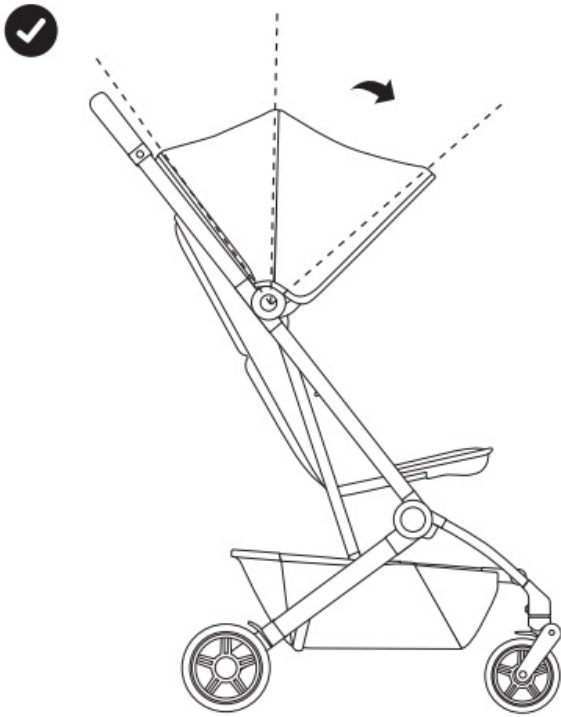

NOTE: breezes of fresh air

How to use the seat harness

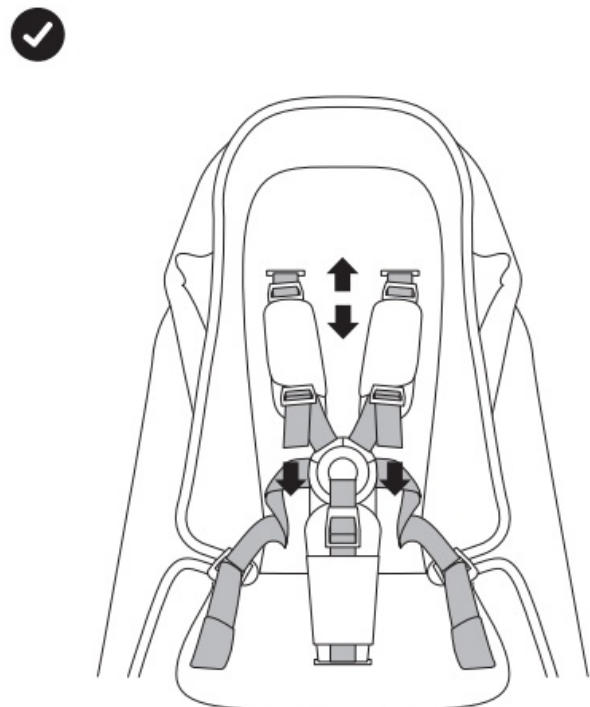
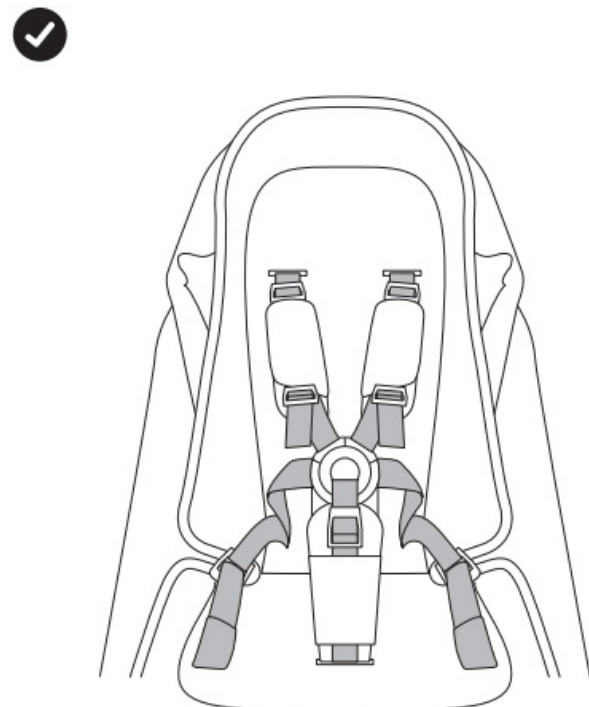

How to use the buckle

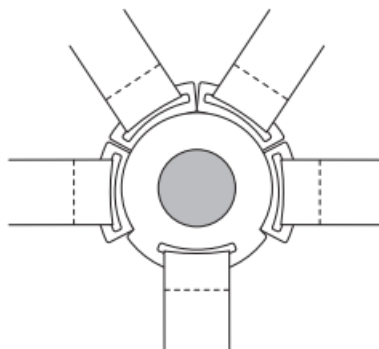
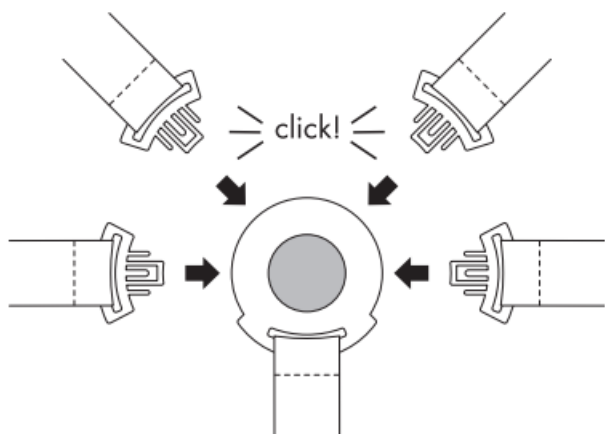

How to use the brake

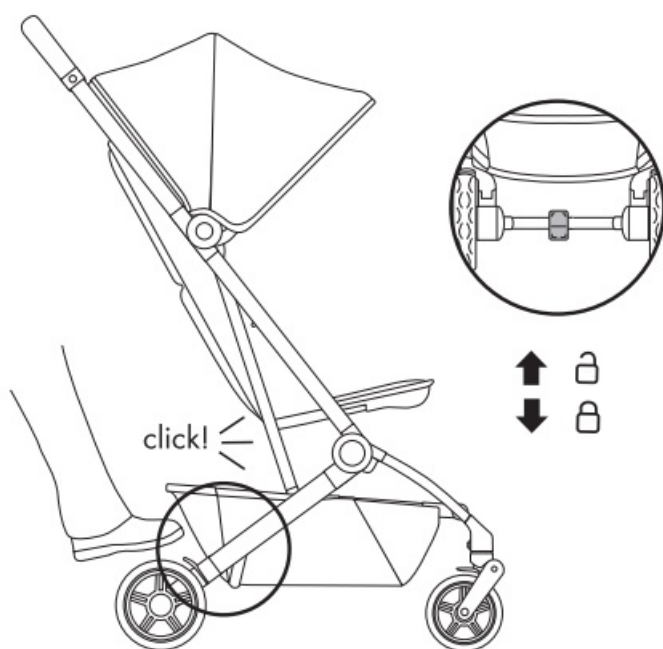

How to use the swivel lock

comment utiliser les roues pivotantes

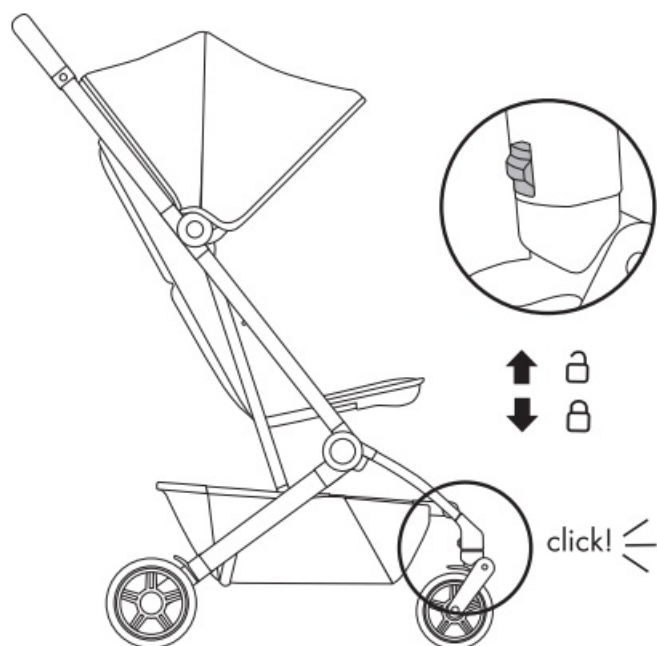

Compact storage

stockage compact

1

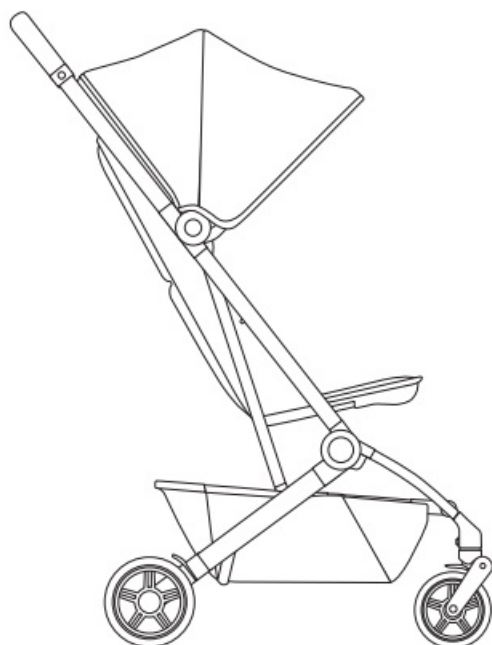

2

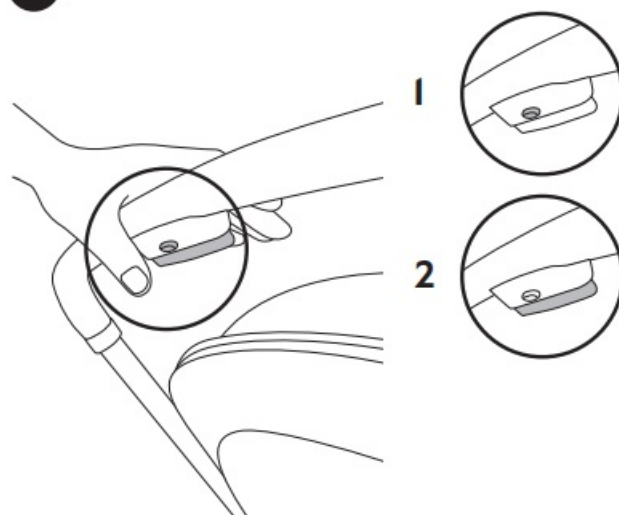

3

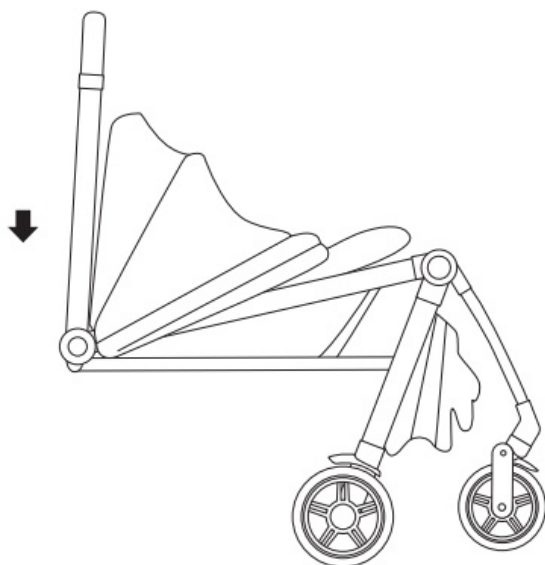

4

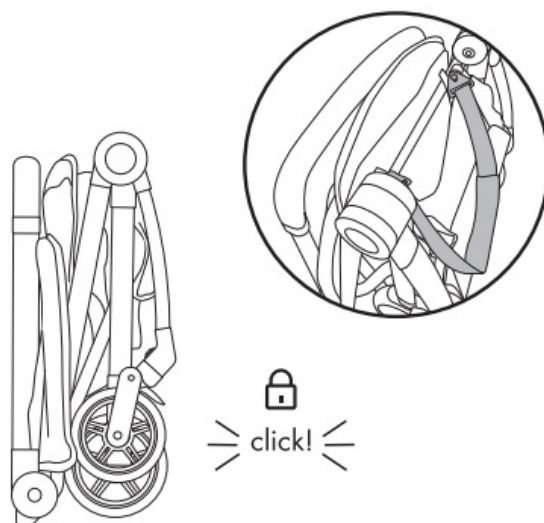

5

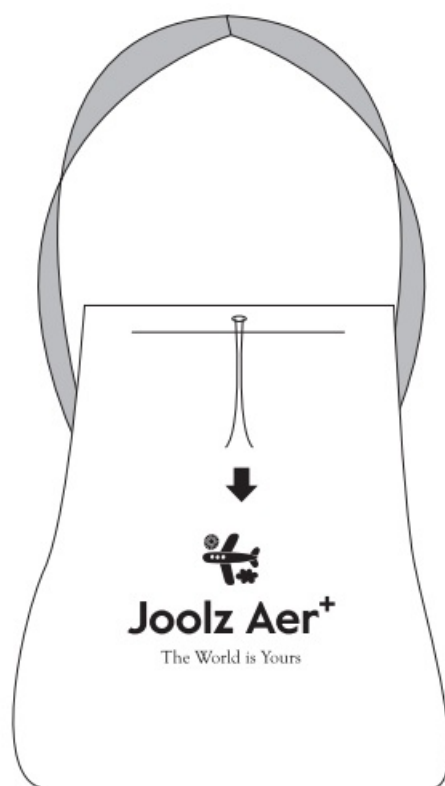
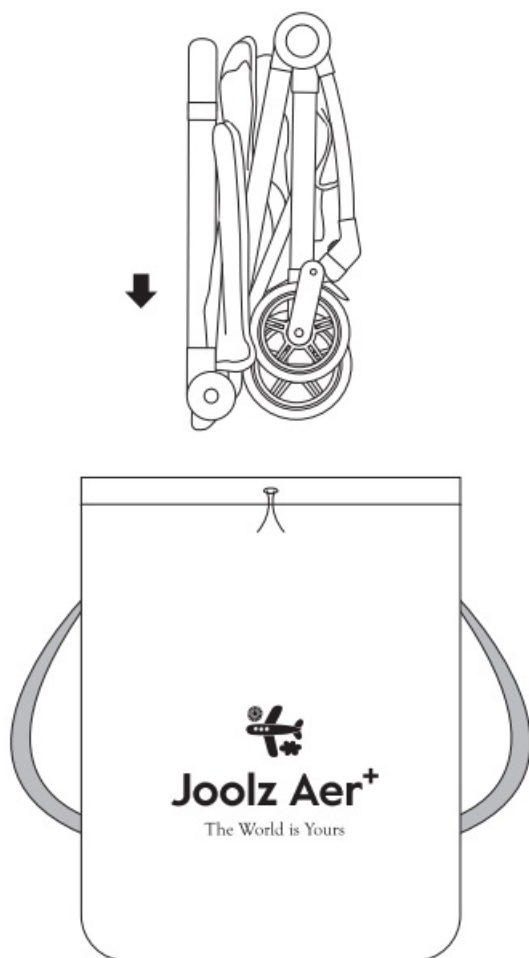

IMPORTANT: PLEASE READ THESE INSTRUCTIONS CAREFULLY BEFORE USAGE AND KEEP THEM FOR FUTURE REFERENCE. FOLLOW THE MANUFACTURER'S INSTRUCTION.

WARNING + The seat unit is intended for children from 6 months until 4 years, or up to a maximum weight of 22 kg with a maximum height of 100 cm. Which ever comes first.

- + For USA the seat unit is tested for a maximum weight of 50 lbs and maximum height of 42.5 inch.
- + The seat unit is not suitable for children under 6 months.
- + This product is not suitable for running or skating.
- + Never leave the child unattended.
- + To avoid injury, ensure that your child/ children are kept away when adjusting, unfolding and folding this product.
- + Be aware of finger entrapment when folding or unfolding the pram/stroller. Due care should be exercised.
- + Avoid serious injury from falling or sliding out. Always use the restraint system.
- + Ensure that all locking devices are engaged before use.
- + Check that the pram body or seat unit or car seat attachment devices are correctly engaged before use.
- + The seat unit is only compatible with the Joolz Aer+ chassis and vice versa.
- + Any load attached to the pushbar and/or on the back of the backrest and/or on the sides of the vehicle will affect the stability of the vehicle.
- + Parcels or accessory items, or both, placed on the unit may cause the unit to become unstable. Excessive weight may cause a hazardous unstable
- + The seat unit can carry only one child at a time.
- + Only use car seats, replacement or spare parts and accessories that are supplied or approved by Joolz.
- + Do not use any pillow, comforter, or additional mattress for padding that are not supplied or approved by Joolz.
- + Car seats used in conjunction with a chassis do not replace a cot or a bed. Should your child need to sleep, then it should be placed in a suitable crib, bed or approved sleeping area based on your child's requirements.
- + Check the buggy chassis, seat unit and accessories regularly for signs of damage and tear.
- + Do not use the buggy if any of the parts are damaged, torn or missing.
- + The brakes should always be engaged when placing and removing the children.
- + The maximum weight of the shopping basket is 5 kg/11 lbs.
- + Make sure that children do not climb into the buggy.
- + Do not let a child/children play with this product.
- + Make sure that the brake pedal is fully engaged when applying the brake.
- + The maximum weight of the backrest pocket is 2 kg/4.4 lbs.

MAINTENANCE/WASHING INSTRUCTIONS Clean the fabric with lukewarm water and soap. Rinse with fresh water and leave to dry. Never use bleach or other chemical detergents. Periodically (approximately once a month) treat the wheels and metal parts with Teflon or silicon spray to ensure the buggy continues to run smoothly.

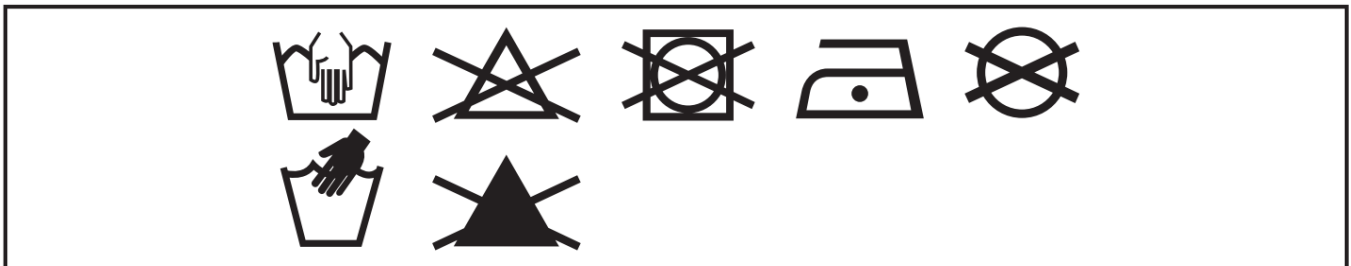

The aluminium parts of your Aer+ buggy are coated to protect it from external influences such as corrosion.

Coated aluminium parts are vulnerable to acidic cleaners or grease, which can cause stains and discoloration of the aluminium parts. We therefore advise you to clean the aluminum parts of your buggy with warm water and a soft cloth.

Safety was an important consideration throughout the development of the Joolz Aer+. Our products therefore meet the following safety standards:

Europe: EN 1888-2:2018

United States: ASTM F833-21

Australia: AS 2088:2022

Please visit joolz.com, facebook.com/myjoolz or contact your retailer for any questions and/or comments

IMPORTANT: PLEASE READ THESE INSTRUCTIONS CAREFULLY BEFORE USAGE AND KEEP THEM FOR FUTURE REFERENCE. FOLLOW THE MANUFACTURER'S INSTRUCTION.

- + The stroller is intended for children from 6 months, up to maximum weight of 22 kg.

- + To avoid injury or death: always apply the brakes whenever the stroller is stationary.
- + Do not leave children unattended.
- + The stroller is not to be used as an unsupervised sleeping environment.
- + Secure the child in the harness at all times.
- + Do not carry extra children or bags on this stroller.
- + Make sure you and your child/children are clear of any moving parts if you adjust the stroller. Otherwise they may be injured.
- + Seat usage is not recommended for a child under 6 months.+ Use the tether strap to stop the stroller from rolling away.
- + Do not use the seat with any other models of stroller.
- + Never leave a harness buckled when not fitted to a child in the stroller because the harness can form loops which may pose a strangulation hazard.
- + Be aware of finger entrapment when folding or unfolding the stroller. Due care should be exercised.
- + Regularly inspect the stroller, chassis and accessories regularly for signs of damage and tear.
- + Only use car seats, replacement or spare parts and accessories that are supplied or approved by Joolz. Using non-approved accessories is unsafe.
- + Care should be taken if the stroller is used on stairs or escalators.
- + The stroller should not be used near an open fire or exposed flame.
- + The maximum weight of the shopping basket is 5 kg.
- + The vehicle is designed for use on flat or gently sloping surfaces and may be unstable on higher sloping and uneven surfaces.
- + When used on higher sloping and uneven surfaces resulting in the possibility of the vehicle tipping over.
- + Make sure storage latch is engaged when lifting or carrying the stroller.
- + Use carry strap to safely transport folded stroller.
- + To use the tether strap stick your hand through the loop and wrap the strap around your wrist.
- + Put on all the brakes whenever you park the stroller.
- + The maximum weight of the backrest pocket is 2 kg/4.4 lbs.
- + Please note this product can unfold without using the activation bottom when shaken.
- + To avoid injury ensure that you and your child/children are safe from moving parts when unfolding, folding and adjusting this product.
- + When the Aer+ is folded ensure that the auto folding lock is engaged before carrying the stroller.

MAINTENANCE/WASHING INSTRUCTIONS

Clean the fabric with lukewarm water and soap. Rinse with fresh water and leave to dry. Never use bleach or other chemical detergents. Periodically (approximately once a month) treat the wheels and metal parts with Teflon or silicon spray to ensure the pushchair continues to run smoothly.

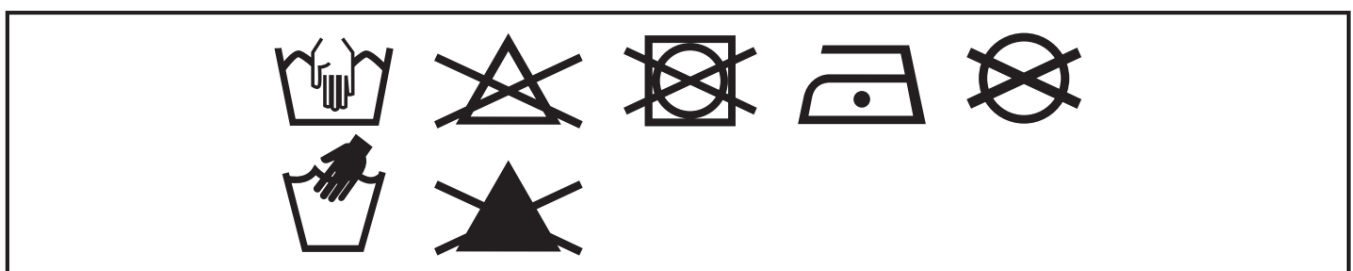

The aluminium parts of your Aer+ buggy are coated to protect it from external influences such as corrosion. Coated aluminium parts are vulnerable to acidic cleaners or grease, which can cause stains and discoloration of the aluminium parts. We therefore advise you to clean the aluminum parts of your pushchair with warm water and a soft cloth.

WARRANTY

Our goods come with guarantees that cannot be excluded under the Australian Consumer Law. You are entitled to a replacement or refund for a major failure and for compensation for any other reasonably foreseeable loss or

damage. You are also entitled to have the goods repaired or replaced if the goods fail to be of acceptable quality and the failure does not amount to a major failure. See page 95 for further information.

Safety was an important consideration throughout the development of the Joolz Aer+. Our products therefore meet the following safety standards:

Europe: EN 1888-2:2018

United States: ASTM F833-21

Australia: AS 2088:2022

Please visit joolz.com, facebook.com/myjoolz or contact your retailer for any questions and/or comments.



Documents / Resources

	<p>JOOLZ Aer Compact Folding Buggy [pdf] Instruction Manual Aer, Aer Compact Folding Buggy, Compact Folding Buggy, Folding Buggy, Buggy</p>
---	---

References

- [Joolz Official Webshop - Positive Design | Strollers and accessories](#)
- [Sites-joolz-bnl-Site](#)
- [Joolz Official Webshop - Positives Design | Design Kinderwagen und Zubehör](#)