

JONSBO T6 Handle Case User Guide

[Home](#) » [JONSBO](#) » JONSBO T6 Handle Case User Guide 

Contents

- 1 JONSBO T6 Handle Case
- 2 Product Specification:
- 3 1. Parts List
- 4 2. Parts Diagram
- 5 3. Before installing the hardware, remove the side panels and bottom panel on both sides
- 6 4. Power supply installation
- 7 5. Cable management
- 8 6. Motherboard installation.
- 9 7. Graphics Card Installation
- 10 8. SSD hard drive installation
- 11 9. Fan installation
- 12 10. Front fan fitter installation
- 13 11. Install the handle
 - 13.1 12. Front panel, side panel, top panel, bottom panel installation /
- 14 Documents / Resources
 - 14.1 References
- 15 Related Posts

JONSBO T6 Handle Case

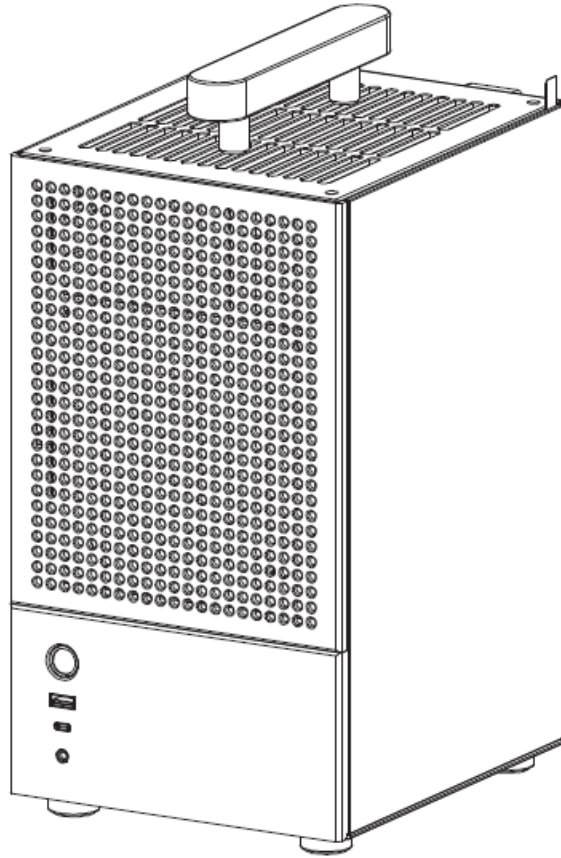

USER GUIDE



MODEL: T6

Product Specification:

- Color: Black/Silver
- Dimension: 185mm(W)*223mm(D)*332mm(H) (with case stand 10mm)
- Material: 3mm Aluminum alloy +1 mm Steel+Wood
- Drive Bay: 2.5" SSD*2
- Motherboard: ITX
- PCI Expansion Slot: 2
- Front I/O Port: Type-Cx1/USB3.0*1 (AUDIO*1+MIC*1 2 in 1)
- PSU Support: ATX:s;140mm
- Max. CPU Cooler Height: :s;160mm
- Max. Display Card Length: :s;215mm
- Cooling System: Front 120mm*1 or 140mm*1 Rear 120mm*1
- Weight: Net 3.5 kg

1. Parts List

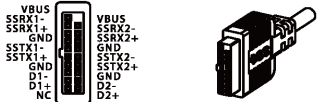
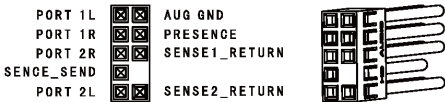
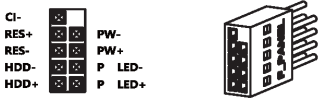
A		×4	Mainboard Screw / 主板螺丝 / Mainboard-Schraube / Vis de la carte mère / 메인보드 나사 / Tornillos de la placa base
B		×4	PSU Screws / 电源螺丝 / Netzteil Schrauben / Vis du bloc d'alimentation / PSU 나사 / Tornillo de potencia
C		×8	SSD step screw / SSD台阶螺丝 / SSD-Stufenschraube / Vis étagée SSD / SSD 스텝 나사 / Tornillo de paso SSD
D		×8	HDD Rubber grommet / 硬盘胶垫 / HDD Gummitülle / Œillet en caoutchouc pour disque dur / HDD 고무 그로밋 / HDD Almohadilla de goma del disco duro
E		×8	Fan Screw / 风扇螺丝 / Lüfterschraube / Vis du ventilateur / 팬 나사 / Tornillo del ventilador
F		×5	Cable tie / 束线带 / Kabelbinder / Attache de câble / 케이블 타이 / Correas de sujeción
G		×1	Cable tie/Velcro / 魔术贴扎带 / Kabelbinder/Klettverschluss / Attache-câble/Velcro / 케이블 타이 / Cinta de Velcro
H		×13	Gasket / 红滑丝垫片 / Dichtung / Joint / 틈 메우는 물건 / Gásquet
I		×1	Handles / 木拔手 / Handhaben / Poignée / 핸들 / Manejar
J		×2	AL standoff / 抛光铝柱 / AL-Abstand / Entretoise AL / 알루미늄 기둥 / Columna de aluminio
K		×2	Screw / 拔手螺丝 / Schraube / Vis / 나사 / Tornillo
L		×1	Wrench / 内六角扳手 / Schraubenschlüssel / clé / 렌치 / llave inglesa
M		×1	Front panel filter / 前板过滤网 / Frontplattenfilter / Filtre du panneau avant / 전면 패널 필터 / Filtro del panel frontal

USB 3.0	HD AUDIO
	
F_PANEL	Type-C Connection
	
<p>The connector diagram only shows the line sequence relationship. Please refer to the actual product for functions</p> <p>连接器图示仅表示线序关系，功能请以产品实际为准</p> <p>Das Anschlussdiagramm zeigt nur die Leitungssequenzbeziehung. Die Funktionen entnehmen Sie bitte dem tatsächlichen Produkt</p> <p>Le schéma des connecteurs montre uniquement la relation de séquence de lignes. Veuillez vous référer au produit réel pour les fonctions</p> <p>커넥터 다이어그램은 라인 순서 관계만 표시하므로 기능은 실제 제품을 참조하십시오</p> <p>El diagrama del conector solo muestra la relación de secuencia de líneas. Consulte el producto real para conocer las funciones</p>	

2. Parts Diagram

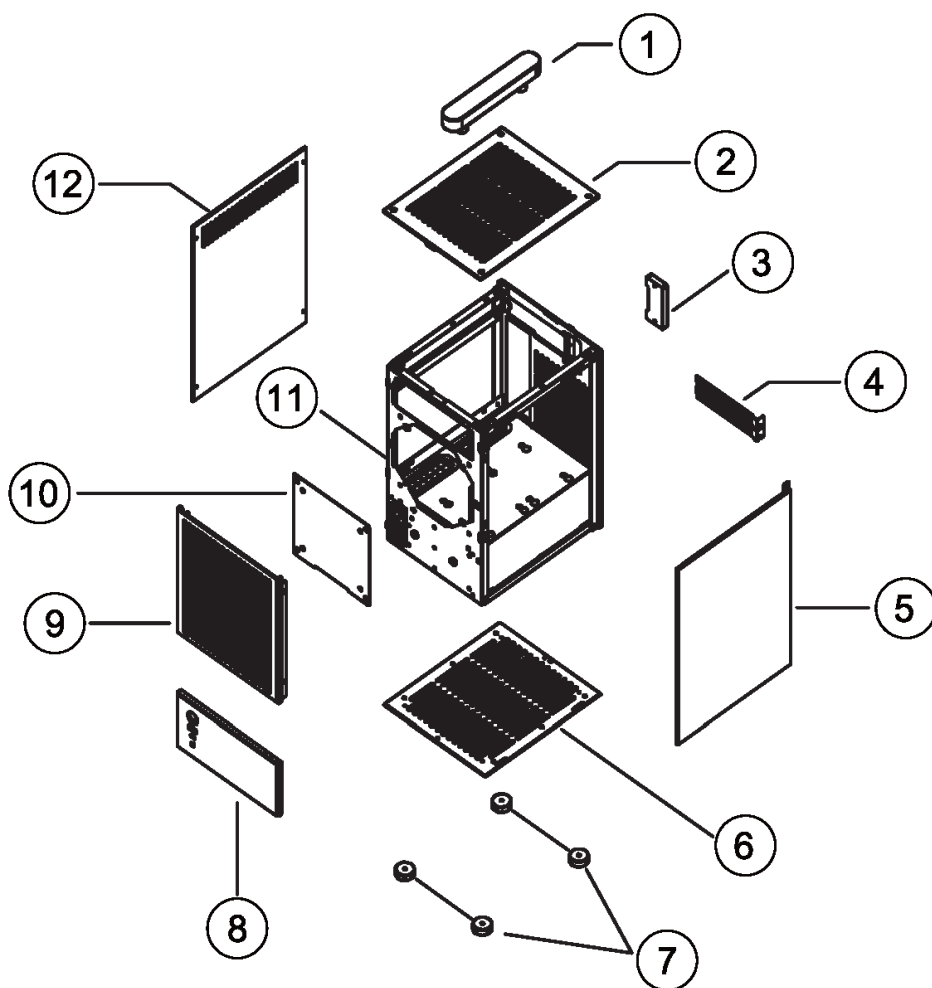

1. Handles
2. Aluminum top cover
3. PCIE cover
4. PCIE card strip
5. Glass side panel
6. Aluminum bottom cover
7. Aluminum feet
8. Wood veneer
9. Aluminum front panel

10. Front panel filler
10. Main body

11. Aluminum side panel

3. Before installing the hardware, remove the side panels and bottom panel on both sides

3.1 Use an internal hex wrench to unscrew the aluminum side panel screws.

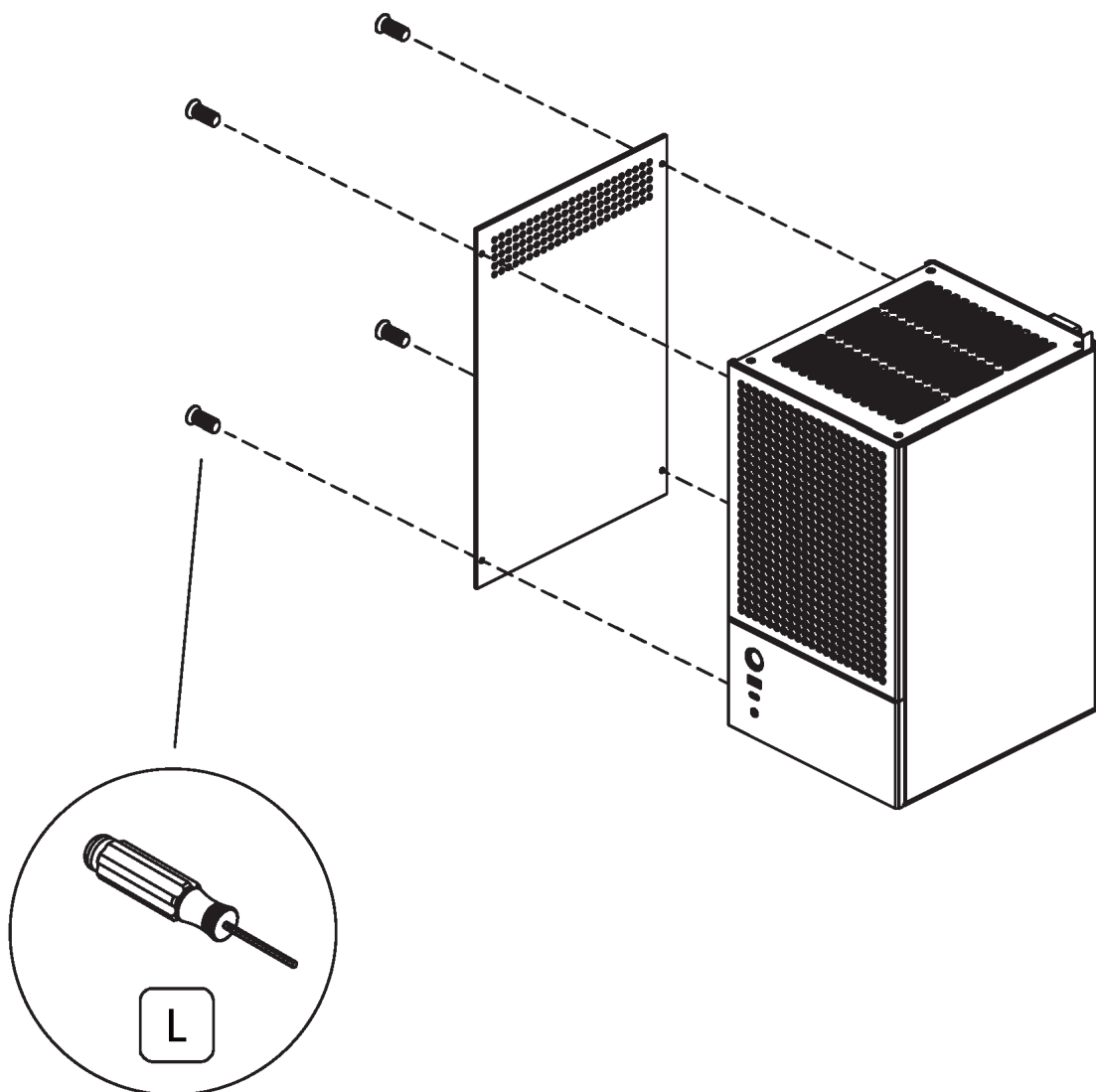

3.2 Use an inner hex wrench to unscrew the bottom plate screw.

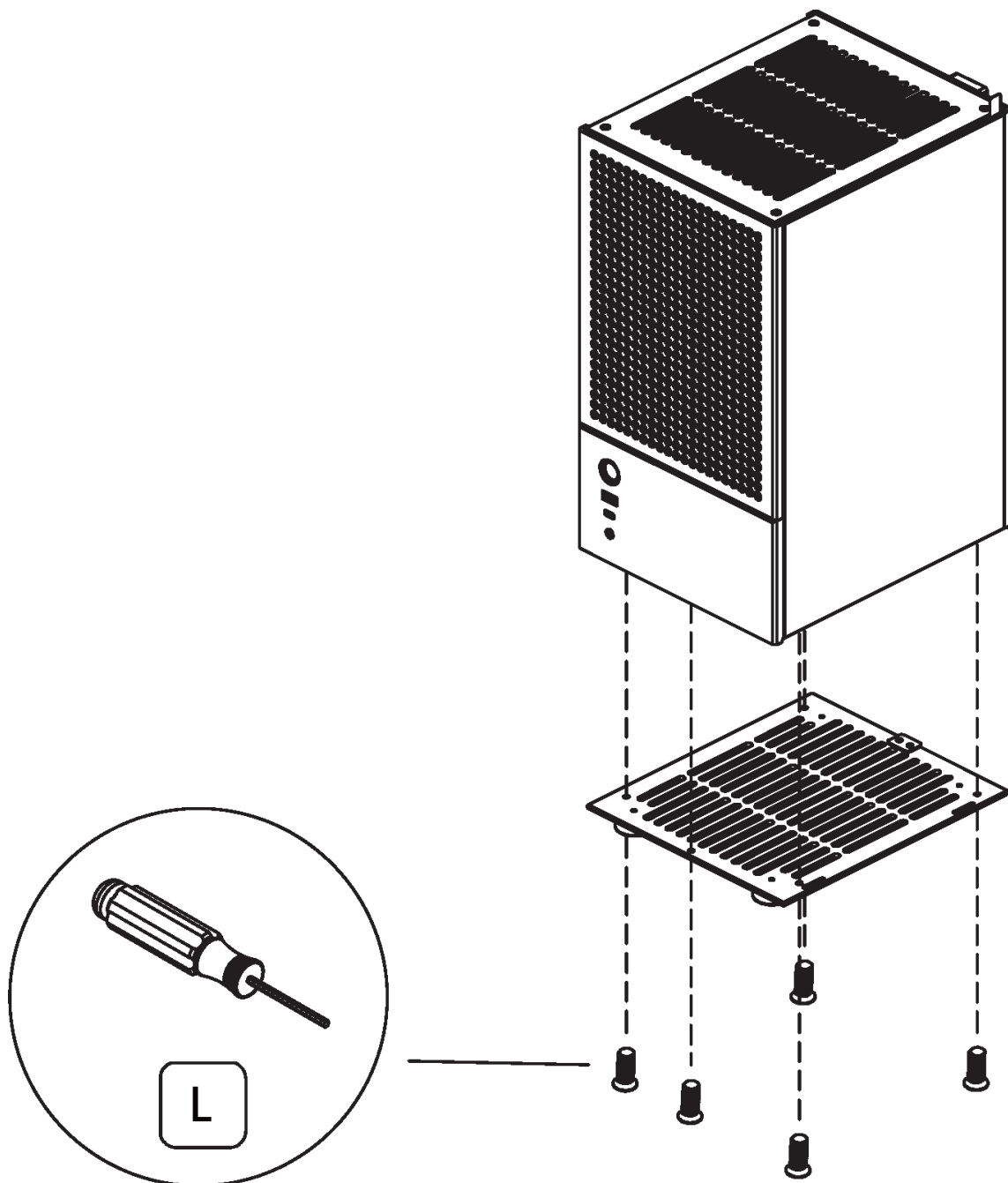

3.3 Use an inner hex wrench to unscrew the bottom plate screw.

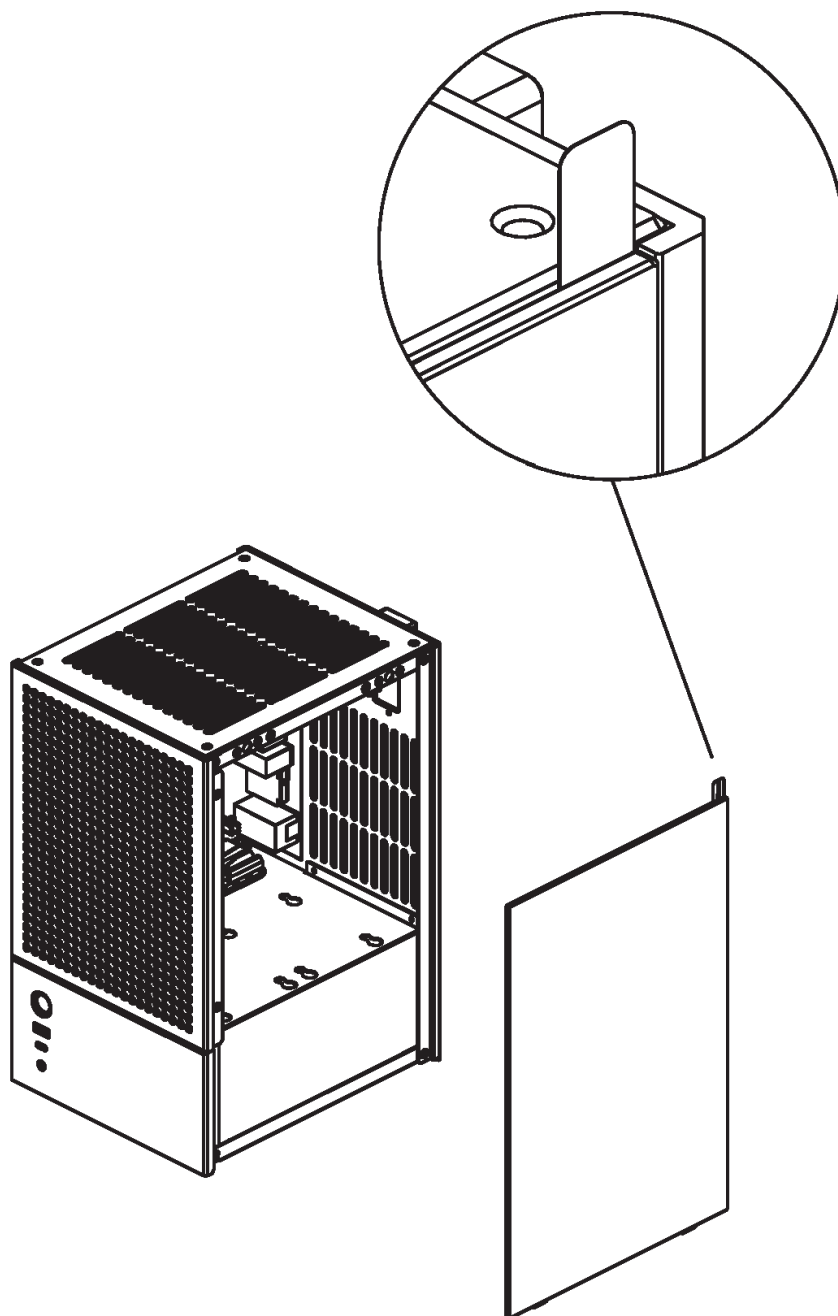

4. Power supply installation

The power supply is placed into the chassis from the bottom and locked with screws.

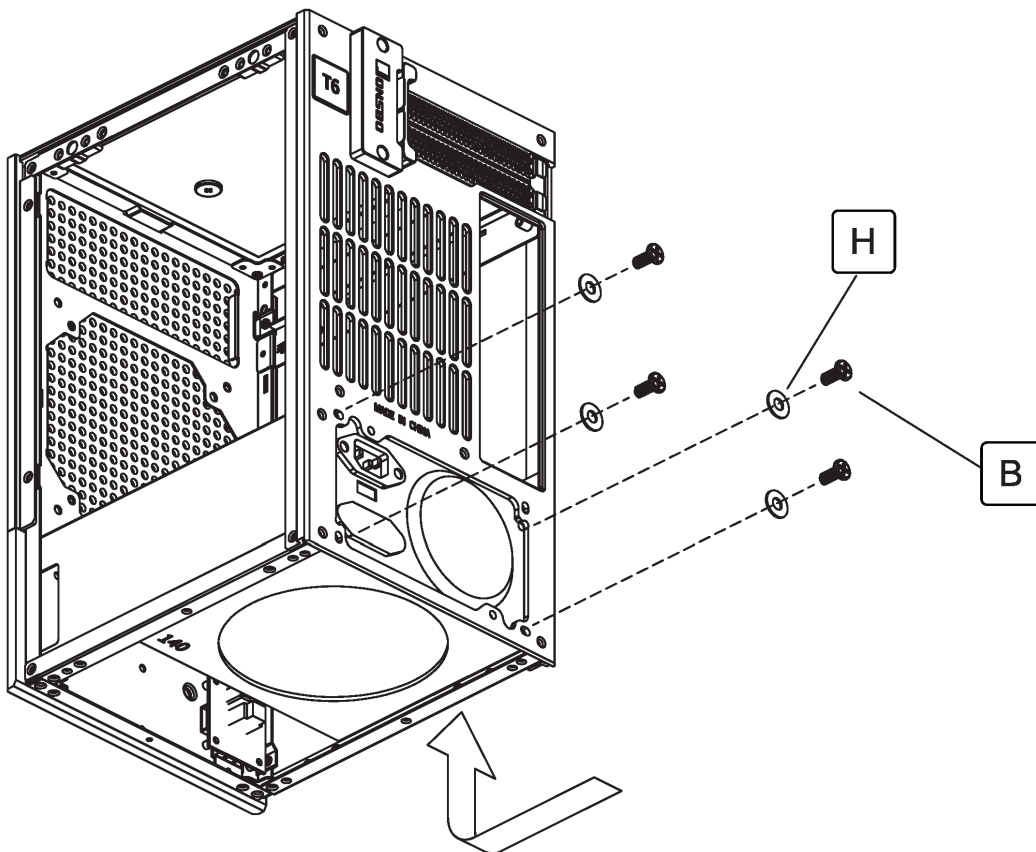

5. Cable management

Before installing the motherboard, arrange the power cables as shown in the diagram.

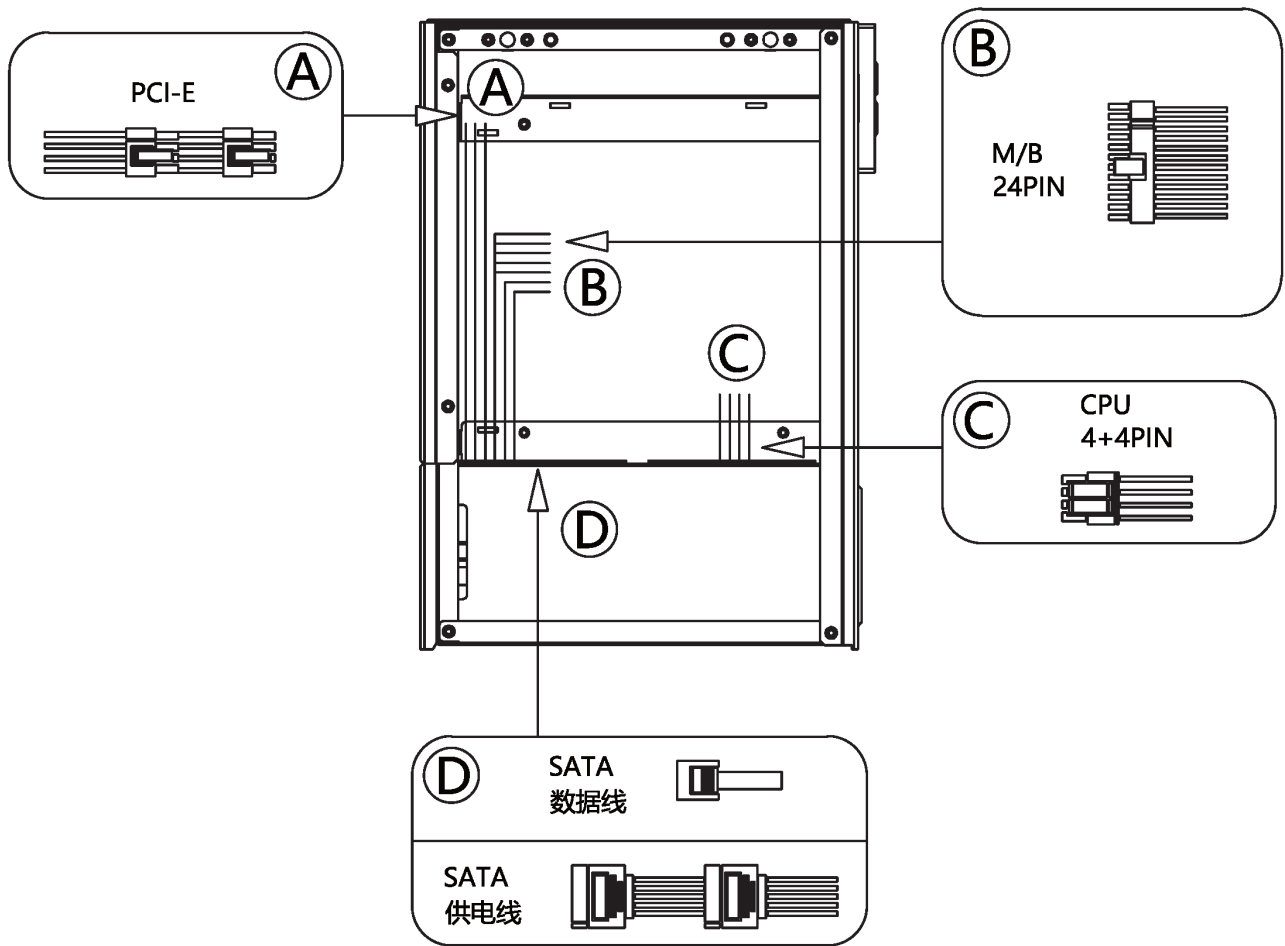

6. Motherboard installation.

The motherboard is placed in the area shown and locked with screws.

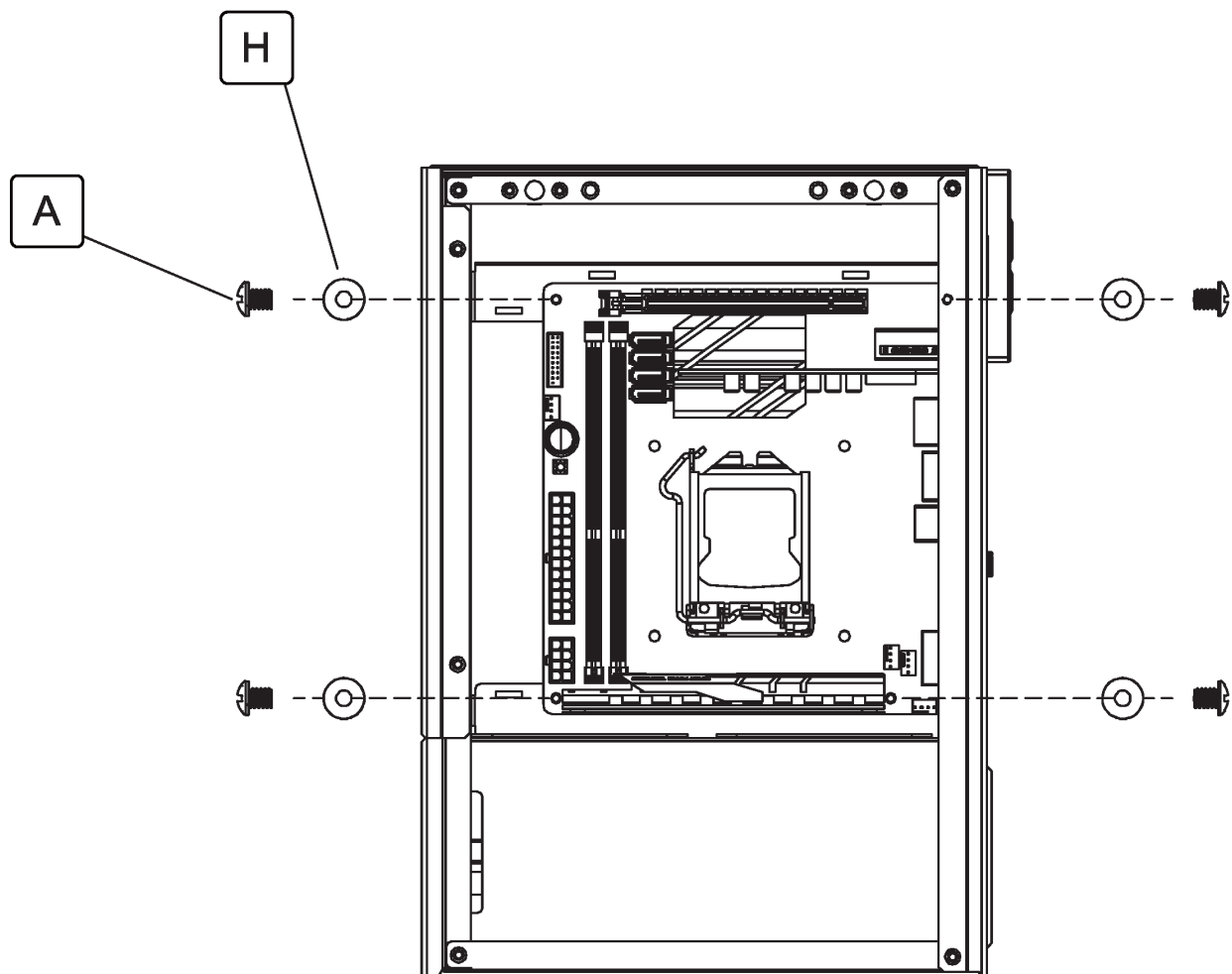

7. Graphics Card Installation

7.1 Use an internal hex wrench to unscrew the front panel screws.

7.2 Use an internal hex wrench to unscrew the PCIE cover and remove the PCIE card strip.

7.3 Insert the graphics card into the motherboard slot and lock it with screws.

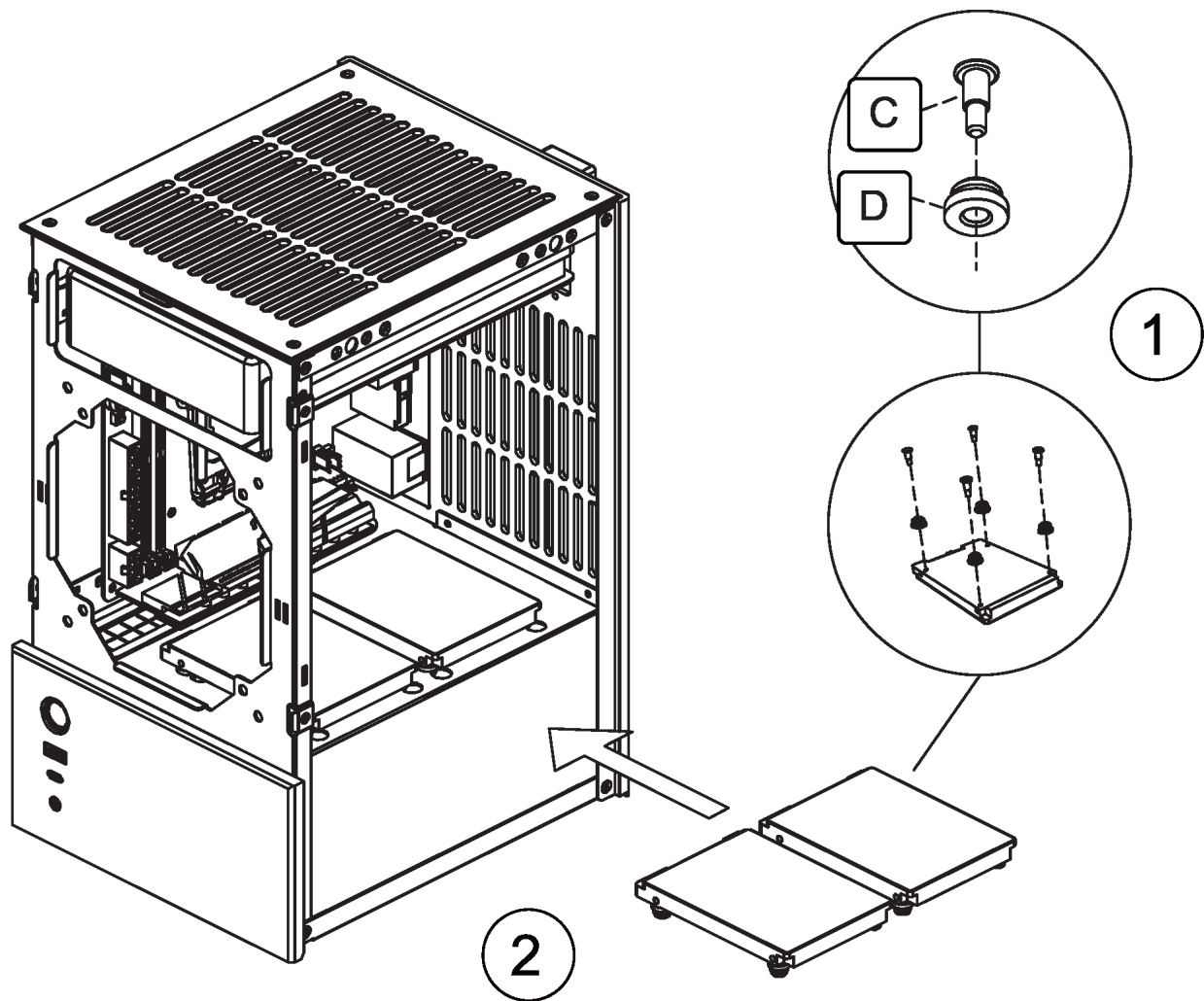

9. Fan installation

Front panel 120mm*1 or 140mm*1 fan, rear panel 120mm*1 fan

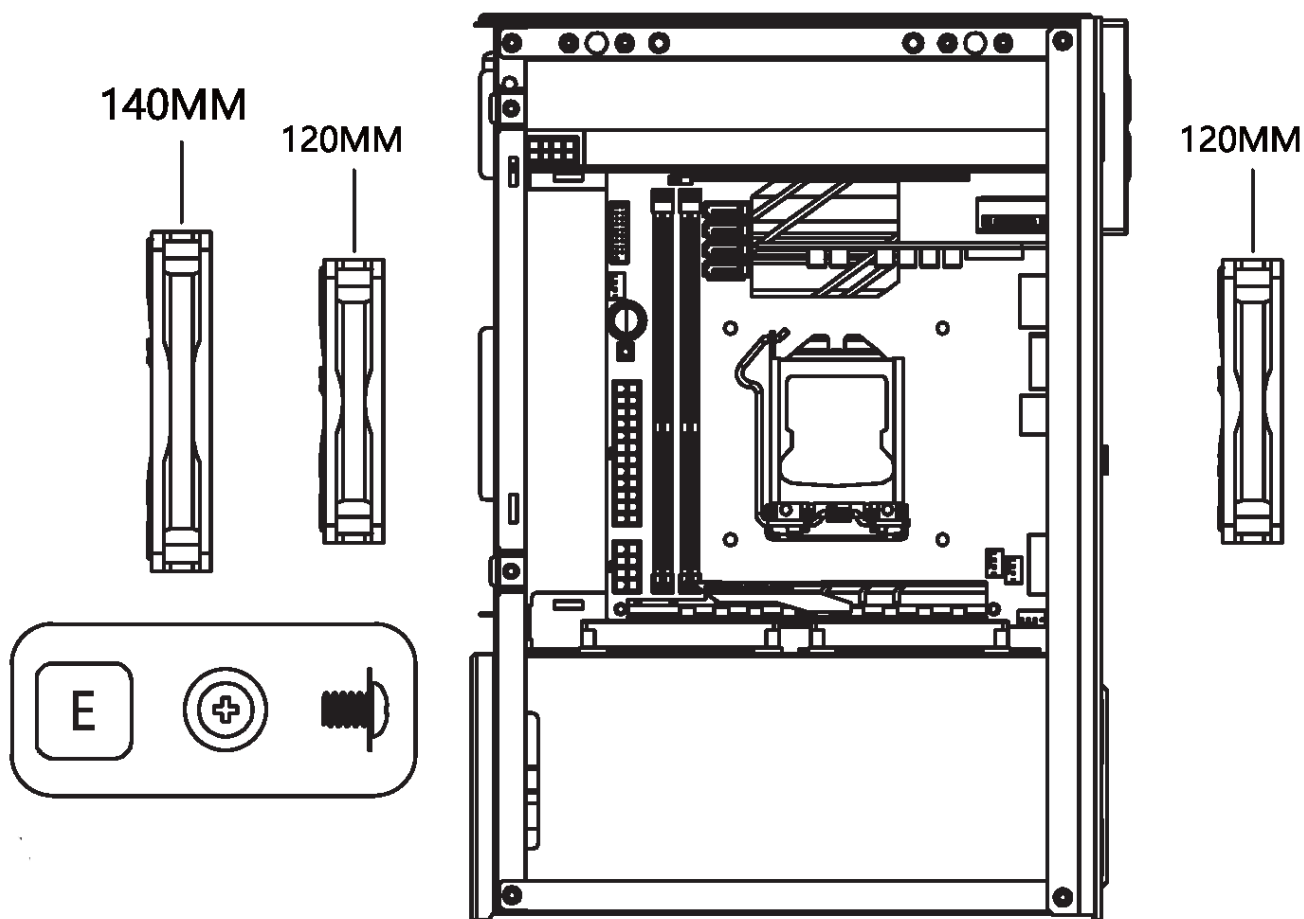

10. Front fan fitter installation

The fan screw passes through the filter and front panel to lock the fan.

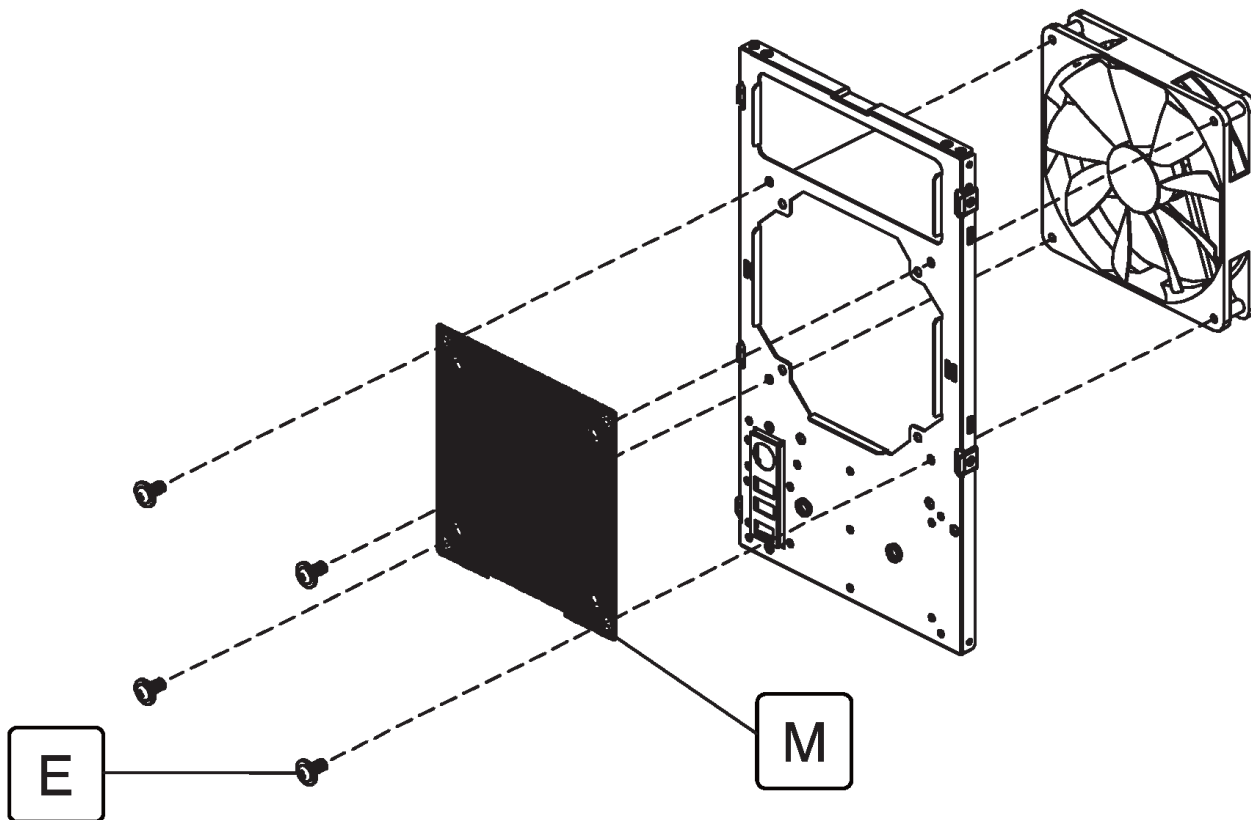

11. Install the handle

11.1 Use an internal hex wrench to unscrew the top plate screws.

11.2 The wooden handle is assembled on the top plate with screws and aluminum posts.

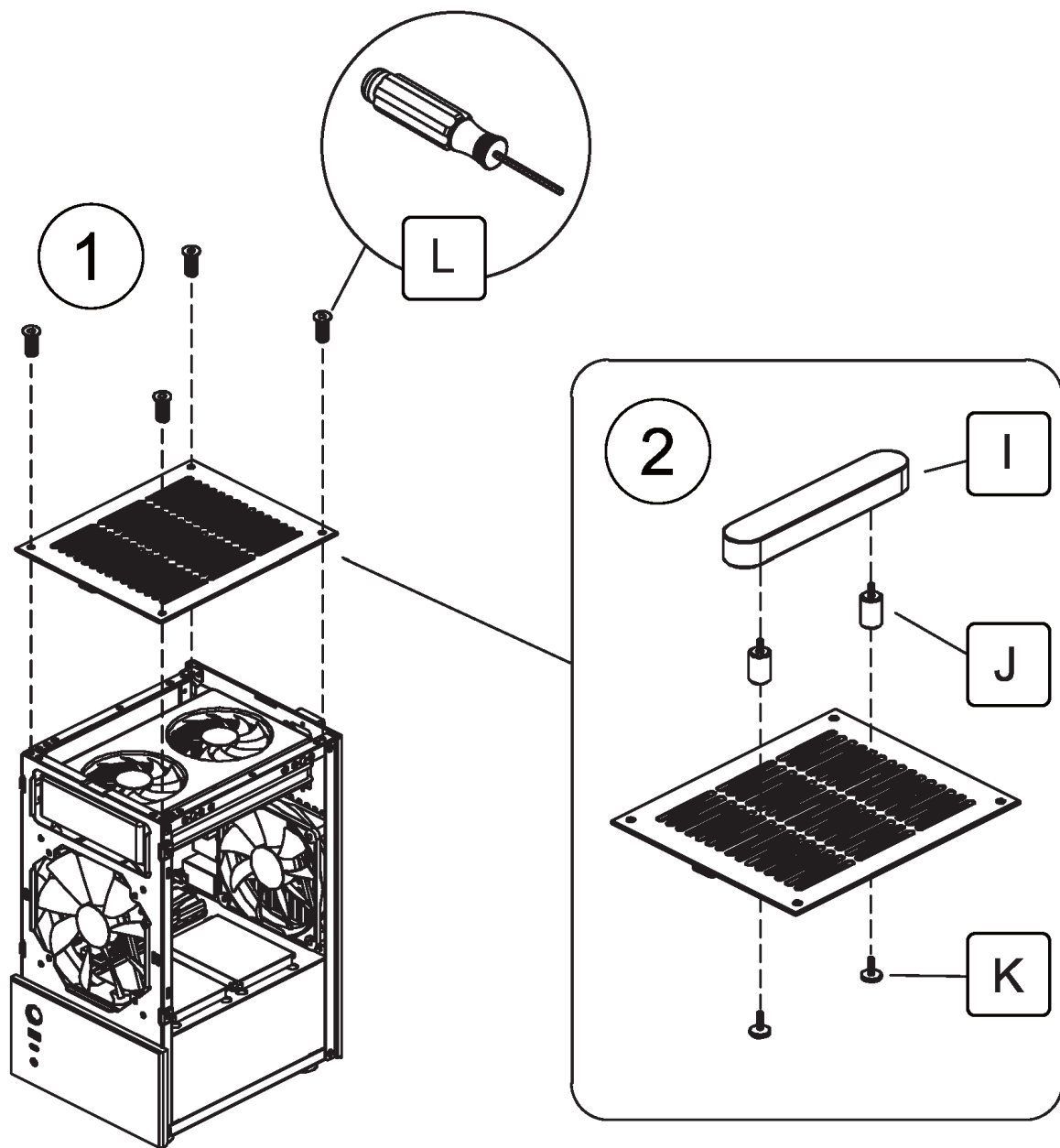

12. Front panel, side panel, top panel, bottom panel installation /

Use an inner hex wrench to install the front, side, top and bottom panels

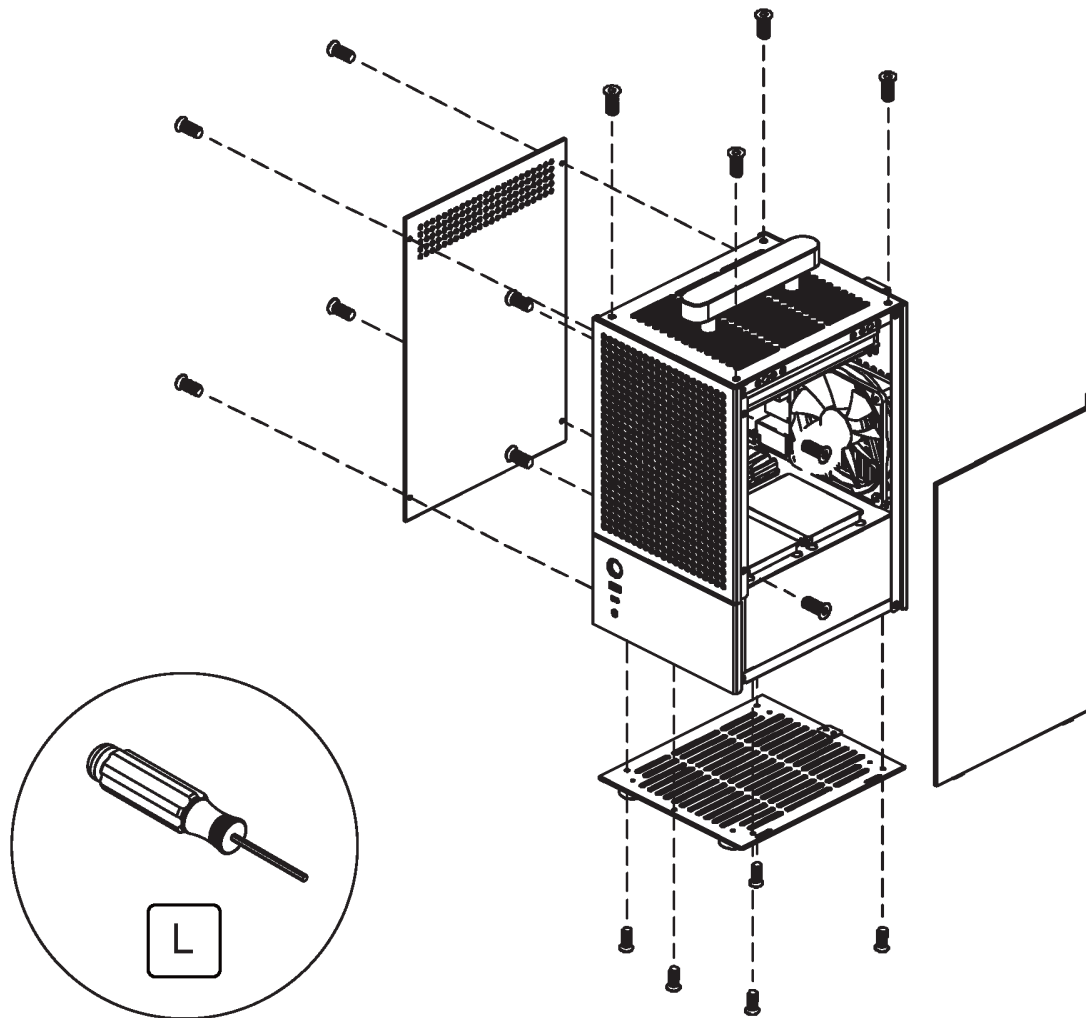

Dongguan Sibositong Industrial Co., Ltd.

No.5, Xinglong Lu, Sanzhong Village, Qingxi Town, Dongguan City, Guangdong Province, 523651, China

© 2023 Dongguan Sibositong Industrial Co., Ltd. All right reserved. Specifications are subject to change without prior notice. Some trademark may be claimed as the property of others.

Documents / Resources

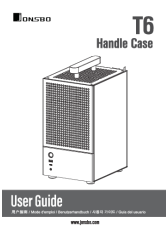
	<p>JONSBO T6 Handle Case [pdf] User Guide T6 Handle Case, T6, Handle Case, Case</p>
---	---

References

- [User Manual](#)

Manuals+. Privacy Policy

This website is an independent publication and is neither affiliated with nor endorsed by any of the trademark owners. The "Bluetooth®" word mark and logos are registered trademarks owned by Bluetooth SIG, Inc. The "Wi-Fi®" word mark and logos are registered trademarks owned by the Wi-Fi Alliance. Any use of these marks on this website does not imply any affiliation with or endorsement.