

## Joie signature float 4WD Drift Horizontal Lightweight Trolley Instruction Manual

[Home](#) » [Joie signature](#) » Joie signature float 4WD Drift Horizontal Lightweight Trolley Instruction Manual 

**Joie signature float 4WD Drift Horizontal Lightweight Trolley**



Read these instructions carefully before use and keep them for future reference. Your child's safety may be affected if you do not follow these instructions.

## Contents

- 1 Emergency
- 2 Parts List
- 3 Accessories
- 4 WARNING
- 5 Stroller Assembly
- 6 Stroller Operation
- 7 Adjust Calf Support
- 8 Care and Maintenance
- 9 Documents / Resources
  - 9.1 References
- 10 Related Posts

## Emergency

In case of emergency or accident, it is most important to have your child taken care of with first aid and medical treatment immediately.

## Parts List

Make sure all parts are available before assembly. If any part is missing, please contact local distributor. No tools are required for assembly.

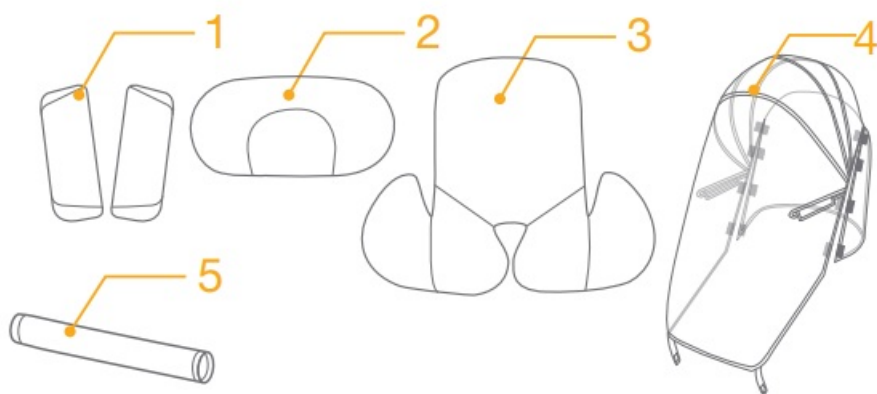

- 1. Canopy
- 2. Drift Button
- 3. One-Hand-Fold Button
- 4. Head Support
- 5. Shoulder Harness Cover
- 6. Armbar
- 7. Seat Pad
- 8. Footrest
- 9. Front Swivel Lock
- 10. Front Wheel
- 11. Rear Wheel

12. 3/5 Point Buckle
13. Reversible Slider
14. Secondary Lock
15. Handle
16. Storage Basket
17. Rear Brake Lever
18. Front Brake Lever

## Accessories

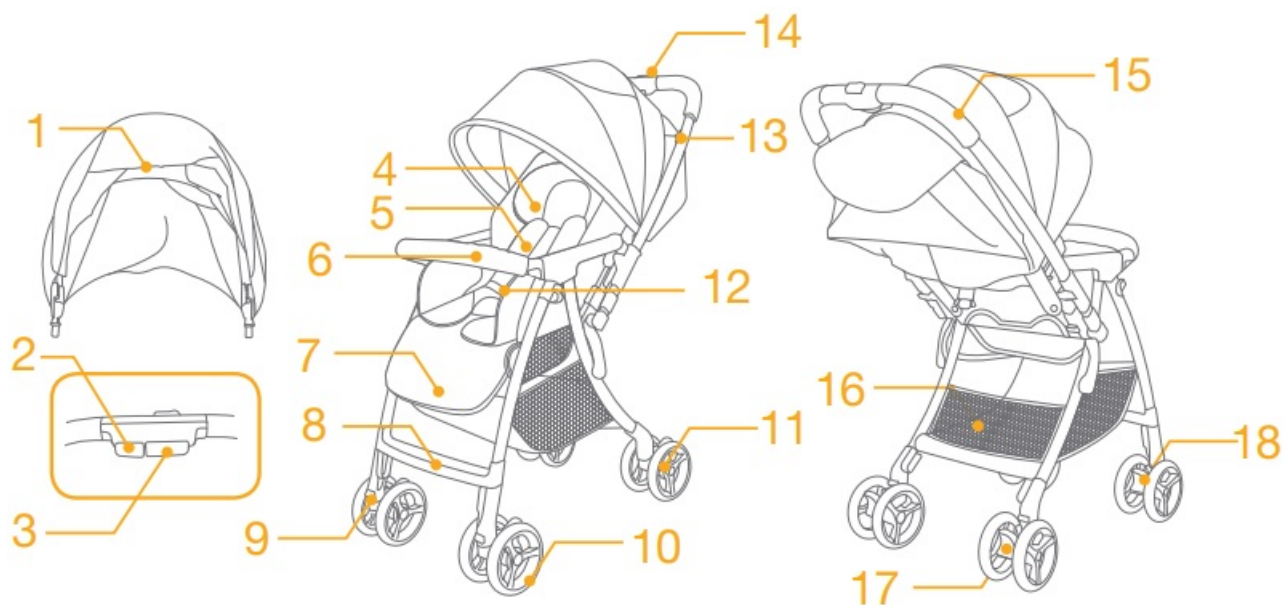

1. Shoulder Harness Cover
2. Head Support
3. Infant Insert
4. Rain Cover
5. Armbar Cover

Accessories may be sold separately or may not be available depending on region.

## **WARNING**

! Always use the restraint system. Safety belts and restraint systems must be used correctly.

! Ensure that all the locking devices are engaged before use.

! Do not let your child play with this product.

! Adult assembly required.

! Use the stroller with a child weighing less than 15kg. It will cause damage to the stroller with an unfitted child.

! To prevent a hazardous, unstable condition, do not place more than 4.5kg in the storage basket.

! Never leave your child unattended. Always keep child in view while in stroller.

! Use the stroller with only one child at a time. Never place purses, shopping bags, parcels or accessory items on the handle or canopy.

! Accessories which are not approved by the manufacturer shall not be used. Only replacement parts supplied or recommended by the manufacturer shall be used.

! Never use accessories, parts or components not produced or approved by the manufacturer. Please read the instruction manual carefully.

! Please read all the instructions in the manual before using the product. Please save instruction manual for future use. Failure to follow these warnings and instructions may result in serious injury or death.

! To avoid serious injury from falling or sliding out, always use seat belt.

! Make sure your child's body is clear from the moving parts when adjusting the stroller.

! Be sure the stroller is fully open or folded before allowing child near the stroller.

! Child may slip into leg openings and be strangled if the harness is not used.

! Never use stroller on stairs or escalators.

! Keep away from high temperature objects, liquids, and electronics.

! Never allow your child to stand on the stroller or sit in the stroller with head toward front of stroller.

! Never place the stroller on roads, slopes or dangerous areas.

! To avoid strangulation, DO NOT place items with a string around your child's neck, suspend strings from this product, or attach strings to toys.

! Any load attached to the handle and/or on the back of the backrest and/or on the sides of the stroller will affect the stability of the stroller.

! DO NOT lift stroller while child is in stroller.

! DO NOT use storage basket as a child carrier.

! To prevent tipping, never let child climb the stroller. Always lift the child in and out of the stroller.

! To avoid finger entrapment, use care when folding and unfolding the stroller.

! To avoid injury, ensure that your child is kept away when unfolding and folding this product.

! To ensure your child's safety, please make sure all parts are assembled and fastened properly before using the stroller.

! To avoid strangulation, do make sure your child is clear from the canopy or rain cover.

! Always engage the brakes when parking the stroller.

! Discontinue using stroller if it is damaged or broken.

! Stroller to be used only at walking speed. This product is not intended for use while jogging.

! To avoid suffocation, remove plastic bag and packaging materials before using this product. The plastic bag and packaging materials should then be kept away from babies and children.

! This product is not suitable for running or skating.

! Pushchair designed to be used from birth shall recommend the use of the most reclined position for new born babies.

! The parking device shall be engaged when placing and removing children.

## Stroller Assembly

(Please refer to figures on page 1-9)

Please read all the instructions in this manual before assembling and using this product.

see image 1



Push secondary lock 1 – 1 and squeeze one-hand-fold button. 1 – 2

Meanwhile, pull the stroller backward to open. Latches should click into place.

! Check that the stroller is completely open before continuing.

### Assemble Canopy

see images 2 – 4

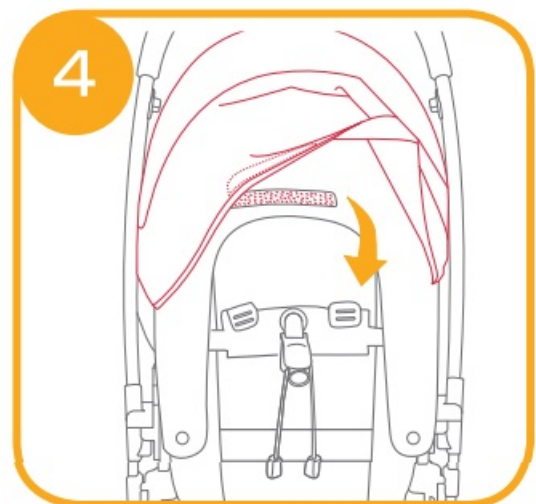
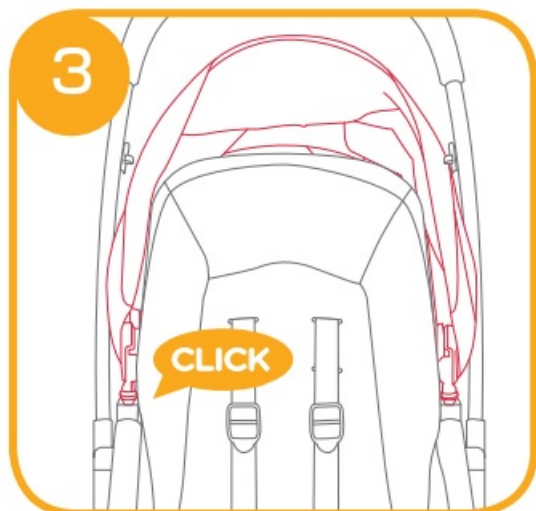
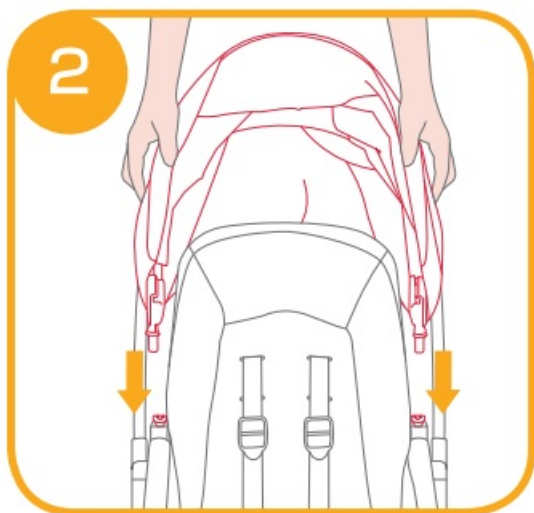

## Assemble & Detach Armbar

see images 5 – 7

The armbar can be pulled up on both left and right sides. Press armbar release button 7 – 1, and then pull up the armbar. 7 – 2

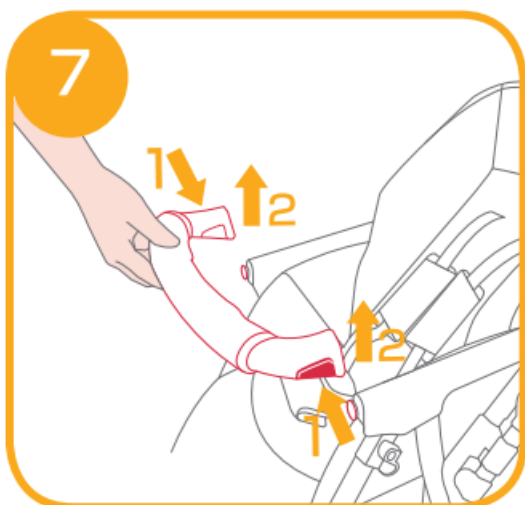
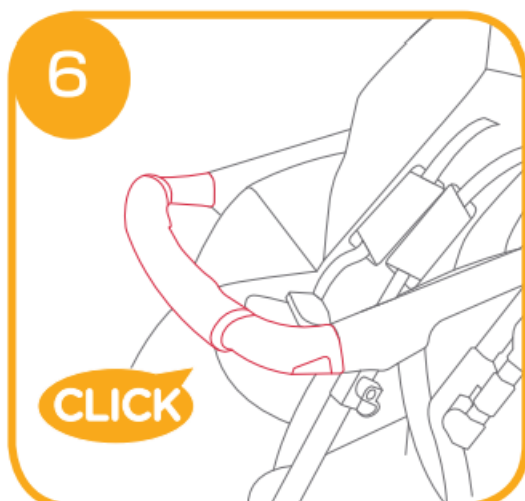
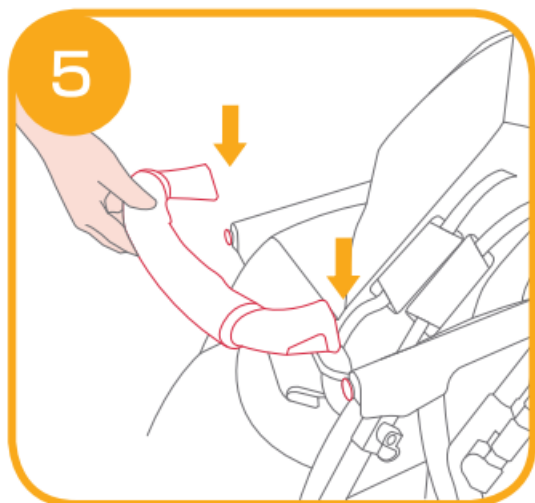



**Tip** Armbar can be removable or pivot open for stroller entry.

The completely assembled stroller is shown as 8

## **Stroller Operation**

### **Adjust Backrest Angle**

see images 9 -10

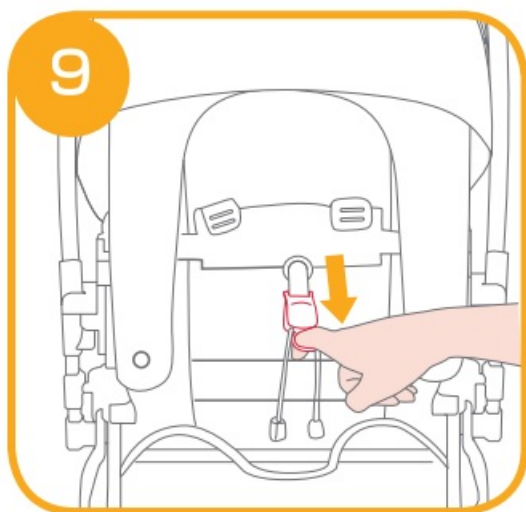



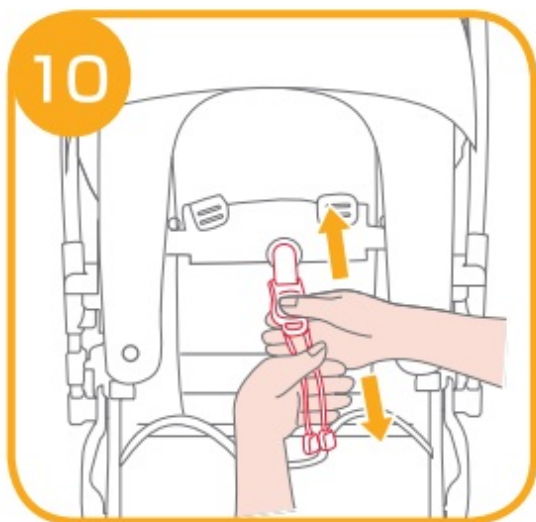

### Recline Backrest

Pull tab to recline backrest 9.

! Hold the backrest with the other hand if a child is already seated in the stroller.

### Raise Backrest

Hold both left and right strings and push up the angle adjuster to raise backrest.

! Make sure the backrest angle is set properly for use. 10

### Use Buckle

see images 11 – 12

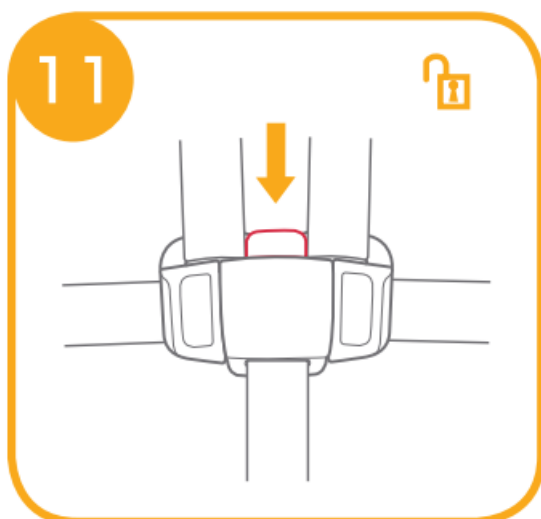

12

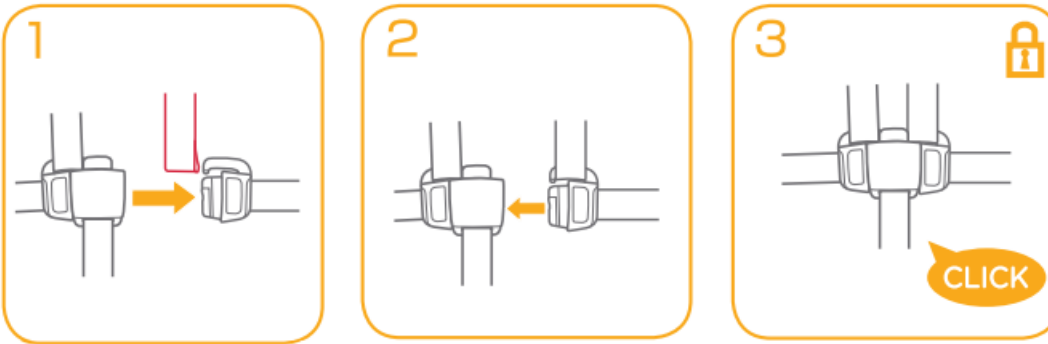

### Release Buckle

Press the button, the buckle will release automatically. 11

### Lock Buckle

Match the waist belt buckle with the shoulder buckle 12 – 1, and align them with the center buckle, the buckle can lock automatically 12 – 2

A “click” sound means the buckle is locked completely. 12 – 3

! To avoid serious injury from falling or sliding out, always secure your child with harness.

! Make sure your child is snugly secured, the space between the child and the shoulder harness is about the thickness of one hand.

! Do not cross the shoulder belts. This will cause pressure on child’s neck.

### Use Shoulder & Waist Harnesses

see images 13 – 16

13

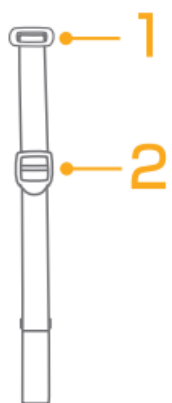

14

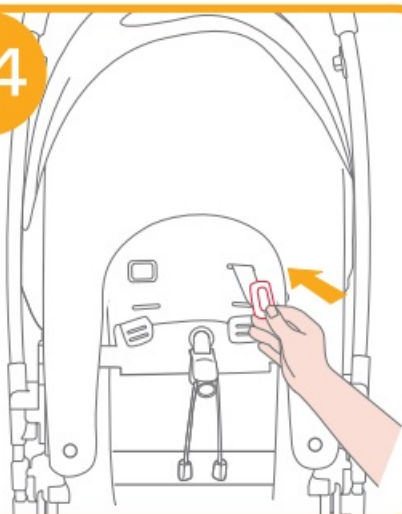

15



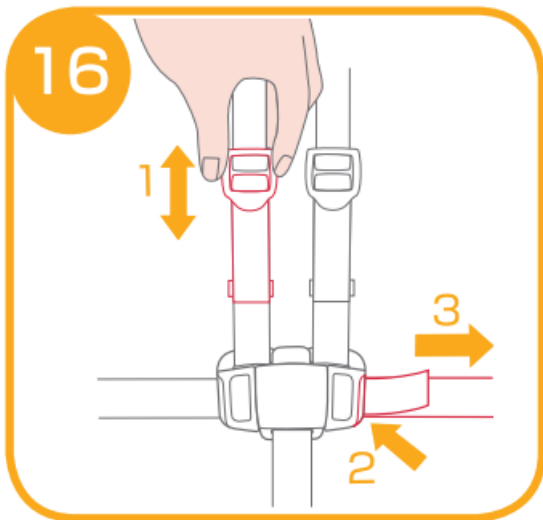

! In order to protect your child from falling out, after your child is placed into the seat, check whether the shoulder and waist harnesses are at proper height and length.

13 – 1 Shoulder harness anchor

13 – 2 Slide adjuster

For larger child, use shoulder harness anchor and the highest shoulder slots. For smaller child, use shoulder harness anchor and the lowest shoulder slots.

To adjust the position of the shoulder harness anchor, turn the anchor to be level with the side facing forward. Thread it through the shoulder harness slot from back to front. 14 Rethread it through the slot that is closest to child's shoulder height. 15

Use slide adjuster to change the harness length. 16 – 1

Press the button 16 – 2, while pulling the waist harness to proper length. 16 – 3

## Adjust Calf Support

see images 17 -18

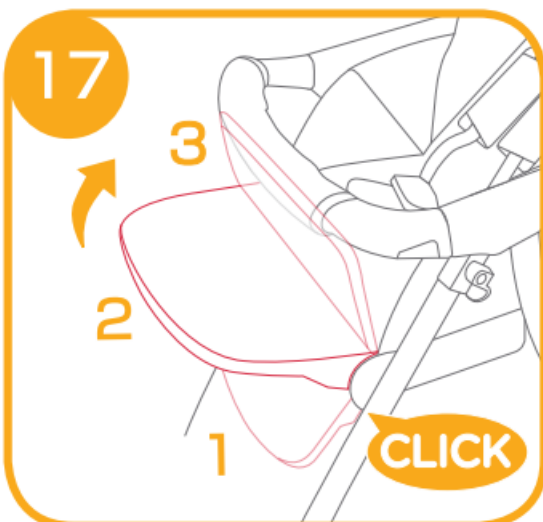

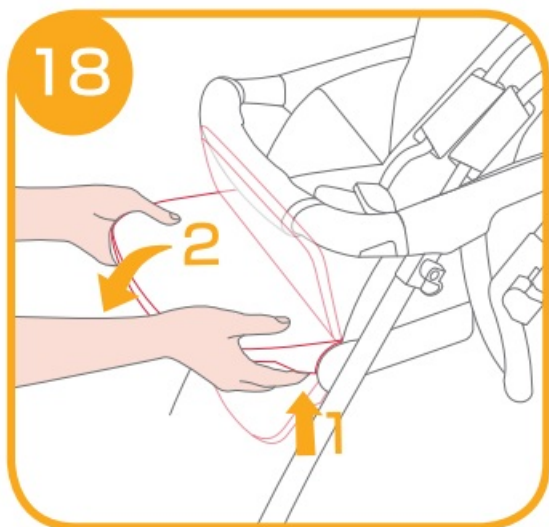

There are two recline angles, 1-2 1 7 for adjustment.

To raise calf support, push the calf support from position 1 to position 2 17

To lower calf support, press the adjustment buttons on both sides of the calf support 18 – 1, and rotate the calf support downwards. 18 – 2

### Use Canopy

see image 19

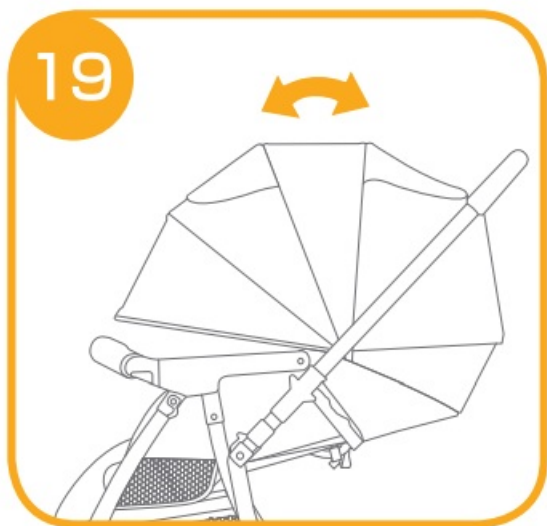

To open the canopy, pull canopy toward front. 19

To fold the canopy, pull canopy toward back. 19

### Switch Handle Direction

see image 20

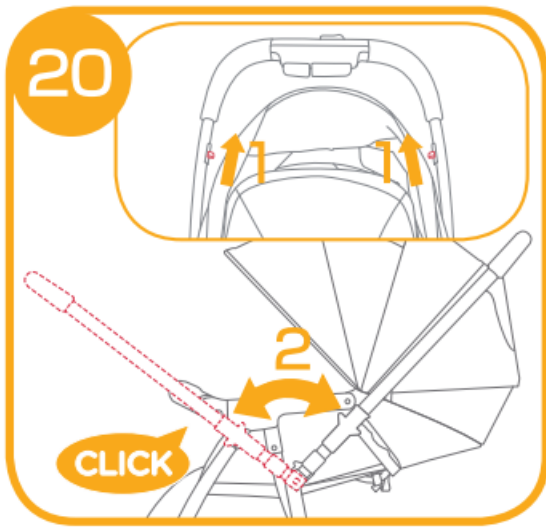

! Make sure child's hands and legs are clear from the armrest when switching the handle.

! Front swiveling wheels or rear swiveling wheels can be locked automatically when you use the handle in rear facing position or front facing position.

#### Use Front Swivel Lock

see images 21 – 23

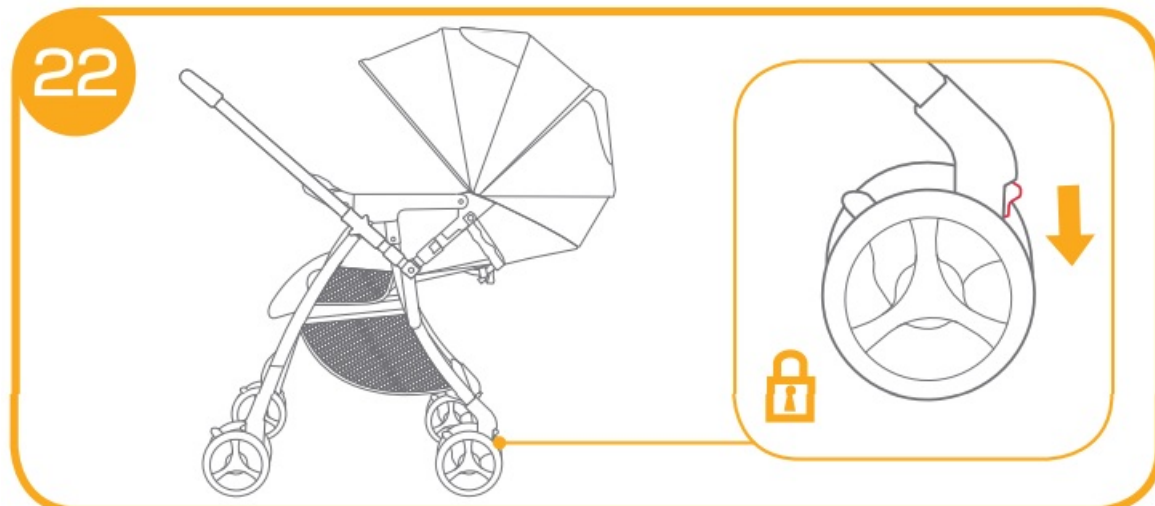
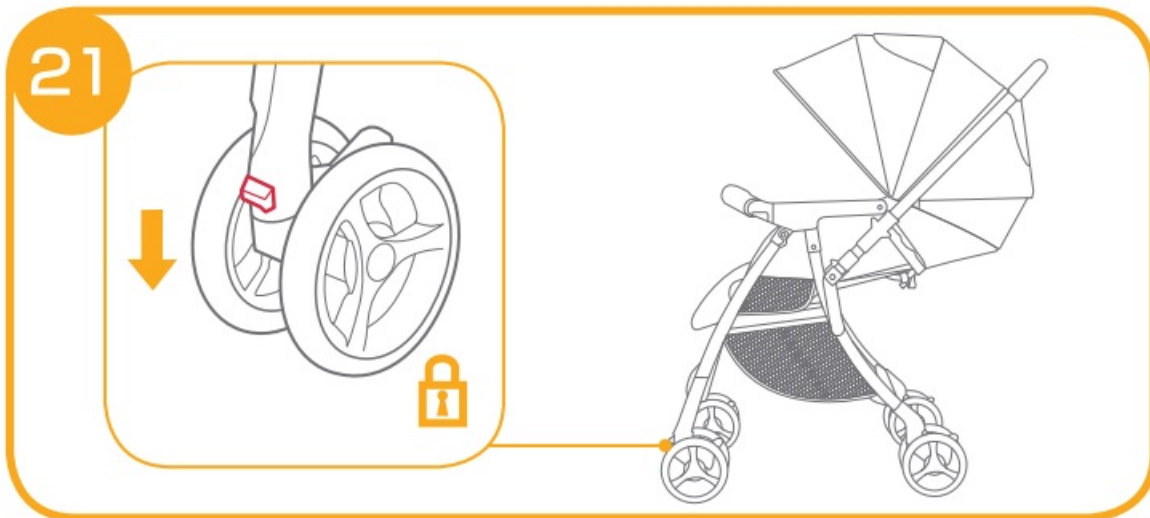

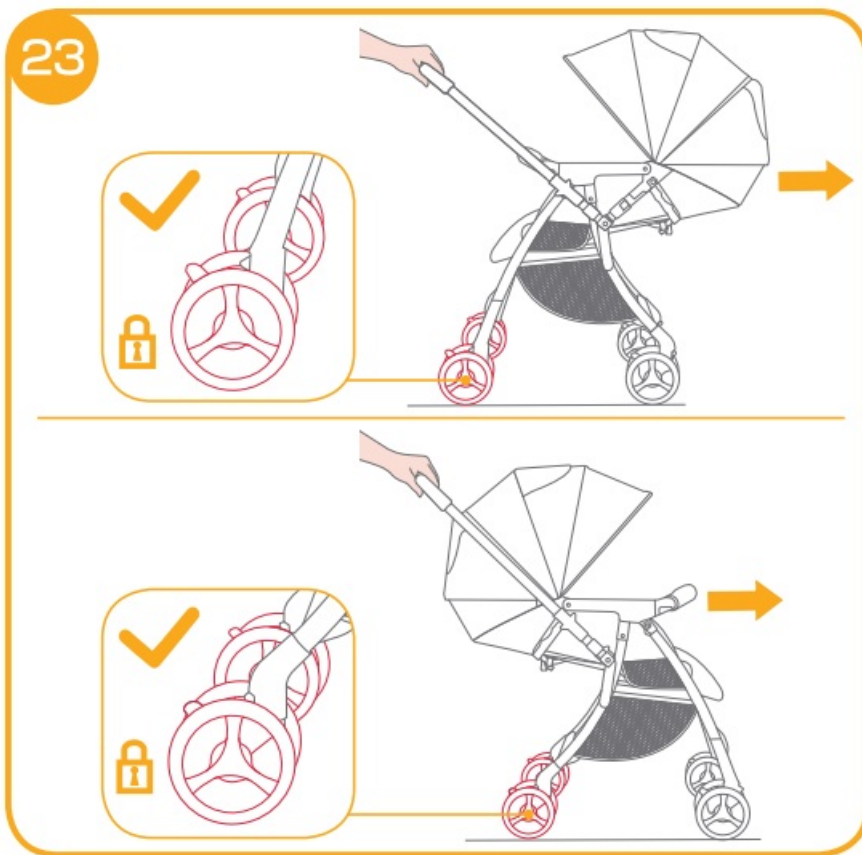

Press the front swivel locks to maintain the moving direction. 21 22

**Tip** It is recommended to use swivel lock on uneven surfaces.

! After switching the handle position, push the stroller forward to ensure that the wheels nearest to you are locked and do not swivel. 23

### Use Brake

see image 24

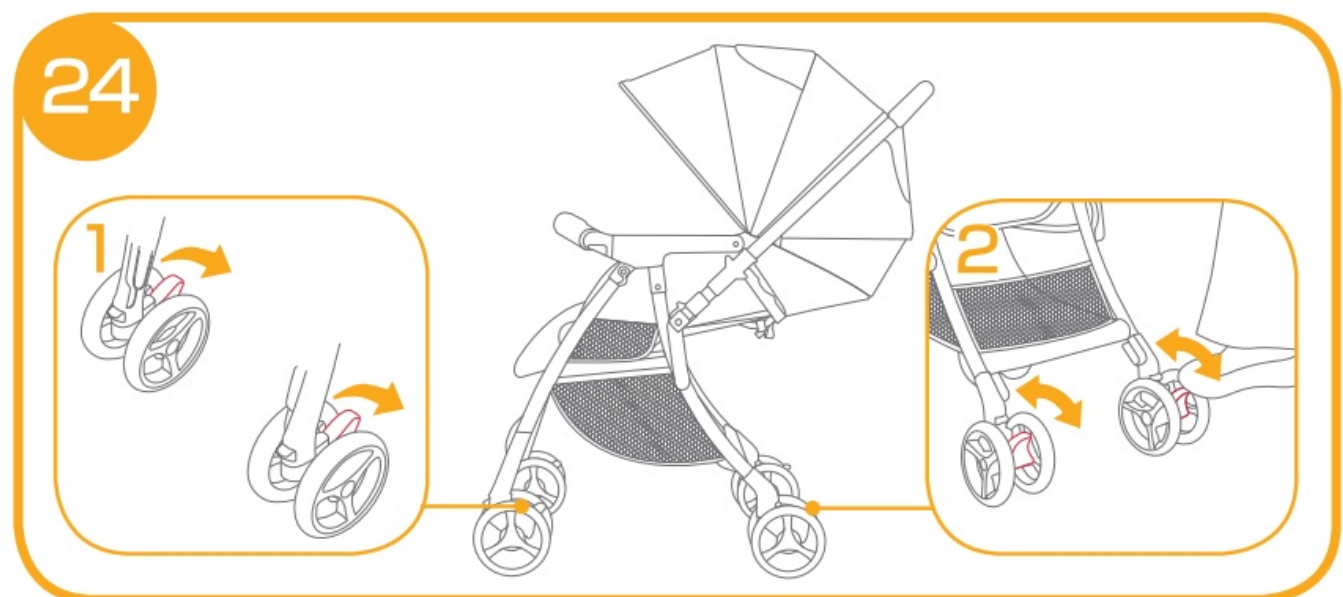

To lock wheels, step on the brake lever. Front wheel is shown as 24-1, rear wheel is shown as 24-2.

Lift the brake lever to release wheel.

**Tip** The brake must be engaged when placing and removing children.

**Tip** Always apply brake when stroller is in stopped position.

**Tip** To ensure brake is fully on, gently rock the stroller backwards and forwards before releasing the handle.

**! WARNING** To prevent potential hazard, always make sure the parking device for all swiveling wheels are engaged when you reverse the handle.

### Use Drift

see images 25 – 26

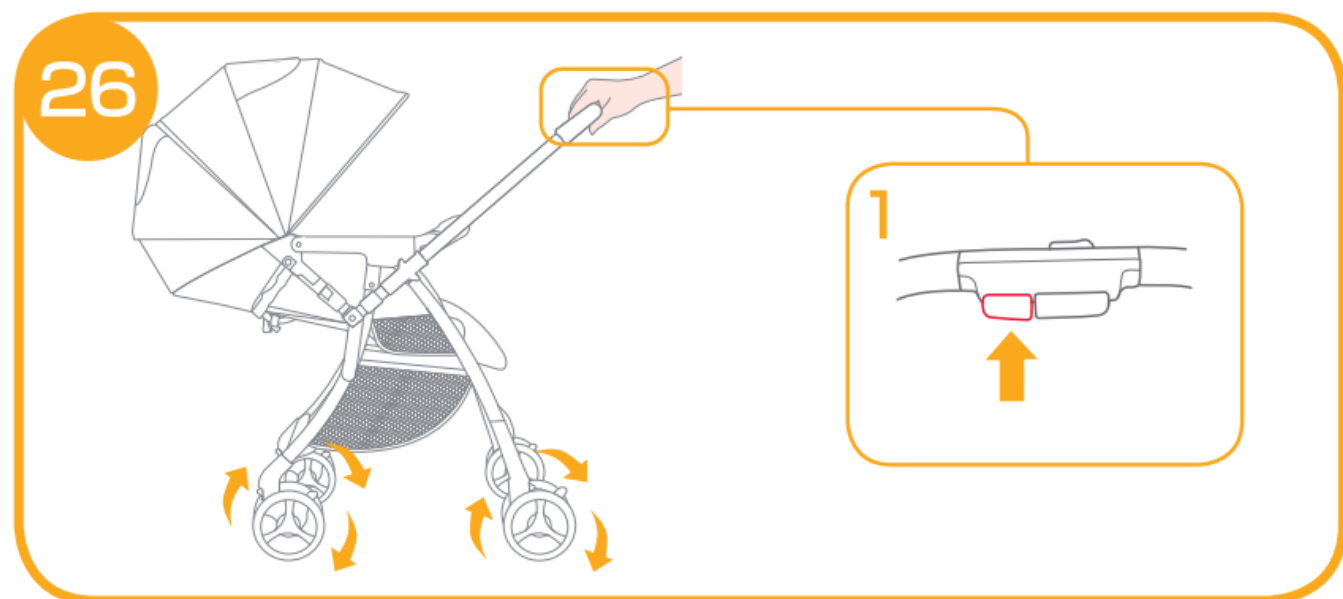
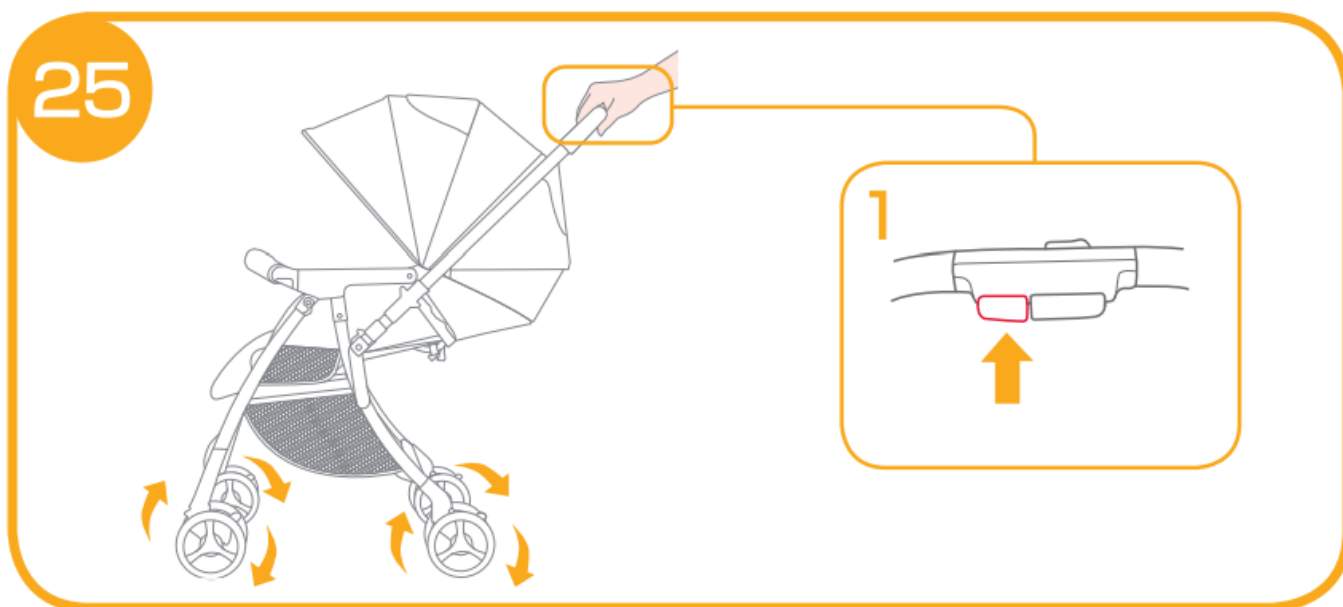



Press the drift button 25 – 1 & 26 – 1, all wheels of the stroller can be rotated. 25 26

! Please release front wheel orientation lock and rear wheel brake pedal before use drift.

! When use drift, all wheels are in free rotation status, please be sure to push the stroller forward for a distance to make rear wheels return to locked state after use drift, then stroller can be used normally.

## Fold Stroller

see images 27 – 28

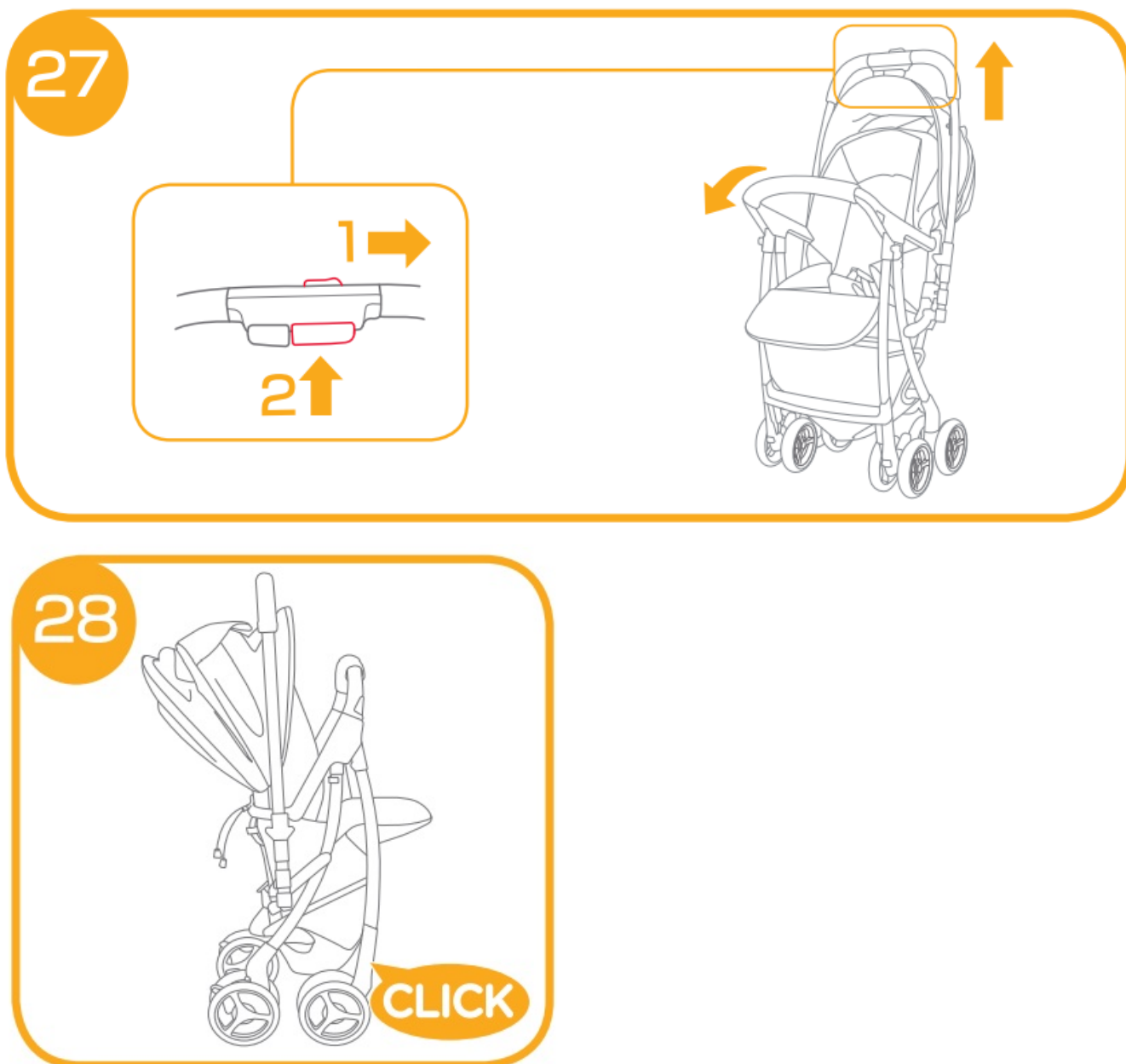

Please fold the canopy before folding the stroller. 19 Push secondary lock 7 – 1 and squeeze one-hand-fold button 7 – 2 Push the stroller forward to fold.

A click sound means the stroller is folded completely. 28

## Use Accessory

Accessories may be sold separately or may not be available depending on region.

### Use Shoulder Harness Cover

see image 29

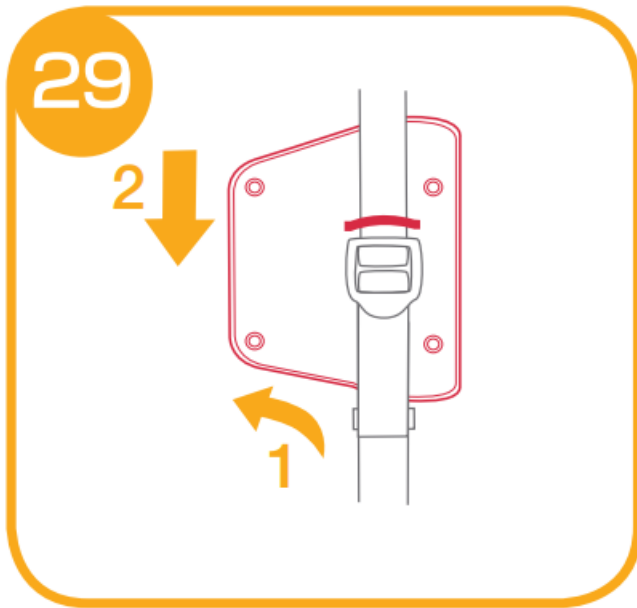

The shoulder harness cover can be removed from the webbing. Simply reverse these steps to re-assemble shoulder harness cover.

### Use Armbar Cover

The armbar cover can be removed from the armbar. Simply reverse these steps to re-assemble armbar cover.

### Use Head Support & Infant Insert

see image 30

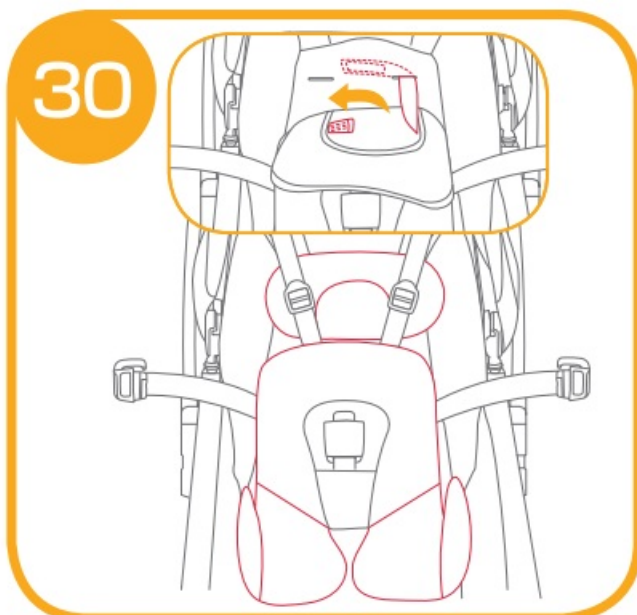

## Detach & Assemble Soft Goods

see images 31 – 40

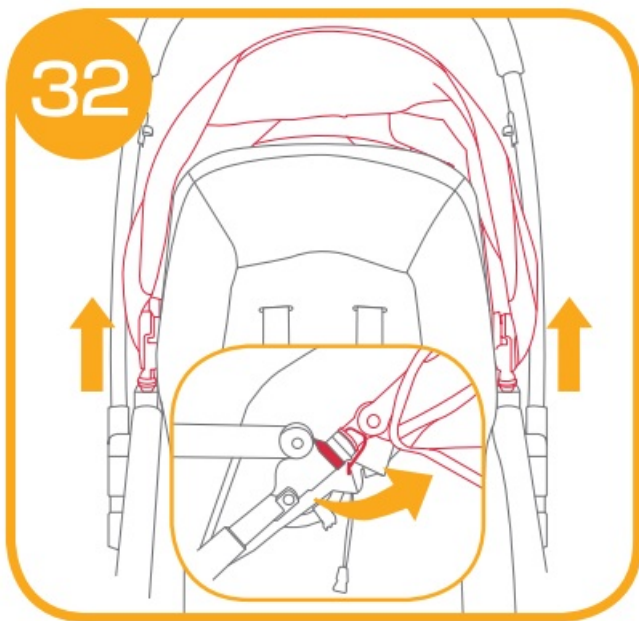
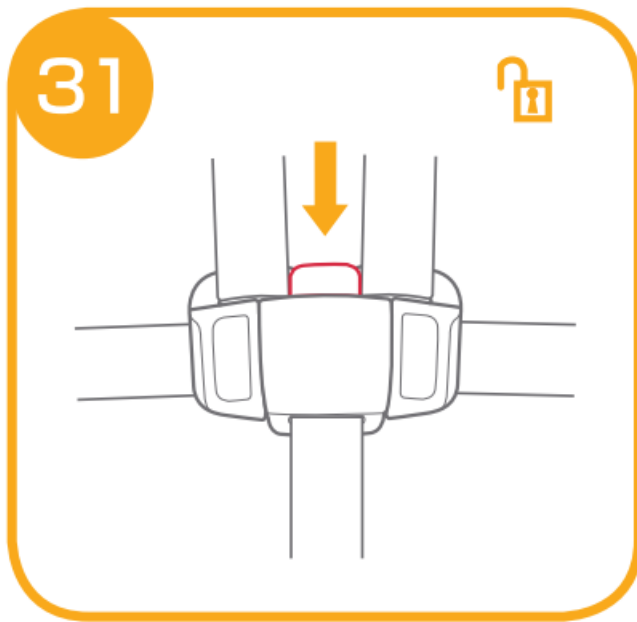

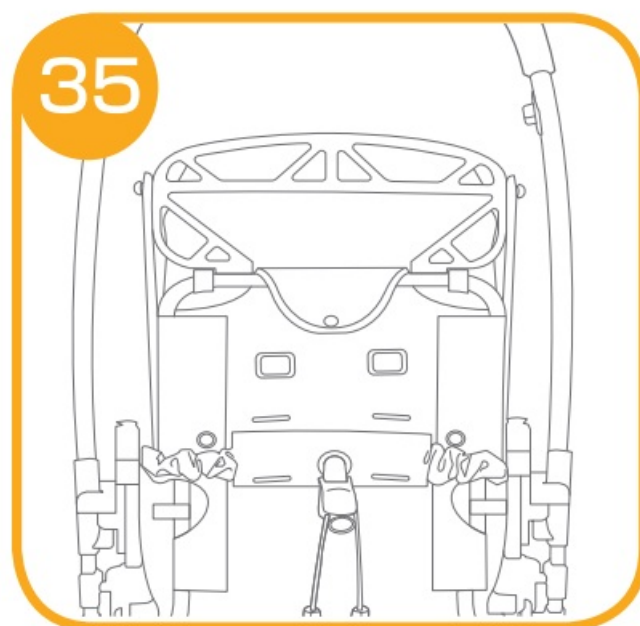
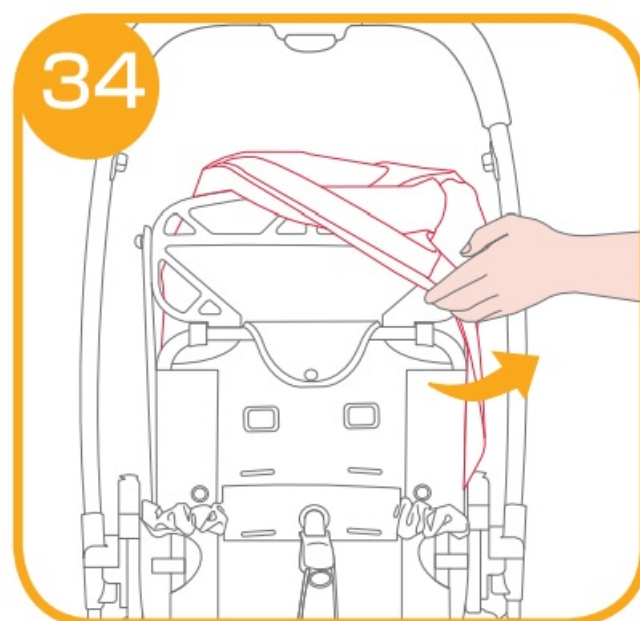
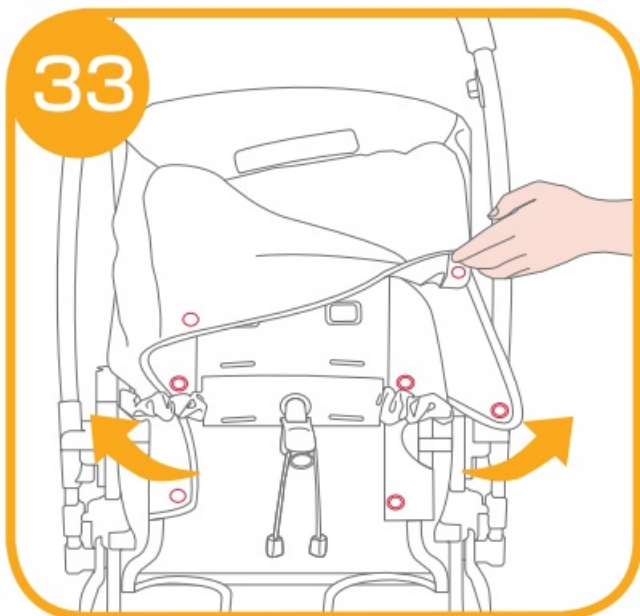

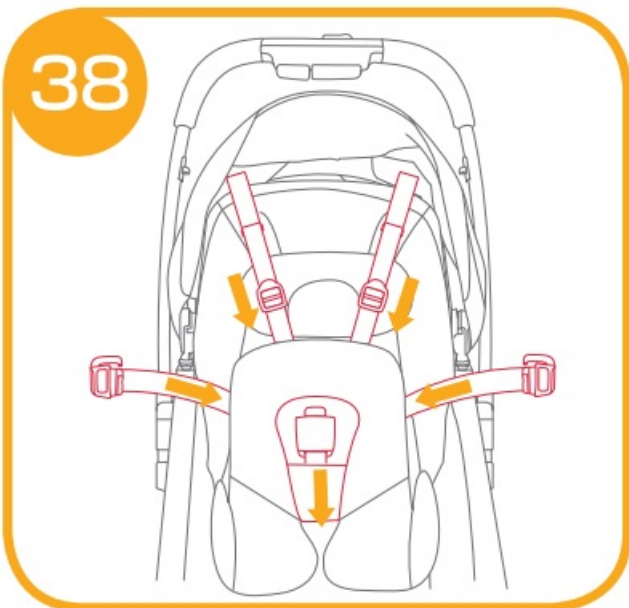
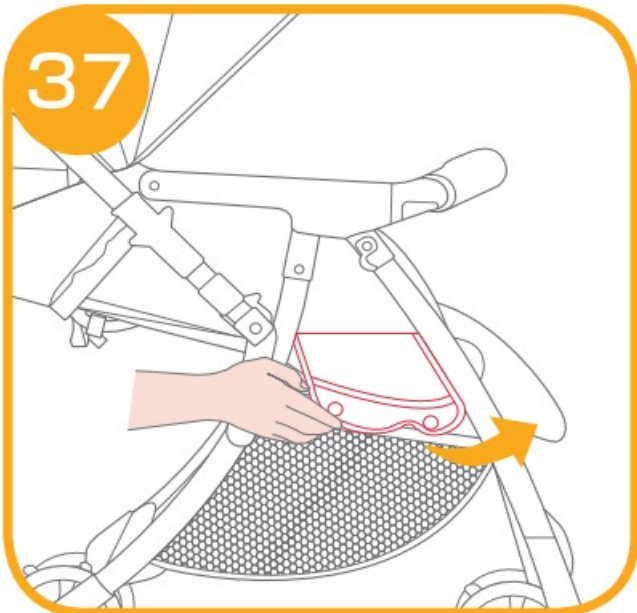
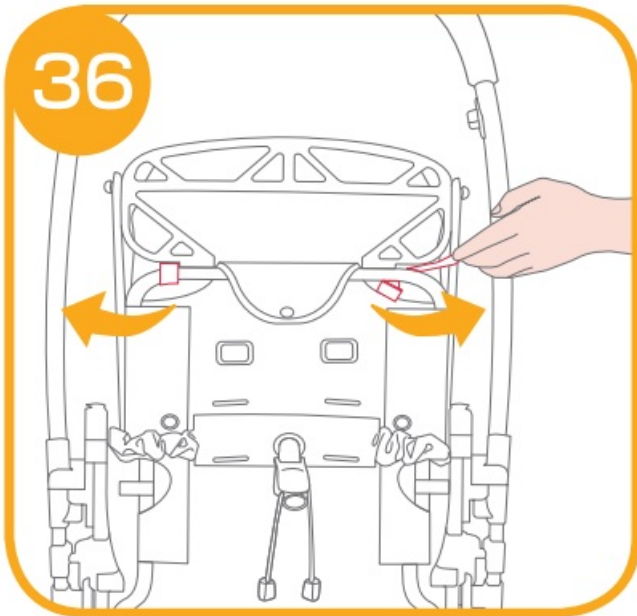

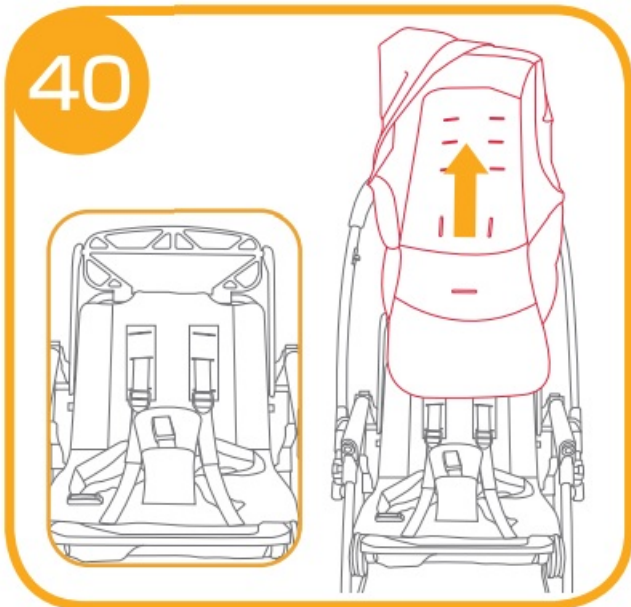
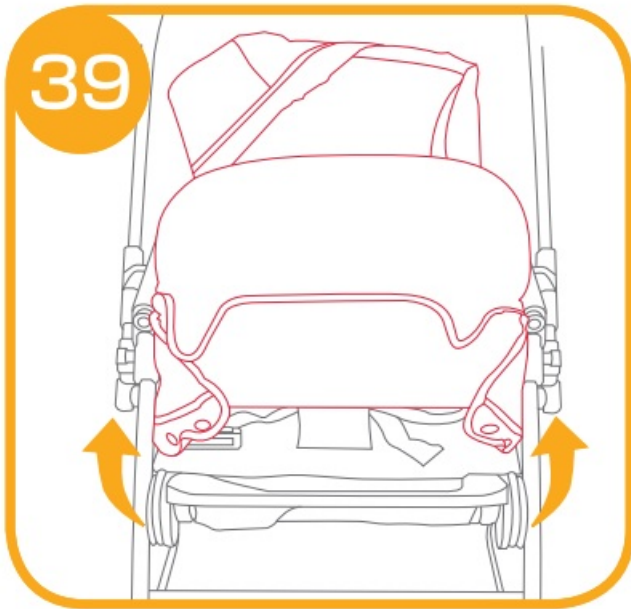

To re-assemble seat soft goods, follow the steps above in reverse 40-31

#### **Use Rain Cover**

**see image 41**



To assemble the rain cover, place it over the stroller, and then attach the seaps and hook and loop fasteners on the rain cover.

! When using the rain cover, please always check its ventilation.

! When not in use, please check that the rain cover has been cleaned and dried before folding.

! Do not fold the stroller after assembling the rain cover.

! Do not place your child into the stroller assembled with rain cover during hot weather.

## Care and Maintenance

see image 42

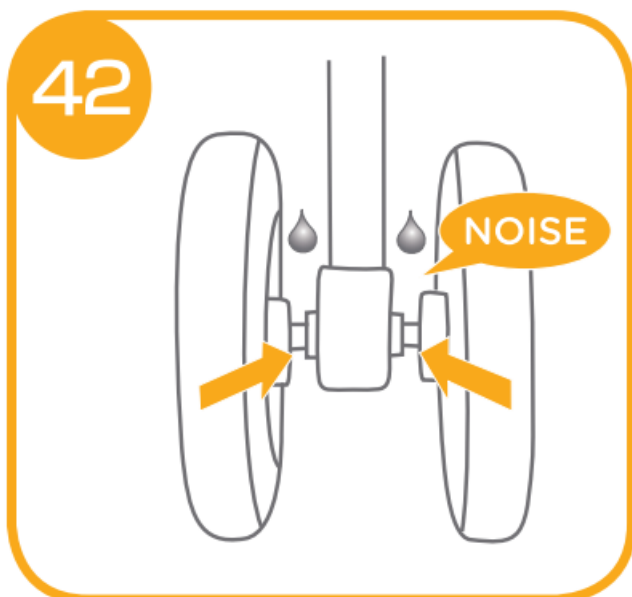

! To clean stroller frame, use only household soap and warm water. No bleach or detergent. Please refer to the care label for instructions on cleaning the fabric parts of the stroller.

! Removable soft goods can be washed by machine. No bleach. Do not twist the seat cover and inner padding to dry with great force. It may leave the seat cover and inner padding with wrinkles.

! From time to time, check your stroller for loose screws, worn parts, torn material or stitching. Replace or repair the parts as needed. Periodically wipe clean plastic parts with a soft damp cloth. Always dry the metal parts to prevent the formation of rust if the stroller has come into contact with water.

! Excessive exposure to sun or heat could cause fading or warping of parts.

! If stroller becomes wet, open canopy and allow to dry thoroughly before storing.

! If wheels squeak, use a light oil (e.g., Silicon Spray, antirust oil, or sewing machine oil). It is important to get the oil into the axle and wheel assembly. 42

! When using your stroller at the beach or other sandy/dusty environments, completely clean your stroller after use to remove sand and salt from mechanisms and wheel assemblies.



## Documents / Resources

	<a href="#">Joie signature float 4WD Drift Horizontal Lightweight Trolley</a> [pdf] Instruction Manual float 4WD, float 4WD Drift Horizontal Lightweight Trolley, Drift Horizontal Lightweight Trolley, Horizontal Lightweight Trolley, Lightweight Trolley, Trolley
---	--

## References

- [Joie's Signature Collection | Luxury Baby Gear](#)
- [online store](#)
- [Baby Gear That Goes Above & Beyond | Joie](#)
- [- - - Joie China | Explore Joie](#)