



Johnson Controls IQ WIFI 6 Mesh Router User Guide

[Home](#) » [Johnson Controls](#) » Johnson Controls IQ WIFI 6 Mesh Router User Guide 



Contents

- [1 IQ WIFI 6 Mesh Router](#)
- [2 TROUBLESHOOTING](#)
- [3 Documents / Resources](#)
- [4 Related Posts](#)

IQ WIFI 6 Mesh Router

CONNECT TO INTERNET

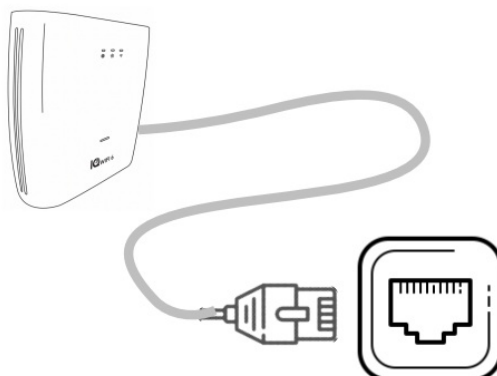

Connect one end of the provided ethernet cable into an available port on a modem or router.

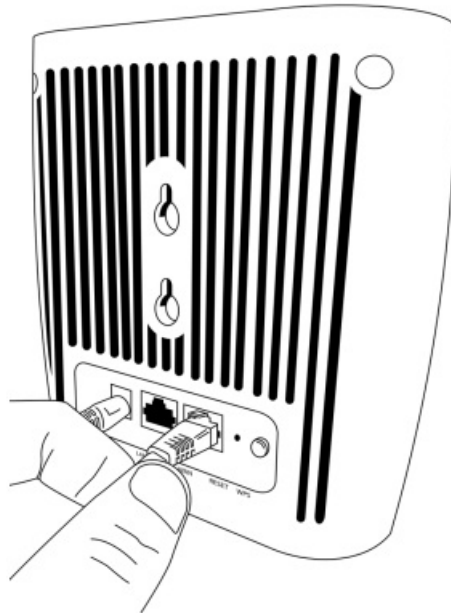

Connect the other end into the “WAN” port on IQ WiFi 6

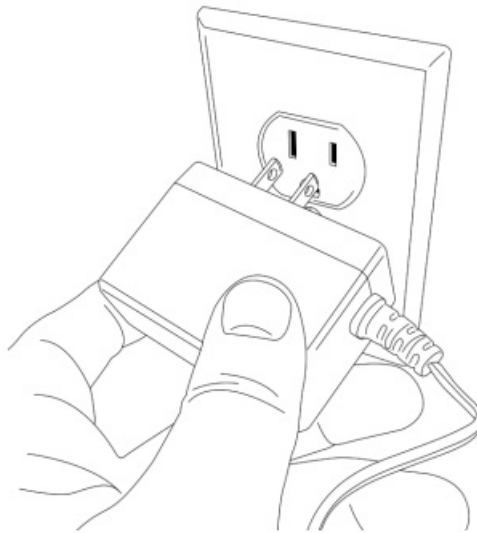

Plug the barrel jack of the power supply into the “DC-IN” port on IQ WiFi 6. Plug the power supply into the wall outlet.

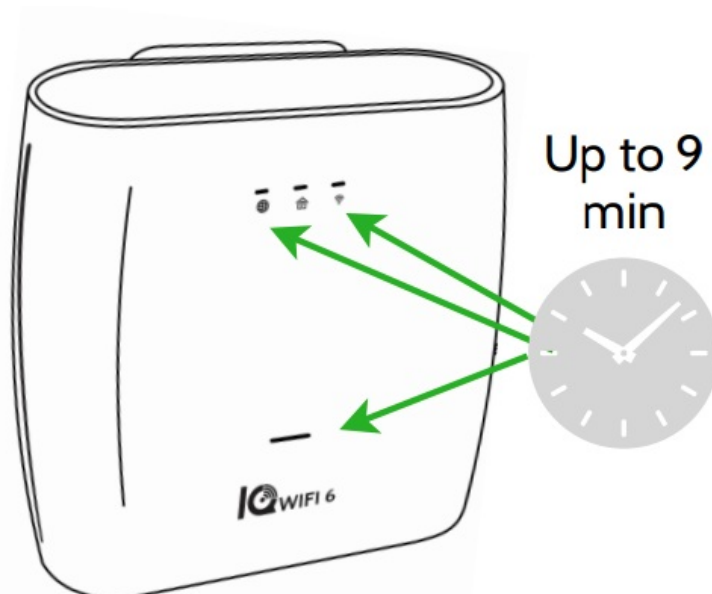

IQ WiFi 6 will automatically power up, configure as the primary IQ WiFi 6, and download any needed updates. The LEDs will be solid green when complete*.

*PRO TIP: If you are adding additional IQ WiFi 6 to the mesh (see step 2) we suggest you might use this time to

unbox and power up.

ADD ADDITIONAL IQ WIFI 6 TO EXPAND COVERAGE

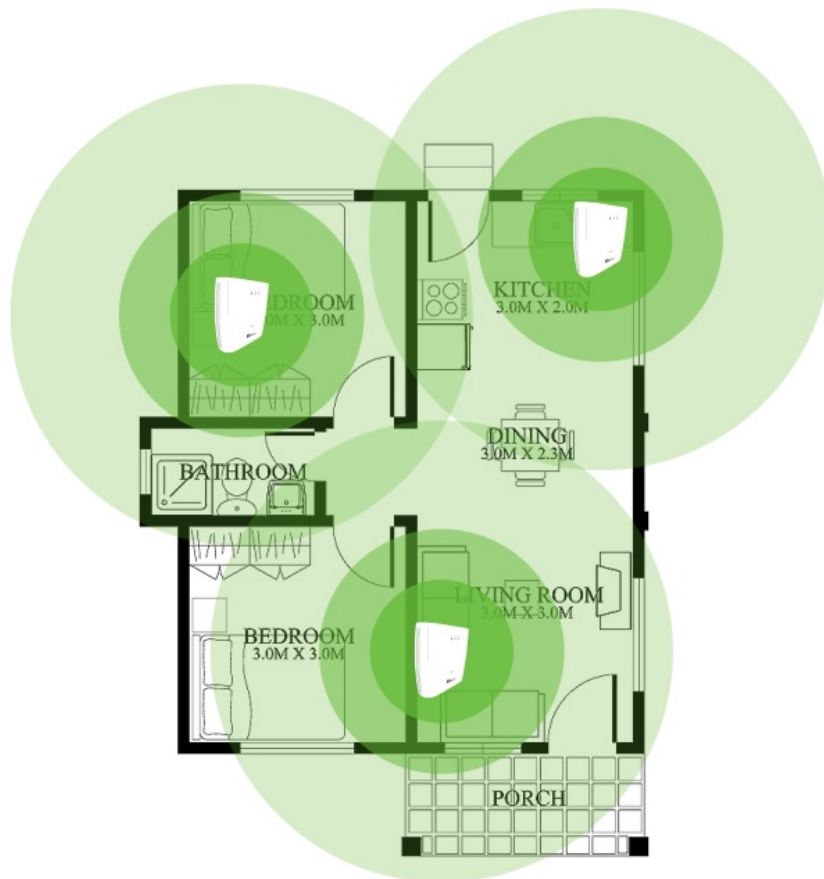

Add up to seven IQ WiFi 6 to cover dead spots and improve performance



Plug the power supply into an additional IQ WiFi 6. The power LED will stop flashing when complete. (Up to 2 min)

PRIMARY IQ WIFI 6

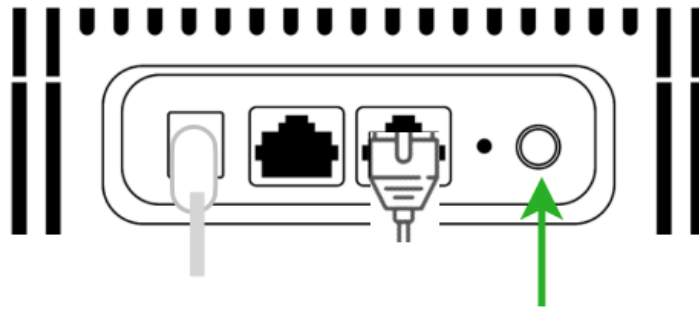

ADDITIONAL IQ WIFI 6

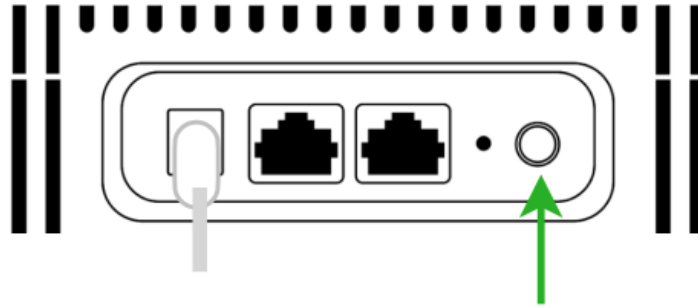

Press the WPS button on the primary and then the additional to begin pairing*

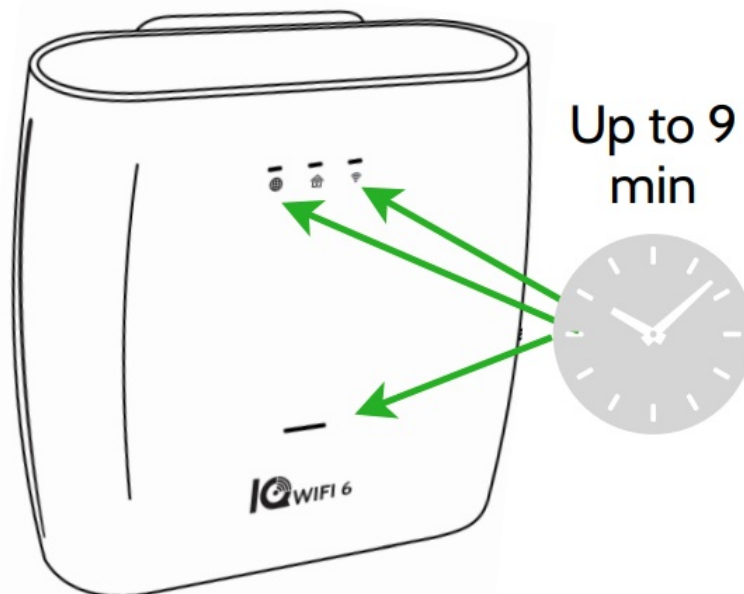

IQ WiFi 6 will automatically sync, configure and download any updates. The LEDs will be solid green when complete. (Up to 9 min).

*PRO TIP: Once the "🌐" LED on the Primary IQ WiFi 6 is solid you can repeat WPS pairing additional IQ WiFi 6
CONNECT IQ PANEL OR IQ HUB TO NETWORK

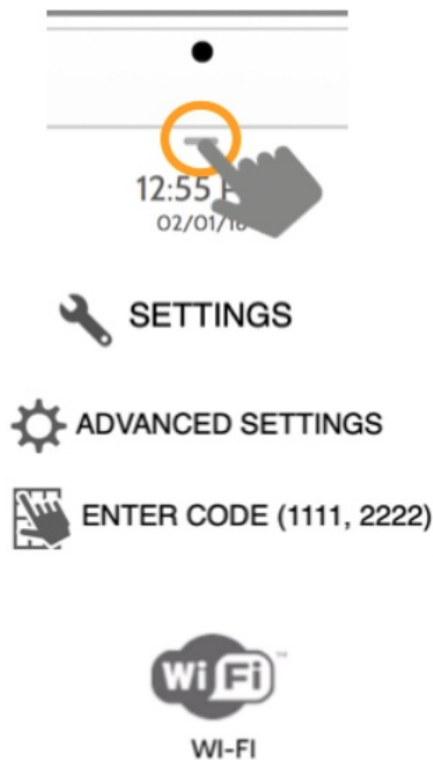

On the IQ Panel (or IQ Hub)

Open settings tray, touch Settings, Advanced Settings, type valid Dealer or Installer code, then touch Wi-Fi.

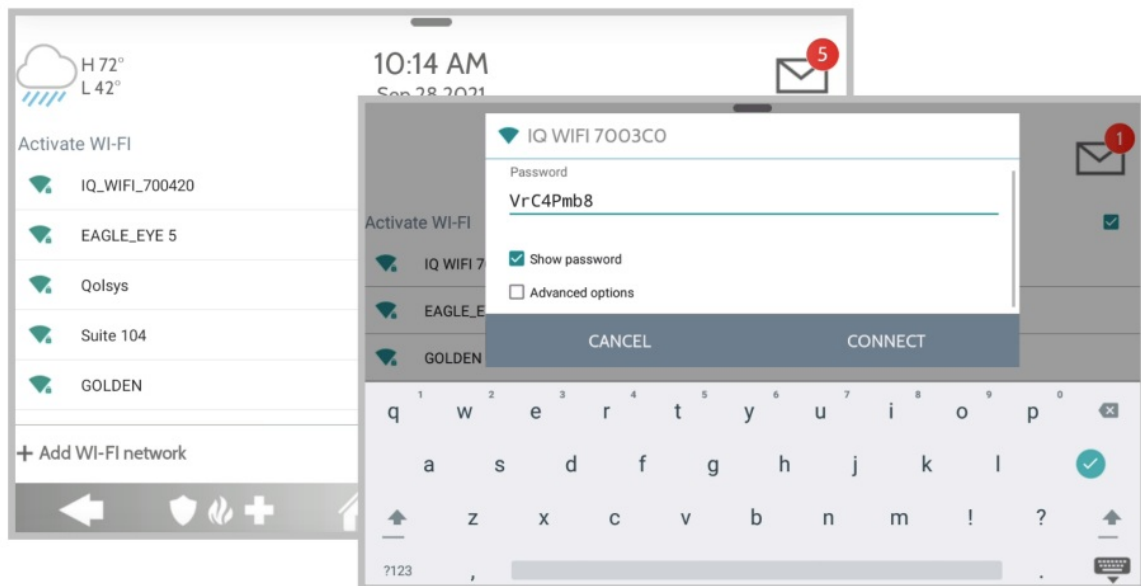

Locate the SSID/Network name IQ_WiFi_XXXXXX and touch it to connect.

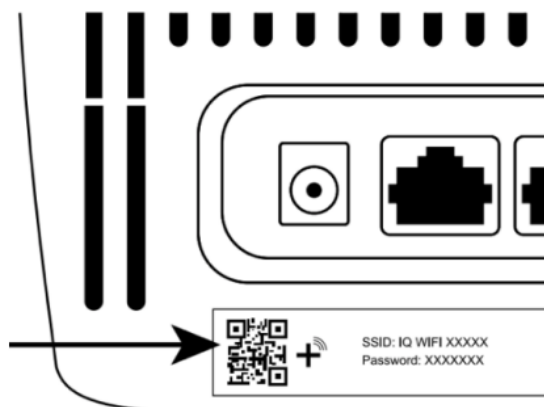

Default password is located on the sticker & on the bottom of the Primary Controller

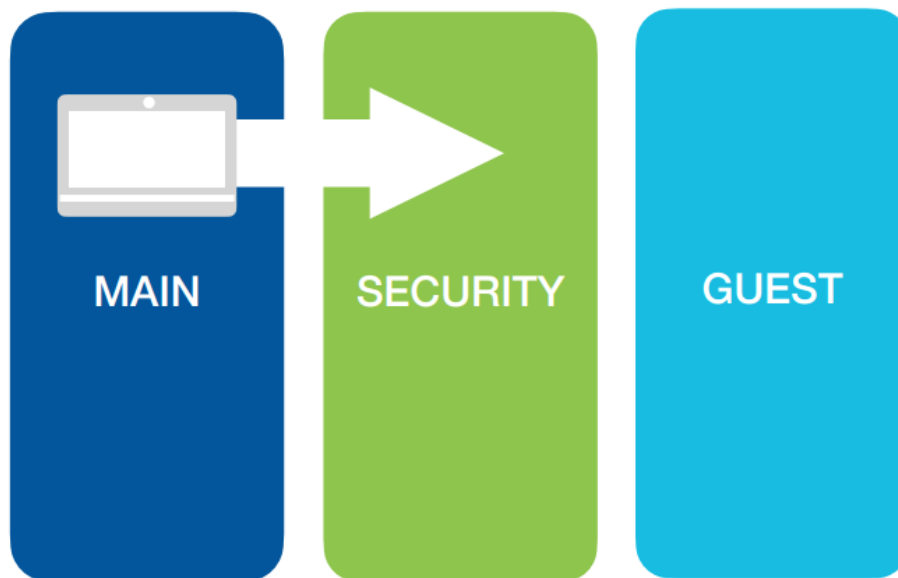

IQ Panel will automatically move to IQWiFi 6's Security Network.

IMPORTANT NOTE: Make sure that the IQ Panel software is 2.8.0, 3.1.0 or 4.2.0 or higher before pairing to the network

CONFIGURE WIFI NETWORK



On IQ Panel, open settings tray, touch Settings, Advanced Settings, type in valid code, touch Installation, Devices, WiFi Devices, then touch the IQ WiFi icon

A screenshot of the IQ Panel's WiFi settings screen. It has a light green background. At the top, it says 'Wi-Fi'. Below that, there are two sections: '2.4GHz' and '5GHz'. Each section shows the 'IQ_WIFI_700420 - WiFi Network Name (SSID)' and 'kZw7n8VK - Password (Network Key)'. There are dropdown arrows to the right of each section.

Select an SSID/Network name to access the Network Settings page.

A screenshot of the IQ Panel's Network Settings page. At the top, it shows weather (H 72° L 42°), time (3:26 PM), and date (Sep 28 2021). Below this, there are input fields for 'Network Name (SSID)' (EagleEye), 'Password' (12345678), and 'Security Method' (WPA2 PSK). There is a 'Show Wi-Fi Via QR Code' button labeled 'SHOW' and a 'Hidden' checkbox. At the bottom, there is a 'SAVE' button. On the right side, there is an icon of the IQ WiFi device. At the very bottom, there is a navigation bar with icons for back, home, and other functions.

Make edits as desired. You'll use this information to add devices to the network.

IMPORTANT NOTE: When you change one network (2.4 or 5 GHz) it will automatically change the other to match.

SAVE

Press "SAVE" to complete. The entire IQ WiFi 6 network will automatically sync and reboot.

IMPORTANT NOTE: If replacing an existing Wi-Fi router, use the same SSID and password so existing devices automatically connect.

CONNECT IQ WIFI 6 TO [ALARM.COM](https://www.alarm.com)

Using the Alarm.com MobileTech app, find the customer account

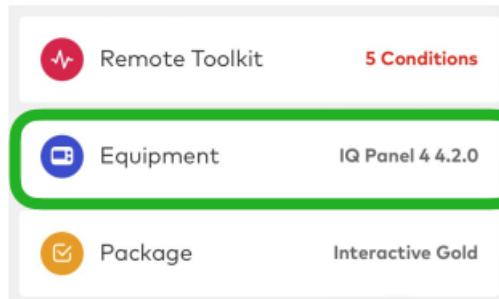

Select "Equipment"

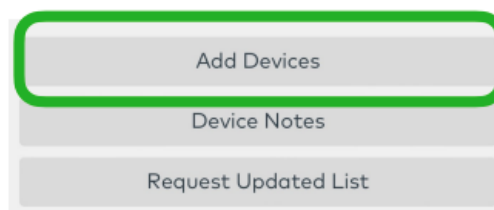

"Add Devices"

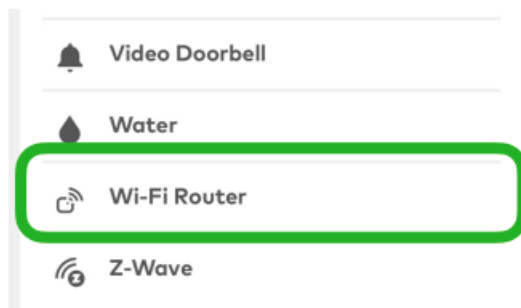

"Wi-Fi Router"

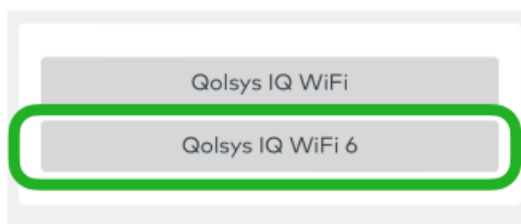

"Qolsys IQ WIFI 6"

Locate the MAC address on the bottom the Primary IQ WiFi 6

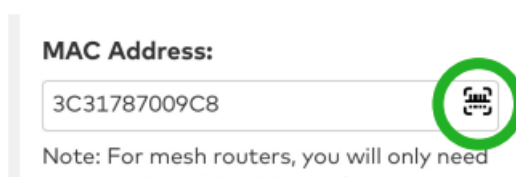

Enter the MAC or touch the "camera" icon and scan the bar code below the MAC

Note: For mesh routers, you will only need to enter the MAC address of the controller. Additional mesh nodes will be added to your account automatically after installation once they have been paired.

Add

ouch "Add"

Internet/modem via an ethernet

cc

M

S

N

to

cc

ac

in

er

Name Your Device x

What would you like to name your device?

Living Room

Cancel Continue

Name your device. IQ WiFi 6 will sync automatically.

Status:

Installation started, waiting for device to connect...

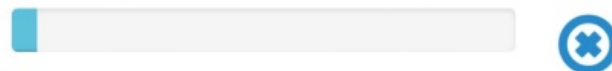

Sensors 1 >

Panel Camera ID 129 ✓ ✓
PANEL CAMERA

Peripherals 0 >

Access Points 2 >

jci_700BC0 2200 ✗ ✓
IQ WIFI 6 PRE-REL...

jci_7008A0 2201 ✗ ✓
IQ WIFI 6 PRE-REL...

Z-Wave Devices 0 >

IQ WiFi 6 will appear under "Access Points" on the customer's account

CONNECT DEVICES TO THE NETWORK

IQ WiFi 6 broadcasts 3 SSID/network names:



MAIN: Primary network for customer devices such as TVs, Tablets and appliances

SECURITY: Your private place for IQ Panel, IQ Remotes, Video Doorbells, Cameras, etc.

GUEST: For customer's guests

Using the network credentials you created in step 4, add any NEW devices to the MAIN network. (You'll move them to the security network in the next step)



To move security devices to the security network, log into your Alarm.com customer account and choose "Wireless Network" under Video settings.



Choose "Access Point"

Select the "Security" SSID/ Network. (Touch "Advanced" to apply to all cameras.).

Cameras will move automatically

END USER APP

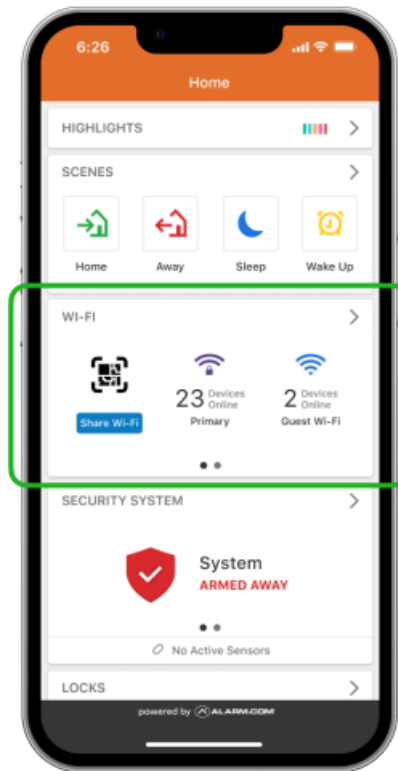

IQ WiFi 6 settings and controls will automatically appear in the end user's Alarm.com mobile app.
MANAGE WI-FI PROFILES VIEW WI-FI DEVICE LIST PAUSE WI-FI GUEST NETWORK



The Alarm.com App is available in the iOS App Store, Google Play Store and more



A standalone "IQ WiFi" app is available for end users who are not yet [Alarm.com](https://www.alarm.com) customers

TROUBLESHOOTING

Many troubleshooting issues can be identified using the chart below:

Power LED			WAN Status			LAN Status		
	Off	Power Off		Off	No WAN Link / No Mesh Link		Off	No LAN Link / WiFi Not Available
	On	Power On / Ready		On	WAN Link / Agent Mesh Link Strong		On	WiFi Available
	Blink	Bootup / Firmware Update		Single Blink Off	Agent Mesh Link Medium	Smart Home Status Reserved for future use		
	On	Critical Fault Detected		Double Blink Off	Agent Mesh Link OK			
	Blink	Factory reset		Blink	WPS Pairing in Progress - Wait			

IQ WiFi 6 link quality between the primary controller and secondary agents using the LEDs on each unit. To improve link quality move the unit to various locations in the site.

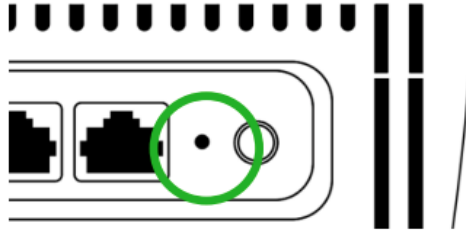

To factory default: press and hold the reset button with a paper clip for 15 sec. until power LED blinks red, release when LED solid red.

GOT QUESTIONS?

CONTACT TECH SUPPORT

techsupport@qolsys.com

Johnson Controls proprietary.

Reproduction without permission is not permitted.

This device complies with Industry Canada license-exempt RSS standard(s).

Operation is subject to the following two conditions:

- (1) this device may not cause interference, and
- (2) this device must accept any interference, including interference that may cause undesired operation of the device.

Document#: IQWIFI6-IM

Revision Date: 2022-11

Documents / Resources

	<p>Johnson Controls IQ WIFI 6 Mesh Router [pdf] User Guide IQ WIFI 6 Mesh Router, IQ WIFI 6, Mesh Router</p>
---	--