



Johnson Controls IQ WiFi 6 User Guide

[Home](#) » [Johnson Controls](#) » Johnson Controls IQ WiFi 6 User Guide 

Johnson Controls IQ WiFi 6
User Guide

IQ WIFI 6 QUICK GUIDE



(1) CONNECT TO INTERNET

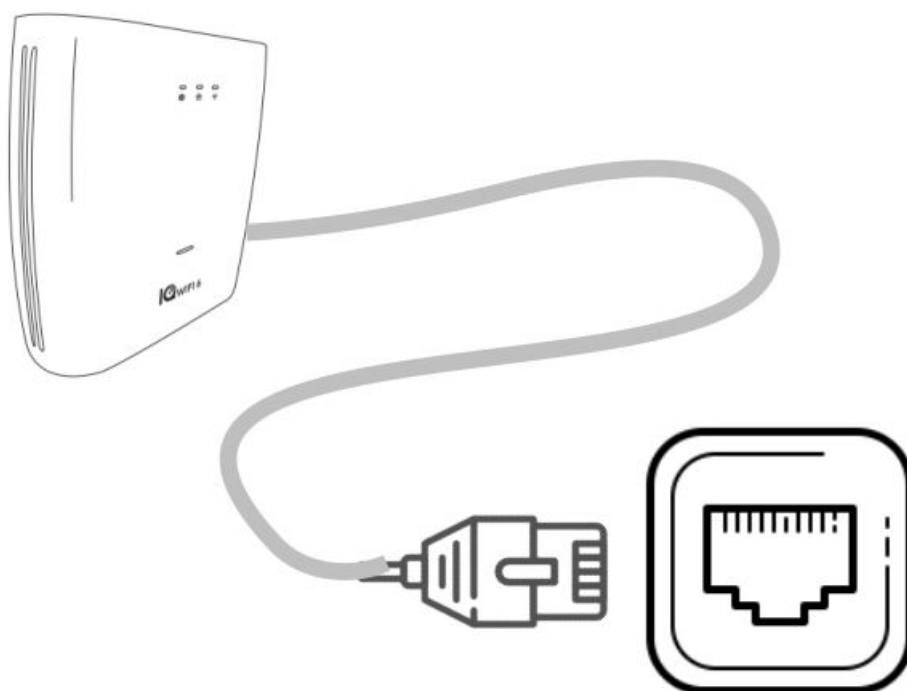

Connect one end of the provided ethernet cable into an available port on a modem or router.



Connect the other end into the “WAN” port on IQ WiFi 6



Plug the barrel jack of the power supply into the “DC-IN” port on IQ WiFi 6. Plug the power supply into the wall outlet.

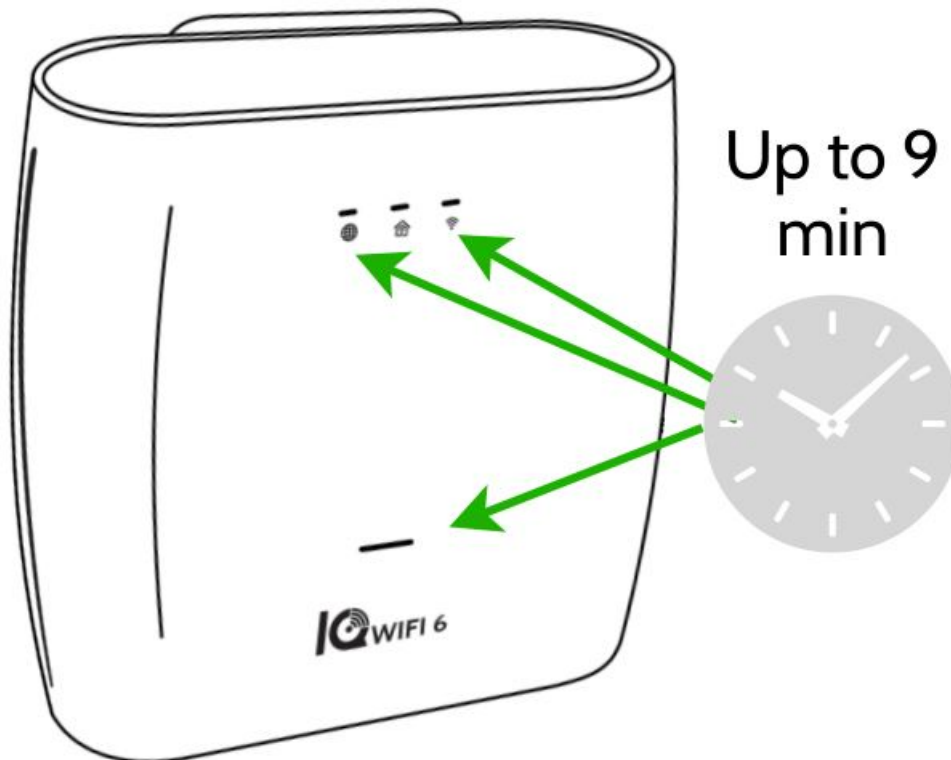

IQ WiFi 6 will automatically power up, configure as the primary IQ WiFi 6, and download any needed updates. The LEDs will be solid green when complete*. (Up to 9 min)

***PRO TIP:** If you are adding additional IQ WiFi 6 (see step 2) you might use this time to unbox and power up.

(2) ADD ADDITIONAL IQ WIFI 6 TO EXPAND COVERAGE

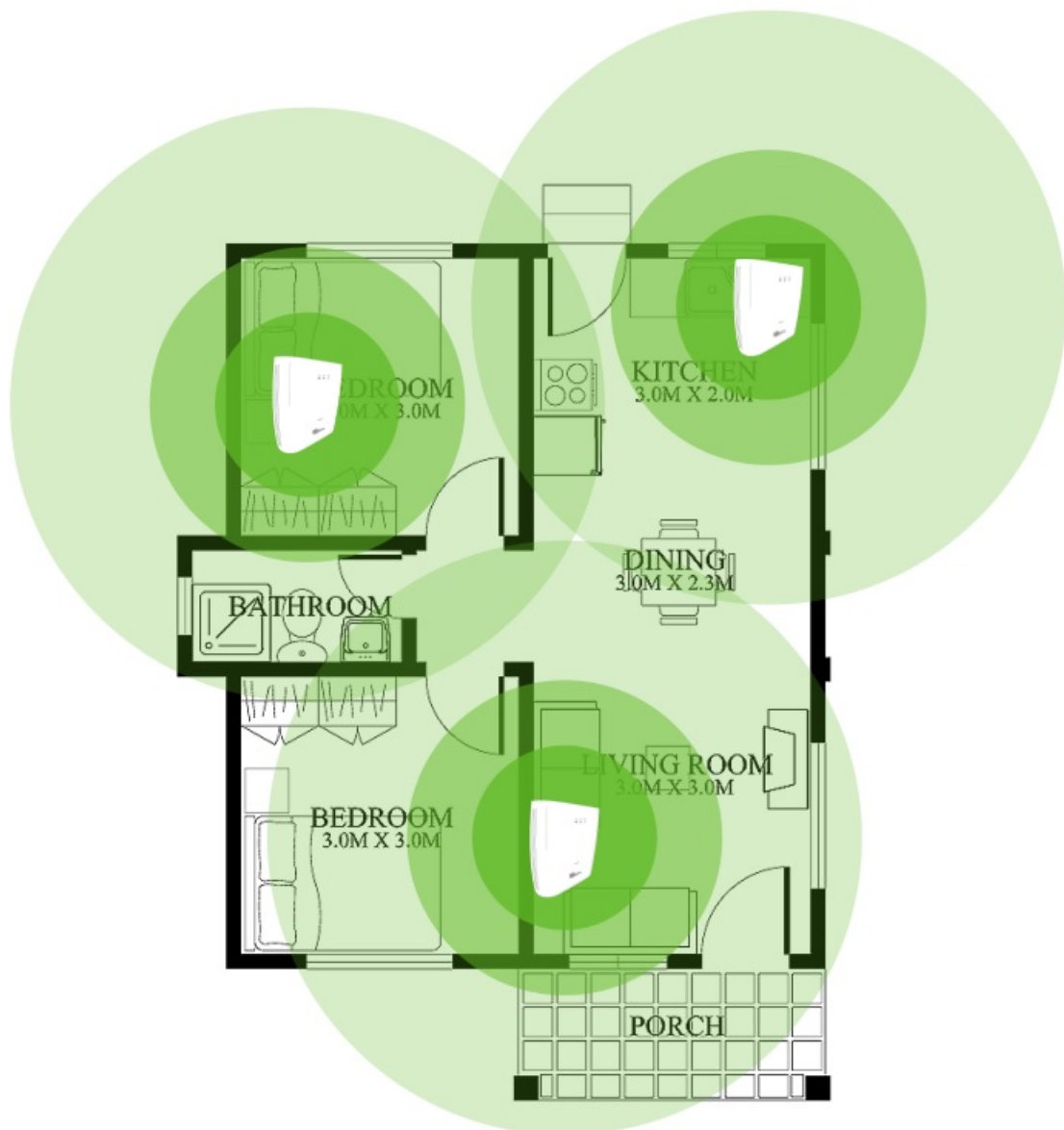

Add up to seven IQ WiFi 6 to cover dead spots and improve performance

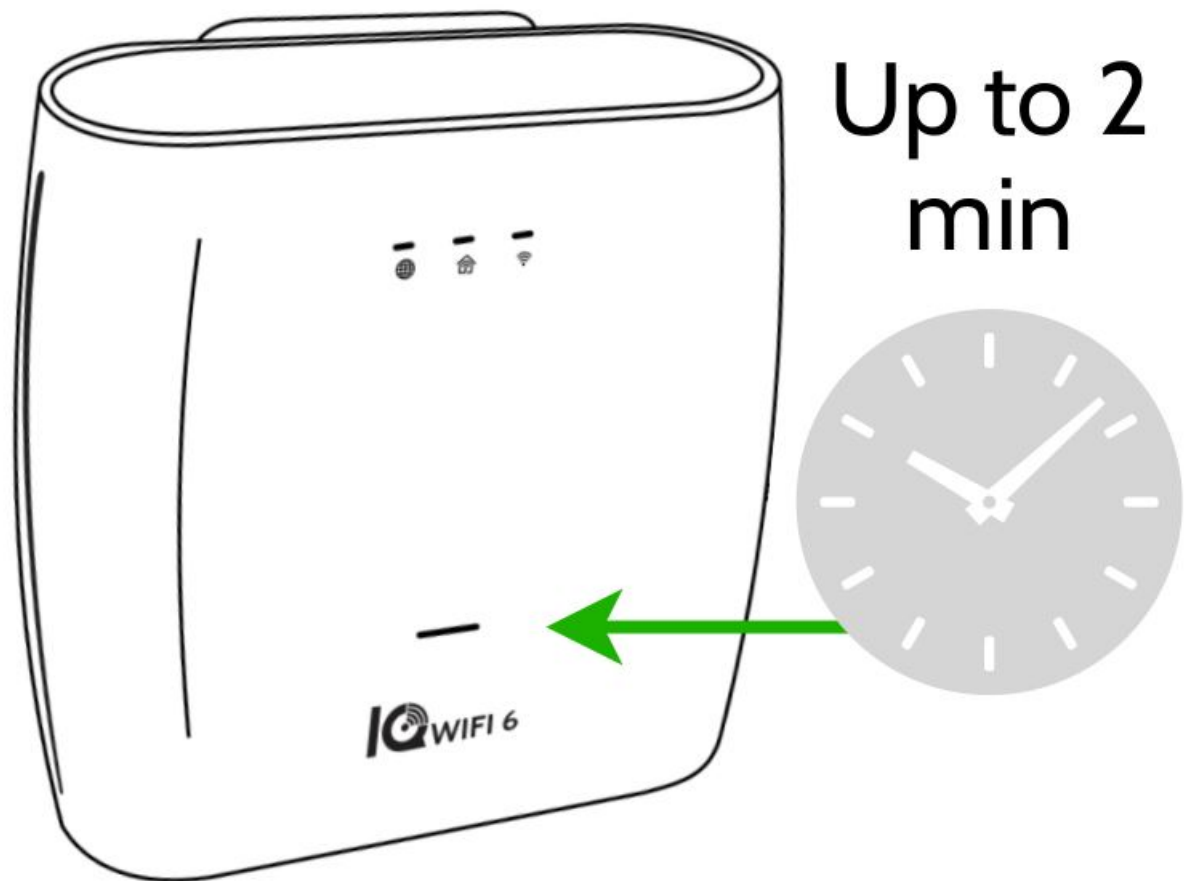

Plug the power supply into an additional IQ WiFi 6. The power LED will stop flashing when complete. (Up to 2 min)

PRIMARY IQ WIFI 6

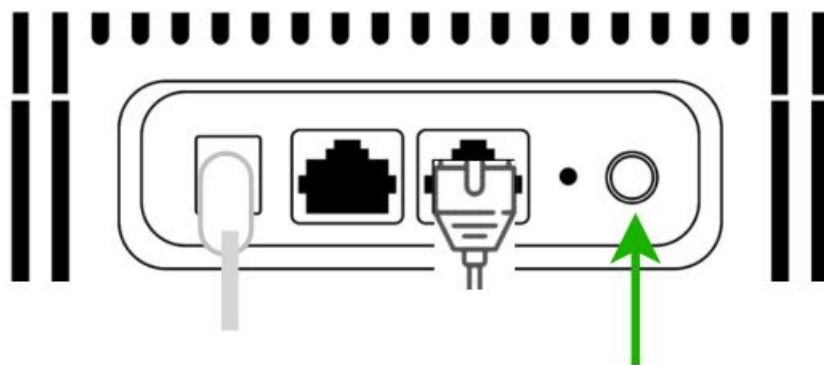

ADDITIONAL IQ WIFI 6

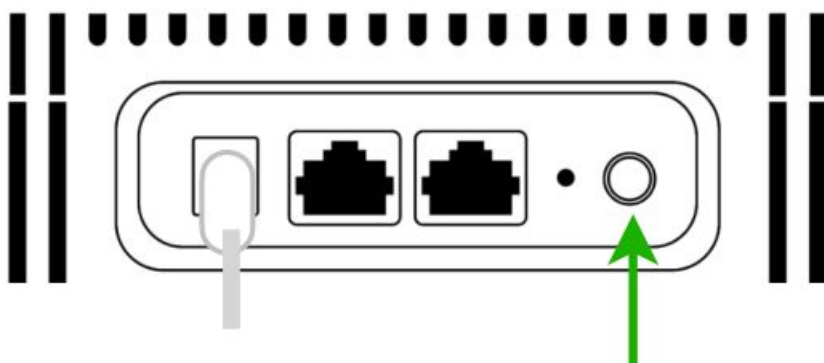

Press the WPS button on the primary and then the additional to begin pairing*

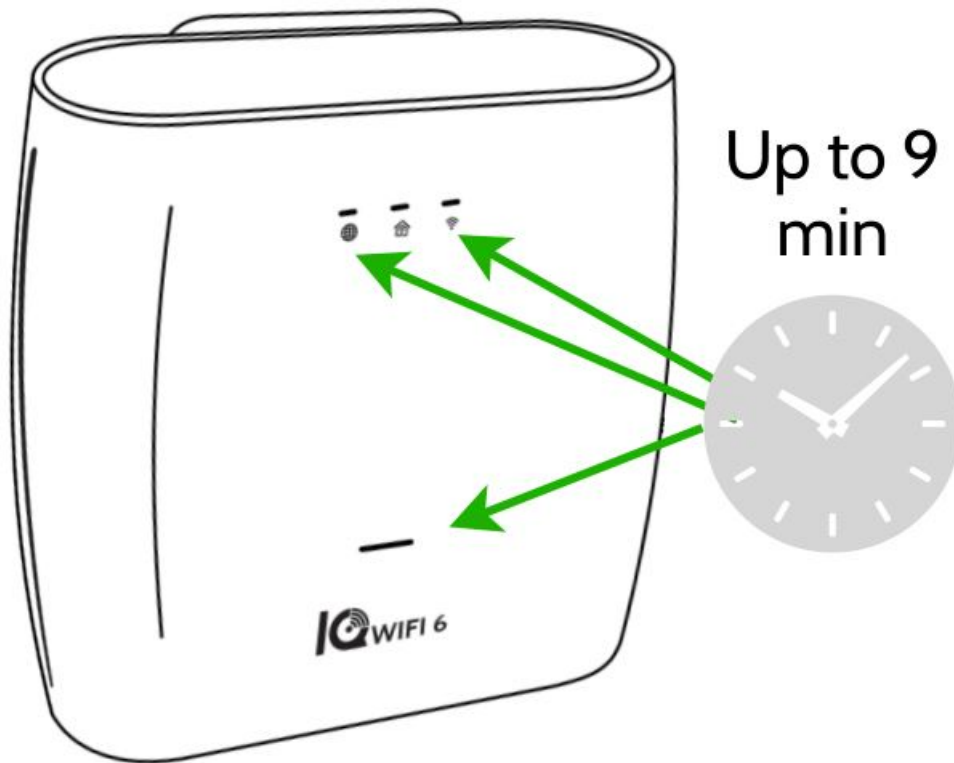

IQ WiFi 6 will automatically sync, configure and download any updates. The LEDs will be solid green when complete. (Up to 9 min).

***PRO TIP:** Once the “” LED on the Primary IQ WiFi 6 is solid you can repeat WPS pairing additional IQ WiFi 6

(3) CONNECT IQ PANEL OR IQ HUB TO NETWORK

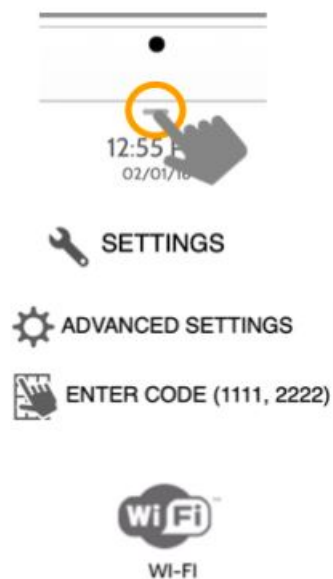

On the IQ Panel (or IQ Hub)

Open settings tray, touch Settings, Advanced Settings, type valid Dealer or Installer code, then touch Wi-Fi.

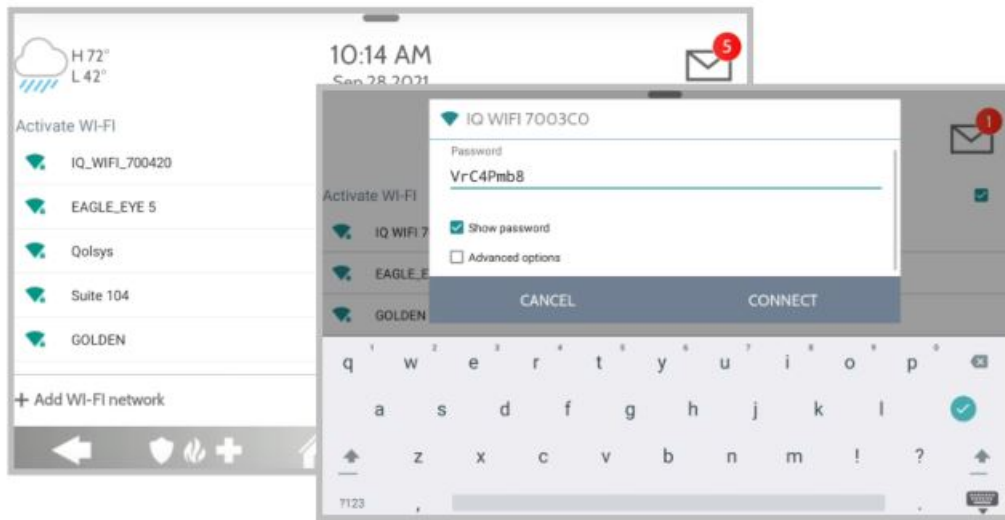

Locate the SSID/Network name **IQ_WiFi_XXXXXX** and touch it to connect.

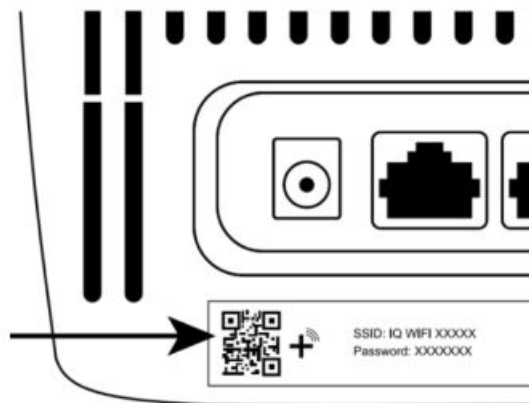

Default password is located on the sticker & on the bottom of the Primary Controller

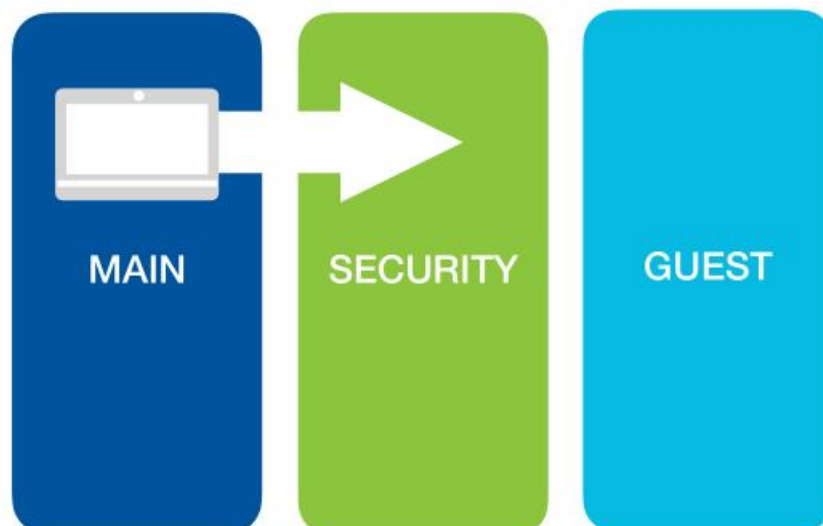

IQ Panel will automatically move to IQWiFi 6's Security Network.

IMPORTANT NOTE: Make sure that the IQ Panel software is 2.7.2, 3.1.0 or 4.2.0 or higher before pairing to the network

(4) CONFIGURE WIFI NETWORK



On IQ Panel, open settings tray, touch Settings, Advanced Settings, type in valid code, touch Installation, Devices, WiFi Devices, then touch the IQ WiFi icon

WI-FI

2.4GHz
IQ_WIFI_700420 - WiFi Network Name (SSID)
kZw7n8VK - Password (Network Key)

5GHz
IQ_WIFI_700420 - WiFi Network Name (SSID)
kZw7n8VK - Password (Network Key)

Select an SSID/Network name to access the Network Settings page.

Weather: Cloud with rain, H 72° L 42°

Time: 3:26 PM, Date: Sep 28 2021

Network Name (SSID): EagleEye

Password: 12345678

Security Method: WPA2 PSK

Show Wi-Fi Via QR Code: SHOW

Hidden: ☐

SAVE

Bottom navigation bar: Back, Shield, Flame, Plus, Home

Make edits as desired. You'll use this information to add devices to the network.

IMPORTANT NOTE: When you change one network (2.4 or 5 GHz) it will automatically change the other to match.



Press "SAVE" to complete.

The entire IQ WiFi 6 network will automatically sync and reboot.

IMPORTANT NOTE: If you would like existing devices to automatically move to the new network, name and password should be identical to the previous network

Johnson Controls proprietary.
Reproduction without permission is not permitted.

Contents

1 Documents / Resources

2 Related Posts

Documents / Resources

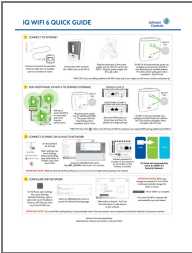
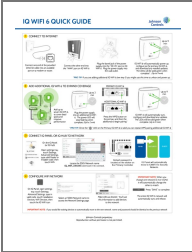
	<p>Johnson Controls IQ WiFi 6 [pdf] User Guide IQ WiFi 6, IQ WiFi, WiFi, WiFi 6</p>
	<p>Johnson Controls IQ WiFi 6 [pdf] User Guide IQ WiFi 6, IQ WiFi, WiFi 6, WiFi</p>