



# JOCEL JCH-100 Horizontal Freezer Instruction Manual

[Home](#) » [JOCEL](#) » JOCEL JCH-100 Horizontal Freezer Instruction Manual



**HORIZONTAL FREEZER  
JCH-100 e JCH-200**



**INSTRUCTION MANUAL**

**WARNING!**



It is hazardous for anyone other than authorized service personnel to carry out servicing or repairs which involves the removal of covers. To avoid the risk of an electric shock do not attempt to repair this appliance yourself.

**Contents** [ [hide](#)

- [1 SAFETY TIPS](#)
- [2 CLIMATE RANGE](#)
- [3 FREON-FREE](#)
- [4 NAMES OF THE PARTS](#)
- [5 TRANSPORTATION INSTRUCTIONS](#)
- [6 INSTALLATION INSTRUCTIONS](#)
- [7 STARTING](#)
- [8 FREEZER OPERATION](#)
- [9 STORING FROZEN FOOD](#)
- [10 FREEZING FRESH FOOD](#)
- [11 DEFROSTING](#)
- [12 CLEANING AND CARE](#)
- [13 ADVICE](#)
- [14 CERTIFICATIONS](#)
- [15 Documents / Resources](#)
  - [15.1 References](#)
- [16 Related Posts](#)

## SAFETY TIPS



- Do not use electrical appliances such as a hairdryer or heater to defrost your Freezer.
  - Containers with flammable gases or liquids can leak at low temperatures.
  - Do not store any containers with flammable materials, such as spray cans, fire extinguisher refill cartridges, etc. in the Freezer.
  - Do not place carbonated or fizzy drinks in the freezer compartment. Ice lollies can cause “Frost/Freeze burns”. If consumed straight from the Freezer.
  - Do not remove items from the freezer compartment if your hands are damp/wet, as this could cause skin abrasions or “frost/Freezer burns”. Bottles and cans must not be placed in the Freezer compartment as they can burst when the contents freeze.
  - Manufacturers’ recommended storage times should be adhered to. Refer to relevant instructions.
  - Do not allow children to tamper with the controls or play with the Freezer. The Freezer is heavy. Care should be taken when moving it. It is dangerous to alter the specification or attempt to modify this product in any way.
  - Do not store inflammable gases or liquids inside your Freezer.
  - If the power cable is damaged, it must be replaced by the manufacturer, its service agent, or similarly qualified persons in order to avoid a hazard.
  - This appliance can be used by children aged 8 years and above and persons with reduced physical, sensory or mental capabilities or lack of experience and knowledge if they have been given supervision or instruction concerning the use of the appliance in a safe way and understand the hazards involved. Children shall not play with the appliance.
- Cleaning and user maintenance shall not be made by children without supervision.

- This refrigerating appliance is not intended to be used as a built-in appliance.
- This appliance is intended to be used in household and similar applications such as:
  - staff kitchen areas in shops, offices, and other working environments;
  - farm houses and by clients in hotels, motels, and other residential type environments;
  - bed and breakfast type environments;
  - catering and similar non-retail applications.
- Keep ventilation openings, in the appliance enclosure or in the built-in structure, clear of obstruction.
- Do not use mechanical devices or other means to accelerate the defrosting process, other than those recommended by the manufacturer.
- Do not damage the refrigerant circuit.
- Do not use electrical appliances inside the food storage compartments of the appliance, unless they are of the type recommended by the manufacturer.
- Do not store explosive substances such as aerosol cans with a flammable propellant in this appliance.

This appliance is not intended for use by persons (including children) with reduced physical, sensory or mental capabilities, or lack of experience and knowledge unless they have been given supervision or instruction concerning the use of the appliance by a person responsible for their safety. Children should be supervised to ensure that they do not play with the appliance.

- **WARNING:** Keep ventilation openings, in the appliance enclosure or in the built-in structure, clear of obstruction.
- **WARNING:** Do not use mechanical devices or other means to accelerate the defrosting process, other than those recommended by the manufacturer.
- **WARNING:** Do not damage the refrigerant circuit.
- **WARNING:** Do not use electrical appliances inside the food storage compartments of the appliance, unless they are of the type recommended by the manufacturer
- **WARNING:** Refrigerating appliances — in particular, a refrigerator-freezer Type I — might not operate consistently (possibility of defrosting of contents or temperature becoming too warm in the frozen food compartment) when sited for an extended period of time below the cold end of the range of temperatures for which the refrigerating appliance is designed;
- **WARNING:** The refrigerant used in your appliance and insulation materials requires special disposal procedures.
- **WARNING:** When positioning the appliance, ensure the supply cord is not trapped or damaged.
- **WARNING:** Do not locate multiple portable socket outlets or portable power supplies at the rear of the appliance.
- Children aged from 3 to 8 years are allowed to load and unload refrigerating appliances.  
To avoid contamination of food, please respect the following instructions:
  - Opening the door for long periods can cause a significant increase in the temperature in the compartments of the appliance
  - Clean regular surfaces that can come in contact with food and accessible drainage systems.
  - Clean water tanks if they have not been used for 48 h; flush the water system connected to a water supply if water has not been drawn for 5 days.
  - Store raw meat and fish in suitable containers in the refrigerator, so that it is not in contact with or drip onto other food.

- Two-star frozen-food compartments are suitable for storing pre-frozen food, storing or making ice-cream, and making ice cubes.
- One-, two- and three-star compartments are not suitable for the freezing of fresh food. If the refrigerating appliance is left empty for long periods, switch off, defrost, clean, dry, and leave the door open to prevent mold from developing within the appliance.

## CLIMATE RANGE

The information about the climate range of the appliance is provided on the rating plate. It indicates at which ambient temperature (that is, room temperature, in which the appliance is working) the operation of the appliance is optimal (proper).

| Climate range | Permissible ambient temperature |
|---------------|---------------------------------|
| SN            | from +10°C to +32°C             |
| N             | from +16°C to +32°C             |
| ST            | from +16°C to +38°C             |
| T             | from +16°C to +43°C             |

**Note:** Given the limit values of the ambient temperature range for the climate classes for which the refrigerating appliance is designed and the fact that the internal temperatures could be affected by such factors as the location of the refrigerating appliance, ambient temperature, and the frequency of door opening, the setting of any temperature control device might have to be varied to allow for these factors, if appropriate. If the power cable is damaged, it must be replaced by the manufacturer, its service agent, or similarly qualified persons in order to avoid a hazard.

 **Note:** When operating in an environment other than the specified climate type (i.e., beyond the rated ambient temperature range), the appliance may not be able to maintain the desirable compartment temperatures.

## FREON-FREE

The freon-free refrigerant (R600a) and the foaming insulation material (cyclopentane) that is environmentally friendly are used for the refrigerator, causing no damage to the ozone layer and having a very small impact on global warming. R600a is flammable and sealed in a refrigeration system, without leakage during normal use. But, in case of refrigerant leakage due to the refrigerant circuit being damaged, be sure to keep the appliance away from open flames and open the windows for ventilation as quickly as possible.



## NAMES OF THE PARTS

Due to technological innovations, the product descriptions in this manual may not be completely consistent with your product. Detailed information is in accordance with the final product.

**⚡WARNING⚡**: Never touch the interior of the Freezer Chamber or frozen foods in the compartment with wet hands as this could result in frostbite.

## TRANSPORTATION INSTRUCTIONS

The appliance should be transported only in a vertical upright position. The packing as supplied must be intact during transportation.

If during the course of transport, the product has been transported horizontally, it must only be laid on its left-hand side (when facing the door front) and it must not be operated for at least 4 hours to allow the system to settle after the appliance is brought back to an upright position.

1. Failure to comply with the above instructions could result in damage occurring to the manufacturer will not be held responsible if these instructions are disregarded.
2. The appliance must be protected against rain, moisture, and other atmospheric influences.

**IMPORTANT:** Care must be taken while cleaning/carrying the appliance to avoid touching the condenser metal wires at the back of the appliance, as you might injure your fingers and hands or damage your product.

**IMPORTANT:** This appliance is not designed for stacking with any other appliance. Do not attempt to sit or stand on top of your appliance as it is not designed for such use. You could injure yourself or damage the appliance.

**IMPORTANT:** Make sure that the main cable is not caught under the appliance during and after carrying/moving the appliance, to avoid the main cable becoming cut or damaged. When positioning your appliance take care not to damage your flooring, pipes, wall coverings, etc. Do not move the appliance by pulling by the lid or handle. Do not allow children to play with the appliance or tamper with the controls. Our company declines to accept any liability should the instructions not be followed.

## INSTALLATION INSTRUCTIONS

1. If possible, avoid placing the appliance near cookers, radiators, or in direct sunlight as this will cause the

compressor to run for long periods. If installed next to a source of heat or refrigerator, maintain the following minimum side clearances:

|                |              |
|----------------|--------------|
| From Cookers   | 4" (100 mm)  |
| From Radiators | 12" (300 mm) |
| From Fridges   | 4" (100 mm)  |

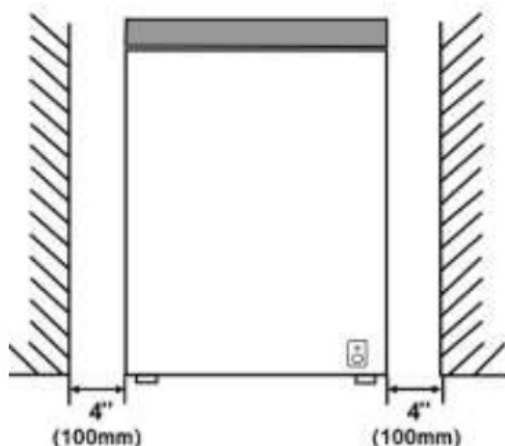

2. Make sure that sufficient room is provided around the appliance to ensure free air Ideally, A space of no less than 10cm must be left around the freezer, and ensure you allow gaps as shown in the below diagram.
3. The appliance should be located on a smooth surface.
4. It is forbidden to use the refrigerator outdoors.
5. Protection from moisture. Do not locate the freezer in a moist space to avoid the metal parts do not spray water into the freezer, otherwise, it will weaken the insulation and causes current leakage.
6. Refer to the "Cleaning and Care" section to prepare your appliance for use.
7. If the freezer is installed in unheated areas, garages, etc., in cold weather condensation may form on the outer surfaces. This is quite normal and is not a fault. Remove the condensation by wiping with a dry cloth.

## STARTING

### Final Check

Before you start to use the freezer, please check that:

1. The interior is dry and air can circulate freely at the rear.
2. Clean the interior as recommended under "CLEANING AND CARE".
3. Insert the plug into the wall socket and switch on the electricity supply then the Red light is on.
4. You will hear a noise as the compressor starts up. The liquid and gases sealed within the refrigeration system may also give rise to noise, whether the compressor is running or not which is quite normal.
5. If you going to store already frozen food open the freezer lid and check that the freezer has reached the correct temperature. Then you can put in your already frozen food.
6. Do not load the appliance immediately after it is switched on. Wait until the correct storage temperature has been reached.

### Important Notes:

- If there is a power failure do not open the lid. Frozen food should not be affected if the failure lasts for less than 20 hours. If the failure is longer, then the food should be checked and eaten immediately or cooked and then refrozen.
- If you find that the lid of the chest freezer is difficult to open just after you have closed it, don't worry. This is due to the pressure difference which will equalize and allow the lid to be opened normally after a few minutes.

## FREEZER OPERATION



The inside temperature of the freezer is regulated by a thermostat adjustment knob.

The "1,2,3,4,5,6" marks on the knob do not represent the exact temperature but show that the smaller number represents the higher the temperature, conversely, the bigger number, the lower the temperature.

### Temperature adjustment

Turn the thermostat to set the temperature.

- Position 1: cooling mode (temperature from 5°C)
- Position 2 to 4: soft freeze mode (temperature from -12 to -18°C)
- Position 4 to 7: freezing mode (temperature from -18°C to -24°C)
- Position 7: quick-freeze mode (temperature below -24°C)

Due to the difference of the condition and environment when freezers are used, there can be a deviation of  $\pm 3^{\circ}\text{C}$  on each mode in different usage environments that do not accord with the above data. Please make adjustments according to each condition.

- Fast freezing position 7: While setting the knob to a fast freezing range, please keep the compressor continuously operating without stopping, the food can be quickly cooled.

**Caution:** Do not keep the knob in the fast-freezing position after fast freezing.

### Refrigerating mode:

 When changing the refrigerating status to others, you should take out food to avoid them being frosted damaged. If shift freezing or soft freezing status to refrigerating mode, you should take the following steps: Set the knob of the thermostat to refrigeration mode (position 1), then remove all of the frozen food from the freezer compartment, then keep it being empty for one hour, and finally put the required food into it.

**Due to individual factors of the refrigerator, the actual temperature in the box may have a certain error from the set temperature, which is a normal phenomenon and does not affect the normal use of the product.**

## STORING FROZEN FOOD

Prepackaged commercially frozen food should be stored in accordance with the frozen food manufacturer's instructions.

**Tips:**

1. Put packets in the freezer as quickly as possible after purchase.
2. Do not exceed "Use By", "Best Before" dates on the packaging.

## **FREEZING FRESH FOOD**

- Place the fresh food to be frozen near the side walls to ensure fast freezing and away from already frozen food, if possible.
- Never exceed this maximum capacity. Do not freeze too large a quantity at any one time.
- The quality of the food is best preserved when it is frozen right through to the center as quickly as possible.
- Take special care not to mix already frozen food and fresh food.

## **DEFROSTING**

Defrost twice a year or when a frost layer of around 7 mm (1/4") has formed.

Alternatively: you may switch off the freezer at the socket outlet and pull out the mains plug.

Extract the water conduit and put it in a water container.

Before defrosting (we recommend 6 hours before), please set the thermostat knob at a 7" position to make sure the food is at the lowest temperature when you get it out.

All food should be stored in a cool place, for example, in the fridge, it can be packed with isothermal bags, to keep the temperature of the frozen food for longer.

Remove the freezer basket; leave the lid open. Adding a container of warm water can speed up the defrosting process.

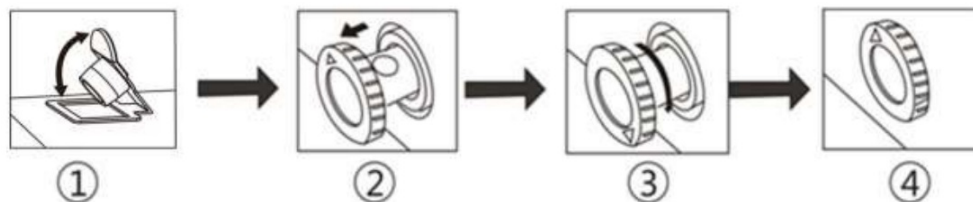

Never use hairdryers, electrical heaters, or other such electrical appliances for defrosting.

When defrosting has finished flow out defrost water which collects at the bottom of the freezer as the below diagram and dries the interior thoroughly.

Switch on the Fast Freeze and leave it on for about three hours.

1. There is a water conduit at the interior bottom of the freezer, when defrosting, extract the rubber cover, defrosted water will drip into the hole and flow out.
2. Extract the water conduit on the exterior of the freezer by 20-25mm until the water hole can be seen.
3. Twist the water conduit until the arrow points downward.
4. After defrosting is done, make sure there is no more water coming out before out the water conduit in place and make the arrow point upward.
5. After defrosting is done, make sure there is no more water coming out before out the water conduit in place and make the arrow point upward.

**Important Notes:**



- Do not use pointed or sharp-edged objects such as knives or forks to remove the frost.
- Never use hairdryers, electrical heaters, or other such electrical appliances for defrosting.
- It is normal that water beads or frosts appear on the freezer collar and door gaskets in wet weather, which will not affect the normal use. In such a case, please clean it with a dry cloth.

## **CLEANING AND CARE**

- We recommend that you switch off the freezer at the socket outlet and pull out the mains plug before cleaning.
- Never use any sharp abrasive instrument, soap, household cleaner, detergent, and wax polish for cleaning.
- Use lukewarm water to clean the cabinet of the freezer and wipe it dry.
- Use a damp cloth wrung out in a solution of one teaspoon of bicarbonate of soda to one pint of water to clean the interior and wipe it dry.
- Excess deposits of ice should be removed on a regular basis using a plastic ice scraper available from your local store. A large accumulation of ice will impair the performance of the freezer.
- If the freezer is not going to be used for a long period of time switch it off, remove all food, clean it and leave the lid ajar.
- Check lid seals regularly to ensure they are clean and free from food particles.

### **Important Notes:**

Never use water wash the compressor position, wipe it with a dry cloth thoroughly after cleaning to prevent rust.

## **ADVICE**

- Defrost food from the freezer thoroughly in a fridge or in a microwave oven following defrosting and cooking instructions.
- Ensure that the chest freezer lid is completely closed after each use.
- Defrost frozen meat completely before cooking.
- Close the lid gently.
- Check contents of the freezer at regular intervals.
- Clean and defrost your freezer regularly (See “Defrosting”)
- Keep food for as short a time as possible and adhere to “Best Before”, “Use By” dates.
- Store commercially frozen food in accordance with the instructions given on the packets that you buy.
- Always choose high-quality fresh food and be sure it is thoroughly clean before you freeze it.
- Prepare fresh food for freezing in small portions to ensure rapid freezing.
- Wrap all foods in aluminum foil or freezer quality plastic bags and make sure any air is excluded.
- Wrap frozen food when you buy it and put it into the freezer as soon as possible.
- Store small items in the basket provided.
- Remove ice cream from the freezer 10-20 minutes before serving.
- Don't leave the lid open for long periods.
- Don't use pointed sharp-edged objects such as knives, forks to remove the ice.
- Don't put hot food in the freezer. Let it cool down first.
- Don't put liquid-filled bottles or sealed cans containing carbonated liquids into the freezer as they may burst.
- Don't store poisonous or dangerous substances in the freezer. Your freezer has been designed for the storage of edible foodstuffs only.
- Don't consume ice cream and water ices direct from the freezer. The low temperature may cause 'freezer burns' on lips.
- Don't freeze fizzy drinks.
- Don't try to keep frozen food that has thawed, it should be eaten within 24 hours or cooked and refrozen.
- Don't remove items from the freezer with wet hands.

– Don't shut the lid with force. You will damage the appliance.

- This appliance is not intended for use by persons (including children) with reduced physical, sensory or mental capabilities, or lack of experience and knowledge unless they have been given supervision or instruction concerning the use of the appliance by a person responsible for their safety.
- Children should be supervised to ensure that they do not play with the appliance.
- Do not store explosive substances such as aerosol cans with a flammable propellant in this appliance.
- This appliance is intended to be used in household and similar applications such as staff kitchen areas in shops, offices, and other working environment farm houses and by clients in hotels, motels, and other residential type environments; bed and breakfast type environments catering and similar non-retail applications.
- If the supply cord is damaged, it must be replaced by the manufacturer, its service agent, or similarly qualified persons in order to avoid a hazard.

**Energy efficiency level: F**

## **CERTIFICATIONS**

### **Electrical information**

This electrical appliance must be grounded.

This product is equipped with a plug, which is suitable for all houses equipped with sockets meeting the current specifications

If the fitted plug is not suitable for your socket outlets, it should be cut off and carefully disposed of. To avoid a possible shock hazard, do not insert the discarded plug into a socket.

This product complies with the EEC directives.

### **CORRECT DISPOSAL OF THIS PRODUCT**



This marking indicates that this product should not be disposed of with other household wastes throughout the EU. To prevent possible harm to the environment or human health from uncontrolled waste disposal, recycle it responsibly to promote the sustainable reuse of material resources. To return your used device, please use the return and collection systems or contact the retailer where the product was purchased. They can take this product for environmentally safe recycling.

### **Warnings for disposal**

※ Refrigerant and cyclopentane foaming material used for the refrigerator are flammable. Therefore, when the refrigerator is scrapped, it shall be kept away from any fire source and be recovered by a special recovering company with a corresponding qualification other than being disposed of by combustion, so as to prevent damage to the environment or any other harm.

※ When the refrigerator is scrapped, disassemble the doors, and remove the gasket of the door and shelves; put the doors and shelves in a proper place, so as to prevent the trapping of any child.

**JOCEL®**

Rua dos 5 Caminhos, nº 516  
4780-382 Argemil  
Sto Tirso  
Portugal

## DECLARATION OF CONFORMITY



We declare on our own responsibility that the machine indicated below:

|         |                    |
|---------|--------------------|
| Product | HORIZONTAL FREEZER |
| Brand   | JOCEL              |
| Model   | JCH-100 / JCH-200  |

Complies with the following European directives and standards implementation.

|                               |            |  |
|-------------------------------|------------|--|
| Low Voltage                   | 2014/35/EU | 2014/35/EU   |
| Electromagnetic Compatibility | 2014/30/EU | EN 55014-2:1997+A1:01+A2:08<br>EN 55014-1:2006+A1:09+A2:11<br>EN 61000-3-3:2013<br>EN 61000-3-2:2014 |

## Documents / Resources

|  |   |
|--|---|
|  <p>JOCEL<br/>CONGELADOR HORIZONTAL<br/>HORIZONTAL FREEZER<br/>JCH-100 e JCH-200</p> <p>MANUAL DE INSTRUÇÕES<br/>MANUAL DE INSTRUCCIONES<br/>INSTRUCTION MANUAL</p> | <p><a href="#">JOCEL JCH-100 Horizontal Freezer</a> [pdf] Instruction Manual<br/>JCH-100, JCH-200, JCH-100 Horizontal Freezer, Horizontal Freezer</p> |
|--|---|

## References

- [/// assistencia@jocel.pt](mailto:assistencia@jocel.pt)
- [/// JOCEL Electrodomésticos](#)
- [/// JOCEL Electrodomésticos](#)