



JMK F06 Circulating Fan Instruction Manual

[Home](#) » [JMK](#) » JMK F06 Circulating Fan Instruction Manual 

JMK F06 Circulating Fan Instruction Manual



Contents

- [1 Feature](#)
- [2 Exterior Size](#)
- [3 Basic Configuration](#)
- [4 Step For Usage](#)
- [5 Perating Description](#)
- [6 Protective Net Removal](#)
- [7 Aromatherapy Cover Disassemble](#)
- [8 Warranty Card](#)
- [9 Documents / Resources](#)
- [10 Related Posts](#)

Feature

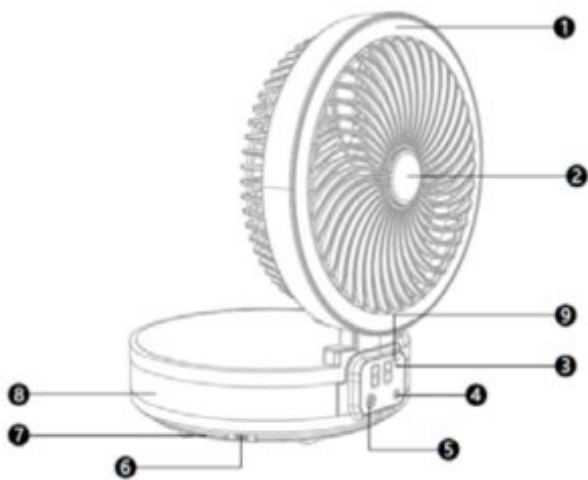

1. Removable Protective Net
2. Removable Aromatherapy w Cover
3. Temperature Display
4. Night light Mode Adjustment
5. Turn On Or Off / Speed GSM' Adjustment / Cycle Mode
6. USB Charging Port
7. Suspended Base
8. Night Light
9. Charging Indicator

Exterior Size

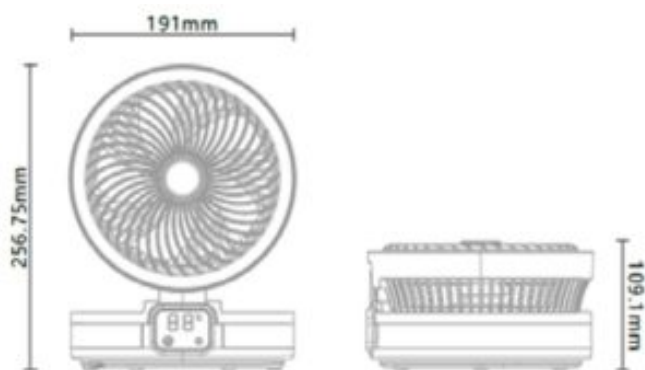

Basic Configuration



Product Model
F06 Cocular Fan



Gear
4 Speed Gear



Charging Time

6-8h



Display Function

Gear Room Temperature



Charging Input

5V/1A



Usage Time

3-1 .12h



Product Weight

670g



Decibel Value

40-50DB



Power Consumption

5W



Battery Specifications

6000mah



Control Method

Touch Control



Executive Standard

GB4706 1-2006

GB4706274006

GB/T5262-2016

Step For Usage



- Open the box and take out the circulating fan from the box.
- Connect the circulating fan to a USB charger for charging. The red indicator light is always on when charging, and the indicator light turns green when fully charged.
- Manually adjust the flip circulation fan to a proper angle (Adjustable to 90").

Perating Description

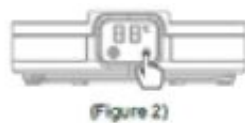
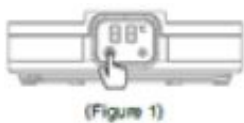

The touch button operation is as follows:

- Long press (Figure 1) with your finger position to turn on/off the fan mode, click again to adjust the fan 1/2/3/4 gear (click and touch frequency interval 0.5 seconds), double click to turn on/off the fan rotation cycle mode (5 seconds after power on The real-time temperature is displayed by default without using the touch button)
- Long press (Figure 2) finger position to turn on/off night light mode, click again (Figure 2) finger position to adjust light brightness (click and touch frequency interval 0.5 seconds). double click (Figure 2) finger position to adjust light mode (L1/L2) /L3/L4), there are four lighting modes: cool white/warm white/warm white/breathing light.

Protective Net Removal

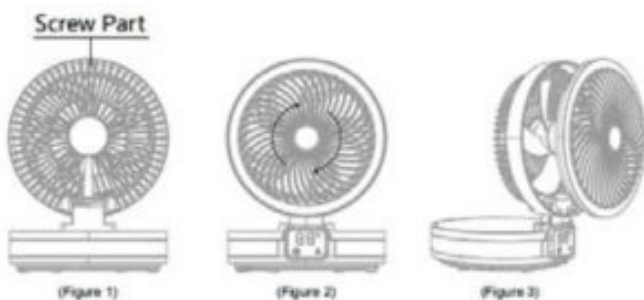

- Turn the fan to 90 and unscrew the screws on the back of (Figure 1).
 - Then turn the protective net (Figure 2) clockwise to a buckle position.
 - Finally. the protective net can be disassembled and cleaned with water.
- Aromatherapy Cover Disassemble

Aromatherapy Cover Disassemble



Rotate the aromatherapy cover counterclockwise to remove the aromatherapy cover (the product does not contain aromatherapy)

Warranty Card

Username_____

Contact Number_____

Product Name_____

Dealer (Signature):_____

Purchase Date_____

Installation Address_____

This product has been strictly inspected before leaving the factory to ensure that its quality meets various standards.

Maintenance Records:

Repair Date	Maintenance Project	Maintenance Organization	Repairer's Signature

Not:

1. Please keep this card properly. and contact the after-sales service center with the warranty card and purchase invoice when repairs are needed.
 2. The company guarantees 1 year for the F06 circulating fan purchased by the user, and the repair content includes: fan control panel, etc. (except for replaceable consumables, normal fan clearing and maintenance in the later part)
 3. The company's warranty card is only for use in China (excluding Hong Kong, Macao, and Taiwan).
 4. The warranty card shall not be copied or forged.
1. Android. Apple scan code to download and install APP.



2. Turn on the fan, turn on the phone's Bluetooth to automatically connect with the phone.

3. Open the APP to enter the operation page. The operation instructions are as follows:

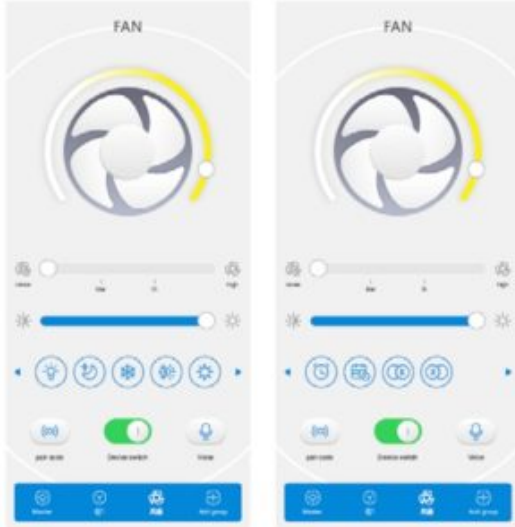

- Marquee Mode
- Breathing Light
- Cold Light Mode
- Warm And Cold Light Mode
- Warm Light Mode
- Timing
- Tentative
- Circulating Fan
- Turn Off Circulating Fan

Warning:

Changes or modifications to this unit not expressly approved by the party responsible for compliance could void the user's authority to operate the equipment.

NOTE: This device complies with part 15 of the FCC Rules. Operation is subject to the following two conditions:

- (1) This device may not cause harmful interference, and
- (2) this device must accept any interference received, including interference that may cause undesired operation.

FCC Statement:

This equipment has been tested and found to comply with the limits for a Class B digital device, pursuant to part 15 of the FCC Rules. These limits are designed to provide reasonable protection against harmful interference in a residential installation. This equipment generates, uses and can radiate radio frequency energy and, if not installed and used in accordance with the instructions, may cause harmful interference to radio communications. However, there is no guarantee that interference will not occur in a particular installation. If this equipment does cause harmful interference to radio or television reception, which can be determined by turning the equipment off and on, the user is encouraged to try to correct the interference by one or more of the following measures:

- Reorient or relocate the receiving antenna.
- Increase the separation between the equipment and receiver.
- Connect the equipment into an outlet on a circuit different from that to which the receiver is connected.
- Consult the dealer or an experienced radio/TV technician for help.

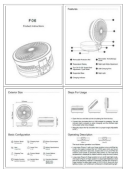

[JMK F06 Circulating Fan](#) [pdf] Instruction Manual
F06, 2A2EN-F06, 2A2ENF06, F06, Circulating Fan