

 **EPICMOUSE Multi
Device Advanced
Wireless Mouse
with Infinity
Scroll**



JLAB EPICMOUSE Multi Device Advanced Wireless Mouse with Infinity Scroll User Guide

[Home](#) » [JLab](#) » JLAB EPICMOUSE Multi Device Advanced Wireless Mouse with Infinity Scroll User Guide 

Contents

- [1 JLAB EPICMOUSE Multi-Device Advanced Wireless Mouse with Infinity Scroll](#)
- [2 Product Specifications](#)
- [3 Product Usage Instructions:](#)
- [4 PERSONAL TECH DONE BETTER](#)
- [5 SETUP](#)
- [6 CHARGING](#)
- [7 INTERFACE](#)
- [8 CUSTOMIZATION](#)
- [9 GET STARTED + FREE GIFT](#)
- [10 WE GOT YOUR BACK](#)
- [11 Frequently Asked Questions \(FAQ\)](#)
- [12 Documents / Resources](#)
 - [12.1 References](#)
- [13 Related Posts](#)



JLAB EPICMOUSE Multi-Device Advanced Wireless Mouse with Infinity Scroll



Product Specifications

- **Model:** V1.0 V1.1
- **Manufacturer:** Jerry Ji
- **Dimensions:** 1.98*155mm
- **Weight:** 2.157g/42
- **Compliance:** REACH, RoHS

Product Usage Instructions:

Unboxing and Setup:

When you receive the product, carefully unbox it and check for any visible damage. Follow the included instructions to set up the product for first-time use.

Powering On:

To power on the device, locate the power button and press it for a few seconds until the device boots up.

Connectivity:

Ensure that the product is in pairing mode if it requires connection to external devices such as smartphones or computers. Follow the pairing instructions in the manual.

Usage:

Use the product according to its intended purpose as described in the manual. Avoid using it in extreme conditions that may damage the product.

Maintenance:

Regularly clean the product using a soft, dry cloth to remove any dust or debris. Avoid using harsh chemicals that may damage the surface.

WELCOME TO THE LAB

The Lab is where you'll find real people, developing great products, in a real place called San Diego.

PERSONAL TECH DONE BETTER

Designed for You

We listen to what you want and we're always looking for ways to make everything easier and better for you.

Surprisingly Awesome Value

We always pack the most functionality and fun into every product at a truly accessible price.



SETUP

2.4 Connect

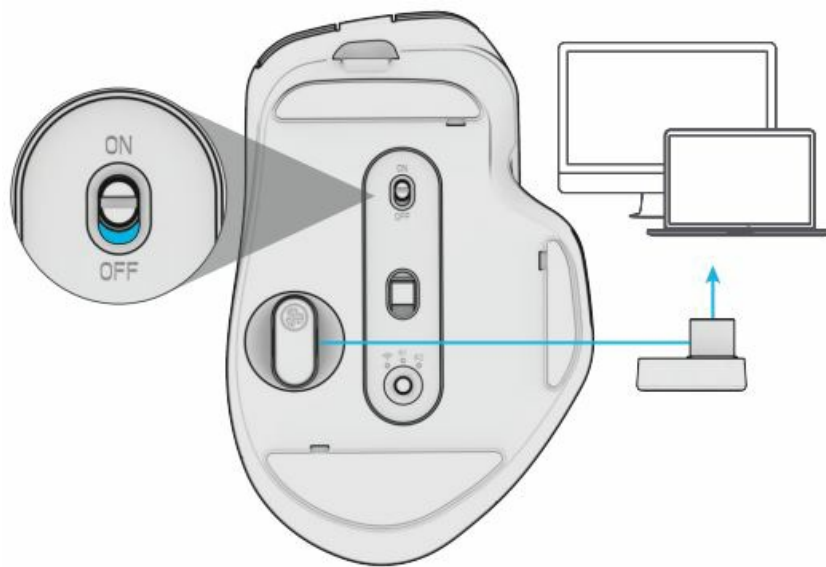
Plug in the USB-C dongle to the computer and turn it ON. Epic Mouse 2 will auto-connect.



Bluetooth Connect

- Quick Press to switch between 2.4,  1, and .
- Then Press Hold to enter Pairing Mode.
- Select JLab Epic Mouse 2 in the device settings.

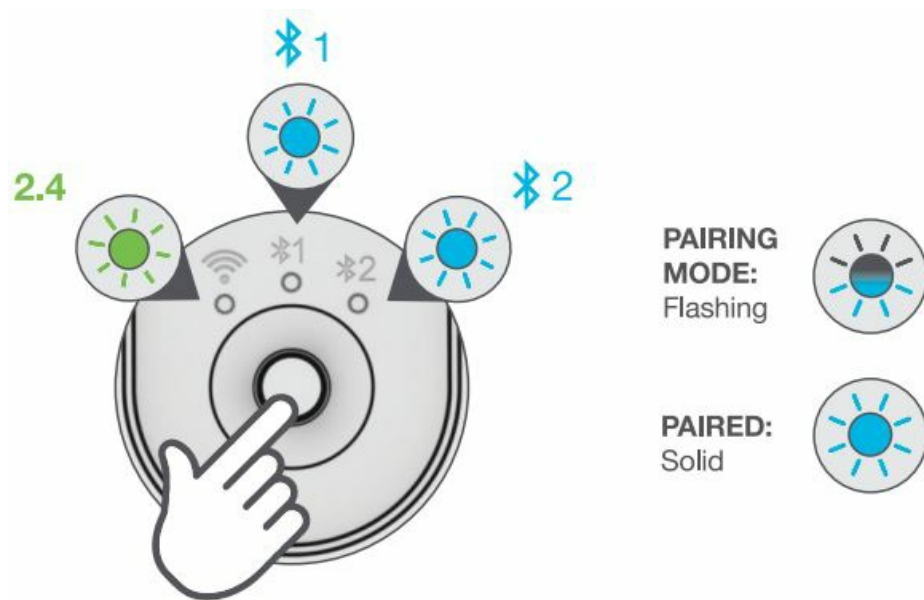

CHARGING

Connect the Epic Mouse 2 to the computer or USB 5V 1A (or less) to charge.

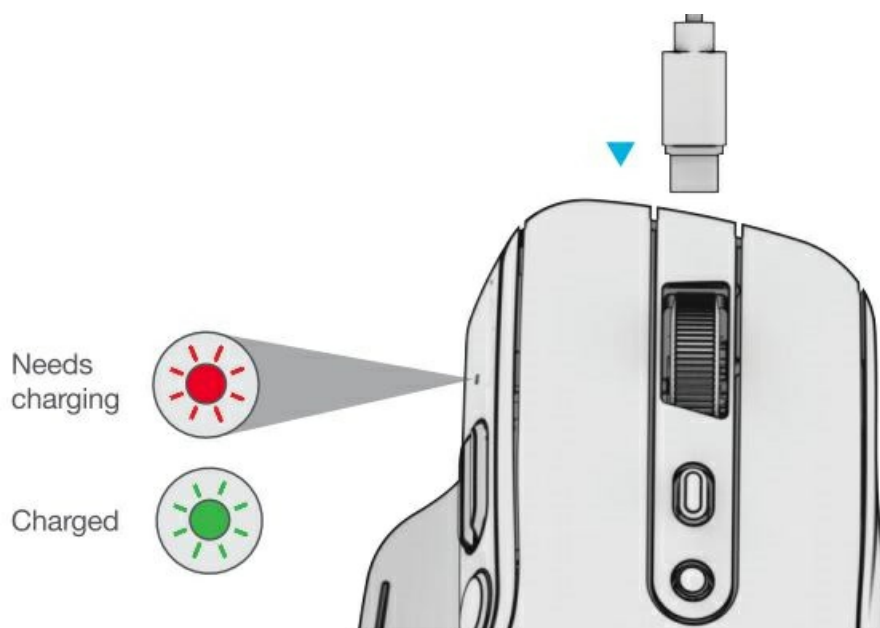

INTERFACE

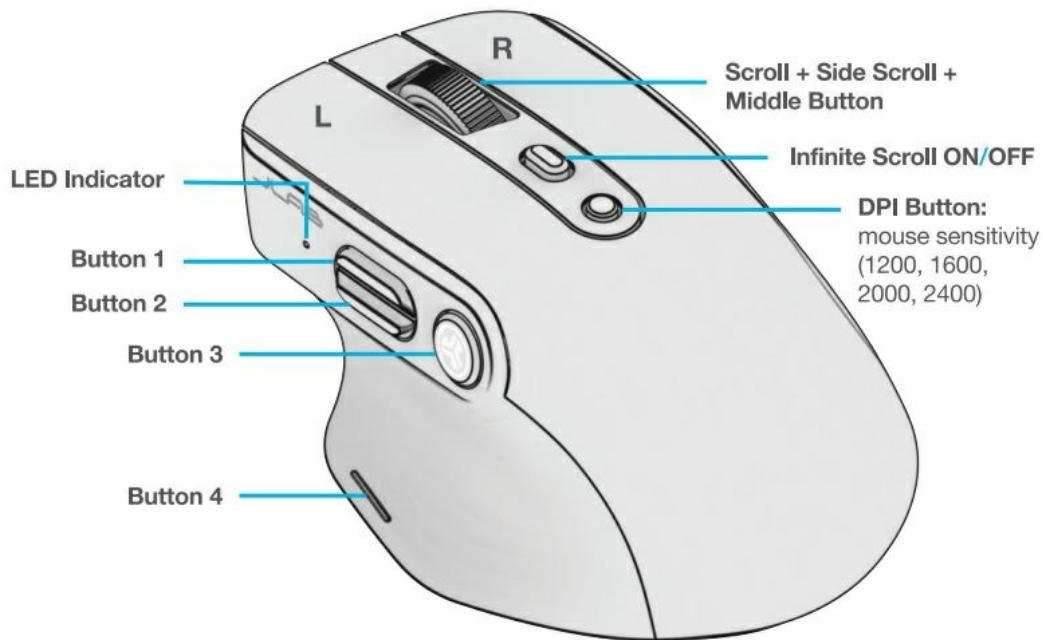

CUSTOMIZATION

Download the JLab Work App (for Mac and PC) to fully customize the Epic Mouse 2 at: [JLAB.COM/SOFTWARE](https://www.jlab.com/software)



GET STARTED + FREE GIFT

- Go to [jlab.com/register](https://www.jlab.com/register) to unlock your customer benefits including a gift.
- Gift for US only. No APO/FPO/DPO addresses.

WE GOT YOUR BACK

We're obsessed with creating the best possible experience around owning our products. If you have any questions, concerns, or feedback, we're here for you. Contact a real human on our U.S.-based customer support team:

- Website: [jlab.com/contact](https://www.jlab.com/contact)
- Email: support@jlab.com
- Phone U.S.: +1 [405-445-7219](tel:405-445-7219) (Check hours [jlab.com/hours](https://www.jlab.com/hours))
- Phone U.K./EU: +44 (20) 8142 9361 (Check hours [jlab.com/hours](https://www.jlab.com/hours))
- Visit [jlab.com/warranty](https://www.jlab.com/warranty) to initiate a return or exchange.

LATEST AND GREATEST

Our team is constantly improving your product experience.

This model may have new features or controls which are not detailed in this guide.

For the latest version of the manual, scan the QR code below.



Frequently Asked Questions (FAQ)

- **How do I charge the device?**

The device can be charged using the provided charging cable. Simply connect one end to the device and the other end to a power source.

- **Is the product waterproof?**

The product is not waterproof. Avoid exposing it to water or liquids to prevent damage.

- **Can I customize the settings of the product?**

Some products may allow for customization. Refer to the manual or contact customer support for more information on customizing settings.

Documents / Resources

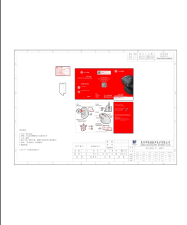
	<p>JLAB EPICMOUSE Multi Device Advanced Wireless Mouse with Infinity Scroll [pdf] User Guide</p> <p>2AHYV-EPICM2, 2AHYVEPICM2, EPICMOUSE Multi Device Advanced Wireless Mouse with Infinity Scroll, EPICMOUSE, Multi Device Advanced Wireless Mouse with Infinity Scroll, Advanced Wireless Mouse with Infinity Scroll, Wireless Mouse with Infinity Scroll, Mouse with Infinity Scroll, Infinity Scroll, Scroll, Mouse</p>
---	--

References

- **[User Manual](#)**

[Manuals+](#), [Privacy Policy](#)

This website is an independent publication and is neither affiliated with nor endorsed by any of the trademark owners. The "Bluetooth®" word mark and logos are registered trademarks owned by Bluetooth SIG, Inc. The "Wi-Fi®" word mark and logos are registered trademarks owned by the Wi-Fi Alliance. Any use of these marks on this website does not imply any affiliation with or endorsement.