



## **C6-650 6-1/2 Component System**



# **JL AUDIO C6-650 6-1/2 Component System Owner's Manual**

[Home](#) » [JL AUDIO](#) » JL AUDIO C6-650 6-1/2 Component System Owner's Manual 

### **Contents**

- [1 JL AUDIO C6-650 6-1/2 Component System](#)
- [2 Dimension](#)
- [3 Features](#)
- [4 What In The Box](#)
- [5 Installation Instructions](#)
- [6 ADJUSTABLE TWEETER LEVEL](#)
- [7 Warranty](#)
- [8 Documents / Resources](#)
  - [8.1 References](#)



**JL AUDIO C6-650 6-1/2 Component System**



### **IMPORTANT**

- Installation requires appropriate tools and safety equipment. Professional installation is recommended.
- Before installation, turn off the audio system and disconnect the battery system from the audio system.
- Before cutting or drilling, check for potential obstacles behind mounting surfaces.
- Do not mount this product in an engine compartment or other area of extreme heat.
- Mount this product securely to prevent damage or injury in severe conditions.





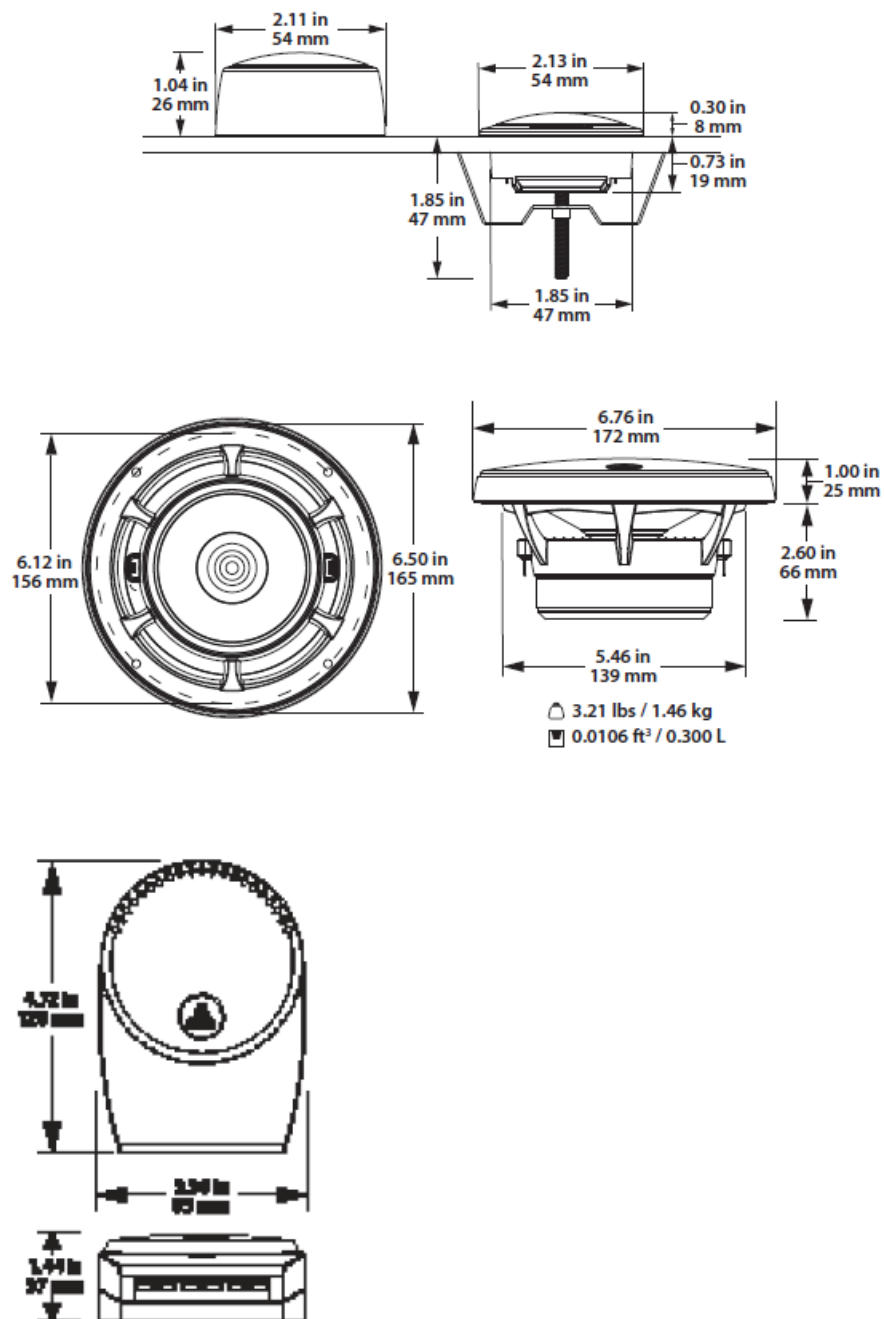

### **WARNING**

- Listen to your audio system at levels appropriate for operating conditions and hearing safety.

### **Dimension**



## Features

	C6-650
 TW	1.00 in / 25 mm
 RMS	100 W
 WATT	30 - 100 W
 SPL	87.37 dB @ 1W/1m
 FREQ	53 Hz – 21 KHz $\pm$ 3 dB
 ZNOM	4 $\Omega$

- Product images shown are for illustrative purposes only and may differ from the actual product.
- Due to continuous product development, all specifications are subject to change without notice.

## What In The Box

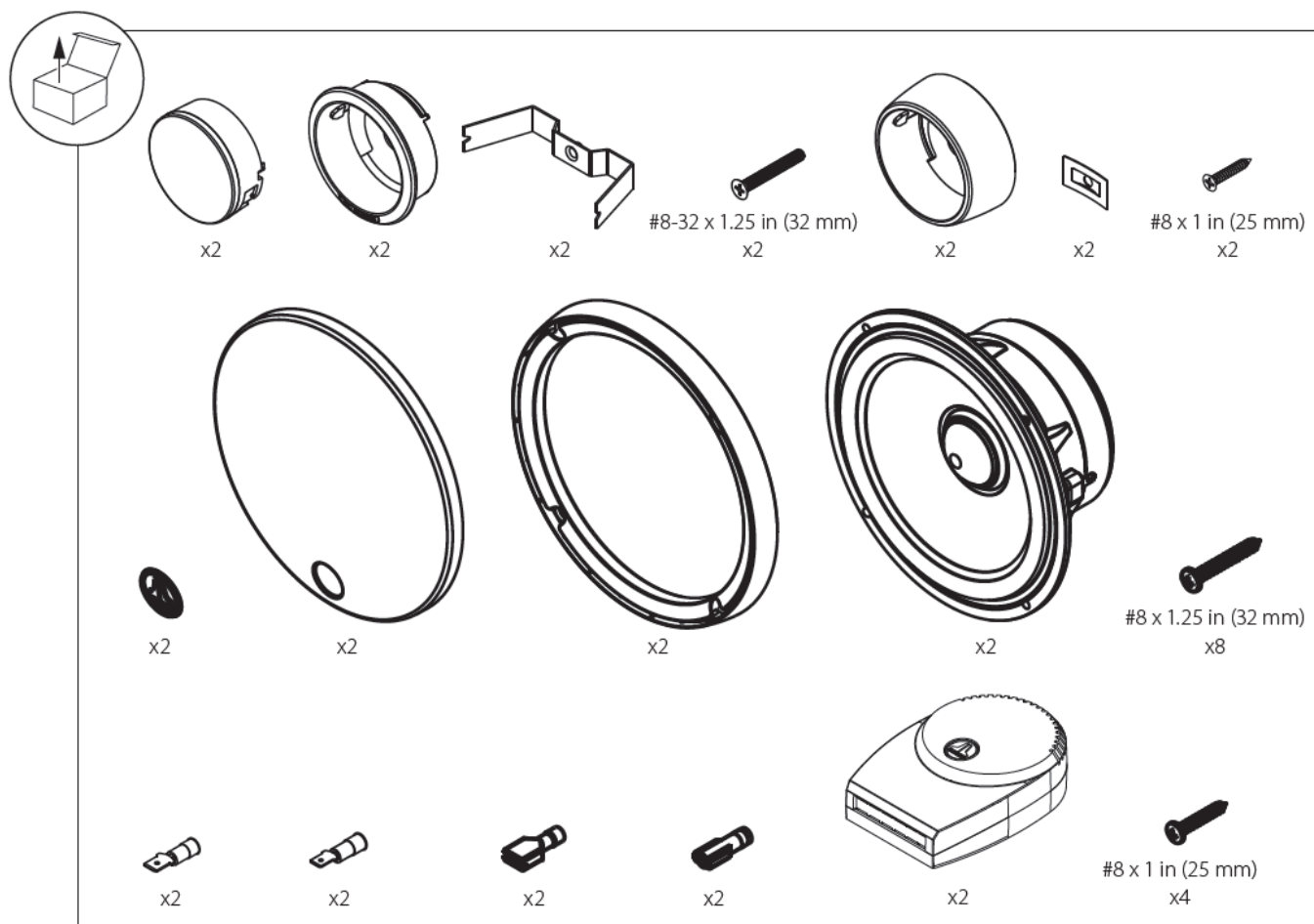

## Installation Instructions

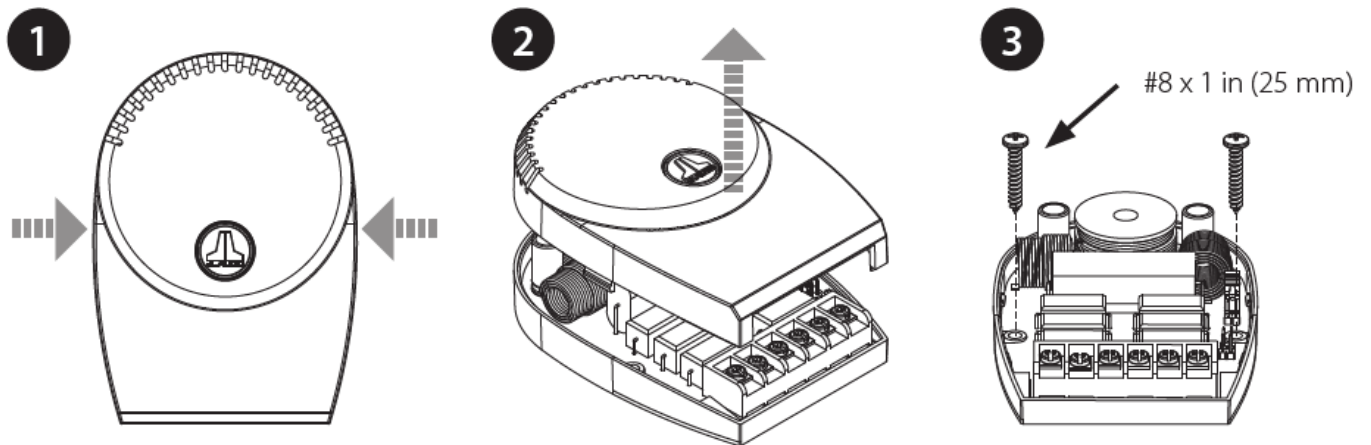

**WARNING!** Failure to use the appropriate filters supplied in this kit will result in damage or failure of the product and will NOT be covered under warranty. Securely install in dry locations only! Do not install inside of doors.

### FLUSH MOUNT

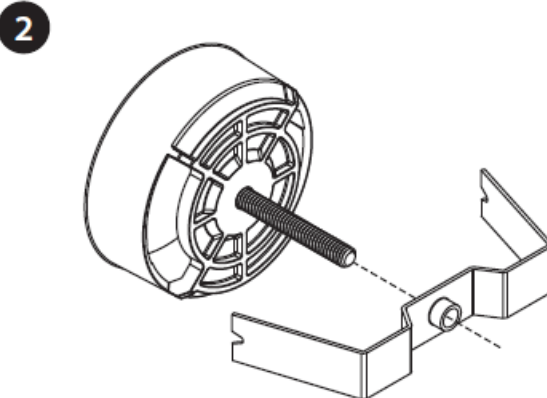
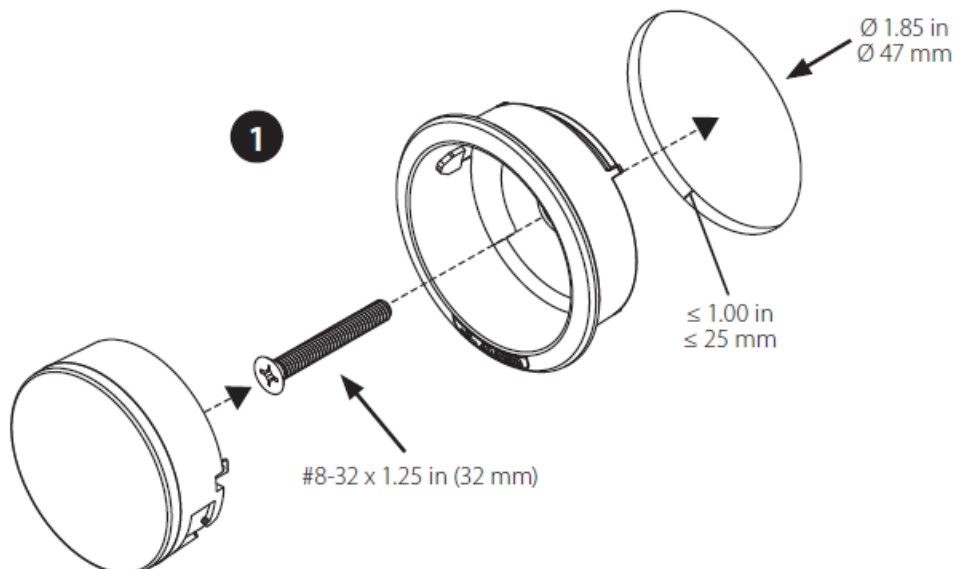

### SURFACE MOUNT

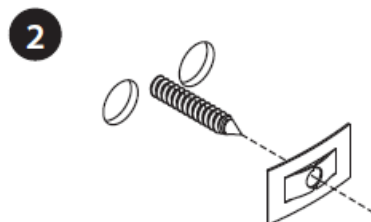
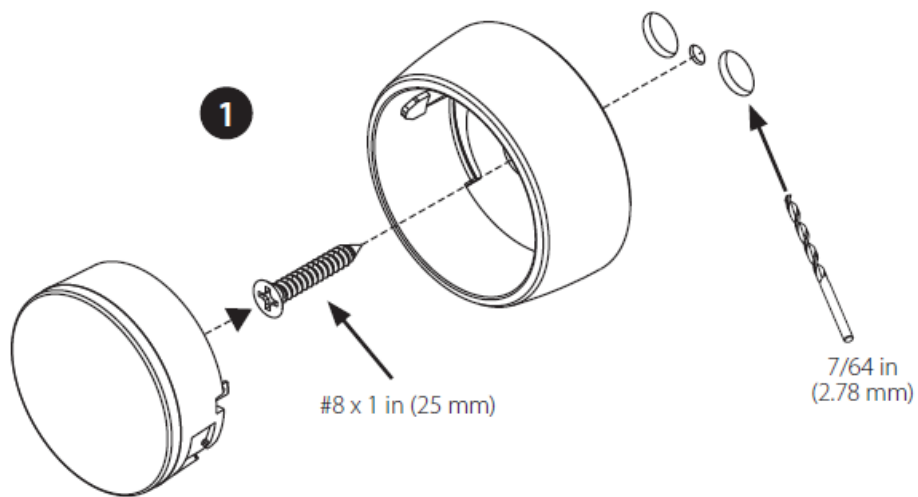

**A** EN Optional

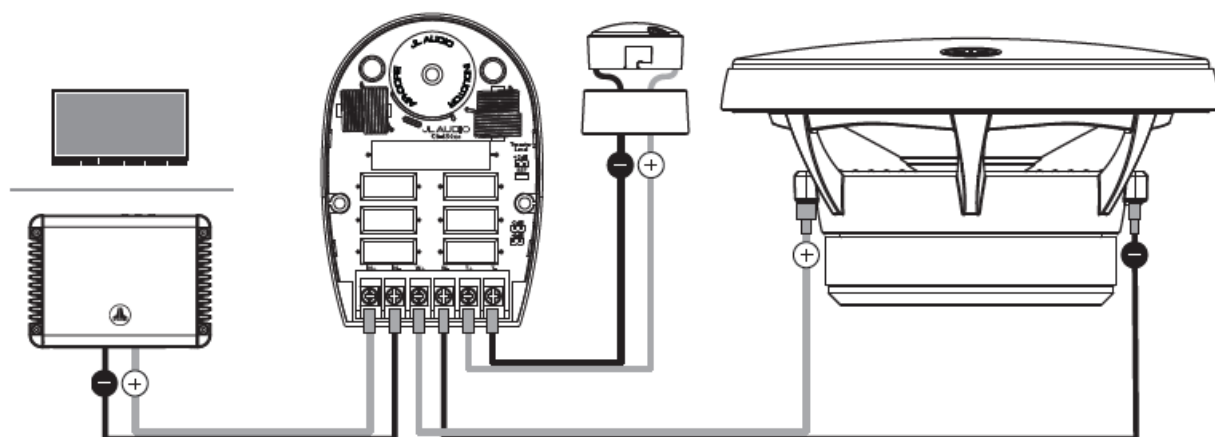
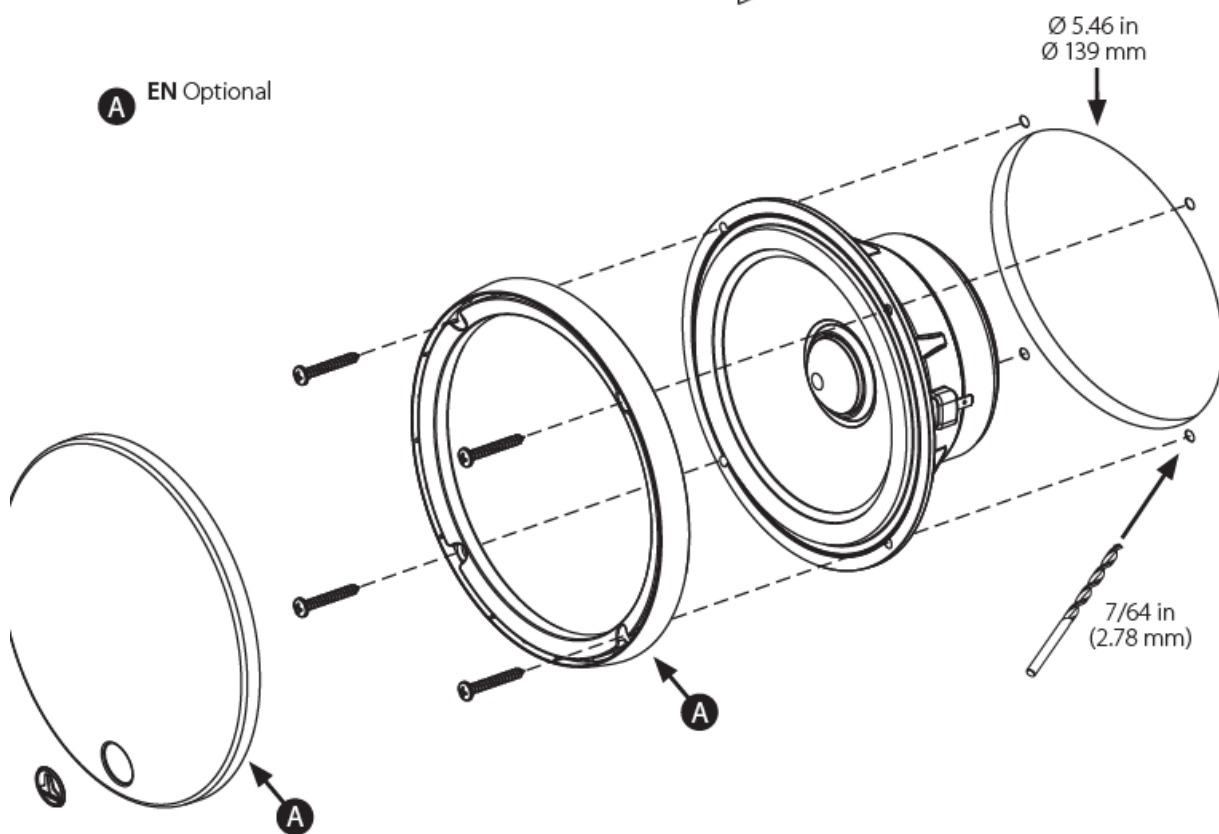

## ADJUSTABLE TWEETER LEVEL

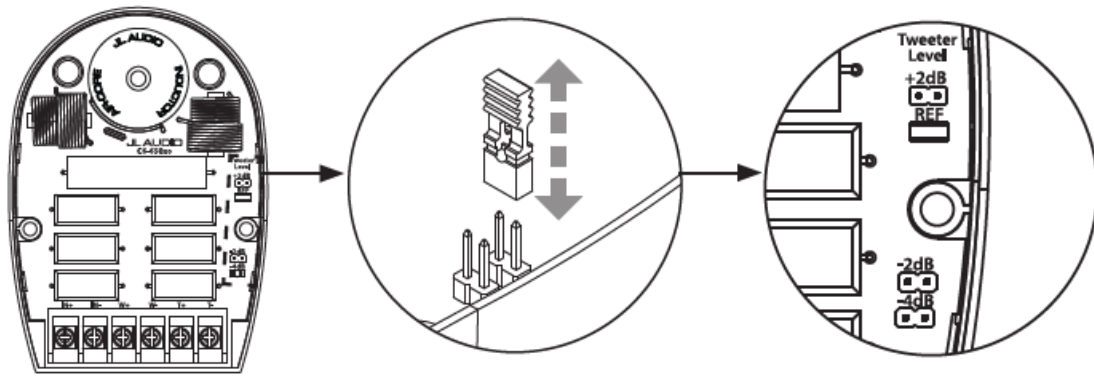

## Warranty

### USA Limited Warranty

FOR CAR AUDIO PRODUCTS SOLD AT RETAIL

JL Audio warrants these products to be free of defects in materials and workmanship from the original date of purchase for these periods:

One (1) year from the original date of purchase: Car Speakers and Subwoofers  
Two (2) years from the original date of purchase: Car Amplifiers, Electronics, Enclosed Sub woofers, Stealthbox and Connection Products

**Note:** The Car Amplifier Warranty Period Is extended to three (3) years when accompanied by the purchase of a qualifying JL Audio Amplifier Power Connection System and with installation by an authorized JL Audio dealer. This warranty is not transferable and applies only to the original retail purchaser from an authorized JL Audio dealer in the USA. Should service be necessary under this warranty for any reason due to manufacturing defect or malfunction, JL Audio will (at its discretion), repair or replace the defective product with new or remanufactured product at no charge.

**Note:** Products purchased from unauthorized dealers are not covered under warranty.

Damage caused by the following is not covered under warranty: accident, misuse, physical abuse, product modification or neglect, failure to follow Installation instructions, unauthorized repair attempts, and misrepresentations by the seller.

loudspeakers with thermal or over-excursion damage are not covered under warranty. This warranty does not cover incidental, accidental, or consequential damages and does not cover the cost of removing or reinstalling products.

Cosmetic damage due to improper handling, accident or normal wear and tear, or exposure to harsh chemicals is not covered under warranty. JL Audio will not be responsible for restoring or maintaining custom finishes or cosmetic treatments applied to products.

**This warranty is void if the product's serial number has been removed, altered, or defaced**

Any applicable implied warranties are limited in duration to the period of the express warranty as provided herein beginning with the date of the original purchase at retail, and no warranties, whether express or implied, shall apply to this product thereafter. Some states do not allow limitations on implied warranties, therefore these exclusions may not apply to you. This warranty gives you specific legal rights, and you may also have other rights which vary from state to state.

### If you need service on your JL Audio product

All USA retail warranty returns should be sent to JL Audio freight prepaid through an authorized JL Audio dealer and must be accompanied by proof of purchase (a copy of the original retail sales receipt.) Direct returns from consumers or non-authorized dealers will be refused unless specifically authorized by JL Audio with a valid return authorization number. Warranty expiration on products returned without proof of purchase will be determined from the manufacturing date code. Coverage may be invalidated as this date is prior to the purchase date. Return only defective components.

(If one speaker fails in a system, return only that speaker component, not the entire system.) Non-defective items received will be returned freight-collect. The customer is responsible for shipping charges and insurance in sending the product to JL Audio. Freight damage on returns is not covered under warranty.

### **JL Audio Customer Service**

- 1-[954-443-1100](tel:954-443-1100)
- 9:00 AM – 5:00 PM (Eastern Time Zone)

### **JL Audio Technical Support**

- [www.jlaudio.com/support](http://www.jlaudio.com/support)

### **Original Equipment Warranty**

- For JL Audio products installed as original equipment by a boat or vehicle manufacturer, warranty coverage is provided within the boat or vehicle manufacturer's warranty program.
- Please contact your boat dealer or manufacturer.

### **International Warranty**

- JL Audio Car Audio products are warrantied against defects in materials and workmanship for a minimum time period as stated in the USA warranty above, beginning on the date of purchase from a Dealer authorized by a JL Audio Distributor.
- The warranty is only valid within the country of purchase and products are covered by each country's JL Audio Distributor warranty program.
- To find your country's Distributor please visit this link: [www.jlaudio.com/pages/dealer-locator](http://www.jlaudio.com/pages/dealer-locator) Consumers in the
- EEA countries and the Russian Federation are protected by local consumer law and benefit from local statutory warranties.
- JL Audio reserves the right to change or modify any of the terms and conditions contained in this Warranty Statement, at any time and in our sole discretion.
- Any changes or modifications will be effective immediately upon posting the revisions on the JL Audio website at [www.jlaudio.com/warranty](http://www.jlaudio.com/warranty), and you waive any right you may have to receive specific notice of such changes or modifications.





Printed in Taiwan © 2023 JL Audio is a trademark of Garmin Ltd. or its subsidiaries and is registered in one or more countries, including the U.S. The JL Audio logo and the C6 logo are trademarks of Garmin Ltd. or its subsidiaries.

## Documents / Resources

 C6-650 6-1/2 Component System OWNER'S MANUAL JL AUDIO	<a href="#">JL AUDIO C6-650 6-1/2 Component System</a> [pdf] Owner's Manual C6-650-120723, 13699133, C6-650 6-12 Component System, C6-650, 6-12 Component System, Component System, System
--	---

## References

- [JL Audio Help Center - Search Articles](#)
- [JtAudio.com is for sale | HugeDomains](#)
- [User Manual](#)

### Manuals+ Privacy Policy

This website is an independent publication and is neither affiliated with nor endorsed by any of the trademark owners. The "Bluetooth®" word mark and logos are registered trademarks owned by Bluetooth SIG, Inc. The "Wi-Fi®" word mark and logos are registered trademarks owned by the Wi-Fi Alliance. Any use of these marks on this website does not imply any affiliation with or endorsement.