

JL AUDIO C1-650se Component Speaker System



JL AUDIO C1-650se Component Speaker System Owner's Manual

[Home](#) » [JL AUDIO](#) » JL AUDIO C1-650se Component Speaker System Owner's Manual 

Contents

- [1 JL AUDIO C1-650se Component Speaker System](#)
- [2 Surface Mount:](#)
- [3 Adaptor Information](#)
- [4 OWNER'S MANUAL](#)
- [5 SURFACE MOUNT](#)
- [6 ADAPTOR: HONDA/OTHER APPLICATIONS](#)
- [7 Documents / Resources](#)
 - [7.1 References](#)
- [8 Related Posts](#)



JL AUDIO C1-650se Component Speaker System



Specifications

- Product: 2-Way Component System
- Size: 6.50 in (165 mm)
- Component Size: 25 mm
- Power Handling: 50 W RMS, 10 – 75 W peak
- Sensitivity: 91.0 dB @ 1W/1m

Installation Options

The component system can be installed using two different methods:

Surface Mount:

- Use #6 screws for mounting (16 mm)
- Depth required: 1/16 in (1.50 mm)
- Recommended hole size: 1/4 in (6 mm)

Flush Mount

- Depth required: 0.375 in (10 mm)
- Recommended hole size: 0.75 in (19 mm)

Adaptor Information

Adaptors are provided for specific applications:

GM Applications

- Use #8 screws for mounting (6 mm and 19 mm)





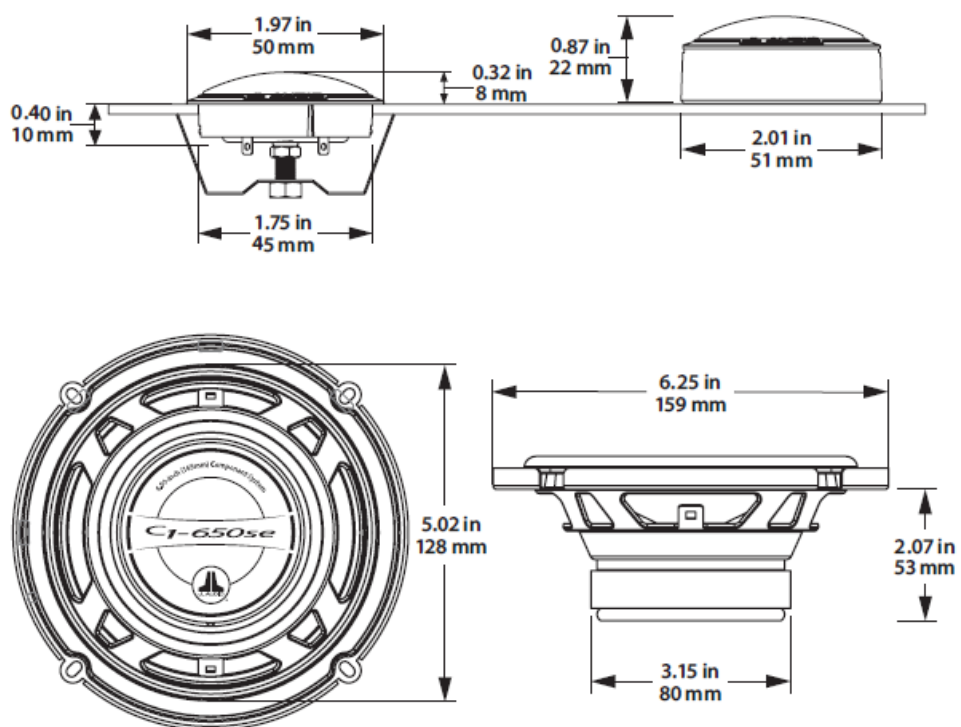

Honda/Other Applications

- Use #8 screws for mounting (6 mm and 19 mm)

6.50 in (165 mm) 2-Way Component System

OWNER'S MANUAL



	C1-650se
 TW	1.00 in / 25 mm
 RMS	50 W
 WATT	10 - 75 W
 SPL	91.0 dB @ 1W/1m
 FREQ	48 Hz - 21 KHz \pm 3 dB
 ZNOM	4 Ω

Product images shown are for illustrative purposes only and may differ from the actual product. Due to continuous product development, all specifications are subject to change without notice.

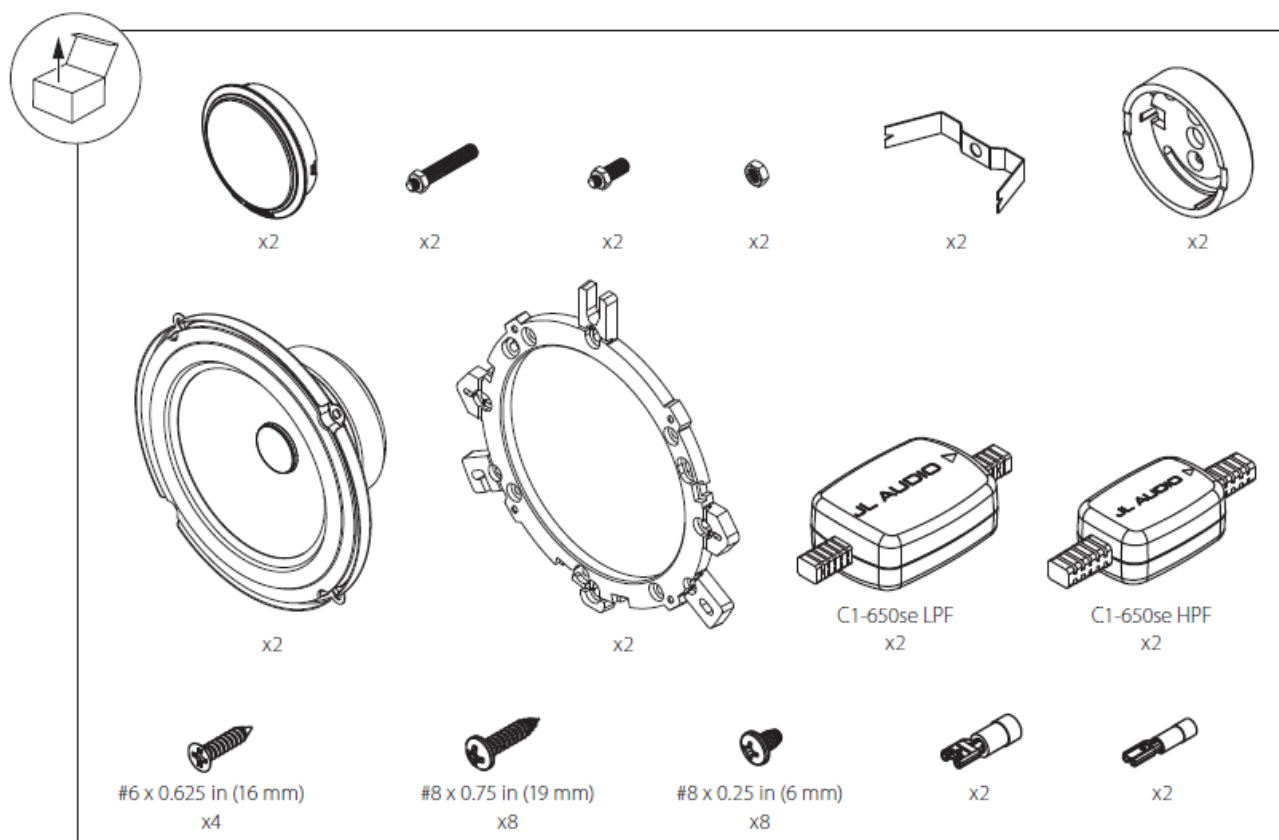

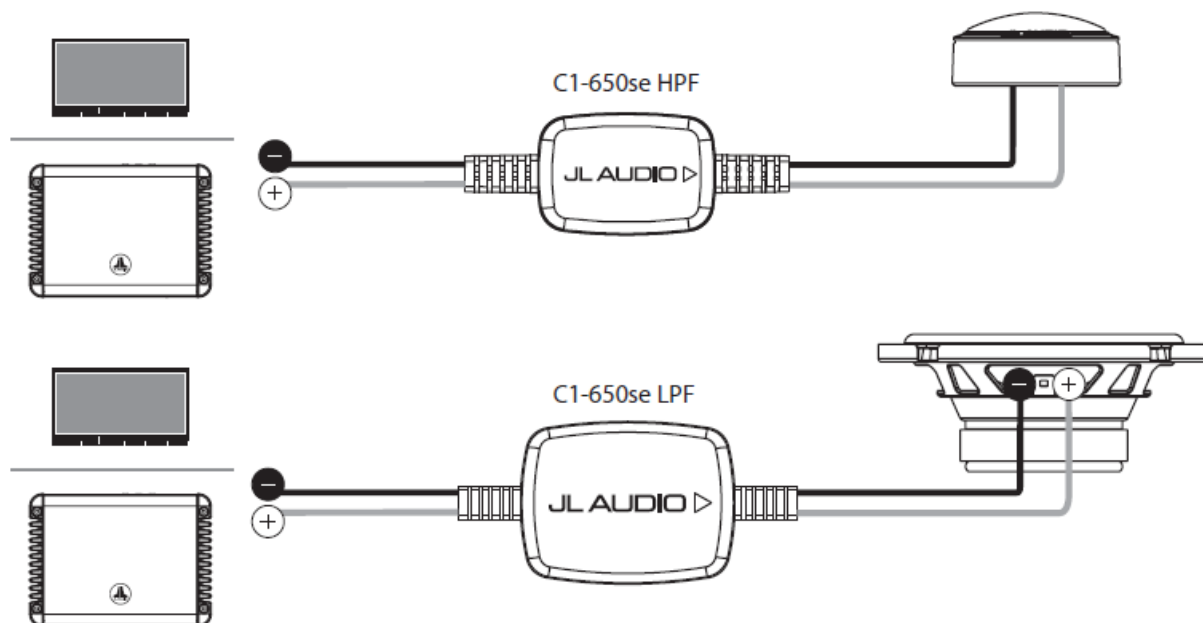

WARNING! Failure to use the appropriate filters supplied in this kit will result in damage or failure of the product and will NOT be covered under warranty.

SURFACE MOUNT

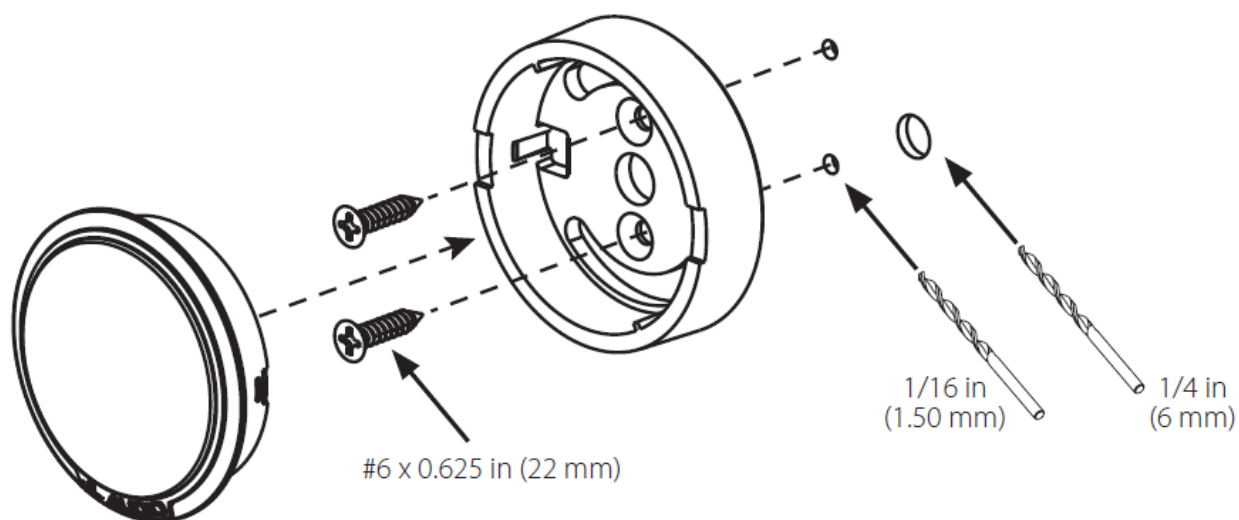

FLUSH MOUNT

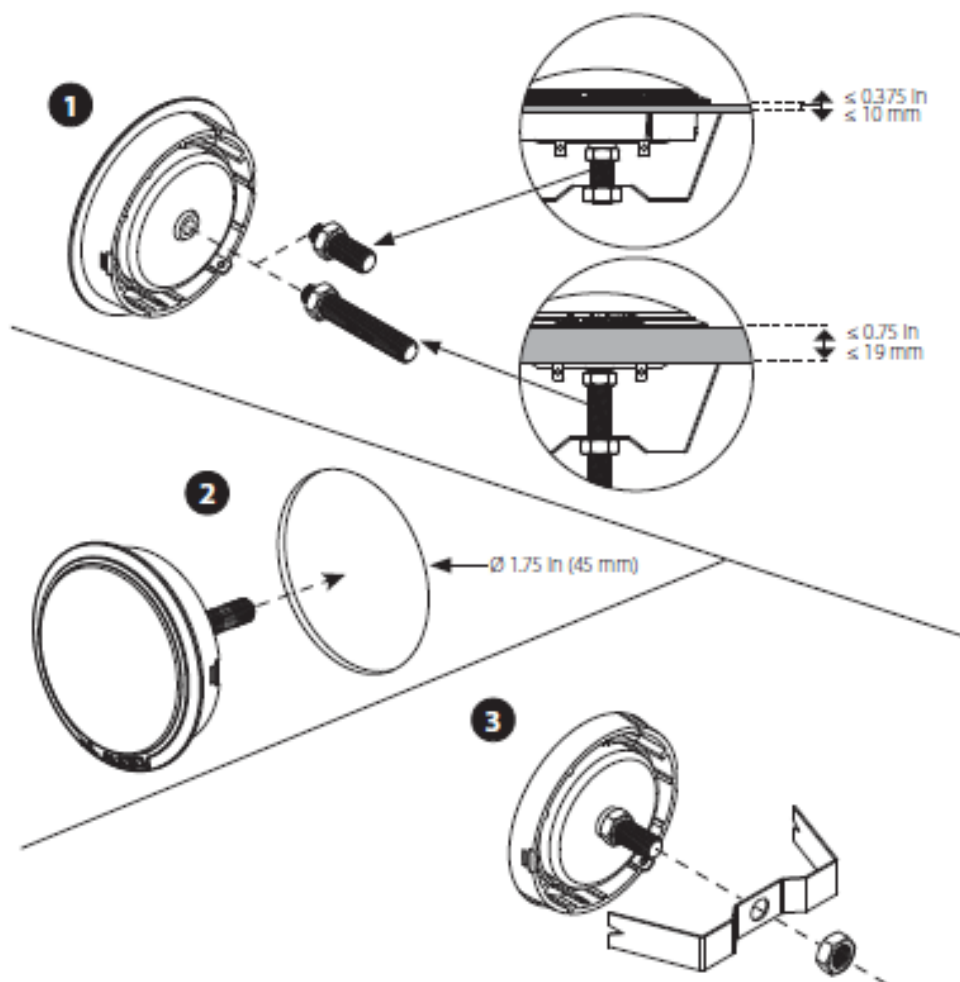

ADAPTOR: GM APPLICATIONS

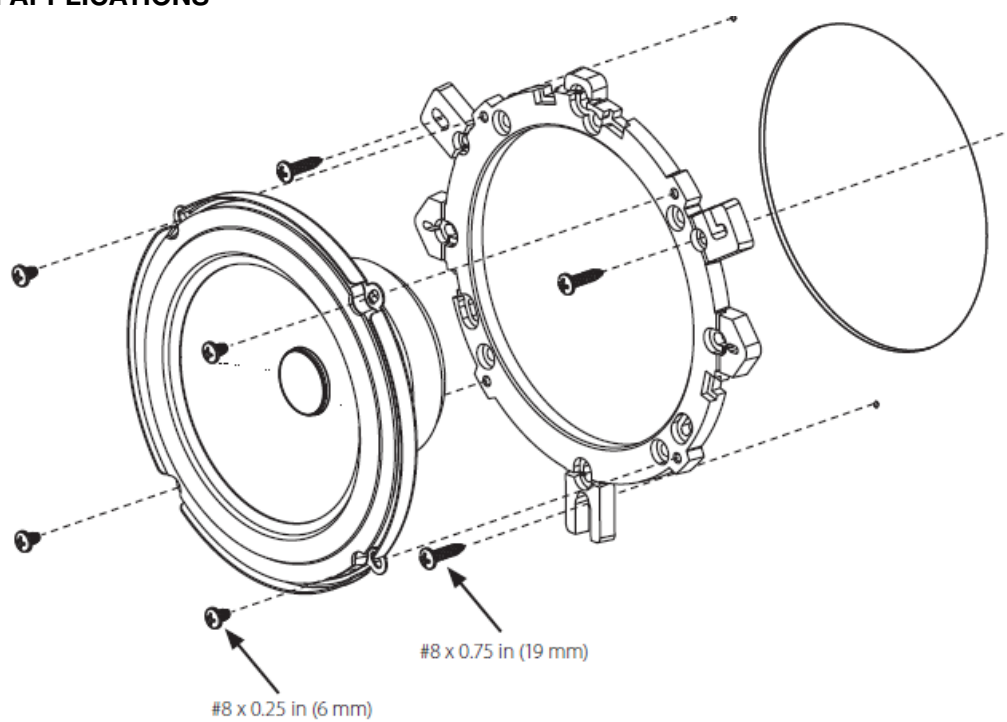

ADAPTOR: HONDA/OTHER APPLICATIONS

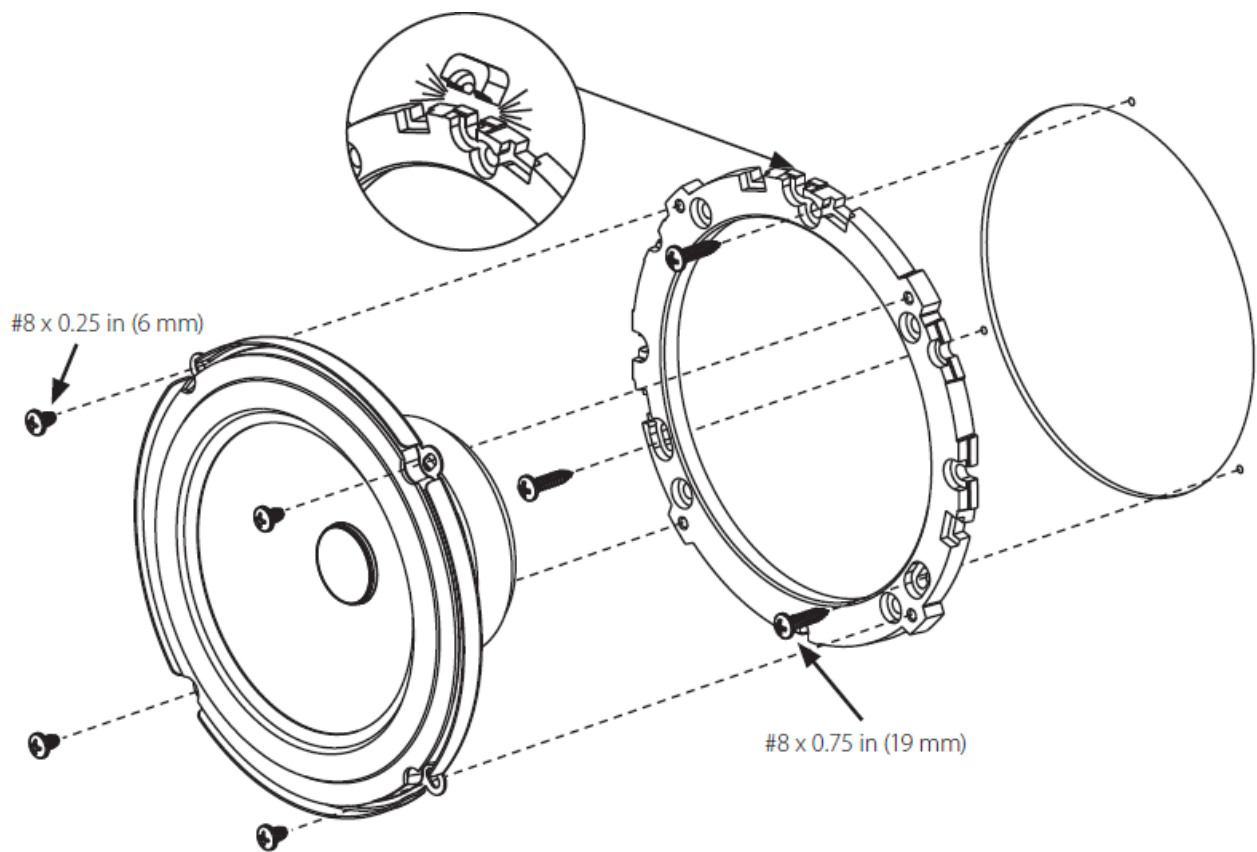

IMPORTANT

- Installation requires appropriate tools and safety equipment. Professional installation is recommended.
- Before installation, turn off the audio system and disconnect the battery system from the audio system.
- Before cutting or drilling, check for potential obstacles behind mounting surfaces.
- Do not mount this product in an engine compartment or other area of extreme heat.
- Mount this product securely to prevent damage or injury in severe conditions.

Warning

Listen to your audio system at levels appropriate for operating conditions and hearing safety.

Documents / Resources

 <p>C1-650se 6.5/4/2 Ohm 2-Way Component System</p> <p>Speaker Components: 65Watt/100V, 4-ohm Speaker Components: 65Watt/100V, 2-ohm Speaker Components: 65Watt/100V, 4-ohm Speaker Components: 65Watt/100V, 2-ohm</p> <p>OWNER'S MANUAL</p>	<p>JL AUDIO C1-650se Component Speaker System [pdf] Owner's Manual</p> <p>C1-650se Component Speaker System, C1-650se, Component Speaker System, Speaker System, System</p>
--	---

References

- [User Manual](#)

[Manuals+](#), [Privacy Policy](#)

This website is an independent publication and is neither affiliated with nor endorsed by any of the trademark owners. The "Bluetooth®" word mark and logos are registered trademarks owned by Bluetooth SIG, Inc. The "Wi-Fi®" word mark and logos are registered trademarks owned by the Wi-Fi Alliance. Any use of these marks on this website does not imply any affiliation with or endorsement.