

JL AUDIO C1-650se 2 Way Component Speaker System



JL AUDIO C1-650se 2 Way Component Speaker System Owner's Manual

[Home](#) » [JL AUDIO](#) » JL AUDIO C1-650se 2 Way Component Speaker System Owner's Manual 

Contents

- [1 JL AUDIO C1-650se 2 Way Component Speaker System](#)
- [2 Product Information](#)
- [3 Product Usage Instructions](#)
- [4 Specification](#)
- [5 What's In The Box](#)
- [6 Connection](#)
- [7 MOUNTING INSTRUCTION](#)
- [8 IMPORTANT INSTRUCTION](#)
- [9 Documents / Resources](#)
 - [9.1 References](#)



JL AUDIO C1-650se 2 Way Component Speaker System



Product Information

The 6.50 in (165 mm) 2-way Component System is a high-quality audio system designed for optimal sound performance. It is a versatile component system that can be used in various applications.

Specifications

- **Component System Size:** 6.50 in (165 mm)
- **Tweeter Size:** 25 mm
- **Power Handling (RMS):** 50 W
- **Power Handling (Peak):** 10 – 75 W
- **Sensitivity:** 91.0 dB @ 1W/1m
- **Impedance:** 4 Ohms

Product Usage Instructions

Surface Mount Installation

1. Choose a suitable location for mounting the component system.
2. Securely mount the component system using the provided #6 x 0.625 in (16 mm) screws.
3. Connect the component system to your audio system following the wiring diagram in the user manual.

Flush Mount Installation

1. Select a suitable location for flush mounting the component system.
2. Make necessary cutouts in the mounting surface using a 1/16 in (1.50 mm) drill bit and a 1/4 in (6 mm) drill bit.
3. Place the component system into the cutouts and secure it using the provided #8 x 0.25 in (6 mm) screws.
4. Connect the component system to your audio system following the wiring diagram in the user manual.

Adaptor Installation for GM Applications

1. If you have a GM vehicle, use the provided adaptor for installation.
2. Securely mount the adaptor using the provided #8 x 0.25 in (6 mm) and #8 x 0.75 in (19 mm) screws.
3. Attach the component system to the adaptor using the provided screws.
4. Connect the component system to your audio system following the wiring diagram in the user manual.

Adaptor Installation for Honda/Other Applications

1. If you have a Honda or other vehicle, use the provided adaptor for installation.
2. Securely mount the adaptor using the provided #8 x 0.25 in (6 mm) and #8 x 0.75 in (19 mm) screws.
3. Attach the component system to the adaptor using the provided screws.
4. Connect the component system to your audio system following the wiring diagram in the user manual.

FAQ

- **Q: What is the power handling of this component system?**

A: The power handling of this component system is 50 W RMS and can handle peak power between 10 – 75 W.

- **Q: What is the sensitivity of this component system?**

A: The sensitivity of this component system is 91.0 dB @ 1W/1m.

- **Q: What is the impedance of this component system?**

A: The impedance of this component system is 4 Ohms.

- **Q: Can I use this component system in a GM vehicle?**





A: Yes, there is an adaptor provided for GM applications. Please refer to the user manual for installation instructions.

- **Q: Can I use this component system in a Honda or other vehicle?**

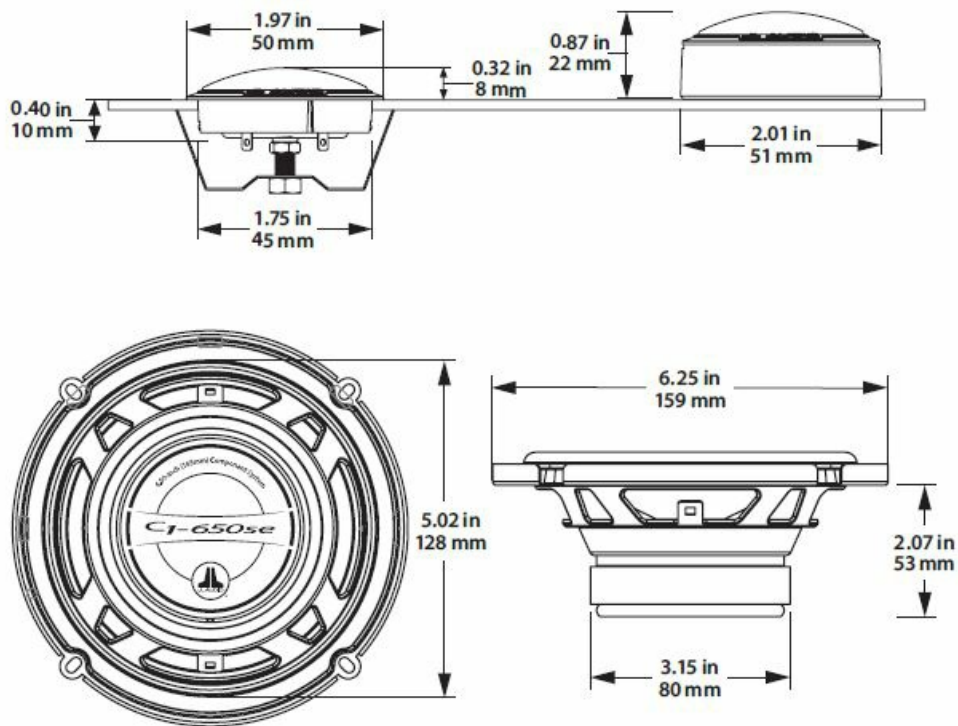
A: Yes, there is an adaptor provided for Honda/Other applications. Please refer to the user manual for installation instructions.

Specification

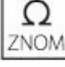

	C1-650se
 TW	1.00 in / 25 mm
 RMS	50 W
 WATT	10 - 75 W
 SPL	91.0 dB @ 1W/1m
 FREQ	48 Hz – 21 KHz ± 3 dB
 ZNOM	4 Ω

Product images shown are for illustrative purposes only and may differ from the actual product. Due to continuous product development, all specifications are subject to change without notice.

What's In The Box

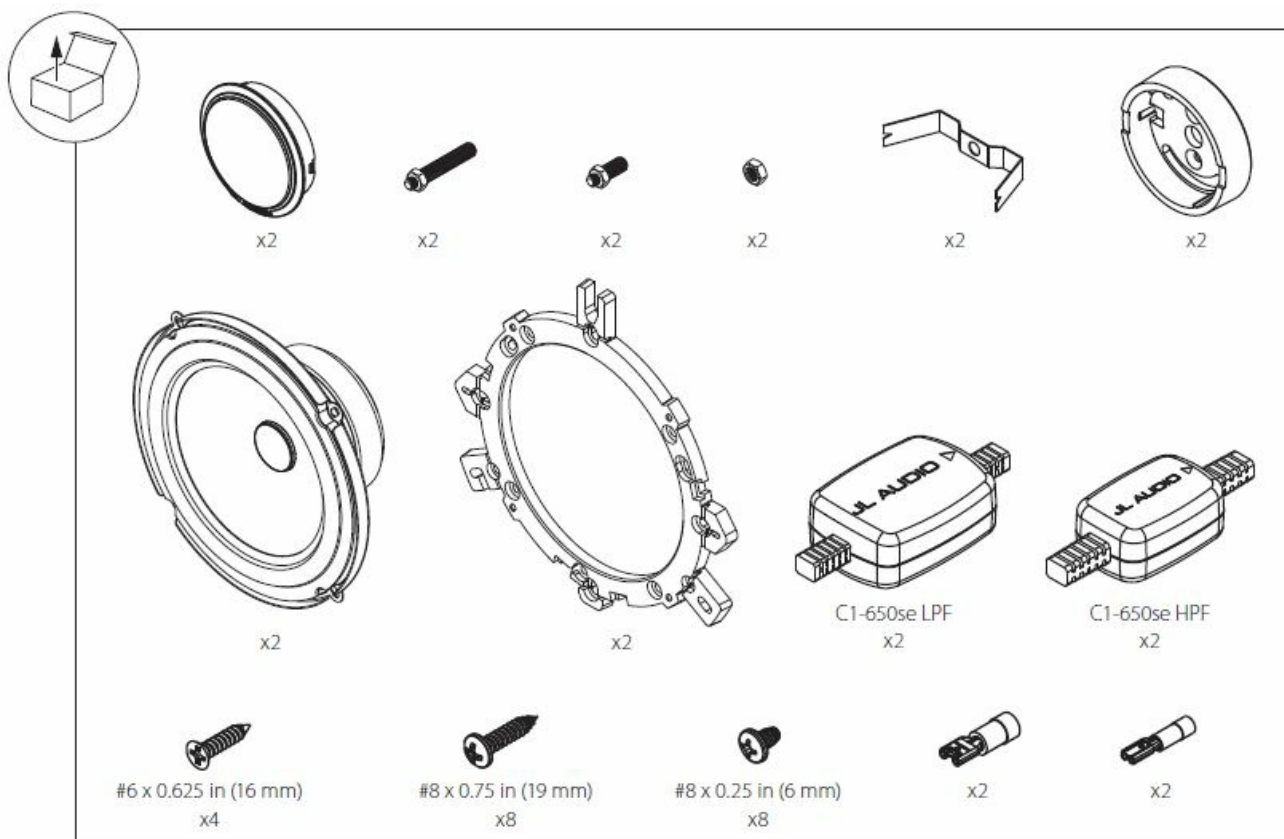

Connection

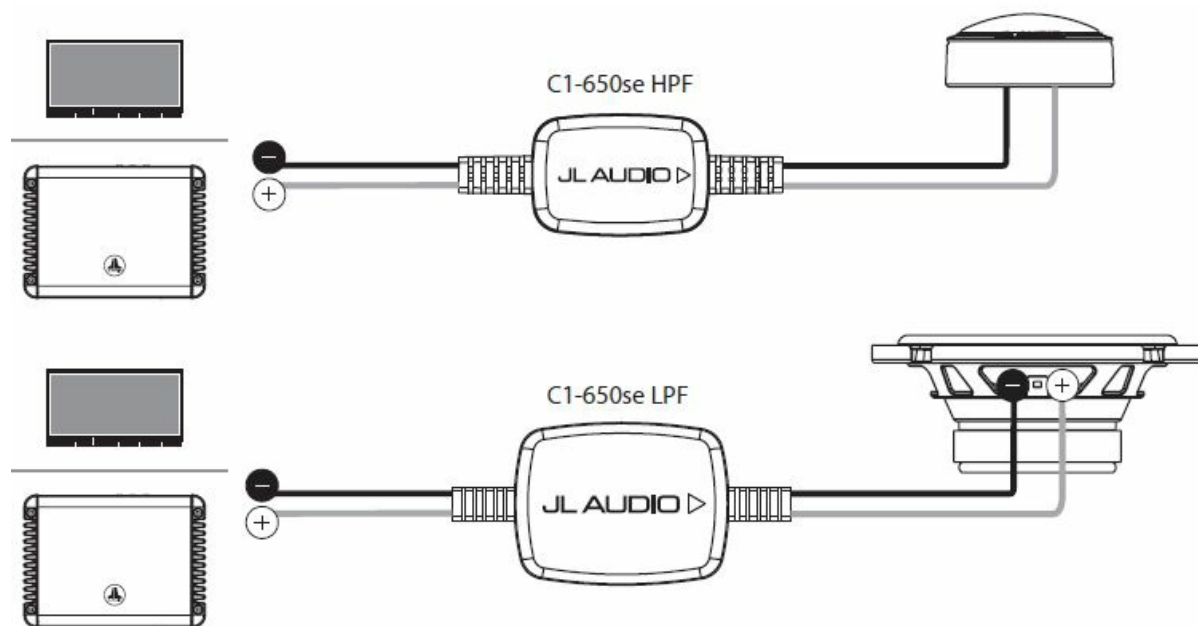

WARNING!

Failure to use the appropriate filters supplied in this kit will result in damage or failure of the product and will NOT be covered under warranty.

MOUNTING INSTRUCTION

SURFACE MOUNT

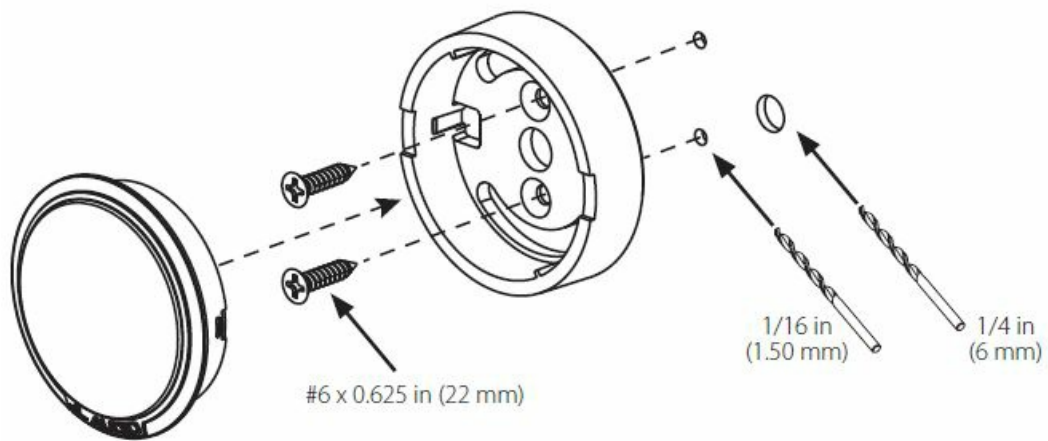

FLUSH MOUNT

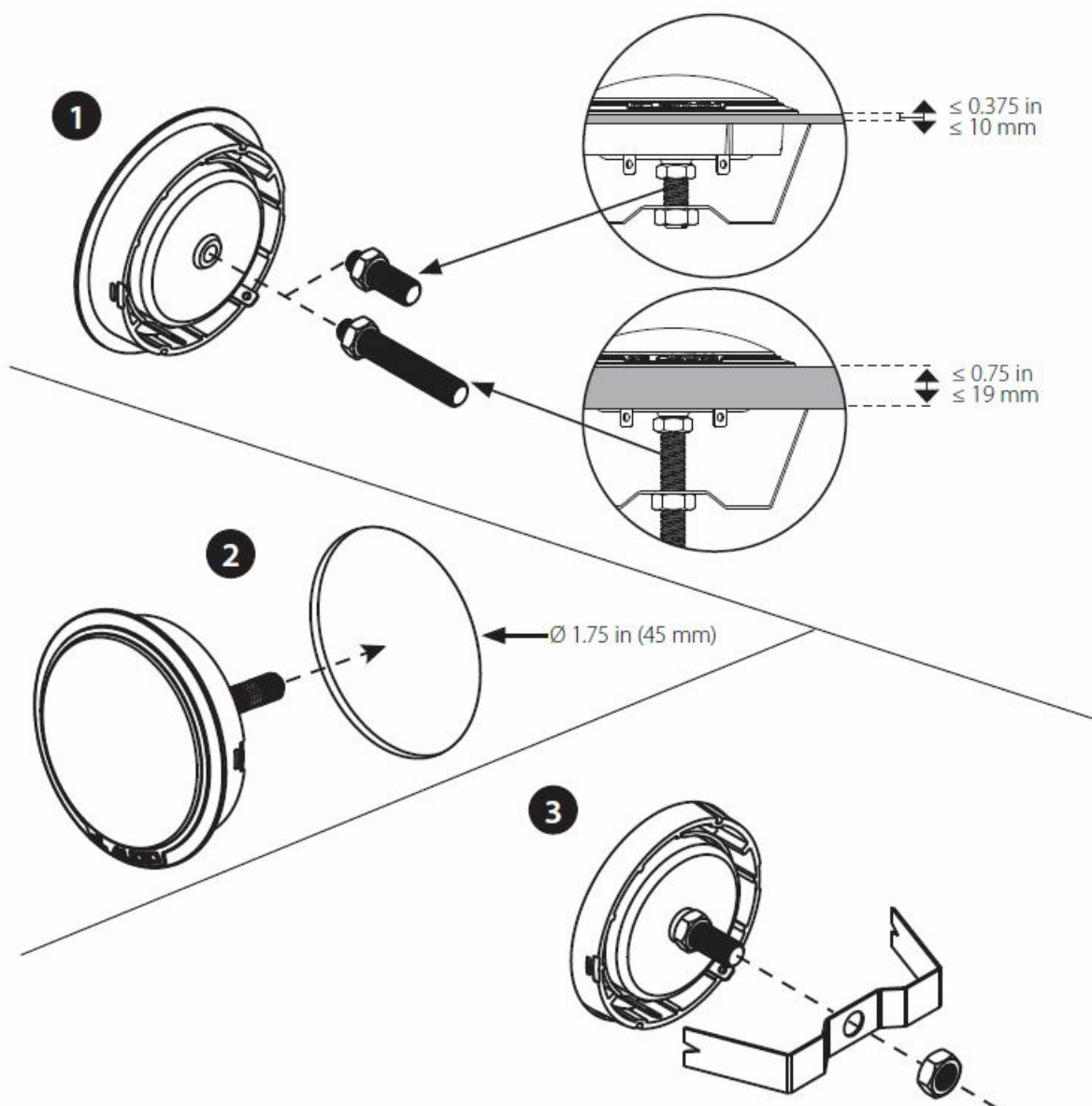

ADAPTOR: GM APPLICATIONS

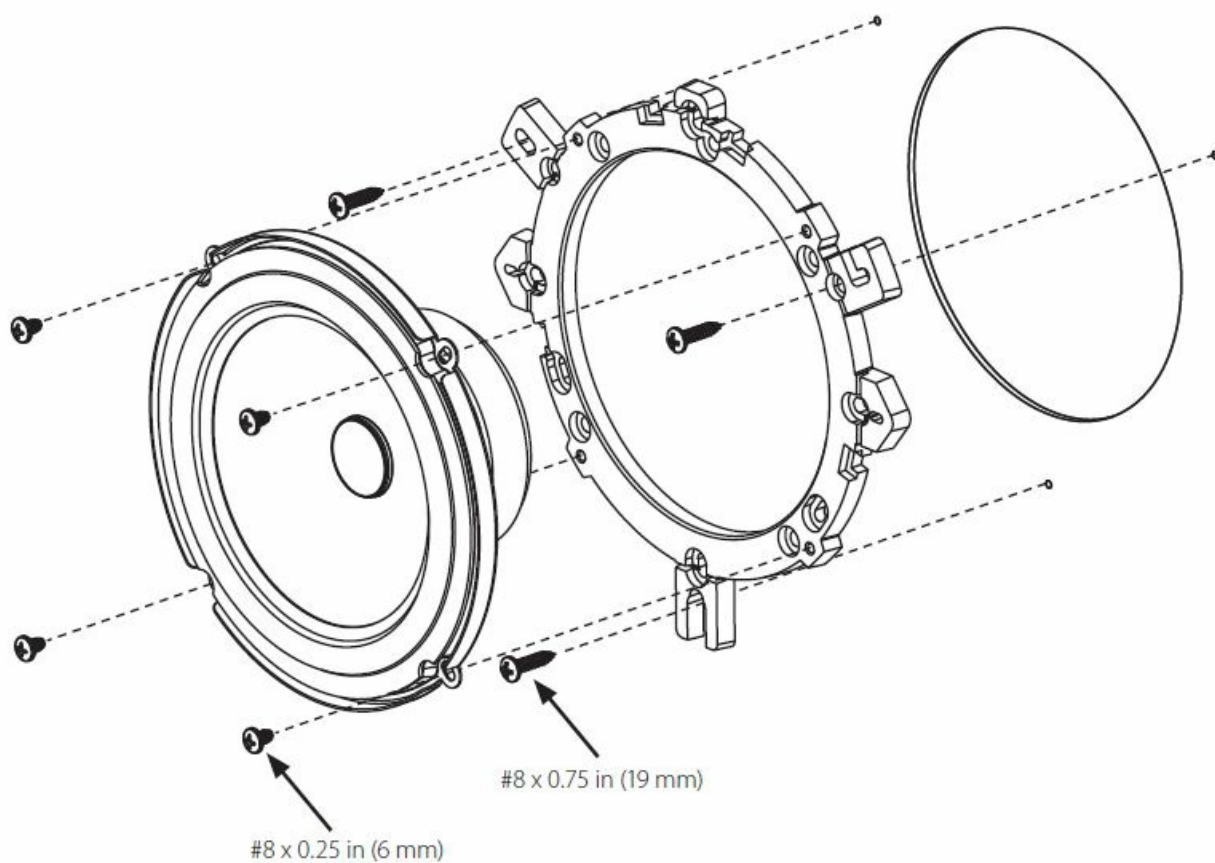

ADAPTOR: HONDA/OTHER APPLICATIONS

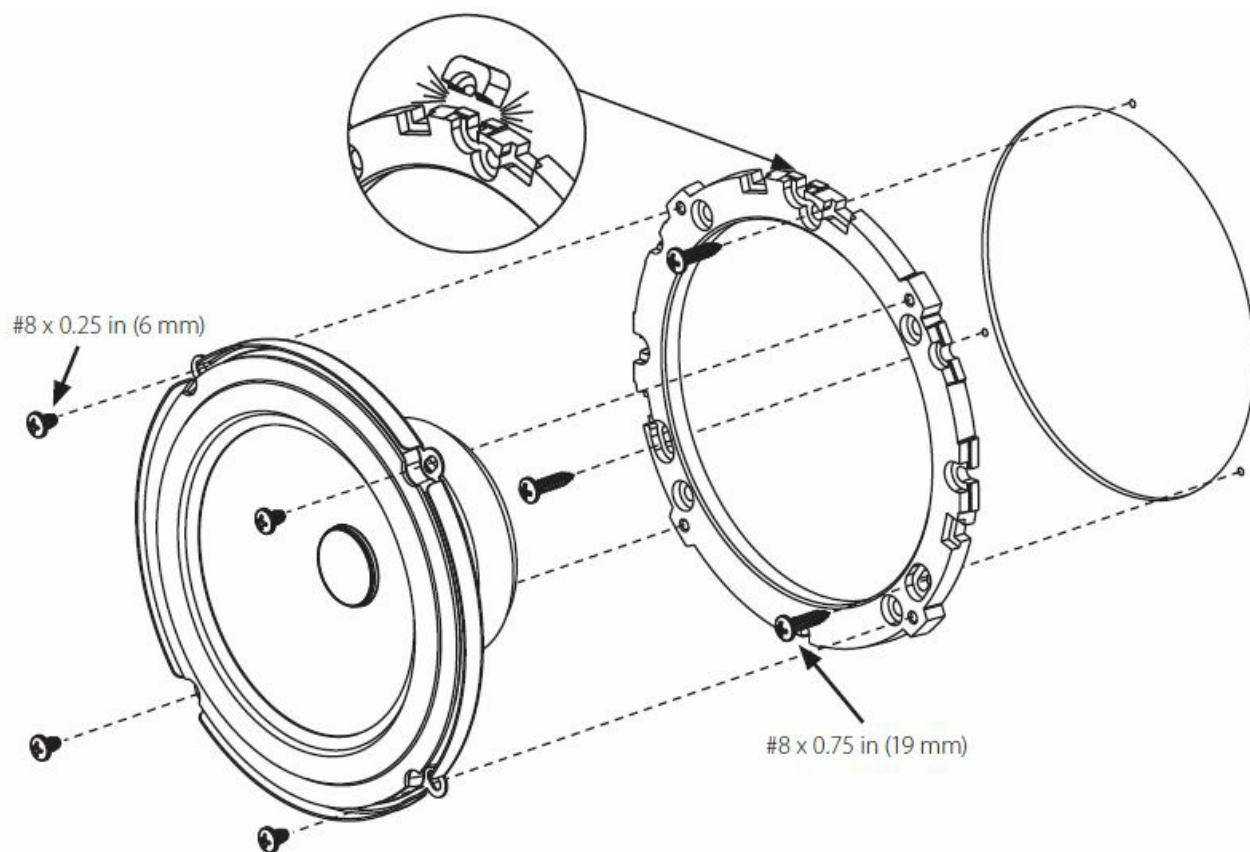

IMPORTANT INSTRUCTION

- Installation requires appropriate tools and safety equipment. Professional installation is recommended.
- Before installation, turn off the audio system and disconnect the battery system from the audio system.
- Before cutting or drilling, check for potential obstacles behind mounting surfaces.
- Do not mount this product in an engine compartment or other area of extreme heat.
- Mount this product securely to prevent damage or injury in severe conditions.

WARNING

Listen to your audio system at levels appropriate for operating conditions and hearing safety.

Documents / Resources

	<p>JL AUDIO C1-650se 2 Way Component Speaker System [pdf] Owner's Manual C1-650se 2 Way Component Speaker System, C1-650se, 2 Way Component Speaker System, Component Speaker System, Speaker System, System</p>
---	--

References

- [User Manual](#)

[Manuals+.](#) [Privacy Policy](#)

This website is an independent publication and is neither affiliated with nor endorsed by any of the trademark owners. The "Bluetooth®" word mark and logos are registered trademarks owned by Bluetooth SIG, Inc. The "Wi-Fi®" word mark and logos are registered trademarks owned by the Wi-Fi Alliance. Any use of these marks on this website does not imply any affiliation with or endorsement.