



JIMTAB B2 USB Bluetooth Adapter User Manual

[Home](#) » [JIMTAB](#) » JIMTAB B2 USB Bluetooth Adapter User Manual 

Contents

- 1 JIMTAB B2 USB Bluetooth Adapter
- 2 B2 2 IN1 USB Bluetooth
- 3 Receive Mode (For normal audio / car / wired headset,etc
.)
- 4 CUSTOMER SUPPORT
- 5 Documents / Resources
 - 5.1 References
- 6 Related Posts



JIMTAB B2 USB Bluetooth Adapter



Specifications

- **Product Name:** B2 2 IN1 USB Bluetooth Adapter Transmitter& Receiver
- **Supported Bluetooth Version:** BT5.0+EDR
- **Transmission/Reception Distance:** 8-10 meters
- **Supported Bluetooth Profiles:** AD2P

B2 2 IN1 USB Bluetooth

Adapt Transmitter& Receiver Transmitter

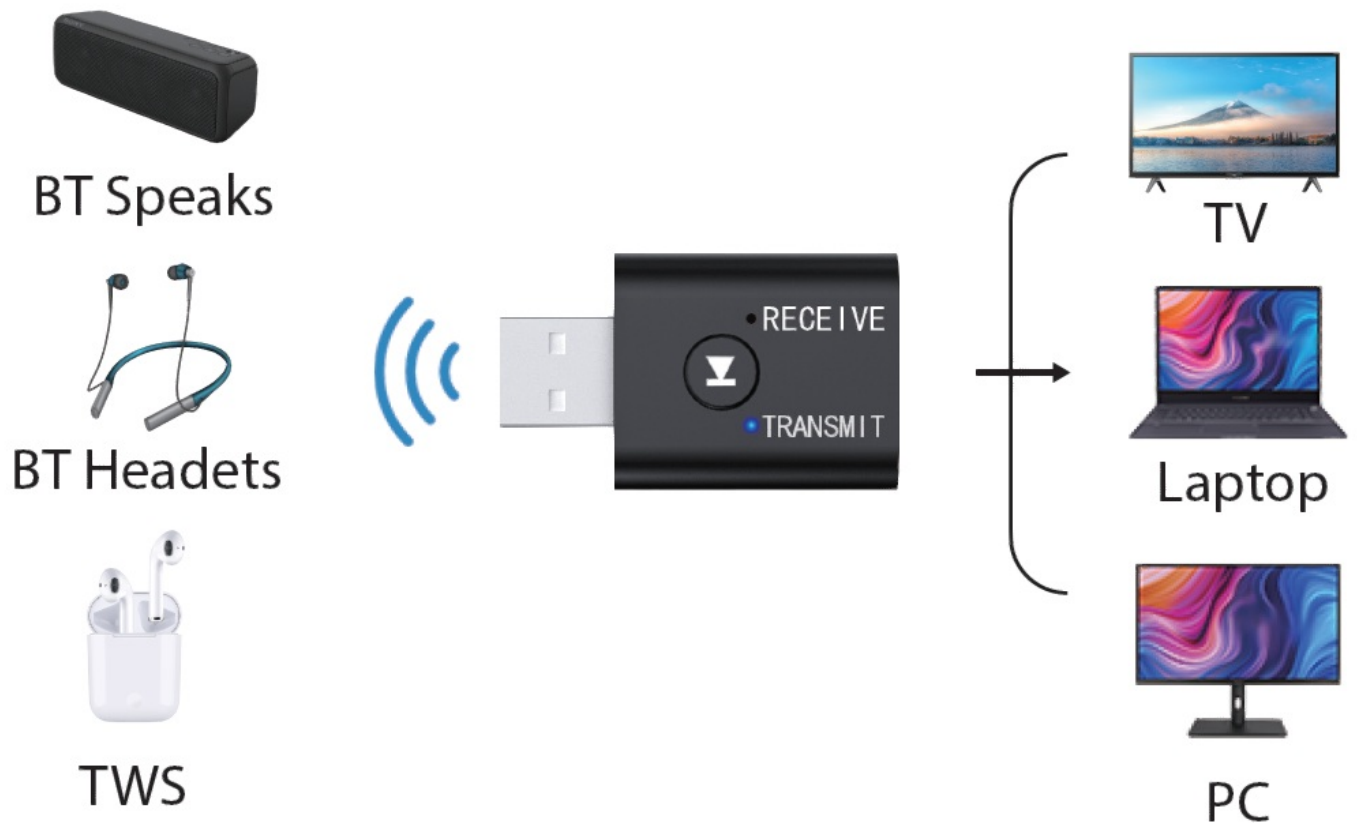

Receiver

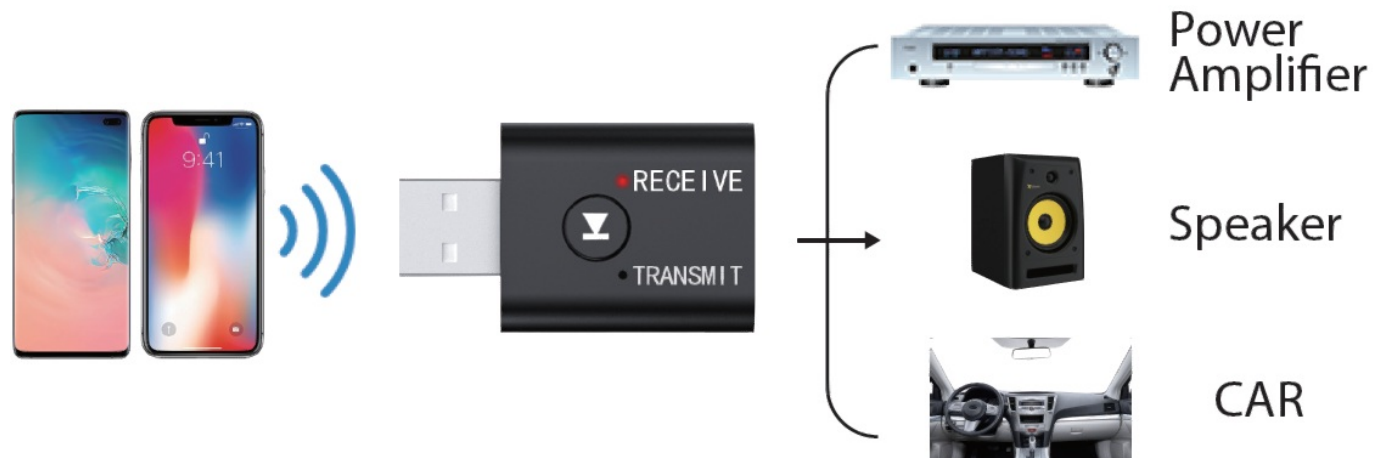

- Please refer to when using the Transmitter mode

Computer Sound Output Setting

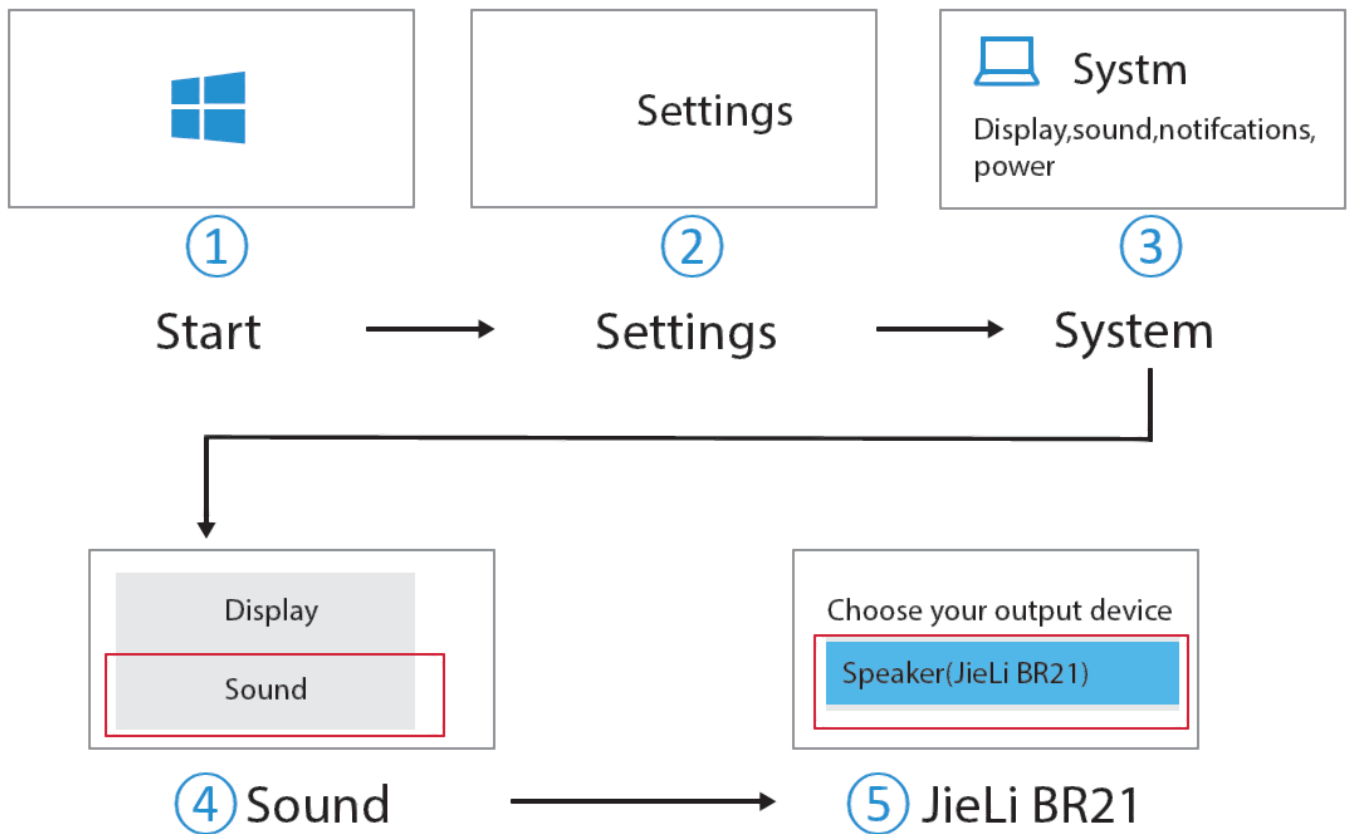

Common TV Audio Output Settings

- **MIT:** Settings -Output Devices -External Speakers Lit: Settings – Sound – Output Devices – Headphones More TV settings are in the collection.

Note

- This product only supports the earphone RCA audio output interface, if the TV only has a fiber output interface, please change our other products that support digital output.

Instructions For Use

- Transmission / Receiveing Mode Switch
- Audio cable insert TRANSMIT hole is Transmission mode.

(Blue LED)

- Audio cable insert RECEIVE hole is Receiving mode .

(Red LED)

- USB insert computer is Transmission.

How to Use

Transmitter Mode (For sending Computer/TV/MP3 audio to Bluetooth headset/sound)

1. The adapter is plugged into the USB power supply, the blue LED flashes and enters the transmit mode.
2. Plug one end of the audio cable into the adapter TRANSMIT port and the other end into the audio output port (OUTPUT) of the TV or other devices. (Remark: In Transmitter mode, this product has USB+AUX dual input function. If it is used on a computer, it does not need to be inserted audio cable, plug directly into USB)
3. Turn on the Bluetooth headset / stereo etc, and enter the pairing status.
4. Wait a moment, the automatic connection is successful, and the LED is always on.
5. Open the TV or computer APP music player software. Music can be played through Bluetooth headset.

Receive Mode (For normal audio / car / wired headset, etc.)

1. Plug the adapter into the USB power supply.
2. Plug one end of the audio cable into the RECEIVE port of the adapter and the other end into the audio input interface (INPUT) of the audio device.
3. Open the Bluetooth function of your phone or tablet, search: TR6 Click to pair.
4. After the pairing is completed the red LED is always on.
5. Open the mobile APP music player software, mobile music can be played through the speaker.

Version: BT5.0+EDR/ 8-10 Meter Distance AD2P supports music transmission/reception

CUSTOMER SUPPORT

North America

support@jimtab.com

United Kingdom

support.uk@jimtab.com

Deutschland

support.de@jimtab.com

France

support.fr@jimtab.com

España

support.es@jimtab.com

Italia

support.it@jimtab.com

日本

support.jp@jimtab.com

Website

www.jimtab.com



@ijimtab



Documents / Resources

