



JIECANG JCHR35W5C2/C3 Remote Controller User Manual

[Home](#) » [JIECANG](#) » JIECANG JCHR35W5C2/C3 Remote Controller User Manual 

Contents

- [1 JCHR35W5C2/C3 Remote Controller](#)
- [2 Product Information](#)
- [3 Product Usage Instructions](#)
- [4 Product Info](#)
- [5 Models & Parameters](#)
- [6 Instructions](#)
- [7 Documents / Resources](#)
- [8 Related Posts](#)



JCHR35W5C2/C3 Remote Controller

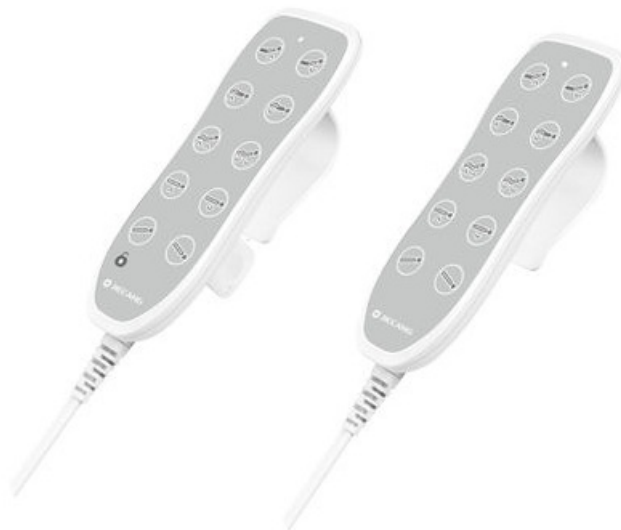

Product Information

The JCHR35W5C2/C3 Remote Controller is a 16-channel LCD remote controller used for controlling motorized shades. The remote controller has two models, JCHR35W5C2 and JCHR35W5C3, both of which have the same number of channels and LCD display. The remote controller features three favorite positions, where the user can save their preferred shade positions at 25%, 50%, and 75%.

Models & Parameters

The specific parameters for each model can be found on the nameplate of the product.

Caution!

The transmitter should not be exposed to moisture or impact, so as not to affect its life. 2. During use, when the remote control distance is significantly shorter or less sensitive, please check whether the battery needs to be replaced. 3. When the battery voltage is too low, the LED screen will show a low voltage prompt, prompting to replace the battery. 4. Please properly dispose of used batteries according to the local garbage classification and recycling policy.

Product Usage Instructions

Channels & Groups Toggling

Note: Channel 0 is the group control for all the channels.

Number of Channels Setting

To set the number of channels, refer to the instructions for each model.

Number of Groups Setting

To set the number of groups, refer to the instructions for each model.

Channel in Group Setting

To add or remove a channel from a group, short press the button corresponding to that channel. If the channel number is steady-lit, it is part of the group. If the channel number is flashing, it is not part of the group.

Check the Channels in Groups

Refer to the instructions for each model to check which channels are in a group.

Prohibit Dual-key Operation

To prohibit dual-key operation, refer to the instructions for each model.

Position Percent Setting

To set the shade position percentage, stop the shade at the desired percentage and wait 3 seconds. The shade will move to the chosen percentage position.

Special operation on remote controller JCHR35W5C3:

- CH+ & Up: Upper limit set
- CH+ & Down: Lower limit set
- CH+ & Stop: Favorite position set
- Press the CH+ button for 2 seconds to fast get to the favorite position

For all other operations, refer to the motor operation instruction manual.

Product Info

front view

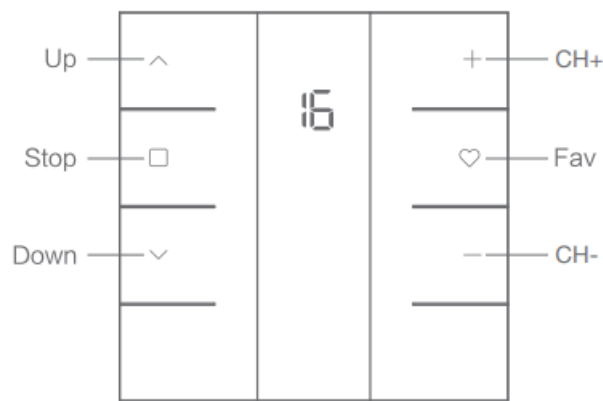

JCHR35W5C2
16-channel LCD remote controller

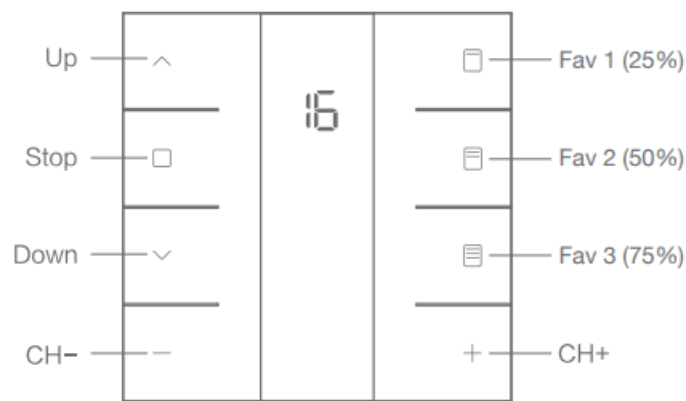

JCHR35W5C3
16-channel LCD remote controller

Back view

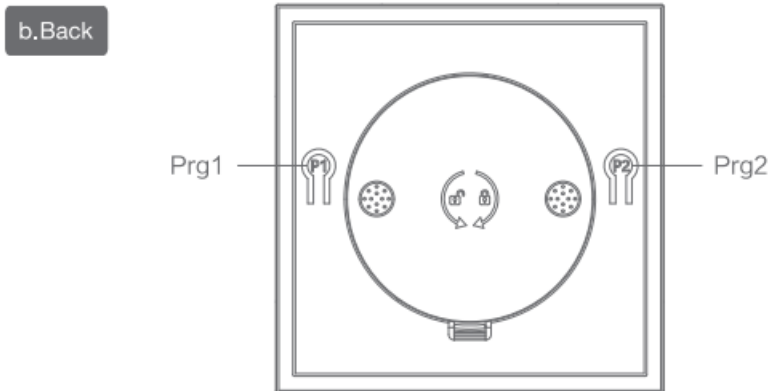

JCHR35W5C2/C3

Models & Parameters

(more info please refer to the nameplate)

Electrical Specification	Standard
Battery Type	CR2430*3V*2
Working Temperature	-10℃-50℃
Radio Frequency	433.92M ± 100KHz
Transmit Distance	>=30m indoor

Caution!

1. The transmitter should not be exposed to moisture or impact, so as not to affect its life
2. During use, when the remote control distance is significantly shorter or less sensitive, please check whether the battery needs to be replaced.
3. When the battery voltage is too low, the LED screen will show a low voltage prompt, prompting to replace the battery. 
4. Please properly dispose of used batteries according to the local garbage classification and recycling policy.

Instructions

Channels & Groups Toggling

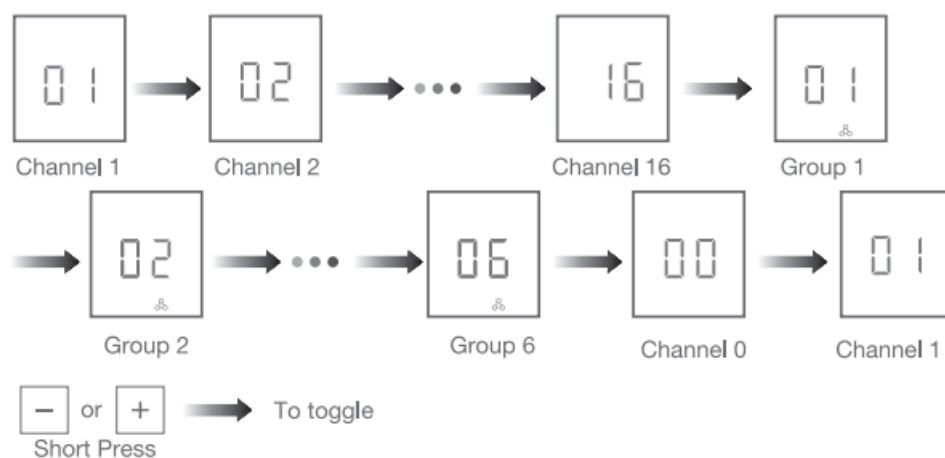

Note Channel 0 is the group control for all the channels.

Number of Channels Setting

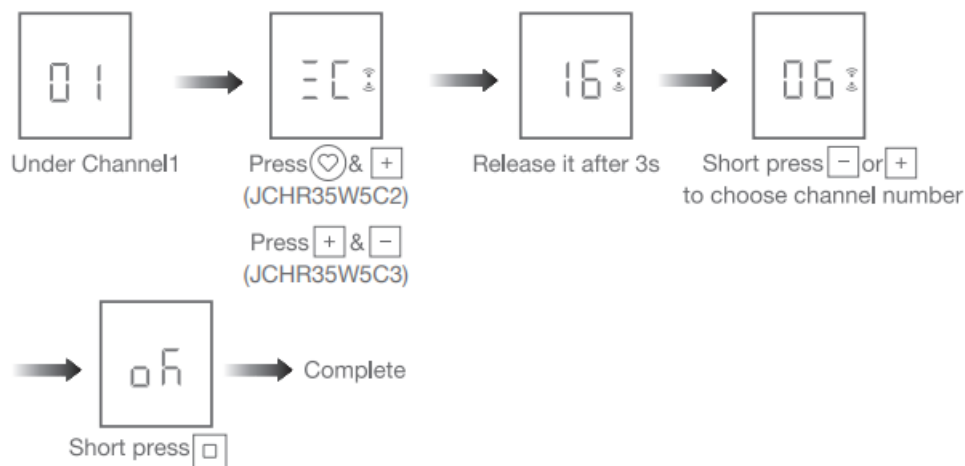

Note: Max&Min number is 16&1 when it's set under channel 1-16.

Number of Groups Setting

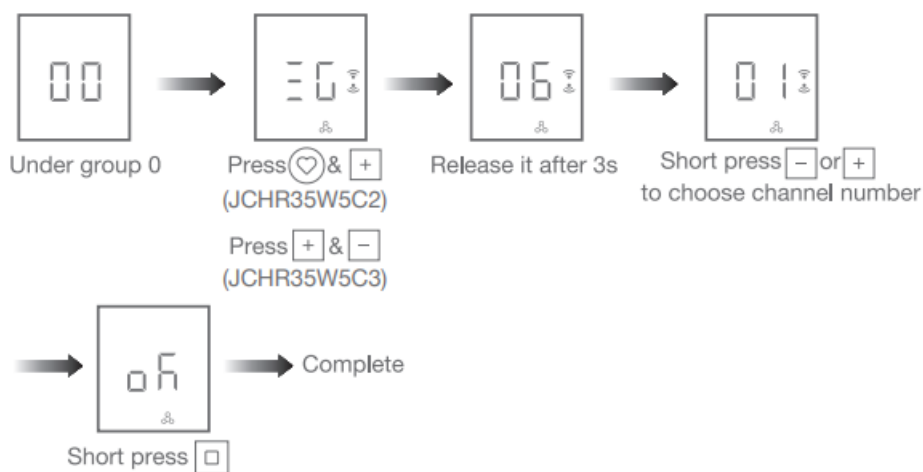

Note: Max&Min number is 6&0 when it's set under channel 0.

Channel in Group Setting

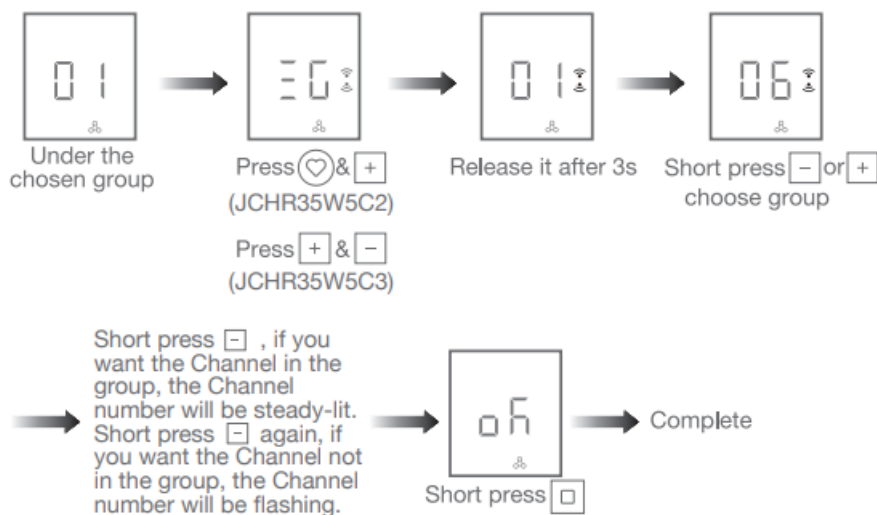

Note: Channel in groups setting is under GROUP 1-6.

Note: Channel in groups setting is under GROUP 1-6.

Check the Channels in Groups



Note: LCD will show “EC” if there is no detailed channel.

Prohibit Dual-key Operation



Repeat the above, dual-key operation activated

Note: When dual-key operation prohibited, these programming setting functions are not allowed, such as limits setting.

Position Percent Setting

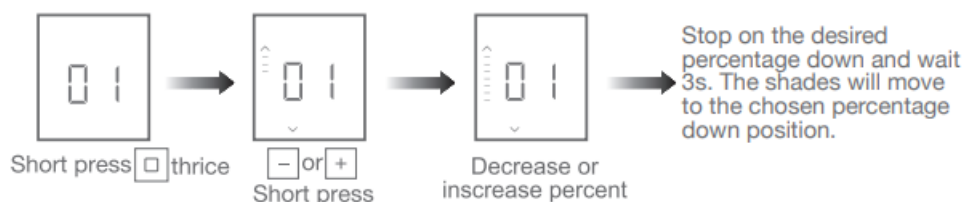

Note: All the shades under same group will run to same position after percent setting.

Special operation on remote controller JCHR35W5C3:

1. CH+ & Up: Upper limit set
 2. CH+ & Down: Lower limit set
 3. CH+ & Stop: Favorite position set
 4. Press the “CH+” button for 2s to fast get to the Fav. point
- i. For other operations, please refer to the motor operation instruction

Documents / Resources

	<p>JIECANG JCHR35W5C2/C3 Remote Controller [pdf] User Manual</p> <p>JCHR35W5C2, JCHR35W5C3, JCHR35W5C2 C3 Remote Controller, JCHR35W5C2 Remote Controller, JCHR35W5C3 Remote Controller, Remote Controller, Remote</p>
--	---