



# JIECANG JCHR35W5C2 Remote Controller User Manual

[Home](#) » [JIECANG](#) » JIECANG JCHR35W5C2 Remote Controller User Manual 

## Contents

- [1 JCHR35W5C2 Remote Controller](#)
- [2 Product Information](#)
- [3 Product Usage Instructions](#)
- [4 Product Info](#)
- [5 Instructions](#)
- [6 Documents / Resources](#)
- [7 Related Posts](#)



# JIECANG

**JCHR35W5C2 Remote Controller**

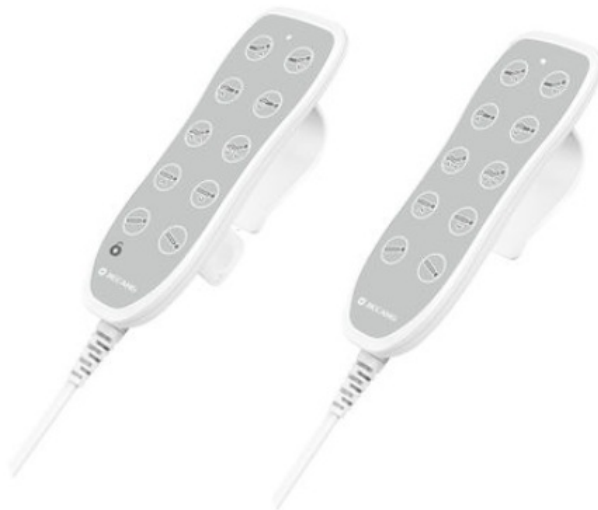

## Product Information

The JCHR35W5C2/C3 Remote Controller is a 16-channel LCD remote controller designed for controlling motorized shades. The remote controller comes in two models – JCHR35W5C2 and JCHR35W5C3. The JCHR35W5C2/C3 remote controller supports channel and group control, position percent setting, and special operations on the JCHR35W5C3 model.

The remote controller has a low voltage prompt feature that indicates when the battery needs to be replaced. It is important to dispose of used batteries properly according to local garbage classification and recycling policy.

## Product Usage Instructions

**Caution:** Do not expose the transmitter to moisture or impact during use.

### Channels & Groups Toggling

**Note:** Channel 0 is the group control for all the channels.

### Number of Channels Setting

- JCHR35W5C2:
- JCHR35W5C3:

### Number of Groups Setting

- JCHR35W5C2:
- JCHR35W5C3:

### Channel in Group Setting

- JCHR35W5C2: Short press , if you want the Channel in the group, the Channel number will be steady-lit. Short press again, if you want the Channel not in the group, the Channel number will be flashing.
- JCHR35W5C3: Short press , if you want the Channel in the group, the Channel number will be steady-lit. Short press again, if you want the Channel not in the group, the Channel number will be flashing.

## Check the Channels in Groups

- JCHR35W5C2: pattern
- JCHR35W5C3: pattern

## Prohibit Dual-key Operation

LCD shown a lock icon such as limits setting.

## Position Percent Setting

Stop on the desired percentage down and wait 3s. The shades will move to the chosen percentage down position.

## Special operation on remote controller JCHR35W5C3:

- CH+ & Up: Upper limit set
- CH+ & Down: Lower limit set
- CH+ & Stop: Favorite position set
- Press the CH+ button for 2s to fast get to the Fav. point

For other operations, please refer to the motor operation instruction..

## Product Info

Front



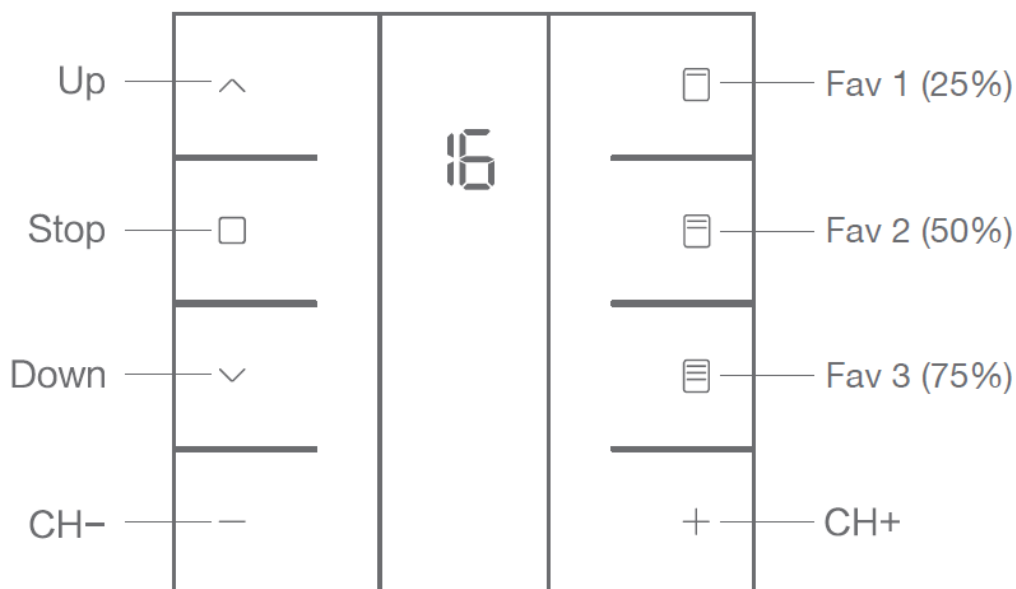

**Back**

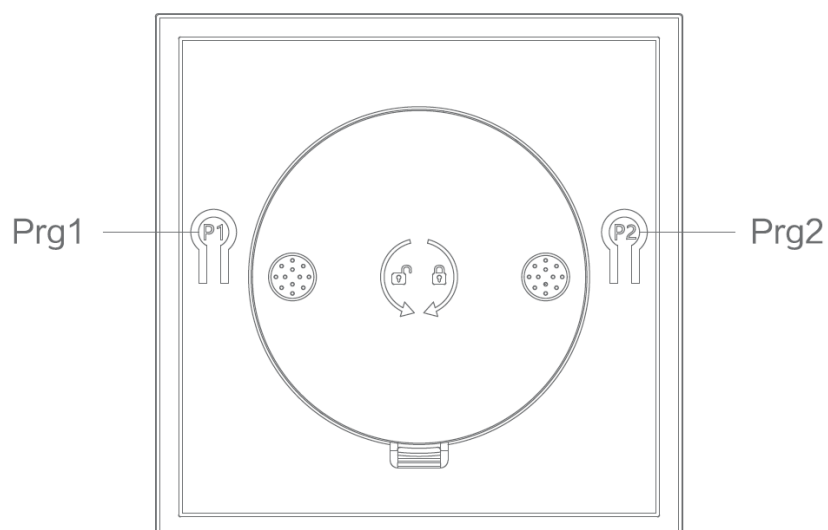

### Models & Parameters

(more info please refer to the nameplate)

Electrical Specification	Standard
Battery Type	CR2430*3V*2
Working Temperature	-10℃-50℃
Radio Frequency	433.92M ± 100KHz
Transmit Distance	>=30m indoor

### Caution!

1. The transmitter should not be exposed to moisture or impact, so as not to affect its life
2. During use, when the remote control distance is significantly shorter or less sensitive, please check whether the battery needs to be replaced.
3. When the battery voltage is too low, the LED screen will show a low voltage prompt, indicating to replace the

battery. 

4. Please properly dispose of used batteries according to the local garbage classification and recycling policy.

## Instructions

### Channels & Groups Toggling

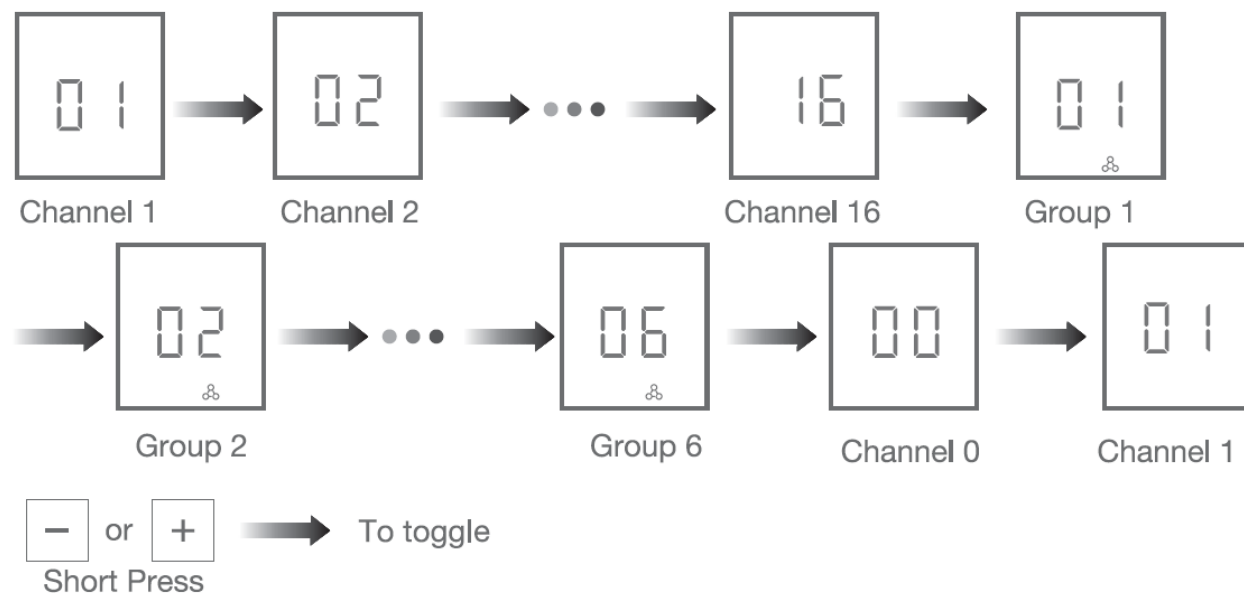

**Note:** Channel 0 is the group control for all the channels.

### Number of Channels Setting

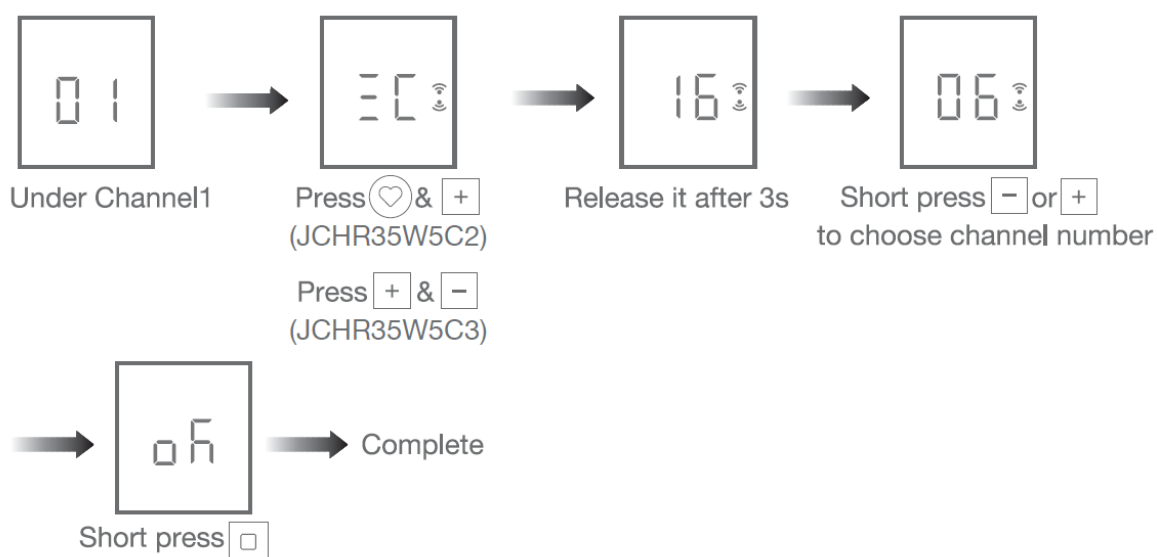

**Note:** Max&Min number is 680 when it's set under channel 0.

### Number of Groups Setting

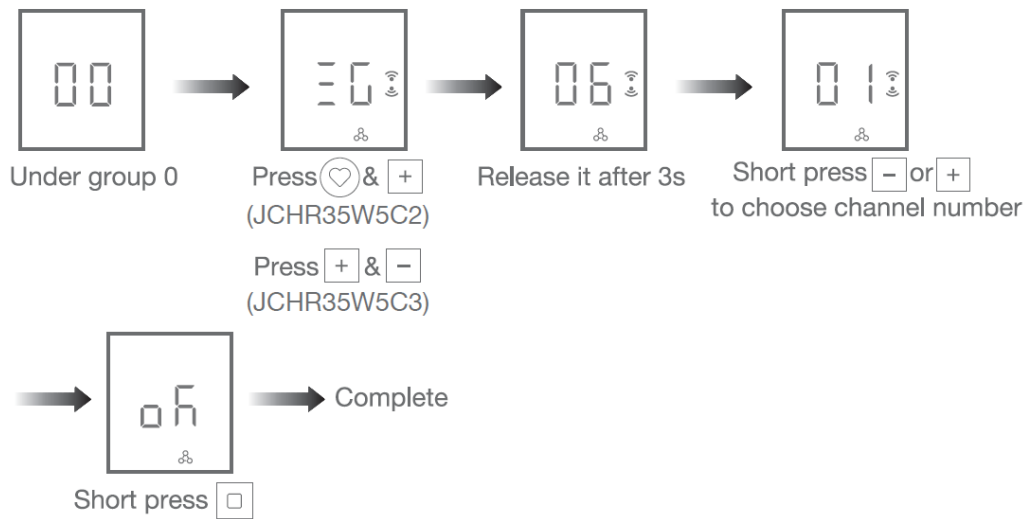

**Note:** Max&Min number is 16&1 when it's set under channel 1-16.

### Channel in Group Setting

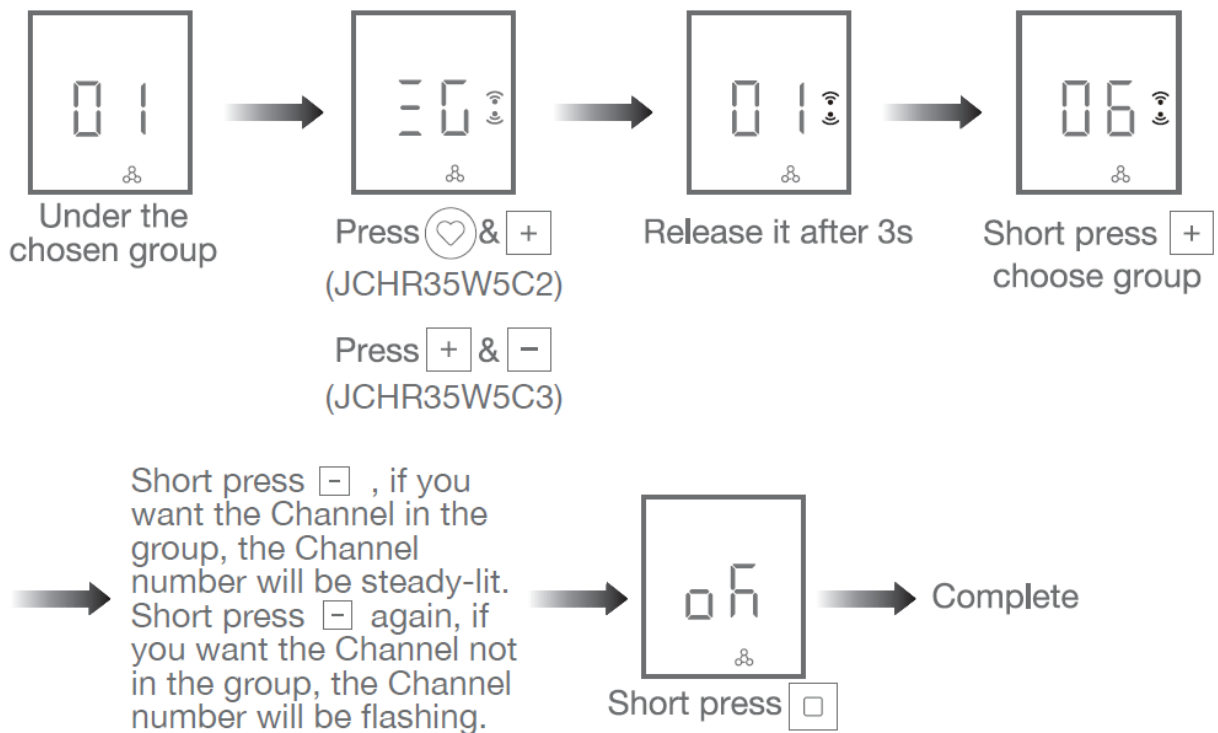

**Note:** Channel in groups setting is under GROUP 1-6.

### Check the Channels in Groups

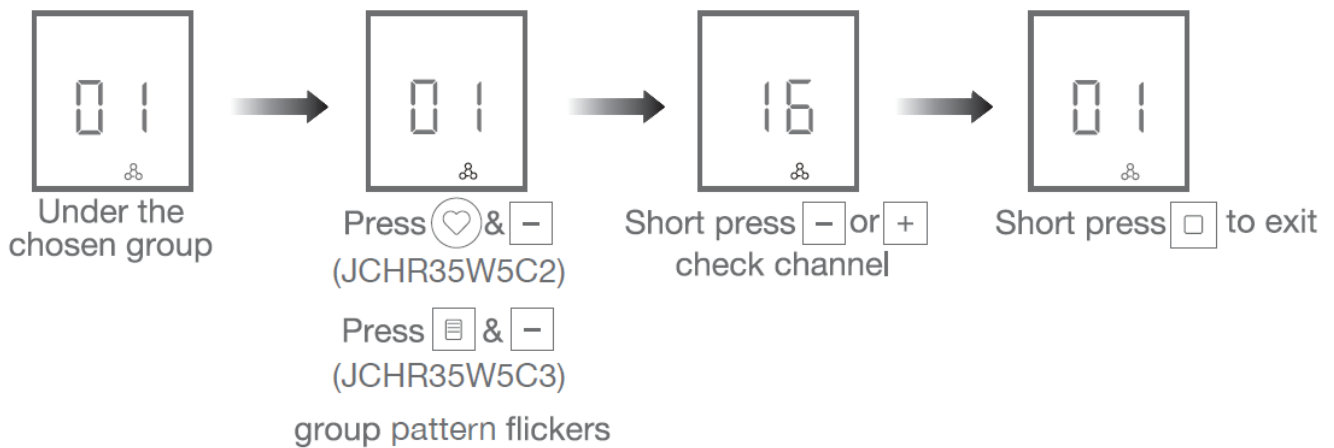

**Note:** LCD will show “EC” if there is no detailed channel.

### Prohibit Dual-key Operation



Prgx10s LCD shown a lock icon

- Repeat the above, dual-key operation activated

**Note:** When dual-key operation prohibited, these programming setting functions are not allowed, such as limits setting.

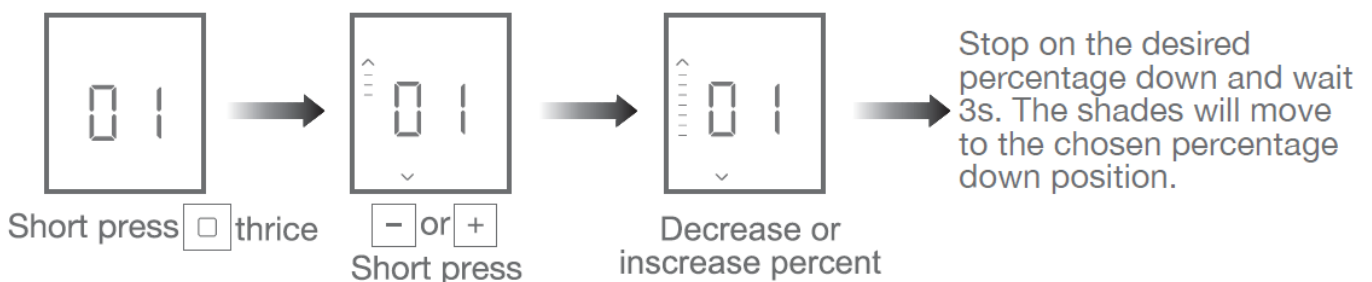

**Note:** All the shades under same group will run to same position after percent setting.

### Position Percent Setting

#### Special operation on remote controller JCHR35W5C3:

- CH+ & Up: Upper limit set
- CH+ & Down: Lower limit set
- CH+ & Stop: Favorite position set
- Press the “CH+” button for 2s to fast get to the Fav. point

For other operations, please refer to the motor operation instruction

### Documents / Resources

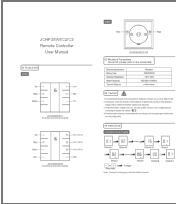
The thumbnail shows the cover of the user manual for the JIECANG JCHR35W5C2 Remote Controller. It includes the product name, model number, and a small image of the remote controller itself. There are also some technical specifications and a warning symbol visible on the cover.

# [JIECANG JCHR35W5C2 Remote Controller](#) [pdf] User Manual

JCHR35W5C2, JCHR35W5C3, JCHR35W5C2 Remote Controller, Remote Controller