



JIECANG JCHR35W5A8 Remote Controller User Manual

[Home](#) » [JIECANG](#) » JIECANG JCHR35W5A8 Remote Controller User Manual 

Contents

- [1 JIECANG JCHR35W5A8 Remote Controller](#)
- [2 Product Information](#)
- [3 Product Usage Instructions](#)
- [4 Product Info](#)
- [5 Models & Parameters](#)
- [6 Caution](#)
- [7 Instructions](#)
- [8 Documents / Resources](#)
- [9 Related Posts](#)



JIECANG JCHR35W5A8 Remote Controller



Product Information

The JCHR35W5A8/A9/C4 Remote Controller is a product used to control shades or blinds. It comes in three models: a single-channel remote controller, a 6-channel remote controller, and a 16-channel remote controller. The remote controller can tilt shades or blinds up and down.

Product Usage Instructions

1. **Caution!** The transmitter should not be exposed to moisture or impact, so as not to affect its life.
2. If the remote control distance is significantly shorter or less sensitive during use, check whether the battery needs to be replaced.
3. If the battery voltage is too low, the JCHR35W5A8 and JCHR35W5A9 models will have an orange LED flicker when a button is pressed, while the JCHR35W5C4 model will show a low voltage pattern on the LCD screen indicating that the battery needs to be replaced.
4. Properly dispose of used batteries according to the local garbage classification and recycling policy.
5. To toggle channels and groups for the JCHR35W5C4 model, follow these steps:
 1. Short press the button to set the number of channels. If you want the channel in the group, the channel number will be steady-lit. Short press again, if you want the channel not in the group, the channel number will be flashing.
 2. To check the channels in groups, look for the icon on the LCD screen.
 3. To prohibit dual-key operation, press the lock icon on the LCD screen.
 4. To set the position percentage for the JCHR35W5C4 model, stop on the desired percentage down and wait for 3 seconds. The shades will move to the chosen percentage down position.
6. For other operations, refer to the motor operation instruction.

JCHR35W5A8/A9/C4 Remote Controller

Product Info

a.Front

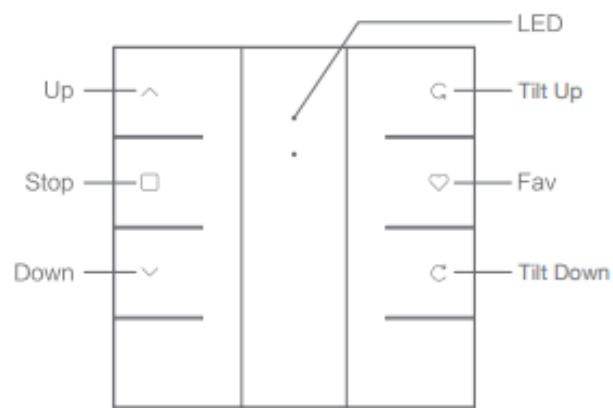

JCHR35W5A8
Single channel remote controller

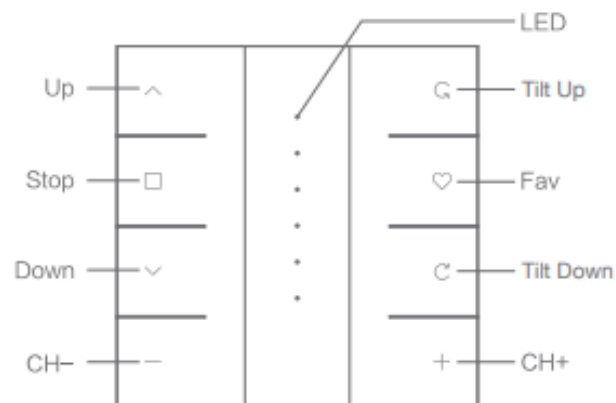

JCHR35W5A9
6-channel remote controller

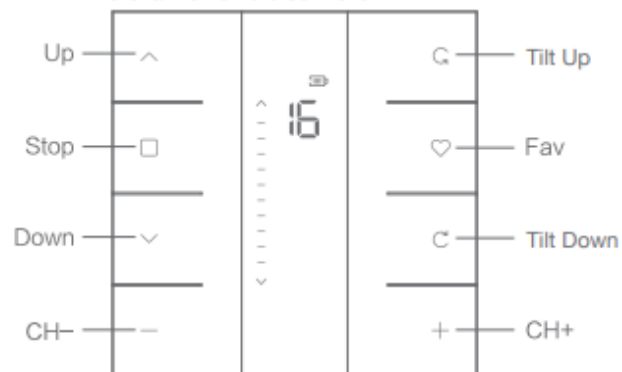

JCHR35W5C4
16-channel remote controller

b.Back

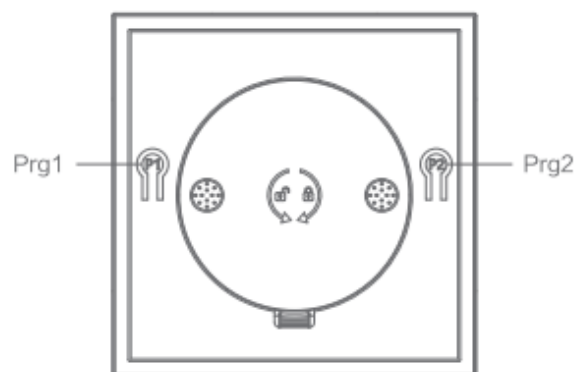

JCHR35W5A8/A9/C4

Models & Parameters

(more info please refer to the nameplate)

Electrical Specification	Standard
Battery Type	CR2430*3V*2
Working Temperature	-10℃-50℃
Radio Frequency	433.92M ± 100KHz
Transmit Distance	>=30m indoor

Caution

- 1. The transmitter should not be exposed to moisture or impact, so as not to affect its life
- 2. During use, when the remote control distance is significantly shorter or less sensitive, please check whether the battery needs to be replaced.
- 3. When the battery voltage is too low, JCHR35W5A8,JCHR35W5Ag orange LED flickers when you press button, while JCHR35W5C4 LCD screen will show a low voltage pattern “” indicating to replace battery.
- 4. Please properly dispose of used batteries according to the local garbage classification and recycling policy.

Instructions

Channels & Groups Toggling

(only apply to JCHR35W5C4)

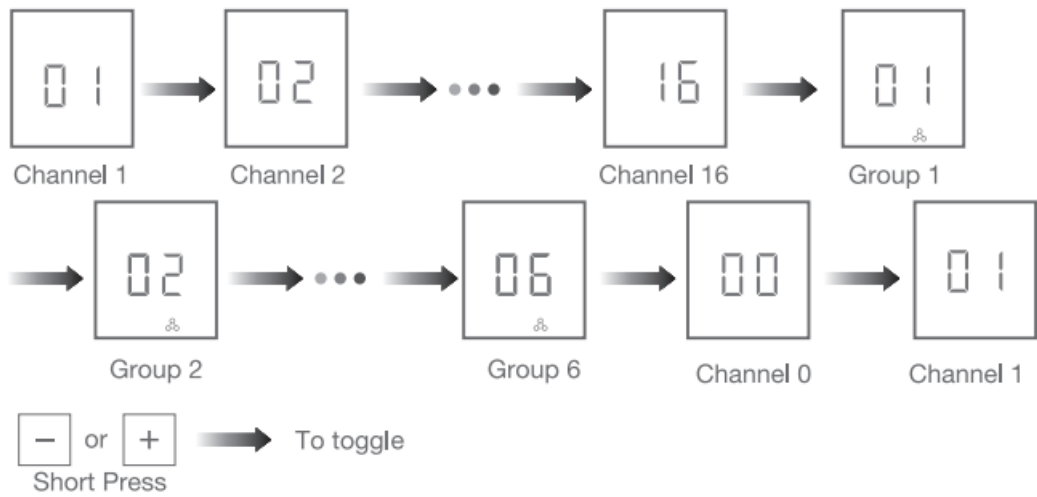

NOTE

Channel 0 is the group control for all the channels.

Number of Channels Setting for JCHR35W5C4



Note: Max&Min number is 16&1 when it's set under channel 1-16

Number of Channels Setting for JCHR35W5A9

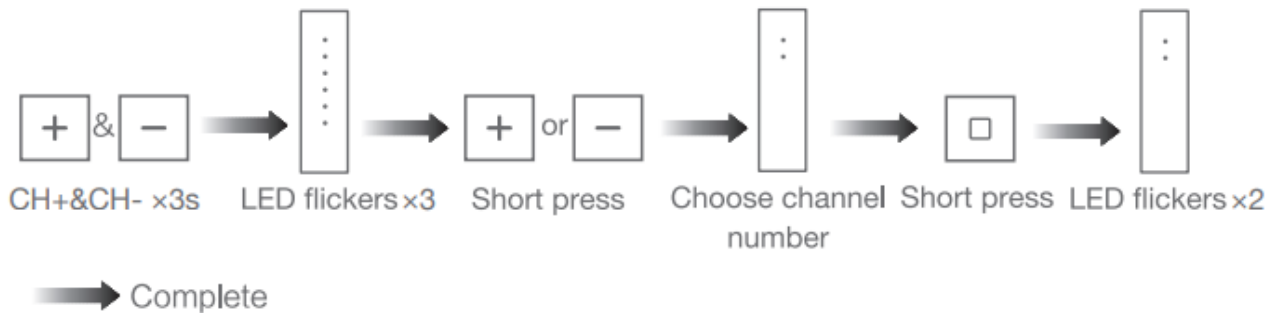

Note: When all LEDs are lit, that is channel O (All channels move together).

Number of Groups Setting

(only apply to JCHR35W5C4)



Note: Max&Min number is 6&0 when it's set under channel 0.

Channel in Group Setting

(only apply to JCHR35W5C4)

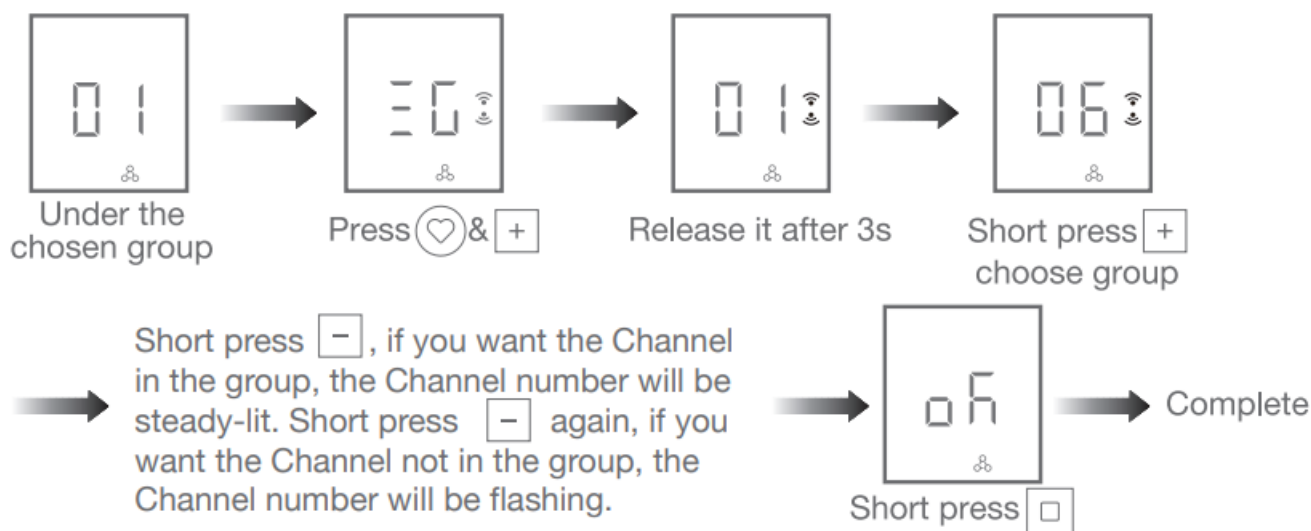

Note: Channel in groups setting is under GROUP 1-6.

Check the Channels in Groups

(only apply to JCHR35W5C4)

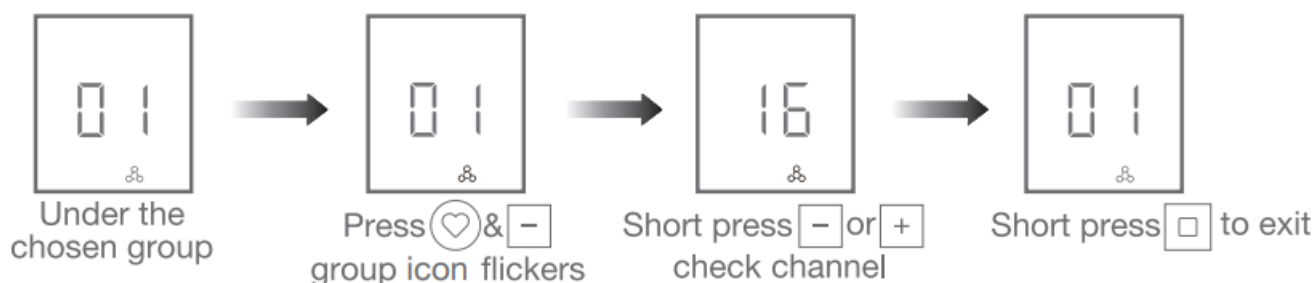

Note: LCD will show "EC" if there is no detailed channel.

Prohibit Dual-key Operation

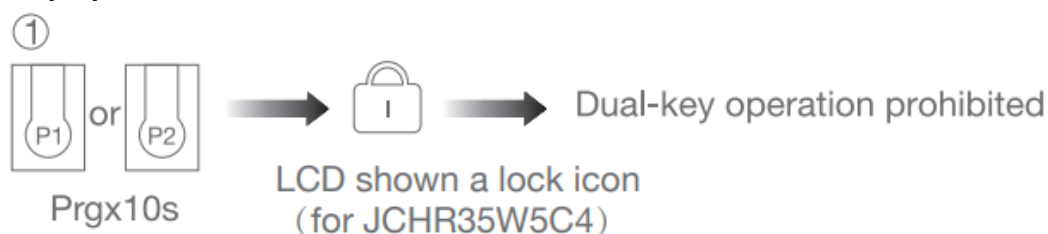

Repeat the above, dual-key operation activated

Note: When dual-key operation prohibited, these programming setting functions are not allowed, such as limits setting.

Position Percent Setting

(only apply to JCHR35W5C4)

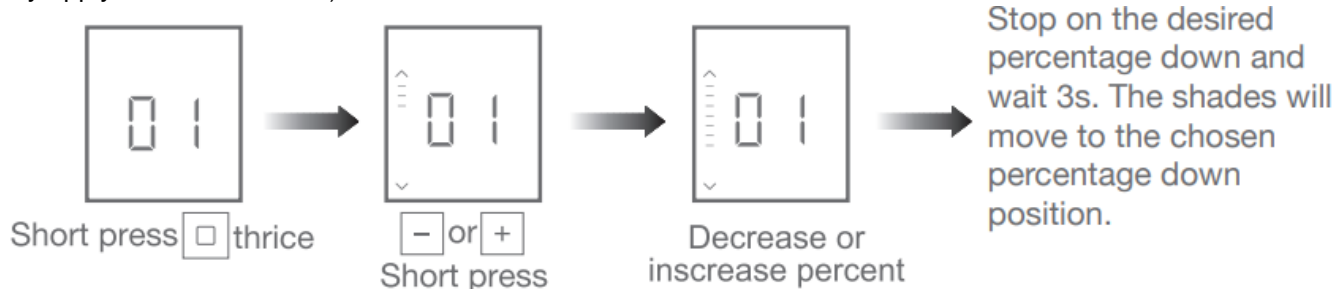

Note: All the shades under same group will run to same position after percent setting. For other operations, please refer to the motor operation instruction

Documents / Resources

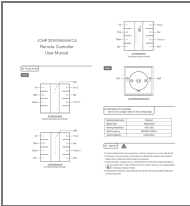
	<p>JIECANG JCHR35W5A8 Remote Controller [pdf] User Manual</p> <p>JCHR35W5A8, JCHR35W5A9, JCHR35W5C4, JCHR35W5A8 A9 C4 Remote Controller, JCHR35W5A8 Remote Controller, JCHR35W5A9 Remote Controller, JCHR35W5C4 Remote Controller, Remote Controller</p>
---	---

[Manuals+](#)