



JIECANG JCHR35W3C3 Hand-held LCD Remote Controller User Manual

[Home](#) » [JIECANG](#) » JIECANG JCHR35W3C3 Hand-held LCD Remote Controller User Manual 



JIECANG

JCHR35W3C3/C4/C5
Hand-held LCD Remote Controller
User Manual

Contents

- [1 Product Info](#)
- [2 Parameters\(more info please refer to the nameplate\)](#)
- [3 Instructions](#)
- [4 Documents / Resources](#)

Product Info

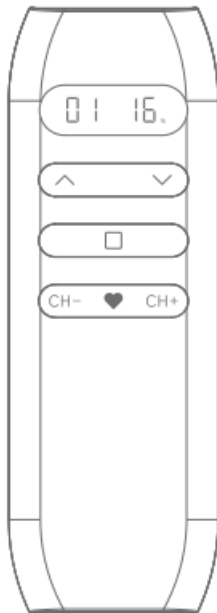

JCHR35W3C3
Application:Roller shade

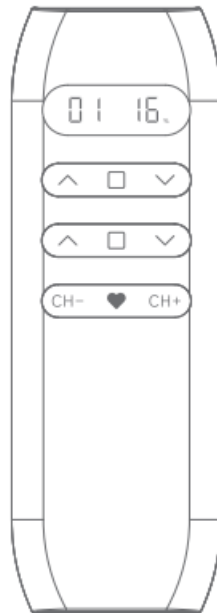

JCHR35W3C4
Application:Roller shade

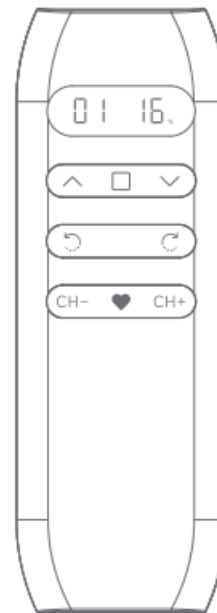

JCHR35W3C5
Application:Venetian blind

Buttons

a. Front

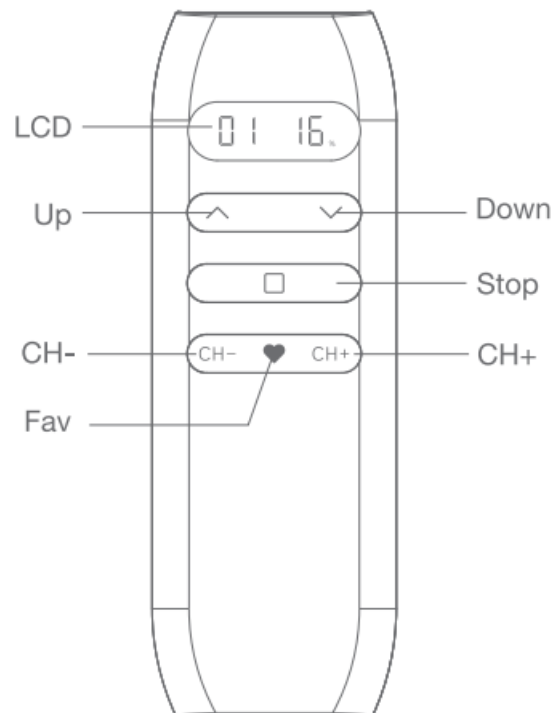

JCHR35W3C3
16-channel LCD
remote controller

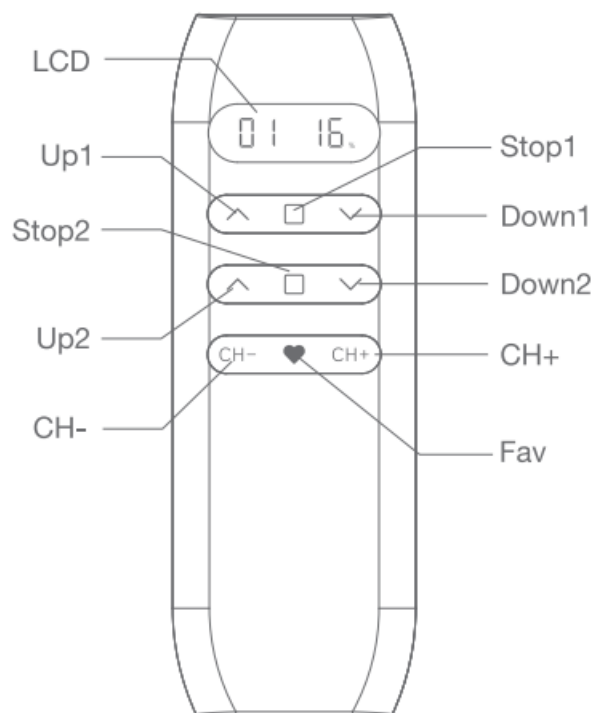

JCHR35W3C4
16-channel dual control LCD
remote controller

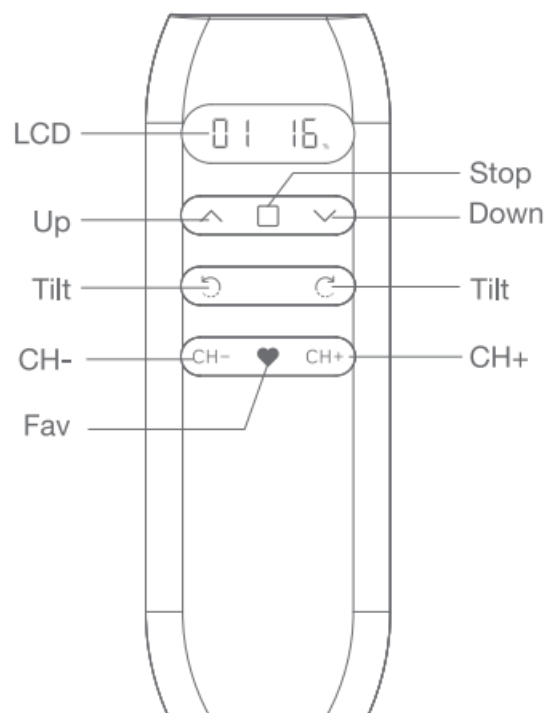

JCHR35W3C5
16-channel LCD
remote controller

b. Back

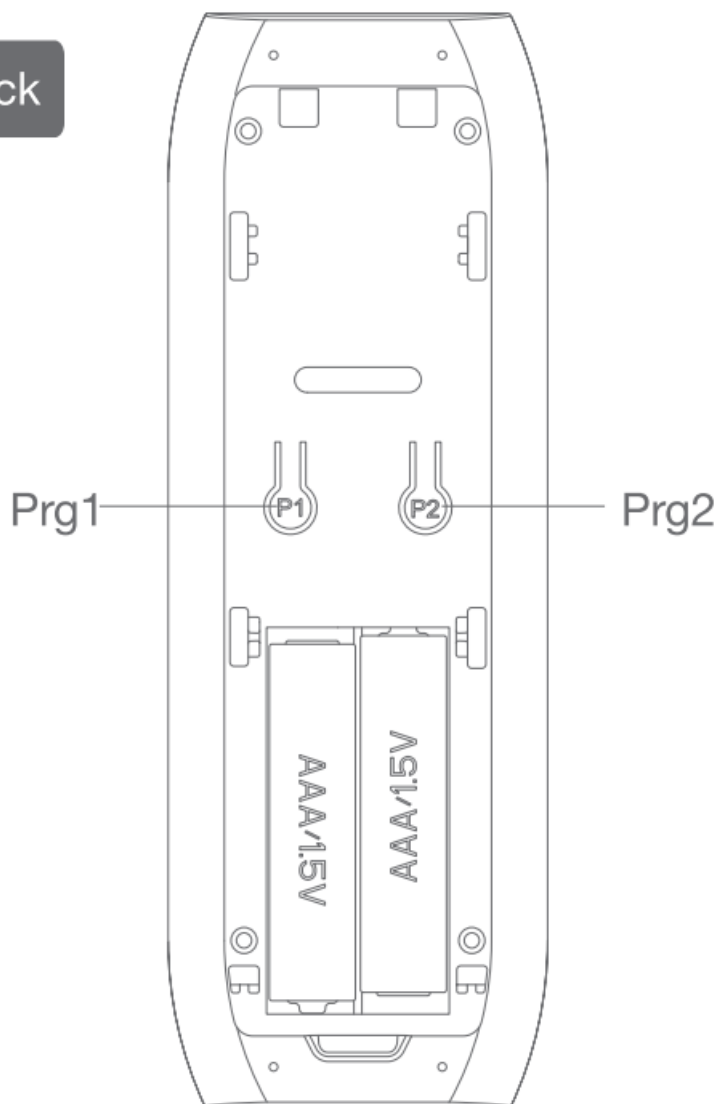

Parameters(more info please refer to the nameplate)

Electrical Specification	Standard
Battery Type	AM battery*2
Working Temperature	-10t-50t
Radio Frequency	433.92M±100KHz
Transmit Distance	>=30m indoor

Caution!

1. The transmitter should not be exposed to moisture or impact, so as not to affect its life
2. During use, when the remote control distance is significantly shorter or less sensitive, please check whether the battery needs to be replaced.
3. When the voltage is too low, the LCD screen digital display will be weak, prompting to replace the battery.
4. Please properly dispose of used batteries according to the local garbage classification and recycling policy.

Instructions

a. Channels & Groups Toggling

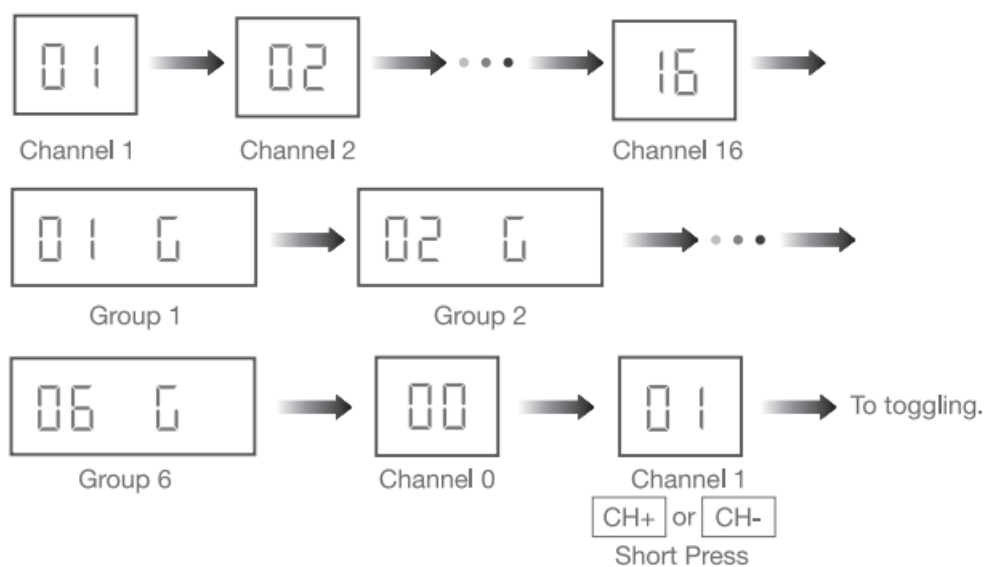

Note: Channel 0 is the group control for all the channels.

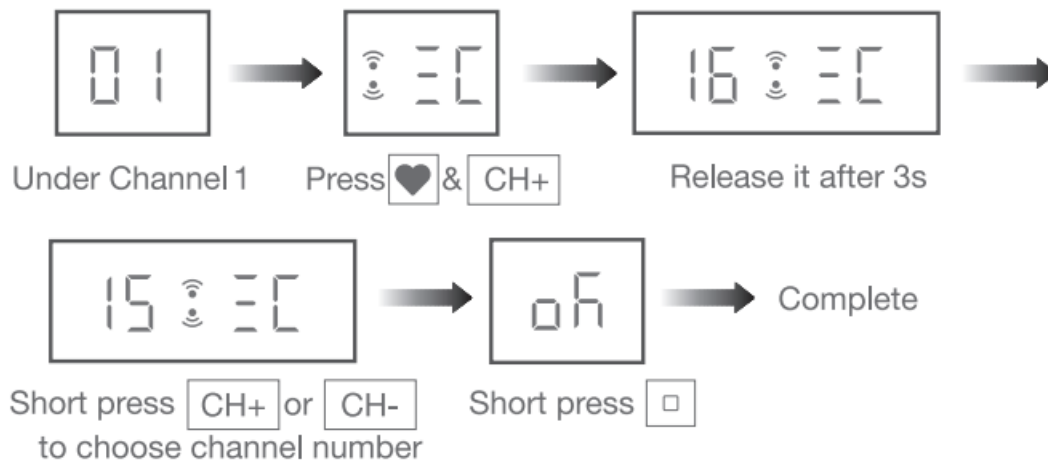

Note: Max & Min number is 16&1 when it's set under channel 1-16

c. Number of Groups Setting

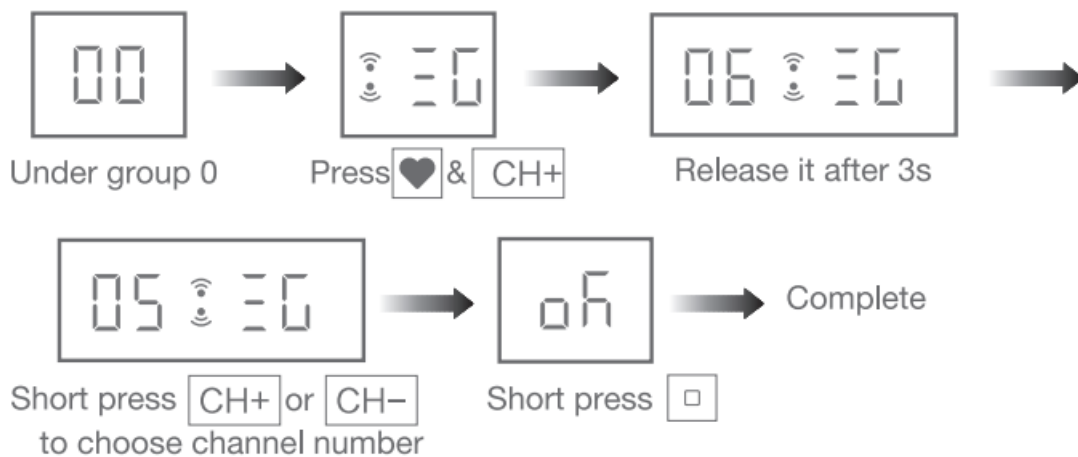

Note: Max & Min number is 6&0 when it's set under channel 0.

d. Channel in Group Setting

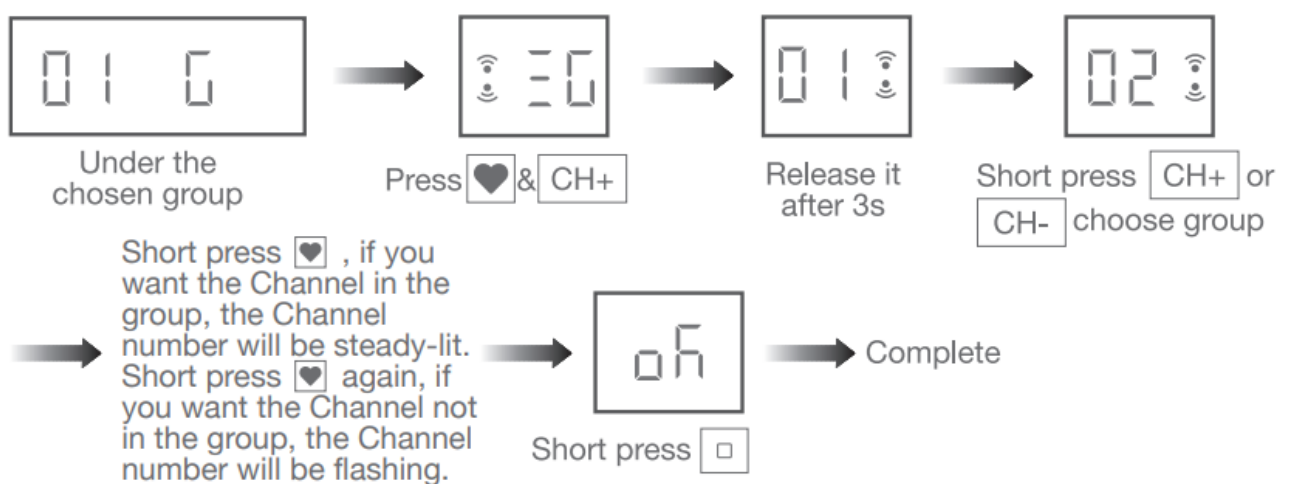

Note: Channel in groups setting is under GROUP 1-6.

e. Check the Channels in Groups

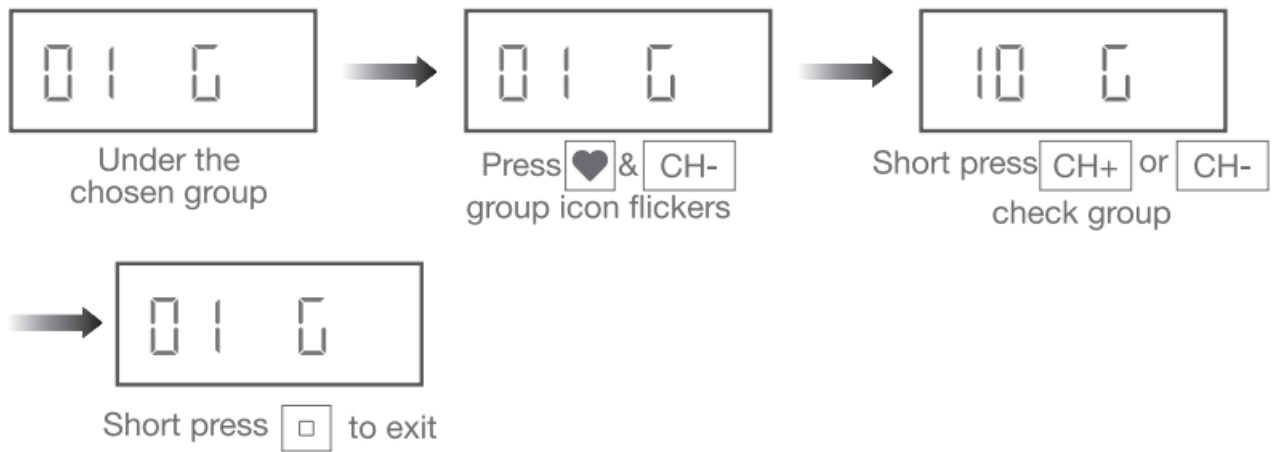

f. Prohibit Dual-key Operation

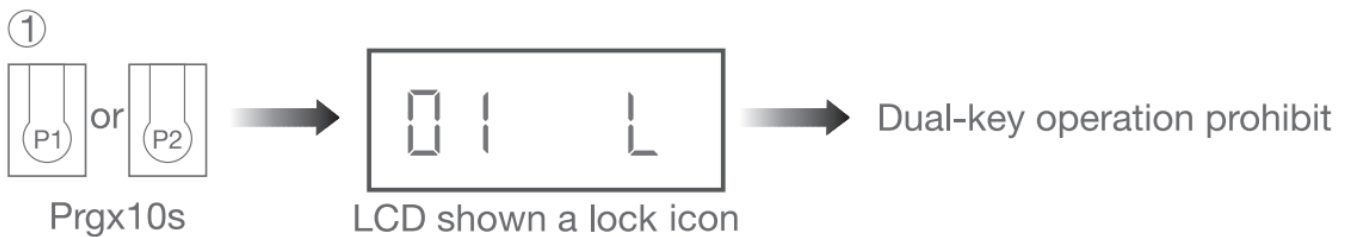

Repeat the above, dual-key operation activated

Note: When dual-key operation prohibited, these programming setting functions are not allowed.

g. Position Percent Setting

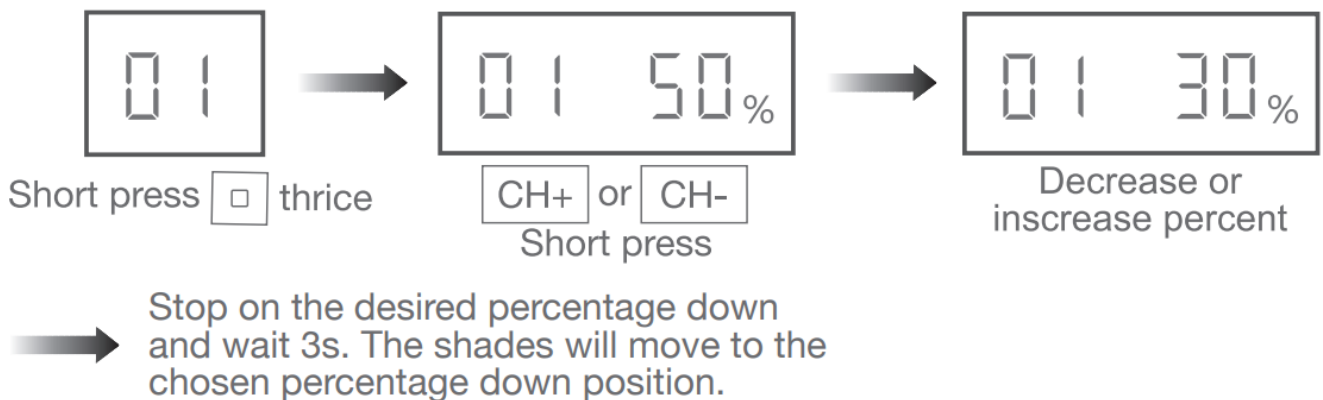

Note: All the shades under same group will run to same position after percent setting.

h. For other operations, please refer to the motor operation instruction



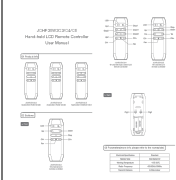

[JIECANG JCHR35W3C3 Hand-held LCD Remote Controller](#) [pdf] User Manual
JCHR35W3C3, JCHR35W3C4, JCHR35W3C5, JCHR35W3C3 Hand-held LCD Remote Controller, JCHR35W3C3, Hand-held LCD Remote Controller, LCD Remote Controller, Remote Controller, Controller