



JIECANG JCHR35W3C1 Hand-Held LCD Remote Controller User Manual

[Home](#) » [JIECANG](#) » JIECANG JCHR35W3C1 Hand-Held LCD Remote Controller User Manual 

Contents

- [1 JIECANG JCHR35W3C1 Hand-Held LCD Remote Controller](#)
- [2 Product Information](#)
- [3 Instructions](#)
- [4 Buttons](#)
- [5 Parameters\(For more info please refer to the nameplate\)](#)
- [6 Caution](#)
- [7 Documents / Resources](#)
- [8 Related Posts](#)



JIECANG JCHR35W3C1 Hand-Held LCD Remote Controller



Product Information

The JCHR35W3C1/C2 Hand-held LCD Remote Controller is a remote control device used to operate motorized shades. It is available in two models: JCH35W3C1 16-channel LCD remote controller and JCH35W3C2 16-channel dual control LCD remote controller.

- **Parameters**

For more information about the product parameters, please refer to the nameplate.

- **Buttons**

The JCHR35W3C1/C2 Hand-held LCD Remote Controller has various buttons for different operations. Please refer to the user manual for more information.

- **Caution!**

If the voltage is too low, the LCD screen digital display will be weak, prompting you to replace the battery.

Instructions

1. **Channels & Groups Toggling:** Channel 0 is the group control for all the channels.
2. **Number of Channels Setting:** Please refer to the user manual for more information.
3. **Number of Groups Setting:** Please refer to the user manual for more information.
4. **Channel in Group Setting:** Short press, if you want the Channel in the group, the Channel number will be steady-lit. Short press again, if you want the Channel not in the group, the Channel number will be flashing.
5. **Check the Channels in Groups:** Please refer to the user manual for more information.
6. **Prohibit Dual-key Operation:** Please refer to the user manual for more information.
7. **Position Percent Setting:** Stop on the desired percentage down and wait for 3s. The shades will move to the chosen percentage down position.
8. **Other Operations:** Please refer to the motor operation instruction.

It is important to follow the instructions carefully to ensure proper usage of the JCHR35W3C1/C2 Hand-held LCD Remote Controller.

Product Info

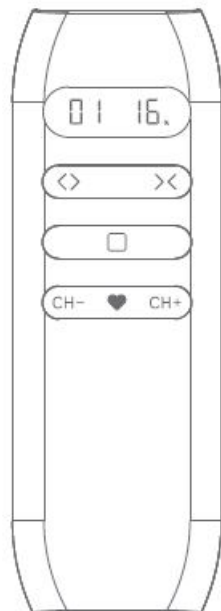

JCH35W3C1
16-channel LCD
remote controller

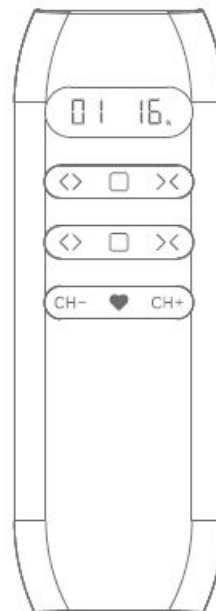

JCH35W3C2
16-channel dual control LCD
remote controller

Buttons

- Front

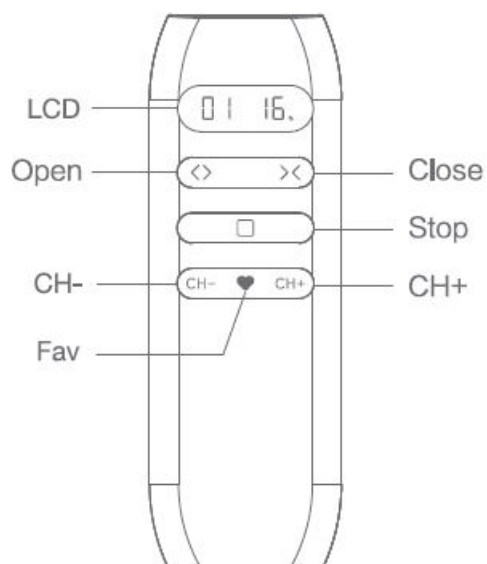

JCH35W3C1
16-channel LCD
remote controller

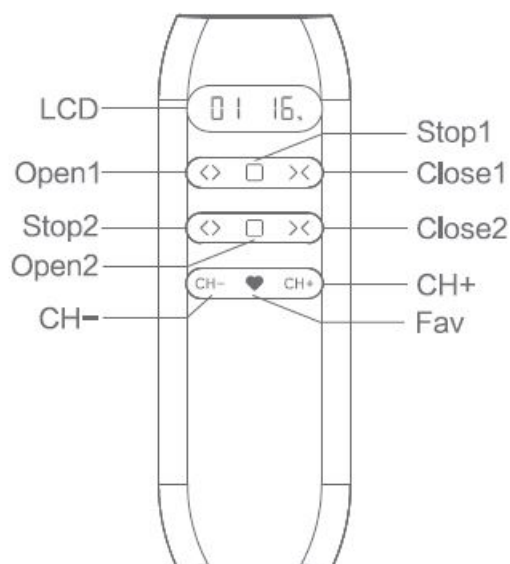

JCH35W3C2
16-channel dual control LCD
remote controller

• Back

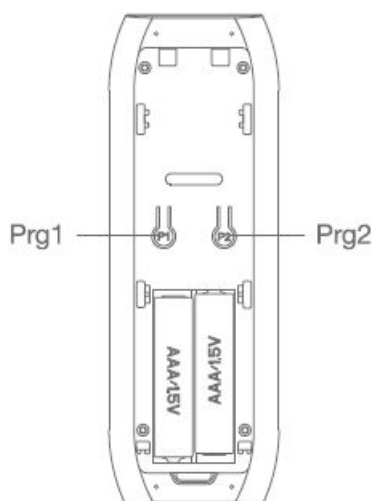

Parameters(For more info please refer to the nameplate)

Electrical Specification	Standard
Battery Type	AAA battery*2
Working Temperature	-10℃-50℃
Radio Frequency	433.92M±100KHz
Transmit Distance	>=30m indoor

Caution

1. The transmitter should not be exposed to moisture or impact, so as not to affect its life
2. During use, when the remote control distance is significantly shorter or less sensitive, please check whether the battery needs to be replaced.
3. When the voltage is too low, the LCD screen digital display will be weak, prompting to replace the battery.

4. Please properly dispose of used batteries according to the local garbage classification and recycling policy.

Instructions

• Channels & Groups Toggling

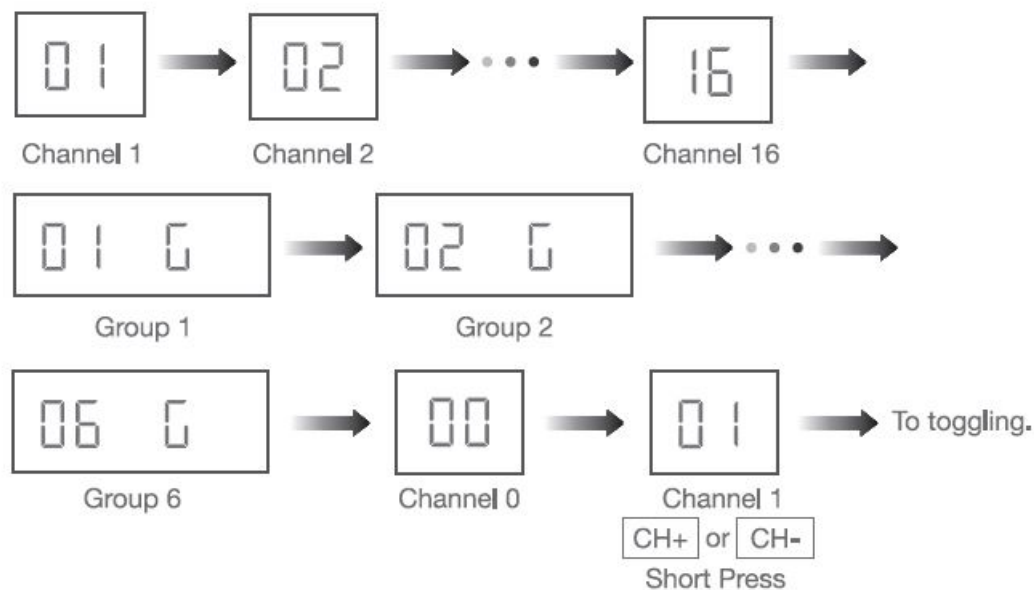

- **Note** Channel 0 is the group control for all the channels.

• Number of Channels Setting

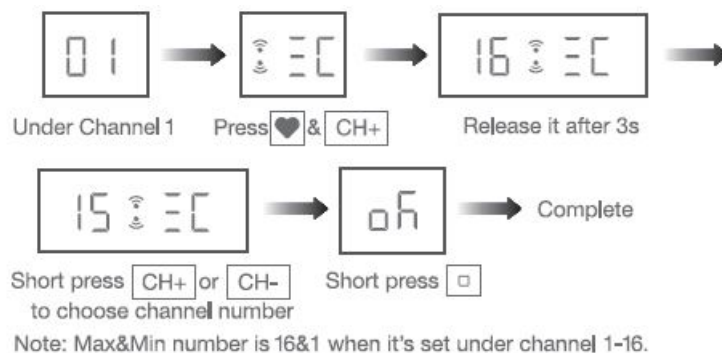

• Number of Groups Setting

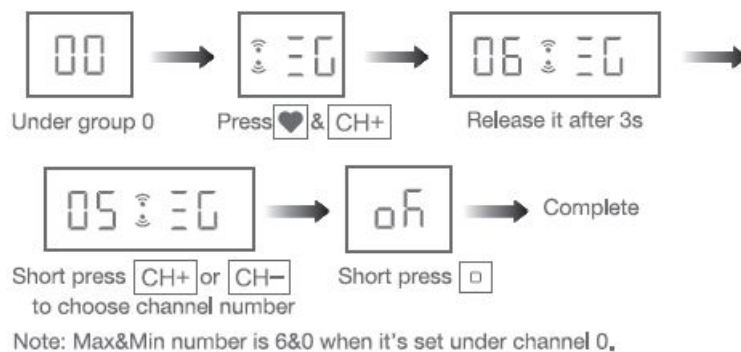

• Channel in Group Setting

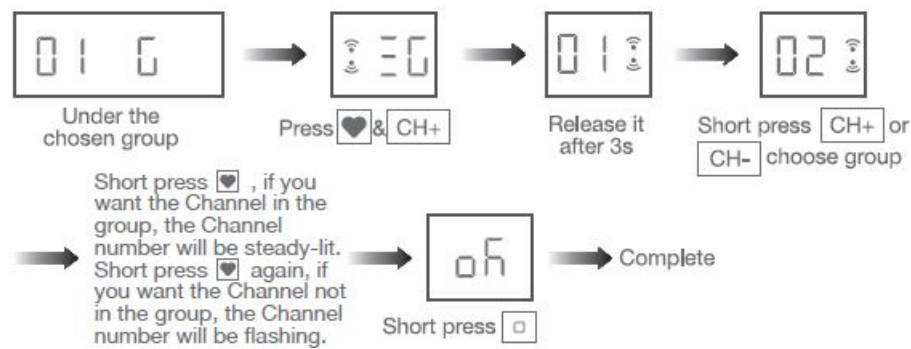

- **Prohibit Dual-key Operation**

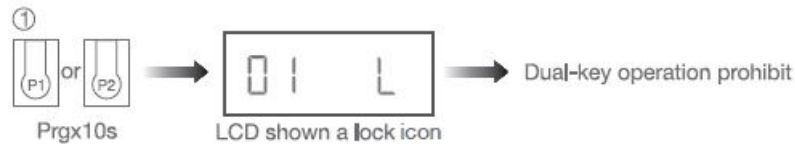

- **Note:** When dual-key operation is prohibited, these programming setting functions are not allowed.

- **Position Percent Setting**

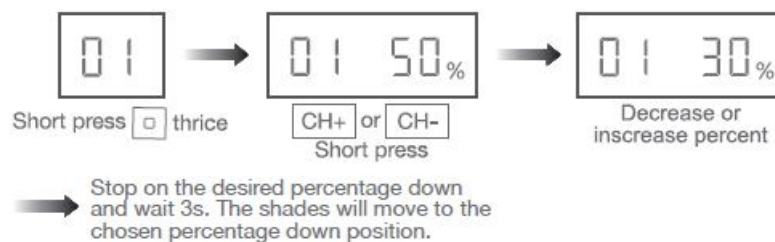

- **Note:** All the shades under the same group will run to the same position after the percent setting.

- **For other operations, please refer to the motor operation instruction**

Documents / Resources

	<p>JIECANG JCHR35W3C1 Hand-Held LCD Remote Controller [pdf] User Manual JCHR35W3C1, JCHR35W3C2, JCHR35W3C1 Hand-Held LCD Remote Controller, JCHR35W3C1, Hand-Held LCD Remote Controller, LCD Remote Controller, Remote Controller, Controller</p>
--	--