



# JIECANG JCHR35W3C1-C2 Hand-Held LCD Remote Controller User Manual

[Home](#) » [JIECANG](#) » JIECANG JCHR35W3C1-C2 Hand-Held LCD Remote Controller User Manual 

## Contents

- [1 JIECANG JCHR35W3C1-C2 Hand-Held LCD Remote Controller](#)
- [2 Product Information](#)
- [3 Product Parameters](#)
- [4 Product Buttons](#)
- [5 Product Instructions](#)
- [6 Check the Channels in Groups](#)
- [7 Position Percent Setting](#)
- [8 Other Operations](#)
- [9 Product Info](#)
- [10 Buttons](#)
- [11 Instructions](#)
- [12 Documents / Resources](#)



**JIECANG JCHR35W3C1-C2 Hand-Held LCD Remote Controller**



## Product Information

The JCHR35W3C1/C2 Hand-held LCD Remote Controller is a product used to control motorized shades. It comes in two variations, the JCH35W3C1 16-channel LCD remote controller and the JCH35W3C2 16-channel dual control LCD remote controller.

## Product Parameters

The product parameters can be found on the nameplate. For more information, please refer to the nameplate.

## Product Buttons

- JCH35W3C1 16-channel LCD remote controller
- JCH35W3C2 16-channel dual control LCD remote controller

## Caution!

If the voltage is too low, the LCD screen digital display will be weak, prompting to replace the battery.

## Product Instructions

### Channels & Groups Toggling

- JCH35W3C1 16-channel LCD remote controller
- JCH35W3C2 16-channel dual control LCD remote controller

**Note:** Channel 0 is the group control for all the channels.

- Number of Channels Setting

- Number of Groups Setting
- Channel in Group Setting

Short press, if you want the Channel in the group, the Channel number will be steady-lit. Short press again, if you want the Channel not in the group, the Channel number will be flashing.

## Check the Channels in Groups

## Prohibit Dual-key Operation

Icon

## Position Percent Setting

Stop on the desired percentage down and wait for 3s. The shades will move to the chosen percentage-down position.

## Other Operations

Please refer to the motor operation instruction for other operations.

## Product Info

- JCH35W3C1 16-channel LCD remote controller.

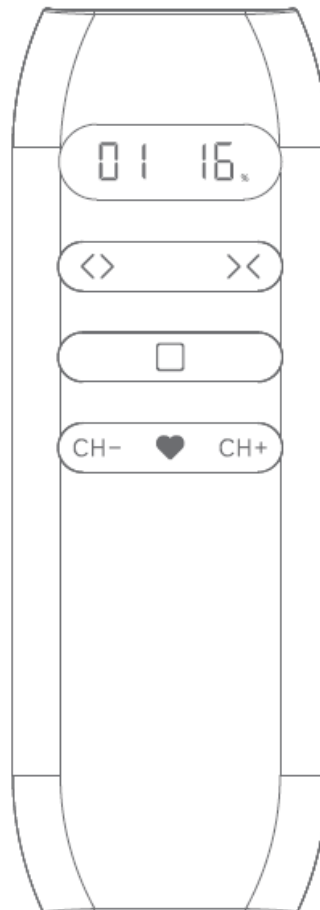

- JCH35W3C2 16-channel dual control LCD remote controller.

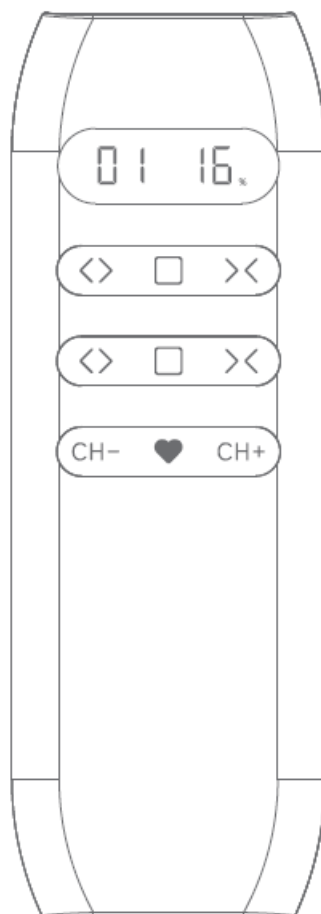

## Buttons

### Front

- JCH35W3C1 16-channel LCD remote controller.

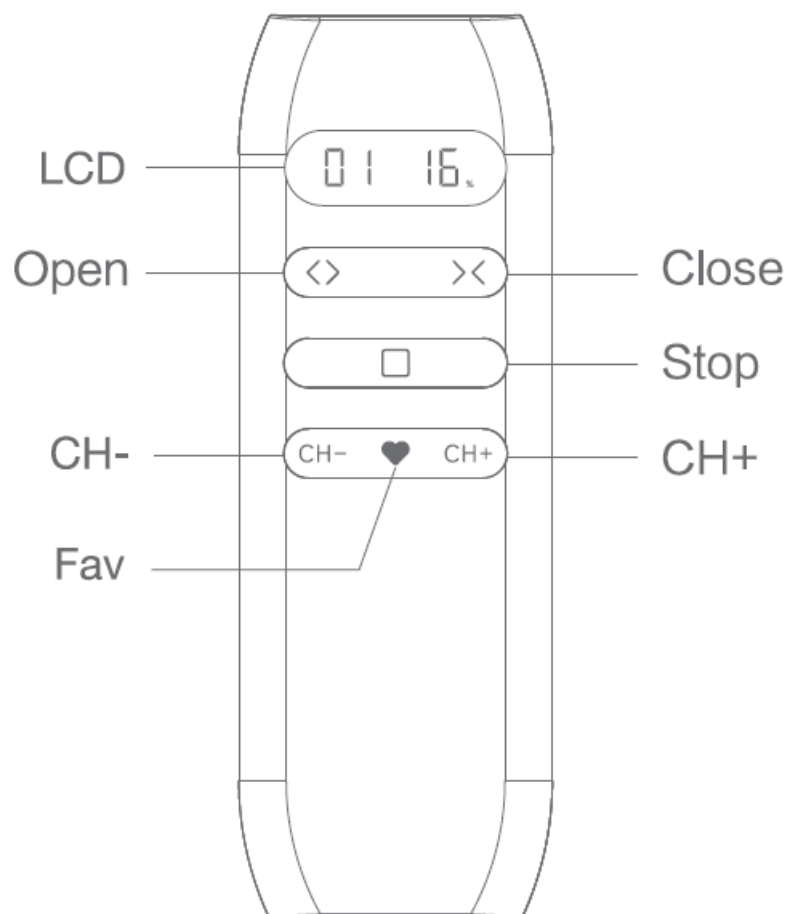

- JCH35W3C2 16-channel dual control LCD remote controller.

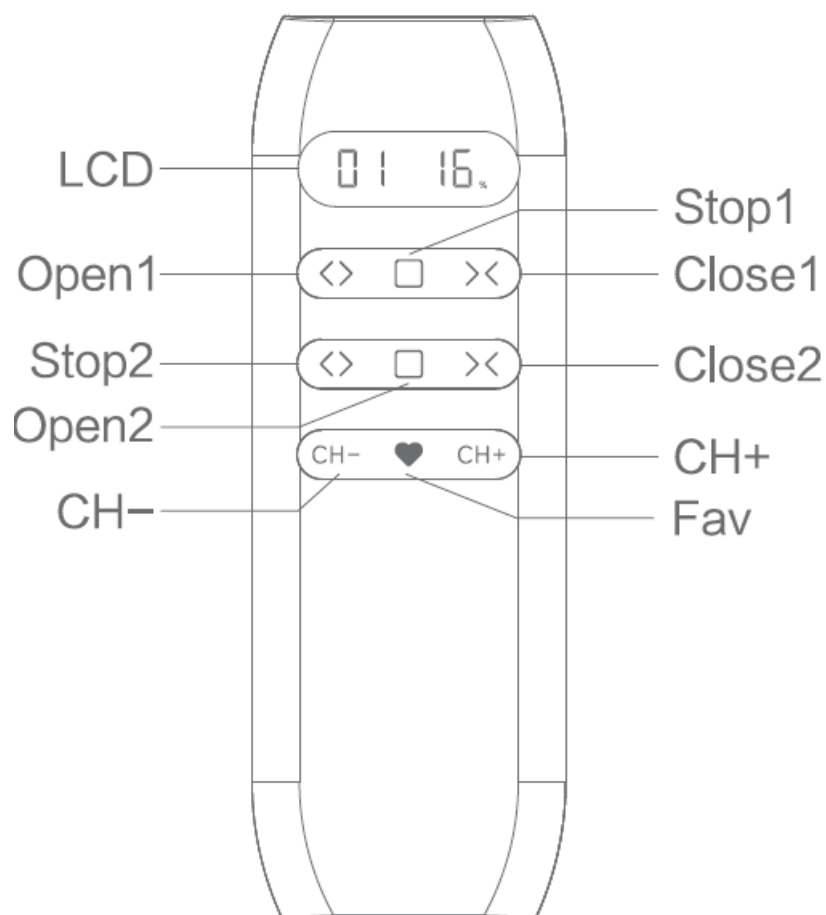

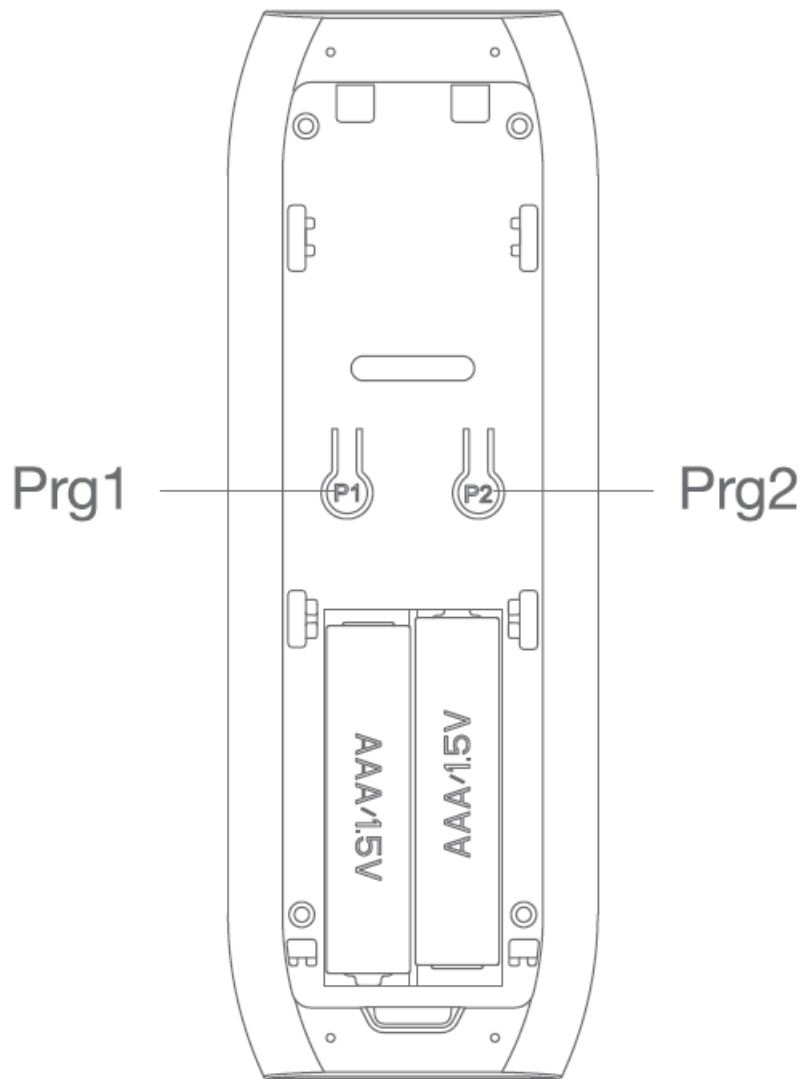

**Parameters(For more info please refer to the nameplate)**

| Electrical Specification | Standard       |
|--------------------------|----------------|
| Battery Type             | AAA battery*2  |
| Working Temperature      | -10°C-50°C     |
| Radio Frequency          | 433.92M±100KHz |
| Transmit Distance        | >=30m indoor   |

#### Caution

1. The transmitter should not be exposed to moisture or impact, so as not to affect its life
2. During use, when the remote control distance is significantly shorter or less sensitive, please check whether the battery needs to be replaced.
3. When the voltage is too low, the LCD screen digital display will be weak, prompting to replace the battery.
4. Please properly dispose of used batteries according to the local garbage classification and recycling policy.

## Instructions

### Channels & Groups Toggling

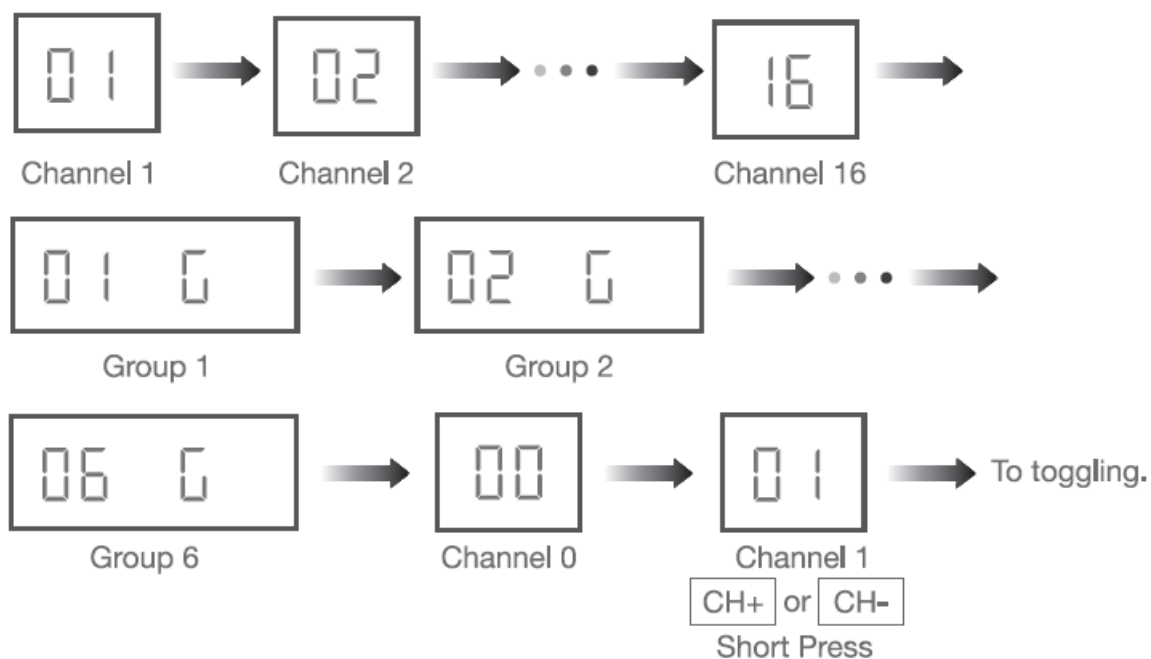

**Note:** Channel 0 is the group control for all the channels.

### Number of Channels Setting

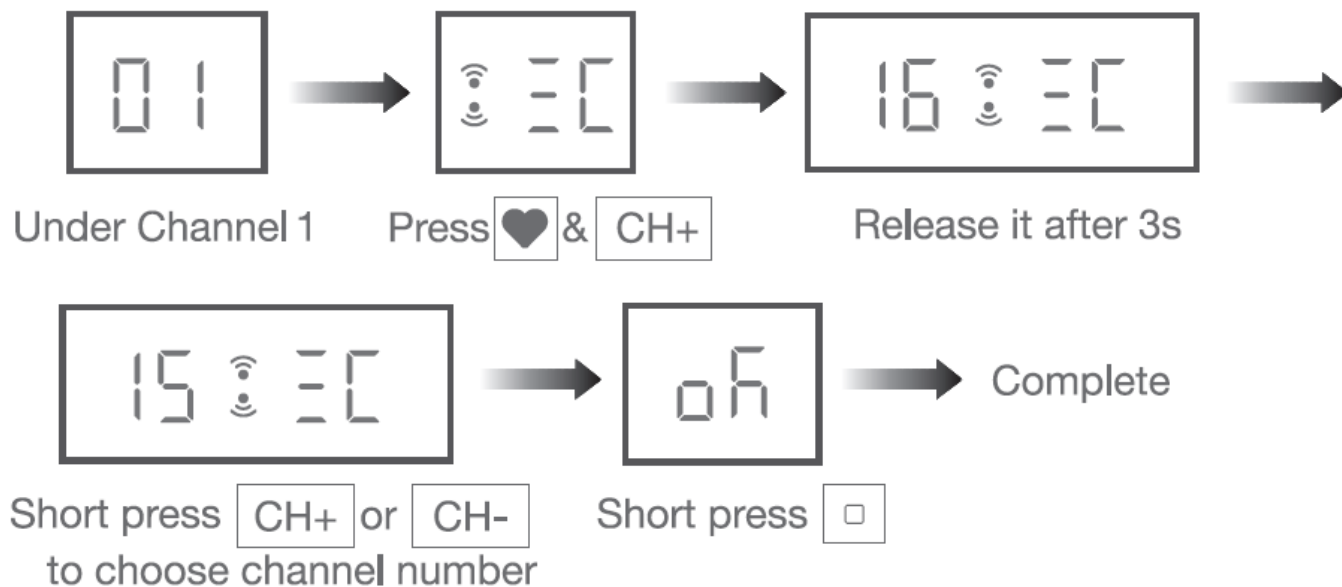

**Note:** Max&Min number is 16&1 when it's set under channels 1-16.

### Number of Groups Setting

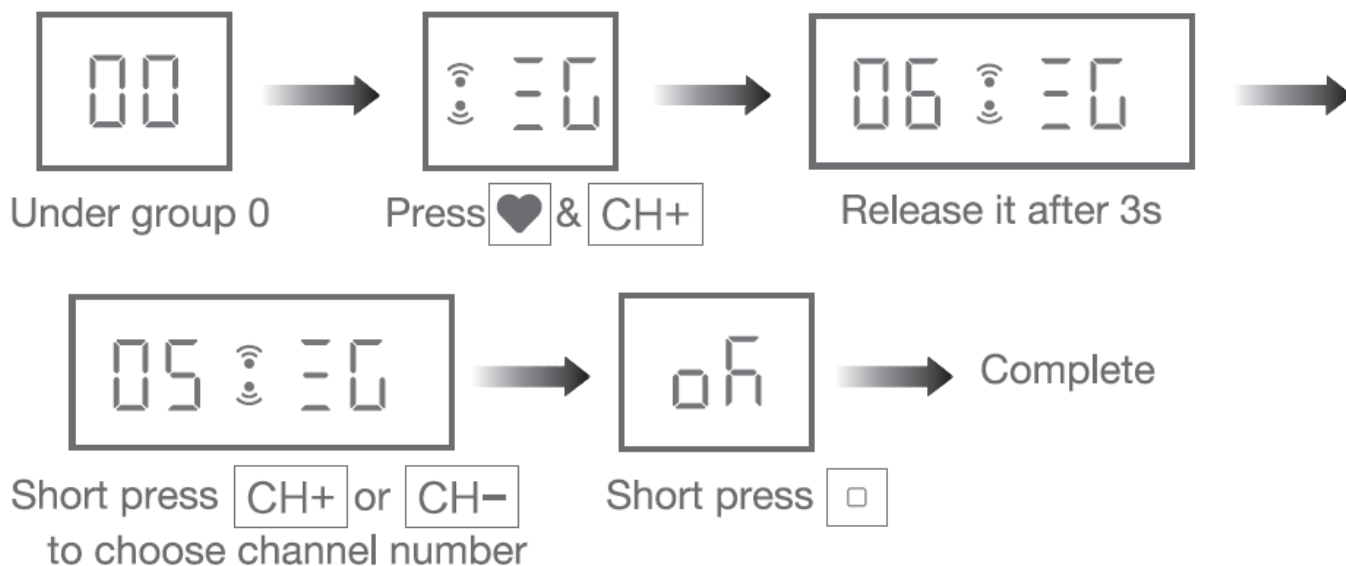

**Note:** The max&Min number is 6&0 when it's set under channel 0.

### Channel in Group Setting

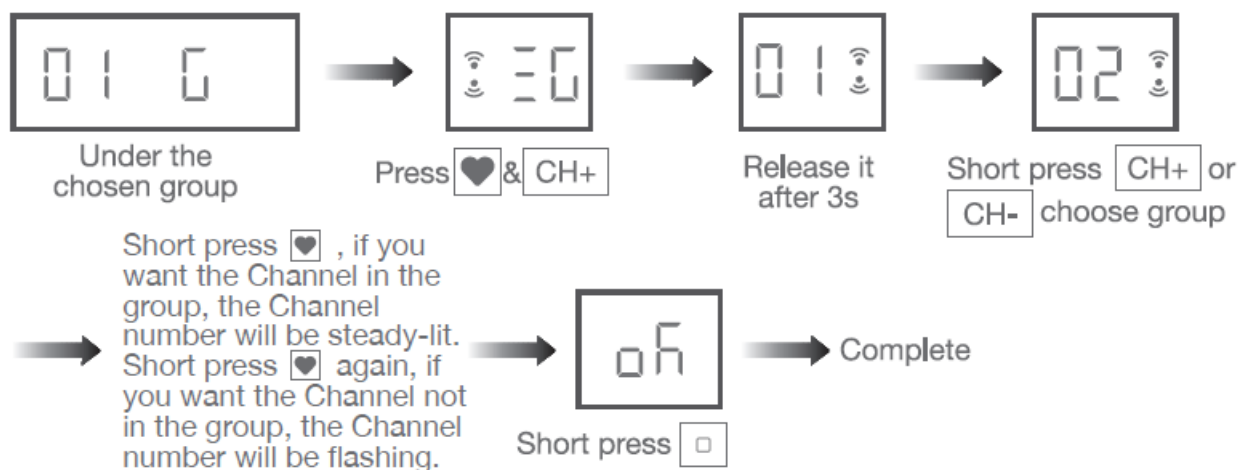

**Note:** Channel in groups setting is under GROUP 1-6.

### Check the Channels in Groups

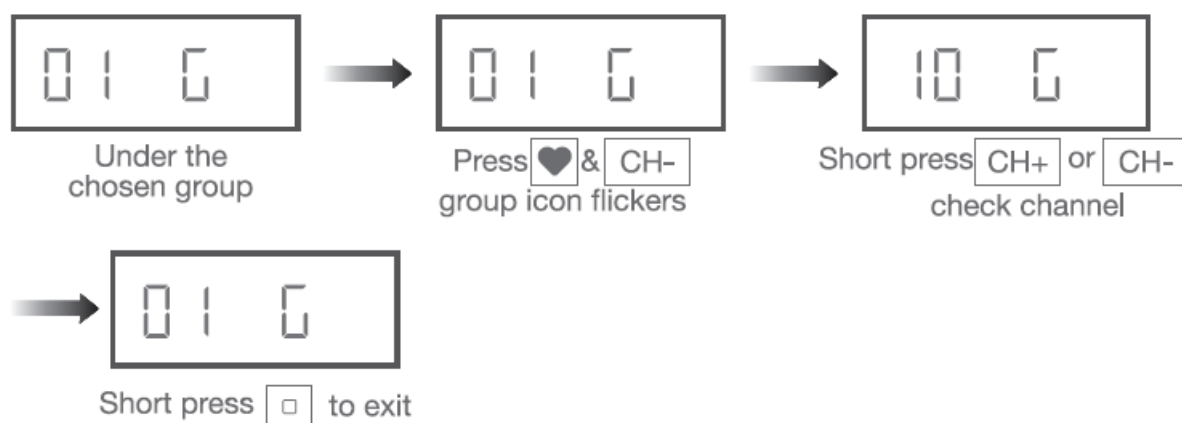

### Prohibit Dual-key Operation





- Repeat the above, dual-key operation activated

**Note:** When dual-key operation is prohibited, these programming setting functions are not allowed.

### Position Percent Setting

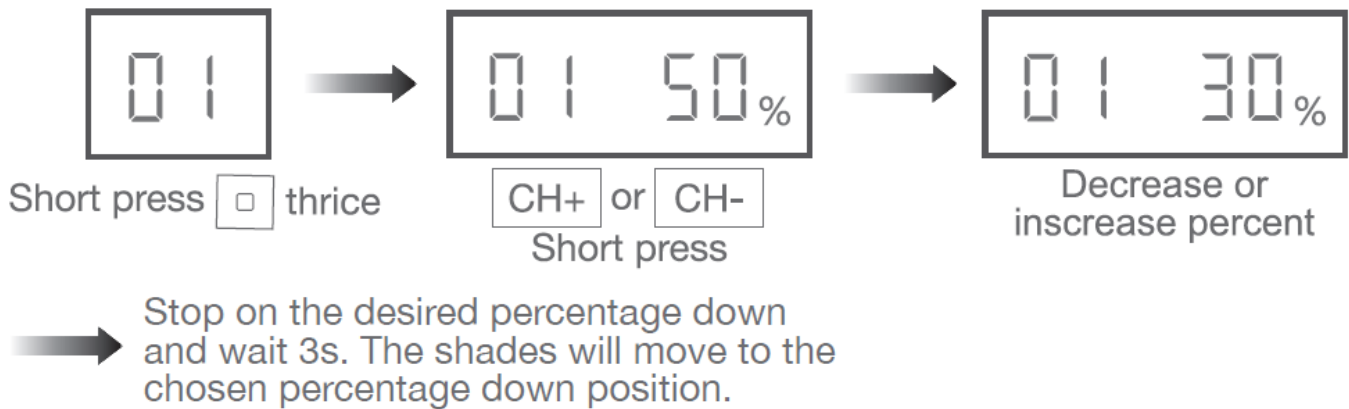

**Note:** All the shades under the same group will run to the same position after the percent setting.

- For other operations, please refer to the motor operation instruction.

### Documents / Resources

|  |   |
|--|---|
|  | <p><a href="#">JIECANG JCHR35W3C1-C2 Hand-Held LCD Remote Controller</a> [pdf] User Manual<br/> JCHR35W3C1-C2 Hand-Held LCD Remote Controller, JCHR35W3C1-C2, Hand-Held LCD Remote Controller, LCD Remote Controller, Remote Controller, Controller</p> |
|--|---|