

# JIECANG JCHR35W1C/2C 16 Channel LCD Remote Controller User Manual

## Contents

- [1 JIECANG JCHR35W1C/2C 16 Channel LCD Remote Controller](#)
- [2 Product Information](#)
- [3 Instructions](#)
- [4 Product Info](#)
- [5 Buttons](#)
- [6 Models & Parameters](#)
- [7 Instruction](#)
- [8 Documents / Resources](#)



## JIECANG JCHR35W1C/2C 16 Channel LCD Remote Controller



### Product Information

The JCHR35W1C/2C is a 16-channel LCD remote controller available in two models: wall-mounted and hand-held. The remote controller is designed to control various devices such as lights, shades, and other home automation systems.

### Models & Parameters

The wall-mounted and hand-held models have the same parameters, which can be found on the nameplate of the device.

### Buttons

The remote controller has several buttons that can be used to control the channels and settings of the connected devices.

## Caution!

Before using the remote controller, make sure to read the instructions carefully to avoid any damage or malfunction of the connected devices.

## Instructions

To control the channels, use the short press function on the remote controller. Pressing the button once will turn on the channel and pressing it again will turn it off. For the group control of all channels, use Channel 0. To add a channel to the group, short-press the button. The channel number will be steady-lit. To remove a channel from the group, short-press the button again. The channel number will start flashing. To set limits for shades, press and hold the button until the shades start moving. Release the button when the shades reach the desired position. Wait for 3 seconds until the shades stop moving.

## Product Info



JCHR35W1C  
Hand-held 16-channel LCD Remote Controller



JCHR35W2C  
Wall-Mounted 16-channel LCD Remote Controller

## Buttons

### FRONT

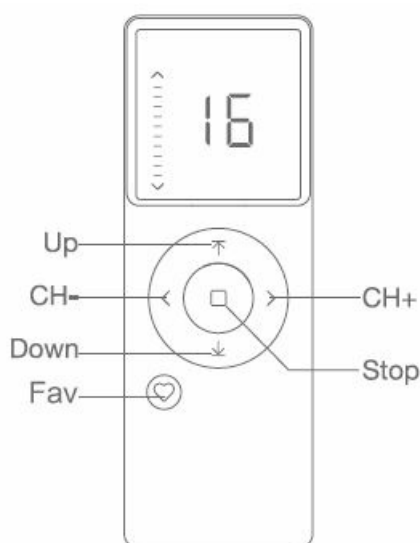

JCHR35W1C  
Hand-held 16-channel LCD Remote Controller

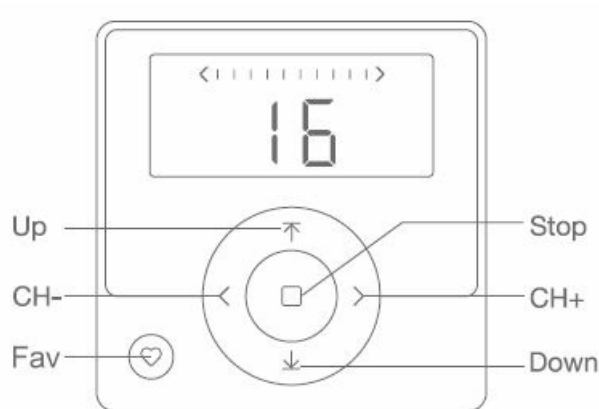

JCHR35W2C  
Wall-Mounted 16-channel LCD Remote Controller

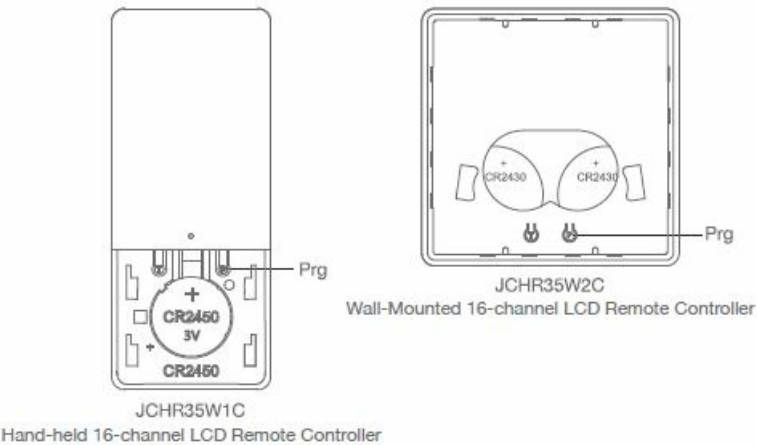

Models & Parameters

(For more info please refer to the nameplate)

Electrical Specification	Standard	
Battery Type	Hand-held:CR2450*3V*1	Wall-mounted: CR2430*3V*2
Working Temperature	-10℃-50℃	
Radio Frequency	433.92M ± 100KHz	
Transmit Distance	>=30m indoor	

Caution

- 1. The transmitter should not be exposed to moisture or impact, so as not to affect its life
- 2. During use, when the remote control distance is significantly shorter or less sensitive, please check whether the battery needs to be replaced.
- 3. When the battery voltage is too low, the LCD screen will show a low voltage prompt, prompting to replace the battery.
- 4. Please properly dispose of used batteries according to the local garbage classification and recycling policy.

Instruction

Channels & Groups Togalina

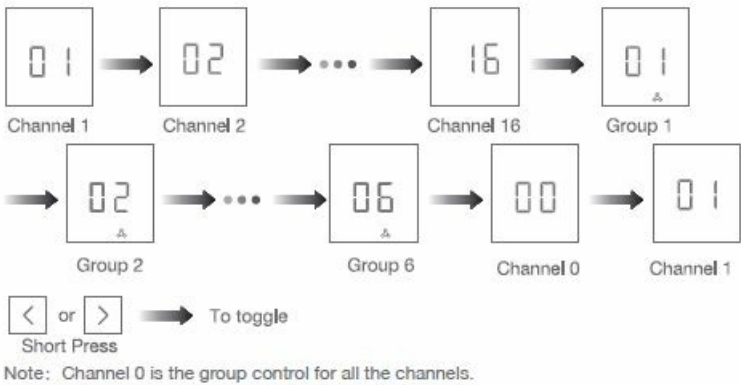

Number of Channels Setting

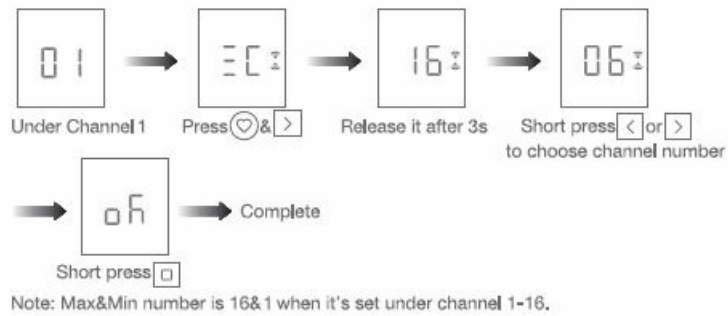

## Number of Groups Setting



## Channel in Group Setting

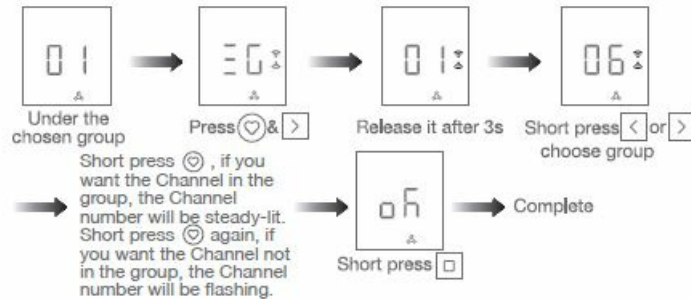

**Note:** Channel in arounds setting is under GROUP 1-6

## Check the Channels in Groups

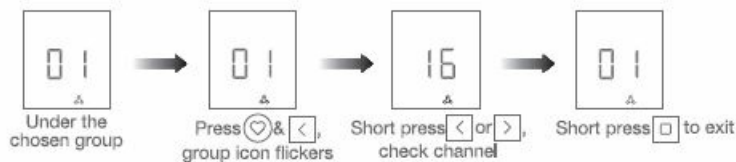

**Note:** LCD will show "EC" if there is no detailed channel.

## Prohibit Dual-key Operation



Repeat the above, dual-key operation activated

**Note:** When dual-key operation prohibited, these programming setting functions are not allowed, such as limits setting.

## Documents / Resources

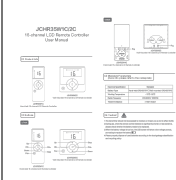

[JIECANG JCHR35W1C/2C 16 Channel LCD Remote Controller](#) [pdf] User Manual  
JCHR35W1C-2C, JCHR35W1C 2C 16 Channel LCD Remote Controller, JCHR35W1C, JCHR35W1C 16 Channel LCD Remote Controller, 2C 16 Channel LCD Remote Controller, 16 Channel LCD Remote Controller, 16 Channel Remote Controller, LCD Remote Controller, Remote Controller