



JIECANG JCHR35W1C 16-Channel LCD Remote Controller User Manual

[Home](#) » [JIECANG](#) » JIECANG JCHR35W1C 16-Channel LCD Remote Controller User Manual 

Contents

- 1 JIECANG JCHR35W1C 16-Channel LCD Remote Controller
- 2 Product Info
 - 2.1 Models & Parameters (more info please refer to the nameplate)
- 3 Buttons
- 4 Caution!
- 5 Instructions
- 6 Product Information
- 7 Models & Parameters (more info please refer to the nameplate)
- 8 Product Instructions
- 9 Documents / Resources
- 10 Related Posts



JIECANG JCHR35W1C 16-Channel LCD Remote Controller



Product Info

The 16-channel LCD Remote Controller is available in two models Wall-Mounted and Hand-held. The controller is used to control the channels of a connected device.

Models & Parameters (more info please refer to the nameplate)

The Wall-Mounted and Hand-held models have the following parameters. Please refer to the nameplate for more information.

- Model: Wall-Mounted 16-channel LCD Remote Controller
- Model: Hand-held 16-channel LCD Remote Controller

Buttons

The controller has multiple buttons that allow the user to control the channels of the connected device.

Caution!

Use the controller as per the instructions mentioned in this manual. Improper usage may lead to damage to the device.

Instructions

Note: Channel 0 is the group control for all the channels. To add a channel to the group:

1. Short press the button corresponding to the channel number. The channel number will be steady-lit.
2. Short press the button again, if you want the Channel not in the group, and the Channel number will be flashing.

To set limits

1. Press and hold the button corresponding to the channel number for 3 seconds.
2. Stop on the desired percentage down and wait 3 seconds. The shades will move to the chosen percentage down position.

Product Information

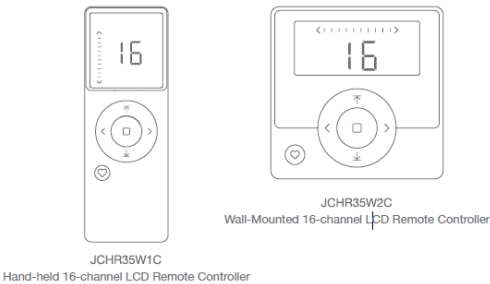

Buttons Function

- front

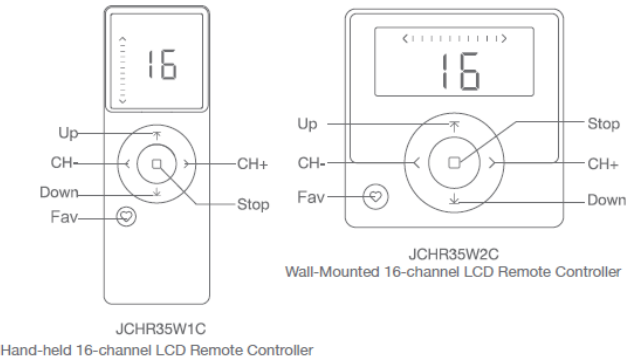

- back

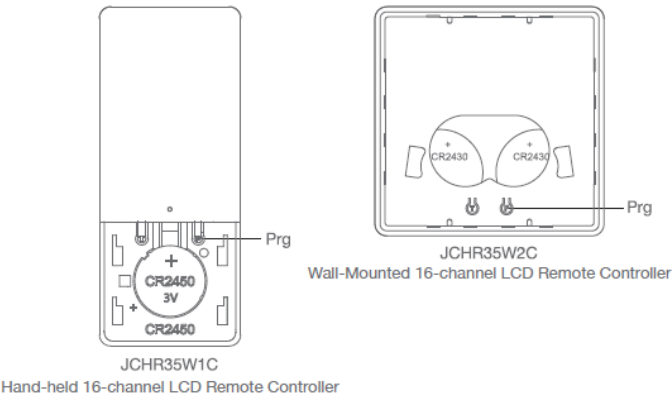

Models & Parameters (more info please refer to the nameplate)

Electrical Specification	Standard	
Battery Type	Hand-held:CR2450*3V*1	Wall-mounted: CR2430*3V*2
Working Temperature	-10℃-50℃	
Radio Frequency	433.92M ± 100KHz	
Transmit Distance	>=30m indoor	

Caution!

- 1.The transmitter should not be exposed to moisture or impact, so as not to affect its life
- 2.During use, when the remote control distance is significantly shorter or less sensitive, please check whether the battery needs to be replaced.
- 3.When the battery voltage is too low, the LCD screen will show a low voltage prompt, prompting to replace the battery. 
- 4.Please properly dispose of used batteries according to the local garbage classification and recycling policy.

Product Instructions

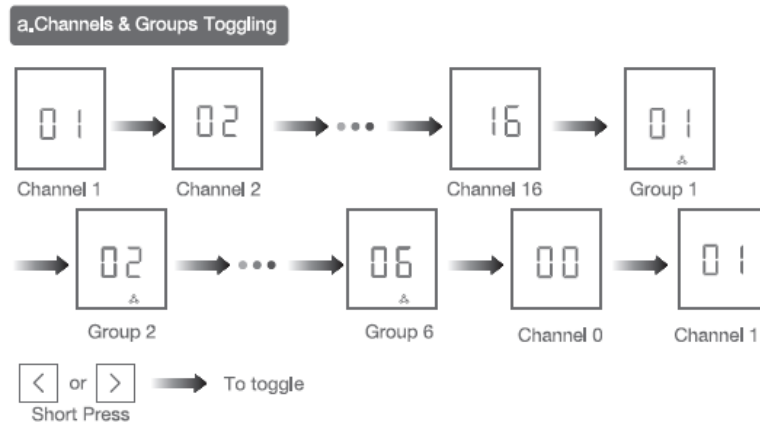

Note: Channel 0 is the group control for all the channels.

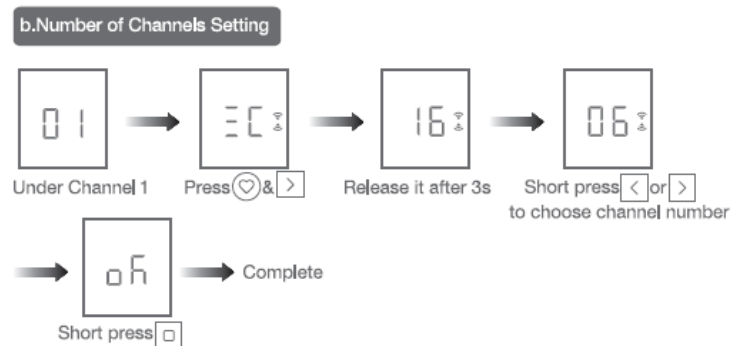

Note: Max & Min number is 16&1 when it's set under channel 1-16

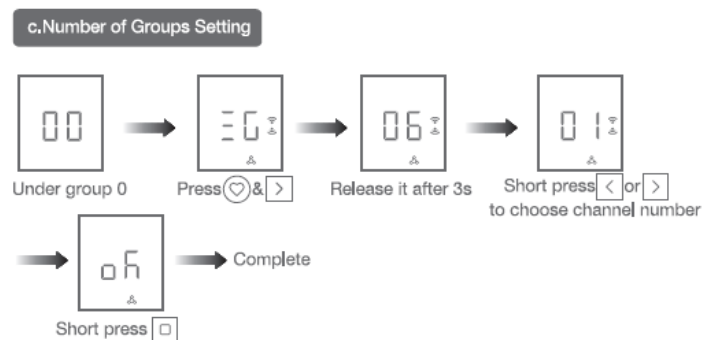

Note: Max & Min number is 6&0 when it's set under channel 0.

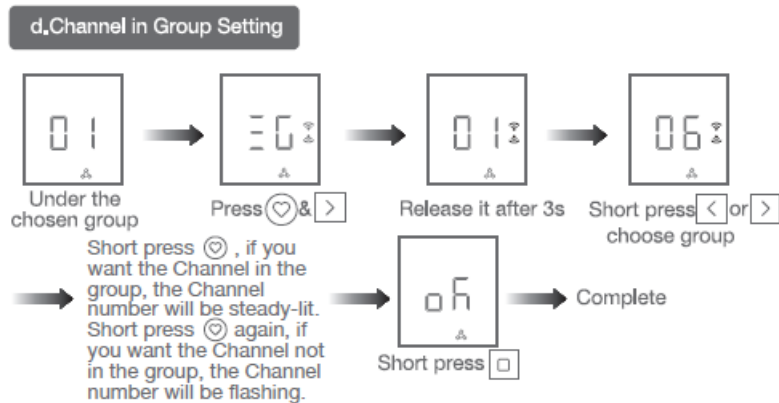

Note: Channel in groups setting is under GROUP 1-6.

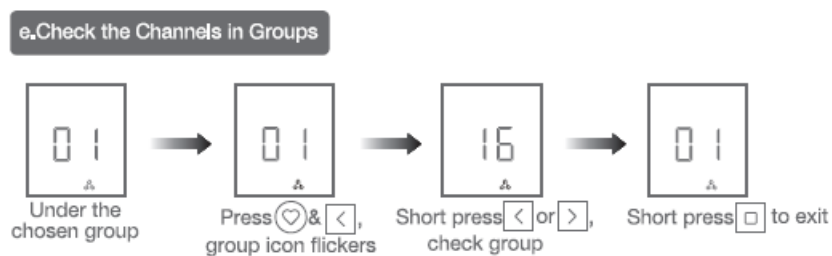

Note: LCD will show "EC" if there is no detailed channel.

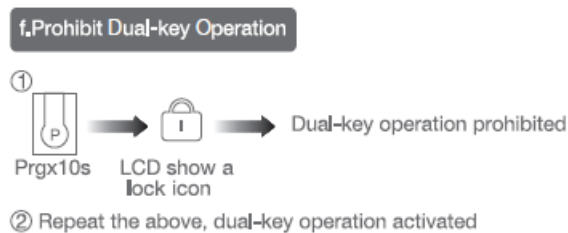

Note: When dual-key operation prohibited, these programming setting functions are not allowed, such as limits setting.

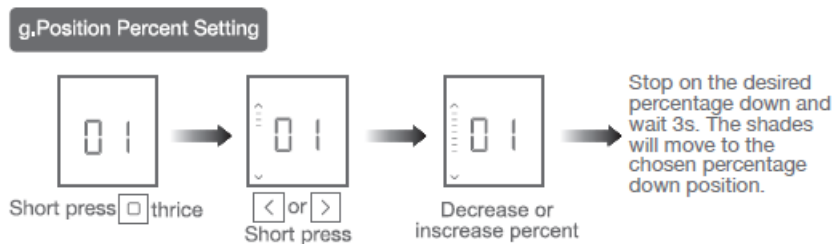

Note: All the shades under same group will run to same position after percent setting. h For other operations, please refer to the motor operation instruction

Documents / Resources

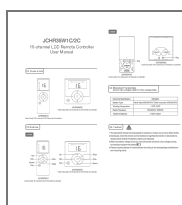

[JIECANG JCHR35W1C 16-Channel LCD Remote Controller](#) [pdf] User Manual
JCHR35W1C 16-Channel LCD Remote Controller, JCHR35W1C, 16-Channel LCD Remote Controller, LCD Remote Controller, Remote Controller, Controller

