

JETSTREAM^{PRO}
BB86 Pro Bottom
Bracket



JETSTREAM BB86 Pro Bottom Bracket Installation Guide

[Home](#) » [JetStream](#) » JETSTREAM BB86 Pro Bottom Bracket Installation Guide 

Contents

- [1 JETSTREAM BB86 Pro Bottom Bracket](#)
- [2 Product Usage Instructions](#)
- [3 Specification Check](#)
- [4 General Safety](#)
- [5 Required Tools](#)
- [6 Bottom Bracket Installation](#)
- [7 Bottom Bracket Maintenance](#)
- [8 Reapply lubricant to the Bottom Bracket](#)
- [9 FAQ](#)
- [10 Documents / Resources](#)
 - [10.1 References](#)
- [11 Related Posts](#)

JETSTREAM^{PRO}

JETSTREAM BB86 Pro Bottom Bracket



Product Usage Instructions

- Ensure internal cable routing will not interfere with BB installation.
- Clean the BB shell inside the frame and apply a thin layer of grease.
- Remove the drive-side BB for later installation.
- Gently position the non-drive side BB into the BB shell.
- Press it in using a dedicated BB installation tool until snug against the frame.
- Align the drive-side BB and Snug Ring vertically inside the BB shell.
- Rotate counterclockwise to insert and use a BB wrench to press in until tight.
- Tighten to 30Nm torque value, ensuring no gap between BB and frame.
- Clean bearings thoroughly with solvent and allow them to dry completely.
- Add lubricant as per recommendations and ensure even distribution by rotating bearings by hand.
- Press seals back securely and check for smooth movement post-reassembly.
- Wear Safety Glasses and Gloves during installation and maintenance.

Specification Check

Before installation,

- please ensure that your bike frame and crankset meet the following specifications.

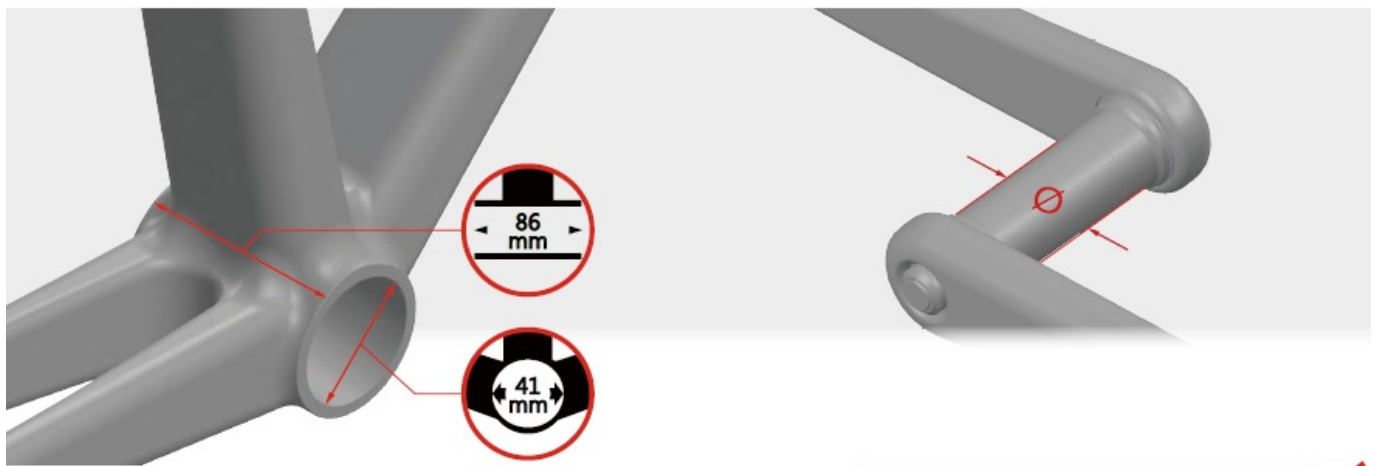

Bike Frame : BB86

Crank Spec: SRAM DUB : Ø28.99mm ☒

- Twist-Fit Type
- Inner Diameter: 41mm
- Width: 86mm

BB BB86 Anatomy

- Before installation, please ensure that the purchased BB meets the following specifications and includes the following contents.



General Safety

- To install the TRiPEAK Bottom Bracket, we strongly recommend that you have a trained bicycle mechanic at your local bike shop.
- Do not alter this product in any way as it can cause unseen damage.
- Any modifications to this product will void the warranty.
- Make sure the crankset is firmly attached to the bottom bracket, Improperly attached cranks can become detached from the BB set.
- When cleaning the bottom bracket set, only use mild soap and water.
- Never use a high-pressure water jet, It will cause BB cup internal water ingress and influence the bearing rolling lifetime.
- If you have any questions or concerns about this product,
- Please feel free to contact us. E-mail: info@tripeakbearing.com



Required Tools

- TRIPEAK Tool Required: B015 Tool compatible with a torque wrench for installation use.



PROTECTION SUPPLIES



OPERATING TOOLS



Bottom Bracket Installation

1. Use the included TRIPEAK ETERNA LV Fluid to Add a full lap of bearings. Rotate the bearings gently by hand to ensure the lubricant is evenly distributed.
Carefully press the seals back into place on the bearings, ensuring they are seated properly and securely. After reassembly, check to ensure the bearings move smoothly and without resistance.

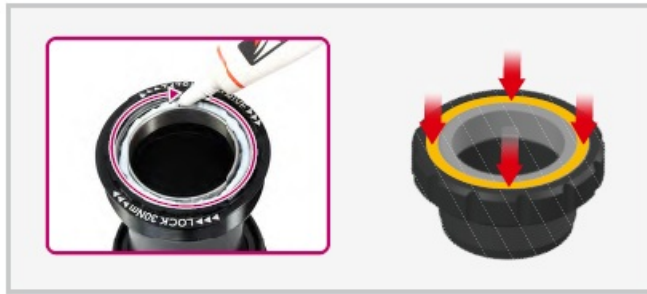

2. Ensure that the internal cable routing of the frame will not interfere with the bottom bracket (BB) installation. Clean the inside of the BB shell on the frame, ensuring it is smooth and free of debris. Apply a thin layer of grease to the inner edges of the BB shell to assist with smooth BB installation.

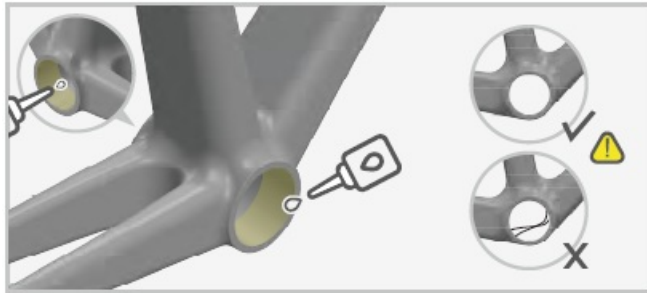

3. Remove the drive-side BB, which will be installed later.

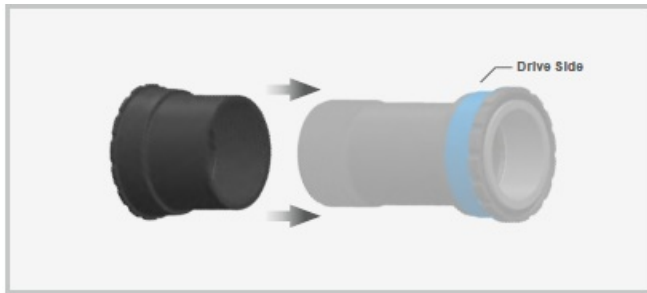

4. Gently position the non-drive side BB into the non-drive side of the BB shell. Using a dedicated BB installation tool, press the non-drive side BB into the BB shell of the frame until there is no gap between the BB and the frame.

During pressing, ensure the BB is inserted at a proper vertical angle to the frame. If you encounter excessive resistance while pressing, stop the process and recheck the insertion angle and the BB shell for any debris or deformation.

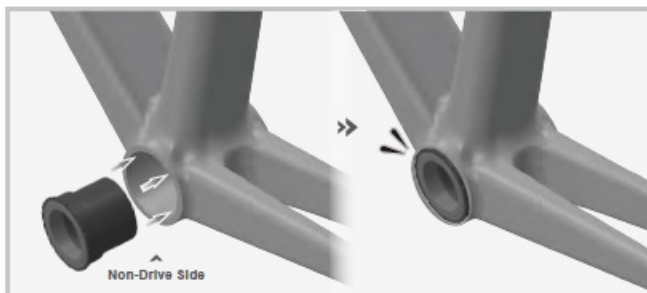

5. Align the drive-side BB along with the Snug Ring vertically with the inside of the drive-side BB shell on the frame, and rotate it counterclockwise to insert. Then, use the BB wrench (B015) to fit the drive-side BB, continuing to rotate counterclockwise to press it in. Tighten to a torque value of 30Nm, ensuring there is no gap between the BB and the frame's BB shell, completing the BB installation.

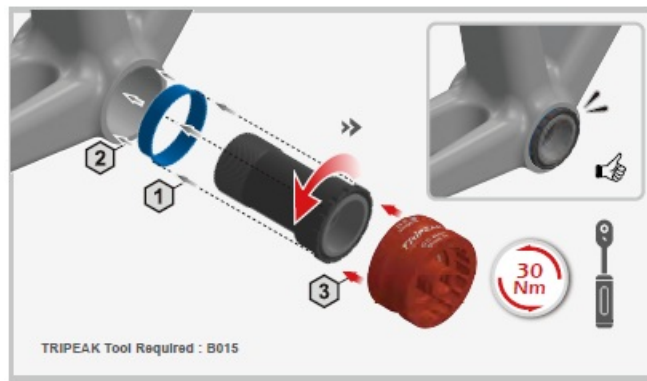

If the non-drive side BB rotates along with the drive-side BB during installation, prepare another BB wrench (B015) to secure the non-drive side BB in place, ensuring the required torque value is reached.

Bottom Bracket Maintenance

- For maintaining and servicing TRIPEAK bottom brackets, we strongly recommend hiring a trained bicycle mechanic at your local bike shop.
- Regular maintenance is generally recommended after riding 5,000-10,000 km. If riding in harsh conditions (wet, dusty, extreme temperatures, etc.), it is advised to perform maintenance immediately after riding.
- Avoid repeated disassembly and reassembly of the BB Cup unless necessary, as maintenance should only focus on the BB bearings to prevent damage to the frame.
- Do not use high-pressure water jets to clean the BB to avoid water infiltration and bearing damage.
- Regularly check the torque value of the BB Cup, and do not ride with a loose BB Cup.
- Roarina cnotifications for RROG RR onvInHmm) Drive Side : 39 x 30 x 6mm (39306) Non-Drive Side : 40 x 30 x 7mm (40307)



Lubricant Recommendation TRIPEAK ETERNA LV Fluid



Reapply lubricant to the Bottom Bracket

1. Carefully use a small tool to gently pry off the outer seals from the bearings. Use a suitable solvent to clean the bearings thoroughly, removing old lubricant and any debris. Allow them to dry completely.
Be cautious not to damage the seals or the bearings.

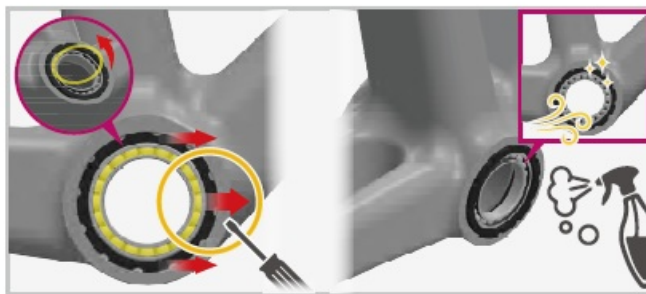

2. Use TRiPEAK ETERNA LV Fluid or the appropriate lubricant to Add a full lap of bearings. Be sure to use the correct type of lubricant recommended for your specific bearings.
Rotate the bearings gently by hand to ensure the lubricant is evenly distributed.

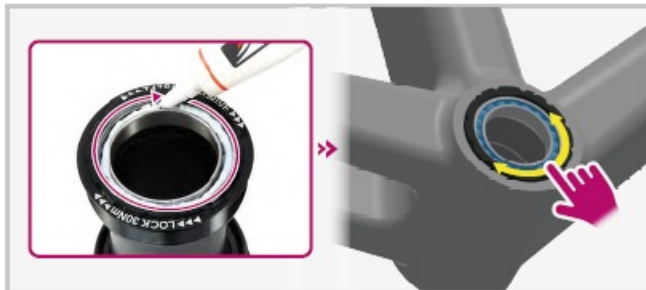

3. Carefully press the seals back into place on the bearings, ensuring they are seated properly and securely.
After reassembly, check to ensure the bearings move smoothly and without resistance.

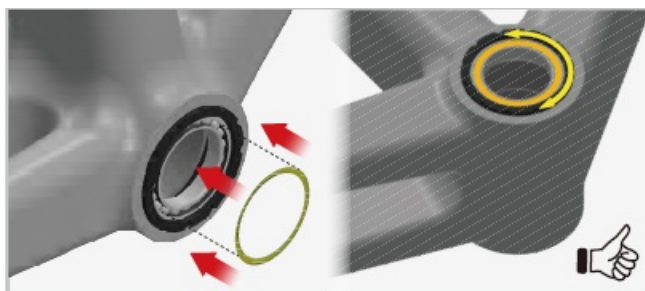

WWW.tripeakbearing.com.

FAQ

- Q: What lubricant should I use for bearing maintenance?

- **A:** It is recommended to use TRiPEAK ETERNA LV Fluid or an appropriate lubricant suitable for your bearings.
- **Q: How do I ensure proper installation torque?**
 - **A:** Use a torque wrench and tighten to the specified torque values provided in the manual.

Documents / Resources

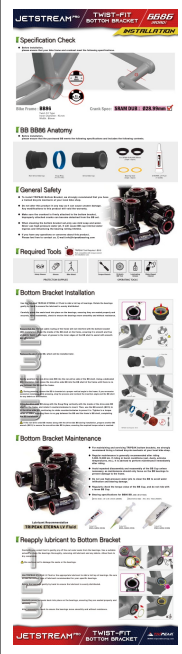

The thumbnail shows the first page of the JETSTREAM BB86 Pro Bottom Bracket Installation Guide. It includes sections for 'Specification Check', 'BB Anatomy', 'General Safety', 'Required Tools', 'Bottom Bracket Installation', 'Bottom Bracket Maintenance', and 'Reapply Lubricant to Bottom Bracket'. The page features various diagrams and images of the bottom bracket components.

[JETSTREAM BB86 Pro Bottom Bracket](#) [pdf] Installation Guide

BB86, DUB, NCT-Keramiske Lejer, BB86 Pro Bottom Bracket, BB86, Pro Bottom Bracket, Bottom Bracket

References

- [User Manual](#)

Manuals+, Privacy Policy

This website is an independent publication and is neither affiliated with nor endorsed by any of the trademark owners. The "Bluetooth®" word mark and logos are registered trademarks owned by Bluetooth SIG, Inc. The "Wi-Fi®" word mark and logos are registered trademarks owned by the Wi-Fi Alliance. Any use of these marks on this website does not imply any affiliation with or endorsement.