



## JENSEN JW10A 10 Inch Powered Subwoofer Owner's Manual

[Home](#) » [Jensen](#) » JENSEN JW10A 10 Inch Powered Subwoofer Owner's Manual

**JENSEN®**



## Contents [ [hide](#) ]

### 1 JW10A

#### 1.1 10" Powered Subwoofer in a Vented Enclosure with Multiple Mounting Options

#### 1.2 INSTALLATION/OWNER'S MANUAL

### 2 PREPARATION

#### 2.1 Getting Started

### 3 INSTALLATION

#### 3.1 Safety First

#### 3.2 Connection Descriptions

#### 3.3 Connections and Controls

#### 3.4 Typical Wire Routing

##### 3.4.1 High Level Input (Speaker Wire)

##### 3.4.2 Main Power Connections

#### 3.5 Mounting

#### 3.6 Control Setup and Adjustment

#### 3.7 WARRANTY

#### 3.8 One-Year (or Two-Year\*) Limited Warranty

#### 3.9 Notes

#### 3.10 Troubleshooting

#### 3.11 Specifications

### 4 Documents / Resources

### 5 Related Posts

## JW10A

### 10" Powered Subwoofer in a Vented Enclosure with Multiple Mounting Options

## INSTALLATION/OWNER'S MANUAL

## PREPARATION

---

### Getting Started

Thank you for purchasing the Jensen JW10A 10" vented enclosure with built-in amplifier. Although Jensen has attempted to ensure the information in this manual is accurate, please be aware that any part of it is subject to change without notice.

Please read entire manual before installation. Due to the technical nature of amplifiers, it is highly recommended that your Jensen JW10A is installed by a professional installer or an authorized dealer.

### Before You Start

- Always disconnect the negative battery terminal. Consult a qualified technician for instructions if you are unsure.
- Avoid installing the amplifier where it would be subject to high temperatures, such as from direct sunlight, or where it would be subject to dust, dirt or excessive vibration.
- Use extreme caution when drilling holes to avoid damaging fuel lines or existing vehicle wiring.

- All amplifier installations require power, signal and speaker wires (not included).
- An amplifier installation kit (sold separately) is highly recommended to facilitate the installation. Consult your dealer for recommendations.

## Mounting Location

Choose a mounting location for the JW10A. Suggested locations include behind a seat or in the trunk.

For optimum performance, make sure to provide at least 1" of space around all sides of the amplifier.

Do not mount the JW10A under carpets or where airflow is restricted.

Do not install the JW10A where it may be exposed to moisture.

The optimum mounting location varies between vehicles. Remember to test all amplifier functions before completing the final mounting procedure.

## INSTALLATION

---

### Safety First



**The following instructions are designed to ensure safety during installation and use of the JW10A. Failure to heed these instructions can result in injury or damage to the unit or vehicle.**

---

The following installation instructions are intended to be used as a basic guideline. If you feel unsure about installing this speaker system yourself, Jensen recommends acquiring the services of a professional car audio installation center.

Before installation, please review the following guidelines:

1. Be sure to carefully read and understand the instructions before attempting to install this product.
2. If additional wiring is required, we recommend running all wires prior to mounting your enclosure in place.
3. To ensure reliable performance and minimize signal or power loss, use the highest quality connectors available.
4. Never run speaker wires underneath your vehicle. Running speaker wires inside the vehicle provides the best protection from exhaust, heat and environmental elements.
5. Avoid running wires over, near or through sharp-edged surfaces. We suggest you also use rubber grommets to protect any wires routed through metal, especially the firewall.
6. When running the speaker cable to the amplifier, avoid running it near sources of high current (i.e. wiring

harnesses, battery cables).

---

### Connection Descriptions

**Note: Be sure to follow specific instructions included with your amplifier installation kit (not included with this amplifier). The information below should be used as a general guideline only.**

#### Power Wire (+12V)

- Disconnect negative battery terminal before proceeding. Consult a qualified technician for instructions if you are unsure.
- Plan wire routing before cutting any wires to length. Begin by routing the power +12V wire from the battery to the amplifier location. Use a grommet when running wires through the firewall or metal openings. Avoid running the power wire near existing vehicle wiring to prevent induced noise from entering the audio system.
- Use extreme caution when drilling holes to avoid damaging fuel lines or existing vehicle wiring.
- The +12V wire **MUST** be fused within 18" of the battery for protection of the vehicle's electrical system.

#### Ground Wire (GND)

- The amplifier ground wire should be as short as possible. Choose a clean unpainted section of metal or the vehicle chassis when attaching the ground connection. Be sure to clean the area of any dirt or grease.

#### Remote Turn-on Wire (REM)

- The remote turn-on wire connects to the head unit's amplifier turn-on lead or other switched 12 volt source.

#### Input Signal

- The amplifier's input signal connects to the receiver's low level (RCA) or high level (speaker wire) outputs.

#### CAUTION

- Never run any wires underneath or outside the vehicle.
- 

### Connections and Controls

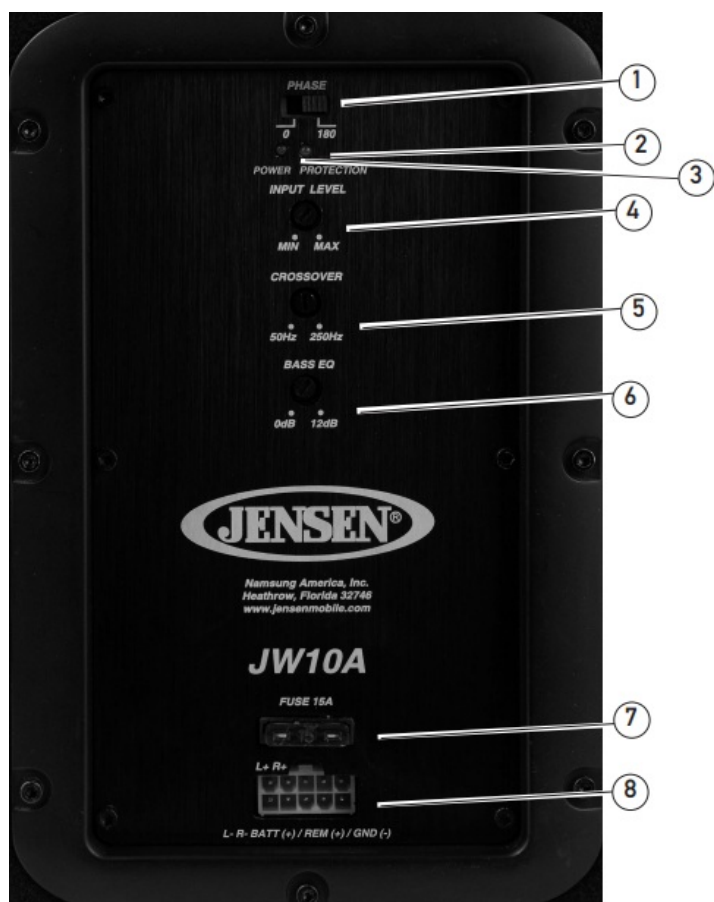

- |                         |                             |
|-------------------------|-----------------------------|
| (1) Phase Control       | (5) Crossover Frequency     |
| (2) Power Indicator     | (6) Bass EQ                 |
| (3) Protect Indicator   | (7) Fuse (15A)              |
| (4) Input Level Control | (8) Power / Input Connector |

### Typical Wire Routing



**High level inputs should only be used when RCA outputs are not available from the head unit.** Connect the head unit speaker outputs to the high level input connector as shown below. The black wire (signal reference ground) may or may not require a connection to chassis ground – depending on your particular installation. **Do not use both low and high level inputs at the same time. Connect only one or the other.**

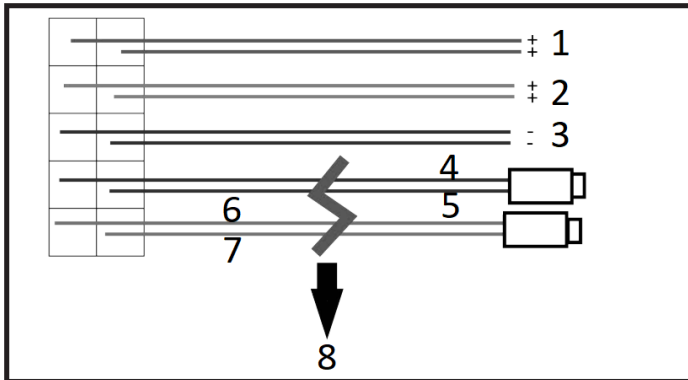

1. BATT
2. Remote
3. Ground
4. White (R+)
5. White / Black (R-)
6. Gray (L+)
7. Gray / Black (L-)
8. Cut the RCA plugs as shown above. This will create the High-Level inputs for connection to the radio.

#### Main Power Connections

Connect BAT+, GND and REM wires accordingly. A suitable fuse **MUST** be installed on the BAT+ lead within 18" of the battery for protection of the vehicle's electrical system.

#### Fuse Rating

When replacing the fuse, make sure new fuse is the correct type and amperage. Using an incorrect fuse could damage the amplifier. The JW10A uses (1) **15 amp** ATO style fuse.

#### Power/Ground Wire Size

For optimum performance, use only **12 gauge** wire or larger. Make sure to use the same size power and ground wire.

---

#### Mounting

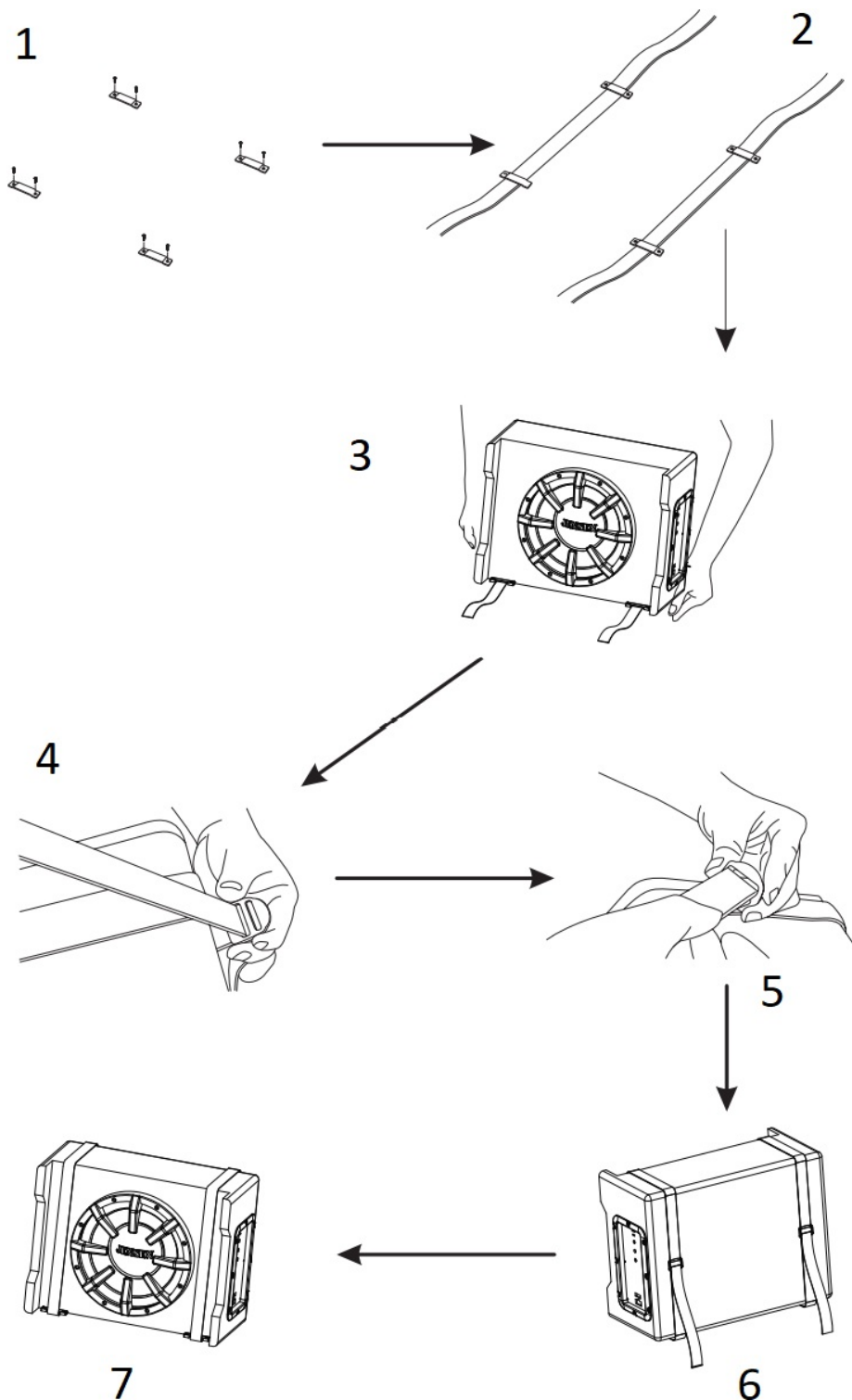

1. Step 1

Secure the supplied mounting brackets to the desired location of your vehicle's trunk or hatchback as illustrated.

2. Step 2

Lace the mounting straps so that they pass through the brackets mounted on the base.

3. Step 3

Place the JW10A on the brackets as shown.

4. Step 4

Lace the mounting straps through the buckles.

5. Step 5

Pull the straps to fasten the buckles as tightly as possible.

6. Back view of proper installation
7. Front view of proper installation

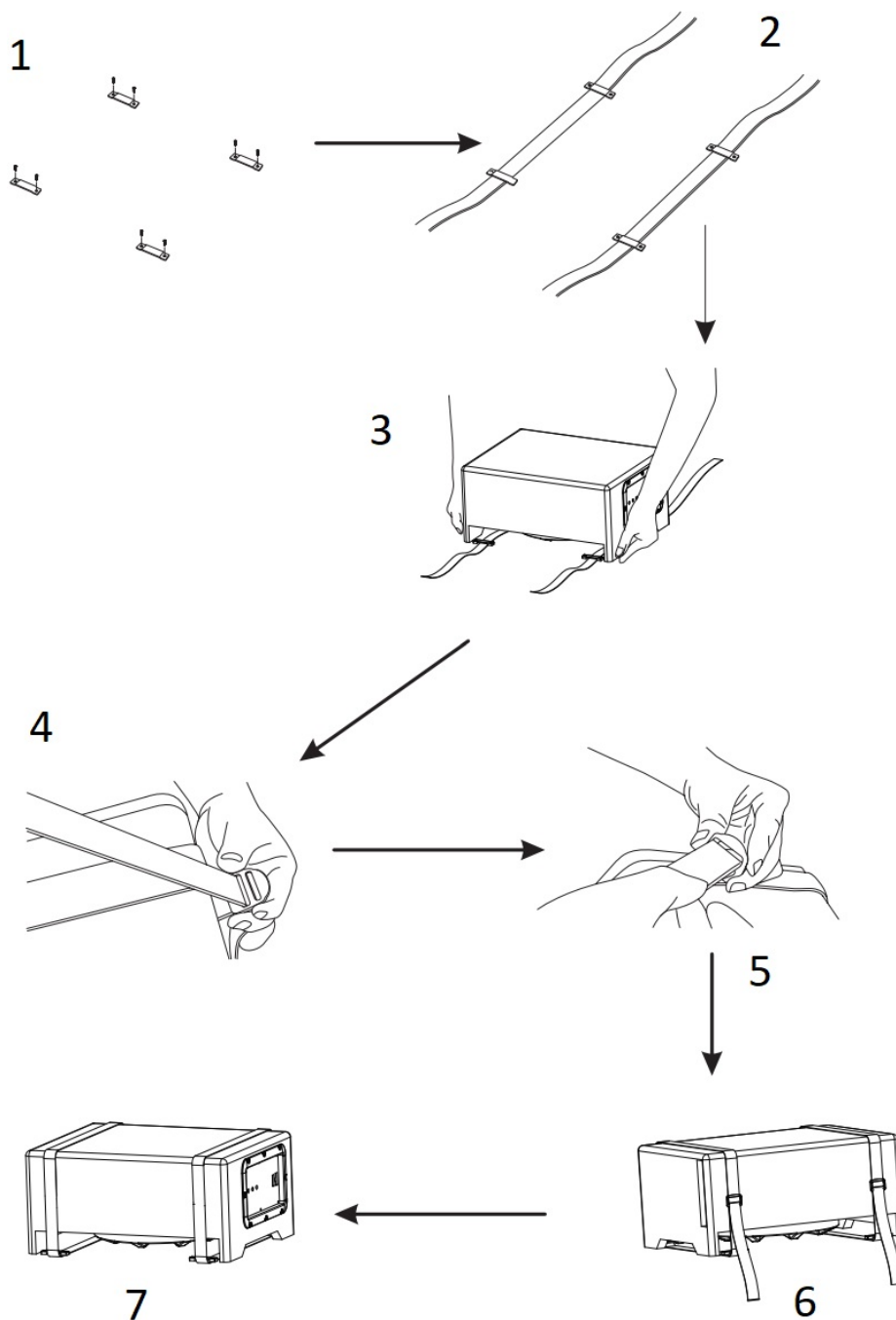

1. Step 1  
Secure the supplied mounting brackets to the desired location of your vehicle's trunk or hatchback as illustrated.
2. Step 2  
Lace the mounting straps so that they pass through the brackets mounted on the base.
3. Step 3  
Place the JW10A on the brackets as shown.
4. Step 4  
Lace the mounting straps through the buckles.
5. Step 5  
Pull the straps to fasten the buckles as tightly as possible.



6. Back view of proper installation
7. Front view of proper installation

---

### Control Setup and Adjustment

<b>Input Signal Connections Low Level (RCA)</b>	Low level (RCA) input signal is preferred for best performance. Typical trunk-mount installations require a 17-20 foot RCA cable. Most trucks and behind-seat applications require a 6-12 foot RCA cable. Using twisted pair construction RCA cables will minimize noise.
<b>Crossover Frequency Control</b>	The adjustable crossover is used to filter out frequencies above 50Hz ~ 250Hz. Adjust it to where the JW10A sound output blends with the rest of the sound system.
<b>Phase Control</b>	The phase control compensates for delay between the JW10A output and the rest of the sound system. Begin with the phase control set to 0 degrees. If the sound is adequate from the normal listening position inside the vehicle, no further adjustment is necessary. If the sound is thin or lacking bass, adjust the phase control until the bass is full and punchy.
<b>Input Level Control</b>	The input level control (LEVEL) is used to obtain the best possible match between the head unit audio output and the amplifier input. Begin by turning the input level control fully counterclockwise. Next, turn up the head unit volume control around 3/4 of the way up. Adjust the input level control clockwise until audible distortion is heard, then slightly counterclockwise to provide the best match.
<b>LED Indicator</b>	The LED indicator illuminates green during normal operation.

### WARRANTY

---

#### One-Year (or Two-Year\*) Limited Warranty

---

This warranty gives you specific legal rights. You may also have other rights which vary from state to state. Namsung America Inc warrants this product to the original purchaser to be free from defects in material and workmanship for a period of one year (or two years\*) from the date of the original purchase. Namsung America Inc agrees, at our option, during the warranty period, to repair any defect in material or workmanship or to furnish an equal new, renewed or comparable product (whichever is deemed necessary) in exchange without charges, subject to verification of the defect or malfunction and proof of the date of purchase. Subsequent replacement products are warranted for the balance of the original warranty period.

**Who is covered?** This warranty is extended to the original retail purchaser for products purchased from an authorized JENSEN dealer and used in the U.S.A.

**What is covered?** This warranty covers all defects in material and workmanship in this product. The following are not covered: software, installation/removal costs, damage resulting from accident, misuse, abuse, neglect,

product modification, improper installation, incorrect line voltage, unauthorized repair or failure to follow instructions supplied with the product, or damage occurring during return shipment of the product. Specific license conditions and copyright notices for the software can be found via [www.jensenmobile.com](http://www.jensenmobile.com).

#### Warranty Coverage

Limited 1-year warranty when purchased from an authorized Jensen dealer.

or

\*Limited 2-year warranty when purchased from and professionally installed by an authorized Jensen dealer.  
(Proof of purchase and Installation required)

#### What to do?

1. Before you call for service, check the troubleshooting guide in your owner's manual. A slight adjustment of any custom controls may save you a service call.
2. If you require service during the warranty period, you must carefully pack the product (preferably in the original package) and ship it by prepaid transportation with a copy of the original receipt from the retailer to an authorized service center.
3. Please describe your problem in writing and include your name, a return UPS shipping address (P.O. Box not acceptable), and a daytime phone number with your shipment.
4. For more information and for the location of the nearest authorized service center please contact us by one of the following methods:
  - Call us toll-free at (888) 921-4088  
(Monday-Friday, 9:00 a.m. to 5:00 p.m. EST)
  - E-mail us at [cs@jensenmobile.com](mailto:cs@jensenmobile.com)

**Exclusion of Certain Damages:** This warranty is exclusive and in lieu of any and all other warranties, expressed or implied, including without limitation the implied warranties of merchantability and fitness for a particular purpose and any obligation, liability, right, claim or remedy in contract or tort, whether or not arising from the company's negligence, actual or imputed. No person or representative is authorized to assume for the company any other liability in connection with the sale of this product. In no event shall the company be liable for indirect, incidental or consequential damages.

#### Notes

<b>For Your Records</b>	Please keep your original sales receipt and be prepared to provide this receipt in the event you require service, as your original receipt is considered the best proof of purchase and indicates the date you purchased your Jensen product.  Dealer Name _____ Dealer Phone _____ Purchase Date _____
<b>Register Your Product</b>	Register your product online at <a href="http://www.jensenmobile.com">www.jensenmobile.com</a>

#### Troubleshooting

Problem	Cause	Action
<b>Unit will not turn on (no power LED indicator)</b>	BAT+ wire not connected or incorrect voltage REM wire not connected or incorrect voltage	Check connections for proper voltage (11~16VDC)
	GND wire not connected	Check connection to ground
	Fuse(s) blown	Replace fuse(s)
<b>Unit has power - LED is green (but no sound)</b>	Volume turned all the way down	Increase volume level at head unit
	Speaker defective or damaged	Check/replace speaker
	Input signal not connected	Check high or low level inputs for proper connection
<b>Unit blows fuse(s)</b>	Incorrect fuse rating	Use fuse(s) with correct rating
	BAT+ wire touching chassis ground	Check for pinched wire
	Speaker defective or damaged	Check/replace speaker
<b>Engine noise</b>	Bad ground connection	Make sure amplifier is grounded to clean bare metal
	Signal ground loop or RFI (radio frequency interference)	Re-route RCA cables from existing high current wiring
<b>Distorted audio output</b>	Incorrect input signal type or input level too high	Check connections and reduce/adjust input level
<b>Low audio output</b>	Incorrect input signal type or input level too low	Check connections and increase or adjust input level
<b>Weak bass</b>	Low frequency output is out of phase	Adjust phase control as needed

### Specifications

<b>Maximum Output Power</b>	300 watts
<b>Continuous Output Power</b>	100 watts
<b>Frequency Response</b>	40-250Hz
<b>Operating Voltage</b>	11.0VDC ~ 14.4VDC Allowed
<b>Impedance</b>	4 Ohms
<b>Crossover Frequency</b>	50–250Hz
<b>Amplifier Type</b>	Class A/B
<b>Phase</b>	0–180 degrees
<b>Fuse</b>	15 amp ATO
<b>Dimensions</b>	Depth (standing): 7.87" / Depth (laying down): 12.6" Height (standing): 12.6" / Height (laying down): 7.87" Width (standing): 16.54" / Width (laying down): 16.54

Design and specifications subject to change without notice.



**Customer Support**

1-888-921-4088

(Monday-Friday, 9AM-5PM EST)

<https://www.jensenmobile.com>

Designed and Engineered in USA



All rights reserved. No part of this publication may be reproduced, distributed, or transmitted in any form or by any means, including photocopying, recording, or other electronic or mechanical methods, without

the prior written permission of NAMSUNG AMERICA INC.

Namsung America Inc.  
©2022 Namsung America  
Inc. All rights reserved.

NSC0322-V01

Documents / Resources

	<p><a href="#">JENSEN JW10A 10 Inch Powered Subwoofer</a> [pdf] Owner's Manual</p> <p>JW10A 10 Inch Powered Subwoofer, JW10A, 10 Inch Powered Subwoofer, Powered Subwoofer, Subwoofer</p>
---	---