



## JCROBOT L7C Pro Smartphone Not Included User Manual

[Home](#) » [JCROBOT](#) » JCROBOT L7C Pro Smartphone Not Included User Manual 

JCROBOT L7C Pro Smartphone Not Included User Manual



## Contents

- 1 Product Introduction
- 2 Product List
- 3 Get to know L7C Pro
- 4 Battery and Charging
- 5 Download Gimbal Pro APP
- 6 Attaching and Powering on
  - 6.1 Attaching the Phone
  - 6.2 Powering on
- 7 How to Use the Gimbal
  - 7.1 On-board Features
  - 7.2 Operating Mode
- 8 How to fold L7C Pro
- 9 How to Use the APP
  - 9.1 How to connect
  - 9.2 Camera view
- 10 Specifications
- 11 Maintenance
- 12 Documents / Resources
  - 12.1 References
- 13 Related Posts

## Product Introduction

The L7C Pro is a three-axis gimbal suitable for mobile phones, controlled by three motors to maintain the continuous stability of the phone and enable it to capture stable and smooth photos/videos.

The gimbal is foldable, making it easy to store and carry. The buttons on the device can easily be used even with one single hand in various scenarios. You can get more smart functions with the Gimbal Pro APP, such as zoom, panoramic, timelapse, vlog mode.

## Product List

- L7C Pro

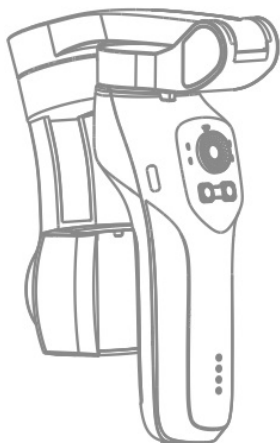

- Tripod



- User Manual



- Power Cable

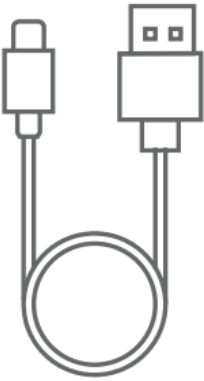

- Storage Pouch

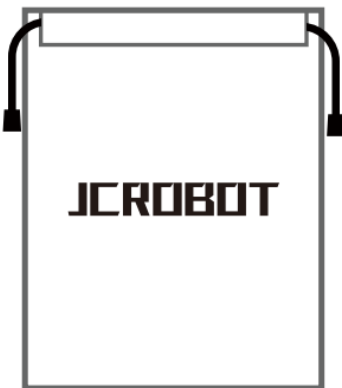

- Lanyard



## Get to know L7C Pro

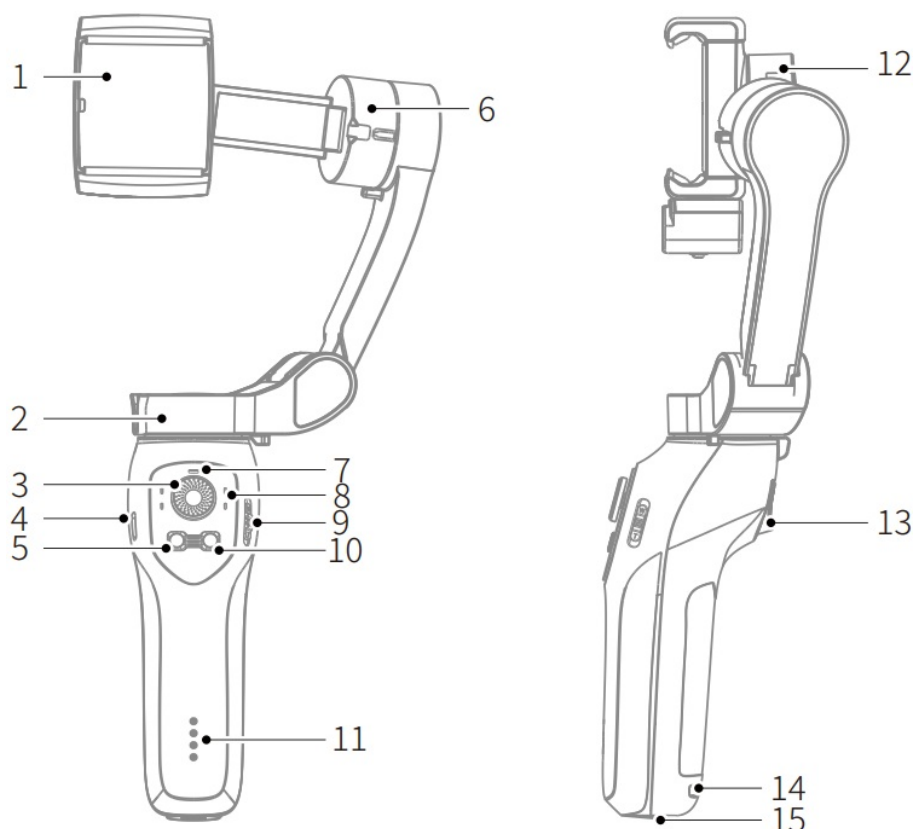

1. Phone Clamp
2. Pan Motor
3. Joystick
4. Charging Port
5. M Button
6. Tilt Motor
7. Device Connection Indicator
8. Gimbal Mode Indicator
9. Zoom Slider
10. Power Button
11. Battery Level Indicator
12. Roll Motor
13. Shutter Button
14. Lanyard Hole
15. 1/4"-20 UNC Port

## Battery and Charging

Please fully charge L7C Pro before using it for the first time.

### Charging Method

To charge L7C Pro, connect a USB adapter (Not included, 5V-2A for best) to the charging port with the provided USB-C charging cable.

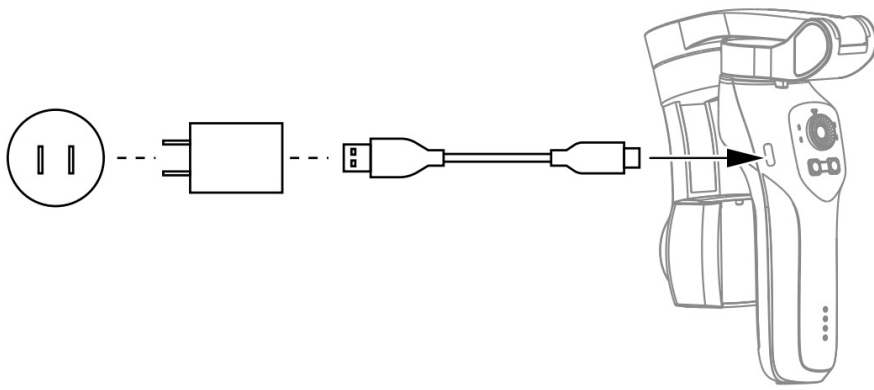

### **Charging Display**

The battery is fully charged when the four lights are on.

#### **Charging (Flashing)**

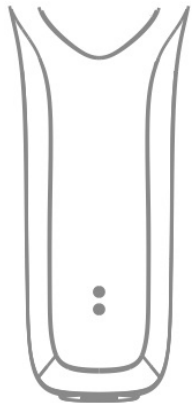

#### **Charging completed (Four lights are on)**

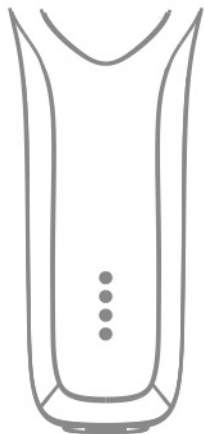

### **Download Gimbal Pro APP**

Scan the QR code or search “Gimbal Pro2” on Google play store or “Gimbal Pro” on App store.

The APP require iOS 12.0 system and later or Android 8.0 system and later.

### **Support iOS and Android**



## Attaching and Powering on

### Attaching the Phone

1. Unfold the gimbal as shown

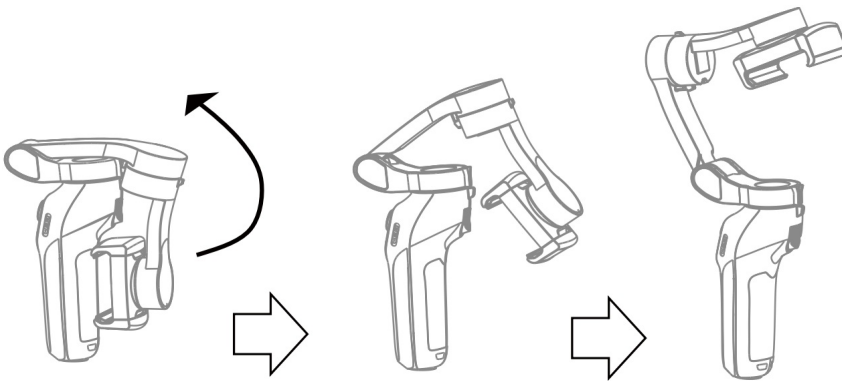

2. Attaching the Phone

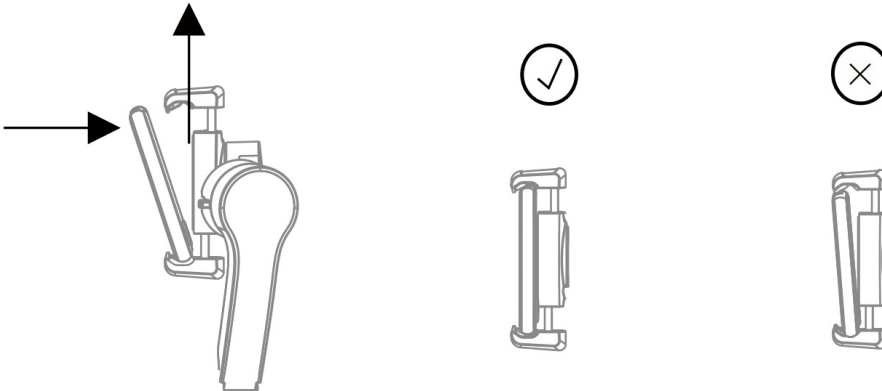

Make sure the phone camera is on the left side of the clamp. Insert your mobile device by putting it stuck in the bottom of phone clamp and pulling the top side of the clamp to clip it into place. Make sure the phone is held securely in the clamp.

Make sure the direction of the phone clamp is the same as shown in the figure left.  
For optimal performance, make sure the phone clamp is in the middle of the mobile phone, and the distance between the clamp arms is the same.

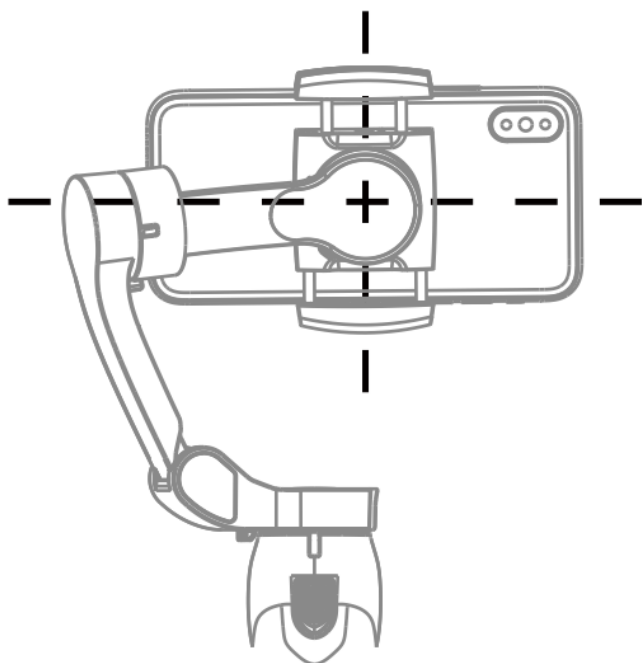

## Powering on

Press and hold the Power Button for 1s – Power on/off.

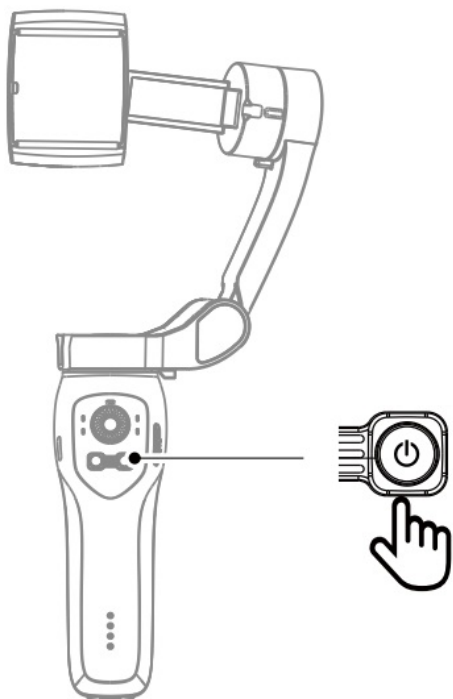

## How to Use the Gimbal

### On-board Features

### System Status Indicator

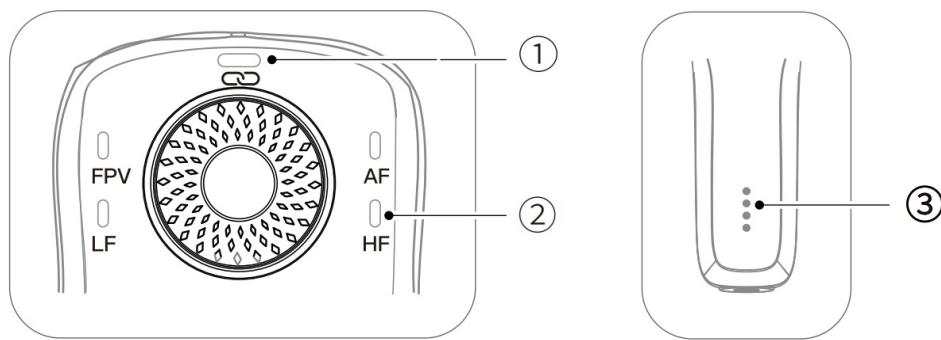

### 1. Device Connection Indicator

**Slow Flashing:** device is not connected.

**Fast Flashing:** device is connecting.

**Light is on:** device is connected.

### 2. Gimbal Mode Indicator

**Light is on:** Displays the current follow mode of the gimbal  
(**HF:** Default mode upon powering on).

### 3. Battery Level Indicator

**Four lights are on:** battery level 76% ~ 100%.

**Three lights are on:** battery level 50% ~ 75%.

**Two lights are on:** battery level 26% ~ 49%.

**The first light is on:** battery level 1% ~ 25%.

## Button Function

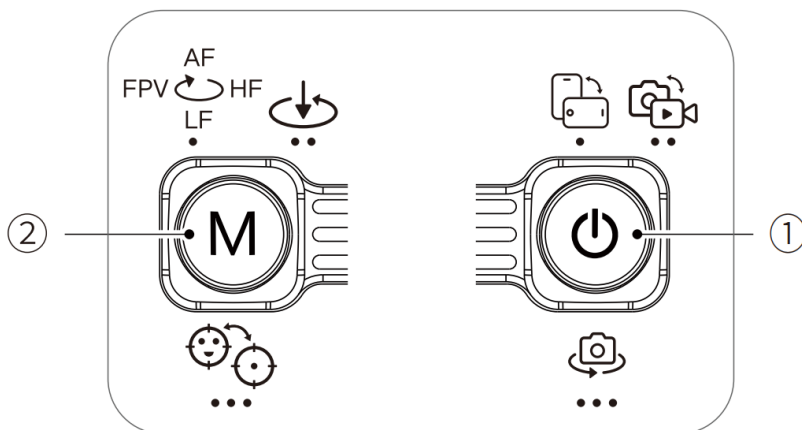

### 1. Power Button

**Press once:** switch between landscape and portrait mode, or restart gimbal when it is stuck.

**Press twice:** switch between photo and record mode (Requires to be used with Gimbal Pro APP).

**Press three times:** switch between the front and rear cameras of your mobile phone (Requires to be used with Gimbal Pro APP).

Portrait mode



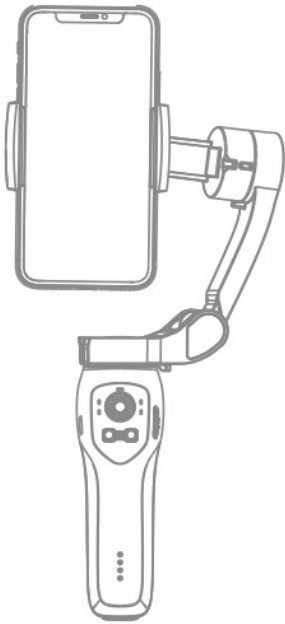

Landscape mode

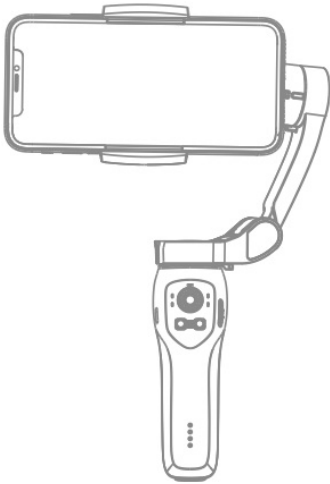

## 2. Mode Button

**Press once:** switch between gimbal modes (**HF-LF-FPV-AF**).

**Press twice:** smartphone back to center.

**Press three times:** quick access to tracking mode options (Requires to be used with Gimbal Pro APP).

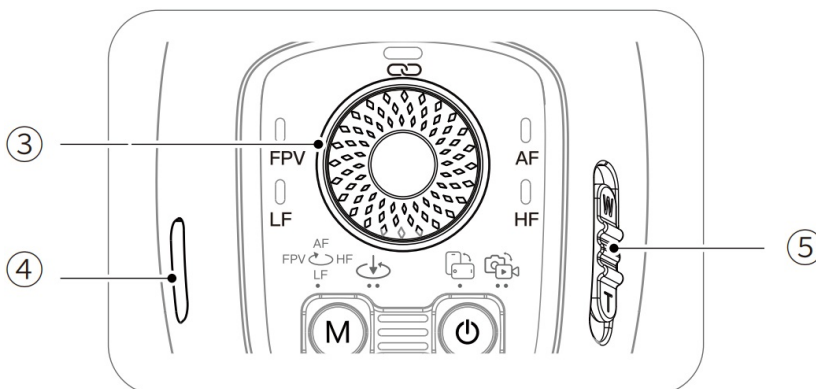

## 3. Joystick

Move vertically and horizontally to tilt and pan the mobile phone. Direction control of Joystick also can be set in Gimbal Pro APP.

## 4. Charging Port

Charge gimbal by connecting a Type-C cable to this port.

## 5. Zoom Slider

Push the slider up/down to zoom in/out (Requires to be used with Gimbal Pro APP).

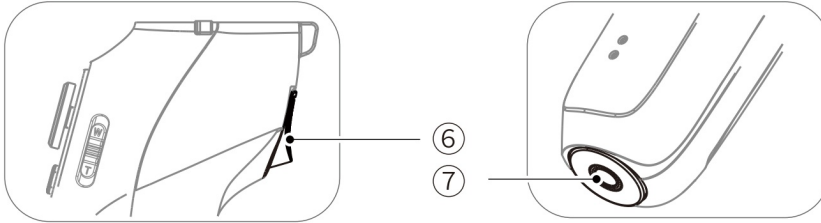

## 6. Shutter Button

Requires to be used with Gimbal Pro APP.

**Press once:** shoot a photo or start/stop recording (Also support native camera after connect to the device).

**Press twice:** suspend/recover the recording.

**Press three times:** capture pictures during recording.

**Press and hold:** burst shooting while under photo mode.

## 7. 1/4 “-20 UNC Port

Can be used to attach a tripod.

## Combination Operation

Press the shutter button and power button at the same time for three seconds to reset the Device name and disconnect, new phone can be connected quickly.

## Gimbal mode

To switch between gimbal modes, please press the M button once (**HF-LF-FPV-AF**).

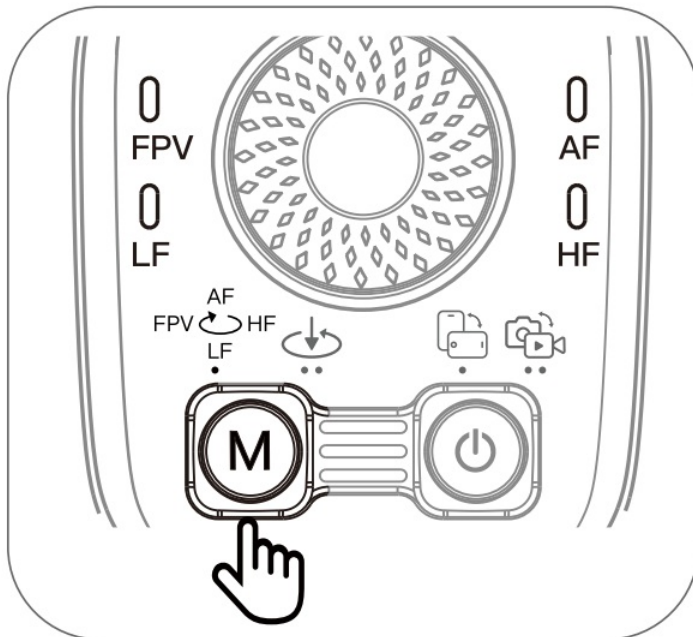

**Half Follow (HF):** only the pan axis follows, where only the pan axis follows the movement of the grip. Suitable for scenarios such as arc shots or moving from left to right.

※ Default mode upon powering on.

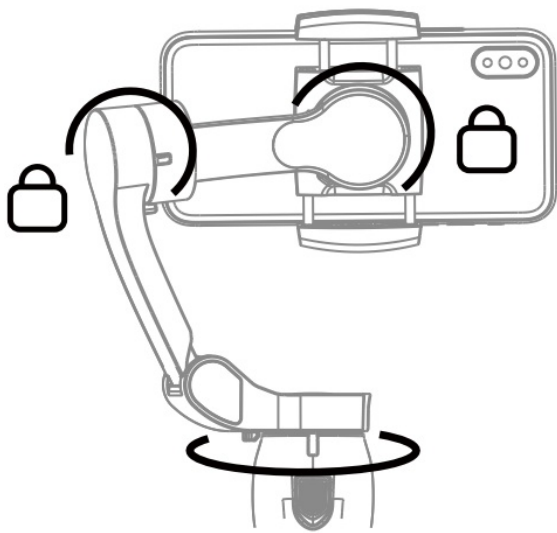

**Lock Full (LF):** Pan, Tilt, Roll axes are all locked. Screen stays the current scene.

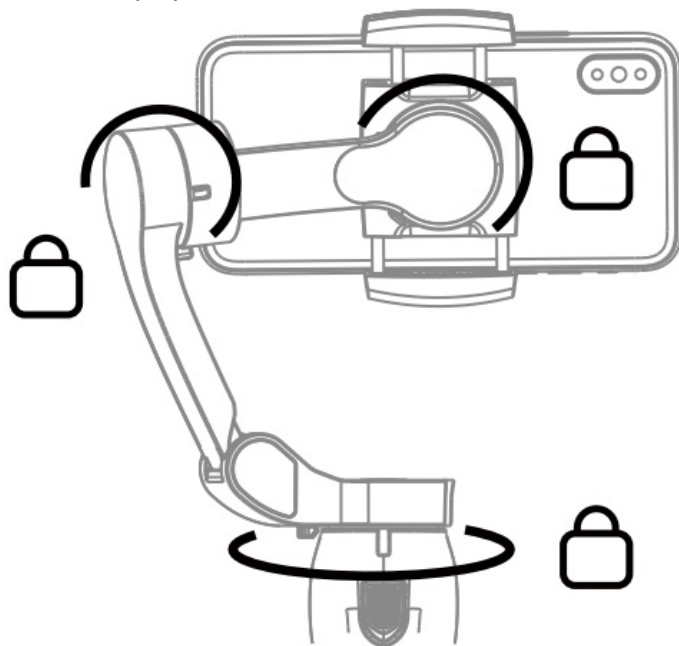

**First person view (FPV):** pan, tilt, and roll axes follow, where all three axes follow the movement of the grip. Suitable for shooting the first-person view.

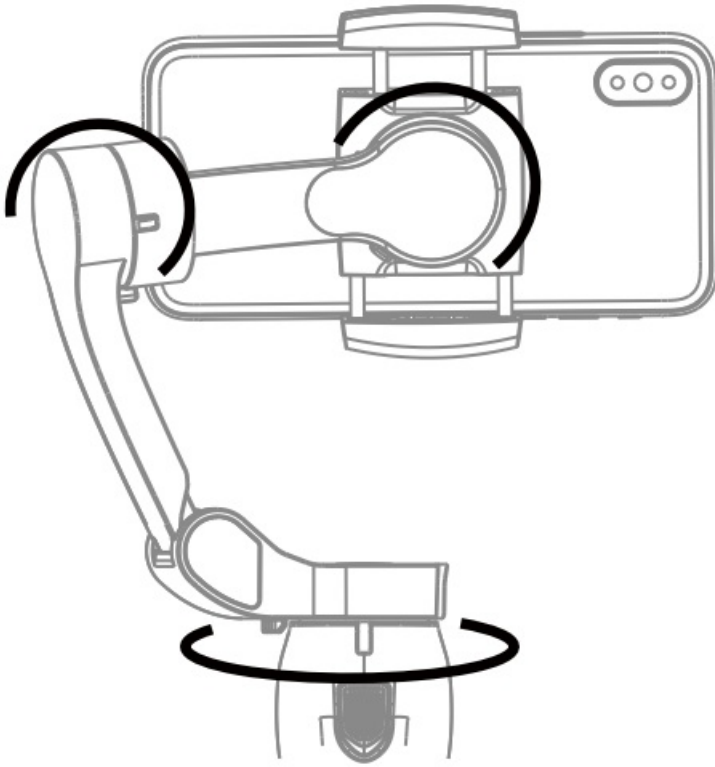

**All Follow (AF):** pan and tilt axes follow, where both the pan and tilt axes follow the movement of the grip. Suitable for scenarios when moving up and down or on a slant.

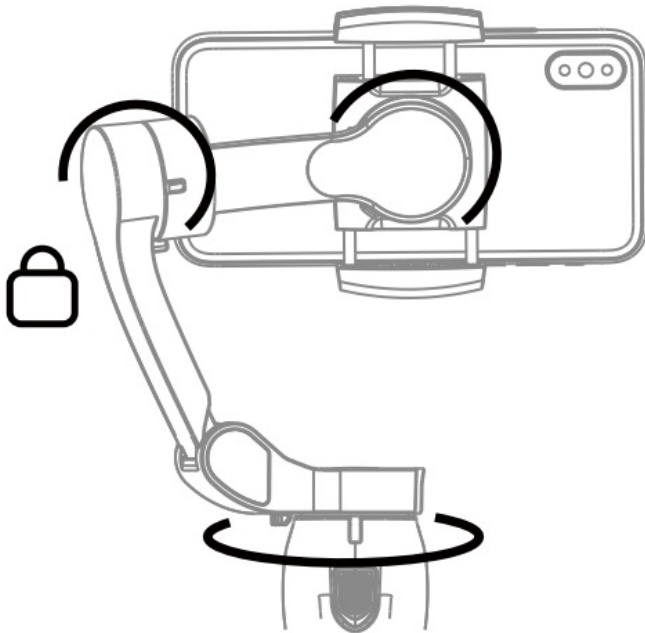

## Operating Mode

Operation modes apply when used in portrait and landscape mode.

## Upright Mode

Upright mode can be used without any further user input.

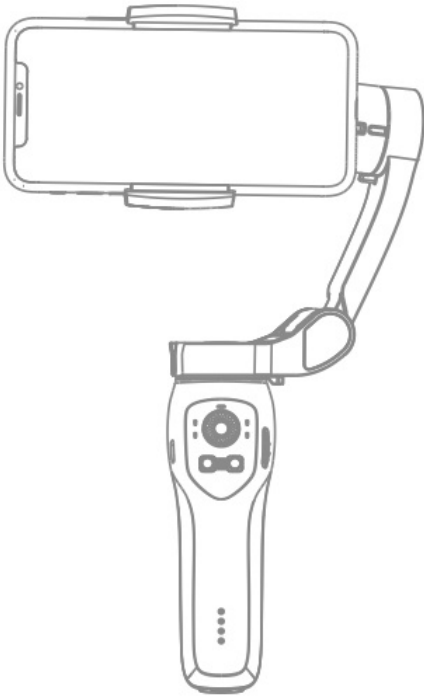

### **Side Grip Mode**

Rotate L7C Pro to the right or left by 90° to change from Upright to Side Grip mode.

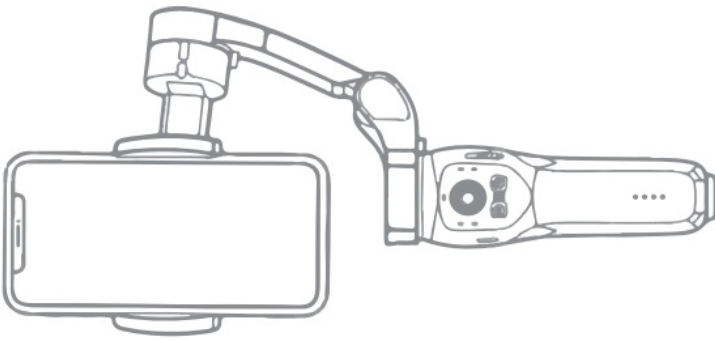

### **Under slung Mode**

Hold L7C Pro upside down to switch Under slung mode, in which the mobile phone can easily capture images from lower position.

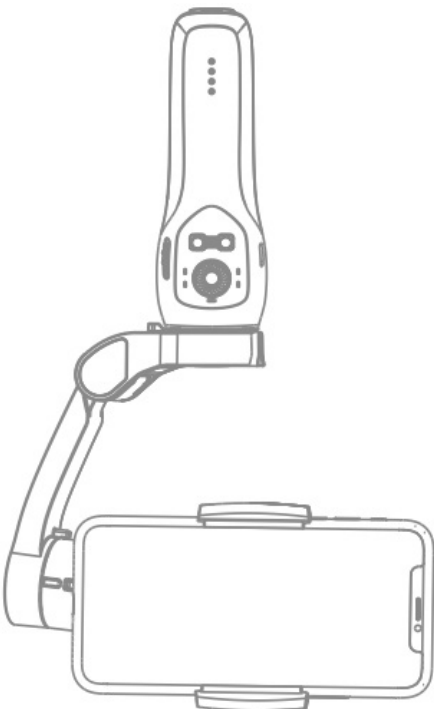

### Low Position Mode

Adjust the angle to Low Position mode. Use Low Position mode to shoot from a low angle.

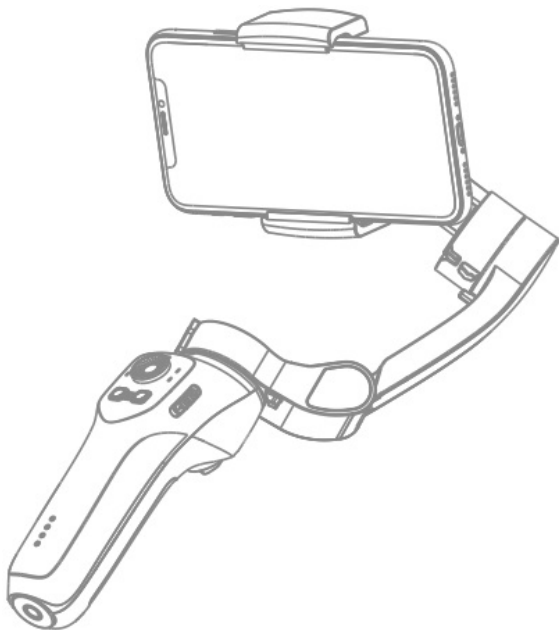

### How to fold L7C Pro

L7C Pro is foldable design and in a locked state after folding, making it easy to store, carry, and transport.  
Step:

1. Press the power button for 1 second to power off;
2. After shutting down, the device will automatically turn to the foldable position;
3. Grasp the pan axis and roll axis, align the buckles of the roll axis and pan axis, and fold the gimbal.

#### Fold the gimbal as shown:

1. Go to storage position

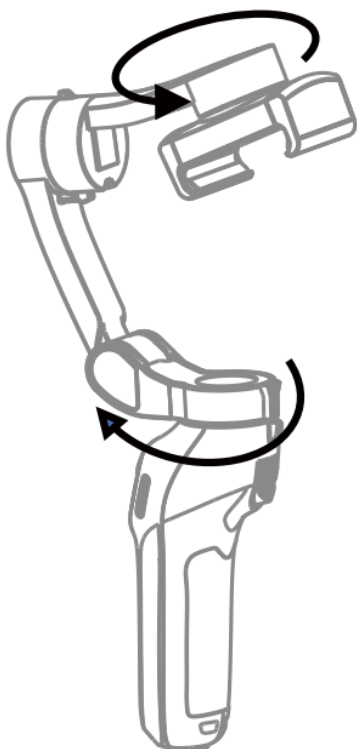

2. Align buckle

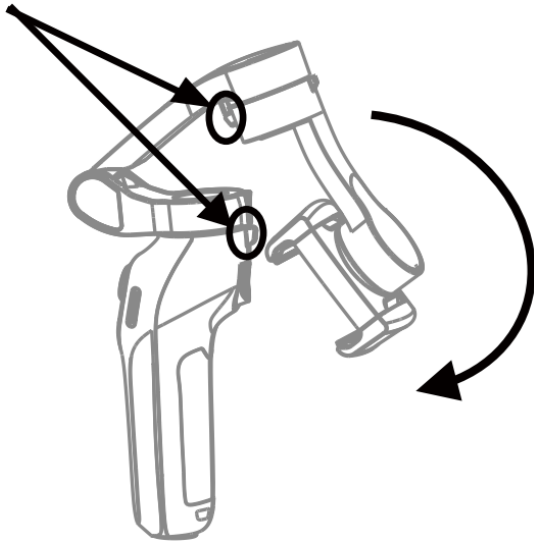

3. Fold

4. Folded state



## How to Use the APP

### How to connect

1. Power on the L7CPro;
2. Goto the Gimbal Pro APP, and allow the prompts to connect L7C Pro device

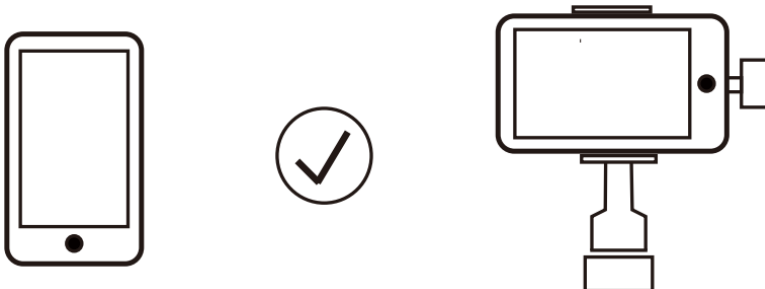

### Camera view



#### 1. Home



:Tap to return to the home screen.

#### 2. Camera Settings



:Settings for flash, filters, white balance, HDR, beauty, etc.

#### 3. Gimbal Mode



:Enable live face tracking, when use other APP to live broadcast and record, can realize face tracking,

**Follow Mode:** choose from HF, LF, FPV, AF.

**Scene Mode:** provides walk, sport and super follow mode.

#### 4. Settings



:Gimbal Settings

##### a. Joystick

Rapid Configuration: tap to set the maximum speed when controlling the joystick (fast/medium/slow) Joystick

Control Direction: choose from Free and H/V.

Free enables the gimbal to be controlled in horizontal and vertical direction simultaneously.

H/V enables the gimbal to be controlled in a horizontal or vertical direction.

**Left and right revers:** the pan-axis movement direction is inverted.

**Upside down:** the tilt-axis movement direction is inverted.

##### b. Follow Speeds

**Horizontal Speed:** provides Fast, Medium, and Slow follow speed.

**Vertical Speed:** provides Fast, Medium, and Slow follow speed.

**c. Calibration** Fine-tune the level: make sure the phone clamp is level state before adjusting the gimbal.

Tap "Start Calibration" to adjust the horizontal angle.

IMU Calibration: Before calibrating, place L7C Pro on a flat surface using a tripod. Do not touch the gimbal during calibration,

Tap "Start Calibration", gimbal is automatically calibrated to minimize drift due to human error or other factors.

##### General Settings

Includes information such as Device Management, Device Name, Version Information and Device Serial Number.

#### 5. Mobile Phone Battery Level





:Displays the current battery level of the mobile phone.

#### 6. Flash



Displays the flash status.

#### 7. Gimbal Battery Level



:Displays the current battery level of the gimbal.

#### 8. Gimbal Mode



Displays the current gimbal mode: HF, LF, FPV, AF.

#### 9. Smart Tracking



**[CH Tap to choose a tracking mode:**

Face tracking, Object tracking. The subject will remain in the center of the camerview by default. Face tracking: device will detect face automatically and start tracking, tap the icon to exit tracking Object tracking: drag the box icon on the screen in the camera view. A green box around the subject indicates tracking is successfully enabled, tap the icon to exit tracking,

#### 10. Shooting Modes



**Tap to choose a shooting mode:** Photo, Video, Vlog mode.

#### 11. Shooting Parameters Settings



Shooting Parameters can be set according to the shooting mode. Tap the icon to access settings.

**Single:** tap to take a single shot photo. Press and hold for burst shooting.

**Pano:** tap to take a 180°, 330°, or 3×3 photo

**Default:** tap to shoot a normal video.

**Slow Motion:** shoot a slow motion video at 240fps.

**M-Timelapse:** select up to ten positions and the gimbal will move to each position in sequence, set the stay time and rotation speed and start to shoot.

**Vlog Mode:** provides several templates for recording video.

#### 12. Shutter/Record Button



:Tap to take a photo or to start or stop recording video,

#### 13. Front/Rear camera Switch



Tap to switch between the front and rear cameras of your mobile phone,

#### 14. Album



Tap to enter the album.

#### 15. Gesture Control Switch (Only support iPhone)



Tap to access Gesture Control settings



After the gesture control is turned on, make a “fist” gesture towards the camera and hold for 1-2 seconds to start taking photos or recording.



Gesture “palm” to stop it.

## Specifications

Gimbal Dimension	Unfolded: 260*130*88mm
Net Weight	355g
Compatible smartphone range	Diagonal: 180mmWidth: 55-90mmThickness: 9.5mm
Tile Angle	160°
Roll Angle	325°
Controllable Tilt Angle	+50°~-40°
Controllable Roll	+180°~-150°
Controllable Pan	+250°~-90°
Working temperature	0°C~40°C
Working Voltage	3.4~4.2V (Standard 3.7V)
Working Current	150~3000mA (Standard 1500mA)
Input Voltage	5V
Input Current	2A
Charging Time	80min (Use 5V/2A adapter)
Working Time	4.5~5H
APP	YES

## Caution

1. L7C Pro is not water resistant. DO NOT allow the product to come into contact with any kind of liquid. DO NOT leave the product out in the rain or near a source of moisture. If the inside of the battery comes into contact with water, chemical decomposition may occur, potentially resulting in the battery catching on fire, and may even lead to an explosion.
2. Never disassemble or pierce the product in any way or the battery may leak, catch fire, or explode.
3. The product should be used in temperatures from 0°C to 40°C (32°F to 104°F). Use of the product in environments above 40°C (104°F) can lead to a fire or explosion. Use of the product below 0°C (32°F) can lead to permanent damage.
4. Make sure there is nothing obstructing the gimbal when it is powered on.
5. Intricate components inside L7C Pro may be damaged upon impact and cause the gimbal to be damaged. DO NOT drop or strike the product. DO NOT place heavy objects on the product.

6. Itisagood practice to monitor the charging progress and disconnect the product when fully charged.

Maintenance

- 1. **DO NOT** use any liquid cleansers. Only use a soft dry cloth to clean it. Never disassemble or pierce the porductin any way or the battery may leak, catch fire, or explode.
- 2. Fold L7C Pro correctly before storage. Make sure there is nothing obstructing the gimbal when it is powered on.
- 3. **DO NOT** store the product fully discharged for an extended period. Otherwise, it will over discharge which will lead to permanent damage.
- 4. **DO NOT** leave the product near heat sources such asa furnace or heater. DO NOT leave the product inside of a vehicle on hot days. The ideal storage temperature is 22°C to 28°C (72°F to 82°F).

JCROBOT

Documents / Resources

	<p><a href="#">JCROBOT L7C Pro Smartphone Not Included</a> [pdf] User Manual</p> <p>L7C Pro Smartphone Not Included, L7C, Pro Smartphone Not Included, Smartphone Not Includ ed, Not Included, Included</p>
-------------------------------------------------------------------------------------	-------------------------------------------------------------------------------------------------------------------------------------------------------------------------------------------------------------

References

- [User Manual](#)