



JBL Wireless Quantum Stream User Guide

[Home](#) » [JBL](#) » JBL Wireless Quantum Stream User Guide 



by **HARMAN**
JBL QUANTUM STREAM
WIRELESS FOR LIGHTNING CONNECTION
QUICK START GUIDE





JBL Headphones app

On your iPhone, download the JBL HEADPHONES app from Apple App Store to gain even more control and personalization on your JBL Quantum Stream Wireless, such as microphone gain, noise suppression, and sound effects.

Contents

- 1 WHAT'S IN THE BOX
- 2 HOW TO WEAR
- 3 FIRST TIME USE
- 4 POWER ON & CONNECT
- 5 CHARGE & RECORD
- 6 BUTTON CONTROLS
- 7 POWER OFF
- 8 DO MORE WITH THE APP
- 9 CHARGING
- 10 LED BEHAVIORS
- 11 TECH SPEC
- 12 Documents / Resources
 - 12.1 References
- 13 Related Posts

WHAT'S IN THE BOX



MICROPHONE

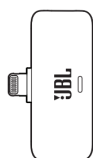

2.4GHz RECEIVER



CHARGING CASE

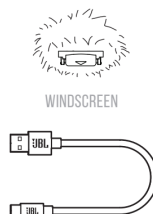

WINDSCREEN
USB CHARGING CABLE



QSG | WARRANTY CARD |
WARNING CARD

HOW TO WEAR

Clip the microphone to your desired position to capture sound from all directions.

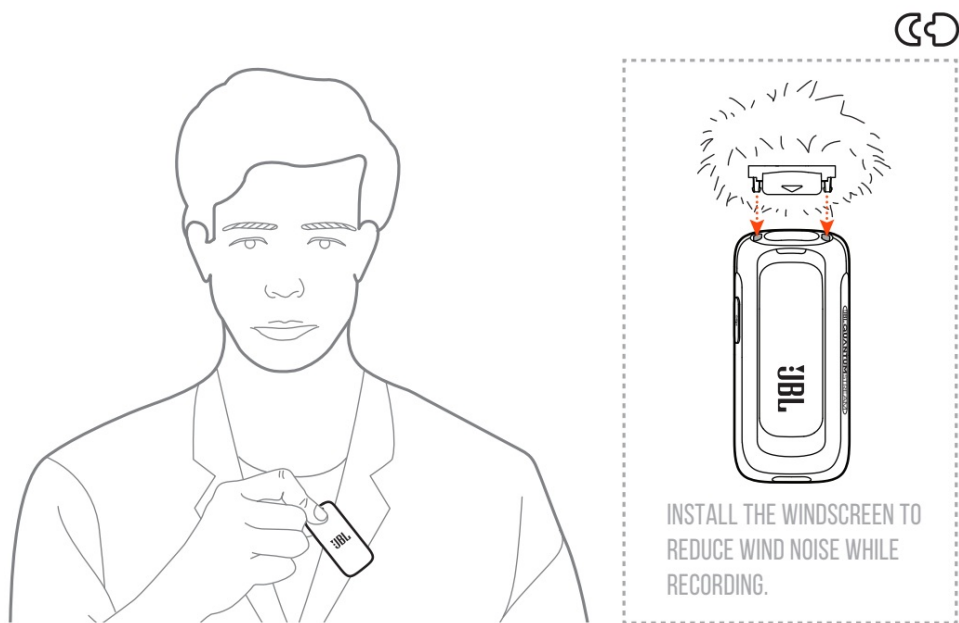

FIRST TIME USE

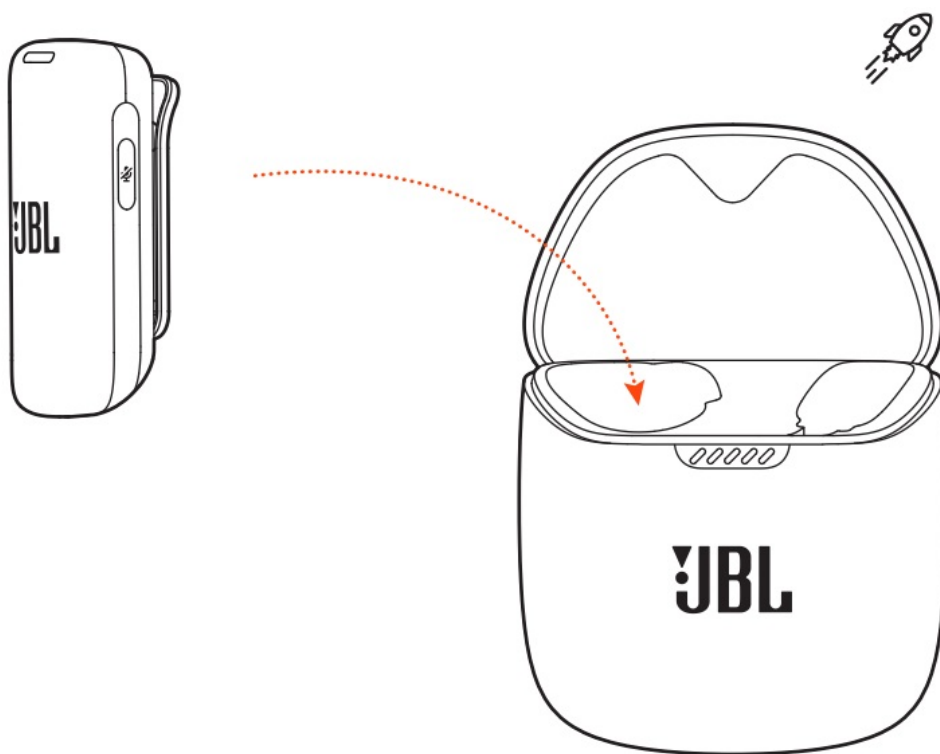

POWER ON & CONNECT



CHARGE & RECORD

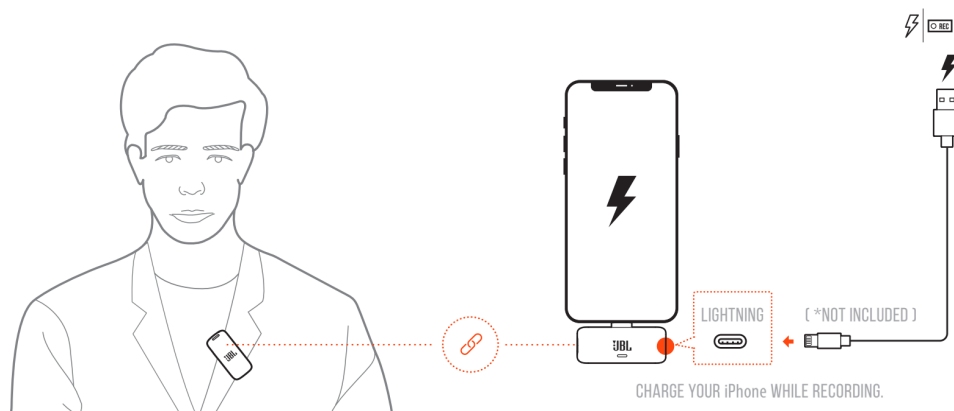

BUTTON CONTROLS

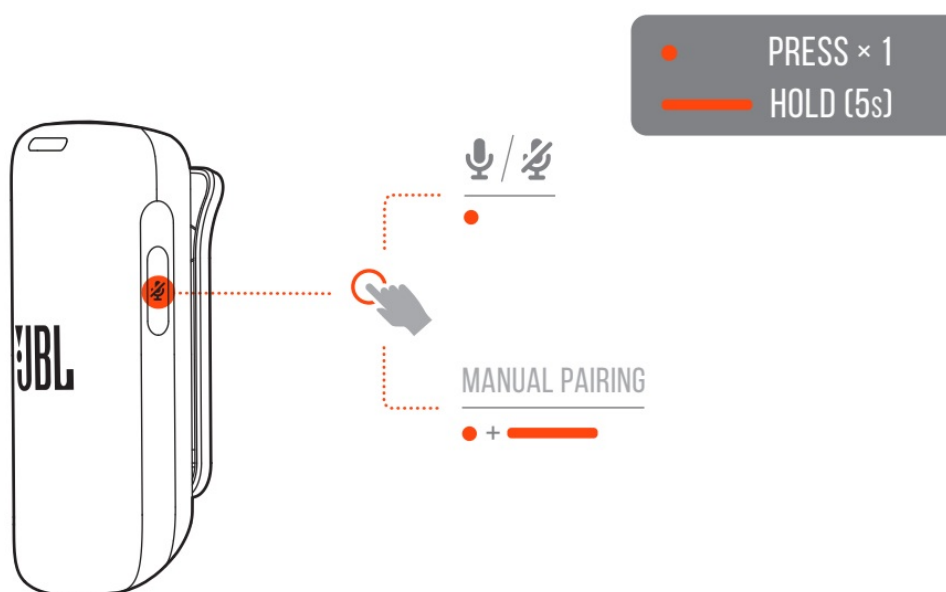

POWER OFF

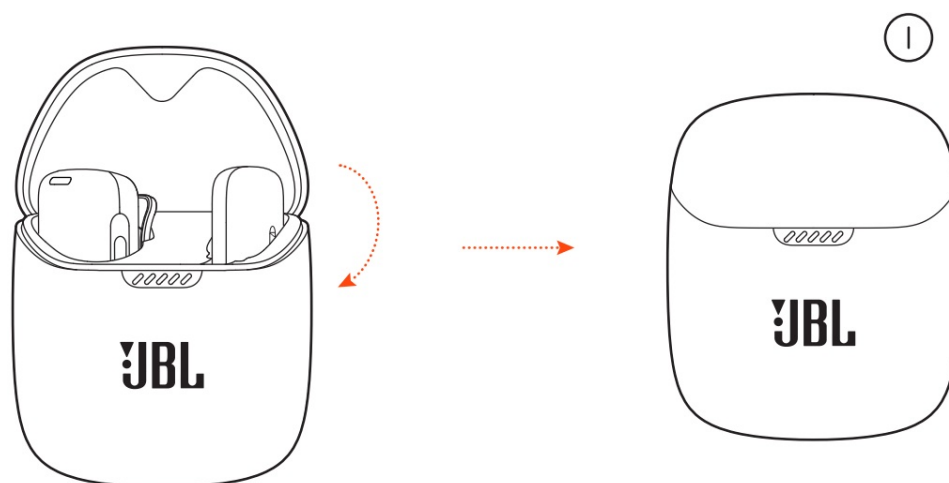

DO MORE WITH THE APP

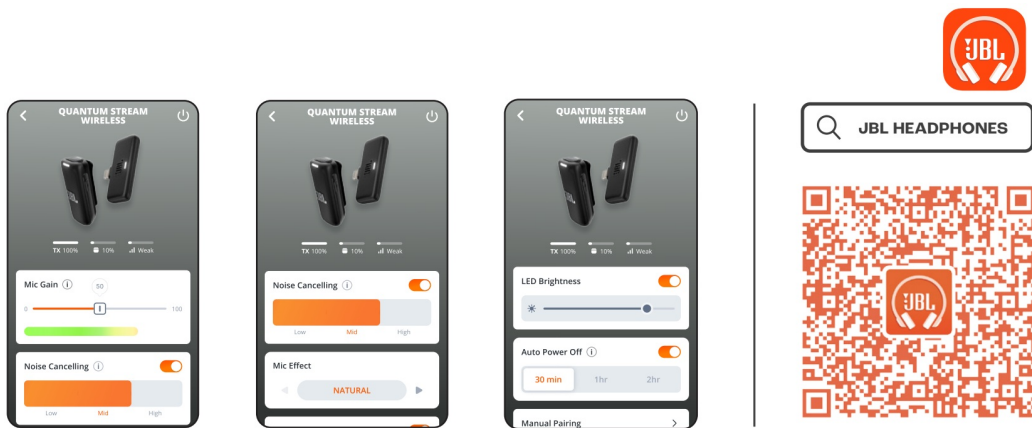

<https://storage.iscloud.harman.com/Testing/MyJBLHeadphones/QRCodeDownload/appstore/jblheadphone.html>

CHARGING

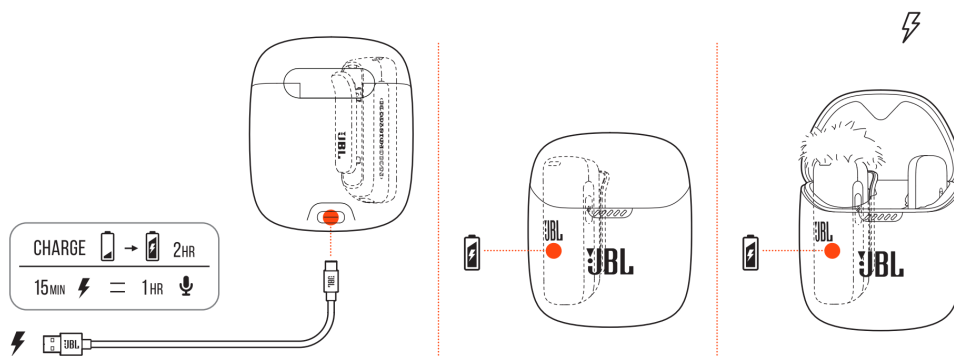

LED BEHAVIORS

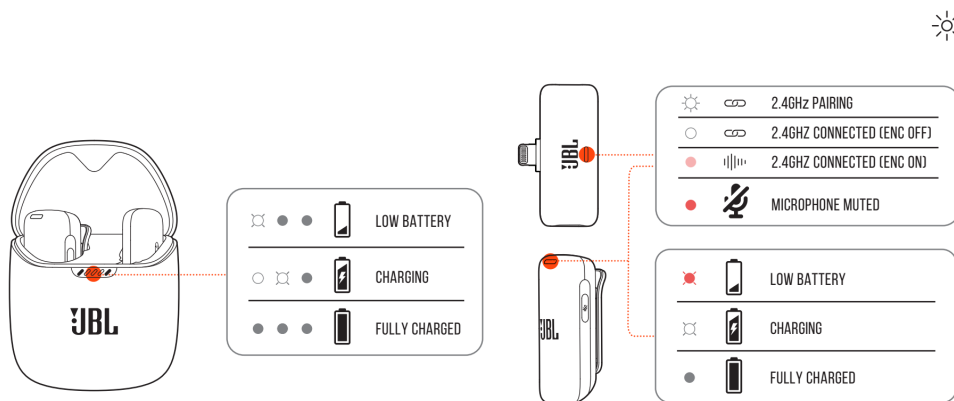

TECH SPEC

Model:	QUANTUM STREAM WIRELESS
Power supply:	5V 1A
Type:	Condensor microphone
Polar patterns:	Omnidirectional
Frequency response:	20 Hz – 20 kHz
Sensitivity:	-36 dBV/Pa@1kHz
Maximum SPL:	100 dB SPL (1kHz @ 1m) dBu
Dynamic range:	86 dB
Bit depth:	16 bit
Sample rate with ENC off:	48 kHz
Sample rate with ENC on:	16 kHz
Microphone:	11.2 g / 0.025 lbs
Dongle:	6.6 g / 0.015 lbs
Charging case:	47.4 g / 0.104 lbs
Microphone battery type:	Lithium-ion polymer (130 mAh / 3.85 V)
Charging case battery type:	Lithium-ion polymer (550 mAh / 3.7 V)
Charging time:	2 hrs from empty
Recording time (ENC on/off):	Up to 6 hrs
Equivalent noise (dBA):	22 dBA
2.4GHz Wireless transmitter frequency range:	2.406 GHz – 2.474 GHz
2.4GHz Wireless transmitter modulation:	GFSK
2.4GHz Wireless transmitter power:	< 10 dBm (EIRP)
Maximum operation temperature:	45°C



IPX4

⚠ TO PROTECT BATTERY LIFESPAN, FULLY CHARGE AT LEAST ONCE EVERY 3 MONTHS. BATTERY LIFE WILL VARY DUE TO USAGE PATTERNS AND ENVIRONMENTAL CONDITIONS.

ISED RF Exposure Information and Statement for Wireless Microphone

This equipment complies with ISED radiation exposure limits set forth for an uncontrolled environment. End user must follow the specific operating instructions for satisfying RF exposure compliance. This transmitter must not be co-located or operating in conjunction with any other antenna or transmitter
The SAR limit of Canada is 1.6 W/kg averaged over one gram of tissue. Device types: (IC: 6132A-QSTREAMWL) has also been tested against this SAR limit According to this standard, the highest SAR value reported during product certification for use when properly worn on the body is 0.588 W/Kg.

ISED RF Exposure Information and Statement for USB Wireless Dongle

This equipment complies with ISED radiation exposure limits set forth for an uncontrolled environment. End user must follow the specific operating instructions for satisfying RF exposure compliance. This transmitter must not be co-located or operating in conjunction with any other antenna or transmitter
The SAR limit of Canada is 1.6 W/kg averaged over one gram of tissue. Device types: (IC: 6132A-QSTREAMWLT!) has also been tested against this SAR limit According to this standard, the highest SAR value reported during product certification for use when properly worn on the body is 0.183 W/Kg.

Body operation

The device was tested for typical bodily operations where the product was kept with 0 mm distance attaching away from the body. Non-compliance with the above restrictions may result in violation of IC RF exposure guidelines. Use only the supplied or approved antenna.

IC: 6132A-QSTREAMWL;
IC: 6132A-QSTREAMWLT!

WARNING

DO NOT ATTEMPT TO OPEN, SERVICE, OR DISASSEMBLE THE BATTERY | DO NOT SHORT CIRCUIT | MAY EXPLODE IF DISPOSED OF IN FIRE | RISK OF EXPLOSION IF BATTERY IS REPLACED BY AN INCORRECT TYPE | DISPOSE OR RECYCLE USED BATTERIES ACCORDING TO THE INSTRUCTIONS

Microphone:

FCC ID: APIQSTREAMWL;
IC:IC: 6132A-QSTREAMWL;

Dongle:

FCC ID: APIQSTREAMWLT!
IC: 6132A-QSTREAMWLT!

Product specifications and app screens are subject to change without notice.
HP_Quantum Stream Wireless MIC For Lighting_QSG_Global_SOP_V9

Documents / Resources

	JBL Wireless Quantum Stream [pdf] User Guide Wireless Quantum Stream, Quantum Stream, Stream
---	---

References

- [User Manual](#)

[Manuals+](#), [Privacy Policy](#)

This website is an independent publication and is neither affiliated with nor endorsed by any of the trademark owners. The "Bluetooth®" word mark and logos are registered trademarks owned by Bluetooth SIG, Inc. The "Wi-Fi®" word mark and logos are registered trademarks owned by the Wi-Fi Alliance. Any use of these marks on this website does not imply any affiliation with or endorsement.