

[Skip to content](#)

Manuals+

User Manuals Simplified.

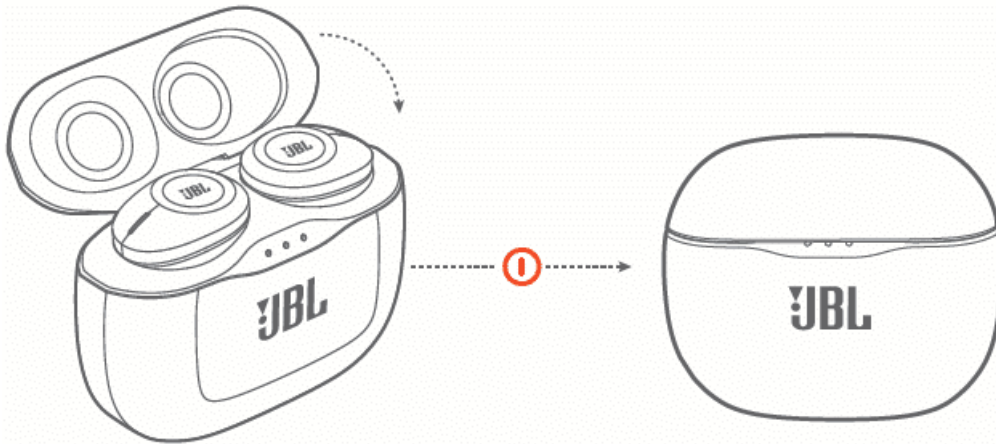

JBL Tune 120 TWS Earbuds User Manual

[Home](#) » [JBL](#) » JBL Tune 120 TWS Earbuds User Manual

Quick Start Guide
UNE120TWS

WHAT'S IN THE BOX



How to Wear

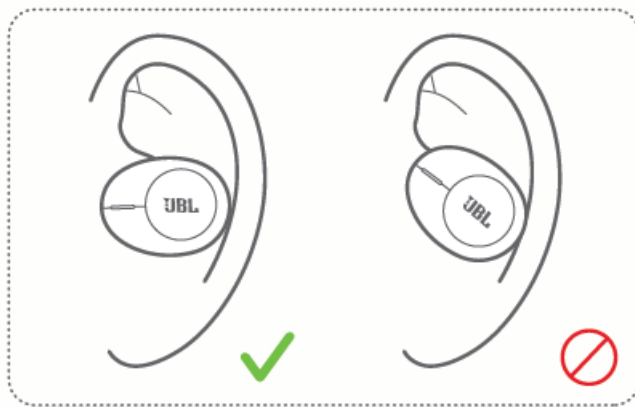
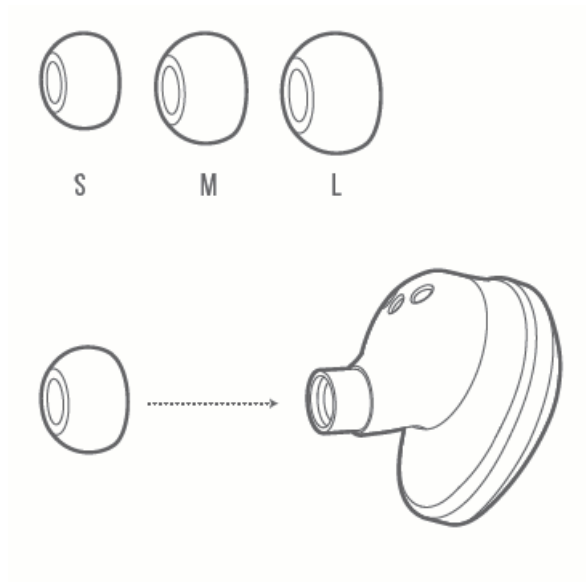

First Time Use

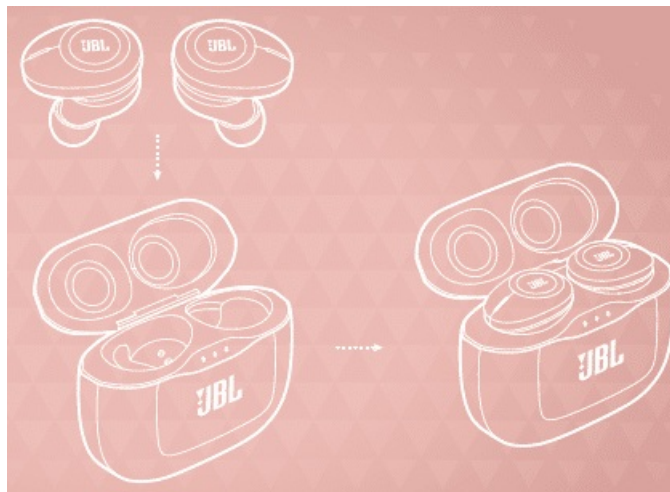

Power on & Connect

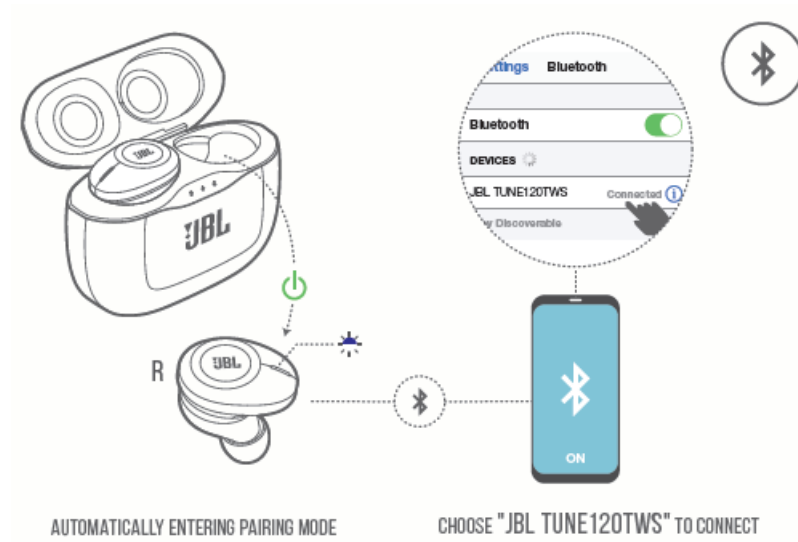

Pairing

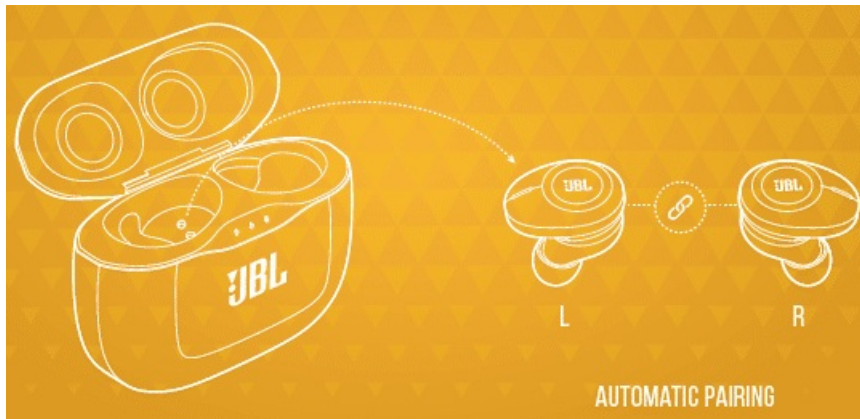

Power OFF

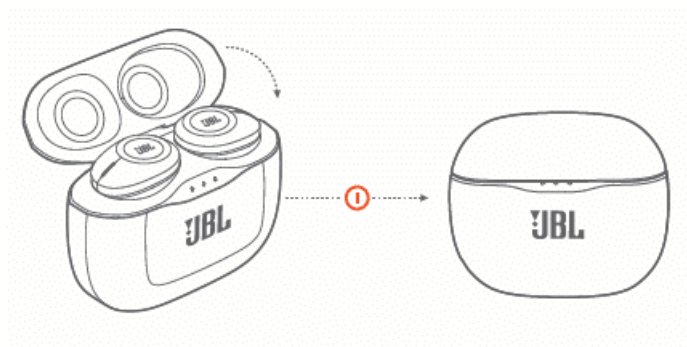

Power on & connect to device

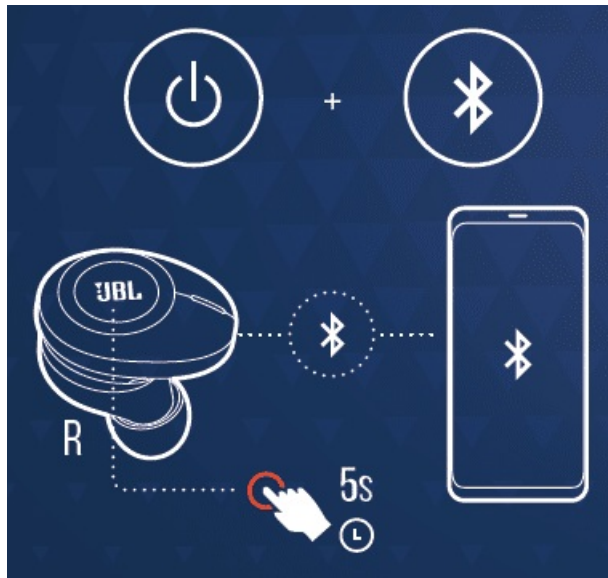

CONNECTING

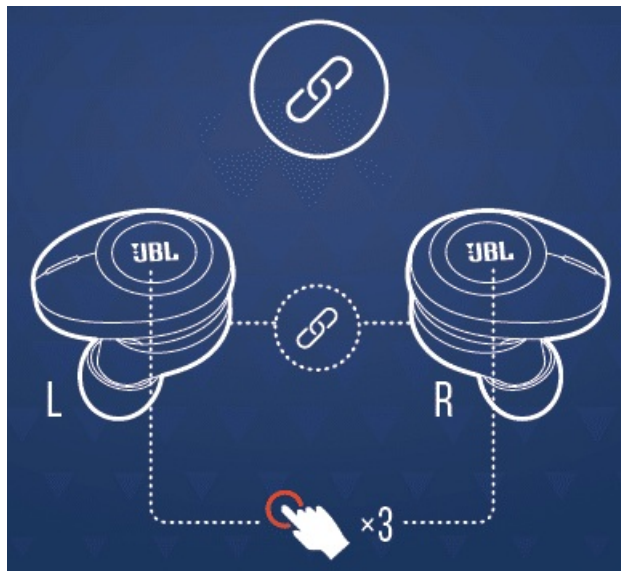

Power ON / OFF

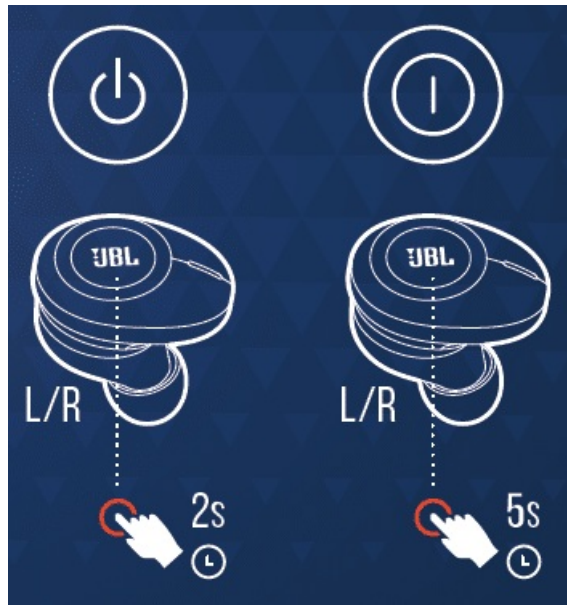

BUTTON COMMAND

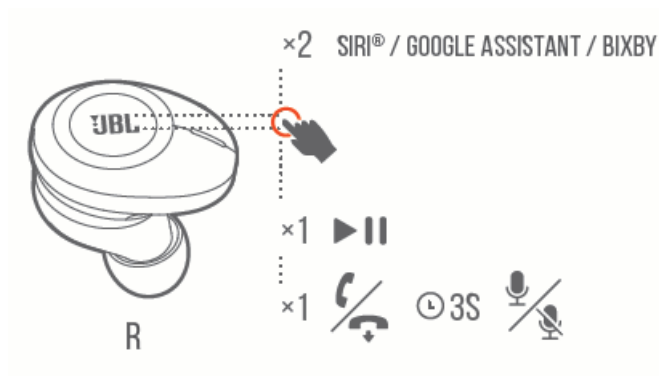
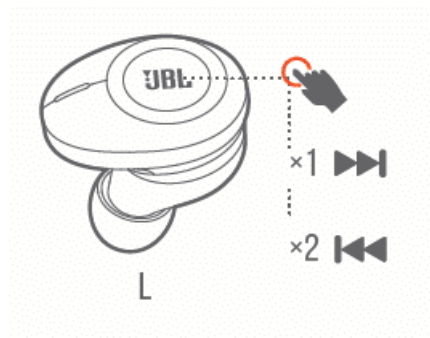

Charging Time

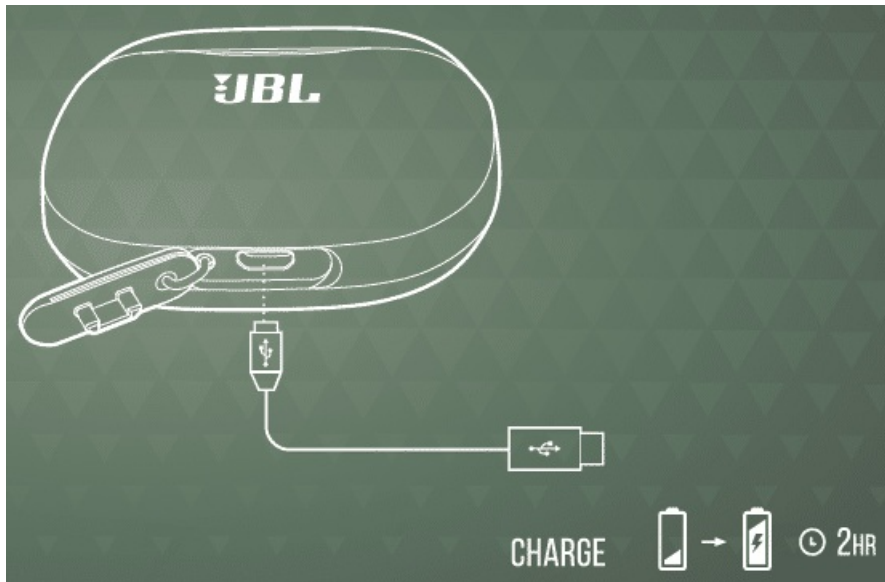

LED Behaviors

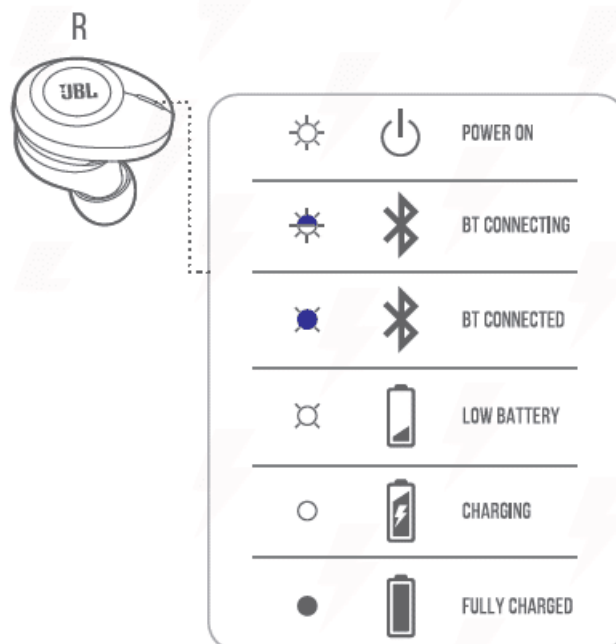
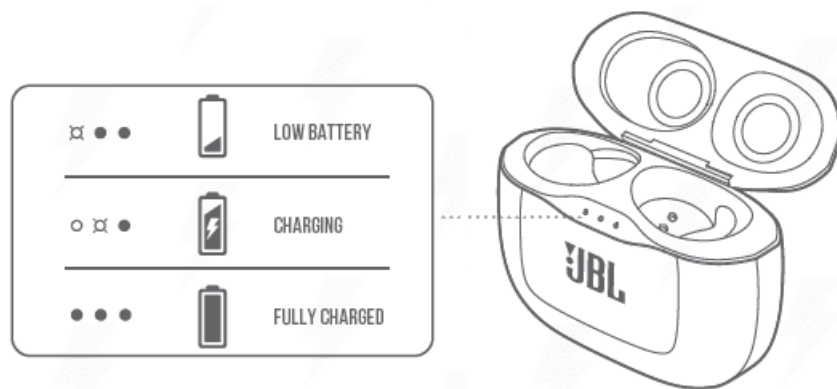

TECH SPECIFICATIONS

Driver Size: 5.8 mm Dynamic Driver
Frequency Response: 20 Hz - 20 kHz
Sensitivity: 96 dB SPL @ 1 kHz 1 mW
Maximum SPL: 96 dB
Microphone Sensitivity: - 38 dBV/Pa @ 1 kHz
Impedance: 14 ohm
Bluetooth transmitted power: <12 dbm
Bluetooth transmitted modulation: GFSK, 1/4 DQPSK, 8DPSK
Bluetooth frequency: 2.402 GHz - 2.480 GHz
Bluetooth profile version: A2DP 1.3, AVRCP 1.5, HFP V1.6
Bluetooth version: 4.2
HEADSET BATTERY TYPE: LITHIUM-ION BATTERY (85 MAH/3.7 V DC)
Charging case battery TYPE: LITHIUM-ION BATTERY (850 MAH/3.7 V DC)
Power Supply: 5 V 1.0 A
Charging time (headset & charging case): <2 hrs from empty
Music playtime with BT on: UP TO 4 hrs
Weight: 73 g

IC RF Exposure Information and Statement

The SAR limit of Canada (C) is 1.6 W/kg averaged over one gram of tissue. Device types: (IC: 6132A-JBLT120TWS) has also been tested against this SAR limit According to this standard, the highest SAR value reported during product certification for head use is 0.049 W / kg. The device was tested for typical bodily operations where the product was kept 5 mm from the head. To maintain compliance with IC RF exposure requirements, use accessories that maintain a separation distance of 0mm between the user's head and the back of the headset. The use of belt clips, holsters and similar accessories shall not contain metal parts in its assembly. Use of accessories that do not meet these requirements may not comply with IC RF exposure requirements and should be avoided.

Head operation

The device was subjected to a typical head manipulation test. In order to comply with RF exposure requirements, a minimum separation distance of 0 cm must be maintained between the user's ear and the product (including the antenna). Head exposure that do not meet these requirements may not meet RF exposure requirements and should be avoided. Use only the supplied or approved antenna.

IC: 6132A-JBLT120TWS



The Bluetooth® word mark and logos are registered trademarks owned by Bluetooth SIG, Inc. and any use of such marks by HARMAN International Industries, Incorporated is under license. Other trademarks and trade names are those of their respective owners.

[JBL-Tune-120-TWS-Earbuds-User-Manual](#) [Download](#)

Questions about your Manual ? Post in the comments!

Related Manuals:

1. [JBL Tune 220TWS True Wireless Earbuds User Manual](#) User Manual JBL Tune 220TWS True Wireless Earbuds WHAT'S...

2. **JBL Club Pro+ TWS Earbuds Quick Start Guide** JBL Club Pro+ TWS Earbuds Quick Start Guide WHAT'S IN...
3. **JBL Tune 500 BT User Manual** User Manual JBL Tune 500 BT What's in the Box...
4. **JBL Tune 115TWS True Wireless In-Ear Headphones User Manual** User Manual JBL Tune 115TWS True Wireless In-Ear Headphones ...
5. **JBL TUNE 500BT Manual** TUNE 500 WIRELESS HEADSET Quick Start Guide 1. What's in...
6. **JBL TUNE 750BTNC Manual** JBL TUNE 750BTNC WHAT'S IN THE BOX POWER ON AND...